

United States Department of the Interior
National Park Service

National Register of Historic Places
Inventory—Nomination Form

For NPS use only
received MAY 21 1984

date entered JUN 21 1984

See instructions in *How to Complete National Register Forms*
Type all entries—complete applicable sections

1. Name

historic Epney

and or common same

2. Location

street & number Off LA ~~HWY~~ 445

N/A not for publication

city, town Amite vic, X vicinity of

state LA code 22 county Tangipahoa Parish code 105

3. Classification

Category	Ownership	Status	Present Use
<input type="checkbox"/> district	<input type="checkbox"/> public	<input checked="" type="checkbox"/> occupied	<input type="checkbox"/> agriculture
<input checked="" type="checkbox"/> building(s)	<input checked="" type="checkbox"/> private	<input type="checkbox"/> unoccupied	<input type="checkbox"/> commercial
<input type="checkbox"/> structure	<input type="checkbox"/> both	<input type="checkbox"/> work in progress	<input type="checkbox"/> educational
<input type="checkbox"/> site	Public Acquisition	Accessible	<input type="checkbox"/> entertainment
<input type="checkbox"/> object	N/A in process	<input checked="" type="checkbox"/> yes: restricted	<input type="checkbox"/> government
	N/A being considered	<input type="checkbox"/> yes: unrestricted	<input type="checkbox"/> industrial
		<input type="checkbox"/> no	<input type="checkbox"/> military
			<input type="checkbox"/> museum
			<input type="checkbox"/> park
			<input checked="" type="checkbox"/> private residence
			<input type="checkbox"/> religious
			<input type="checkbox"/> scientific
			<input type="checkbox"/> transportation
			<input type="checkbox"/> other:

4. Owner of Property

name Mrs. Madeline B. Brasher

504-748-7059

street & number Rt. 2, Box H15-AA

city, town Amite N/A vicinity of

state LA 70422

5. Location of Legal Description

courthouse, registry of deeds, etc. Tangipahoa Parish Courthouse

street & number Mulberry and Bay Streets P.O. Box 667

city, town Amite

state LA 70422

6. Representation in Existing Surveys

title LA Historic Sites Survey

has this property been determined eligible? yes no

date 1984

federal state county local

depository for survey records LA State Historic Preservation Office

city, town Baton Rouge

state LA

7. Description

Condition

excellent
 good
 fair

deteriorated
 ruins
 unexposed

Check one

unaltered
 altered

Check one

original site
 moved date N/A

1891 S ML

Describe the present and original (if known) physical appearance

Epney (c. 1885) is a story and a half, frame, late Greek Revival farmhouse located in rolling, stock grazing country in central Tangipahoa Parish. The house has received only a few minor alterations and hence retains its National Register eligibility.

The five bay house has a pedimented portico and a central hall plan. The main block of the house is two rooms deep and has a linear rear wing. There is also an "L" shaped rear gallery which embraces the back of the house and the rear wing. At each end of the "L" is a small enclosure which resembles a cabinet. These small rooms appear to be original, despite their odd placement. At the rear of the central hall is an enclosed staircase which leads to the finished garret. The house has a total of four chimneys, all set between rooms.

The front portico has four Doric posts, two pilasters, a frieze, and a drip cornice. It is surmounted by an overly vertical pediment with an inscribed six over six window. The front doorway features a transom, side lights, molded capital pilasters, a frieze, and a drip cornice. The facade of the house is surmounted by a frieze which is a bit lighter in proportion than the portico frieze. The gable ends of the house feature end returns. Windows are six over six and the shutters have movable louvers in the lower panels and fixed louvers in the upper panels.

The interior features flush boarded walls and transoms over the doorways. Detailing is simple with flat paneled doors and no cornices. The seven mantels are all of identical design with molded capital pilasters and heavy entablatures.

Assessment of Integrity:

Since construction, the following changes have been made in the house:

1. The rear gallery has been enclosed.
2. A modern kitchen has been installed in the rear wing.
3. A bathroom has been installed.
4. A wide opening has been cut between two of the rooms in the rear wing.

In our opinion, these alterations should be regarded as minor.

To the rear of the house is a c. 1900 board and batten shed. It is listed as a contributing element because it helps establish Epney's historic identity as a farmhouse.

8. Significance

Period	Areas of Significance—Check and justify below			
<input type="checkbox"/> prehistoric	<input type="checkbox"/> archeology-prehistoric	<input type="checkbox"/> community planning	<input type="checkbox"/> landscape architecture	<input type="checkbox"/> religion
<input type="checkbox"/> 1400–1499	<input type="checkbox"/> archeology-historic	<input type="checkbox"/> conservation	<input type="checkbox"/> law	<input type="checkbox"/> science
<input type="checkbox"/> 1500–1599	<input type="checkbox"/> agriculture	<input type="checkbox"/> economics	<input type="checkbox"/> literature	<input type="checkbox"/> sculpture
<input type="checkbox"/> 1600–1699	<input checked="" type="checkbox"/> architecture	<input type="checkbox"/> education	<input type="checkbox"/> military	<input type="checkbox"/> social/
<input type="checkbox"/> 1700–1799	<input type="checkbox"/> art	<input type="checkbox"/> engineering	<input type="checkbox"/> music	<input type="checkbox"/> humanitarian
<input checked="" type="checkbox"/> 1800–1899	<input type="checkbox"/> commerce	<input type="checkbox"/> exploration/settlement	<input type="checkbox"/> philosophy	<input type="checkbox"/> theater
<input type="checkbox"/> 1900–	<input type="checkbox"/> communications	<input type="checkbox"/> industry	<input type="checkbox"/> politics/government	<input type="checkbox"/> transportation
		<input type="checkbox"/> invention		<input type="checkbox"/> other (specify)

Specific dates c. 1885 **Builder/Architect** Builder: William A. Bell

Statement of Significance (in one paragraph) Criterion C

Epney is locally significant in the area of architecture as one of Tangipahoa Parish's architectural landmarks. It is a rare and important example of the Greek Revival style in the parish.

Tangipahoa Parish experienced significant development in the late-nineteenth and early-twentieth centuries due largely to booms in strawberry and lumber production. As a result, it has a large contingent of buildings dating from this period of prosperity. The Queen Anne Revival, Colonial Revival, bungalow, and late Italianate commercial styles are all well represented.

This period of rapid development, however, apparently obliterated the parish's earlier building stock. As far as the State Historic Preservation Office is aware, there are only about half a dozen extant buildings in the parish which represent the Greek Revival taste. Of these, Epney is thought to be the only one with a pedimented portico. Although the pediment is a bit too vertical in proportion, it still represents the parish's closest approximation of the Greek temple form, which is the hallmark of the style.

9. Major Bibliographical References

Historical sketch submitted by owner. Copy in National Register file, LA State Historic Preservation Office.

Tangipahoa Crossings: Excursions Into Tangipahoa History, Baton Rouge, Morgan Publishing Corporation, 1979.

10. Geographical Data

Acreeage of nominated property @1/2 of an acre

Quadrangle name Husser, LA

Quadrangle scale 1:24000

UTM References

A

1	5	7	5	6	5	6	0	3	4	0	0	3	6	0
Zone				Easting				Northing						

B

Zone				Easting				Northing						

C

Zone				Easting				Northing						

D

Zone				Easting				Northing						

E

Zone				Easting				Northing						

F

Zone				Easting				Northing						

G

Zone				Easting				Northing						

H

Zone				Easting				Northing						

Verbal boundary description and justification See enclosed sketch map for description, Justification: Boundary lines were drawn to discretely encompass the significant resource. They cut closely around the house because the nominated buildings are situated on a large farm which is under separate ownership.

List all states and counties for properties overlapping state or county boundaries

state N/A code county code

state code county code

11. Form Prepared By

ASSISTED BY OWNER

name/title National Register Staff

organization Division of Historic Preservation
State of Louisiana

date March 1984

street & number P.O. Box 44247

telephone 504- 342-6682

city or town Baton Rouge

state LA 70804

12. State Historic Preservation Officer Certification

The evaluated significance of this property within the state is:

national state local

As the designated State Historic Preservation Officer for the National Historic Preservation Act of 1966 (Public Law 89-665), I hereby nominate this property for inclusion in the National Register and certify that it has been evaluated according to the criteria and procedures set forth by the National Park Service.

State Historic Preservation Officer signature

Robert B. DeBlieux

Robert B. DeBlieux

title State Historic Preservation Officer

date May 16, 1984

For NPS use only

I hereby certify that this property is included in the National Register

Entered in the
National Register

date

6/21/84

Delores Byers
Keeper of the National Register

Attest:

date

Chief of Registration

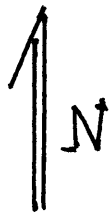

Epney
Tangipahoa Parish
La.

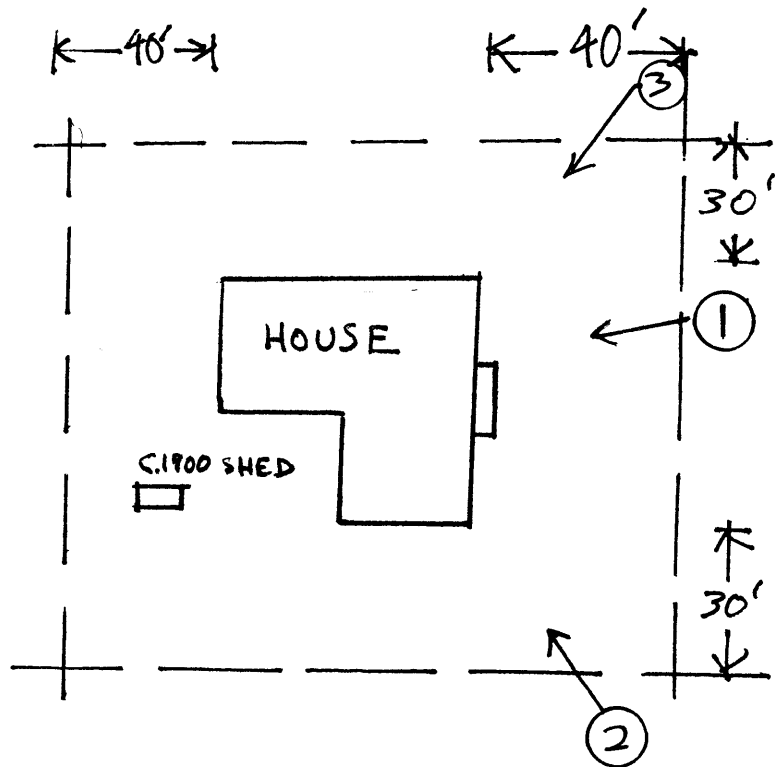

Boundaries parallel
house elevations at the
distances shown.

NOT TO SCALE

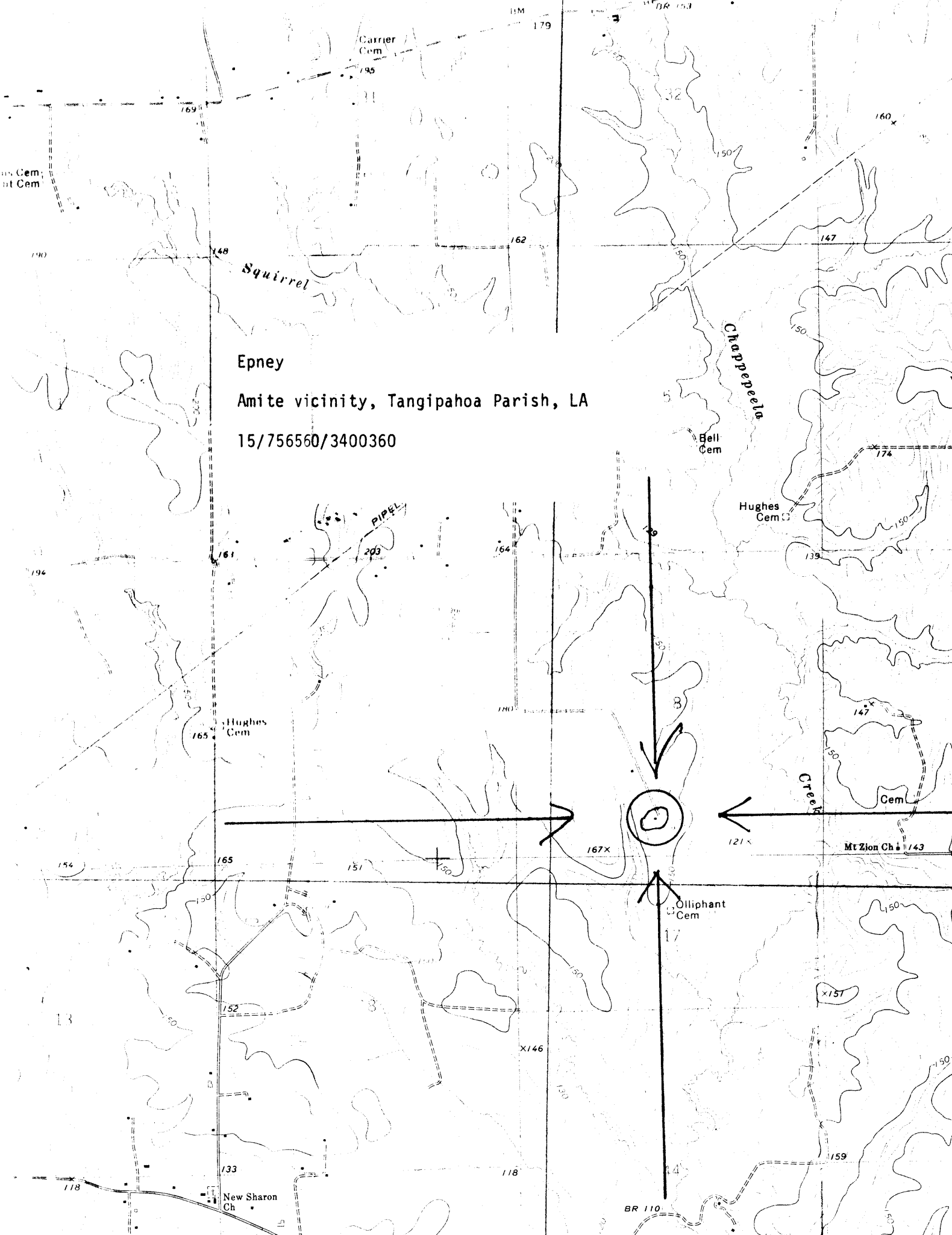

Epney
Amite vicinity, Tangipahoa Parish, LA
15/756560/3400360

