

United States Department of the Interior  
National Park Service

897

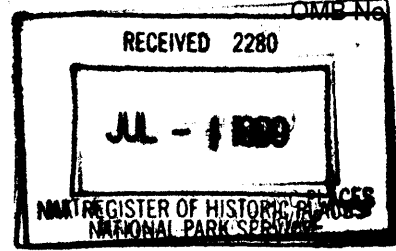

# National Register of Historic Places Registration Form

This form is for use in nominating or requesting determination for individual properties and districts. See instruction in *How to Complete the National Register of Historic Places Registration Form* (National Register Bulletin 16A). Complete each item by marking "x" in the appropriate box or by entering the information requested. If an item does not apply to the property being documented, enter "N/A" for "not applicable." For functions, architectural classification, materials and areas of significance, enter only categories and subcategories from the instructions. Place additional entries and narrative items on continuation sheets (NPS Form 10-900a). Use a typewriter, word processor, or computer, to complete all items.

## 1. Name of Property

historic name Crowley School

other names/site number Crowley County Heritage Center / 5CW26

## 2. Location

street & number 301 Main Street [N/A] not for publication

city or town Crowley [N/A] vicinity

state Colorado code CO county Crowley code 025 zip code 81033

## 3. State/Federal Agency Certification

As the designated authority under the National Historic Preservation Act, as amended, I hereby certify that this [X] nomination [ ] request for determination of eligibility meets the documentation standards for registering properties in the National Register of Historic Places and meets the procedural and professional requirements set forth in 36 CFR Part 60. In my opinion, the property [ X ] meets [ ] does not meet the National Register criteria. I recommend that this property be considered significant [ ] nationally [ ] statewide [ X ] locally. ( [ ] See continuation sheet for additional comments.)

Margaux Coetzee State Historic Preservation Officer 6/16/99  
Signature of certifying official/Title Date

State Historic Preservation Office, Colorado Historical Society  
State or Federal agency and bureau

In my opinion, the property [ ] meets [ ] does not meet the National Register criteria.  
( [ ] See continuation sheet for additional comments.)

Signature of certifying official/Title Date

State or Federal agency and bureau

## 4. National Park Service Certification

I hereby certify that the property is:

- entered in the National Register  
[ ] See continuation sheet.
- determined eligible for the  
National Register  
[ ] See continuation sheet.
- determined not eligible for the  
National Register.
- removed from the  
National Register
- other, explain  
[ ] See continuation sheet.

Edson H. Beall Signature of the Keeper 7/28/99 Date of Action

Crowley School  
Name of Property

Crowley County, CO  
County/State

**5. Classification**

**Ownership of Property**

(Check as many boxes as apply)

- private
- public-local
- public-State
- public-Federal

**Category of Property**

(Check only one box)

- building(s)
- district
- site
- structure
- object

**Number of Resources within Property**

(Do not count previously listed resources.)

Contributing

Noncontributing

|   |   |            |
|---|---|------------|
| 1 | 0 | buildings  |
| 0 | 0 | sites      |
| 0 | 0 | structures |
| 0 | 0 | objects    |
| 1 | 0 | Total      |

**Name of related multiple property listing.**

(Enter "N/A" if property is not part of a multiple property listing.)

N/A

**Number of contributing resources previously listed in the National Register.**

0

**6. Function or Use**

**Historic Function**

(Enter categories from instructions)

Education: school

**Current Functions**

(Enter categories from instructions)

Government: city hall  
Social

**7. Description**

**Architectural Classification**

(Enter categories from instructions)

Late 19<sup>th</sup> and 20<sup>th</sup> Century Revivals:  
Italian Renaissance

**Materials**

(Enter categories from instructions)

foundation Concrete  
walls Brick  
roof Asphalt  
other

**Narrative Description**

(Describe the historic and current condition of the property on one or more continuation sheets.)

Crowley School  
Name of Property

Crowley County, CO  
County/State

## 8. Statement of Significance

### Applicable National Register Criteria

(Mark "x" in one or more boxes for the criteria qualifying the property for National Register listing.)

- A Property is associated with events that have made a significant contribution to the broad patterns of our history.
- B Property is associated with the lives of persons significant in our past.
- C Property embodies the distinctive characteristics of a type, period, or method of construction or represents the work of a master, or possesses high artistic values, or represents a significant and distinguishable entity whose components lack individual distinction.
- D Property has yielded, or is likely to yield, information important in prehistory or history.

### Criteria Considerations

(Mark "x" in all the boxes that apply.)

Property is:

- A owned by a religious institution or used for religious purposes.
- B removed from its original location.
- C a birthplace or grave.
- D a cemetery.
- E a reconstructed building, object, or structure.
- F a commemorative property.
- G less than 50 years of age or achieved significance within the past 50 years.

### Narrative Statement of Significance

(Explain the significance of the property on one or more continuation sheets.)

### Areas of Significance

(Enter categories from instructions)

Architecture

### Periods of Significance

1914

### Significant Dates

1914

### Significant Person(s)

(Complete if Criterion B is marked above).

N/A

### Cultural Affiliation

N/A

### Architect/Builder

unknown

## 9. Major Bibliographical References

### Bibliography

(Cite the books, articles and other sources used in preparing this form on one or more continuation sheets.)

### Previous documentation on file (NPS):

- preliminary determination of individual listing (36 CFR 67) has been requested
- previously listed in the National Register
- previously determined eligible by the National Register
- designated a National Historic Landmark
- recorded by Historic American Buildings Survey

#

- recorded by Historic American Engineering Record

#

### Primary location of additional data:

- State Historic Preservation Office
- Other State Agency
- Federal Agency
- Local Government
- University
- Other

Name of repository:

Colorado Historical Society  
Crowley County Heritage Center

Crowley School  
Name of Property

Crowley County, CO  
County/State

**10. Geographical Data**

**Acreage of Property** 3.65 acres

**UTM References**

(Place additional UTM references on a continuation sheet.)

1. 13 600450 4227840  
Zone Easting Northing

3. Zone Easting Northing

2. Zone Easting Northing

4. Zone Easting Northing

[ ] See continuation sheet

**Verbal Boundary Description**

(Describe the boundaries of the property on a continuation sheet.)

**Boundary Justification**

(Explain why the boundaries were selected on a continuation sheet.)

**11. Form Prepared By**

name/title Norene Aydelotte / Mayor of Crowley (HLW, ed.)

organization Town of Crowley date 26 February 1999

street & number 301 Main Street telephone 719-267-3384

city or town Crowley state Colorado zip code 81033

**Additional Documentation**

Submit the following items with the completed form:

**Continuation Sheets**

**Maps**

A USGS map (7.5 or 15 minute series) indicating the property's location.

A Sketch map for historic districts and properties having large acreage or numerous resources.

**Photographs**

Representative black and white photographs of the property.

**Additional Items**

(Check with the SHPO or FPO for any additional items)

**Property Owner**

(Complete this item at the request of SHPO or FPO.)

name Town of Crowley

street & number 301 Main telephone 719-267-3384

city or town Crowley state Colorado zip code 81033

**United States Department of the Interior  
National Park Service**

**National Register of Historic Places  
Continuation Sheet**

Crowley School  
Crowley County, CO

Section number 7 Page 1

---

**DESCRIPTION**

The 1914 Crowley School occupies the southern half of an entire block within a mostly residential section of Crowley, a small town on Colorado's eastern plains. The building is surrounded by a vast expanse of grass interspersed with a few deciduous trees. Small evergreen trees are scattered along the south and west sides of the building. A short distance from the southeast corner of the building is a flagpole. The school is red brick with its wood trim painted white. The rectangular plan (approximately 42' by 64') building is one story above a raised basement with garden level windows. The truncated hipped roof is covered with asphalt shingles and a brick chimney pierces the north slope. The slightly overhanging eaves have a boxed cornice with a dentilled frieze. The predominant features of the building are the trios of round arched windows and a large ornate, wood shingled, cupola over the front entry. After restoration, the building is in excellent condition and retains its integrity of location, setting, design, materials and workmanship.

Constructed in the Renaissance Revival style, Crowley School is a symmetrical composition with a horizontal emphasis. A concrete sill course encircles the building providing a clear division between the main and lower levels of the school. The running bond brick walls of the lower section have an indented seventh course creating the impression of wide bands of masonry. The basement level has small, flat arched, two vertical light windows with brick voussoirs. The main level has tall, narrow, round-arched window openings containing paired double-hung 1/1 light windows sharing a semicircular transom light. The running bond walls of the main level are broken only by a dentilled stringcourse that follows the curve of each transom light creating an archivolt.

The school faces south onto Main Street, where a long stretch of concrete sidewalk leads from the street to the curved brick sidewalls of the central staircase. The south face of the building is divided into three bays with the central, slightly projecting entrance bay marked by the staircase. The curved brick side walls capped with concrete are a redder, newer brick. A flight of concrete stairs lead to the recessed entrance--double leaf, wooden panelled doors topped with a semi-circular transom light. A keystone in the brick archivolt above the recessed entry is carved with "1914" and above it is a panel with the words "Crowley School." Two narrow arched windows flank this entrance.

Above this central entrance bay is a large cupola emerging from the broken cornice line. The base of the cupola spans nearly the full width of the entrance bay and rises up from a concave sloping base to form a rectangular structure with a steeply pitched pyramidal roof topped with a finial. At each corner there are smaller pyramidal "roofs" with finials. The walls of the cupola are faced with square cut and fish scale wood shingles. Each side of the cupola has a small port hole window with quarter-round lights and a broad molded surround. Above each window is a round-arched opening with cross bracing framed by paneled pilasters.

The remaining two bays of the south face are filled with evenly spaced windows. The main level windows consists of a large arched, central window opening flanked by two smaller arched ones, creating a modified Palladian window motif. The larger window opening consists of paired double hung windows sharing a

**United States Department of the Interior  
National Park Service**

**National Register of Historic Places  
Continuation Sheet**

Crowley School  
Crowley County, CO

Section number 7 Page 2

---

common semicircular transom light. The smaller windows are a single double hung with transom. Directly below each of these main level windows is a flat arched window. The wider openings consists of paired windows.

The large arched window opening is repeated on the east and west sides of the building. Three of these windows are centrally clustered on the wall with their flat-arched, paired counterparts below. One of the large upper level windows on the west side had been removed and a door to a fire escape was added sometime in the 1930s. During restoration, this opening was retrofitted with a custom-designed door containing a 99" tall window to recreate the original fenestration pattern. A handicap accessible ramp leads from this opening. Evergreen trees were planted that will eventually conceal the ramp and minimize its impact.

The rear (north) wall is broken by the slightly projecting brick chimney. To the west of this offset chimney are three evenly spaced segmentally arched window openings each filled with a single, double hung 1/1 light window.

When the school was constructed there were no restrooms inside the building. It is believed that in the 1930s, flat roof concrete additions were constructed on each side of the staircase, destroying portions of the curving side walls. The access to each restroom was through the basement via windows that were converted into doors. At the same time, it is believed that the west side window was converted into a door with a set of fire escape steps below.

The building underwent a three phase restoration/rehabilitation between 1993 and 1998. During the first phase, the roof was replaced and the cupola repaired. The second phase converted the fire escape into a handicap ramp, removed the concrete restrooms, restored windows, and reconstructed the curving side walls of the staircase. The third phase completed the custom designed door to the ramp. Interior work done during the three phases included the creation of two bathrooms, a kitchenette and work space on the main floor and the installation of a new ceiling to replace the one that collapsed. The original plaster walls were painted historic colors and the maple floors were sanded and refinished.

**United States Department of the Interior**  
National Park Service

**National Register of Historic Places**  
**Continuation Sheet**

Section number 8 Page 3

Crowley School  
Crowley County, CO

**SIGNIFICANCE**

The Crowley School is eligible for the National Register under criterion C for its architectural significance. The building is an unusual example of Second Renaissance Revival. This Renaissance Revival style is best identified by its horizontal divisions defined by belt or string courses and by the use of different treatments in each division, notably changes in the shapes, sizes, and surrounds of windows. Arched openings and projecting cornices with dentils are also characteristic of this style. The Crowley School possesses all these distinctive qualities. However, its unusual and elaborate cupola creates an interesting expression of the style. The Second Renaissance Revival was most common in Colorado between 1900 and 1930. The vernacular examples are generally less ornate and on a smaller scale. The Crowley School, its elaborate cupola notwithstanding, is indicative of that pattern. The school is also the only known example of the style in Crowley County. The 1914 Crowley School also carries the distinction of being the oldest public building in Crowley County. The Crowley County Courthouse was not constructed until 1915, and none of the early schools from the other towns in the county still exist.

**Historical Background**

The townsite of Crowley was platted in 1910 and first named Bradley. In August of that year the site was sold to the town company and renamed Dayton. The name was changed to Shiloh when it was learned there was already a town by the name of Dayton. Finally on January 18, 1913, the town site was re-dedicated and given the name of Crowley in honor of the Colorado senator who was influential in forming Crowley County from part of Otero County. The land surrounding the townsite was initially considered good for only grazing cattle and sheep, but when put under irrigation, it proved to be some of the most fertile in the Arkansas Valley. Two store buildings and the Missouri Pacific railroad tracks comprised the town. There was a demand for a place to market farmer's crops and purchase supplies. In a short span of five years, Crowley grew into a thriving town with a population of 500. It boasted one of the largest alfalfa meal mills in the state. The town was incorporated in 1921.

In May of 1914, at a meeting of the school board, the decision was made to build the school. Construction began in July and the following month, the *Crowley County Leader* newspaper reported on the progress:

The erection of a school building has been commenced in Crowley. The ground having been broken last week. The work will be pushed as fast as possible that it may be completed by the time school begins this fall. It will be one of the finest rural school buildings in this section of the state and people of the district look forward to the near future when it ceases to be a rural school but a town school. There will be two rooms and a basement. The building will be erected along modern lines making it a neat attractive and convenient structure for its purposes.

**United States Department of the Interior  
National Park Service**

**National Register of Historic Places  
Continuation Sheet**

Section number 8 Page 4

Crowley School  
Crowley County, CO

The school opened Monday, the 23rd of November 1914 with 44 students. The land cost \$300 and the building and its furnishings cost \$7,700. An *Ordway New Era* article described "the handsome new two story brick building" with its four rooms as "one of the finest buildings for a district the size of Crowley's that can be found anywhere in the country." The article commended the new school for maintaining the four high school grades as well. The school was under the direction of Prof. F. K. Bolles, formerly of Rocky Ford, and Miss Glenn.

The accolades for the school continued in a January 1915 article by the same newspaper.

The school building at Crowley is one of the finest and most convenient buildings its size to be found anywhere. The rooms are commodious, well ventillated [sic] and fitted throughout with the most substantial furniture and fixtures. The seats are modern, the blackboards of the best slate and everything choice. The building is heated by steam heat from a good furnace and the radiators arranged in the best possible manner.... The school house is in reality a community building. It is the idea of the people of the district to use this building for all legitimate purposes, and thus bring about a closes [sic] relation between the parents and the teachers and pupils, as well as promote a better acquaintance and a more friendly spirit.

The school building also served other community needs. Before a church was built in Crowley, services were held in the school building. Services for the Crowley Presbyterian Church were held there until the new building was constructed in 1920. The Commercial Club met there for speeches and refreshments. During the first World War, Red Cross classes were held in the building and it served as a temporary hospital during the 1918 flu epidemic.

The building operated as a four-teacher school, doing two years of high school work with very little high school equipment until 1920 when the Crowley School and two other districts were consolidated to become Crowley Consolidated #1, the first consolidated district in the Arkansas River Valley. That same year a new high school building with gymnasium was constructed on the adjacent block. By 1921, the school housed 175 students and five teachers. This enrollment was about equal to the combined attendance of the three school districts prior to consolidation.

Consolidated RE1J District was created in 1962, which brought all of the schools in the four towns of the county under one district. Crowley School was used for shop and band. The building had been vacant for 15 years (used intermittently for school storage) when the district abandoned it 1992 with the offer of giving it to the town. By this time, the dilapidated school looked like it should be torn down. There were large holes in the roof, seventy-five percent of the windows were gone, and hundreds of pigeons had taken up residence. The building underwent a reversal of fortune as the recipient of three grants from the Colorado State Historical Fund. Prisoners from the nearby Arkansas Valley Correctional Facility in Ordway and members of the Crowley County Heritage Society donated over 5,000 hours of labor to the restoration project.



**United States Department of the Interior  
National Park Service**

**National Register of Historic Places  
Continuation Sheet**

Section number 8 Page 5

Crowley School  
Crowley County, CO

---

Crowley School now serves as a multi-purpose building for all kinds of social, public, and educational activities. The school functions as the Crowley Town Hall with board meetings and municipal court held in the building. The town office is also contained within the building. It serves as a senior center, sponsoring coffees and providing community meals. It is a popular place for wedding receptions, parties, family reunions, 4H and FFA activities, and many other community functions. In addition to being a community center, the building houses the Heritage Museum.

**United States Department of the Interior  
National Park Service**

**National Register of Historic Places  
Continuation Sheet**

Crowley School  
Crowley County, CO

Section number 9 Page 6

---

**BIBLIOGRAPHY**

Apple, Maynard. [former student] Crowley, Colorado. Interview, January 1993.

Blumenson, John J.-G. *Identifying American Architecture*. 2nd ed. Nashville: American Association for State and Local History, 1981.

Crowley County Heritage Society. *Crowley County History*. Dallas: Taylor Publishing, 1980.

*Crowley County Leader*, 29 May; 17 August 1914.

Crowley School Reunion Booklets. 1980, 1985, 1990. (on file at Crowley County Heritage Center).

*Crowley Standard*, 17, 18 March 1921.

Keck, Francis Bollacker. *Conquistadors to the 21st Century*. La Junta, Colorado: Otero Press, 1999.

*Ordway New Era*, 27 November 1914; 22 January 1915; 16 January 1920; 5 March 1920.

Pearce, Sarah J. *A Guide to Colorado Architecture*. Denver: The State Historical Society of Colorado, 1983.

Swift, Gertrude. [former student] Ordway, Colorado. Interview, January 1993.

Talkington, Lex. "Historic and Current Condition of the Property." 1998 (paper on file at Crowley County Heritage Center).

Whiffen, Marcus. *American Architecture Since 1780*. Revised ed. Cambridge: The MIT Press, 1992.

video of Maynard Apple, Clifford Newhouser and Betty Rusher [former students] (on file at Crowley County Heritage Center).

**United States Department of the Interior  
National Park Service**

**National Register of Historic Places  
Continuation Sheet**

Section number 10 Page 7

Crowley School  
Crowley County, CO

---

**GEOGRAPHICAL DATA**

**Verbal Boundary Description**

Lots 169 through 176 and 185 through 192 of Block 6, Original Town of Crowley.

**Boundary Justification**

Although the school is the only building on Block 6, the north half of the lot was historically used as a football field for the adjacent 1920 high school building. The south half is the parcel of land historically associated with the Crowley School..

United States Department of the Interior  
National Park Service

National Register of Historic Places  
Continuation Sheet

Crowley School  
Crowley County, CO

Section number \_\_\_ Page 8

SKETCH MAP

TOWN OF CROWLEY

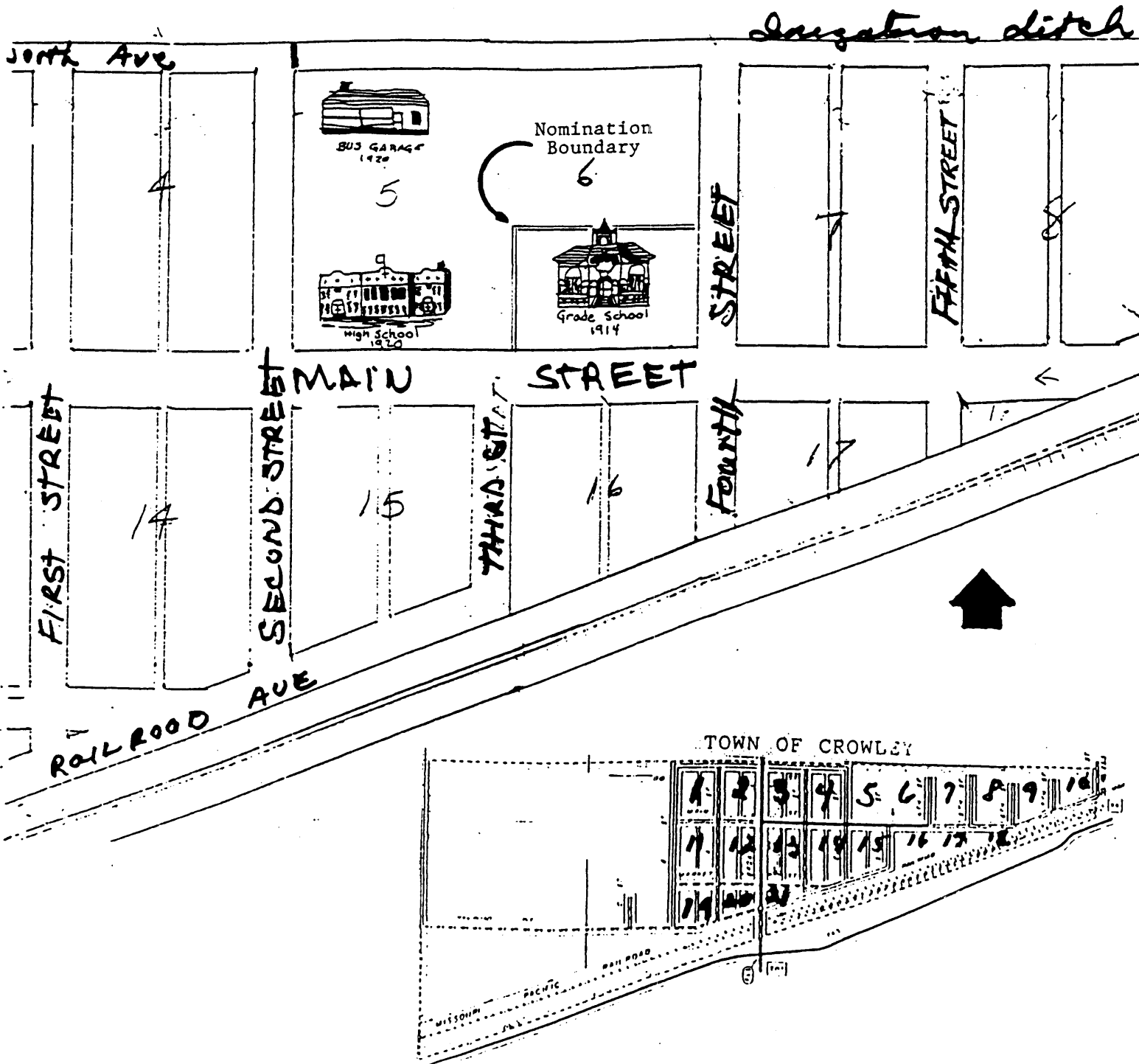

United States Department of the Interior  
National Park Service

National Register of Historic Places  
Continuation Sheet

Crowley School  
Crowley County, CO

Section number \_\_\_ Page 9

U.S.G.S. MAP - Ordway Quad

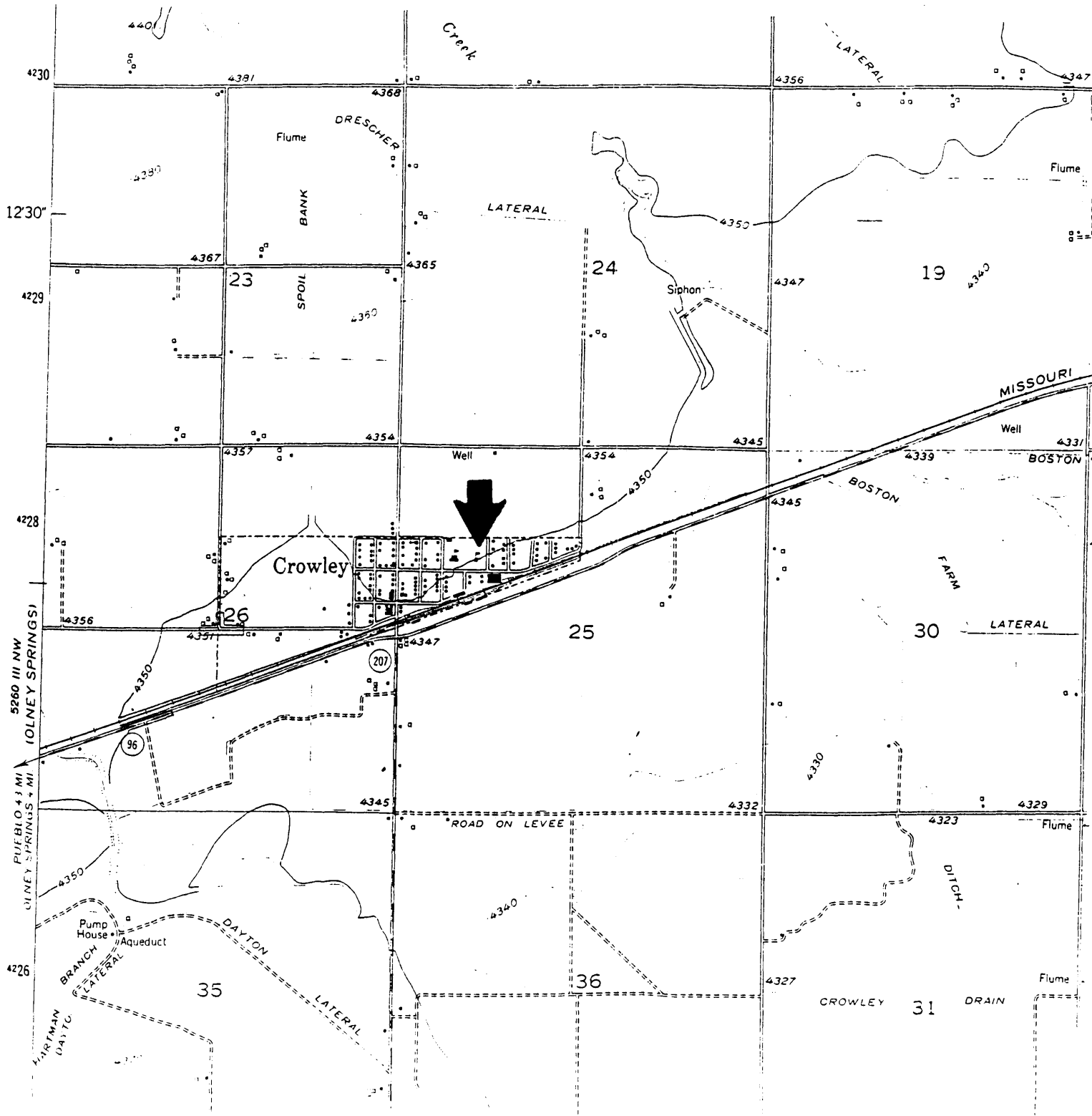

**United States Department of the Interior  
National Park Service**

**National Register of Historic Places  
Continuation Sheet**

Section number \_\_\_ Page 10

Crowley School  
Crowley County, CO

PHOTOGRAPH LOG

The following information is the same for all photographs, except as noted:

Name of property: Crowley School

City, County, and State: Crowley, Crowley County, Colorado

Photographer: David Hashberger

Date of Photograph: April 1999

Location of original negative: Crowley County Heritage Center, 301 Main Street, Crowley

| <u>Photo #</u> | <u>Description</u>                              |
|----------------|---|
| #1             | front (south façade); camera facing north       |
| #2             | front entry and cupola; camera facing northeast |
| #3             | east side; camera facing west                   |
| #4             | west side; camera facing east                   |
| #5             | rear (north); camera facing south               |