

PH 0354279

DATA SHEET

UNITED STATES DEPARTMENT OF THE INTERIOR  
NATIONAL PARK SERVICE

FOR NPS USE ONLY  
RECEIVED APR 5 1977  
DATE ENTERED MAY 24 1977

NATIONAL REGISTER OF HISTORIC PLACES  
INVENTORY -- NOMINATION FORM

SEE INSTRUCTIONS IN HOW TO COMPLETE NATIONAL REGISTER FORMS  
TYPE ALL ENTRIES -- COMPLETE APPLICABLE SECTIONS

**1 NAME**

HISTORIC  Michel Prudhomme Home  
\*\*  
AND/OR COMMON  Same or Ringrose

**2 LOCATION**

STREET & NUMBER 1152 Prudhomme Circle

CITY, TOWN Opelousas  
STATE Louisiana  
VICINITY OF 8th - Gillis Long  
CODE 22  
COUNTY St. Landry  
CODE 097

**3 CLASSIFICATION**

CATEGORY	OWNERSHIP	STATUS	PRESENT USE
<input type="checkbox"/> DISTRICT	<input type="checkbox"/> PUBLIC	<input type="checkbox"/> OCCUPIED	<input type="checkbox"/> AGRICULTURE <input type="checkbox"/> MUSEUM
<input checked="" type="checkbox"/> BUILDING(S)	<input checked="" type="checkbox"/> PRIVATE	<input checked="" type="checkbox"/> UNOCCUPIED	<input type="checkbox"/> COMMERCIAL <input type="checkbox"/> PARK
<input type="checkbox"/> STRUCTURE	<input type="checkbox"/> BOTH	<input checked="" type="checkbox"/> WORK IN PROGRESS	<input type="checkbox"/> EDUCATIONAL <input type="checkbox"/> PRIVATE RESIDENCE
<input type="checkbox"/> SITE	<input type="checkbox"/> PUBLIC ACQUISITION	<b>ACCESSIBLE</b>	<input type="checkbox"/> ENTERTAINMENT <input type="checkbox"/> RELIGIOUS
<input type="checkbox"/> OBJECT	<input type="checkbox"/> IN PROCESS	<input checked="" type="checkbox"/> YES: RESTRICTED	<input type="checkbox"/> GOVERNMENT <input type="checkbox"/> SCIENTIFIC
	<input type="checkbox"/> BEING CONSIDERED	<input type="checkbox"/> YES: UNRESTRICTED	<input type="checkbox"/> INDUSTRIAL <input type="checkbox"/> TRANSPORTATION
		<input type="checkbox"/> NO	<input checked="" type="checkbox"/> OTHER: will be used as museum

**4 OWNER OF PROPERTY**

NAME Preservationists of St. Landry, Inc.

STREET & NUMBER P. O. Drawer 1668

CITY, TOWN Opelousas  
STATE Louisiana

**5 LOCATION OF LEGAL DESCRIPTION**

COURTHOUSE, REGISTRY OF DEEDS, ETC. St. Landry Parish Courthouse

STREET & NUMBER Court Street

CITY, TOWN Opelousas  
STATE Louisiana 70570

**6 REPRESENTATION IN EXISTING SURVEYS**

TITLE None known

DATE

FEDERAL  STATE  COUNTY  LOCAL

DEPOSITORY FOR SURVEY RECORDS

CITY, TOWN

STATE

## 7 DESCRIPTION

CONDITION		CHECK ONE	CHECK ONE
<input type="checkbox"/> EXCELLENT	<input type="checkbox"/> DETERIORATED	<input type="checkbox"/> UNALTERED	<input checked="" type="checkbox"/> ORIGINAL SITE
<input checked="" type="checkbox"/> GOOD	<input type="checkbox"/> RUINS	<input checked="" type="checkbox"/> ALTERED	<input type="checkbox"/> MOVED      DATE _____
<input type="checkbox"/> FAIR	<input type="checkbox"/> UNEXPOSED		

---

### DESCRIBE THE PRESENT AND ORIGINAL (IF KNOWN) PHYSICAL APPEARANCE

The Michel Prudhomme Home is a late 18th/early 19th century plantation home, typical of the character of French Colonial architecture in Louisiana.

The two-story building has a gallery across the front, while the rear gallery, which had rooms on either end, has now been enclosed. (The original lower column and upper colonettes which support this gallery are still in place, and the enclosure is such that it could be removed without damage to the original structure.) The lower story is of soft pink brick, while the upper story is of brique entre poteaux. The exterior walls of the upper story are covered by clapboarding on the sides and rear, while the front is covered by stucco scored to resemble stone. (Portions of this have been removed at either end, exposing the brique entre poteaux.) The lower story has circular brick columns supporting the upper gallery, while the upper gallery has cypress colonettes and balustrade. The house has a high-pitched hipped roof with one dormer on each of the four sides.

The plan of the house is of French origin, with three rooms across the front, two across the rear (now actually three if the enclosed gallery is included), and no interior hallways. (See enclosed floor plan.) Access to the various rooms comes only from the galleries or from the interior doors between rooms. The floors on the lower story were brick, but these were removed and the floors covered with concrete. Originally the lower story was used for the dining room and rooms for supplies, provisions and servants. The center room upstairs was the living room, and bedrooms were on the sides. There are two interior chimneys: one between the central and right front rooms, and the other in the rear. The structural techniques used (brique entre poteaux, hewn cypress timbers, pegged joints) and the stylistic details (French and Federal) strongly suggest a late 18th or early 19th century date of construction for this house.

Alterations to the house have included the enclosing of the rear gallery, the replacement of many of the windows, the concreting of the ground floor, and the addition of modern paneling and tile to some of the rooms. None of these changes are irreversible.

Early outbuildings still on the property are one pigeonier and a corn crib. The pigeonier is located about 60' from the right front corner of the house. Originally there was an identical pigeonier to the left front of the house, but it no longer remains. The interior of the pigeonier has the same type of beaded beams as in the house. The pigeonier is constructed of hewn cypress and has a hipped roof.

The corn crib is located about 30' from the southeast corner of the house. It was originally on the other side of the house, but had to be moved because it no longer fit within the present property boundaries. It is constructed of hewn cypress and has the same pegged construction as seen in the framing of the house roof. Unlike the house and the pigeonier, the corncrib has a gable roof.

UNITED STATES DEPARTMENT OF THE INTERIOR  
NATIONAL PARK SERVICE

**NATIONAL REGISTER OF HISTORIC PLACES  
INVENTORY -- NOMINATION FORM**

FOR NPS USE ONLY

RECEIVED APR 5 1977

DATE ENTERED MAY 24 1977

Michel Prudhomme Home

CONTINUATION SHEET 1

ITEM NUMBER 7 PAGE 2

7. Description (cont'd)

The house was originally located on a large land grant, but now only the immediate surroundings (approximately 141' x 163') remain intact. The property is located at the end of a cul-de-sac next to the General Hospital in a fairly heavily built up area of Opelousas.

# 8 SIGNIFICANCE

PERIOD		AREAS OF SIGNIFICANCE -- CHECK AND JUSTIFY BELOW			
<input type="checkbox"/> PREHISTORIC	<input type="checkbox"/> ARCHEOLOGY-PREHISTORIC	<input type="checkbox"/> COMMUNITY PLANNING	<input type="checkbox"/> LANDSCAPE ARCHITECTURE	<input type="checkbox"/> RELIGION	
<input type="checkbox"/> 1400-1499	<input type="checkbox"/> ARCHEOLOGY-HISTORIC	<input type="checkbox"/> CONSERVATION	<input type="checkbox"/> LAW	<input type="checkbox"/> SCIENCE	
<input type="checkbox"/> 1500-1599	<input type="checkbox"/> AGRICULTURE	<input type="checkbox"/> ECONOMICS	<input type="checkbox"/> LITERATURE	<input type="checkbox"/> SCULPTURE	
<input type="checkbox"/> 1600-1699	<input checked="" type="checkbox"/> ARCHITECTURE	<input type="checkbox"/> EDUCATION	<input type="checkbox"/> MILITARY	<input type="checkbox"/> SOCIAL/HUMANITARIAN	
<input checked="" type="checkbox"/> 1700-1799	<input type="checkbox"/> ART	<input type="checkbox"/> ENGINEERING	<input type="checkbox"/> MUSIC	<input type="checkbox"/> THEATER	
<input checked="" type="checkbox"/> 1800-1899	<input type="checkbox"/> COMMERCE	<input type="checkbox"/> EXPLORATION/SETTLEMENT	<input type="checkbox"/> PHILOSOPHY	<input type="checkbox"/> TRANSPORTATION	
<input type="checkbox"/> 1900-	<input type="checkbox"/> COMMUNICATIONS	<input type="checkbox"/> INDUSTRY	<input type="checkbox"/> POLITICS/GOVERNMENT	<input type="checkbox"/> OTHER (SPECIFY)	
		<input type="checkbox"/> INVENTION			

SPECIFIC DATES

BUILDER/ARCHITECT

## STATEMENT OF SIGNIFICANCE

The Michel Prudhomme Home is locally significant because of its architecture. It is an excellent example of 18th century French-influenced building tradition as it began to be affected by the classicism of the first half of the 19th century. While this type of house was fairly typical of the late 18th/early 19th centuries in this part of Louisiana, remaining examples are rapidly diminishing in number. Outbuildings such as those present here - especially the pigeonnier - are also becoming quite rare. Although the exact construction date of this house is not known, local tradition says that it is the oldest domestic structure in St. Landry Parish.

During the 1770's, Michel Prudhomme received several parcels of land in this vicinity by Spanish land grant and by purchase. In 1796 Prudhomme, who was a native of the Strasbourg area of France, donated some of the property to what is now the St. Landry Catholic Church, enabling that church to be moved from the Washington area to Opelousas in 1798.

Family tradition states that Michel Prudhomme built the house in the 1770's. A report in the American State Papers of 1816 claims that in 1812 this property had already been inhabited and cultivated for twenty-two consecutive years prior to that date. Thus, there are strong suggestions (these along with the form, plan, structural elements and some stylistic details of the house) which indicate that it could have been built in the late 18th century. On the other hand, the physical traits used in this house were quite often in evidence during the early 19th century, and certain other details, such as the scored stucco facade and the nature of the window treatment, indicate that the house may not have been built until around 1820, unless it was built earlier and underwent some changes in the early 19th century. However, regardless of the actual date of construction - whether late 18th or early 19th century - this house is representative of a type which is becoming increasingly rare in Louisiana, and as such should be recognized and preserved.

The house received one of its common names - Ringrose - from the family of the same name who owned and occupied it in later years.

## 9 MAJOR BIBLIOGRAPHICAL REFERENCES

American State Papers.

Conveyance Records, St. Landry Parish, Opelousas, Louisiana.

Land Grant from the Spanish Government to Michel Prudhomme dated the 5th day of March, 1778, signed by Governor B do De Galvez, Governor of the Province of Louisiana.

## 10 GEOGRAPHICAL DATA

ACREAGE OF NOMINATED PROPERTY less than 1

UTM REFERENCES

A 

1	5	5	8	8	6	0	0	3	3	7	9	2	7	5
ZONE			EASTING				NORTHING							

B 

ZONE			EASTING				NORTHING							

C 

ZONE			EASTING				NORTHING							

D 

ZONE			EASTING				NORTHING							

VERBAL BOUNDARY DESCRIPTION

LIST ALL STATES AND COUNTIES FOR PROPERTIES OVERLAPPING STATE OR COUNTY BOUNDARIES

STATE	CODE	COUNTY	CODE
STATE	CODE	COUNTY	CODE

STATE	CODE	COUNTY	CODE
STATE	CODE	COUNTY	CODE

## 11 FORM PREPARED BY

NAME / TITLE C. Kenneth Deshotel, President

ORGANIZATION Preservationists of St. Landry, Inc.

DATE February 1976

STREET & NUMBER P. O. Drawer 1668

TELEPHONE (318) 942-5746

CITY OR TOWN Opelousas

STATE Louisiana

## 12 STATE HISTORIC PRESERVATION OFFICER CERTIFICATION

THE EVALUATED SIGNIFICANCE OF THIS PROPERTY WITHIN THE STATE IS:

NATIONAL  STATE  LOCAL

As the designated State Historic Preservation Officer for the National Historic Preservation Act of 1966 (Public Law 89-665), I hereby nominate this property for inclusion in the National Register and certify that it has been evaluated according to the criteria and procedures set forth by the National Park Service.

~~RECEIVED~~ SIGNATURE Andrea J. Thompson

TITLE State Historic Preservation Officer

DATE March 30, 1977

FOR NPS USE ONLY

I HEREBY CERTIFY THAT THIS PROPERTY IS INCLUDED IN THE NATIONAL REGISTER

DIRECTOR, OFFICE OF ARCHITECTURE AND HISTORIC PRESERVATION  
 ATTEST: Charles A. Harris  
 KEEPER OF THE NATIONAL REGISTER

DATE 5-24-77

DATE 5/29/77

# Michel Prudhomme Home

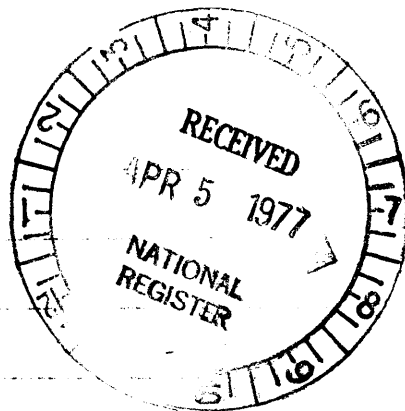
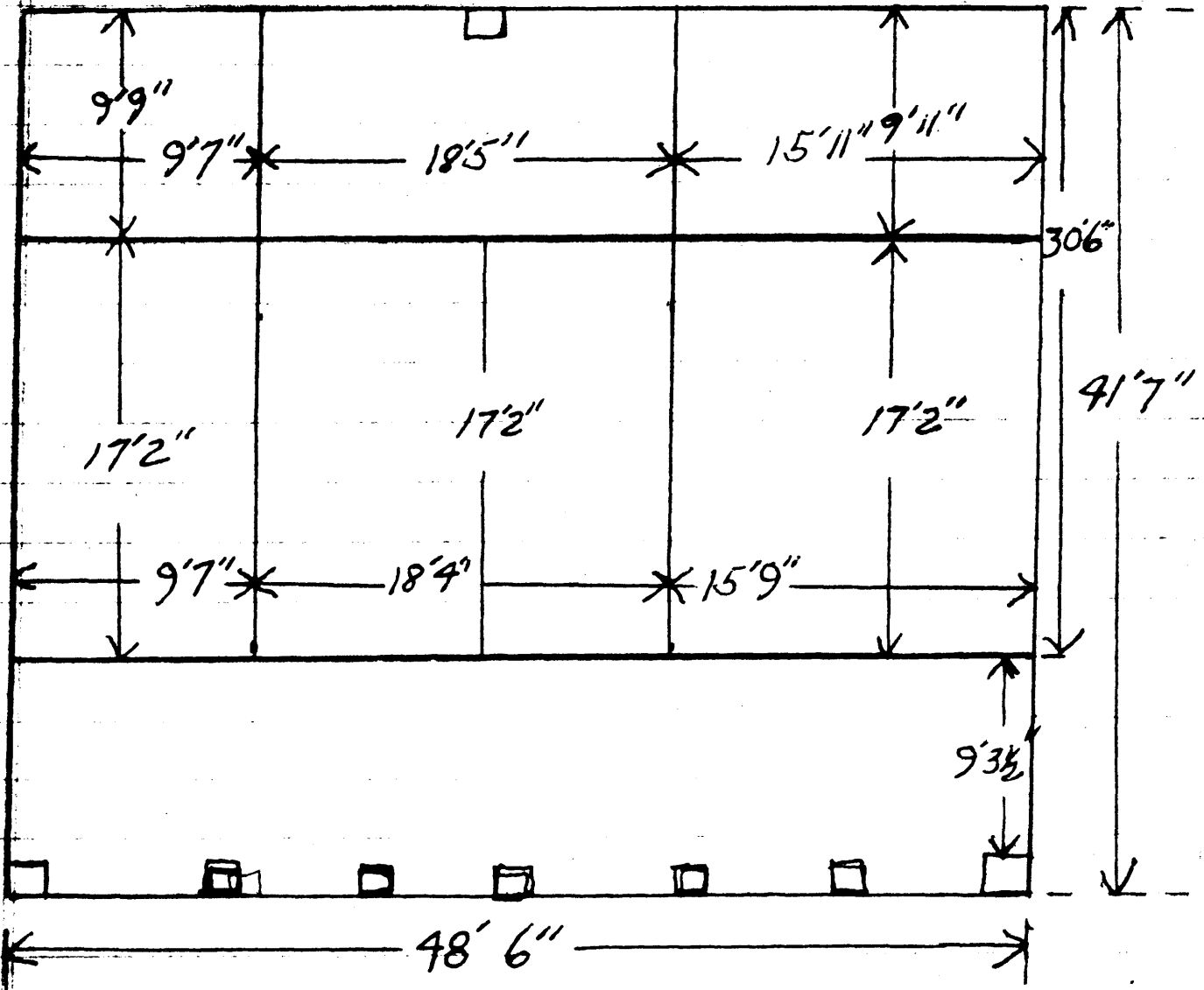

MAY 24 1977