

HB no 4 m
PH0041521

STATE: Arizona	
COUNTY: Pima	
FOR NPS USE ONLY	
ENTRY NUMBER	DATE
	APR 13 1972

**NATIONAL REGISTER OF HISTORIC PLACES
INVENTORY - NOMINATION FORM**

(Type all entries - complete applicable sections)

1. NAME

COMMON:
"Old Main" University of Arizona

AND/OR HISTORIC:
University of Arizona, School of Agriculture (1891)

2. LOCATION

STREET AND NUMBER:
University of Arizona Campus

CITY OR TOWN:
Tucson

Zip 85720

STATE Arizona	CODE 04	COUNTY: Pima	CODE 019
------------------	------------	-----------------	-------------

3. CLASSIFICATION

CATEGORY (Check One)	OWNERSHIP	STATUS	ACCESSIBLE TO THE PUBLIC
<input type="checkbox"/> District <input type="checkbox"/> Site <input type="checkbox"/> Object <input checked="" type="checkbox"/> Building <input type="checkbox"/> Structure	<input checked="" type="checkbox"/> Public <input type="checkbox"/> Private <input type="checkbox"/> Both	Public Acquisition: <input type="checkbox"/> In Process <input type="checkbox"/> Being Considered <input checked="" type="checkbox"/> Occupied <input type="checkbox"/> Unoccupied <input type="checkbox"/> Preservation work in progress	Yes: <input type="checkbox"/> Restricted <input checked="" type="checkbox"/> Unrestricted <input type="checkbox"/> No
PRESENT USE (Check One or More as Appropriate)			
<input type="checkbox"/> Agricultural <input type="checkbox"/> Commercial <input checked="" type="checkbox"/> Educational <input type="checkbox"/> Entertainment	<input type="checkbox"/> Government <input type="checkbox"/> Industrial <input type="checkbox"/> Military <input type="checkbox"/> Museum	<input type="checkbox"/> Park <input type="checkbox"/> Private Residence <input type="checkbox"/> Religious <input type="checkbox"/> Scientific	<input type="checkbox"/> Transportation <input type="checkbox"/> Other (Specify) <input type="checkbox"/> Comments

4. OWNER OF PROPERTY

OWNER'S NAME:
University of Arizona (State of Arizona)

STREET AND NUMBER:

CITY OR TOWN:
Tucson

STATE:
Arizona

CODE
04

5. LOCATION OF LEGAL DESCRIPTION

COURTHOUSE, REGISTRY OF DEEDS, ETC.:
State Land Department

STREET AND NUMBER:
1688 West Adams

CITY OR TOWN:
Phoenix

STATE:
Arizona

CODE
04

6. REPRESENTATION IN EXISTING SURVEYS

TITLE OF SURVEY:
Historic American Buildings Survey

DATE OF SURVEY: 1938 Federal State County Local

DEPOSITORY FOR SURVEY RECORDS:
Library of Congress

STREET AND NUMBER:

CITY OR TOWN:
Washington

STATE:
District of Columbia

CODE
08

SEE INSTRUCTIONS

STATE: Arizona	ENTRY NUMBER APR 13 1972	FOR NPS USE ONLY
COUNTY: Pima	DATE	

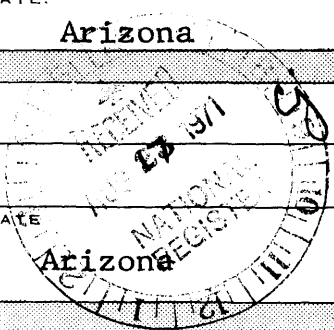

7 DESCRIPTION

CONDITION	(Check One)					
	<input type="checkbox"/> Excellent	<input checked="" type="checkbox"/> Good	<input type="checkbox"/> Fair	<input type="checkbox"/> Deteriorated	<input type="checkbox"/> Ruins	<input type="checkbox"/> Unexposed
	(Check One)			(Check One)		
	<input checked="" type="checkbox"/> Altered Interior			<input type="checkbox"/> Moved		
	<input type="checkbox"/> Unaltered			<input checked="" type="checkbox"/> Original Site		

DESCRIBE THE PRESENT AND ORIGINAL (If known) PHYSICAL APPEARANCE

"OLD MAIN", University of Arizona, Pima County, Tucson, Arizona.
 Dates of Construction - October 27, 1887-October 1, 1891.
 Architect - ~~C. H. Creighton~~; Builder - M. J. Sullivan.

see phone call
 to AZ. 10-7-75
 MSZ

James M. Creighton

Old Main is a two story structure, consisting in plan of a center section about 100' on the north-south sides and 95' on the east-west sides. From the north-south sides of this center section and centered upon these sides, two wings project which are about 50' long and 35' wide. The result in plan is a bi-symmetrical elongated cross about 195' on the long (north-south) axis, and 120' on the short (east-west) axis. All portions of Old Main were constructed and finished at the same time. The interior has witnessed major alterations in response to changing functional demands, while the exterior has changed very little since 1891.

There are four towers, capped with pyramidal roofs and about 50' in height, centered upon the four sides of the cross type plan. These towers mark the entries, with primary entries on the east and west sides and the secondary on the north-south sides. These entries are notable, for they utilize a semi-circular arch to further express the points of entry.

The floor of the first story is about 3' below existing grade, which results in a "raised basement" tucked under a 12' wide roofed porch which surrounds the entire second story. Each floor--first and second-- is reached by stairs centered upon each side. The ceiling heights are 12' for the first story and 17' for the second story. The roof of Old Main can best be described as a variety of the "Mansard" which was a popular architectural mode c. 1890, while the porch roof, which is lower, is a simple sloping shed roof surrounding the entire structure. In general, the exterior character of Old Main is one of horizontality due to the surrounding porch and a resulting deep horizontal shadow which emphasizes this horizontality by accentuating the fascia of the porch roof. The four towers punctuate this horizontality and provide vertical accents as well as expressing entry points.

The basis structural concept is wall-beam. The first story wall is of ashlar stone masonry, while the second story wall to its intersection with the roof is of red brick. Beams in all cases are of dimensioned lumber, with wooden trusses used

SEE INSTRUCTIONS

NATIONAL REGISTER OF HISTORIC PLACES
INVENTORY - NOMINATION FORM

(Continuation Sheet)

STATE Arizona	
COUNTY Pima	
FOR NPS USE ONLY	
ENTRY NUMBER	DATE
	APR 13 1972

(Number all entries)

7. Description (continued)

in the roof structure. The porch floor and roof also utilize demensioned lumber, while the porch posts on the first story are of red brick. The second story porch posts are of wood with a wooden porch handrail between. Some wooden brackets occur on both the porch eaves at the column points and on the cornice of the main structure.

Openings, both doors and windows, are spanned by flat lintels of stone on both stories. The only exceptions to this are the tower entries which are spanned by semi-circular arches of brick. The windows were the double-hung wooden single light type. Exterior doors were the typical paneled raised moulding doors of the 1890's. Roof surfaces have been replaced, and as far as can be ascertained, the present roof is not original.

The interior of Old Main has seen the greatest number of physical alterations, due to continuously changing uses since 1891. At present, the plan has a "through-hall" from east to west on axis of the main entries, while the remainder of the plan responds not to axial symmetry but instead to functional demands. While there have been considerable internal changes since 1891, sufficient detail, i.e., doors, mouldings and other trim, remains which, when correlated with early photographs, gives a clear picture of the original interior if a restoration were contemplated. All interior floors are of wood, and the porch at the second story is also of wood, while the first story exterior floor below the porch is of concrete.

In 1938, due to neglect by the University, Old Main was condemned and ruled as unsafe by city authorities. Nothing was done to rectify this until 1942 when the U. S. Navy took over the structure and provided considerable funds for the necessary repairs. At this time, the Sundt Construction Company of Tucson repointed the exterior walls where needed, and the first story exterior concrete walk below the porch was repaired. The second story porch floor and roof were also renovated, as was the porch handrail and all wooden stairs. All interior wooden floors were put into good condition, and interior walls were patched where necessary. Several bad trusses in the roof were replaced, and roof leaks were repaired. Since this major renovation of 1942, the building has been relatively well maintained, and it continues to function as part of the University. It now

NATIONAL REGISTER OF HISTORIC PLACES
INVENTORY - NOMINATION FORM

(Continuation Sheet)

STATE Arizona	
COUNTY Pima	
FOR NPS USE ONLY	
ENTRY NUMBER	DATE
	APR 13 1972

(Number all entries)

7. Description (continued)

provides space for the ROTC program and other minor campus offices.

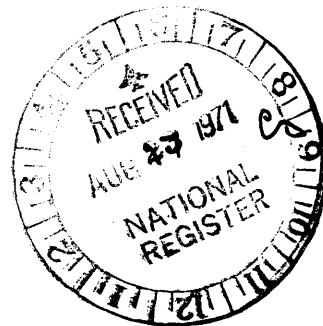

SIGNIFICANCE

PERIOD (Check One or More as Appropriate)

- | | | | |
|--|---------------------------------------|--|---------------------------------------|
| <input type="checkbox"/> Pre-Columbian | <input type="checkbox"/> 16th Century | <input type="checkbox"/> 18th Century | <input type="checkbox"/> 20th Century |
| <input type="checkbox"/> 15th Century | <input type="checkbox"/> 17th Century | <input checked="" type="checkbox"/> 19th Century | |

SPECIFIC DATE(S) (If Applicable and Known) **October 27, 1887 - October 1, 1891**

AREAS OF SIGNIFICANCE (Check One or More as Appropriate)

- | | | | |
|--|---|--|--|
| <input type="checkbox"/> Aboriginal | <input checked="" type="checkbox"/> Education | <input type="checkbox"/> Political | <input type="checkbox"/> Urban Planning |
| <input type="checkbox"/> Prehistoric | <input type="checkbox"/> Engineering | <input type="checkbox"/> Religion/Philosophy | <input type="checkbox"/> Other (Specify) |
| <input type="checkbox"/> Historic | <input type="checkbox"/> Industry | <input type="checkbox"/> Science | _____ |
| <input type="checkbox"/> Agriculture | <input type="checkbox"/> Invention | <input type="checkbox"/> Sculpture | _____ |
| <input checked="" type="checkbox"/> Architecture | <input type="checkbox"/> Landscape Architecture | <input type="checkbox"/> Social/Humanitarian | _____ |
| <input type="checkbox"/> Art | <input type="checkbox"/> Literature | <input type="checkbox"/> Theater | _____ |
| <input type="checkbox"/> Commerce | <input type="checkbox"/> Military | <input type="checkbox"/> Transportation | _____ |
| <input type="checkbox"/> Communications | <input type="checkbox"/> Music | | _____ |
| <input type="checkbox"/> Conservation | | | _____ |

STATEMENT OF SIGNIFICANCE

Old Main is the original University of Arizona. The University was authorized in 1885 by an act of the 13th Arizona Territorial Assembly, which appropriated \$25,000 for the purpose. Two years later, the Regents approved a contract of \$37,969 for construction of "Old Main", which was originally intended to house the School of Mines. Ground was broken on October 27, 1887 in a picturesque ceremony at which school children, soldiers from Fort Lowell, a traveling stock company and citizens of Tucson all participated. Construction went along until funds ran out. When the Regents learned that federal funds were available for schools of agriculture, the School of Mines was moved out, and Old Main became the home of Agriculture. With the resulting federal money, Old Main was completed and opened its doors on October 1, 1891.

Today, Old Main stands in a central position within a great university. Its site is astride an east-west mall, upon which it occupies a most significant position as the termination of vistas from the east and west arrival gates of the University. Thus, it has immense significance as a vital piece of the present campus plan. While fulfilling this focal function, it further acts as a significant symbolic landmark, reminding all who view it of the historical educational aspirations of a western territory which viewed education as a civilizing force on the frontier. It is one of the oldest surviving western educational structures.

Architecturally, Old Main is a well preserved gem of the "Territorial" period of Arizona's history. It preserves today the architectural idiom in use for educational and civic structures in the Southwest of c. 1890. Its exterior, especially, possesses an architectural integrity found too seldom in the Southwest of today, for structures of this vintage have all too often been badly altered or even destroyed.

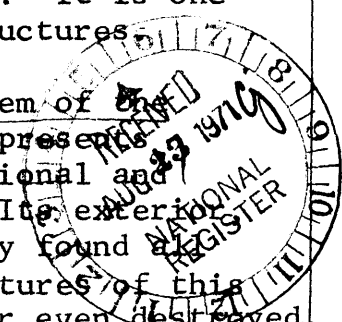

SEE INSTRUCTIONS

9. MAJOR BIBLIOGRAPHICAL REFERENCES

- A. File on "Old Main" (books, clippings and other documents),
Special Collections Division,
University of Arizona Library, Tucson, Arizona
- B. Photographs and other documents,
Collection, Arizona Pioneers' Society Historical Society
Tucson, Arizona

10. GEOGRAPHICAL DATA

LATITUDE AND LONGITUDE COORDINATES DEFINING A RECTANGLE LOCATING THE PROPERTY			O R	LATITUDE AND LONGITUDE COORDINATES DEFINING THE CENTER POINT OF A PROPERTY OF LESS THAN TEN ACRES		
CORNER	LATITUDE	LONGITUDE		LATITUDE	LONGITUDE	
	Degrees Minutes Seconds	Degrees Minutes Seconds		Degrees Minutes Seconds	Degrees Minutes Seconds	
NW	° ' "	° ' "		32° 13' 55"	110° 57' 10"	
NE	° ' "	° ' "				
SE	° ' "	° ' "				
SW	° ' "	° ' "				

APPROXIMATE ACREAGE OF NOMINATED PROPERTY: 3/4 acre

LIST ALL STATES AND COUNTIES FOR PROPERTIES OVERLAPPING STATE OR COUNTY BOUNDARIES

STATE:	CODE	COUNTY:	CODE

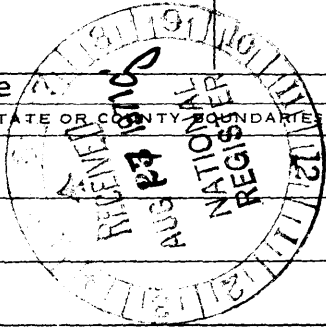

SEE INSTRUCTIONS

11. FORM PREPARED BY

NAME AND TITLE: Prof. Gordon Heck, AIA & Mrs. June Caldwell Martin, Ed., Ariz. Alumni Mag.

ORGANIZATION: College of Architecture DATE: 15 Jan. 1970

STREET AND NUMBER: University of Arizona

CITY OR TOWN: Tucson STATE: Arizona CODE: 04

12. STATE LIAISON OFFICER CERTIFICATION

NATIONAL REGISTER VERIFICATION

As the designated State Liaison Officer for the National Historic Preservation Act of 1966 (Public Law 89-665), I hereby nominate this property for inclusion in the National Register and certify that it has been evaluated according to the criteria and procedures set forth by the National Park Service. The recommended level of significance of this nomination is:

National State Local

Name: Dennis McCarthy
 Title: Director, ASPB
 Date: 8/12/71

I hereby certify that this property is included in the National Register.

Robert M. Utley
 Chief, Office of Archeology and Historic Preservation

Date: 4/13/72

ATTEST:
William J. Stewart
 Keeper of The National Register

Date: _____

**NATIONAL REGISTER OF HISTORIC PLACES
INVENTORY - NOMINATION FORM**

(Continuation Sheet)

STATE Arizona	
COUNTY Pima	
FOR NPS USE ONLY	
ENTRY NUMBER	DATE
	APR 18 1972

(Number all entries)

8. Significance (continued)

There is no surfeit of such structures in the Southwest, and because of its significance as a vital piece of the campus plan and its historical and architectural merit, Old Main deserves to be listed on the National Register of Historic Places.



794,000 FEET

798,000 FEET

MATCH LINE TO SHEET 12-19

802,000 FEET

806,000 FEET

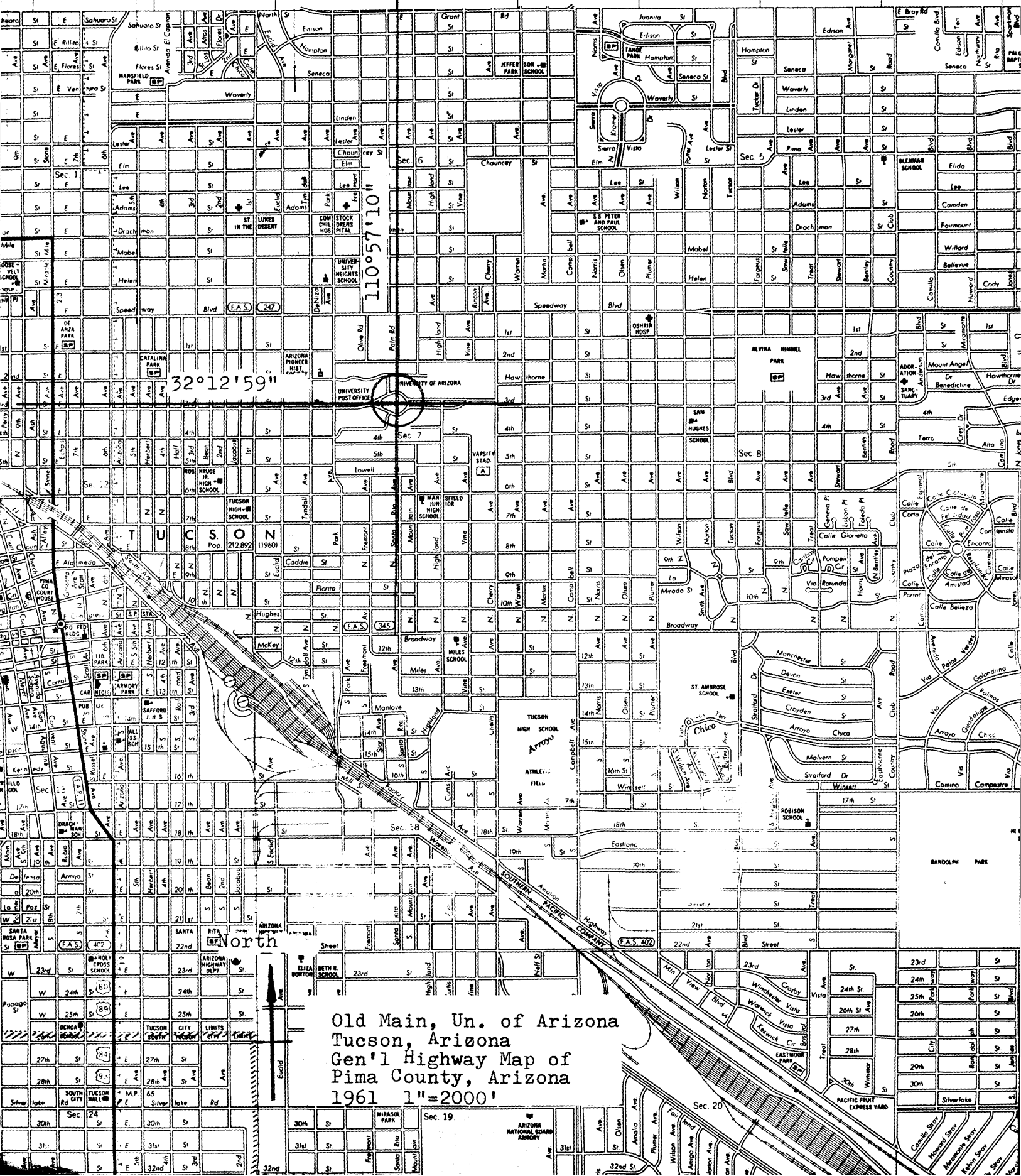

5730

1105710

32°12'59"

UNIVERSITY POST OFFICE

UNIVERSITY OF ARIZONA

Sec 7

Sec 8

Sec 9

Sec 10

Sec 11

Sec 12

Sec 13

Sec 14

Sec 15

Sec 16

Sec 17

Sec 18

Sec 19

Sec 20

Old Main, Un. of Arizona
 Tucson, Arizona
 Gen'l Highway Map of
 Pima County, Arizona
 1961 1"=2000'



32nd

31st

30th

29th

28th

27th

26th

25th

24th

23rd

22nd

21st

20th

19th

18th

17th

16th

15th

14th

13th

12th

11th

10th

9th

8th

7th

6th

5th

4th

3rd

2nd

1st

0th

1st

2nd

3rd

4th

5th

6th

7th

8th

9th

10th

11th

12th

13th

14th

15th

16th

17th

18th

19th

20th

21st

22nd

23rd

24th

25th

26th

27th

28th

29th

30th

31st

32nd

33rd

34th

35th

36th

37th

38th

39th

40th

41st

42nd

43rd

44th

45th

46th

47th

48th

49th

50th

51st

52nd

53rd

54th

55th

56th

57th

58th

59th

60th

61st

62nd

63rd

64th

65th

66th

67th

68th

69th

70th

71st

72nd

73rd

74th

75th

76th

77th

78th

79th

80th

81st

82nd

83rd

84th

85th

86th

87th

88th

89th

90th

91st

92nd

93rd

94th

95th

96th

97th

98th

99th

100th