

KENTUCKY HISTORIC RESOURCES INVENTORY

Site No. Id - 34

1. Historic Name(s) <i>Proctor house</i>		22. ADD/County <i>Bluegrass / Garrard</i>	
Original Owner <i>William? Proctor or Ben Robinson</i>		23. U.S.G.S. Quadrant (15'/75') <i>Bryantville vic.</i>	
2. Present Name <i>Proctor house</i>		24. UTM Reference <i>16 709900 4179880</i>	
3. Location <i>on the west side of Hwy 27 at 1845, so side Ky. R.</i>		Zone Easting Northing	
4. Owner's Name <i>Christian Appalachian Project</i>		25. Coordinate Accuracy <input type="checkbox"/>	
5. Owner's Address <i>Crab Orchard St. Lancaster Ky. 40444</i>		26. Prehistoric Site Object Historic Site Structure Building <input checked="" type="checkbox"/> Other	
6. Open to Public Yes <input type="checkbox"/> No <input checked="" type="checkbox"/>	7. Visible from road Yes <input checked="" type="checkbox"/> No <input type="checkbox"/>	8. Ownership Private <input checked="" type="checkbox"/> Local <input type="checkbox"/> State <input type="checkbox"/> Federal <input type="checkbox"/>	
9. Local Contact/Organization		27. National Register District Name:	
10. Site Plan with North Arrow <i>see attached boundary form</i>		28. Significance Evaluation <input type="checkbox"/>	
11. Architect		29. Status National Landmark <input type="checkbox"/> Date _____ National Register <input type="checkbox"/> Landmark Certificate <input type="checkbox"/> Kentucky Survey <input type="checkbox"/> Local Landmark <input type="checkbox"/> HABS/HAER <input type="checkbox"/>	
12. Builder		30. Historic Theme Primary <i>architecture</i> <input checked="" type="checkbox"/> Secondary <i>settlement</i> <input checked="" type="checkbox"/> Other <input type="checkbox"/>	
13. Date <i>c. 1790</i> A. <input checked="" type="checkbox"/> B. <input type="checkbox"/>		31. Endangered Yes <input type="checkbox"/> No <input checked="" type="checkbox"/>	
14. Style A. <i>Federal</i> <input checked="" type="checkbox"/> B. <input type="checkbox"/>		32. Preservation Project Status <input type="checkbox"/>	
15. Original Use <i>residence</i> <input checked="" type="checkbox"/>		Actual Cost in \$1,000s <input type="checkbox"/>	
16. Present use <i>residence</i>		33. ATTACH PHOTO	
17. Condition <i>good</i> <input checked="" type="checkbox"/>		Roll No. _____ Picture No. _____ Direction _____	
18. Description <i>dry 1 1/2 story, 3 bay, hall-parlor stone house with full cellar; original mantels, chair rail, window frames, banisters, newels (upstairs); porch seems H. R. period, later frame all at rear has dry stone foundation. Located on hill facing south above a spring.</i>		34. Prepared by: <i>C.M. Woolley</i>	
(Continue on Back)		35. Organization	
19. History <i>Built by William? Proctor or Benjamin Robinson on a land grant which ran to the Ky. River. An old stage coach route ran along the branch.</i>		36. Date <i>1982</i>	
20. Significance <i>nearly intact example of early Ky. stone house.</i>		37. Revision Dates	
21. Source of Information <i>19: Forrest Calico (deceased) of Lancaster 18: inspection</i>		38. Staff Review	

18. Look:

the head of a branch
to Ky. R; farm contains
rock fences, and large
stack & tobacco barn with
fine stone foundation which
steps down hillside toward
spring branch, 15 beats,
2 passages.

(photo 6)

(photo 7)

VERBAL BOUNDARY DESCRIPTION & JUSTIFICATION

Beginning at A, where the farm boundary meets Hwy. 27, thence E to B at the old Lancaster-Lexington Rd., thence N to the farm boundary at C, thence running with the boundary & E to D at 27, thence S to the beginning, containing 19.5 acres which now comprises the farm; and including the stone house, spring, spring branch and barn. This whole acreage is ^{over}

SKETCH MAP OF SITE SHOWING BOUNDARIES AND KEY BUILDINGS AND FEATURES WITH NORTH ARROW.

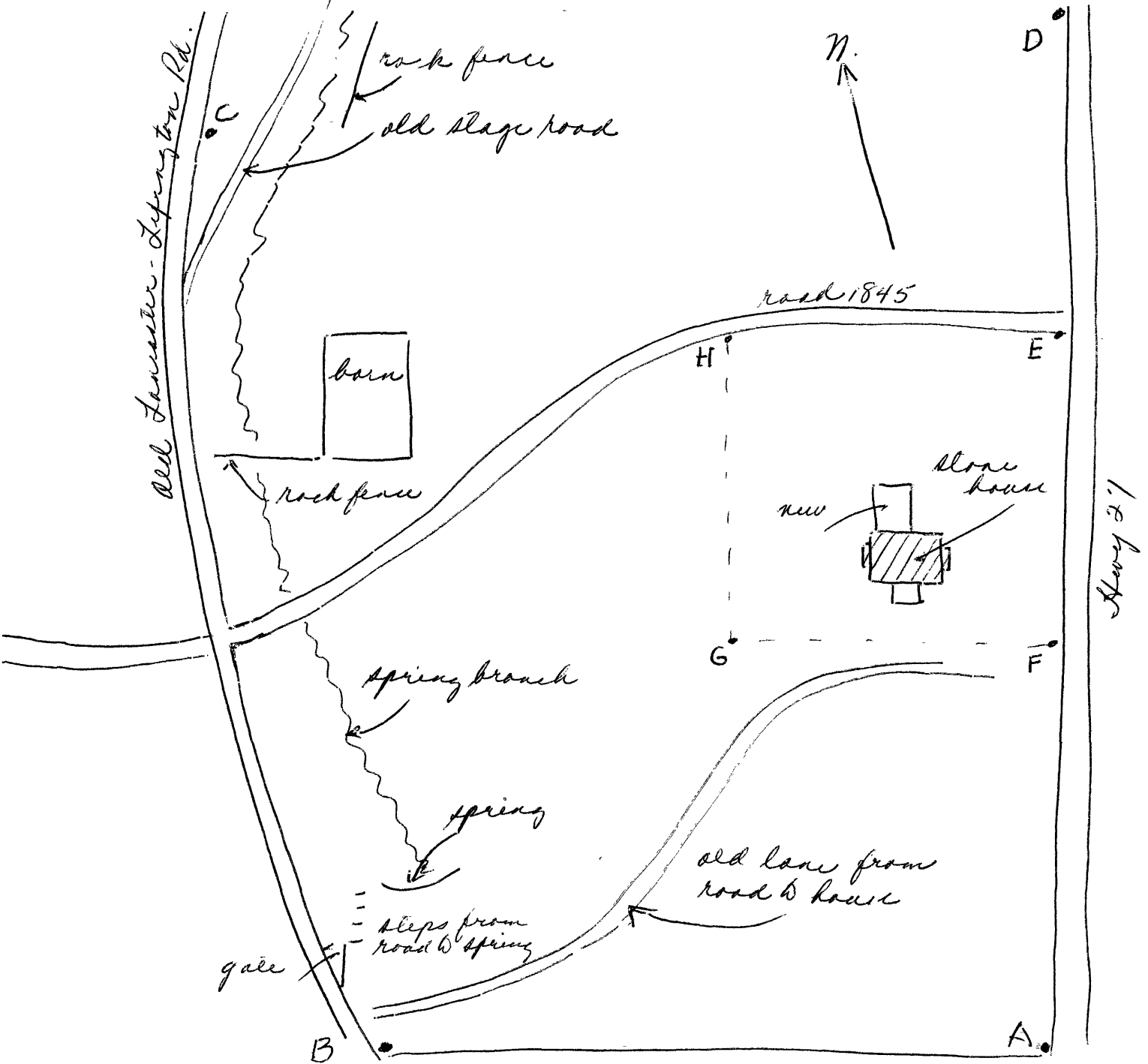

picturesque and adds to the atmosphere of the house's setting. The owner would like the whole farm included.

Alternative boundary would be: beginning at E at the intersection of 27 and 1845, thence S 250 ft along 27 to F, thence parallel to front of house W 200 ft to G, thence at right angle, N 225 ft to H at 1845, thence with road E to the beginning - about 1.1 acres.

United States Department of the Interior
National Park Service

National Register of Historic Places
Continuation Sheet

Section number _____ Page _____

SUPPLEMENTARY LISTING RECORD

NRIS Reference Number: 83002780

Date Listed: 6/23/83

Proctor House
Property Name

Garrard
County

KY
State

Multiple Name

This property is listed in the National Register of Historic Places in accordance with the attached nomination documentation subject to the following exceptions, exclusions, or amendments, notwithstanding the National Park Service certification included in the nomination documentation.

Beth Boland

Signature of the Keeper

8/16/01

Date of Action

=====

Amended Items in Nomination:

The original nomination offered alternate acreage and boundaries, and although the National Register accepted the smaller boundary and resource count into its database, the documentation appears ambiguous and confusing. The correct acreage is 1.1. The correct boundary is a small square around the house, indicated by the lines running between E, E, G, and H on the inventory form's sketch map. The correct resource count is 1 contributing building (the house is the only resource included within the boundary). This clarification was requested by the SHPO.

DISTRIBUTION:

- National Register property file :
- Nominating Authority (without nomination attachment)