

PH0086118

**NATIONAL REGISTER OF HISTORIC PLACES  
INVENTORY - NOMINATION FORM**

(Type all entries - complete applicable sections)

STATE:  
California

COUNTY:  
Riverside

FOR NPS USE ONLY

ENTRY NUMBER: \_\_\_\_\_ DATE: MAY 17 1973

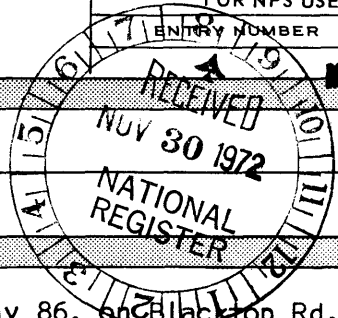

**1. NAME**

COMMON:  
MARTINEZ HISTORICAL DISTRICT

AND/OR HISTORIC:  
MARTINEZ INDIAN AGENCY

**2. LOCATION**

STREET AND NUMBER:  
1 1/2 miles east, 1/2 mile south of Highway 86, on Blacktop Rd. off Ave. 66

CITY OR TOWN:  
TORRES-MARTINEZ INDIAN RESERVATION

STATE: California CODE: 06 COUNTY: Riverside CODE: 065

**3. CLASSIFICATION**

CATEGORY (Check One)	OWNERSHIP	STATUS	ACCESSIBLE TO THE PUBLIC
<input checked="" type="checkbox"/> District <input type="checkbox"/> Site <input type="checkbox"/> Building <input type="checkbox"/> Structure <input type="checkbox"/> Object	<input checked="" type="checkbox"/> Public <input type="checkbox"/> Private <input type="checkbox"/> Both	Public Acquisition: <input type="checkbox"/> In Process <input type="checkbox"/> Being Considered	<input type="checkbox"/> Occupied <input checked="" type="checkbox"/> Unoccupied <input type="checkbox"/> Preservation work in progress
PRESENT USE (Check One or More as Appropriate)			
<input type="checkbox"/> Agricultural <input checked="" type="checkbox"/> Educational <input checked="" type="checkbox"/> Entertainment	<input checked="" type="checkbox"/> Government <input type="checkbox"/> Industrial <input type="checkbox"/> Military <input type="checkbox"/> Museum	<input type="checkbox"/> Park <input type="checkbox"/> Private Residence <input checked="" type="checkbox"/> Religious <input type="checkbox"/> Scientific	<input type="checkbox"/> Transportation <input type="checkbox"/> Other (Specify) _____ <input type="checkbox"/> Comments _____

**4. OWNER OF PROPERTY**

OWNER'S NAME:  
Torres-Martinez Band of Mission Indians

STREET AND NUMBER:  
c/o Mr. Ted Torro, Chairman, 41060 Sunset Lane

CITY OR TOWN: Hemet STATE: California CODE: 06

**5. LOCATION OF LEGAL DESCRIPTION**

COURTHOUSE, REGISTRY OF DEEDS, ETC.:  
Southern California Agency, Bureau of Indian Affairs

STREET AND NUMBER:  
6848 Magnolia Ave., Suite 8

CITY OR TOWN: Riverside STATE: California CODE: 06

**6. REPRESENTATION IN EXISTING SURVEYS**

TITLE OF SURVEY:  
Riverside County Historical Commission Survey of Historic Sites

DATE OF SURVEY: 1971  Federal  State  County  Local

DEPOSITORY FOR SURVEY RECORDS:  
Riverside County Parks Department

STREET AND NUMBER:  
3865 Orange Street

CITY OR TOWN: Riverside STATE: California CODE: 06

STATE: California

COUNTY: Riverside

ENTRY NUMBER: \_\_\_\_\_

DATE: MAY 17 1973

FOR NPS USE ONLY

SEE INSTRUCTIONS

7. DESCRIPTION

CONDITION	(Check One)				<input type="checkbox"/> Ruins	<input type="checkbox"/> Unexposed
	<input type="checkbox"/> Excellent	<input checked="" type="checkbox"/> Good	<input type="checkbox"/> Fair	<input type="checkbox"/> Deteriorated		
	(Check One)					
	<input checked="" type="checkbox"/> Altered	<input type="checkbox"/> Unaltered	(Check One)			
			<input type="checkbox"/> Moved	<input checked="" type="checkbox"/> Original Site		

DESCRIBE THE PRESENT AND ORIGINAL (if known) PHYSICAL APPEARANCE

Presently the District is occupied by a palm grove, several buildings including the three principal historic structures, and the modern meeting hall for the Torres-Martinez Band. The main standing historic structures are three in number: the schoolhouse (Photo #1), the agency building (Photo #2) and the agent's quarters (Photo #3). An earlier adobe building on the premises, which apparently was a previous school building, burned in 1969. In spite of constant care and maintenance by Band members and their supporters in surrounding communities, including a recent large-scale clean-up and painting, the buildings are continuing to fall into disrepair, and are in serious danger of catching fire.

A large archaeological site has been reported about 150 yards to the west of the buildings, from which local collectors have recovered late prehistoric potsherds and projectile points. One large walk-in Cahuilla Indian water well still exists about 350 yards northeast of the buildings, and four more, in various states of repair, extend to the east for a distance of about 3/4 mile.

William Blake reports an Indian village at the location of the District in 1853 (See attachment A). In 1856, according to surveyor John La Croze of The Henry Washington party, two Indian "rancherías" and agricultural fields were located in the immediate vicinity of the District (Map 2). One of the rancherías was probably the village of Puichekiva or wanteauem (Strong 1929:44; Map 3), and one of them is probably represented by the archaeological site and wells. Presumably these rancherías were occupied prior to the advent of whites into the area, but subsequent to the substantial dessication of the Blake Sea, which is thought to have covered the area until approximately 1600 A.D.

The modern tribal building is the only new structure in the immediate vicinity of the historical buildings; it is a medium-sized stucco building in front of which is a bedrock mortar placed there after being seized by the FBI from a vandal who had removed it from federal land in Martinez Canyon, several miles west of the Reservation. Except for the absence of this building and a few other modern facilities, the District in the early 20th century probably looked rather little different from its present appearance, though of course the agency buildings were then new and in continual use.



SEE INSTRUCTIONS

**SIGNIFICANCE**

PERIOD (Check One or More as Appropriate)

- Pre-Columbian |  16th Century |  18th Century |  20th Century  
 15th Century |  17th Century |  19th Century

SPECIFIC DATE(S) (If Applicable and Known) ca. 1600, 1853, 1856, 1876, 1907

AREAS OF SIGNIFICANCE (Check One or More as Appropriate)

- |  |   |  |  |
|--|---|--|--|
| <input type="checkbox"/> Aboriginal              | <input checked="" type="checkbox"/> Education   | <input type="checkbox"/> Political           | <input type="checkbox"/> Urban Planning  |
| <input checked="" type="checkbox"/> Prehistoric  | <input type="checkbox"/> Engineering            | <input type="checkbox"/> Religion/Philosophy | <input type="checkbox"/> Other (Specify) |
| <input checked="" type="checkbox"/> Historic     | <input type="checkbox"/> Industry               |  | _____                                    |
| <input checked="" type="checkbox"/> Agriculture  | <input type="checkbox"/> Invention              | <input type="checkbox"/> Science             | _____                                    |
| <input checked="" type="checkbox"/> Architecture | <input type="checkbox"/> Landscape Architecture | <input type="checkbox"/> Sculpture           | _____                                    |
| <input type="checkbox"/> Art                     | <input type="checkbox"/> Literature             | <input type="checkbox"/> Social/Humanitarian | _____                                    |
| <input type="checkbox"/> Commerce                | <input type="checkbox"/> Military               | <input type="checkbox"/> Theater             | _____                                    |
| <input type="checkbox"/> Communications          | <input type="checkbox"/> Music                  | <input type="checkbox"/> Transportation      | _____                                    |
| <input type="checkbox"/> Conservation            |   |  | _____                                    |

STATEMENT OF SIGNIFICANCE

Prehistoric: The archaeological site within the boundaries of the proposed District was probably occupied sometime after 1600 A.D. by a population involved in economic readaptation following the recession of the Blake Sea. Sometime prior to 1856 this group adopted agriculture, since fields were recorded by Henry Washington's survey team that went through the area in that year. The problem of human adaptation to the dessication of the Blake Sea is the primary research question being addressed by archaeologists in the Coachella Valley, and the early presence of agriculture at this village argues for adoption of plant cultivation as an adaptation to the loss of lake resources.

Historic: The Martinez (subsequently Torres-Martinez) Reservation was established in 1876 by order of President U. S. Grant. The Agency building, Agent's quarters, and school were constructed by 1907 and are today the oldest Indian agency buildings still standing in California, according to research conducted by the Riverside County Historical Commission. They continue to be a significant focus for the community life of the Torres-Martinez Reservation (See attachment B); church services are held in the school building and fiestas are held in the District, during which times the Agency buildings are used as temporary museums. The site of the buildings themselves has been designated a Riverside County Historical Landmark, and a bronze plaque has been erected on the site by the Riverside County Historical Commission (See attachment C).

Architectural: The Agency buildings provide a good example of early 20th-century governmental architecture. The comments of Mr. William Cody, architectural historian for the local chapter of the American Institute of Architects, are attached (See attachment D).

SEE INSTRUCTIONS



**9. MAJOR BIBLIOGRAPHICAL REFERENCES**

Reports of Explorations and Surveys...etc. (See attachment A)  
 Field notes and map of 1856 survey, on file with County Recorder,  
 Riverside, California.  
 Pertinent articles in Riverside PRESS-ENTERPRIZE, May 7, 1970 by Bill  
 Jennings, May 12, 1970 and December 5, 1971 by Tom Patterson  
 ABORIGINAL SOCIETY IN SOUTHERN CALIFORNIA, William D. Strong, University  
 of California Press 1929:44.  
 Various documents in the National Archives, Washington, D.C. (See  
 attachment E)

**10. GEOGRAPHICAL DATA**

LATITUDE AND LONGITUDE COORDINATES DEFINING A RECTANGLE LOCATING THE PROPERTY			O R	LATITUDE AND LONGITUDE COORDINATES DEFINING THE CENTER POINT OF A PROPERTY OF LESS THAN TEN ACRES		
CORNER	LATITUDE	LONGITUDE		LATITUDE	LONGITUDE	
	Degrees Minutes Seconds	Degrees Minutes Seconds		Degrees Minutes Seconds	Degrees Minutes Seconds	
NW	33° 34 ' 05 "	116° 09 ' 50 "		0	0	
NE	33° 34 ' 05 "	116° 07 ' 40 "				
SE	33° 33 ' 15 "	116° 07 ' 40 "				
SW	33° 33 ' 15 "	116° 09 ' 50 "				

APPROXIMATE ACREAGE OF NOMINATED PROPERTY: **2 square miles**

LIST ALL STATES AND COUNTIES FOR PROPERTIES OVERLAPPING STATE OR COUNTY BOUNDARIES

STATE:	CODE	COUNTY	CODE

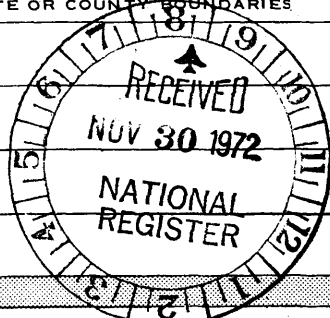

**11. FORM PREPARED BY**

NAME AND TITLE: **Thomas F. King, Member**

ORGANIZATION: **Riverside County Historical Commission** DATE: **Sept. 5, 1972**

STREET AND NUMBER: **3865 Orange Street**

CITY OR TOWN: **Riverside** STATE: **California 92501** CODE: **06**

**12. STATE LIAISON OFFICER CERTIFICATION NATIONAL REGISTER VERIFICATION**

As the designated State Liaison Officer for the National Historic Preservation Act of 1966 (Public Law 89-665), I hereby nominate this property for inclusion in the National Register and certify that it has been evaluated according to the criteria and procedures set forth by the National Park Service. The recommended level of significance of this nomination is:

National  State  Local

Name: [Signature]

Title: State Liaison Officer

Date: NOV 8 1972

I hereby certify that this property is included in the National Register.

[Signature]  
 Chief, Office of Archeology and Historic Preservation

Date: 5/17/73

ATTEST:

[Signature]  
 Keeper of The National Register

Date: 5 15 73

SEE INSTRUCTIONS



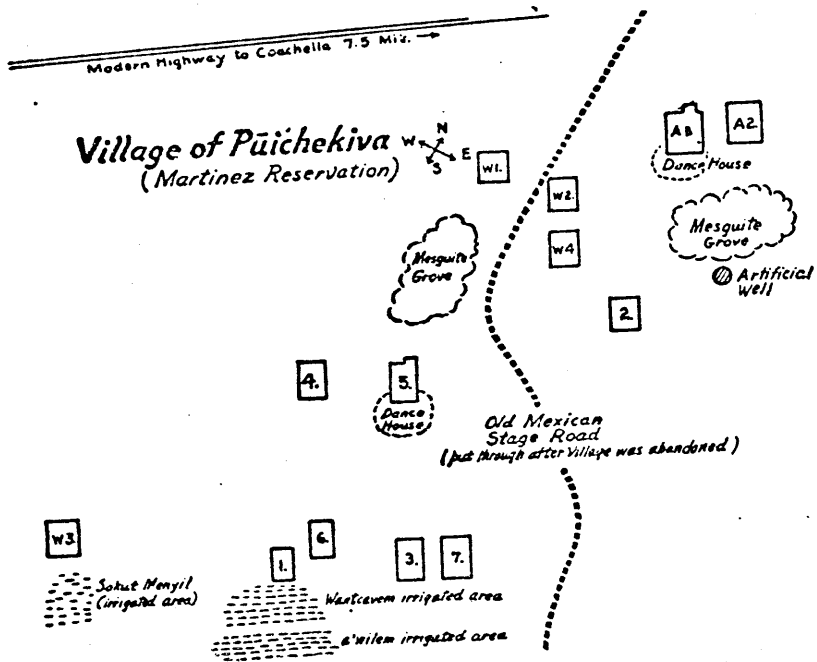

MAP 3: VILLAGE OF PŪICHEKIVA,  
IN OR NEAR PROPOSED HISTORICAL  
DISTRICT.

After Strong 1929:44, Map 3

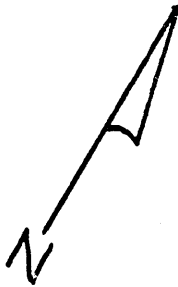

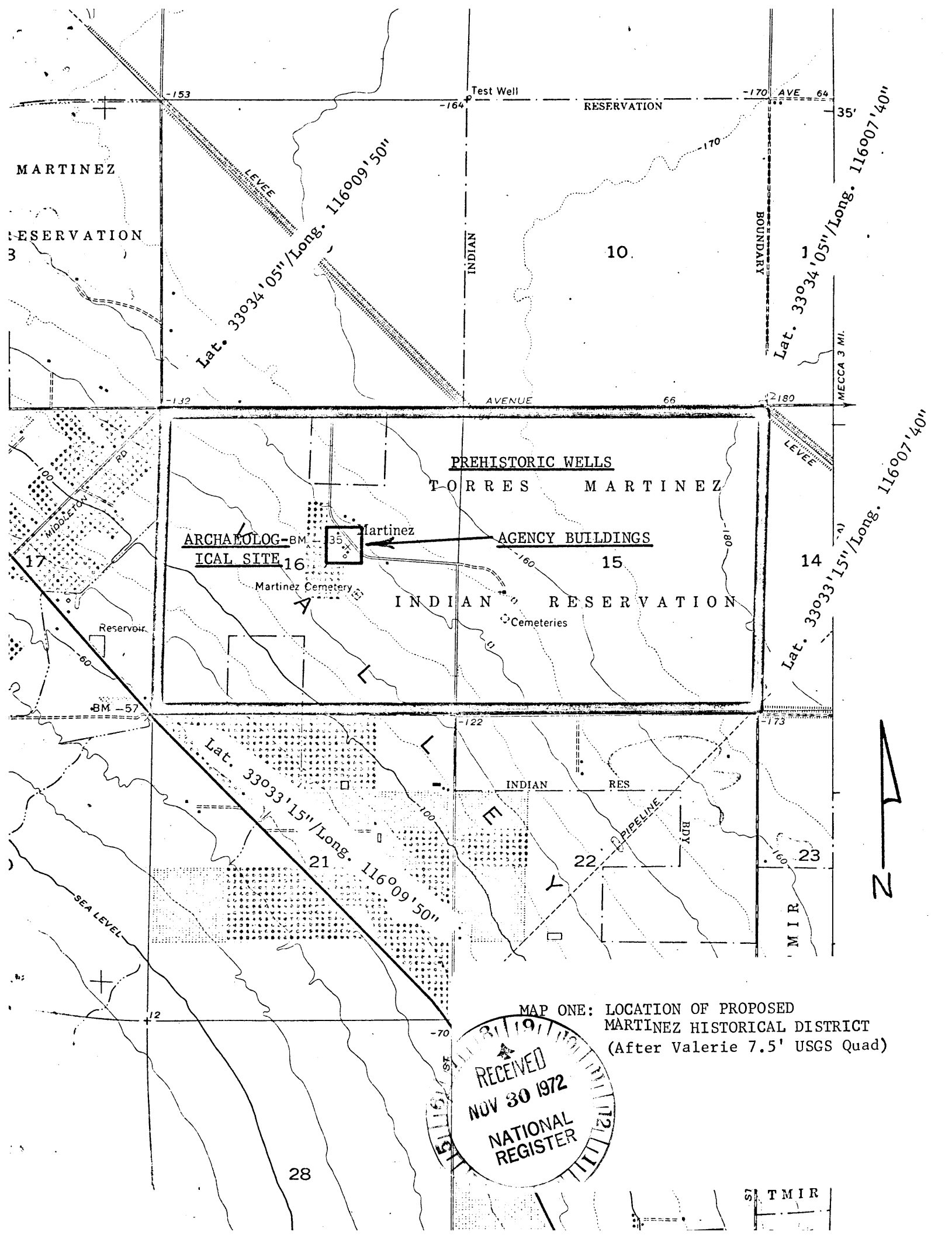

MARTINEZ  
RESERVATION

-153

-164

-170

AVE 64

35'

Lat. 33°34'05"/Long. 116°09'50"

Lat. 33°34'05"/Long. 116°07'40"

-132

AVENUE

66

2180

MECCA 3 MI.

PREHISTORIC WELLS

TORRES MARTINEZ

ARCHAEOLOGICAL SITE 16

Martinez

AGENCY BUILDINGS 15

Martinez Cemetery

Cemeteries

INDIAN RESERVATION

Lat. 33°33'15"/Long. 116°07'40"

Reservoir

BM -57

-122

-173

INDIAN RES

Lat. 33°33'15"/Long. 116°09'50"

-70

MAP ONE: LOCATION OF PROPOSED  
MARTINEZ HISTORICAL DISTRICT  
(After Valerie 7.5' USGS Quad)

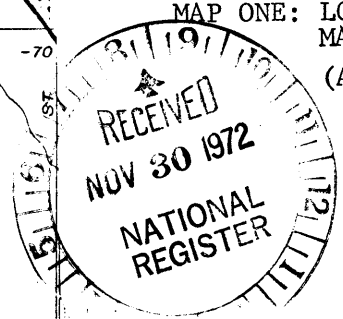

28

TMIR