

FORM B - BUILDING

AREA	FORM NO.
	82

MASSACHUSETTS HISTORICAL COMMISSION
294 WASHINGTON STREET, BOSTON, MA 02108

Town Rehoboth

Address 40 Maple Lane

Historic Name Goff Homestead

Use: Present residence

Original residence

DESCRIPTION:

Date ca. 1750-1780

Source architectural detail

Style Georgian

Architect unknown

Exterior wall fabric clapboard; shingle

Outbuildings attached garge and masonry

carriage house - 19th century

Major alterations (with dates) _____

see text

Moved no Date _____

Approx. acreage 8

Setting 40 feet from road, gable end

to road, wooden environs

PHOTO: (3x3" or 3x5", black & white)
staple to left side of form

Photo number _____

SKETCH MAP

Show property's location in relation to nearest cross streets and/or geographical features. Indicate all buildings between inventoried property and _____
Indicate north

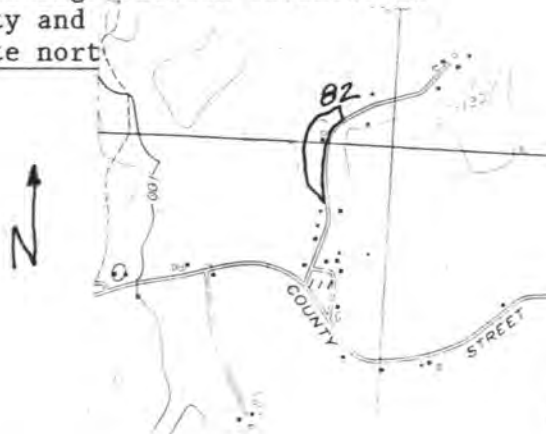

UTM: 19/315360/4635000

Recorded by Leslie C. Abernathy, III

Organization Rehoboth Historical Commission

Date April 1976; revised 1981

(Staple additional sheets here)

ARCHITECTURAL SIGNIFICANCE (Describe important architectural features and evaluate in terms of other buildings within the community.)

The Goff Homestead represents a rare and unusual period architectural form both in Rehoboth and in the region. Although the characteristic Georgian central hall plan has been partially altered during the 19th and early 20th century modifications, it retains its original trabeated entrance treatment and many interior details including mantels and chairrails. Its most striking features, however, are two triangular end chimneys. The east stack has been covered due to chimney fire damage, but the west is intact. Few double chimney houses were built or have

(Continued)

HISTORICAL SIGNIFICANCE (Explain the role owners played in local or state history and how the building relates to the development of the community.)

The ancestral home of the numerous local Goffs who are descended from George L or Bradford Goff was purchased by their father Asa Goff in 1784. It is unclear whether he actually built the house. The Goff family owned the house, operating a dairy farm here, until ca. 1920, when it was sold.

The Goff Homestead embodies distinctive characteristics of Georgian period architecture as well as illustrating an uncommon and perhaps a discrete local variation in chimney design, and thus meets criterion C of the National Register of Historic Places individually.

BIBLIOGRAPHY and/or REFERENCES (name of publication, author, date and publisher)

Snape, Sue Ellen. Mighty Liberty Men, 1976, p. 124.

Massachusetts Historical Commission. Historic and Archaeological Resources of Southeast Massachusetts, Boston, 1982.

INVENTORY FORM CONTINUATION SHEET

MASSACHUSETTS HISTORICAL COMMISSION
Office of the Secretary, Boston

Community: Rehoboth	Form No: 82
Property Name: Goff Homestead	

Indicate each item on inventory form which is being continued below.

Architectural Significance (Continued)

survived in Rehoboth. This is one of two known examples of this particular end-chimney treatment remaining in Rehoboth, and the only in a 2½-story wood frame house (see Form #36). Further, for their canted chimneys, both houses are considered to be extremely rare and perhaps unique in Massachusetts (MHC 1982).

The Goff Homestead formed the center of a large farmstead into the 20th century. It is located on a large peninsula jutting north into Squannakonk Swamp. The house was clearly built with reference to terrain and practicality, not the road. It faces south with its gable end to Maple Land which was not paved full length until ca. 1950 and is still a dead end. A 19th century stone walled carriage shed attached to the house once opened onto the road. There are several archaeological features known to be present: a large barn across the road, which went down in the 1938 hurricane; what may be the original well is located in front of the house; a privy once behind the house and taken down ca. 1950; and large amounts of 19th century ceramics, glass, etc. have been surface collected around the house.

Staple to Inventory form at bottom

United States Department of the Interior National Park Service National Register of Historic Places Inventory—Nomination Form

For NPS use only
received
date entered

Continuation sheet

Item number

Page 3 of 4

Multiple Resource Area
Thematic Group

Name Rehoboth Multiple Resource Area
State Massachusetts

Nomination/Type of Review

Date/Signature

- | | | | |
|---|----------------------------------|------------|-------------------------------|
| 21. Goff Farm | Substantive Review | Keeper | <u>Thomas W. Dwyer 6/6/83</u> |
| | Entered in the National Register | Attest | _____ |
| 22. Goff Homestead | | for Keeper | <u>Delores Byers 6/6/83</u> |
| | | Attest | _____ |
| 23. Hornbine Baptist Church | Entered in the National Register | for Keeper | <u>Delores Byers 6/6/83</u> |
| | | Attest | _____ |
| 24. Hornbine School | Entered in the National Register | for Keeper | <u>Delores Byers 6/6/83</u> |
| | | Attest | _____ |
| 25. Horton, Welcome, Farm | Entered in the National Register | for Keeper | <u>Delores Byers 6/6/83</u> |
| | | Attest | _____ |
| 26. House at 197 Hornbine Road | Entered in the National Register | for Keeper | <u>Delores Byers 6/6/83</u> |
| | | Attest | _____ |
| 27. House at 30 Kelton Street | Entered in the National Register | for Keeper | <u>Delores Byers 6/6/83</u> |
| | | Attest | _____ |
| 28. Ingalls-Wheeler-Horton Homestead Site | Entered in the National Register | for Keeper | <u>Delores Byers 6/6/83</u> |
| | | Attest | _____ |
| 29. Kingsley House | Entered in the National Register | for Keeper | <u>Delores Byers 6/6/83</u> |
| | | Attest | _____ |
| 30. Knapp, Seth, Jr., House | Entered in the National Register | for Keeper | <u>Delores Byers 6/6/83</u> |
| | | Attest | _____ |

8. Significance

Period _____ Area of Significance—Check and justify below

Specific dates _____ Builder/Architect _____

Statement of Significance (in one paragraph)

- _____ summary paragraph
- _____ completeness
- _____ clarity
- _____ applicable criteria
- _____ justification of areas checked
- _____ relating significance to the resource
- _____ context
- _____ relationship of integrity to significance
- _____ justification of exception
- _____ other

9. Major Bibliographical References

10. Geographical Data

Acres of nominated property _____

Quadrangle name _____

UNIT References _____

Verbal boundary description and justification _____

11. Form Prepared By

12. State Historic Preservation Officer Certification

The evaluated significance of this property within the state is:

_____ national _____ state _____ local

State Historic Preservation Officer signature _____

title _____ date _____

13. Other

- _____ Maps
- _____ Photographs
- _____ Other

Questions concerning this nomination may be directed to _____

Signed _____ Date _____ Phone: 202 272-3504

Comments for any item may be continued on an attached sheet



19:10

RAHS #82

Goff Homestead

Rehoboth MRA, Ma



40 Maple Lane
 Goff Homestead (form 82)
 Town of Rehoboth Property Map
 scale 1"=200'
 1978

Please refer to the map in the
Multiple Property Cover Sheet
for this property

Multiple Property Cover Sheet Reference Number: 64000292