

# HISTORIC PROPERTY INVENTORY FORM

State of Washington  
Office of Archaeology and Historic Preservation  
111 W. 21st Ave. KL-11  
Olympia, WA 98504  
(206) 753-5010

## IDENTIFICATION SECTION

Site No.: 39-265  
Site Name: Historic Powell House  
Common \_\_\_\_\_  
Field Recorder: J. Kipp/G. Grulich  
Date Recorded: 7/19/86  
Owner's Name: Browning, Louis and Don  
Street: 107 S. 9th St.  
City/Town: Yakima  
County: 39  
Zip Code: 98901

Status:  
National Register   
State Register   
Survey/Inventory   
Determined Eligible   
Other (NHL, HABS, HAER) Indicate

Classification \_\_\_\_\_ Date: \_\_\_\_\_  
District   
Site   
Building   
Structure   
Object

## LOCATION SECTION

Street Number 207 S. 9th St.  
City/Town Yakima Zip Code 98901  
County 39 Twp. 13 Range 19 Sect. 19 ¼ Sect. NE ¼ Sect. SE  
Tax No./Parcel No. 191319-14081  
UTM References Zone 10 Easting 692410 Northing 5163760  
Acreage: .94 USGS Quadrangle: Yakima East (7.5)  
Legal boundary description:  
North Yakima, S 214 feet of  
N 660.3 feet of W 233 feet of  
SE ¼ of NE ¼. Except W 20  
feet and S 22 feet for road.  
Scale 1:24,000

## PHOTOGRAPHY

Photography Neg. No.: 11-27  
(Roll No. + Frame No.)  
View: NE  
Date: 8/29/85

## DESCRIPTION SECTION

### Materials & Features/Structural Types:

Roof Material:  
Wood Shingle   
Asbestos/Asphalt Shingle   
Slate   
Tar   
Metal (specify) \_\_\_\_\_   
Other (specify) \_\_\_\_\_   
Roof Type:  
Gable   
Flat   
Monitor   
Gambrel   
Shed

Foundation:  
Log   
Post & Pier   
Stone   
Concrete   
Block   
Poured   
Brick   
Other (specify) \_\_\_\_\_   
Other (specify) Round Turret

### Style/Form: (Check one or more of the following)

Pioneer/Homestead   
Greek Revival   
Gothic Revival   
Italianate   
Second Empire   
Stick/Eastlake   
Queen Anne   
Shingle Style   
Richardsonian Romanesque   
Chicago School/  
Sullivanesque   
Beau Arts Classicism   
Princess Anne   
Neo-Colonial   
Dutch Colonial   
Spanish Colonial   
English Revival   
Bungalow   
Craftsman   
American Foursquare/  
Classic Box   
Prairie Style   
Art Deco/Moderne   
Commercial Vernacular   
Vernacular   
Other (specify) \_\_\_\_\_

Cladding (Exterior Wall Surfaces):  
Log   
Horizontal Wood Siding { Rustic/Novelty   
Clapboard   
Wood Shingle { Split Shakes   
Re-sawn   
Machine Shingle   
Asbestos/Asphalt Shingle   
Brick Masonry   
Stone Masonry   
Stucco   
Terra Cotta   
Carrara Glass   
Vinyl/Aluminum Siding   
Other (specify) \_\_\_\_\_

Height/No. of Stories:  
One   
One and one-half   
Two   
Two and one-half   
Three   
Other (specify) \_\_\_\_\_

Integrity: (include detailed description in 'Additional Description' section)

Additions to house plan   
Changes to windows   
Changes to roof shape   
Changes to interior plan   
Other (specify) \_\_\_\_\_

Intact   
Slight   
Moderate   
Excessive

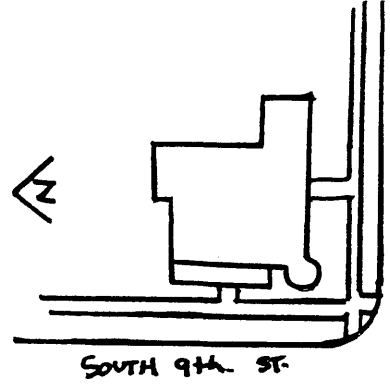

# NARRATIVE SECTION

Areas of Significance/Study Unit Themes: (check one or more of the following)

Agriculture	<input type="checkbox"/>	Conservation	<input type="checkbox"/>	Military	<input type="checkbox"/>
Architecture/Landscape Architecture	<input checked="" type="checkbox"/>	Education	<input type="checkbox"/>	Politics/Government/Law	<input type="checkbox"/>
Arts	<input type="checkbox"/>	Entertainment/Recreation	<input type="checkbox"/>	Religion	<input type="checkbox"/>
Commerce	<input type="checkbox"/>	Ethnic Heritage (specify) _____	<input type="checkbox"/>	Science & Engineering	<input type="checkbox"/>
Communications	<input type="checkbox"/>	Health/Medicine	<input type="checkbox"/>	Social Movements/Organizations	<input type="checkbox"/>
Community Planning/Development	<input type="checkbox"/>	Manufacturing/Industry	<input type="checkbox"/>	Transportation	<input type="checkbox"/>
				Other (Specify) _____	<input type="checkbox"/>

Statement of Significance: (Reference names, dates, events, areas of significance/study unit themes)

Date of Construction: ca 1895

Architect/Builder: \_\_\_\_\_

Historical Significance:

The residence at 207 South 9th Street is associated with North Yakima's earliest development period: 1885 -1900. Properties at the eastern edge of town were usually sold in larger parcels and small farms were established. This house is significant as an excellent example of the "Queen Anne" style designed and built by tradesmen/ carpenter/contractors for modest/middle income families. The Powell House is typical of the modest one-story residences built in the "Queen Anne" style in Yakima. Intersecting gables and a conical roofed, corner octagonal tower bring significant Queen Anne elements into this structure. Extensive spindlework has been used to frame covered porches on two sides of the residence. Fishscale shingles and multi-paned art glass windows are decorative features incorporated into this fine example of Queen Anne. The house has retained its original elements and integrity during its two family ownerships. The property was part of a patent land grant to Samuel Wilson, recorded June 1, 1894. Ida Powell purchased the property in October, 1894, and the deed was recorded in May, 1895. The Powell's owned this property for 75 years. Ida's husband, A. Finley Powell listed his occupation as a stock dealer in the 1900 Federal Census. A brother, William L. Powell, resided at this address until 1965; his occupation was listed as rancher in early City Directories. In 1965, a daughter, Rita Powell Bock, sold the property to Jessie F. Browning. Browning died in 1975. Current owners are Louis and Don Browning.

**Additional Description of Physical Appearance & Significant Architectural Features:**  
(Architectural significance; can include interior & site features; address integrity issues specifically)

207 South 9th Street is a one story, wood framed residence with an irregular plan of the "Queen Anne" style. The roof plan is intersecting gables with a steeply pitched conical roof above a small octagonal turret. The turret is decorated with fishscale shingles and with clapboard siding with trimmed corners. The remaining siding is also clapboard. The front gable end contains diamond and fishscale shingles while the side gable (south) has clapboards. The porches include spindlework overhead and the front porch is supported by turned posts. A large addition was added to the east with a different plate line and with windows of 1/1 double-hung units unlike the remainder of the building. These windows' upper units are of multi-paned colored glass above single lower panes. The building rests on a brick foundation. The integrity of the front elevation has been maintained with original materials and forms. The side elevation has been significantly altered by the addition because of its size, although this addition appears to have been added during the early history of the house and is sympathetic to the original design.

Total contributing properties: 1 (house); noncontributing: 0

**Major Bibliographic References:** (Include books, periodicals, manuscripts, newspapers, legal documents, maps, photos, oral sources, etc.)

Polk, R.L. & Co. Yakima City Directory, 1903-1965.

1900 Federal Census, Yakima County, Washington. Abs. Yakima Genealogy Society, p. 64.

Yakima County Assessor's records

Index to Lands, 5 p. 28-33. Index to Lands, 8 p. 208. Schreiner Land Title Co., 30 North 2nd Street, Yakima).