

UNITED STATES DEPARTMENT OF THE INTERIOR
NATIONAL PARK SERVICE

FOR NPS USE ONLY
RECEIVED JAN 29 1979
DATE ENTERED OCT 15 1979

**NATIONAL REGISTER OF HISTORIC PLACES
INVENTORY -- NOMINATION FORM**

SEE INSTRUCTIONS IN *HOW TO COMPLETE NATIONAL REGISTER FORMS*
TYPE ALL ENTRIES -- COMPLETE APPLICABLE SECTIONS

1 NAME

HISTORIC *Norfolk National Register District*

AND/OR COMMON
Same

2 LOCATION

STREET & NUMBER: *The village green properties abutting the village green, and the business district north of the village green.*

CITY, TOWN: *Norfolk* VICINITY OF: *U.S. 44 and CT 292* NOT FOR PUBLICATION

STATE: *CT* COUNTY: *Litchfield* CONGRESSIONAL DISTRICT: *6th Toby Moffett*

CODE: *5*

3 CLASSIFICATION

CATEGORY	OWNERSHIP	STATUS	PRESENT USE
<input checked="" type="checkbox"/> DISTRICT	<input type="checkbox"/> PUBLIC	<input checked="" type="checkbox"/> OCCUPIED	<input type="checkbox"/> AGRICULTURE <input checked="" type="checkbox"/> MUSEUM
<input type="checkbox"/> BUILDING(S)	<input type="checkbox"/> PRIVATE	<input type="checkbox"/> UNOCCUPIED	<input checked="" type="checkbox"/> COMMERCIAL <input checked="" type="checkbox"/> PARK
<input type="checkbox"/> STRUCTURE	<input checked="" type="checkbox"/> BOTH	<input type="checkbox"/> WORK IN PROGRESS	<input type="checkbox"/> EDUCATIONAL <input checked="" type="checkbox"/> PRIVATE RESIDENCE
<input type="checkbox"/> SITE	PUBLIC ACQUISITION	ACCESSIBLE	<input type="checkbox"/> ENTERTAINMENT <input checked="" type="checkbox"/> RELIGIOUS
<input type="checkbox"/> OBJECT	<input type="checkbox"/> IN PROCESS	<input type="checkbox"/> YES: RESTRICTED	<input checked="" type="checkbox"/> GOVERNMENT <input type="checkbox"/> SCIENTIFIC
	<input type="checkbox"/> BEING CONSIDERED	<input type="checkbox"/> YES: UNRESTRICTED	<input type="checkbox"/> INDUSTRIAL <input type="checkbox"/> TRANSPORTATION
		<input type="checkbox"/> NO	<input type="checkbox"/> MILITARY <input type="checkbox"/> OTHER

4 OWNER OF PROPERTY

NAME: *See continuation sheet*

STREET & NUMBER

CITY, TOWN

STATE

VICINITY OF

5 LOCATION OF LEGAL DESCRIPTION

COURTHOUSE, REGISTRY OF DEEDS, ETC. *Town Clerk's Office*

STREET & NUMBER: *Greenwoods Road*

CITY, TOWN

Norfolk

STATE

Connecticut

6 REPRESENTATION IN EXISTING SURVEYS

TITLE: *Norfolk Historic District - State Register of Historic Places*

DATE: *1962* FEDERAL STATE COUNTY LOCAL

DEPOSITORY FOR SURVEY RECORDS: *Norfolk Historic District Commission and Connecticut Historical Commission*

CITY, TOWN

Norfolk and Hartford

STATE

Connecticut

UNITED STATES DEPARTMENT OF THE INTERIOR
NATIONAL PARK SERVICE

**NATIONAL REGISTER OF HISTORIC PLACES
INVENTORY -- NOMINATION FORM**

FOR NPS USE ONLY	
RECEIVED	JAN 29 1979
DATE ENTERED	OCT 15 1979

Norfolk National Register District
Norfolk, Connecticut

CONTINUATION SHEET Property Owners ITEM NUMBER 4 PAGE 1

All properties in the district are considered to contribute to the historic character of the district.

All addresses are Norfolk, CT 06058 unless otherwise noted.

Map No.	Address of Property Name of Owner (Owner's address same as property address unless additional address is given.)	Identification
1.	Litchfield Road William S. & Elke F. McCarthy	1883. Cady. Stick Style house, asymmetrical with porches, gables, struts.
2.	Mountain Road Roderick J. & Linda S. Perkins	1884. Cady. Former Robbins School. Frame with high gable roof, a horizontal band of windows in the gable, and arcaded porch.
3.	Litchfield Road Elaine W. DeLarm	c. 1870. Former house of estate steward. Frame. 19 C vernacular farm house. Altered.
4, 6, 8, 9, 10, 39.	Stoeckel Estate, Village Green Trust u/w/o Ellen Battell Stoeckel, c/o Connecticut Bank & Trust Co., 1 Constitution Plaza, Hartford, CT 06115	Group of buildings formerly occupied by Battell, Eldridge, and Stoeckel families, with additions. Now used as facilities for Yale summer school of music and art.
5.	Battell Chapel, Village Green Church of Christ	1888. Cady. Granite Romanesque church building with Tiffany windows. Added ell to south.
7.	Village Green Church of Christ	1813. Hoadley church. Tetrastyle Ionic portico (nor original) supports tower, belfry stages, and spire.
11.	Litchfield Road Arthur R. & Lola J. Ernest	c. 1875. 2 1/2 story frame house with gable roof, shingled siding, and recessed entrance.

UNITED STATES DEPARTMENT OF THE INTERIOR
NATIONAL PARK SERVICE

FOR NPS USE ONLY

RECEIVED

DATE ENTERED

**NATIONAL REGISTER OF HISTORIC PLACES
INVENTORY -- NOMINATION FORM**

Norfolk National Register District
Norfolk, Connecticut

CONTINUATION SHEET Property Owners ITEM NUMBER 4 PAGE 2

12. Litchfield Road
✓ Margaret R. Hoover
c. 1940. 2 1/2 story frame house with gable roof parallel to road. There are dormers in the roof. Siding is clapboards.
13. Village Green
✓ Reginald W. & Marjorie M. Whidden
2 1/2 story frame structure with gable roof and cross gable. Clapboard siding. Possibly this structure originally was the carriage house for #14.
14. Village Green
✓ Donald H. & Elizabeth H. Ackley
Mansard roof house. Mansard added late 19 C to what may be a late 18 C five-bay structure.
15. Village Green
✓ John D., Jr., & Catherine Washburn
c. 1825. 1 1/2 story U-shaped, clapboard house. Wide fascia under eaves continues vertically at corners in pilaster effect.
- 16, 22, 38
Village Green
Town of Norfolk
Town Hall, Maple Avenue
Village green. Triangular park with Civil War monument, Battell Fountain, and decorative directional sign.
17. Village Green
✓ Town of Norfolk
Town Hall, Maple Avenue
1840. Norfolk Academy. Greek Revival pediment supported by panelled pilasters. Subsequently Town Hall and now premises of Norfolk Historical Society.
18. Village Green
✓ George V. & Phyllis B. Phelan
c. 1820. 1 1/2 story cottage with gable roof and clapboard siding on high stone and brick basement.
19. ✓ Village Green
George V. & Phyllis B. Phelan
1776 per sign on house. 1 1/2 story house with central chimney, gable roof, and clapboard siding. Entrance is from side porch on south.
20. ✓ Village Green
Church of Christ
1970. Parsonage. Frame house of simple design. Replaces Italianate parsonage that was demolished.

UNITED STATES DEPARTMENT OF THE INTERIOR
NATIONAL PARK SERVICE

FOR NPS USE ONLY

RECEIVED

DATE ENTERED

**NATIONAL REGISTER OF HISTORIC PLACES
INVENTORY -- NOMINATION FORM**

Norfolk National Register District
Norfolk, Connecticut

CONTINUATION SHEET Property Owners ITEM NUMBER 4 PAGE 3

- | | |
|---|---|
| 21. ✓ Greenwood's Road East
✓ Dr. Richard Barstow
Litchfield Road | c. 1814. Doctor's office. 19 C vernacular frame structure. Little embellishment. |
| 23. ✓ Greenwood's Road East
✓ Thomas G. Sanders et ux. | c. 1806. A long, rectangular 2 1/2 story house with bay window. Entrance porch has square, panelled columns. The roof of a long shed to the rear is covered with sod. |
| 24. Maple Avenue
✓ Catheryn H. Alford | c. 1860. A two-story shingled house. The porches on the front and two sides have sawn and turned decorative wood components. |
| 25. ✓ Greenwood's Road East
✓ Norfolk Library, Inc. | 1888 and 1911. Keller. Stone and tile hung walls, broad gable roof, horizontal bands of windows, Richardsonian interior. |
| 26. Greenwood's Road East
✓ Alexander M. Vagliano | 18 C. Former Pettibone Tavern. Five bay, center chimney colonial. Aluminum clapboards. |
| 27. Station Place
✓ Joseph T. Pallone & Pasquale D'Amato | 1960. Drug store. Plate glass store window front. One story. |
| 28. Station Place
Bernard & Marcia Polinsky | 1910. Taylor. Hardware store. Early cinder block. Peaked tile roof with shaped gable ends. Terra cotta decorative tiles around doors and windows. Now stucco clad. |
| 29. Station Place
Joseph T. Pallone | 1904. Taylor. Royal Arcanum Building. Romanesque Revival/Chateausque four story commercial building. Terra cotta decorative elements. |
| 30. Greenwood's Road West
Town of Norfolk
Town Hall, Maple Avenue | 1857. Small, one and a half story granite Greek Revival Savings Bank building. Now Town Office Building. |

UNITED STATES DEPARTMENT OF THE INTERIOR
NATIONAL PARK SERVICE

**NATIONAL REGISTER OF HISTORIC PLACES
INVENTORY -- NOMINATION FORM**

FOR NPS USE ONLY

RECEIVED

DATE ENTERED

Norfolk National Register District
Norfolk, Connecticut

CONTINUATION SHEET Property Owners ITEM NUMBER 4 PAGE 4

31. ✓ Greenwood Road West
Ronald & Susan Clifford
48 Britton Avenue
Torrington, CT 06790
1883. Village Hall. Imaginative Queen Anne Shingle style structure. Once housed stores, offices, and Opera House. Opera House is still in original condition.
32. ✓ Greenwood Road West
Edward R., Jr., & Margery H. Gebelein
Stoney Brook Farm
Harwinton, CT
c. 1900. Thurston Building. 2 1/2 story frame building. Sunburst brackets support hood over sidewalk. Former restaurant and plumbing shop.
33. ✓ Greenwood Road West
Edward R., Jr., & Margery H. Gebelein
Stoney Brook Farm
Harwinton, CT
1919. Wangum Hotel. Four story brick 40 x 70' commercial building.
34. ✓ Station Place
John C. & Dorothy R. Bazzano,
Lawrence & Sally C. Hannafin
1898. Hill and Turner. Railroad station. Rectangular granite block with projecting central section.
35. ✓ John J. Curtiss Road
Maloney Realty Co.
Carlton, Yarmouth County
Nova Scotia BOW ILO, Canada
1960. U. S. Post Office. Georgian Revival. One story brick and stone facing with white trim. Gable roof.
36. ✓ John J. Curtiss Road
National Iron Bank
1967. Modern bank. High, elongated portico of four square columns under flush boarding pediment with half-round window. Low wings to left and right with pedimented gables.
37. ✓ Maple Avenue
Town of Norfolk
1892. Marshall. Town Hall. Former Eldridge Gymnasium. One story, broad roofed, buff brick building suggestive of Prairie style.

7 DESCRIPTION

CONDITION		CHECK ONE	CHECK ONE
<input checked="" type="checkbox"/> EXCELLENT	<input type="checkbox"/> DETERIORATED	<input type="checkbox"/> UNALTERED	<input checked="" type="checkbox"/> ORIGINAL SITE
<input checked="" type="checkbox"/> GOOD	<input type="checkbox"/> RUINS	<input checked="" type="checkbox"/> ALTERED	<input type="checkbox"/> MOVED DATE _____
<input checked="" type="checkbox"/> FAIR	<input type="checkbox"/> UNEXPOSED		

DESCRIBE THE PRESENT AND ORIGINAL (IF KNOWN) PHYSICAL APPEARANCE

Norfolk, located in the scenic hills of northwestern Connecticut, was incorporated in 1758. It is not an old town by Connecticut standards, but because 20th century development and construction have passed it by, Norfolk today displays the architectural charm and country town ambience that were created during the 19th century years when the descendants of Joseph Battell helped establish the community's present character.

The traffic center and the visual center of the village is the green, which is a narrow, triangular park running 500 feet in the north-south direction. Just north of the green is the business and shopping center. The district is comprised of the green, with its abutting properties, and the business district. There are 37 sites and structures. All are considered to add to the historic character of the district.

Highways from north, south, and east converge at the green which is pleasantly planted with trees and shrubs. It is the site of three monuments. In the center is a tall stone obelisk commemorating local citizens who fought in the Civil War. At the northern edge of the green is a flag pole and bronze tablet mounted on stone in which are incised the names of those who offered their lives in World War II. At the southern tip of the triangle is a fountain, designed by Stanford White in 1889, honoring the second Joseph Battell. The fountain is executed in pink stone in the conventional arrangement of round column topped by a sphere with trough for animals on one side and fountain for humans on the other. Three fish are positioned over the sphere, from whose mouths issue streams of water that fall into the trough. A further stream issues into the trough from the mouth of a lion mounted on the column, while water for the humans' fountain comes from the mouth of a fish on the other side of the column. Two more animal heads on the side of the trough spurt water into shallow basins at grade for small animals. The mechanism for the seven streams of water is in good working order. The nearby marble bench was part of the original composition, and the two tall handsome free-standing bronze lamps were added at a later date to match the two on the column.

A sign made of wood giving direction and mileage to nearby towns is located at the north-west corner of the green. Round posts support two rectangular panels at a 90-degree angle to one another on which are shown not only the factual information needed by travellers, but also the likenesses of a hare and a stag. The present sign, painted in 1965 by Raymond Dowden, then director of the Yale summer school of art at Norfolk, duplicates the faded original that is now on display at the Historical Society. Artist for the original is unknown.

The structures surrounding the green are institutions and private homes. Every New England village green traditionally has a white church with a tall spire. Norfolk has a handsome specimen on the west side, built in 1813 to the design of David Hoadley. Set back from the street on an elevated site, and with its spire rising higher than any other building, the Church of Christ is altogether a commanding presence in Norfolk. Its square tower with a vertical oval window on three faces and a clock on the front is supported half by the roof of the body of the meeting house and half by a central projecting pavilion. The spire rises from the tower in two octagonal stages and is surmounted by a tall cone with cross finial. There are three balustrades, at the top of the tower and at the top of each of the two octagonal stages. Each face of the stages has a rectangular window. On the front facade the gable roof of the pavilion, forming a pediment, projects out over a porch of white marble, and is supported by four two-

UNITED STATES DEPARTMENT OF THE INTERIOR
NATIONAL PARK SERVICE

**NATIONAL REGISTER OF HISTORIC PLACES
INVENTORY -- NOMINATION FORM**

FOR NPS USE ONLY	
RECEIVED	JAN 29 1979
DATE ENTERED	OCT 15 1979

Norfolk National Register District
Norfolk, Connecticut

CONTINUATION SHEET Description ITEM NUMBER 7 PAGE 1

story Ionic columns. The traditional composition is completed by six windows, with twenty-over-twenty sash and shutters, at the first and second story levels along the sides of the body of the meeting house, under a dentilled eaves cornice.

Across the green from the church is a smaller, 30 by 41-foot white clapboarded building of similar plan and proportions, constructed in 1840 for the Norfolk Academy. It served as the Town Hall for a period of years starting in 1846 when the Ecclesiastical Society no longer would permit use of the church for town meetings. The Norfolk Historical Society now occupies these premises. The dominating feature of the building is its pediment, supported by panelled pilasters. The pediment has wide flush boarding running parallel to each of its three sides. A short, square tower rises above the pediment. The top of the tower carries a battlemented parapet in miniature.

Two more institutional buildings face the west and north sides of the green, both constructed in 1888. The Battell Chapel, a heavy granite Christian education building for the Church of Christ, was designed by J. Cleveland Cady in the Romanesque style. On the right, a massive, square, two-story tower with pyramidal roof surmounts a round arched entrance that is under two small, square medieval apertures and, at a higher level, paired round arched windows. At the left is a square porch for an additional entry. In the center, under gable roof with projecting eaves is a half-round one-story section with apsidal roof, separated from the porch by a small, round, two-story turret. The five windows in the central, round wall have stained glass, added later, signed Lewis C. Tiffany. They depict, mostly in shades of blue and green, the seasons at Norfolk, with hills, streams, trees, and snow-covered landscape. A later, one-story brick ell has been added to the left.

The second 1888 institution is the library, the work of George Keller in a style that is difficult to categorize, but that owes much to the influence of Philip Webb and Norman Shaw. The first floor is built of rough-finished Longmeadow red freestone. Above it are scalloped red tile, and then a large expanse of roof, originally red tile and now shingles. The front facade at each of its three levels has a horizontal band of windows, an early use of this motif. At the right is a round tower with conical roof, a Queen Anne feature characteristic of Keller's work. At the left, the entrance porch arch is barely pointed, and above it is a shield in foil surrounded by foliate carving, a Gothic element. The interior of the library is similar to contemporary work by H. H. Richardson. The bookshelves of ash are arrayed in alcoved two tiers high, divided horizontally by balconies with low balustrades under a barrel vault ceiling. A large reading room addition was constructed on the back of the library in 1911 to Keller's design.

The land facing the west side of the green, except for that in the center occupied by the two Church of Christ edifices, is the former Stoeckel estate, now serving as summer quarters

UNITED STATES DEPARTMENT OF THE INTERIOR
NATIONAL PARK SERVICE

**NATIONAL REGISTER OF HISTORIC PLACES
INVENTORY -- NOMINATION FORM**

FOR NPS USE ONLY	
RECEIVED	JAN 29 1979
DATE ENTERED	OCT 15 1979

Norfolk National Register District
Norfolk, Connecticut

CONTINUATION SHEET Description ITEM NUMBER 7 PAGE 2

for the Yale school of music and art. The estate, roughly square in shape, is 78 acres in size and is by far the largest single component of the 90-acre district. At the north and south ends of the green are two houses lived in for many years by Joseph Battell and his descendants. The Joseph Eldridge house at the south, now called the Battell House, has undergone many alterations. It was built early in the 19th century as a modest farm house, and enlarged from time to time. At about the turn of the century Classical Revival details were added, such as a Palladian window in the front facade over the doorway, and a front porch with round columns. Early in the 20th century a wing was removed and replaced with a community meeting room, and the third story of the house was removed. The building is now used for administration of the Yale summer school. The 1799 Joseph Battell house at the north, always referred to as the Whitehouse, has also been enlarged and altered from time to time. It now provides space for a collection of paintings and for music practice rooms. It presents an impressive appearance visible for a distance at the end of the street as one approaches the green from the east. Its three-story front facade, formerly Italianate, now has a two-story, semi-circular portico of two Ionic columns and two Ionic pilasters supporting a high roof with balustrade. The entrance has four fluted Ionic colonettes in front of pilasters on either side of the door and its leaded sidelights. There is a balcony supported by consoles over the doorway. It has a graceful balustrade composed of spirally turned balusters and spirally turned newell posts that have urn finials. The house has an opulent interior, after the manner of Robert Adam (1728-1792), the English architect who popularized delicate and attenuated moldings, festoons, ceiling decorations, doorway surrounds and other classically inspired trim.

Much of the estate is enclosed by a stepped, six-foot-high, masonry fence built of brick on a stone base and capped by marble. It dominates the streetscape on the west side of the road north of the green. The music shed on the estate, not visible from the road, was built in 1904, Erick C. Rossiter, architect. A brown shingled building with white trim, it has a columned, pedimented portico size 10 by 19 feet, with a leaded semi-circular window in the pediment. Behind the porch is a 12 by 36-foot foyer, and then the principal part of the building, 60 by 162 feet, with seating for 1,200 in the redwood-finished interior. Other estate buildings are used by the school and new housing has been built on the grounds for the school.

Several other buildings face the green on the north and east sides. The house at the northwest corner was the Pettibone Tavern, 1794, a stop on the Hartford-Albany stage coach line. Enlarged from time to time, it presents a five-bay facade to the green that is covered with aluminum clapboard siding and aluminum trim. The central doorway surround, however, is the original wood, and there is a central chimney, and third-floor overhang at front and ends. At the southeast corner of the green, the influence of the Second Empire is apparent in the mansard roof added c. 1887 to an older house known as Crissey Place. It is now painted white except for the shingles of the mansard that remain a weathered grey. There are pedimented dormers in the mansard, the central one a double window, and there is a cupola on the roof.

UNITED STATES DEPARTMENT OF THE INTERIOR
NATIONAL PARK SERVICE

**NATIONAL REGISTER OF HISTORIC PLACES
INVENTORY -- NOMINATION FORM**

FOR NPS USE ONLY	
RECEIVED	JAN 29 1979
DATE ENTERED	OCT 15 1979

Norfolk National Register District
Norfolk, Connecticut

CONTINUATION SHEET Description ITEM NUMBER 7 PAGE 3

All the buildings around the green, with the exception of the two masonry 1888 institutions, are painted white, irrespective of age or style, in accordance with the practice often followed by small New England towns. A fine exception to this rule is present on the west side of the road three houses below the southern edge of the Stoeckel estate. Here, tucked behind the trees, is an impressive 1884 Stick Style house painted all over a deep red. It is asymmetrical in plan, with an array of porches and gables. The dominating feature is a heavy third-floor gable over the front entrance at the left corner of the house. The gable is corbelled out from the front wall and an arcade in wood is corbelled out from the gable, connecting the broad eaves.

The location of the present Norfolk business center was determined in 1871 with the arrival of the Western Connecticut Railroad. The tracks ran in a cut just east of the library and the station was established at a site behind (north of) the library. A street known as Station Place was cut through from the main road north of the Pettibone Tavern to the station. Center-village activities still line this short street. The largest and most elaborate structure in this group is the four-story Royal Arcanum Building at the northeast corner of Station Place and the main road. Alfredo S.G. Taylor drew the plans for this building, which was completed in 1905. At completion it housed the Post Office, drug store, Fire Department, Probate Court, telephone company, Royal Arcanum hall, and other offices. Construction material included stone foundations, brick walls, interior brick bearing walls, and terra cotta decorative trim in colors blue, white, light green, dark green, and buff. The style of architecture of the building can perhaps be characterized as Romanesque Revival with overtones of the Chateausque. The facade facing Station Place has blind round arches at first and second stories that contain the entrance and windows. The broad roof starts above the second story and has banks of dormers at third and fourth story levels, jerkinhead at the third floor and steeply gabled at the fourth. There is a row of brick latticework below the second floor eaves, with the interstices of the lattice filled with green terra cotta panels. Terra cotta in colors is used for the lettering ROYAL ARCANUM over the front door and for the letters NVFD to right and left of the fire department entrance. A one-story porch at the corner of the main road, out over the sidewalk, has an arcade of five large, round arches with oversize brick keystones. Third floor gables at the corner have broad bands of diaper brickwork parallel to their eaves, and heavy pyramidal stone finials at the gable peaks.

Diagonally across Station Place from the Arcanum Building is a 1902 Spanish Colonial Revival stucco hardware store. It has heavy shaped central gable and gable ends and a red tile roof over round-headed windows. Terra cotta mosaic borders the brick doorway and the central window, and is used in panels above the foundations. Visible over the roof of the store is the cupola of a Victorian barn with a three-dimensional rooster weathervane. Further along on this side of Station Place is the former 1898 railroad station, a quarry finish granite ashlar building. It has a porte-cochere under hip roof in front of a projecting section of its oblong mass. The interior was rehabilitated for residential use in 1973.

Continuing north on the main road, the neighbor of the Arcanum Building is the small,

UNITED STATES DEPARTMENT OF THE INTERIOR
NATIONAL PARK SERVICE

**NATIONAL REGISTER OF HISTORIC PLACES
INVENTORY -- NOMINATION FORM**

FOR NPS USE ONLY	
RECEIVED	JAN 29 1979
DATE ENTERED	OCT 15 1979

Norfolk National Register District
Norfolk, Connecticut

CONTINUATION SHEET Description ITEM NUMBER 7 PAGE 4

one-story, grey granite, Greek Revival Norfolk Savings Bank building, built in 1857. It has buff granite surrounds for its segmental arched windows. The pilasters, entablature, and pediment of the entrance are wood. Next to the bank is the 1888 Opera House or Village Hall, a fanciful expression of the Queen Anne style. Its facade, covered with shingles in several shapes, has two gables with a long shed dormer between them on a high roof. The front wall flares out over the sidewalk. Above the flare, in the center, is a decorative group of seven windows surmounted by a large festoon. On the right, over windows arranged in the shape of a cross, is the image, in wood, of a new moon, with a man. On the left in a corresponding position is a sunburst. On the interior the hall remains in original condition, occupying the second and third floors. The painted and panelled proscenium arch, painted house curtain, shaped balcony balustrade and balcony, narrow, beaded wall and ceiling boards, roof struts, colored glass, and gas fixtures are all still in place. The hall is not used.

This confection is followed by a two-story frame plumbing shop, now vacant, again with shaped shingles, in a composition that is Queen Anne with Greek Revival accents. Its first floor pent roof is supported by quarter-round brackets that have an incised radial pattern. Beyond it is a three-story brick commercial building, formerly the Wangum Hotel, built in 1913.

Northeast of the railroad station is a unique example in Norfolk of the influence of Frank Lloyd Wright - the Eldridge Gymnasium of 1892, now the Town Hall. Henry Rutgers Marshall drew the plans for this broad, shingle roofed, horizontally oriented exception to the colonial and revival styles found elsewhere in Norfolk. It is built of long, thin, pressed buff bricks that measure 1 3/8 by 4 by 12 inches. Its porte-cochere at the left is balanced by the entrance porch at the right, both having broad roofs that are extensions of the main roof. The main roof, originally covered with orange tiles, is high hip in configuration, with truncated dormers; yet the overall emphasis of the building is horizontal. The front wall, between the porte-cochere and the porch has a long rectangle of light and dark brown bricks in the pattern of a Greek fret. Because of the sloping site, the building which is one-story on the front is two-story in the back. The long rear expanse is broken by two bows in the wall. The upper floor was designed as an open verandah with a view of the Canaan Valley and the Taconic range. It is now closed in. Below the porch three massive bands of rough, dark brown sandstone at the top, middle, and bottom of the first-floor windows by contrasting in color and texture with the lighter, smooth brick introduce an H. H. Richardson accent to the design.

In 1962 Norfolk established one of the first local historic districts in Connecticut. Its boundaries surround the green, including the buildings but not the full depth of the properties facing the green, and several houses south of the green. The present district encompasses all the structures in the local district and all of the land of these properties, plus the commercial district north of the green, and the Eldridge Gymnasium. The local district memorialized

UNITED STATES DEPARTMENT OF THE INTERIOR
NATIONAL PARK SERVICE

NATIONAL REGISTER OF HISTORIC PLACES INVENTORY -- NOMINATION FORM

FOR NPS USE ONLY	
RECEIVED	JAN 29 1979
DATE ENTERED	OCT 15 1979

Norfolk National Register District
Norfolk, Connecticut

CONTINUATION SHEET Description ITEM NUMBER 7 PAGE 5

the white, primarily colonial-appearing structures around the green. The present district adds a group of primarily vernacular late 19th century commercial buildings, and the Eldridge Gymnasium. Together, they constitute the center of the town of Norfolk.

8 SIGNIFICANCE

PERIOD		AREAS OF SIGNIFICANCE -- CHECK AND JUSTIFY BELOW			
<input type="checkbox"/> PREHISTORIC	<input type="checkbox"/> ARCHEOLOGY-PREHISTORIC	<input type="checkbox"/> COMMUNITY PLANNING	<input type="checkbox"/> LANDSCAPE ARCHITECTURE	<input type="checkbox"/> RELIGION	
<input type="checkbox"/> 1400-1499	<input type="checkbox"/> ARCHEOLOGY-HISTORIC	<input type="checkbox"/> CONSERVATION	<input type="checkbox"/> LAW	<input type="checkbox"/> SCIENCE	
<input type="checkbox"/> 1500-1599	<input type="checkbox"/> AGRICULTURE	<input type="checkbox"/> ECONOMICS	<input type="checkbox"/> LITERATURE	<input type="checkbox"/> SCULPTURE	
<input type="checkbox"/> 1600-1699	<input checked="" type="checkbox"/> ARCHITECTURE	<input checked="" type="checkbox"/> EDUCATION	<input type="checkbox"/> MILITARY	<input checked="" type="checkbox"/> SOCIAL/HUMANITARIAN	
<input checked="" type="checkbox"/> 1700-1799	<input type="checkbox"/> ART	<input type="checkbox"/> ENGINEERING	<input checked="" type="checkbox"/> MUSIC	<input type="checkbox"/> THEATER	
<input checked="" type="checkbox"/> 1800-1899	<input type="checkbox"/> COMMERCE	<input type="checkbox"/> EXPLORATION/SETTLEMENT	<input type="checkbox"/> PHILOSOPHY	<input type="checkbox"/> TRANSPORTATION	
<input checked="" type="checkbox"/> 1900-	<input type="checkbox"/> COMMUNICATIONS	<input type="checkbox"/> INDUSTRY	<input checked="" type="checkbox"/> POLITICS/GOVERNMENT	<input type="checkbox"/> OTHER (SPECIFY)	
		<input type="checkbox"/> INVENTION			

SPECIFIC DATES

BUILDER/ARCHITECT

STATEMENT OF SIGNIFICANCE

The amount of good architecture in Norfolk, Connecticut is quite surprising for a sleepy, country town. In addition to late colonial buildings of interest for their antiquity, the work of seven 19th and early 20th century architects of national standing is present in the district, a representation hard to match elsewhere in the state in towns of similar size. Moreover, the spacing and arrangement of the buildings around the village green and in the adjacent business district provide a charm and ambience of great merit.

The history of the town and its architecture is so intimately entwined with people related to Joseph Battell, that it is valuable to have in mind the basics of the Battell-Eldridge-Stoeckel family tree. The Reverend Ammi Ruhama Robbins (1740-1813) arrived in Norfolk in 1761 and served as minister for 52 years until 1813, the year the present church edifice was raised. Twenty years after his arrival, Joseph Battell (1774-1841) took up residence in Norfolk. He became a highly successful merchant and land speculator. Joseph Battell married the daughter of Rev. Robbins and became the father of nine children, including Robbins (1819-1895), Sarah (1809-1878), and Uraniah (1814-1887). His sons followed in his footsteps, owning extensive acreage in Vermont, the Western Reserve, and elsewhere. Robbins was the donor of the chapel. Sarah married Joseph Eldridge (1804-1874), who for 42 years was pastor of the church. Their three daughters, the Eldridge sisters, each made an architectural gift for the benefit of the town, Mary (1842-1926) the fountain, Isabella (1848-1919) the library, and Alice (1850-1926) the gymnasium. Robbins Battell's daughter, Ellen (1851-1939), in 1895 married Carl Stoeckel (1858-1925). It is their estate that includes the ancestral Battell and Eldridge homes and the Music Shed, now the summer home of the Yale school of music and art.

The first of the architects drawn to Norfolk to design buildings associated with the Battell-Eldridge-Stoeckel family was David Hoadley (1774-1838), a life-long resident of Waterbury. Though self-taught, he was one of the two or three fully-qualified architects in Connecticut early in the 19th century. The meeting house he designed for Norfolk is one of his best. Hoadley's other, similar work includes the United Church on the Green in New Haven, and Congregational churches at Killingworth, Avon, Milford, and Waterbury, all in Connecticut. His Norfolk church has been changed on the outside by late 19th century alterations to the front facade that included the introduction of round-headed windows, a pedimented hood supported by carved brackets over the central door, and heavy flat molded caps over the flanking doors. In 1926 these Italianate elements were removed in favor of the present imposing Ionic porch, the gift of Alice Eldridge Bridgman. Changes on the inside in 1846, 1880, and 1949 included a new pulpit and memorial window in the wall behind the pulpit. Nevertheless, the present basic size, plan, proportions, and Baroque steeple clearly are Hoadley's.

9 MAJOR BIBLIOGRAPHICAL REFERENCES

See continuation sheet.

10 GEOGRAPHICAL DATA

ACREAGE OF NOMINATED PROPERTY 90 prox.
UTM REFERENCES See continuation sheet.

Quadrangle Name: Norfolk
Quadrangle Scale: 1:24 000

A	ZONE	EASTING	NORTHING
C	ZONE	EASTING	NORTHING

B	ZONE	EASTING	NORTHING
D	ZONE	EASTING	NORTHING

VERBAL BOUNDARY DESCRIPTION

See continuation sheet.

LIST ALL STATES AND COUNTIES FOR PROPERTIES OVERLAPPING STATE OR COUNTY BOUNDARIES

STATE	CODE	COUNTY	CCDE
STATE	CODE	COUNTY	CODE

11 FORM PREPARED BY

NAME / TITLE

David F. Ransom, Consultant

ORGANIZATION

Connecticut Historical Commission

DATE

July 22, 1978

STREET & NUMBER

56 Prospect Street

TELEPHONE

(203) 566-3005

CITY OR TOWN

Hartford

STATE

Connecticut 06106

12 STATE HISTORIC PRESERVATION OFFICER CERTIFICATION

THE EVALUATED SIGNIFICANCE OF THIS PROPERTY WITHIN THE STATE IS:

NATIONAL

STATE

LOCAL

As the designated State Historic Preservation Officer for the National Historic Preservation Act of 1966 (Public Law 89-665), I hereby nominate this property for inclusion in the National Register and certify that it has been evaluated according to the criteria and procedures set forth by the National Park Service.

STATE HISTORIC PRESERVATION OFFICER SIGNATURE

TITLE Director, Connecticut Historical Commission

DATE January 23, 1979

FOR NPS USE ONLY

I HEREBY CERTIFY THAT THIS PROPERTY IS INCLUDED IN THE NATIONAL REGISTER

DATE 10-15-79

DIRECTOR, OFFICE OF ARCHEOLOGY AND HISTORIC PRESERVATION

ATTEST:

DATE 10/11/79

KEEPER OF THE NATIONAL REGISTER

UNITED STATES DEPARTMENT OF THE INTERIOR
NATIONAL PARK SERVICE

**NATIONAL REGISTER OF HISTORIC PLACES
INVENTORY -- NOMINATION FORM**

FOR NPS USE ONLY	
RECEIVED	JAN 29 1979
DATE ENTERED	OCT 15 1979

Norfolk National Register District
Norfolk, Connecticut

CONTINUATION SHEET Significance ITEM NUMBER 8 PAGE 1

J. Cleveland Cady (1837-1919) of New York, architect of the Battell Chapel, was well known in Connecticut. A graduate of Trinity College, Hartford, he worked as a draftsman for Town and Davis before opening his own office in 1870. He designed several buildings for Yale and Trinity, was invited to participate in the second 1872 competition for the Connecticut State Capitol but declined, was judge of the 1882 abortive competition for Hartford's Civil War arch, and in 1872 designed the Watkinson Library wing of the Wadsworth Atheneum in Hartford (demolished 1968). His Battell Chapel remains essentially in its original condition, with the welcome addition of the Tiffany windows. The chapel was a benefaction of several members of the Battell family in memory of Joseph and Sarah Battell. The Tiffany windows were presented by Ellen Battell Stoeckel. A contemporary wing has been added for offices.

The Battell Memorial Fountain, designed by Stanford White (1853-1906), is a standard fountain of the times. George Keller did quite similar designs at the Ansonia, Connecticut, Library in 1891 and in honor of Col. Albert A. Pope in Pope Park, Hartford, in 1913. There is no question, however, that White designed the Battell fountain. The Norfolk Historical Society has researched the matter and has in its possession an invitation to the unveiling September 27, 1889, and contemporary clippings from a local newspaper and from the New York Herald, all of which state that White designed the fountain.

Isabella Eldridge engaged George Keller (1842-1935) of Hartford to design her library for the town. In this case, as in the others, the exact circumstances that brought the client together with the architect are not known. It can only be said that members of the Battell-Eldridge-Stoeckel family obviously were cosmopolitan and well-connected. Keller's libraries, here, at Ansonia, and at Granville, Massachusetts, were the crowning achievement of his career, though they did not bring him the national recognition that his Garfield Memorial (1885-1890), Cleveland, Ohio, did. The Keller library and Cady chapel were under construction simultaneously and used some of the same artisans and resources, although only Keller used Hartford's sculptor, Albert W. Entress (1846-1926). James T. Levi of Norfolk was the contractor for carpentry for both buildings, Snow and Wooster of Norfolk for the stone work, Maitland, Armstrong and Company of New York the stained glass windows, and the Baynes Mosaic and Tracery Company of New York the memorial tablets in both.

Henry Rutgers Marshall (1852-1927), architect of Alice Eldridge Bridgman's Gymnasium, was an author, and lectured at Yale, which may have been the point of contact with the Norfolk family. He conducted a substantial practice that included the library at Rutgers University, Brunswick, New Jersey, and the home of Rudyard Kipling at Brattleboro, Vermont.

Erick K. Rossiter (1854-1941), who designed the Music Shed for the Stoeckels, was born in Paris and had his office in New York. He was responsible for a number of buildings in New England, including Hepburn Hall at the University of Vermont and St. John's Church in Washington, Connecticut.

UNITED STATES DEPARTMENT OF THE INTERIOR
NATIONAL PARK SERVICE

**NATIONAL REGISTER OF HISTORIC PLACES
INVENTORY -- NOMINATION FORM**

FOR NPS USE ONLY	
RECEIVED	JAN 29 1979
DATE ENTERED	OCT 15 1979

Norfolk National Register District
Norfolk, Connecticut

CONTINUATION SHEET Significance ITEM NUMBER 8 PAGE 2

All six of the architects discussed thus far were associated with Norfolk through the Battell-Eldridge-Stoeckel family. A seventh man was local. He was Alfredo S. G. Taylor (1872-1947). Taylor was born in Florence, Italy, and it is possible to see a Mediterranean influence in his frequent use of stucco, red tile roofs, shaped gables, and decorative terra cotta colors. After graduating from Harvard in 1894, Columbia School of Architecture in 1897, and the Ecole des Beaux Arts in 1902, he opened an office in New York City and practiced architecture there with James Levi for several decades. His summer residence was in Norfolk and he designed some fifteen structures in the greater Norfolk area in addition to the Royal Arcanum Building and perhaps the hardware store. The other works included the Church of the Immaculate Conception, his own and other homes, the garage behind the Joseph Eldridge (Battell) House, the Country Club, the Dennis Pavilion, and the World War I monument. His early penchant for bold profiles, stucco, and red tile succumbed later on, to a degree, to the influence of the Colonial Revival.

The Royal Arcanum Building, built for the Norfolk Realty Company and named for its chief tenant at the time of construction, a fraternal order, over the years has lost its original tenants, except the Masons, who shared the fraternal quarters from the beginning. Several decades ago the building also lost the tower originally positioned at its north end. The tower had a heavy balustrade at fourth floor level above which, corbelled out, each face had a gable and finial similar to those at the southwest corner of the building. In addition to housing the fire bell, the tower also provided for drying the hose.

The hardware store was built in 1910 for the Norfolk Water Company, which had its office in the building. Most of the space has always been occupied by a hardware store. The walls were covered with stucco in 1967 as a matter of maintenance and because other Taylor buildings have stucco. Prior to that time the original cement blocks, poured at the site at the time of construction, were exposed, without finish. The rear wall of the building continues in this condition.

The impressive 19th and early 20th century work of these seven architects is important to Norfolk today. Two other important aspects of Norfolk's history have left little impression in the present village. One of these was the late 18th/early 19th century industrial development. Water power was available from the falls in the Blackberry River just northwest of the district and several manufacturing establishments, including a silk mill, were located nearby. Little or nothing remains of these structures. In common with similar industry in other Connecticut hill towns, these enterprises succumbed in the 19th century to the combined influences of steam power and rail transportation that were available in the valleys. The industrial buildings themselves were eventually torn down as being unsightly, at the expense of a private benefactor (not a member of the Battell-Eldridge-Stoeckel family).

In 1871 the railroad (Western Connecticut, later Central New England) did come to town, bringing the second important influence that has now largely disappeared. The railroad

UNITED STATES DEPARTMENT OF THE INTERIOR
NATIONAL PARK SERVICE

**NATIONAL REGISTER OF HISTORIC PLACES
INVENTORY -- NOMINATION FORM**

FOR NPS USE ONLY	
RECEIVED	JAN 29 1979
DATE ENTERED	OCT 15 1979

Norfolk National Register District
Norfolk, Connecticut

CONTINUATION SHEET Significance ITEM NUMBER 8 PAGE 3

right-of-way was first laid out through the green, which the town was willing to sacrifice in order to have the railroad. The Rev. Joseph Eldridge mounted a strong one-man campaign against this plan and eventually carried the day, to the later satisfaction of his fellow townspeople. The Norfolk station was declared to be at the highest elevation, 1,250 feet above sea level, of any in Connecticut; therefore, the air was healthful; therefore, the town became a summer resort. Several summer hotels were built, now destroyed. A number of summer homes were also constructed, and these survive, now as year-round residences, and, while none of them is in the district, their presence is to be noted as a factor in the present condition of the wider town that supports the district.

The Battell-Eldridge-Stoeckel family had a long association with Yale. Robbins Battell was an 1839 Yale graduate. He was a musician and a benefactor of Yale, a combination of pursuits that brought him into contact with Gustav J. Stoeckel, the university's first professor of music. Gustav's son, Carl, became secretary to Robbins Battell and married his daughter, Ellen. Mr. and Mrs. Carl Stoeckel continued active in the world of music, built the Music Shed, and left the estate in trust for use as summer quarters for Yale studies in music and art, now in their 38th season.

The Academy building has had a checkered career. It was built as a private secondary school and did double duty in mid-19th century by providing a place to hold town meetings. Then the Academy was bought out by Robbins and Anna Battell, who built a new building across the street just south of the green called the Robbins School, in honor of their forebearer. The Stick Style house next door was built at this time as the residence for the school's headmaster. This institution operated from 1884 to 1912. Both the school building and the headmaster's house were designed by J. Cleveland Cady. They are now private residences. Meanwhile, the old Academy became part of a summer boarding house complex and by mid-20th century had fallen into disuse. It was then rescued by private philanthropy, title lodged in the town, and the premises given over to the Norfolk Historical Society, newly formed for the purpose, and now presenting an appearance that couldn't look more venerable.

The Norfolk district memorializes, first, the 18th century layout of the town that established the position of the green and the church; second, the unique 19th century influence of the Battell-Eldridge-Stoeckel family in bringing good architects to Norfolk; and, third, the late 19th century business district that is particularly notable for the work of Alfredo S. G. Taylor.

UNITED STATES DEPARTMENT OF THE INTERIOR
NATIONAL PARK SERVICE

**NATIONAL REGISTER OF HISTORIC PLACES
INVENTORY -- NOMINATION FORM**

FOR NPS USE ONLY	
RECEIVED	JAN 29 1979
DATE ENTERED	OCT 15 1979

Norfolk National Register District
Norfolk, Connecticut

CONTINUATION SHEET Bibliography ITEM NUMBER 9 PAGE 1

Joan Candler, "Alfredo S. G. Taylor," (typescript, available at Connecticut Historical Commission).

"The Chapel, Norfolk, Connecticut," program of dedication ceremonies of the Battell Chapel, December 13, 1888 (available at the Church of Christ).

Theron Wilmot Crissey, 1744-1900 History of Norfolk, Everett, Mass.: Massachusetts Publishing Co., 1900.

Our Town, Norfolk, Connecticut, Norfolk: Norfolk Historical Society, 1975.

James H. Potter, Church of Christ (Congregational), Norfolk, Connecticut (available at the church).

David F. Ransom, George Keller, Architect, Hartford: The Stowe-Day Foundation, 1978.

Sydney Thompson, The History of the Ellen Battell Stoeckel Trust, n. d. (available at the office of the Trust, Norfolk, CT).

Alice V. Waldecker, Norfolk, Connecticut, 1900-1975, Norfolk: Norfolk Bicentennial Commission, 1976.

UNITED STATES DEPARTMENT OF THE INTERIOR
NATIONAL PARK SERVICE

**NATIONAL REGISTER OF HISTORIC PLACES
INVENTORY -- NOMINATION FORM**

FOR NPS USE ONLY	
RECEIVED	JAN 9 1979
DATE ENTERED	OCT 15 1979

Norfolk National Register District
Norfolk, Connecticut

CONTINUATION SHEET Geographical Data ITEM NUMBER 10 PAGE 1

UTM REFERENCES:

A 18/649300/4650080
B 18/649280/4650050
C 18/649220/4650090
D 18/649200/4650070
E 18/649220/4650030
F 18/649220/4650000
G 18/649260/4649950
H 18/649220/4649900
I 18/649230/4649790
J 18/649100/4649560
K 18/648960/4649550
L 18/648970/4649690
M 18/648430/4649760
N 18/648580/4650160
O 18/648920/4650400
P 18/649020/4650160
Q 18/649080/4650180
R 18/649130/4650020
S 18/649190/4650170

UNITED STATES DEPARTMENT OF THE INTERIOR
HERITAGE CONSERVATION AND RECREATION SERVICE

FOR HCRS USE ONLY
RECEIVED AUG 5 1979
DATE ENTERED

NATIONAL REGISTER OF HISTORIC PLACES INVENTORY -- NOMINATION FORM

Norfolk Historic District
Norfolk, Connecticut

CONTINUATION SHEET Geograph. Data ITEM NUMBER 10 PAGE 1

UTM References

A 18/649320/4650100
B 18/649280/4650060
C 18/649220/4650090
D 18/649180/4650000
E 18/649280/4650980 -4649
F 18/649240/4649920
G 18/649250/4649810
H 18/648090/4649580
95D I 18/648050/4649590
J 18/648960/4649720
K 18/648460/4649770
L 18/648610/4650180
M 18/648950/4650400
N 18/649040/4650160
O 18/649100/4650190
P 18/649140/4650070
Q 18/649200/4650180

UNITED STATES DEPARTMENT OF THE INTERIOR
NATIONAL PARK SERVICE

FOR NPS USE ONLY	
RECEIVED	JAN 9 1979
DATE ENTERED	OCT 15 1979

**NATIONAL REGISTER OF HISTORIC PLACES
INVENTORY -- NOMINATION FORM**

Nprfolk District
Norfolk, CT

CONTINUATION SHEET Geograph. Data ITEM NUMBER 10 PAGE 2

Verbal boundary description:

Beginning on Maple Avenue at the northeast corner of the Town Hall property, the boundary runs south along Maple Avenue to the southeast corner of the Town Hall property, west along the south line of the Town Hall property to the former right of way of the Central New England Railway, south along the right of way to the northwest corner of the Alford property, east along the north line of the Alford property to Maple Avenue, across Maple Avenue to the northwest corner of the Sanders property, west along the north border of the Sanders property to the northeast corner of the Sanders property, south along the east line of the Sanders property to Greenwoods Road East, west along Greenwoods Road East to the former right of way of the Central New England Railway, south along the right of way to the southeast corner of the Ernest property, west along the south line of the Ernest property to Litchfield Road, south along Litchfield Road to the southeast corner of the McCarthy property, west along the south line of the McCarthy property to the southwest corner of the McCarthy property, north along the west line of the McCarthy property and the west line of the Perkins property to Mountain Road, west, north, and east along the borders of the Stoeckel Estate to Greenwoods Road West, south along Greenwoods Road West to the northwest corner of the Wangum Hotel property, east along the north border of the north border of the Wangum Hotel property to the northeast corner of the Wangum Hotel property, south along the east lines of the properties of the Wangum Hotel, Thurston Building, Opera House, Town Office Building, and Royal Arcanum Building to Station Place, northeast along Station Place and John J. Curtiss Road to the northwest corner of the National Iron Bank property, and east along the north border of the National Iron Bank property and Town Hall property to the point of beginning.

UNITED STATES DEPARTMENT OF THE INTERIOR
NATIONAL PARK SERVICE

**NATIONAL REGISTER OF HISTORIC PLACES
INVENTORY -- NOMINATION FORM**

FOR NPS USE ONLY	
RECEIVED	JAN 29 1979
DATE ENTERED	OCT 15 1979

Norfolk National Register District
Norfolk, Connecticut

CONTINUATION SHEET Map

ITEM NUMBER

PAGE 1

Norfolk has no tax maps. There are no maps showing property boundaries. The assessor's cards do not give dimensions of the plots.

The sketch map used with this nomination was traced from an aerial photograph.

As noted in the verbal boundary description, the district's boundaries follow property lines. The indication of the boundary line of the district on the sketch map is approximate.

Key to Map Numbers of Buildings Mentioned in Text

1. *Battell School headmaster's house
2. *Battell School
3. *Stoeckel estate caretaker's house
4. *Joseph Eldridge House, now Battell House
5. Battell Chapel
6. Yale summer school housing
7. Church of Christ Congregational
8. *Joseph Battell House, Whitehouse
9. *Stoeckel Stables
10. Music Shed
14. *Crissey Place
16. Battell Fountain
17. *Norfolk Academy, now Norfolk Historical Society
22. Civil War Monument
25. Norfolk Library
26. *Pettibone Tavern
28. Hardware store
29. Royal Arcanum Building
30. *Norfolk Savings Bank
31. *Opera House, Village Hall
32. Plumbing Shop
33. *Wangum Hotel
34. *Railroad Station
37. *Gymnasium, now Town Hall
38. Sign giving directions
39. Stoeckel estate outbuildings

* denotes historic name

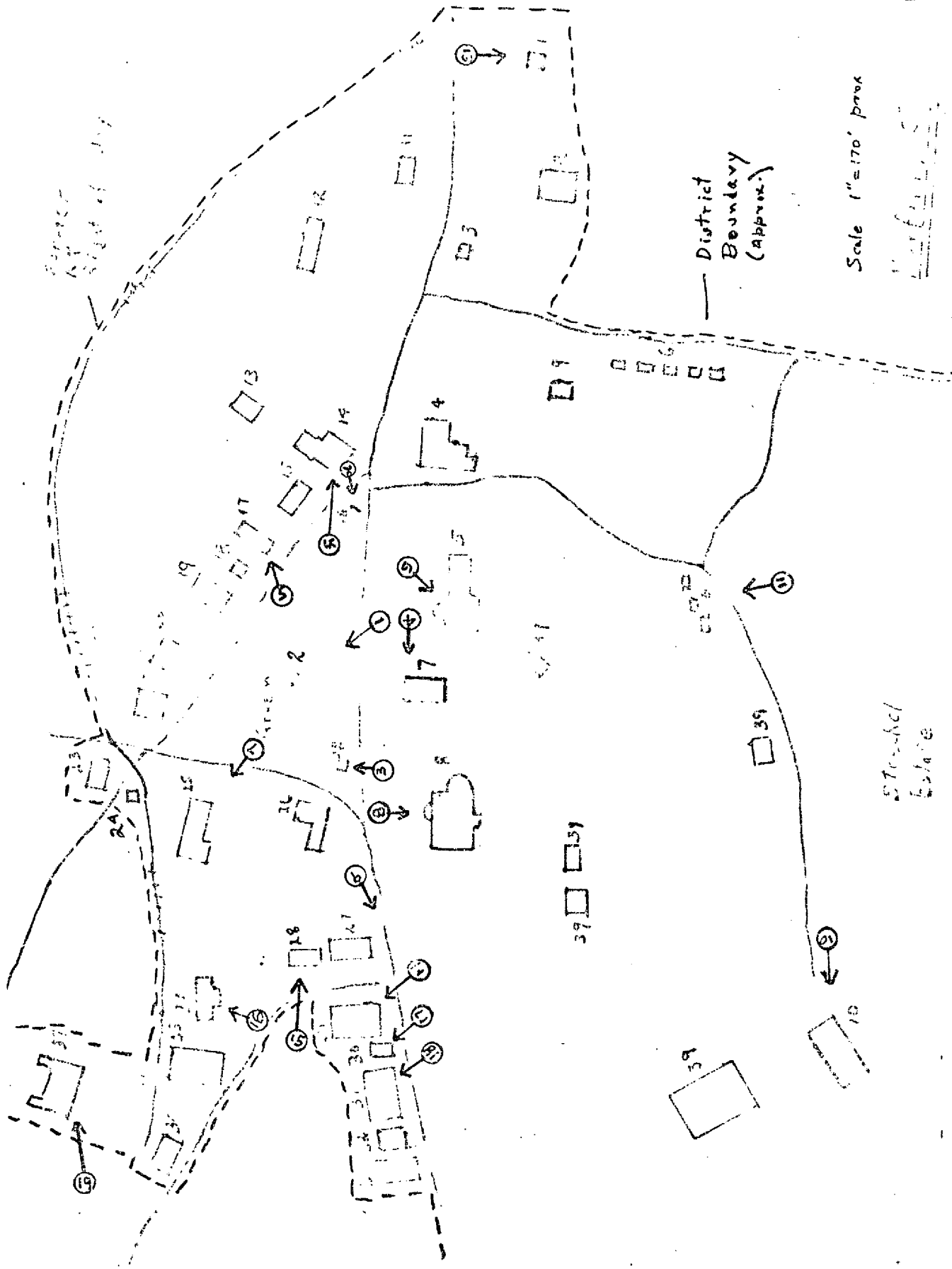

District Boundary (Approx.)

Scale 1"=170' prox

Street/ Lot #

Norfolk, CT AUG 6 1974
Scale: 1" = 450'
District boundary

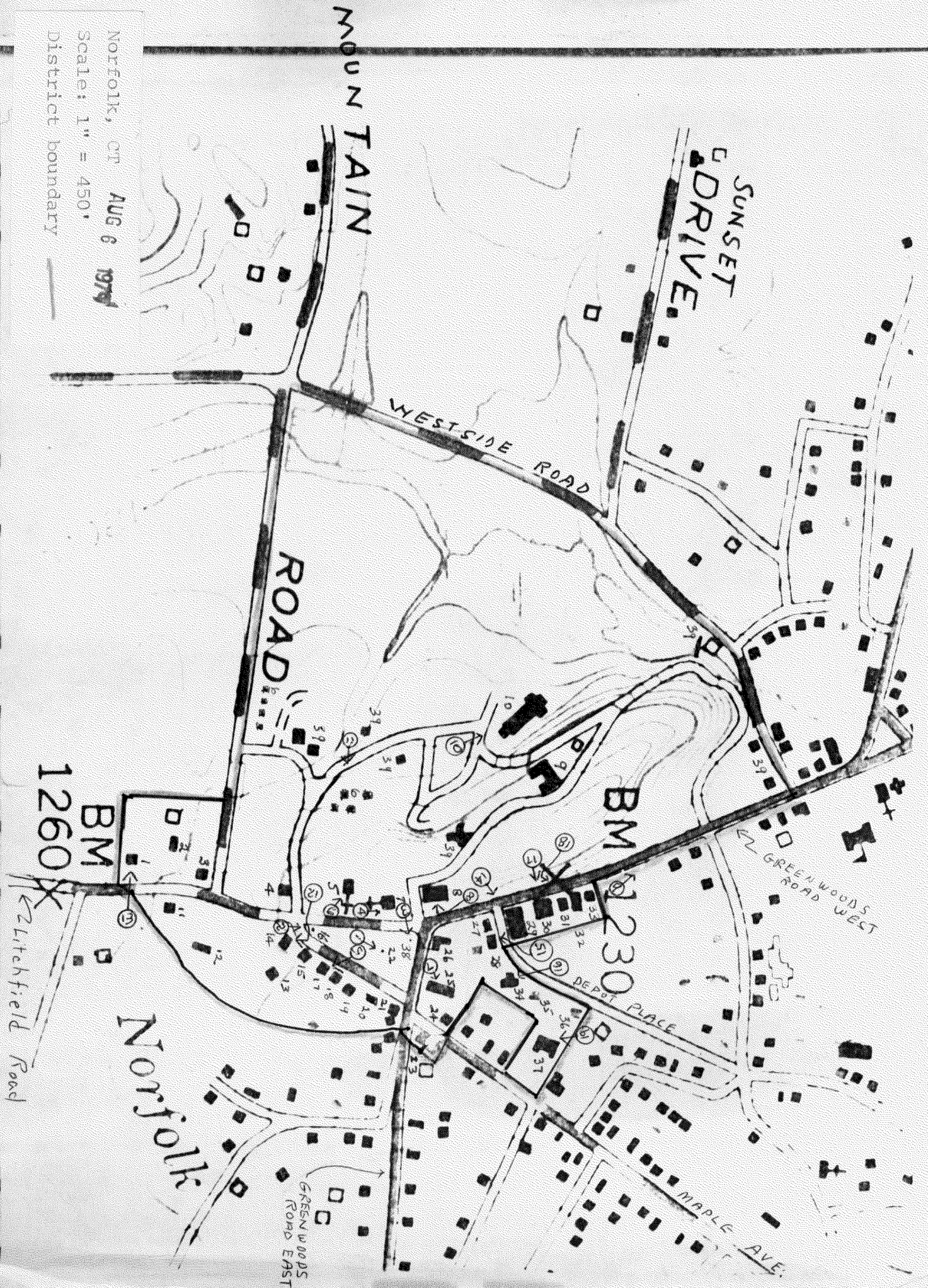

These properties are included in the Norfolk Historic District. Additional information on these properties was provided in the "Taylor, Alfred S.G., Thematic Resource". We have included the information from the Thematic Resource in this file.

Royal Arcanum Building

Shepard Building

Tamarac Lodge

Misses Eldridge Garage

Eldridge House

White House Stables

Eldridge Barn

**HISTORIC RESOURCES INVENTORY
BUILDING AND STRUCTURES**

HIST-6 NEW 5, 77

STATE OF CONNECTICUT
CONNECTICUT HISTORICAL COMMISSION
59 SOUTH PROSPECT STREET, HARTFORD, CONNECTICUT 06106
(203) 566-3005

FOR OFFICE USE ONLY	
Town No.:	Site No.:
UTM	
QUAD:	
DISTRICT <input type="checkbox"/> S <input type="checkbox"/> NR	IF NR, SPECIFY <input type="checkbox"/> Actual <input type="checkbox"/> Potential

#4

IDENTIFICATION	1. BUILDING NAME (Common) (Historic) Arcanum Building Royal Arcanum Building	
	2. TOWN/CITY Norfolk	VILLAGE COUNTY Litchfield
	3. STREET AND NUMBER (and/or location) Station Place, northeast corner of Greenwoods Road	
	4. OWNER(S) Joseph T. Pallone, Laurel Way, Norfolk, CT 06058 <input type="checkbox"/> Public <input checked="" type="checkbox"/> Private	
	5. USE (Present) (Historic) Commercial and residential Commercial	
DESCRIPTION	6. ACCESSIBILITY TO PUBLIC: <input checked="" type="checkbox"/> Yes <input type="checkbox"/> No	
	EXTERIOR VISIBLE FROM PUBLIC ROAD <input checked="" type="checkbox"/> Yes <input type="checkbox"/> No	
	INTERIOR ACCESSIBLE <input type="checkbox"/> Yes <input checked="" type="checkbox"/> No	
	IF YES, EXPLAIN	
	7. STYLE OF BUILDING	
	DATE OF CONSTRUCTION 1904	
	8. MATERIAL(S) (Indicate use or location when appropriate)	
	<input type="checkbox"/> Clapboard <input type="checkbox"/> Asbestos Siding <input checked="" type="checkbox"/> Brick <input type="checkbox"/> Other (Specify) _____ <input type="checkbox"/> Wood Shingle <input type="checkbox"/> Asphalt Siding <input checked="" type="checkbox"/> Fieldstone foundations <input type="checkbox"/> Board & Batten <input type="checkbox"/> Stucco <input type="checkbox"/> Cobblestone <input type="checkbox"/> Aluminum Siding <input type="checkbox"/> Concrete Type: _____ <input type="checkbox"/> Cut stone Type: _____	
	9. STRUCTURAL SYSTEM	
	<input type="checkbox"/> Wood frame <input type="checkbox"/> Post and beam <input type="checkbox"/> balloon <input checked="" type="checkbox"/> Load bearing masonry <input type="checkbox"/> Structural iron or steel <input type="checkbox"/> Other (Specify) _____	
10. ROOF (Type)		
<input type="checkbox"/> Gable <input type="checkbox"/> Flat <input type="checkbox"/> Mansard <input type="checkbox"/> Monitor <input type="checkbox"/> sawtooth <input type="checkbox"/> Gambrel <input type="checkbox"/> Shed <input checked="" type="checkbox"/> Hip <input type="checkbox"/> Round <input type="checkbox"/> Other (Specify) _____ (Material) <input type="checkbox"/> Wood Shingle <input type="checkbox"/> Roll Asphalt <input type="checkbox"/> Tin <input checked="" type="checkbox"/> Slate <input type="checkbox"/> Asphalt shingle <input type="checkbox"/> Built up <input type="checkbox"/> Tile <input type="checkbox"/> Other (Specify) _____		
11. NUMBER OF STORIES APPROXIMATE DIMENSIONS 4 48 x 124'		
12. CONDITION (Structural) (Exterior) <input type="checkbox"/> Excellent <input checked="" type="checkbox"/> Good <input type="checkbox"/> Fair <input type="checkbox"/> Deteriorated <input type="checkbox"/> Excellent <input checked="" type="checkbox"/> Good <input type="checkbox"/> Fair <input type="checkbox"/> Deteriorated		
13. INTEGRITY (Location) WHEN ? (Alterations) IF YES, EXPLAIN <input checked="" type="checkbox"/> On original site <input type="checkbox"/> Moved <input checked="" type="checkbox"/> Yes <input type="checkbox"/> No East tower removed years ago.		
14. RELATED OUTBUILDINGS OR LANDSCAPE FEATURES <input type="checkbox"/> Barn <input type="checkbox"/> Shed <input type="checkbox"/> Garage <input type="checkbox"/> Other landscape features or buildings (Specify) _____ <input type="checkbox"/> Carriage house <input type="checkbox"/> Shop <input type="checkbox"/> Garden		
15. SURROUNDING ENVIRONMENT <input type="checkbox"/> Open land <input type="checkbox"/> Wood-land <input type="checkbox"/> Residential <input type="checkbox"/> Scattered buildings visible from site <input checked="" type="checkbox"/> Commercial <input type="checkbox"/> Indus-trial <input type="checkbox"/> Rural <input type="checkbox"/> High building density		
16. INTERRELATIONSHIP OF BUILDING AND SURROUNDINGS The Arcanum Building is the largest structure in the business center. It is on the the corner of the street leading to the depot and the through road.		

(OVER)

DESCRIPTION (Continued)

This four-story business block is constructed of stone foundations, brick exterior walls, brick load bearing interior walls, slate roof, and terra cotta decorations. The brick is laid in Flemish bond of red stringers and black/green headers. The south facade has blind round arches at first and second stories, containing round headed windows with small panes. A one-story porch at the corner of the main road, out over the sidewalk, has an arcade of five large, round arches with oversized brick keystones. There is a band of brick lattice work below the second floor eaves whose interstices are filled with green terra cotta panels. Terra cotta in colors blue, white, green, and buff is used for the lettering, ROYAL ARCANUM, over the front door and for the letters NVFD to right and left of the entrance used by the Fire Department. The broad, steeply-pitched roof rises about the second story and

(continued)

18 ARCHITECT

A.S.G. Taylor

BUILDER

19 HISTORICAL OR ARCHITECTURAL IMPORTANCE

SIGNIFICANCE

The substantial mass of this building, asymmetrical roof line (especially when the tower was in place), and terra cotta decorative elements, including the roof cresting, all suggest the Queen Anne style, while the broad expanse of high roof with banks of dormers brings the Chateausque to mind, and the big round arches in masonry are a Romanesque influence. In concept and execution it was an ambitious project for a small northwestern Connecticut town in 1904.

The exposed, shaped rafters supporting the roof overhang and the round headed windows with radial glazing were to appear in Taylor's houses.

SOURCES

Print of drawing for end elevation is in the Taylor Collection.

PHOTO

PHOTOGRAPHER

D. Ransom

DATE

July 1978

VIEW

Northeast

NEGATIVE ON FILE

Conn. Historical Commission

Place

COMPILED BY

NAME

D. Ransom

DATE

Oct. 29, 1978

Photograph

ORGANIZATION

Connecticut Historical Commission

Here

ADDRESS

59 South Prospect Street, Hartford, CT 06106

101 plk 14

20 SUBSEQUENT FIELD EVALUATIONS

Verbal boundary description: NLR 48/378, less than 1 acre. The building is in the Norfolk National Register District.
UTM Reference: 18/649100/4648070

21 THREATS TO BUILDING OR SITE

- None known
 Highways
 Vandalism
 Developers
 Other _____
 Renewal
 Private
 Deterioration
 Zoning
 Explanation _____

STATE OF CONNECTICUT
CONNECTICUT HISTORICAL COMMISSION
59 South Prospect Street, Hartford, Connecticut 06106
HISTORIC RESOURCES INVENTORY FORM
For Buildings and Structures

FOR OFFICE USE ONLY			
TOWN NO.:	SITE NO.:		
UTM: 18	/	/	/
QUAD:			
DISTRICT:	S	NR:	ACTUAL POTENTIAL

CONTINUATION SHEET

Item number: 17 Date: Oct. 19, 1978

A.S.G. Taylor Thematic Group
Norfolk, CT

Royal Arcanum Building #4

has banks of dormers at third and fourth story levels, jerkinhead at the third floor, and peaked at the fourth. The dormers have finials at their peaks and low, solid iron cresting runs across the ridge line.

Initially, the building housed a drugstore, Post Office, a plumber's shop, and the Fire Department on the ground floor, with offices, and rooms for both the Masons and the Royal Arcanum Lodge above. The ground floor now has a restaurant and offices, while upstairs has become residential with the exception of the Lodge rooms still occupied by the Masons.

HISTORIC RESOURCES INVENTORY
BUILDING AND STRUCTURES

HIST-6 NEW 5,77

STATE OF CONNECTICUT
CONNECTICUT HISTORICAL COMMISSION
 59 SOUTH PROSPECT STREET, HARTFORD, CONNECTICUT 06106
 (203) 566-3005

FOR OFFICE USE ONLY	
Town No.:	Site No.:
UTM:	
QUAD:	
DISTRICT <input type="checkbox"/> S <input type="checkbox"/> NR	IF NR, SPECIFY <input type="checkbox"/> Actual <input type="checkbox"/> Potential

#5

IDENTIFICATION

1. BUILDING NAME (Common) <i>(Historic)</i> Hardware Store Shepard Building	
2. TOWN/CITY Norfolk	VILLAGE COUNTY Litchfield
3. STREET AND NUMBER (and/or location) Station Place, south side	
4. OWNER(S) Bernard & Marcia Polinsky, Station Place, Norfolk, CT 06058 <input type="checkbox"/> Public <input checked="" type="checkbox"/> Private	
5. USE (Present) <i>(Historic)</i> Hardware store Hardware store and office	
6. ACCESSIBILITY TO PUBLIC: <input checked="" type="checkbox"/> Yes <input type="checkbox"/> No	EXTERIOR VISIBLE FROM PUBLIC ROAD <input type="checkbox"/> Yes <input type="checkbox"/> No
INTERIOR ACCESSIBLE <input checked="" type="checkbox"/> Yes <input type="checkbox"/> No	IF YES, EXPLAIN Is a store.

DESCRIPTION

7. STYLE OF BUILDING Spanish Colonial Revival		DATE OF CONSTRUCTION 1906
8. MATERIAL(S) (Indicate use or location when appropriate)		
<input type="checkbox"/> Clapboard	<input type="checkbox"/> Asbestos Siding	<input type="checkbox"/> Brick <input checked="" type="checkbox"/> Other (Specify) Cinder block
<input type="checkbox"/> Wood Shingle	<input type="checkbox"/> Asphalt Siding	<input type="checkbox"/> Fieldstone
<input type="checkbox"/> Board & Batten	<input checked="" type="checkbox"/> Stucco	<input type="checkbox"/> Cobblestone
<input type="checkbox"/> Aluminum Siding	<input type="checkbox"/> Concrete Type: _____	<input type="checkbox"/> Cut stone Type: _____
9. STRUCTURAL SYSTEM		
<input type="checkbox"/> Wood frame	<input type="checkbox"/> Post and beam	<input checked="" type="checkbox"/> balloon
<input type="checkbox"/> Load bearing masonry	<input type="checkbox"/> Structural iron or steel	
<input type="checkbox"/> Other (Specify) _____		
10. ROOF (Type)		
<input type="checkbox"/> Gable	<input type="checkbox"/> Flat	<input type="checkbox"/> Mansard <input type="checkbox"/> Monitor <input type="checkbox"/> sawtooth
<input type="checkbox"/> Gambrel	<input type="checkbox"/> Shed	<input checked="" type="checkbox"/> Hip <input type="checkbox"/> Round <input type="checkbox"/> Other (Specify) _____
(Material)		
<input type="checkbox"/> Wood Shingle	<input type="checkbox"/> Roll Asphalt	<input type="checkbox"/> Tin <input type="checkbox"/> Slate
<input type="checkbox"/> Asphalt shingle	<input type="checkbox"/> Built up	<input checked="" type="checkbox"/> Tile <input type="checkbox"/> Other (Specify) _____
11. NUMBER OF STORIES 1	APPROXIMATE DIMENSIONS 40 x 60	
12. CONDITION (Structural) <i>(Exterior)</i>		
<input type="checkbox"/> Excellent <input checked="" type="checkbox"/> Good <input type="checkbox"/> Fair <input type="checkbox"/> Deteriorated	<input type="checkbox"/> Excellent <input checked="" type="checkbox"/> Good <input type="checkbox"/> Fair <input type="checkbox"/> Deteriorated	
13. INTEGRITY (Location) WHEN? <i>(Alterations)</i> IF YES, EXPLAIN		
<input checked="" type="checkbox"/> On original site <input type="checkbox"/> Moved	<input type="checkbox"/> Yes <input type="checkbox"/> No	
14. RELATED OUTBUILDINGS OR LANDSCAPE FEATURES		
<input type="checkbox"/> Barn <input type="checkbox"/> Shed <input type="checkbox"/> Garage	<input checked="" type="checkbox"/> Other landscape features or buildings (Specify)	
<input type="checkbox"/> Carriage house <input type="checkbox"/> Shop <input type="checkbox"/> Garden	Size of the lot is approximately the size of the building.	
15. SURROUNDING ENVIRONMENT		
<input type="checkbox"/> Open land <input type="checkbox"/> Wood-land <input type="checkbox"/> Residential	<input type="checkbox"/> Scattered buildings visible from site	
<input checked="" type="checkbox"/> Commercial <input type="checkbox"/> Indus-trial <input type="checkbox"/> Rural	<input type="checkbox"/> High building density	
16. INTERRELATIONSHIP OF BUILDING AND SURROUNDINGS		
The hardware store is across Station Place from the Arcanum Building. It abuts the drugstore and the grounds of the library.		

(OVER)

DESCRIPTION (Continued)

The Hardware Store is an early cinder block building. The stucco was added in recent years. The back wall still has the exposed cinder block. The broad, red tile, hipped roof with gables in the front and side slopes is the building's striking feature. Equally interesting is the faience work around the window and doors and in a band above the foundations. These handmade tiles were reported at the time of construction to be the work of Adolph Grant of Philadelphia in designs based on old Spanish castles and monasteries.

18 ARCHITECT

A.S.G. Taylor

BUILDER

19. HISTORICAL OR ARCHITECTURAL IMPORTANCE

SIGNIFICANCE

With this building, Taylor was deeply involved with Norfolk. His client was Frederick M. Shepard, scion of an old family, who went out into the world to make his fortune. Shepard built this building in the backyard of the family home. A small portion was rented as an office to the Norfolk Water Co., another F. M. Shepard enterprise, and most of it to the Brown Co., dealers in hardware and lumber. A Spanish Colonial Revival building in remote northwestern Connecticut, in 1906, must have been cause for comment. Taylor's introduction of the style, as well as its execution in cinder block, are good examples of the new designs and new ideas that Taylor introduced to Norfolk.

SOURCES

Obituary, A.S.G. Taylor, Winsted, Connecticut Evening Citizen, Oct. 22, 1947, p. 6.
 Print of drawing of roof plan (Norfolk Water Co.) by Taylor is in the Taylor Collection, n.d.
 Postcard in Taylor Collection, dated 1908, is picture of this building.

PHOTO

PHOTOGRAPHER

D. Ransom

DATE

July 1978

VIEW

South

NEGATIVE ON FILE

Conn. Historical Commission

Place

COMPILED BY

NAME

D. Ransom

DATE

Oct. 29, 1978

Photograph

ORGANIZATION

Connecticut Historical Commission

Here

ADDRESS

59 South Prospect Street, Hartford, CT 06106

20 SUBSEQUENT FIELD EVALUATIONS

Verbal boundary description: NLR 48/591, less than 1 acre. The building is in the Norfolk National Register District.
 UTM Reference: 18/649110/4650040

21 THREATS TO BUILDING OR SITE

- None known Highways Vandalism Developers Other _____
- Renewal Private Deterioration Zoning Explanation _____

STATE OF CONNECTICUT

CONNECTICUT HISTORICAL COMMISSION

59 South Prospect Street, Hartford, Connecticut 06106
(203) 566-3005

HISTORIC RESOURCES INVENTORY FORM

For Buildings and Structures

FOR OFFICE USE ONLY			
TOWN NO.:		SITE NO.:	
UTM: 18/	/	/	/
QUAD:			
DISTRICT:	S	NR:	ACTUAL
			POTENTIAL

13

IDENTIFICATION

One of the Yale

1. BUILDING NAME: Common: Summer School buildings Historic: The Misses Eldridge Garage
2. TOWN/CITY: Norfolk VILLAGE: _____ COUNTY: Litchfield
3. STREET & NUMBER (and/or location): On Stoeckel Estate
4. OWNER(S): Trust u/w/o Ellen Buttell Stoeckel
c/o Connecticut Bank & Trust Co., Hartford, CT 06115 PUBLIC PRIVATE
5. USE: Present: Practice Room Historic: Garage
6. ACCESSIBILITY TO PUBLIC: Exterior visible from public road: yes no
Interior accessible: yes, explain _____ no

DESCRIPTION

7. STYLE OF BUILDING: _____ DATE OF CONSTRUCTION: 1915
8. MATERIAL(S) (indicate use or location when appropriate):
 ___ clapboard ___ asbestos siding ___ brick
 ___ wood shingle ___ asphalt siding fieldstone
 ___ board & batten ___ stucco ___ cobblestone
 ___ aluminum siding ___ concrete: type: _____ ___ cut stone: type: _____
 ___ other: _____
9. STRUCTURAL SYSTEM:
 ___ wood frame: ___ post and beam balloon
 load bearing masonry ___ structural iron or steel
 ___ other: _____
10. ROOF: type:
 ___ gable ___ flat ___ mansard ___ monitor ___ sawtooth
 ___ gambrel ___ shed hip ___ round ___ other _____
 material:
 wood shingle ___ roll asphalt ___ tin ___ slate
 ___ asphalt shingle ___ built up ___ tile ___ other: _____
11. NUMBER OF STORIES: 1 APPROXIMATE DIMENSIONS: 27 x 36'
12. CONDITION: Structural: ___ excellent good ___ fair ___ deteriorated
 Exterior: ___ excellent good ___ fair ___ deteriorated
13. INTEGRITY: Location: on original site ___ moved, when: _____
 Alterations: no yes, explain: _____
14. RELATED OUTBUILDINGS OR LANDSCAPE FEATURES:
 ___ barn ___ shed ___ garage ___ other landscape features or buildings: _____
 ___ carriage house ___ shop garden _____
15. SURROUNDING ENVIRONMENT:
 ___ open land ___ woodland residential scattered buildings visible from site
 ___ commercial ___ industrial ___ rural ___ high building density
16. INTERRELATIONSHIP OF BUILDING AND SURROUNDINGS:

This is one of a number of buildings on the Stoeckel Estate.

17. OTHER NOTABLE FEATURES OF BUILDING OR SITE (interior and/or exterior):

The garage combines rough fieldstone walls with classical trim under a hip roof. Gables rise above a broad fascia on the east and south sides. On the south, the gable is a pedimented roof, supported by two columns, for the entrance arch. The site of the garage is next to a stone arch bridge over a stream that runs through the estate. Another larger building of similar design is nearby.

The building is now used as a practice room for the Yale Summer School of Music and Art.

SIGNIFICANCE

Architect: Taylor & Levi, comm. 103A Builder: _____

18. HISTORICAL OR ARCHITECTURAL IMPORTANCE:

The garage is an example of Taylor combining rough fieldstone walls with Georgian Revival trim.

PHOTOGRAPH

photographer: D. Ransom
date: September 1978 view: Northwest
negative on file: Connecticut Historical Commission

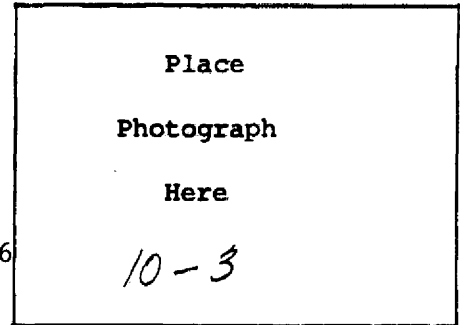

COMPILED BY:

name: D. Ransom date: Oct. 29, 1978
organization: Connecticut Historical Commission
address: 59 South Prospect Street, Hartford, CT 06106

19. SOURCES:

Print of construction drawing in Taylor Collection.

~~20. SUBSEQUENT FIELD EVALUATIONS~~

Verbal boundary description: The garage is located on the Stoeckel Estate and is in the Norfolk National Register District.

UTM Reference: 18/64880/4649810

21. THREATS TO BUILDING OR SITE:

none known highways vandalism developers other: _____
 renewal private deterioration zoning explanation: _____

HISTORIC RESOURCES INVENTORY
BUILDING AND STRUCTURES

HIST-6 NEW 5, 77

STATE OF CONNECTICUT
CONNECTICUT HISTORICAL COMMISSION
 59 SOUTH PROSPECT STREET, HARTFORD, CONNECTICUT 06106
 (203) 566-3005

35

FOR OFFICE USE ONLY	
Town No.:	Site No.:
UTM:	
QUAD:	
DISTRICT	IF NR. SPECIFY
<input type="checkbox"/> S <input type="checkbox"/> NR	<input type="checkbox"/> Actual <input type="checkbox"/> Potential

IDENTIFICATION

1. BUILDING NAME (Common)	(Historic)
Battell House	Eldridge House
2. TOWN/CITY	VILLAGE
Norfolk	Litchfield
3. STREET AND NUMBER (and/or location)	
On the Stoeckel Estate	
4. OWNER(S)	
Trust u/w/o Ellen Battell Stoeckel	
c/o Connecticut Bank & Trust Co., Hartford, CT 06115	<input type="checkbox"/> Public <input checked="" type="checkbox"/> Private
5. USE (Present)	(Historic)
School Administration	Residence
6. ACCESSIBILITY TO PUBLIC:	EXTERIOR VISIBLE FROM PUBLIC ROAD
<input type="checkbox"/> Yes <input type="checkbox"/> No	<input type="checkbox"/> Yes <input type="checkbox"/> No
	INTERIOR ACCESSIBLE
	<input type="checkbox"/> Yes <input type="checkbox"/> No
	IF YES, EXPLAIN

DESCRIPTION

7. STYLE OF BUILDING	DATE OF CONSTRUCTION
	Alterations: 1936, 1941
8. MATERIAL(S) (Indicate use or location when appropriate)	
<input checked="" type="checkbox"/> Clapboard	<input type="checkbox"/> Asbestos Siding
<input type="checkbox"/> Wood Shingle	<input type="checkbox"/> Brick
<input type="checkbox"/> Board & Batten	<input type="checkbox"/> Fieldstone
<input type="checkbox"/> Aluminum Siding	<input type="checkbox"/> Cobblestone
<input type="checkbox"/> Concrete Type:	<input type="checkbox"/> Cut stone Type:
9. STRUCTURAL SYSTEM	
<input type="checkbox"/> Wood frame	<input checked="" type="checkbox"/> Post and beam
<input type="checkbox"/> Load bearing masonry	<input checked="" type="checkbox"/> balloon
<input type="checkbox"/> Other (Specify)	<input type="checkbox"/> Structural iron or steel
10. ROOF (Type)	
<input checked="" type="checkbox"/> Gable	<input type="checkbox"/> Flat
<input type="checkbox"/> Gambrel	<input type="checkbox"/> Mansard
<input type="checkbox"/> Wood Shingle	<input type="checkbox"/> Monitor
<input type="checkbox"/> Asphalt shingle	<input type="checkbox"/> sawtooth
<input type="checkbox"/> Built up	<input type="checkbox"/> Round
<input type="checkbox"/> Tile	<input type="checkbox"/> Other (Specify)
<input checked="" type="checkbox"/> Slate	<input type="checkbox"/> Other (Specify)
11. NUMBER OF STORIES	APPROXIMATE DIMENSIONS
2	50 x 69'
12. CONDITION (Structural)	
<input type="checkbox"/> Excellent	<input checked="" type="checkbox"/> Good
<input type="checkbox"/> Fair	<input type="checkbox"/> Deteriorated
<input type="checkbox"/> Excellent	<input checked="" type="checkbox"/> Good
<input type="checkbox"/> Fair	<input type="checkbox"/> Deteriorated
13. INTEGRITY (Location)	
<input checked="" type="checkbox"/> On original site	<input type="checkbox"/> Moved
WHEN?	(Alterations)
	<input checked="" type="checkbox"/> Yes <input type="checkbox"/> No
	IF YES, EXPLAIN
	Altered by Taylor.
14. RELATED OUTBUILDINGS OR LANDSCAPE FEATURES	
<input type="checkbox"/> Barn	<input type="checkbox"/> Shed
<input checked="" type="checkbox"/> Garage	<input type="checkbox"/> Other landscape features or buildings (Specify)
<input type="checkbox"/> Carriage house	<input type="checkbox"/> Shop
<input type="checkbox"/> Garden	
15. SURROUNDING ENVIRONMENT	
<input type="checkbox"/> Open land	<input type="checkbox"/> Wood-land
<input checked="" type="checkbox"/> Residential	<input checked="" type="checkbox"/> Scattered buildings visible from site
<input type="checkbox"/> Commercial	<input type="checkbox"/> Indus-trial
<input type="checkbox"/> Rural	<input type="checkbox"/> High building density
16. INTERRELATIONSHIP OF BUILDING AND SURROUNDINGS	

The house is located on the Green, and is surrounded by spacious grounds.

(OVER)

DESCRIPTION (Continued)

This early 19th century house has been altered and enlarged from time to time, and it is difficult to tell who did what. Taylor was engaged in 1936 to convert the structure to a community center. In so doing, he removed the third floor and south wing, replacing the south wing with a meeting room that used some of the old paneling. Presumably the Palladian window in the front gable was part of this work. Subsequently, when the structure became an administration building for the Yale Summer School, he added a dining room at the northwest corner.

18 ARCHITECT
1936-Taylor & Levi, No commission number/
1941-A.S.G. Taylor

BUILDER

19 HISTORICAL OR ARCHITECTURAL IMPORTANCE

SIGNIFICANCE

Taylor's alterations met specified utilitarian needs of his clients. The results are now something of a hodgepodge. While individual elements, such as paneling, fireplace, doorway surrounds, and colored glass windows, are of quality, the building no longer has cohesion.

The importance in Norfolk of the house and its occupants is set forth in the nomination of the Norfolk National Register District.

The south elevation of the south wing has a typical Taylor broad gable.

Although the basic structure dates from the 19th century, Taylor's work in this instance is less than 50 years old. The building is included in the nomination because it is integral to the theme of the nomination, the work of A.S.G. Taylor. It is one of several structures on the Stoeckel estate that Taylor was engaged to modify, and is an example of yet another

community need for which Taylor provided a workable design.

SOURCES

Prints of drawings for Norfolk Community Building iron railings, dated February, 1936, are in the Taylor Collection.

Connecticut Western News, July 30, 1936.

COMPILED BY PHOTO

PHOTOGRAPHER D. Ransom	DATE October 1978
VIEW Northwest	NEGATIVE ON FILE Conn. Historical Commission
NAME D. Ransom	DATE Oct. 28, 1978
ORGANIZATION Connecticut Historical Commission	
ADDRESS 59 South Prospect Street, Hartford, CT 06106	

Place

Photograph

Here

20 SUBSEQUENT FIELD EVALUATIONS

Verbal boundary description: The building is on the Stoeckel Estate and is in the Norfolk National Register District.

UTM Reference: 18/649050/4649770.

21 THREATS TO BUILDING OR SITE

None known
 Highways
 Vandalism
 Developers
 Other _____
 Renewal
 Private
 Deterioration
 Zoning
 Explanation _____

HISTORIC RESOURCES INVENTORY
BUILDING AND STRUCTURES

HIST-6 NEW 5/77

STATE OF CONNECTICUT
CONNECTICUT HISTORICAL COMMISSION
 59 SOUTH PROSPECT STREET, HARTFORD, CONNECTICUT 06106
 (203) 566-3005

37

FOR OFFICE USE ONLY	
Town No.:	Site No.:
UTM	
QUAD:	
DISTRICT	IF NR. SPECIFY
<input type="checkbox"/> S <input type="checkbox"/> NR	<input type="checkbox"/> Actual <input type="checkbox"/> Potential

IDENTIFICATION

1. BUILDING NAME (Common) (Historic)		White House Stables	
2. TOWN/CITY	VILLAGE	COUNTY	
Norfolk		Litchfield	
3. STREET AND NUMBER (and/or location) On the Stoeckel Estate.			
4. OWNER(S) Trust u/w/o Ellen Battell Stoeckel c/o Connecticut Bank & Trust Co., Hartford, CT 06115 <input type="checkbox"/> Public <input checked="" type="checkbox"/> Private			
5. USE (Present)		(Historic)	
Summer School		Stables	
6. ACCESSIBILITY TO PUBLIC:	EXTERIOR VISIBLE FROM PUBLIC ROAD	INTERIOR ACCESSIBLE	IF YES, EXPLAIN
<input type="checkbox"/> Yes <input checked="" type="checkbox"/> No	<input type="checkbox"/> Yes <input checked="" type="checkbox"/> No	<input type="checkbox"/> Yes <input checked="" type="checkbox"/> No	Alterations:

DESCRIPTION

7. STYLE OF BUILDING		DATE OF CONSTRUCTION
		1940/1941
8. MATERIAL(S) (Indicate use or location when appropriate)		
<input type="checkbox"/> Clapboard	<input type="checkbox"/> Asbestos Siding	<input checked="" type="checkbox"/> Brick <input type="checkbox"/> Other (Specify) _____
<input type="checkbox"/> Wood Shingle	<input type="checkbox"/> Asphalt Siding	<input type="checkbox"/> Fieldstone
<input type="checkbox"/> Board & Batten	<input type="checkbox"/> Stucco	<input type="checkbox"/> Cobblestone
<input type="checkbox"/> Aluminum Siding	<input type="checkbox"/> Concrete Type: _____	<input type="checkbox"/> Cut stone Type: _____
9. STRUCTURAL SYSTEM		
<input type="checkbox"/> Wood frame	<input type="checkbox"/> Post and beam	<input checked="" type="checkbox"/> balloon
<input type="checkbox"/> Load bearing masonry	<input type="checkbox"/> Structural iron or steel	
<input type="checkbox"/> Other (Specify) _____		
10. ROOF (Type)		
<input checked="" type="checkbox"/> Gable	<input type="checkbox"/> Flat	<input type="checkbox"/> Mansard <input type="checkbox"/> Monitor <input type="checkbox"/> sawtooth
<input type="checkbox"/> Gambrel	<input type="checkbox"/> Shed	<input checked="" type="checkbox"/> Hip <input type="checkbox"/> Round <input type="checkbox"/> Other (Specify) _____
(Material)		
<input checked="" type="checkbox"/> Wood Shingle	<input type="checkbox"/> Roll Asphalt	<input type="checkbox"/> Tin <input type="checkbox"/> Slate
<input type="checkbox"/> Asphalt shingle	<input type="checkbox"/> Built up	<input type="checkbox"/> Tile <input type="checkbox"/> Other (Specify) _____
11. NUMBER OF STORIES	APPROXIMATE DIMENSIONS	
2½	Base of U, 30 x 14'; each arm, 34 x 50'.	
12. CONDITION (Structural) (Exterior)		
<input type="checkbox"/> Excellent	<input checked="" type="checkbox"/> Good	<input type="checkbox"/> Fair <input type="checkbox"/> Deteriorated
<input type="checkbox"/> Excellent	<input checked="" type="checkbox"/> Good	<input type="checkbox"/> Fair <input type="checkbox"/> Deteriorated
13. INTEGRITY (Location)		
<input checked="" type="checkbox"/> On original site	<input type="checkbox"/> Moved	WHEN? (Alterations) IF YES, EXPLAIN
<input checked="" type="checkbox"/> Yes	<input type="checkbox"/> No	Altered by Taylor for school use.
14. RELATED OUTBUILDINGS OR LANDSCAPE FEATURES		
<input type="checkbox"/> Barn	<input type="checkbox"/> Shed	<input type="checkbox"/> Garage <input checked="" type="checkbox"/> Other landscape features or buildings (Specify)
Several estate/school buildings are nearby, including a greenhouse and maintenance shed.		
<input type="checkbox"/> Carriage house	<input type="checkbox"/> Shop	<input type="checkbox"/> Garden
15. SURROUNDING ENVIRONMENT		
<input type="checkbox"/> Open land	<input type="checkbox"/> Wood-land	<input type="checkbox"/> Residential <input checked="" type="checkbox"/> Scattered buildings visible from site
<input type="checkbox"/> Commercial	<input type="checkbox"/> Indus-trial	<input type="checkbox"/> Rural <input type="checkbox"/> High building density
16. INTERRELATIONSHIP OF BUILDING AND SURROUNDINGS		
The stables building is one of several estate buildings in the vicinity.		

(OVER)

DESCRIPTION (Continued)

The building is U-shaped, with recessed entrances under semi-elliptical arches at the two interior angles. There is a high gable in the center of the base of the U, higher than the roof, in a stepped profile. Each of the arms of the U has a square cupola in the center of its roof. There are large windows with diamond-shaped panes at the ground floor and smaller windows with diamond panes under the eaves.

The stables now are used by the Yale Summer School of Music and Art for instruction, exhibits, studios, and a printing shop.

18 ARCHITECT
Taylor & Levi, No commission number.

BUILDER

19 HISTORICAL OR ARCHITECTURAL IMPORTANCE

SIGNIFICANCE

Study of several drawings that designate both old and new work indicates that the stables before Taylor's work had its present U shape, roof configuration, and high, stepped gable. Taylor changed partitions around, tripled the height of the windows, added new steel casements, altered the roof overhang, installed new plumbing, converted box stalls into practice rooms, installed diamond-paned glazing, and so on. One print is a clear exposition of the original floor plans, and in itself is a valuable record of the layout of the stables of an important estate at the turn of the 20th Century. One wing had 12 box stalls.

Although the basic structure dates from the 19th century, Taylor's work in this instance is less than 50 years old. It is included in the nomination because it is integral to the theme of the nomination, the work of A.S.G. Taylor. The pains to which Taylor went to record the condition of the stables prior to his alterations is of special interest, and is the only known instance of his recording historical details in such a

SOURCES

systematic manner.

Copy of facade drawing by Taylor is in possession of the Trust u/w/o Ellen Battell Stoeckel.

Prints of construction drawings are in the Taylor Collection.

PHOTO
COMPILED BY

PHOTOGRAPHER

D. Ransom

DATE

October 1978

VIEW

West

NEGATIVE ON FILE

Connecticut Historical Comm.

Place

NAME

D. Ransom

DATE

Oct. 28, 1978

Photograph

ORGANIZATION

Connecticut Historical Commission

Here

ADDRESS

59 South Prospect Street, Hartford, CT 06106

20 SUBSEQUENT FIELD EVALUATIONS

Verbal boundary description: The building is on the Stoeckel Estate and is in the Norfolk National Register District.

UTM Reference: 18/648920/4650100.

21 THREATS TO BUILDING OR SITE

- None known; Highways Vandalism Developers Other _____
 Renewal Private Deterioration Zoning Explanation _____

HISTORIC RESOURCES INVENTORY
BUILDING AND STRUCTURES

HIST-6 NEW 5/77

STATE OF CONNECTICUT
CONNECTICUT HISTORICAL COMMISSION
 59 SOUTH PROSPECT STREET, HARTFORD, CONNECTICUT 06106
 (203) 566-3005

38

FOR OFFICE USE ONLY	
Town No.:	Site No.:
UTM	
QUAD:	
DISTRICT	IF NR, SPECIFY
<input type="checkbox"/> S <input type="checkbox"/> NR	<input type="checkbox"/> Actual <input type="checkbox"/> Potential

IDENTIFICATION

1. BUILDING NAME (Common)	(Historic)	Eldridge Barn
2. TOWN/CITY	VILLAGE	COUNTY
Norfolk		Litchfield
3. STREET AND NUMBER (and/or location)		
On the Stoeckel Estate.		
4. OWNER(S)		
Trust u/w/o of Ellen Battell Stoeckel		
c/o Connecticut Bank & Trust Co., Hartford, CT 06115		<input type="checkbox"/> Public <input checked="" type="checkbox"/> Private
5. USE (Present)		
Unit in Yale Summer School		(Historic) Barn
6. ACCESSIBILITY TO PUBLIC:	EXTERIOR VISIBLE FROM PUBLIC ROAD	INTERIOR ACCESSIBLE
<input type="checkbox"/> Yes <input checked="" type="checkbox"/> No	<input type="checkbox"/> Yes <input checked="" type="checkbox"/> No	IF YES, EXPLAIN
		Alterations:

DESCRIPTION

7. STYLE OF BUILDING	DATE OF CONSTRUCTION
	1945
8. MATERIAL(S) (Indicate use or location when appropriate)	
<input type="checkbox"/> Clapboard	<input type="checkbox"/> Asbestos Siding
<input type="checkbox"/> Wood Shingle	<input type="checkbox"/> Asphalt Siding
<input type="checkbox"/> Board & Batten	<input type="checkbox"/> Stucco
<input type="checkbox"/> Aluminum Siding	<input type="checkbox"/> Concrete Type: _____
<input type="checkbox"/> Brick	<input type="checkbox"/> Other (Specify) _____
<input checked="" type="checkbox"/> Fieldstone	<input type="checkbox"/> Cobblestone
<input type="checkbox"/> Cut stone	Type: _____
9. STRUCTURAL SYSTEM	
<input type="checkbox"/> Wood frame	<input checked="" type="checkbox"/> Post and beam
<input checked="" type="checkbox"/> Load bearing masonry	<input type="checkbox"/> balloon
<input type="checkbox"/> Other (Specify) _____	<input type="checkbox"/> Structural iron or steel
10. ROOF (Type)	
<input checked="" type="checkbox"/> Gable	<input type="checkbox"/> Flat
<input type="checkbox"/> Gambrel	<input type="checkbox"/> Shed
<input type="checkbox"/> Wood Shingle	<input type="checkbox"/> Hip
<input checked="" type="checkbox"/> Asphalt shingle	<input type="checkbox"/> Round
<input type="checkbox"/> Built up	<input type="checkbox"/> sawtooth
<input type="checkbox"/> Tile	<input type="checkbox"/> Other (Specify) _____
<input type="checkbox"/> Other (Specify) _____	
11. NUMBER OF STORIES	APPROXIMATE DIMENSIONS
2	
12. CONDITION (Structural)	
<input type="checkbox"/> Excellent	<input checked="" type="checkbox"/> Good
<input type="checkbox"/> Fair	<input type="checkbox"/> Deteriorated
<input type="checkbox"/> Excellent	<input checked="" type="checkbox"/> Good
<input type="checkbox"/> Fair	<input type="checkbox"/> Deteriorated
13. INTEGRITY (Location)	
<input checked="" type="checkbox"/> On original site	<input type="checkbox"/> Moved
WHEN?	(Alterations)
	<input checked="" type="checkbox"/> Yes <input type="checkbox"/> No
IF YES, EXPLAIN	
Altered by Taylor	
14. RELATED OUTBUILDINGS OR LANDSCAPE FEATURES	
<input type="checkbox"/> Barn	<input type="checkbox"/> Shed
<input type="checkbox"/> Carriage house	<input type="checkbox"/> Shop
<input type="checkbox"/> Garage	<input checked="" type="checkbox"/> Other landscape features or buildings (Specify)
Is one of a number of buildings on the Estate.	
15. SURROUNDING ENVIRONMENT	
<input type="checkbox"/> Open land	<input type="checkbox"/> Wood-land
<input type="checkbox"/> Residential	<input checked="" type="checkbox"/> Scattered buildings visible from site
<input type="checkbox"/> Commercial	<input type="checkbox"/> Indus-trial
<input type="checkbox"/> Rural	<input type="checkbox"/> High building density
16. INTERRELATIONSHIP OF BUILDING AND SURROUNDINGS	
Is located next to the similar Eldridge garage, near a brook.	

(OVER)

DESCRIPTION (Continued)

The fieldstone and wood trim construction of the barn makes it look as though it was originally designed by Taylor, as was the garage. The possibility comes to mind that the barn may have been substantially altered by Taylor in 1915 when he did the garage, but the only evidence at hand is prints of the drawings of 1945 for alterations for the summer school. The purpose at that time was to create practice rooms. The building now also houses a photographic laboratory.

18 ARCHITECT A.S.G. Taylor	BUILDER
-------------------------------	---------

19 HISTORICAL OR ARCHITECTURAL IMPORTANCE

SIGNIFICANCE

The alterations here, whether in 1915 or 1945, or 1945 only, are an example of Taylor's meeting the changing needs of the community. The present appearance of fieldstone and white trim is unmistakably Taylor.

Although Taylor's alterations to this structure may be less than 50 years old, the structure is included in the nomination because it is integral to the theme of the nomination, the work of A.S.G. Taylor. It is one of several structures on the Stoeckel estate for which Taylor was engaged to design alterations.

SOURCES

Prints of construction drawings are in the Taylor Collection.

PHOTO
COMPILED BY

PHOTOGRAPHER D. Ransom	DATE October 1978	Place Photograph Here
VIEW West	NEGATIVE ON FILE Connecticut Historical Comm.	
NAME D. Ransom	DATE Nov. 4, 1978	
ORGANIZATION Connecticut Historical Commission		
ADDRESS 59 South Prospect Street, Hartford, CT 06106		

20 SUBSEQUENT FIELD EVALUATIONS

Verbal boundary description: The building is on the Stoeckel Estate and is in the Norfolk National Register District.

UTM Reference: 18/648870/4649790.

21 THREATS TO BUILDING OR SITE

- | | | | | |
|--|-----------------------------------|--|-------------------------------------|--|
| <input checked="" type="checkbox"/> None known | <input type="checkbox"/> Highways | <input type="checkbox"/> Vandalism | <input type="checkbox"/> Developers | <input type="checkbox"/> Other _____ |
| <input type="checkbox"/> Renewal | <input type="checkbox"/> Private | <input type="checkbox"/> Deterioration | <input type="checkbox"/> Zoning | <input type="checkbox"/> Explanation _____ |