

KENTUCKY HISTORIC RESOURCES INVENTORY

Site No. Bb 142

1. Historic Name(s) <u>Joseph Kennedy house</u>		22. ADD/County <u>Beechgrass / Bourbon</u>	
Original Owner <u>Joseph Kennedy</u>		23. U.S.G.S. Quadrant (15'/75') <u>Shewan vic</u>	
2. Present Name <u>Joseph Kennedy house</u>		24. UTM Reference Zone <u>16</u> Easting <u>741740</u> Northing <u>4239380</u>	
3. Location <u>1/2 mi E of 1940 on base commencing just S of Flat Run Creek</u>		25. Coordinate Accuracy <input type="checkbox"/>	
4. Owner's Name <u>Ralph Linsville</u>		26. Prehistoric Site <input type="checkbox"/> Object <input type="checkbox"/> Historic Site <input type="checkbox"/> Structure <input type="checkbox"/> Building <input checked="" type="checkbox"/> Other <input type="checkbox"/>	
5. Owner's Address <u>Route 6, Paris, Ky. 40361</u>		27. National Register District Name: <input type="checkbox"/>	
6. Open to Public Yes <input type="checkbox"/> No <input checked="" type="checkbox"/>	7. Visible from road Yes <input type="checkbox"/> No <input checked="" type="checkbox"/>	8. Ownership Private <input checked="" type="checkbox"/> Local <input type="checkbox"/> State <input type="checkbox"/> Federal <input type="checkbox"/>	
9. Local Contact/Organization		28. Significance Evaluation <input type="checkbox"/>	
10. Site Plan with North Arrow <u>see attached boundary form</u>		29. Status National Landmark <input type="checkbox"/> Date _____ National Register <input type="checkbox"/> Landmark Certificate <input type="checkbox"/> Kentucky Survey <input type="checkbox"/> Local Landmark <input type="checkbox"/> HABS/HAER <input type="checkbox"/>	
11. Architect		30. Historic Theme Primary <u>Architecture</u> <input checked="" type="checkbox"/> Secondary <input type="checkbox"/> Other <input type="checkbox"/>	
12. Builder		31. Endangered Yes <input type="checkbox"/> No <input checked="" type="checkbox"/>	
13. Date <u>1835-50</u> A. <input checked="" type="checkbox"/> B. <input type="checkbox"/>		32. Preservation Project Status <input type="checkbox"/>	
14. Style A. <u>H-R.</u> <input checked="" type="checkbox"/> B. <input type="checkbox"/>		Actual Cost in \$1,000s <input type="checkbox"/>	
15. Original Use <u>Residence</u> <input checked="" type="checkbox"/>		33. ATTACH PHOTO <u>attached</u>	
16. Present use <u>vacant</u>			
17. Condition <u>poor</u> <input checked="" type="checkbox"/>			
18. Description <u>2 story, 4 bay, double cell quarried stone house with 1 story rear ell of later period. The exterior chimneys, square (2) 2nd floor newel, balustrade, beaded stair wall, the floor plan and stonework are the only early type</u> (Continue on Back) (over)		No. Stories <u>2</u> <input checked="" type="checkbox"/> Single Pile <input checked="" type="checkbox"/> NA <input type="checkbox"/> Double Pile <input type="checkbox"/> Floor Plan <u>double cell</u> <input checked="" type="checkbox"/> Structural Fabric <u>stone</u> A. <input checked="" type="checkbox"/> B. <input type="checkbox"/> Decorative Fabric <u>—</u> A. <input type="checkbox"/> B. <input type="checkbox"/> Roof Form <u>Gable</u>	
19. History <u>not recorded (Joseph Kennedy not listed in 1790 or 1800 census Bourbon Co.) Was called "Dr." Kennedy; relation to other Kennedys not known.</u>		Roll No. _____ Picture No. _____ Direction _____	
20. Significance <u>rare example late? dry stone house</u>		34. Prepared by: <u>C.M. Woolley</u>	
21. Source of Information <u>inspection</u>		35. Organization _____	
		36. Date <u>1982</u>	
		37. Revision Dates _____ 38. Staff Review _____	

18 cont.:

features. The house seems later than other dry stone houses because of its long narrow shape, low pitched roof, and one monolithic lintel. There is no early woodwork - all simple H.R. window frames and mantel. Queen Ann-fashion pediment added.

(photo 3)

(photo 1)

Flooring has been removed, exposing un-hewn log joists 1st floor, vertically sawn joists 2nd floor. Enclosed stair ~~steps~~ arises from rear.

(I forgot to look for evidence of chair rail patching in plaster, or to note whether latches were head split.)

C.W.

Remains of carriage mount are in front of house.

(photo 8)

(photo 5)

(photo 6)

(photo 7)

VERBAL BOUNDARY DESCRIPTION & JUSTIFICATION

Beginning at A at the NW corner of the yard, thence with fence around yard 250 ft E, 200 ft S, 250 ft W, and 200 ft N to the beginning containing the house and carriage steps and post pillar. The barn is later. About 1 1/4 acres.

SKETCH MAP OF SITE SHOWING BOUNDARIES AND KEY BUILDINGS AND FEATURES WITH NORTH ARROW.

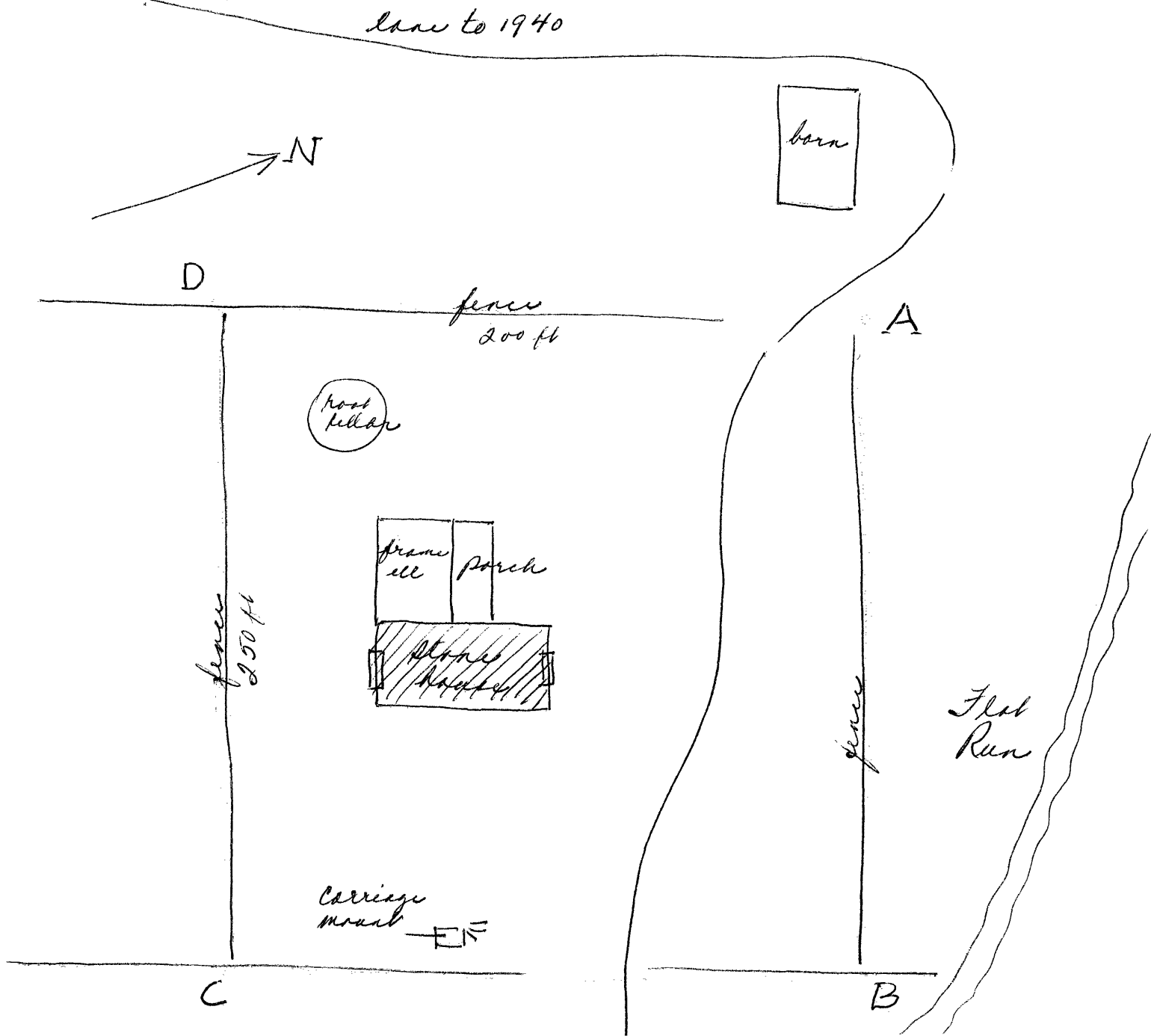

KENTUCKY HISTORIC RESOURCES INVENTORY

Site No. Bb 142

1. Historic Name(s) <u>Joseph Kennedy house</u>		22. ADD/County <u>Beechgrass / Bourbon</u>	
Original Owner <u>Joseph Kennedy</u>		23. U.S.G.S. Quadrant (15'/75') <u>Shewan vic</u>	
2. Present Name <u>Joseph Kennedy house</u>		24. UTM Reference Zone <u>16</u> Easting <u>741740</u> Northing <u>4239380</u>	
3. Location <u>1/2 mi E of 1940 on base commencing just S of Flat Run Creek</u>		25. Coordinate Accuracy <input type="checkbox"/>	
4. Owner's Name <u>Ralph Linsville</u>		26. Prehistoric Site <input type="checkbox"/> Object <input type="checkbox"/> Historic Site <input type="checkbox"/> Structure <input type="checkbox"/> Building <input checked="" type="checkbox"/> Other <input type="checkbox"/>	
5. Owner's Address <u>Route 6, Paris, Ky. 40361</u>		27. National Register District Name: <input type="checkbox"/>	
6. Open to Public Yes <input type="checkbox"/> No <input checked="" type="checkbox"/>	7. Visible from road Yes <input type="checkbox"/> No <input checked="" type="checkbox"/>	8. Ownership Private <input checked="" type="checkbox"/> Local <input type="checkbox"/> State <input type="checkbox"/> Federal <input type="checkbox"/>	
9. Local Contact/Organization		28. Significance Evaluation <input type="checkbox"/>	
10. Site Plan with North Arrow <u>see attached boundary form</u>		29. Status National Landmark <input type="checkbox"/> Date _____ National Register <input type="checkbox"/> Landmark Certificate <input type="checkbox"/> Kentucky Survey <input type="checkbox"/> Local Landmark <input type="checkbox"/> HABS/HAER <input type="checkbox"/>	
11. Architect		30. Historic Theme Primary <u>Architecture</u> <input checked="" type="checkbox"/> Secondary <input type="checkbox"/> Other <input type="checkbox"/>	
12. Builder		31. Endangered Yes <input type="checkbox"/> No <input checked="" type="checkbox"/>	
13. Date <u>1835-50</u> A. <input checked="" type="checkbox"/> B. <input type="checkbox"/>		32. Preservation Project Status <input type="checkbox"/>	
14. Style A. <u>H-R.</u> <input checked="" type="checkbox"/> B. <input type="checkbox"/>		Actual Cost in \$1,000s <input type="checkbox"/>	
15. Original Use <u>Residence</u> <input checked="" type="checkbox"/>		33. ATTACH PHOTO <u>attached</u>	
16. Present use <u>vacant</u>			
17. Condition <u>poor</u> <input checked="" type="checkbox"/>			
18. Description <u>2 story, 4 bay, double cell quarried stone house with 1 story rear ell of later period. The exterior chimneys, square (2) 2nd floor newel, balustrade, beaded stair wall, the floor plan and stonework are the only early type</u> (Continue on Back) (over)		No. Stories <u>2</u> <input checked="" type="checkbox"/> Single Pile <input checked="" type="checkbox"/> NA <input type="checkbox"/> Double Pile <input type="checkbox"/> Floor Plan <u>double cell</u> <input checked="" type="checkbox"/> Structural Fabric <u>stone</u> A. <input checked="" type="checkbox"/> B. <input type="checkbox"/> Decorative Fabric <input type="checkbox"/> A. <input type="checkbox"/> B. <input type="checkbox"/> Roof Form <u>Gable</u>	
19. History <u>not recorded (Joseph Kennedy not listed in 1790 or 1800 census Bourbon Co.) Was called "Dr." Kennedy; relation to other Kennedys not known.</u>		Roll No. _____ Picture No. _____ Direction _____	
20. Significance <u>rare example late? dry stone house</u>		34. Prepared by: <u>C.M. Woolley</u>	
21. Source of Information <u>inspection</u>		35. Organization _____	
		36. Date <u>1982</u>	
		37. Revision Dates _____ 38. Staff Review _____	

18 cont.:

features. The house seems later than other dry stone houses because of its long narrow shape, low pitched roof, and one monolithic lintel. There is no early woodwork - all simple H.R. window frames and mantel. Queen Ann-fashion pediment added.

(photo 3)

(photo 1)

Flooring has been removed, exposing un-hewn log joists 1st floor, vertically sawn joists 2nd floor. Enclosed stair ~~steps~~ arises from rear.

(I forgot to look for evidence of chair rail patching in plaster, or to note whether latches were head split.)

C.W.

Remains of carriage mount are in front of house.

(photo 8)

(photo 5)

(photo 6)

(photo 7)

VERBAL BOUNDARY DESCRIPTION & JUSTIFICATION

Beginning at A at the NW corner of the yard, thence with fence around yard 250 ft E, 200 ft S, 250 ft W, and 200 ft N to the beginning containing the house and carriage steps and post pillar. The barn is later. About 1 1/4 acres.

SKETCH MAP OF SITE SHOWING BOUNDARIES AND KEY BUILDINGS AND FEATURES WITH NORTH ARROW.

