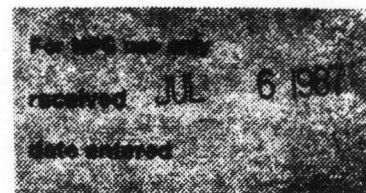

United States Department of the Interior
National Park ServiceNational Register of Historic Places
Inventory—Nomination Form

Continuation sheet

Item number June 1987

Page 1

AMENDMENT TO THE DALLAS COUNTY MRA: CHARLOTTE STREET HISTORIC DISTRICT

DESCRIPTION**SUMMARY**

The four blocks in the Charlotte Street Historic District represent the finest historically and architecturally cohesive residential neighborhood in Fordyce, Arkansas. A. B. Banks bought the land in 1906 which later became the A. B. Banks Addition when the town of Fordyce extended its boundaries. Banks hired contractor C. H. Kollman to build houses on Charlotte Street, with all possibly having been constructed between the years 1914 and 1917. The remaining structures were built after Banks sold empty individual lots.

The south end of the district once contained the oldest structure in the neighborhood, Bank's house designed by renowned architect Charles L. Thompson and built in 1910, although it burned in 1964. The fence, pool, gazebo, carriage house and pergola remain from the Banks Estate and reflect the prosperity that A. B. Banks initiated in Fordyce. Built in 1918, the old Fordyce High School, recently demolished, also lay at the south end of the district and was designed by Charles Thompson.

Continuing north, Charlotte Street is distinguished by large trees that line its borders and Craftsman bungalows which reflect the district's period of significance, 1910 to 1930. The thirteen Craftsman bungalows are one or one-and-a-half stories and are constructed with a mixture of materials, in most cases including wood, stucco, brick and shingles. Low-pitched front gable houses and side gable houses have wide eaves supported by exposed rafters and brackets. Side gable houses often have dormers at the front and roofs that extend to cover porches, while front gable structures' porches are covered by smaller, front gable roofs. Porches are pronounced and their roofs are supported by piers or columns on piers.

ELABORATION

1. A. B. Banks Estate

A) Carriage House - 1910

A one-and-one-half story structure with a gable roof and several dormers sits at the back, or 4th Street side, of the lot. It is sided with narrow weatherboarding.

B) Gazebo - 1910

Designed by Charles L. Thompson, the gazebo has eight Tuscan columns which support an octagonal roof.

C) Pergola - c. 1926

Built to replace an earlier wooden pergola, this structure is rather distinctive. Uniquely designed, the roof is of cast concrete and is supported by brick piers. It is seasonally covered by wysteria.

D) Swimming Pool - c. 1926

Reported to be one of the oldest private swimming pools in the state, it is virtually a "cement pond." The poolhouse is a three-sided structure with brick piers and board-and-batten siding.

United States Department of the Interior
National Park ServiceNational Register of Historic Places
Inventory—Nomination Form

Continuation sheet

Item number June 1987

Page 2

AMENDMENT TO THE DALLAS COUNTY MRA: CHARLOTTE STREET HISTORIC DISTRICT

E) Wynne-Land House - c. 1975 (NC)

This house graces the site where the A. B. Banks house once stood. A "contemporary Greek Revival" house, it is a one-and-one-half-story brick structure with a hipped roof and three-bay central porch.

F) Fence - c. 1926

The red brick wall which is partially crested by wrought iron not only unifies the A. B. Banks estate, but also contributes to the Charlotte Street streetscape.

2. Langley House - 700 Meek Street - 1926

A simple side-gable bungalow with a full front porch, the Langley House is similar to several other houses in the area. The porch supports are brick piers that have been painted white. The roof has exposed rafters and the windows are double-hung with five-over-one vertical panes. The exterior wall surface is white weatherboard.

3. 510 Broadway - 1927

This side-gable bungalow has a full-front recessed porch which is supported by brick piers. The siding is white weatherboard and the windows are double-hung with five-over-one vertical panes. The porch has been partially screened.

4. 506 Broadway - 1930

This bungalow has cross gables and a one-half front porch. The porch is supported by brick piers and has been fully screened. The siding is narrow weatherboard and the windows are double-hung with five-over-one vertical panes.

5. Kenneson House - 700 Charlotte Street - 1915

This white, one-and-one-half-story bungalow is representative of the style which is most prevalent on Charlotte Street. It has weatherboard siding on the ground floor with stucco in the gable ends. There is a large roof over-hang supported by kneebraces. The front entrance is off-center and is covered by a small gable roof. The windows are one-over-one double-hung. Wrought iron posts have replaced original porch posts and are used on the carport. There are also green window shutters which are not original. One unique feature is the three "stairstep" nine-pane square windows in the south gable.

6. Atkinson House - 710 Charlotte Street - 1915

The one-story, hipped roof Atkinson House is perhaps the most uniquely designed in the area. The front facade originally had a recessed porch at each corner (although one is presently enclosed.) In the middle section there are six double-hung sash windows with slightly curvilinear heads. The window heads together create a large segmental arch which is echoed by an upward curve in the eave, similar to an eyebrow dormer. The house has gray weatherboard siding, exposed rafters, and three-over-one vertical pane, double-hung windows.

7. Hampton House - 802 Charlotte Street - 1915

The Hampton House is a one-and-one-half-story structure with a gable roof and narrow weatherboard siding. It has kneebraces, exposed rafters, and half-timbering in the front

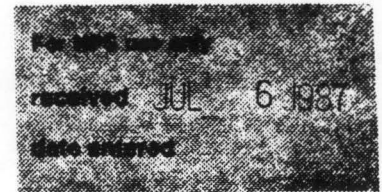
United States Department of the Interior
National Park ServiceNational Register of Historic Places
Inventory—Nomination Form

Continuation sheet

Item number June 1987

Page 3

AMENDMENT TO THE DALLAS COUNTY MRA: CHARLOTTE STREET HISTORIC DISTRICT

gable. Basically rectangular in plan, there are two small projections on each side. At the front, on one side is a sunporch with casement windows and the other was a porch that has now been enclosed. The front entrance is centered and is protected by a small gable roof.

8. 808 Charlotte Street - 1918

This is a one-and-one-half-story, side-gable Craftsman house. The front porch is supported by both posts-on-piers and posts-on-walls and extends beyond the block of the house. It has been partially screened. There is a large shed dormer in the center front and rear. The wall material is narrow yellow weatherboard on the first level and stucco in the gables and dormers. The house has kneebraces, exposed rafters, and four-over-one vertical pane double-hung windows.

9. 911 Charlotte Street - 1913

Most likely the oldest house on the street, this one-and-one-half story Craftsman bungalow is located on a large tree-shaded corner lot. It has weatherboard siding and stucco in the gables. The plan is irregular with a cross gable roof. There are kneebraces, exposed rafters, and one-over-one double-hung windows. The wrap-around porch is supported by posts-on-piers. There is also a free-standing garage.

10. 901 Charlotte Street - c. 1930

This one-story, buff brick house with an irregular plan was influenced by the English Revival style. The roof is steeply pitched, the chimney is located on the front facade, and there is a recessed porch on one front corner, which is accessed by a set of French doors. The front door is located under a small gable entryway. The roof is a combination of types -- various sized gables and a gablet.

11. 811 Charlotte Street - c. 1921

This one-and-one-half-story, side gable bungalow appears to be symmetrical from the front. It has a full-front recessed porch and the porch supports on a weatherboard wall, which matches the house. The left-front of the house is only one room deep, so it is actually more like a wing. There is a large roof overhang which is supported by kneebraces. The windows are six-over-one double-hung.

12. 809 Charlotte Street - c. 1935 (NC)

This one-story gable roof duplex is rectangular in plan. It has a one-half central front porch under a smaller gable roof which is supported by wrought iron posts. It has exposed rafters, kneebraces, and three-over-one vertical pane, double-hung windows. It is covered with artificial siding.

13. 807 Charlotte Street - 1918

This bungalow has a full-front recessed porch which has been screened. The porch supports are battered columns-on-piers. The roof is a cross gable with the side gable at the front. There is a shed dormer with no windows on the front and the exterior is covered with blue-gray weatherboard. Like many of the others on the street, the structure has kneebraces and exposed rafters. The windows are five-over-one, vertical pane, and double-hung.

**United States Department of the Interior
National Park Service**

**National Register of Historic Places
Inventory—Nomination Form**

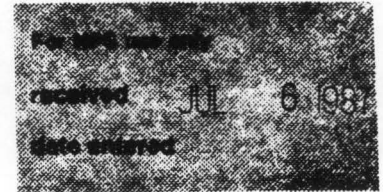

Continuation sheet

Item number June 1987

Page 4

AMENDMENT TO THE DALLAS COUNTY MRA: CHARLOTTE STREET HISTORIC DISTRICT

14. Talbot House - 801 Charlotte Street - 1915

This classic bungalow has an irregular plan with a side gable roof on the house and a front gable roof on the three-quarter porch. The porch supports are columns-on-piers. The house is covered with forest green weatherboard and the gable ends are covered with shingles. The windows are one-over-one double-hung and, again, the roof has exposed rafters and kneebraces.

15. 711 Charlotte Street - 1917 (NC)

Although it differs from the other bungalows on the street by the use of stick-work in both the front and side gable, this one-and-one-half-story house has several similarities. It is probable that, like the others of this period, it also has stucco in the gables, but the house has been covered with artificial siding. According to Sanborn maps, it has also had a wrap-around porch removed. The windows are nine-over-one double-hung and the roof has exposed rafters and kneebraces.

16. 709 Charlotte Street - c. 1940 (NC)

This simple one-story structure has shed additions on both sides. Although it is currently used as a residence, its original use is unknown. It is rectangular in plan, has a gable roof, and is covered with white weatherboard.

17. 701 Charlotte Street
House - c. 1935 (NC)

This two-story house with full basement is in the Colonial Revival style. Very simply detailed, it has a slightly recessed entryway with a two-story porch. There is no roof overhang and the house is covered with artificial siding.

17A. Garage with Apartment - c. 1920

The two-story garage and apartment dates as an ancillary of an earlier structure on this site which burned. The lower level is a garage or carriage house and the upper level is a living space. The apartment is accessed by an exterior staircase. The structure has a gable roof with kneebraces and is sided with narrow weatherboard.

18. D. C. Gates House - 609 Charlotte Street - 1921

Designed by Little Rock architects Sanders and Ginocchio, the Gates House has several exterior details which are very similar to those on other Charlotte Street residences. It is a white weatherboard structure with stucco and half-timbering in the gable. It also has kneebraces, exposed rafters, and a small gable roof over the front entry. The windows are six-over-one double-hung. The plan is rectangular, but has a small sunroom which projects from the front of the south side of the house. The bulk of the house is covered by a clipped gable with a slightly lower gable covering the front room. On the interior, the Gates House still contains many of its original fixtures. It also contains some fairly unique pine wall panelling, which Mr. Gates hand-picked so that it contains no knots.

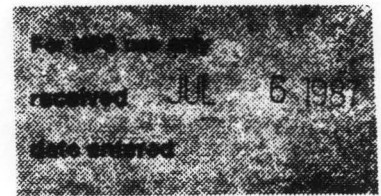
United States Department of the Interior
National Park ServiceNational Register of Historic Places
Inventory—Nomination Form

Continuation sheet

Item number June 1987

Page 5

AMENDMENT TO THE DALLAS COUNTY MRA: CHARLOTTE STREET HISTORIC DISTRICT
SIGNIFICANCE**SUMMARY**

With its Craftsman residences and the remnants of the estate of its developer, insurance magnate A. B. Banks, the Charlotte Street Historic District in Fordyce is representative both architecturally and historically of a boom period in the development of this small south Arkansas lumber town.

DISTRICT BOUNDARIES

The boundaries of the district were drawn to incorporate the area which best represents the neighborhood both architecturally and historically. The entire two blocks which was the estate of A. B. Banks are included, although the original Banks residence is no longer standing. Houses on Broadway and Meek across from the Banks estate were included in the district because they are representative of the period of significance and also because they are homes built for Banks' employees. On the northern edge of the district the boundary stops at Holmes Street because residences past that point retain little of the integrity displayed by the structures within the district. The eastern side of the 900 block of Charlotte Street was not included as three of the four houses there are of post-World War II construction, the only historic dwelling being the Russell House which was part of the original Dallas County MRA nomination. Although the two predominant dwellings on the west side of the 700 block have been designated non-contributing, that area does not detract greatly from the visual cohesiveness of the district because their non-contributing status is due solely to the fact that they are sheathed with artificial siding. The landscaping features such as trees and the low rock wall which help tie the neighborhood together are still present.

The Fordyce High School Building, constructed in 1918 and designed by Charles L. Thompson, and its associated buildings, fronted on 4th Street, from which one enters Charlotte Street. It was representative of the growth and development of the neighborhood during the period of significance; however, the school was demolished in May 1987 and only the associated structures remain.

ELABORATION

A. B. Banks moved to Fordyce in 1885, shortly after the railroad-initiated community had been incorporated as a town. He began selling life insurance, and in 1891 formed a local fire insurance agency. The formation of the Fordyce Lumber Company in 1888, and its subsequent growth, provided a market for the services Banks had to offer and he expanded into accident coverage, forming the Home Life and Accident Insurance Company which was to provide the foundation for his financial power base.

In 1905 Banks purchased an acreage close to the city limits of Fordyce, and in 1906 the area was annexed to the city as the "A. B. Banks Addition." The central thoroughfare of the neighborhood Banks named after his wife, Charlotte, and five blocks on the east side of this street were not subdivided, being designed as the "A. B. Banks Park Reserve." The two southernmost blocks in the reserve Banks turned into his personal estate, and in 1910 he built a grand neoclassical home designed by noted Little Rock architect Charles L. Thompson. Although the house itself burned in 1964 and has been replaced by the 1970's residence of the present owners, the carriage house and gazebo remain from the original Banks estate, the landscaping and layout of which retain their integrity. 1920's aspects of the grounds, which testify to Banks'

**United States Department of the Interior
National Park Service**

**National Register of Historic Places
Inventory—Nomination Form**

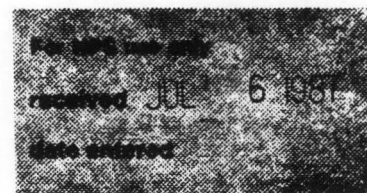

Continuation sheet

Item number

June 1987

Page 6

AMENDMENT TO THE DALLAS COUNTY MRA: CHARLOTTE STREET HISTORIC DISTRICT

affluence, include an inground swimming pool (reportedly the first in the state constructed for private use) and an unusual U-shaped pergola which was built for the wedding of Banks' daughter. An impressive brick fence, probably contemporary to the pool, and pergola, surrounds the entire estate.

The Craftsman residences which comprise the rest of the district, while much more modest than the Banks property, are significant in that they comprise the most cohesive historic neighborhood in Fordyce which reflects the World War I era growth of the city, both architecturally and historically.

After the construction of the Banks house, most of the earliest residences were built on the east side of Charlotte Street on lots which Banks carved out of the Park Reserve. Banks commissioned local contractor C. H. Kollman to build houses on the lots and then sold the property afterwards, often to one of his employees and usually providing the financing himself. Notable among this group is the Atkinson House (#6) with its distinctive "eyebrow" roofline.

The contributing structures on the west side of Charlotte Street were built between 1913 and 1930, with the majority being constructed during the late 'teens and early 'twenties. These are all (with one exception) variations of the bungalow and contribute to the district's integrity as a cohesive unit of vernacular Craftsman architecture. Banks himself reportedly had Kollman build the houses at 801 Charlotte (#14) and 711 Charlotte (#15) and probably some of the others. The D. C. Gates House (#18) is one of the most finely-crafted bungalows in the district, and was designed by Sanders and Ginocchio, associates of Charles Thompson. Gates was one of the original stockholders in the Fordyce Lumber Company and had materials hand-picked for construction of his home. Pine used for cabinets and panelling is of exceptional quality, virtually knot-free.

The late 'teens were good for lumber, when mills throughout southern Arkansas went full blast to meet the heavy demands of World War I and the early post-war period. Founded as a railroad town, Fordyce grew because of the timber industry, and the World War I era prosperity of the town is reflected in the development of the Charlotte Street Historic District. Fordyce Lumber Company was purchased by Georgia-Pacific Corporation in 1963, and none of the Banks family remains in the town, but the neighborhood serves as a reminder of the early development of Fordyce.

**United States Department of the Interior
National Park Service**

**National Register of Historic Places
Inventory—Nomination Form**

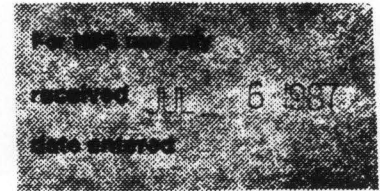

Continuation sheet

Item number

June 1987

Page 7

AMENDMENT TO THE DALLAS COUNTY MRA: CHARLOTTE STREET HISTORIC DISTRICT

BIBLIOGRAPHICAL REFERENCES

Arkansas Democrat, September 16, 1962.

Arkansas Gazette, articles on the following dates: February 11, 1982; March 20, 1920;
May 22, 1932; January 4, 1953.

Dallas County Tax Assessment Records, 1906-1935.

Fordyce Weekly News, articles on the following dates: December 15, 1932; July 18, 1940;
December 13, 1964.

Halphin, Kay. "Sears, Roebuck's Best-Kept Secret," "Historic Preservation", September/October 1981.

Interviews with: Mrs. Richard Banks, February 16, 1987; Mr. K. J. Caplinger, February 9, 1987;
Mrs. Sue Wynne Land, January 29, 1987; Thomas Sparks, February 17, 1987; Mr. & Mrs.
Gary Vaughan, January 29, 1987; Mrs. Phill Word, February 18, 1987.

Sanborn Fire Insurance Maps, 1912, 1917, 1925, with 1946 update.

Schwartz, David M. "When Home Sweet Home Was Just a Mailbox Away," Smithsonian,
November 1985.

Smith, Kenneth L. Sawmill: The Story of Cutting the Last Great Virgin Forest East of
the Rockies. Fayetteville: University of Arkansas, 1986.

Stevenson, Katherine Cole and Jandl, H. Ward. Houses By Mail. Washington, D.C.: The
Preservation Press, 1986.

"Yellow Pine Sextet," promotional publication from Fordyce Lumber Company, c. 1940.

**United States Department of the Interior
National Park Service**

**National Register of Historic Places
Inventory—Nomination Form**

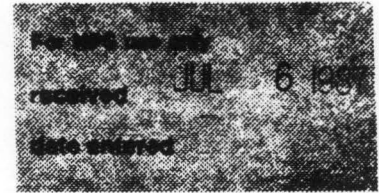

Continuation sheet

Item number

June 1987

Page 8

AMENDMENT TO THE DALLAS COUNTY MRA: CHARLOTTE STREET HISTORIC DISTRICT

VERBAL BOUNDARY

The Charlotte Street Historic District is located in Fordyce, Dallas County, Arkansas. Specifically beginning at the intersection of Charlotte, East Fourth, and East College Streets, proceed north 165 feet on Charlotte Street, then proceed west 100 feet, then proceed north 1200 feet to Holmes Street. Proceed east 110 feet on Holmes to Charlotte Street, then proceed south 335 feet on Charlotte to Smith Street. Proceed east 115 feet on Smith, then proceed south 380 feet, then proceed east 305 feet, then proceed south 165 feet on Broadway to Jackson Street, then proceed 300 feet south on Jackson to East College Street. Proceed west on East College to the corner of East Fourth and Charlotte Streets and the point of beginning.

**United States Department of the Interior
National Park Service**

**National Register of Historic Places
Inventory—Nomination Form**

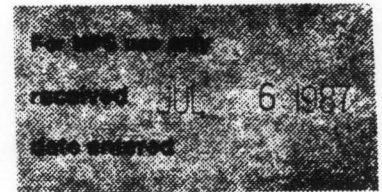

Continuation sheet

Item number

June 1987

Page 9

AMENDMENT TO THE DALLAS COUNTY MRA: CHARLOTTE STREET HISTORIC DISTRICT

PROPERTY

OWNER

- | | |
|--|--|
| 1. 600 Charlotte Street
Fordyce, Dallas County | Ms. Sue Wynne Land
600 Charlotte Street
Fordyce, AR 71742 |
| 2. 700 Meek Street
Fordyce, Dallas County | Mr. & Mrs. Elmer Lane
700 Meek Street
Fordyce, AR 71742 |
| 3. 510 Broadway
Fordyce, Dallas County | Mr. & Mrs. Jack Christie
510 Broadway
Fordyce, AR 71742 |
| 4. 506 Broadway Street
Fordyce, Dallas County | Reverend & Mrs. Rufus Sorrells
506 Broadway Street
Fordyce, AR 71742 |
| 5. 700 Charlotte Street
Fordyce, Dallas County | Mrs. Leroy Turner
700 Charlotte Street
Fordyce, AR 71742 |
| 6. 710 Charlotte Street
Fordyce, Dallas County | Mr. & Mrs. Tommy Mays
710 Charlotte Street
Fordyce, AR 71742 |
| 7. 802 Charlotte Street
Fordyce, Dallas County | Mr. & Mrs. K. J. Caplinger
802 Charlotte Street
Fordyce, AR 71742 |
| 8. 808 Charlotte Street
Fordyce, Dallas County | Mr. & Mrs. Richard Rogers
808 Charlotte Street
Fordyce, AR 71742 |
| 9. 911 Charlotte Street
Fordyce, Dallas County | Mr. & Mrs. A. J. Doss
811 Charlotte Street
Fordyce, AR 71742 |
| 10. 901 Charlotte Street
Fordyce, Dallas County | Mr. Dean Kilgore
901 Charlotte Street
Fordyce, AR 71742 |
| 11. 811 Charlotte Street
Fordyce, Dallas County | Mr. & Mrs. Phill Word
811 Charlotte Street
Fordyce, AR 71742 |

United States Department of the Interior
National Park Service

**National Register of Historic Places
Inventory—Nomination Form**



Continuation sheet

Item number June 1987

Page 10

AMENDMENT TO THE DALLAS COUNTY MRA: CHARLOTTE STREET HISTORIC DISTRICT

PROPERTY

OWNER

12. 809 Charlotte Street
Fordyce, Dallas County

Mrs. Ellen Vineyard
502 Overstreet
Fordyce, AR 71742

13. 807 Charlotte Street
Fordyce, Dallas County

Mr. & Mrs. Jerry Bush
807 Charlotte Street
Fordyce, AR 71742

14. 801 Charlotte Street
Fordyce, Dallas County

Mr. & Mrs. Claud Deaton
801 Charlotte Street
Fordyce, AR 71742

15. 711 Charlotte Street
Fordyce, Dallas County

Mr. & Mrs. Olin Ripley
711 Charlotte Street
Fordyce, AR 71742

16. 709 Charlotte Street
Fordyce, Dallas County

Mr. Eugene Heatherly
Heatherly Electric
1208 Moro Street
Fordyce, AR 71742

17. 701 Charlotte Street
Fordyce, Dallas County

Mr. Homer Cannon
701 Charlotte Street
Fordyce, AR 71742

18. 609 Charlotte Street
Fordyce, Dallas County

Mr. & Mrs. Gary Vaughn
609 Charlotte Street
Fordyce, AR 71742

**United States Department of the Interior
National Park Service**

**National Register of Historic Places
Inventory—Nomination Form**

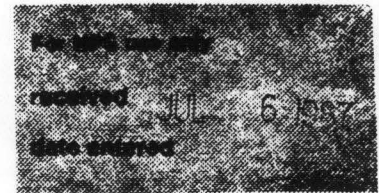

Continuation sheet

Item number June 1987

Page 11

AMENDMENT TO THE DALLAS COUNTY MRA: CHARLOTTE STREET HISTORIC DISTRICT

1. A. B. Banks Estate
 - 1.A) Carriage House - Contributing
 - 1.B) Gazebo - Contributing
 - 1.C) Pergola - Contributing
 - 1.D) Swimming Pool - Contributing
 - 1.E) Wynne-Land House - Non-Contributing
 - 1.F) Fence - Contributing
2. Langley House - 700 Meek Street - Contributing
3. 510 Broadway - Contributing
4. 506 Broadway - Contributing
5. Kenneson House - 700 Charlotte Street - Contributing
6. Atkinson House - 710 Charlotte Street - Contributing
7. Hampton House - 802 Charlotte Street - Contributing
8. 808 Charlotte Street - Contributing
9. 911 Charlotte Street - Contributing
10. 901 Charlotte Street - Contributing
11. 811 Charlotte Street - Contributing
12. 809 Charlotte Street - Non-Contributing
13. 807 Charlotte Street - Contributing
14. Talbot House - 801 Charlotte Street - Contributing
15. 711 Charlotte Street - Non-Contributing
16. 709 Charlotte Street - Non-Contributing
17. House - 701 Charlotte Street - Non-Contributing
- 17.A) Garage with Apartment - 701 Charlotte Street - Contributing
18. D. C. Gates House - 609 Charlotte Street - Contributing

United States Department of the Interior
National Park Service

National Register of Historic Places
Inventory—Nomination Form



Continuation sheet

Item number June 1987

Page 12

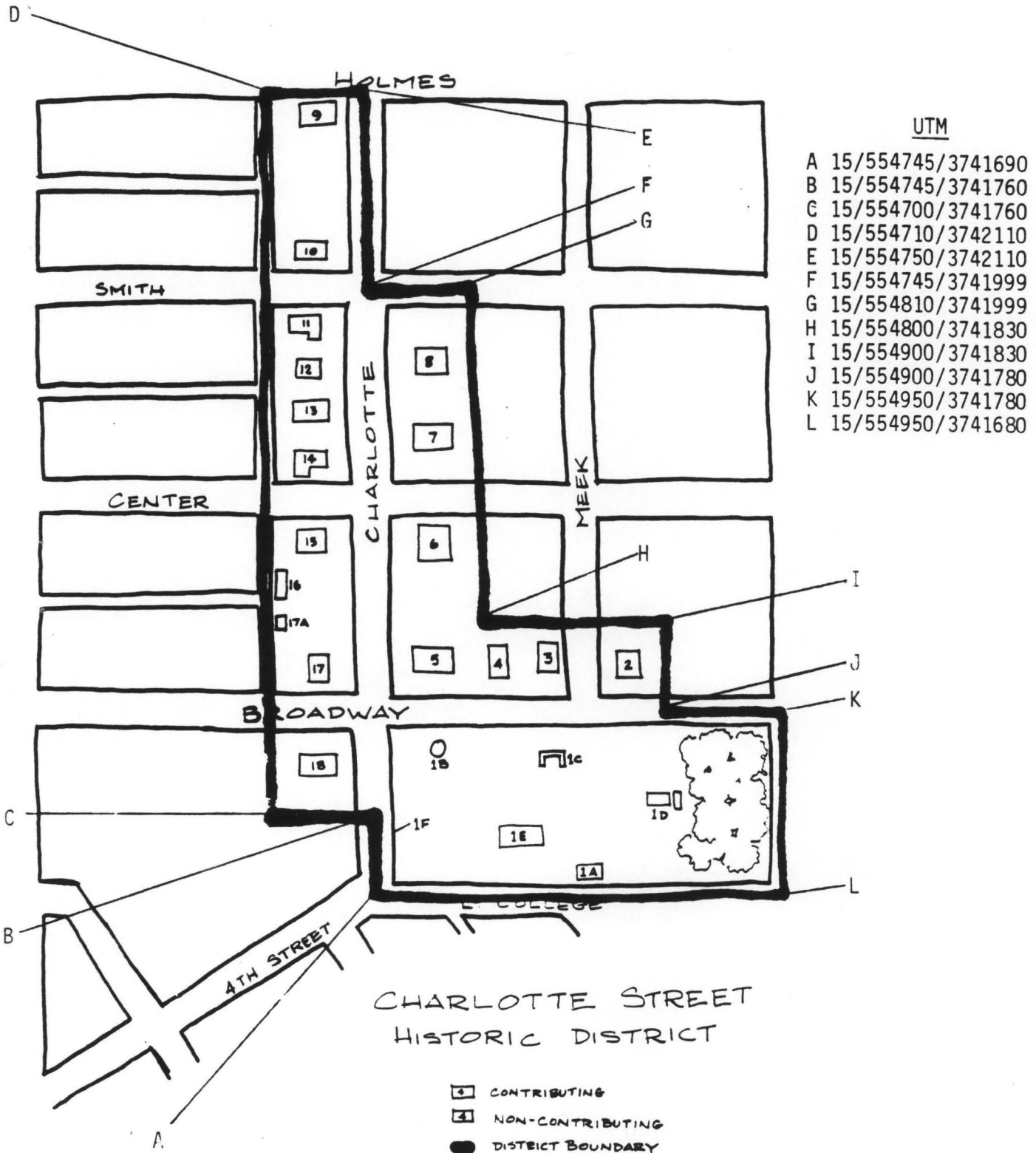

United States Department of the Interior
National Park Service

National Register of Historic Places Inventory—Nomination Form

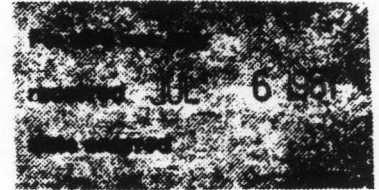

Continuation sheet

Item number June 1987

Page 13

AMENDMENT TO THE DALLAS COUNTY MRA: CHARLOTTE STREET HISTORIC DISTRICT

12. State Historic Preservation Officer Certification

The evaluated significance of this property within the state is:

☐ national ☐ state ☒ local

As the designated State Historic Preservation Officer for the National Historic Preservation Act of 1966 (Public Law 89-665), I hereby nominate this property for inclusion in the National Register and certify that it has been evaluated according to the criteria and procedures set forth by the National Park Service.

State Historic Preservation Officer signature

title State Historic Preservation Officer

date

For NPS use only

I hereby certify that this property is included in the National Register

date

Keeper of the National Register

Attest:

date

Chief of Registration

87001348

UNITED STATES DEPARTMENT OF THE INTERIOR
NATIONAL PARK SERVICE

NATIONAL REGISTER OF HISTORIC PLACES
EVALUATION/RETURN SHEET

Charlotte Street Historic District (Dallas
County MRA)
Dallas County
ARKANSAS

JUL -6 1987

- ☐ resubmission
- ☐ nomination by person or local government
- ☐ owner objection
- ☐ appeal

Working No. _____
Fed. Reg. Date: _____
Date Due: 8/6/87 - 8/20/87
Action: ☐ ACCEPT
☒ RETURN 8-6-87
☐ REJECT
Federal Agency: _____

Substantive Review: ☐ sample ☐ request ☐ appeal ☐ NR decision

Reviewer's comments:

Recom./Criteria _____
Reviewer _____
Discipline _____
Date _____
_____ see continuation sheet

Nomination returned for: ☒ technical corrections cited below
_____ substantive reasons discussed below

1. Name

2. Location

3. Classification

Category	Ownership	Status	Present Use
	Public Acquisition	Accessible	

4. Owner of Property

5. Location of Legal Description

6. Representation in Existing Surveys

Has this property been determined eligible? ☐ yes ☐ no

7. Description

Condition	Check one	Check one
<input type="checkbox"/> excellent	<input type="checkbox"/> deteriorated	<input type="checkbox"/> original site
<input type="checkbox"/> good	<input type="checkbox"/> ruins	<input type="checkbox"/> moved date _____
<input type="checkbox"/> fair	<input type="checkbox"/> unexposed	
	<input type="checkbox"/> unaltered	
	<input type="checkbox"/> altered	

Describe the present and original (if known) physical appearance

- ☐ summary paragraph
- ☐ completeness
- ☐ clarity
- ☐ alterations/integrity
- ☐ dates
- ☐ boundary selection

8. Significance

Period Areas of Significance—Check and justify below

Specific dates Builder/Architect

Statement of Significance (*in one paragraph*)

- ☐ summary paragraph
- ☐ completeness
- ☐ clarity
- ☐ applicable criteria
- ☐ justification of areas checked
- ☐ relating significance to the resource
- ☐ context
- ☐ relationship of integrity to significance
- ☐ justification of exception
- ☐ other

9. Major Bibliographical References

X 10. Geographical Data

X Acreage of nominated property

Quadrangle name

UTM References

Verbal boundary description and justification

11. Form Prepared By

12. State Historic Preservation Officer Certification

The evaluated significance of this property within the state is:

____ national ____ state ____ local

State Historic Preservation Officer signature

title

date

13. Other

- ☐ Maps
- ☐ Photographs
- ☐ Other

Questions concerning this nomination may be directed to

Signed

D. Byers

Date

8/6/87

Phone:

87001348

UNITED STATES DEPARTMENT OF THE INTERIOR
NATIONAL PARK SERVICE

NATIONAL REGISTER OF HISTORIC PLACES
EVALUATION/RETURN SHEET

Charlotte Street Historic District (Dallas
County MRA)
Dallas County
ARKANSAS

RECEIVED

AUG 17 1987

AHPP

JUL -6 1987

Working No. _____

Fed. Reg. Date: _____

Date Due: 8/6/87 - 8/20/87

Action: ☐ ACCEPT

☒ RETURN 8-6-87

☐ REJECT

Federal Agency: _____

- ☐ resubmission
☐ nomination by person or local government
☐ owner objection
☐ appeal

Substantive Review: ☐ sample ☐ request ☐ appeal ☐ NR decision

Reviewer's comments:

Recom./Criteria _____

Reviewer _____

Discipline _____

Date _____

_____ see continuation sheet

Nomination returned for: ☒ technical corrections cited below
_____ substantive reasons discussed below

1. Name

2. Location

3. Classification

Category	Ownership	Status	Present Use
	Public Acquisition	Accessible	

4. Owner of Property

5. Location of Legal Description

6. Representation in Existing Surveys

Has this property been determined eligible? ☐ yes ☐ no

7. Description

Condition

- | | |
|------------------------------------|---------------------------------------|
| <input type="checkbox"/> excellent | <input type="checkbox"/> deteriorated |
| <input type="checkbox"/> good | <input type="checkbox"/> ruins |
| <input type="checkbox"/> fair | <input type="checkbox"/> unexposed |

Check one

- ☐ unaltered
☐ altered

Check one

- ☐ original site
☐ moved date _____

Describe the present and original (if known) physical appearance

- ☐ summary paragraph
☐ completeness
☐ clarity
☐ alterations/integrity
☐ dates
☐ boundary selection

8. Significance

Period Areas of Significance—Check and justify below

Specific dates

Builder/Architect

Statement of Significance (in one paragraph)

- ☐ summary paragraph
- ☐ completeness
- ☐ clarity
- ☐ applicable criteria
- ☐ justification of areas checked
- ☐ relating significance to the resource
- ☐ context
- ☐ relationship of integrity to significance
- ☐ justification of exception
- ☐ other

9. Major Bibliographical References

X 10. Geographical Data

X Acreage of nominated property

From private acreage.

Quadrangle name _____

UTM References _____

Verbal boundary description and justification _____

11. Form Prepared By

12. State Historic Preservation Officer Certification

The evaluated significance of this property within the state is:

____ national

____ state

____ local

State Historic Preservation Officer signature

title

date

13. Other

- ☐ Maps
- ☐ Photographs
- ☐ Other

Questions concerning this nomination may be directed to _____

Signed

D. Byers

Date

8/6/87

Phone: _____

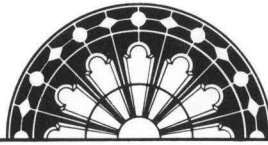

ARKANSAS
HISTORIC
PRESERVATION
PROGRAM

June 25, 1987

Ms. Carol D. Shull
Chief of Registration
United States Department of the Interior
National Register of Historic Places
National Park Service
1100 "L" Street, N.W.
Washington, D.C. 20240

RE: Charlotte Street Historic District
Fordyce, Dallas County
Amendment to Dallas County MRA

Dear Carol:

We are enclosing for your review the nomination for the Charlotte Street Historic District, which is being submitted as an amendment to the Dallas County MRA (NR 10/28/83). The Arkansas Historic Preservation Program has complied with all applicable nominating procedures and notification requirements in the nomination process.

Thank you for your consideration in this matter.

Sincerely,

Wilson Stiles
JLV

Wilson Stiles
State Historic Preservation Officer

WS/TJ/dr

Enclosures

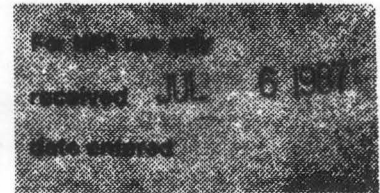

JUL 6 1987

United States Department of the Interior
National Park ServiceNational Register of Historic Places
Inventory—Nomination Form

Continuation sheet

Item number June 1987

Page 1

AMENDMENT TO THE DALLAS COUNTY MRA: CHARLOTTE STREET HISTORIC DISTRICT

DESCRIPTION**SUMMARY**

The four blocks in the Charlotte Street Historic District represent the finest historically and architecturally cohesive residential neighborhood in Fordyce, Arkansas. A. B. Banks bought the land in 1906 which later became the A. B. Banks Addition when the town of Fordyce extended its boundaries. Banks hired contractor C. H. Kollman to build houses on Charlotte Street, with all possibly having been constructed between the years 1914 and 1917. The remaining structures were built after Banks sold empty individual lots.

The south end of the district once contained the oldest structure in the neighborhood, Bank's house designed by renowned architect Charles L. Thompson and built in 1910, although it burned in 1964. The fence, pool, gazebo, carriage house and pergola remain from the Banks Estate and reflect the prosperity that A. B. Banks initiated in Fordyce. Built in 1918, the old Fordyce High School, recently demolished, also lay at the south end of the district and was designed by Charles Thompson.

Continuing north, Charlotte Street is distinguished by large trees that line its borders and Craftsman bungalows which reflect the district's period of significance, 1910 to 1930. The thirteen Craftsman bungalows are one or one-and-a-half stories and are constructed with a mixture of materials, in most cases including wood, stucco, brick and shingles. Low-pitched front gable houses and side gable houses have wide eaves supported by exposed rafters and brackets. Side gable houses often have dormers at the front and roofs that extend to cover porches, while front gable structures' porches are covered by smaller, front gable roofs. Porches are pronounced and their roofs are supported by piers or columns on piers.

ELABORATION

1. A. B. Banks Estate
 - A) Carriage House - 1910
A one-and-one-half story structure with a gable roof and several dormers sits at the back, or 4th Street side, of the lot. It is sided with narrow weatherboarding.
 - B) Gazebo - 1910
Designed by Charles L. Thompson, the gazebo has eight Tuscan columns which support an octagonal roof.
 - C) Pergola - c. 1926
Built to replace an earlier wooden pergola, this structure is rather distinctive. Uniquely designed, the roof is of cast concrete and is supported by brick piers. It is seasonally covered by wysteria.
 - D) Swimming Pool - c. 1926
Reported to be one of the oldest private swimming pools in the state, it is virtually a "cement pond." The poolhouse is a three-sided structure with brick piers and board-and-batten siding.

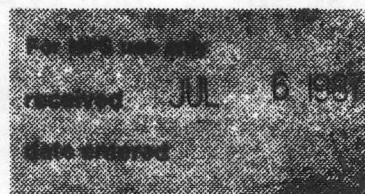
United States Department of the Interior
National Park ServiceNational Register of Historic Places
Inventory—Nomination Form

Continuation sheet

Item number June 1987

Page 2

AMENDMENT TO THE DALLAS COUNTY MRA: CHARLOTTE STREET HISTORIC DISTRICT

E) Wynne-Land House - c. 1975 (NC)

This house graces the site where the A. B. Banks house once stood. A "contemporary Greek Revival" house, it is a one-and-one-half-story brick structure with a hipped roof and three-bay central porch.

F) Fence - c. 1926

The red brick wall which is partially crested by wrought iron not only unifies the A. B. Banks estate, but also contributes to the Charlotte Street streetscape.

2. Langley House - 700 Meek Street - 1926

A simple side-gable bungalow with a full front porch, the Langley House is similar to several other houses in the area. The porch supports are brick piers that have been painted white. The roof has exposed rafters and the windows are double-hung with five-over-one vertical panes. The exterior wall surface is white weatherboard.

3. 510 Broadway - 1927

This side-gable bungalow has a full-front recessed porch which is supported by brick piers. The siding is white weatherboard and the windows are double-hung with five-over-one vertical panes. The porch has been partially screened.

4. 506 Broadway - 1930

This bungalow has cross gables and a one-half front porch. The porch is supported by brick piers and has been fully screened. The siding is narrow weatherboard and the windows are double-hung with five-over-one vertical panes.

5. Kenneson House - 700 Charlotte Street - 1915

This white, one-and-one-half-story bungalow is representative of the style which is most prevalent on Charlotte Street. It has weatherboard siding on the ground floor with stucco in the gable ends. There is a large roof over-hang supported by kneebraces. The front entrance is off-center and is covered by a small gable roof. The windows are one-over-one double-hung. Wrought iron posts have replaced original porch posts and are used on the carport. There are also green window shutters which are not original. One unique feature is the three "stairstep" nine-pane square windows in the south gable.

6. Atkinson House - 710 Charlotte Street - 1915

The one-story, hipped roof Atkinson House is perhaps the most uniquely designed in the area. The front facade originally had a recessed porch at each corner (although one is presently enclosed.) In the middle section there are six double-hung sash windows with slightly curvilinear heads. The window heads together create a large segmental arch which is echoed by an upward curve in the eave, similar to an eyebrow dormer. The house has gray weatherboard siding, exposed rafters, and three-over-one vertical pane, double-hung windows.

7. Hampton House - 802 Charlotte Street - 1915

The Hampton House is a one-and-one-half-story structure with a gable roof and narrow weatherboard siding. It has kneebraces, exposed rafters, and half-timbering in the front

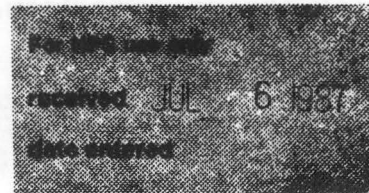
United States Department of the Interior
National Park ServiceNational Register of Historic Places
Inventory—Nomination Form

Continuation sheet

Item number June 1987

Page 3

AMENDMENT TO THE DALLAS COUNTY MRA: CHARLOTTE STREET HISTORIC DISTRICT

gable. Basically rectangular in plan, there are two small projections on each side. At the front, on one side is a sunporch with casement windows and the other was a porch that has now been enclosed. The front entrance is centered and is protected by a small gable roof.

8. 808 Charlotte Street - 1918

This is a one-and-one-half-story, side-gable Craftsman house. The front porch is supported by both posts-on-piers and posts-on-walls and extends beyond the block of the house. It has been partially screened. There is a large shed dormer in the center front and rear. The wall material is narrow yellow weatherboard on the first level and stucco in the gables and dormers. The house has kneebraces, exposed rafters, and four-over-one vertical pane double-hung windows.

9. 911 Charlotte Street - 1913

Most likely the oldest house on the street, this one-and-one-half story Craftsman bungalow is located on a large tree-shaded corner lot. It has weatherboard siding and stucco in the gables. The plan is irregular with a cross gable roof. There are kneebraces, exposed rafters, and one-over-one double-hung windows. The wrap-around porch is supported by posts-on-piers. There is also a free-standing garage.

10. 901 Charlotte Street - c. 1930

This one-story, buff brick house with an irregular plan was influenced by the English Revival style. The roof is steeply pitched, the chimney is located on the front facade, and there is a recessed porch on one front corner, which is accessed by a set of French doors. The front door is located under a small gable entryway. The roof is a combination of types -- various sized gables and a gablet.

11. 811 Charlotte Street - c. 1921

This one-and-one-half-story, side gable bungalow appears to be symmetrical from the front. It has a full-front recessed porch and the porch supports on a weatherboard wall, which matches the house. The left-front of the house is only one room deep, so it is actually more like a wing. There is a large roof overhang which is supported by kneebraces. The windows are six-over-one double-hung.

12. 809 Charlotte Street - c. 1935 (NC)

This one-story gable roof duplex is rectangular in plan. It has a one-half central front porch under a smaller gable roof which is supported by wrought iron posts. It has exposed rafters, kneebraces, and three-over-one vertical pane, double-hung windows. It is covered with artificial siding.

13. 807 Charlotte Street - 1918

This bungalow has a full-front recessed porch which has been screened. The porch supports are battered columns-on-piers. The roof is a cross gable with the side gable at the front. There is a shed dormer with no windows on the front and the exterior is covered with blue-gray weatherboard. Like many of the others on the street, the structure has kneebraces and exposed rafters. The windows are five-over-one, vertical pane, and double-hung.

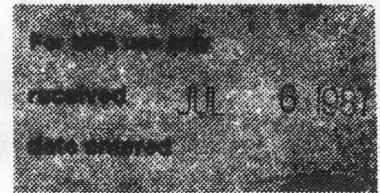
United States Department of the Interior
National Park ServiceNational Register of Historic Places
Inventory—Nomination Form

Continuation sheet

Item number June 1987

Page 4

AMENDMENT TO THE DALLAS COUNTY MRA: CHARLOTTE STREET HISTORIC DISTRICT

14. Talbot House - 801 Charlotte Street - 1915

This classic bungalow has an irregular plan with a side gable roof on the house and a front gable roof on the three-quarter porch. The porch supports are columns-on-piers. The house is covered with forest green weatherboard and the gable ends are covered with shingles. The windows are one-over-one double-hung and, again, the roof has exposed rafters and kneebraces.

15. 711 Charlotte Street - 1917 (NC)

Although it differs from the other bungalows on the street by the use of stick-work in both the front and side gable, this one-and-one-half-story house has several similarities. It is probable that, like the others of this period, it also has stucco in the gables, but the house has been covered with artificial siding. According to Sanborn maps, it has also had a wrap-around porch removed. The windows are nine-over-one double-hung and the roof has exposed rafters and kneebraces.

16. 709 Charlotte Street - c. 1940 (NC)

This simple one-story structure has shed additions on both sides. Although it is currently used as a residence, its original use is unknown. It is rectangular in plan, has a gable roof, and is covered with white weatherboard.

17. 701 Charlotte Street
House - c. 1935 (NC)

This two-story house with full basement is in the Colonial Revival style. Very simply detailed, it has a slightly recessed entryway with a two-story porch. There is no roof overhang and the house is covered with artificial siding.

17A. Garage with Apartment - c. 1920

The two-story garage and apartment dates as an ancillary of an earlier structure on this site which burned. The lower level is a garage or carriage house and the upper level is a living space. The apartment is accessed by an exterior staircase. The structure has a gable roof with kneebraces and is sided with narrow weatherboard.

18. D. C. Gates House - 609 Charlotte Street - 1921

Designed by Little Rock architects Sanders and Ginocchio, the Gates House has several exterior details which are very similar to those on other Charlotte Street residences. It is a white weatherboard structure with stucco and half-timbering in the gable. It also has kneebraces, exposed rafters, and a small gable roof over the front entry. The windows are six-over-one double-hung. The plan is rectangular, but has a small sunroom which projects from the front of the south side of the house. The bulk of the house is covered by a clipped gable with a slightly lower gable covering the front room. On the interior, the Gates House still contains many of its original fixtures. It also contains some fairly unique pine wall panelling, which Mr. Gates hand-picked so that it contains no knots.

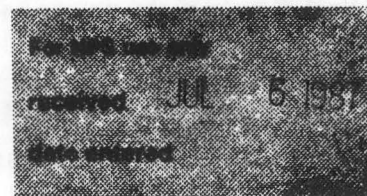
United States Department of the Interior
National Park ServiceNational Register of Historic Places
Inventory—Nomination Form

Continuation sheet

Item number June 1987

Page 5

AMENDMENT TO THE DALLAS COUNTY MRA: CHARLOTTE STREET HISTORIC DISTRICT
SIGNIFICANCE**SUMMARY**

With its Craftsman residences and the remnants of the estate of its developer, insurance magnate A. B. Banks, the Charlotte Street Historic District in Fordyce is representative both architecturally and historically of a boom period in the development of this small south Arkansas lumber town.

DISTRICT BOUNDARIES

The boundaries of the district were drawn to incorporate the area which best represents the neighborhood both architecturally and historically. The entire two blocks which was the estate of A. B. Banks are included, although the original Banks residence is no longer standing. Houses on Broadway and Meek across from the Banks estate were included in the district because they are representative of the period of significance and also because they are homes built for Banks' employees. On the northern edge of the district the boundary stops at Holmes Street because residences past that point retain little of the integrity displayed by the structures within the district. The eastern side of the 900 block of Charlotte Street was not included as three of the four houses there are of post-World War II construction, the only historic dwelling being the Russell House which was part of the original Dallas County MRA nomination. Although the two predominant dwellings on the west side of the 700 block have been designated non-contributing, that area does not detract greatly from the visual cohesiveness of the district because their non-contributing status is due solely to the fact that they are sheathed with artificial siding. The landscaping features such as trees and the low rock wall which help tie the neighborhood together are still present.

The Fordyce High School Building, constructed in 1918 and designed by Charles L. Thompson, and its associated buildings, fronted on 4th Street, from which one enters Charlotte Street. It was representative of the growth and development of the neighborhood during the period of significance; however, the school was demolished in May 1987 and only the associated structures remain.

ELABORATION

A. B. Banks moved to Fordyce in 1885, shortly after the railroad-initiated community had been incorporated as a town. He began selling life insurance, and in 1891 formed a local fire insurance agency. The formation of the Fordyce Lumber Company in 1888, and its subsequent growth, provided a market for the services Banks had to offer and he expanded into accident coverage, forming the Home Life and Accident insurance Company which was to provide the foundation for his financial power base.

In 1905 Banks purchased an acreage close to the city limits of Fordyce, and in 1906 the area was annexed to the city as the "A. B. Banks Addition." The central thoroughfare of the neighborhood Banks named after his wife, Charlotte, and five blocks on the east side of this street were not subdivided, being designed as the "A. B. Banks Park Reserve." The two southernmost blocks in the reserve Banks turned into his personal estate, and in 1910 he built a grand neoclassical home designed by noted Little Rock architect Charles L. Thompson. Although the house itself burned in 1964 and has been replaced by the 1970's residence of the present owners, the carriage house and gazebo remain from the original Banks estate, the landscaping and layout of which retain their integrity. 1920's aspects of the grounds, which testify to Banks'

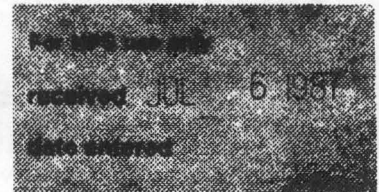
United States Department of the Interior
National Park ServiceNational Register of Historic Places
Inventory—Nomination Form

Continuation sheet

Item number

June 1987

Page 6

AMENDMENT TO THE DALLAS COUNTY MRA: CHARLOTTE STREET HISTORIC DISTRICT

affluence, include an inground swimming pool (reportedly the first in the state constructed for private use) and an unusual U-shaped pergola which was built for the wedding of Banks' daughter. An impressive brick fence, probably contemporary to the pool, and pergola, surrounds the entire estate.

The Craftsman residences which comprise the rest of the district, while much more modest than the Banks property, are significant in that they comprise the most cohesive historic neighborhood in Fordyce which reflects the World War I era growth of the city, both architecturally and historically.

After the construction of the Banks house, most of the earliest residences were built on the east side of Charlotte Street on lots which Banks carved out of the Park Reserve. Banks commissioned local contractor C. H. Kollman to build houses on the lots and then sold the property afterwards, often to one of his employees and usually providing the financing himself. Notable among this group is the Atkinson House (#6) with its distinctive "eyebrow" roofline.

The contributing structures on the west side of Charlotte Street were built between 1913 and 1930, with the majority being constructed during the late 'teens and early 'twenties. These are all (with one exception) variations of the bungalow and contribute to the district's integrity as a cohesive unit of vernacular Craftsman architecture. Banks himself reportedly had Kollman build the houses at 801 Charlotte (#14) and 711 Charlotte (#15) and probably some of the others. The D. C. Gates House (#18) is one of the most finely-crafted bungalows in the district, and was designed by Sanders and Ginocchio, associates of Charles Thompson. Gates was one of the original stockholders in the Fordyce Lumber Company and had materials hand-picked for construction of his home. Pine used for cabinets and panelling is of exceptional quality, virtually knot-free.

The late 'teens were good for lumber, when mills throughout southern Arkansas went full blast to meet the heavy demands of World War I and the early post-war period. Founded as a railroad town, Fordyce grew because of the timber industry, and the World War I era prosperity of the town is reflected in the development of the Charlotte Street Historic District. Fordyce Lumber Company was purchased by Georgia-Pacific Corporation in 1963, and none of the Banks family remains in the town, but the neighborhood serves as a reminder of the early development of Fordyce.

United States Department of the Interior
National Park Service

National Register of Historic Places
Inventory—Nomination Form

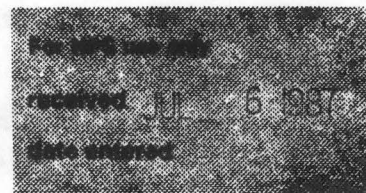

Continuation sheet

Item number

June 1987

Page

7

AMENDMENT TO THE DALLAS COUNTY MRA: CHARLOTTE STREET HISTORIC DISTRICT

BIBLIOGRAPHICAL REFERENCES

Arkansas Democrat, September 16, 1962.

Arkansas Gazette, articles on the following dates: February 11, 1982; March 20, 1920;
May 22, 1932; January 4, 1953.

Dallas County Tax Assessment Records, 1906-1935.

Fordyce Weekly News, articles on the following dates: December 15, 1932; July 18, 1940;
December 13, 1964.

Halphin, Kay. "Sears, Roebuck's Best-Kept Secret, "Historic Preservation, September/October 1981.

Interviews with: Mrs. Richard Banks, February 16, 1987; Mr. K. J. Caplinger, February 9, 1987;
Mrs. Sue Wynne Land, January 29, 1987; Thomas Sparks, February 17, 1987; Mr. & Mrs.
Gary Vaughan, January 29, 1987; Mrs. Phill Word, February 18, 1987.

Sanborn Fire Insurance Maps, 1912, 1917, 1925, with 1946 update.

Schwartz, David M. "When Home Sweet Home Was Just a Mailbox Away," Smithsonian,
November 1985.

Smith, Kenneth L. Sawmill: The Story of Cutting the Last Great Virgin Forest East of
the Rockies. Fayetteville: University of Arkansas, 1986.

Stevenson, Katherine Cole and Jandl, H. Ward. Houses By Mail. Washington, D.C.: The
Preservation Press, 1986.

"Yellow Pine Sextet," promotional publication from Fordyce Lumber Company, c. 1940.

United States Department of the Interior
National Park Service

**National Register of Historic Places
Inventory—Nomination Form**

Charlotte St. Historic District

Fordyce

Dallas Co. MRA Amendment

Item number 10

Continuation sheet

Page 8

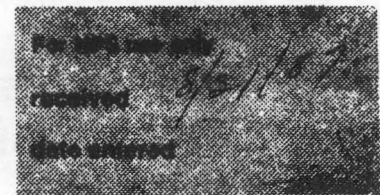

10. GEOGRAPHICAL DATA

Acreage of nominated property- 15.5 acres

Quadrangle Name- Fordyce, Arkansas

Quadrangle Scale- 1:24000

UTM References-

A 15/554745/3741690
C 15/554700/3741760
E 15/554750/3742110
G 15/554810/3741999
I 15/554900/3741830
K 15/554950/3741780

B 15/554745/3741760
D 15/554710/3742110
F 15/554745/3741999
H 15/554800/3741830
J 15/554900/3741780
L 15/554950/3741680

Verbal Boundary Description and Justification-

The Charlotte Street Historic District is located in Fordyce, Dallas County, Arkansas. Specifically beginning at the intersection of Charlotte, East Fourth, and East College Streets, proceed north 165 feet on Charlotte Street, then proceed north 1200 feet to Holmes Street. Proceed east 110 feet on Holmes to Charlotte Street, then proceed south 335 feet on Charlotte to Smith Street. Proceed east 115 feet on Smith, then proceed south 380 feet, then proceed east 305 feet, then proceed south 165 feet on Broadway to Jackson Street, then proceed 300 feet south on Jackson to East College Street. Proceed west on East College to the corner of East Fourth and Charlotte Streets and the point of beginning.

United States Department of the Interior
National Park Service

National Register of Historic Places
Inventory—Nomination Form

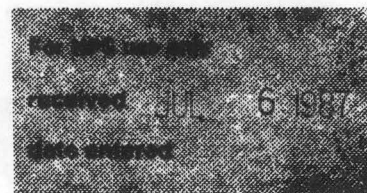

Continuation sheet

Item number

June 1987

Page 9

AMENDMENT TO THE DALLAS COUNTY MRA: CHARLOTTE STREET HISTORIC DISTRICT

PROPERTY

OWNER

- | | |
|--|--|
| 1. 600 Charlotte Street
Fordyce, Dallas County | Ms. Sue Wynne Land
600 Charlotte Street
Fordyce, AR 71742 |
| 2. 700 Meek Street
Fordyce, Dallas County | Mr. & Mrs. Elmer Lane
700 Meek Street
Fordyce, AR 71742 |
| 3. 510 Broadway
Fordyce, Dallas County | Mr. & Mrs. Jack Christie
510 Broadway
Fordyce, AR 71742 |
| 4. 506 Broadway Street
Fordyce, Dallas County | Reverend & Mrs. Rufus Sorrells
506 Broadway Street
Fordyce, AR 71742 |
| 5. 700 Charlotte Street
Fordyce, Dallas County | Mrs. Leroy Turner
700 Charlotte Street
Fordyce, AR 71742 |
| 6. 710 Charlotte Street
Fordyce, Dallas County | Mr. & Mrs. Tommy Mays
710 Charlotte Street
Fordyce, AR 71742 |
| 7. 802 Charlotte Street
Fordyce, Dallas County | Mr. & Mrs. K. J. Caplinger
802 Charlotte Street
Fordyce, AR 71742 |
| 8. 808 Charlotte Street
Fordyce, Dallas County | Mr. & Mrs. Richard Rogers
808 Charlotte Street
Fordyce, AR 71742 |
| 9. 911 Charlotte Street
Fordyce, Dallas County | Mr. & Mrs. A. J. Doss
811 Charlotte Street
Fordyce, AR 71742 |
| 10. 901 Charlotte Street
Fordyce, Dallas County | Mr. Dean Kilgore
901 Charlotte Street
Fordyce, AR 71742 |
| 11. 811 Charlotte Street
Fordyce, Dallas County | Mr. & Mrs. Phill Word
811 Charlotte Street
Fordyce, AR 71742 |

United States Department of the Interior
National Park Service

**National Register of Historic Places
Inventory—Nomination Form**

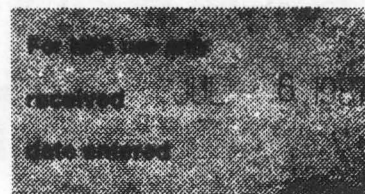

Continuation sheet

Item number June 1987

Page 10

AMENDMENT TO THE DALLAS COUNTY MRA: CHARLOTTE STREET HISTORIC DISTRICT

PROPERTY

OWNER

12. 809 Charlotte Street
Fordyce, Dallas County

Mrs. Ellen Vineyard
502 Overstreet
Fordyce, AR 71742

13. 807 Charlotte Street
Fordyce, Dallas County

Mr. & Mrs. Jerry Bush
807 Charlotte Street
Fordyce, AR 71742

14. 801 Charlotte Street
Fordyce, Dallas County

Mr. & Mrs. Claud Deaton
801 Charlotte Street
Fordyce, AR 71742

15. 711 Charlotte Street
Fordyce, Dallas County

Mr. & Mrs. Olin Ripley
711 Charlotte Street
Fordyce, AR 71742

16. 709 Charlotte Street
Fordyce, Dallas County

Mr. Eugene Heatherly
Heatherly Electric
1208 Moro Street
Fordyce, AR 71742

17. 701 Charlotte Street
Fordyce, Dallas County

Mr. Homer Cannon
701 Charlotte Street
Fordyce, AR 71742

18. 609 Charlotte Street
Fordyce, Dallas County

Mr. & Mrs. Gary Vaughn
609 Charlotte Street
Fordyce, AR 71742

**United States Department of the Interior
National Park Service**

**National Register of Historic Places
Inventory—Nomination Form**

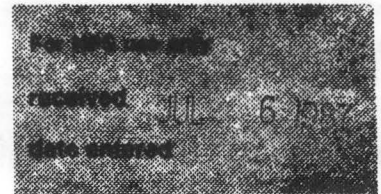

Continuation sheet

Item number June 1987

Page 11

AMENDMENT TO THE DALLAS COUNTY MRA: CHARLOTTE STREET HISTORIC DISTRICT

1. A. B. Banks Estate
 - 1.A) Carriage House - Contributing
 - 1.B) Gazebo - Contributing
 - 1.C) Pergola - Contributing
 - 1.D) Swimming Pool - Contributing
 - 1.E) Wynne-Land House - Non-Contributing
 - 1.F) Fence - Contributing
2. Langley House - 700 Meek Street - Contributing
3. 510 Broadway - Contributing
4. 506 Broadway - Contributing
5. Kenneson House - 700 Charlotte Street - Contributing
6. Atkinson House - 710 Charlotte Street - Contributing
7. Hampton House - 802 Charlotte Street - Contributing
8. 808 Charlotte Street - Contributing
9. 911 Charlotte Street - Contributing
10. 901 Charlotte Street - Contributing
11. 811 Charlotte Street - Contributing
12. 809 Charlotte Street - Non-Contributing
13. 807 Charlotte Street - Contributing
14. Talbot House - 801 Charlotte Street - Contributing
15. 711 Charlotte Street - Non-Contributing
16. 709 Charlotte Street - Non-Contributing
17. House - 701 Charlotte Street - Non-Contributing
- 17.A) Garage with Apartment - 701 Charlotte Street - Contributing
18. D. C. Gates House - 609 Charlotte Street - Contributing

United States Department of the Interior
National Park Service

National Register of Historic Places
Inventory—Nomination Form

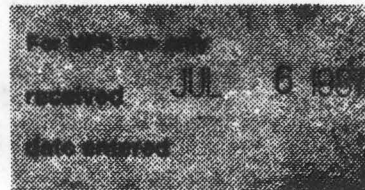

Continuation sheet

Item number June 1987

Page 12

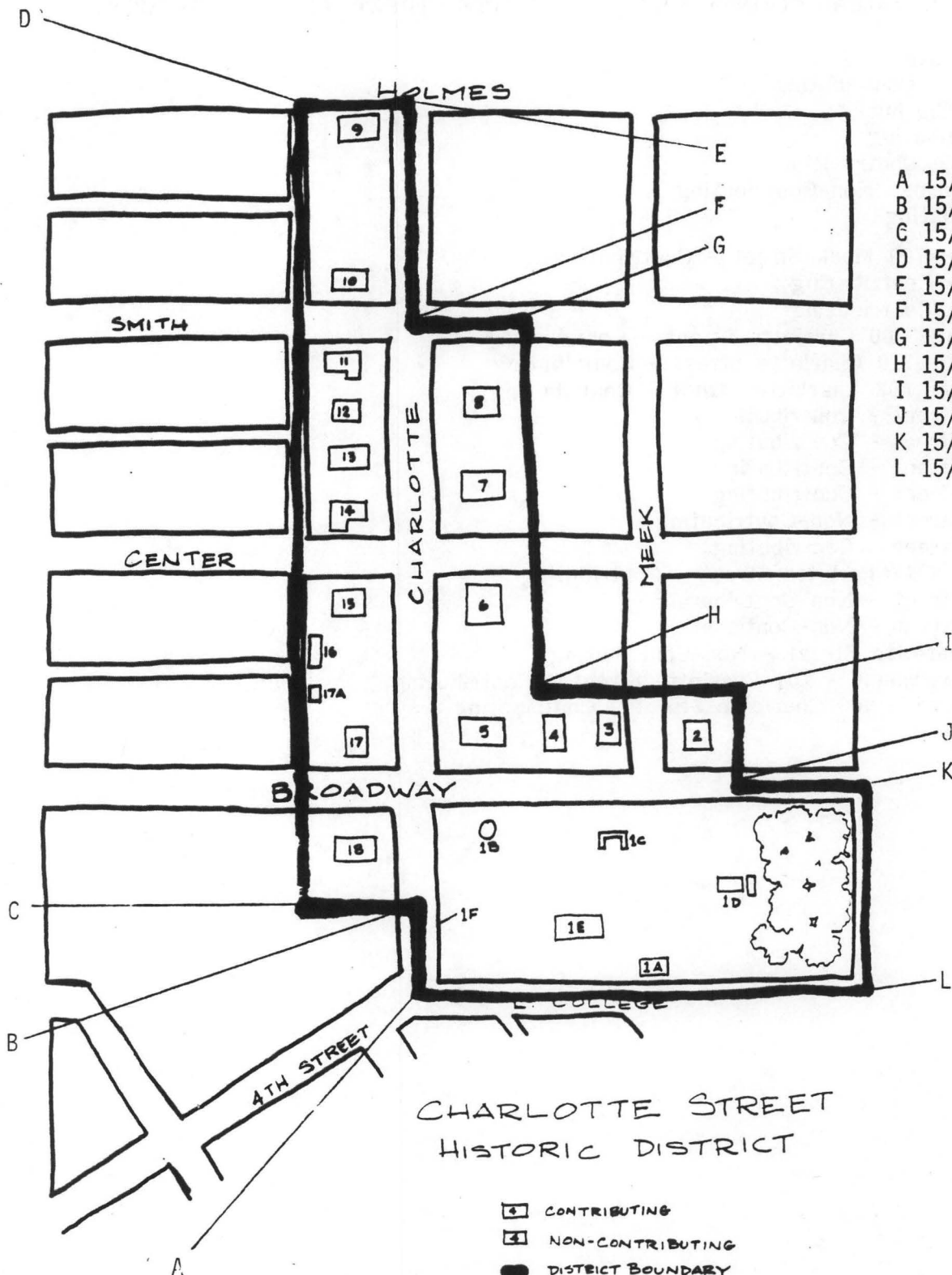

UTM

- A 15/554745/3741690
- B 15/554745/3741760
- C 15/554700/3741760
- D 15/554710/3742110
- E 15/554750/3742110
- F 15/554745/3741999
- G 15/554810/3741999
- H 15/554800/3741830
- I 15/554900/3741830
- J 15/554900/3741780
- K 15/554950/3741780
- L 15/554950/3741680

United States Department of the Interior
National Park Service

National Register of Historic Places Inventory—Nomination Form



Continuation sheet

Item number June 1987

Page 13

AMENDMENT TO THE DALLAS COUNTY MRA: CHARLOTTE STREET HISTORIC DISTRICT

12. State Historic Preservation Officer Certification

The evaluated significance of this property within the state is:

___ national ___ state X local

As the designated State Historic Preservation Officer for the National Historic Preservation Act of 1966 (Public Law 89-665), I hereby nominate this property for inclusion in the National Register and certify that it has been evaluated according to the criteria and procedures set forth by the National Park Service.

State Historic Preservation Officer signature

William J. Stiles

title State Historic Preservation Officer

date

For NPS use only

I hereby certify that this property is included in the National Register

date

Keeper of the National Register

Attest:

date

Chief of Registration

United States Department of the Interior
National Park Service

National Register of Historic Places
Inventory—Nomination Form

For NPS use only
received 9/14/83
date entered

Continuation sheet

Item number

Page 3 of 3

Multiple Resource Area
Thematic Group

Name Dallas County Multiple Resource Area
State Arkansas

Nomination/Type of Review

Date/Signature

21. Princeton Methodist Church

Keeper

Bob Grosvenor 10/28/83

Attest

22. Rock Island Railway Depot

Entered in the
National Register

for Keeper

Helene Byers 10/28/83

Attest

23. Russell, John, House

Entered in the
National Register

for Keeper

Helene Byers 10/28/83

Attest

24. Sardis Methodist Church

Entered in the
National Register

for Keeper

Helene Byers 10/28/83

Attest

25. Smith, Jessie B., House

Entered in the
National Register

for Keeper

Helene Byers 10/28/83

Attest

26. Thomas Homestead

Entered in the
National Register

Keeper

Helene Byers 3/27/84

Attest

27. Tulip Cemetery

Substantive Review

Keeper

Bob Grosvenor 10/28/83

Attest

28. Wynne House

Entered in the
National Register

for Keeper

Helene Byers 10/28/83

Attest

29. Charlotte Street Historic
District

Entered in the
National Register

for Keeper

Helene Byers 9/14/87

Attest

30.

Keeper

Attest

87001348

NATIONAL REGISTER OF HISTORIC PLACES
EVALUATION/RETURN SHEET

Charlotte Street Historic District (Dallas
County MRA)
Dallas County
ARKANSAS

Working No. 1746-87

Fed. Reg. Date: 2/2/88

Date Due: 10/15/87

Action: ☒ ACCEPT 9-14-87

☐ RETURN

☐ REJECT

Federal Agency: _____

- ☒ resubmission
☐ nomination by person or local government
☐ owner objection
☐ appeal

Substantive Review: ☐ sample ☐ request ☐ appeal ☐ NR decision

Reviewer's comments:

Recom./Criteria _____

Reviewer _____

Discipline _____

Date _____

_____ see continuation sheet

Nomination returned for: _____ technical corrections cited below
_____ substantive reasons discussed below

1. Name

2. Location

3. Classification

Category	Ownership	Status	Present Use
	Public Acquisition	Accessible	

4. Owner of Property

5. Location of Legal Description

6. Representation in Existing Surveys

Has this property been determined eligible? ☐ yes ☐ no

7. Description

Condition

- ☐ excellent
☐ good
☐ fair

- ☐ deteriorated
☐ ruins
☐ unexposed

Check one

- ☐ unaltered
☐ altered

Check one

- ☐ original site
☐ moved date _____

Describe the present and original (if known) physical appearance

- ☐ summary paragraph
☐ completeness
☐ clarity
☐ alterations/integrity
☐ dates
☐ boundary selection

8. Significance

Period Areas of Significance—Check and justify below

Specific dates

Builder/Architect

Statement of Significance (*in one paragraph*)

- ☐ summary paragraph
- ☐ completeness
- ☐ clarity
- ☐ applicable criteria
- ☐ justification of areas checked
- ☐ relating significance to the resource
- ☐ context
- ☐ relationship of integrity to significance
- ☐ justification of exception
- ☐ other

9. Major Bibliographical References

10. Geographical Data

Acreage of nominated property _____

Quadrangle name _____

UTM References _____

Verbal boundary description and justification _____

11. Form Prepared By

12. State Historic Preservation Officer Certification

The evaluated significance of this property within the state is:

_____ national _____ state _____ local

State Historic Preservation Officer signature

title

date

13. Other

- ☐ Maps
- ☐ Photographs
- ☐ Other

Questions concerning this nomination may be directed to _____

Signed _____ Date _____ Phone: _____

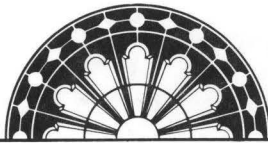

Resubm.

ARKANSAS
HISTORIC
PRESERVATION
PROGRAM

August 25, 1987

Ms. Carol D. Shull
Chief of Registration
U.S. Department of the Interior
National Register of Historic Places
National Park Service
1100 "L" Street, NW
Washington, D.C. 20240

RE: Charlotte Street Historic District
Amendment to the Dallas County Multiple Resource Area
Fordyce, Dallas County

Dear Carol:

Enclosed is the nomination for the Charlotte Street Historic District, which was returned to us for technical correction. We have indicated the total acreage for the district on a continuation sheet.

Thank you for your consideration in this matter.

Sincerely,

Wilson Stiles
State Historic Preservation Officer

WS/TJ/dr

Enclosure



AUG 31 1987



Charlotte Street Historic District
Fordyce, Dallas County
Amendment to the Dallas County MRA
Photographed by Madden and Vosmik
February 1987
Negatives on file at AHPP
700 block, facing south



Charlotte Street Historic District
Fordyce, Dallas County
Amendment to Dallas County MRA
Photographed by Madden and Vosmik
February 1987
Negatives on file at AHPP
800 block facing south



1A Carriage House
Charlotte Street Historic District
Fordyce, Dallas County
Amendment to Dallas County MRA
Photographed by Madden & Vosmik
February 1987
Negatives on file at the AHPP



1B Gazebo

Charlotte Street Historic District

Fordyce, Dallas County

Amendment to Dallas County MRA

Photographed by Madden & Vosmik

February 1987

Negatives on file at the AHPP



1C Pergola

Charlotte Street Historic District

Fordyce, Dallas County

Amendment to Dallas County MRA

Photographed by Madden & Vosmik

February 1987

Negatives on file at the AHPP



1C Pergola

Charlotte Street Historic District

Fordyce, Dallas County

Amendment to Dallas County MRA

Photographed by Madden & Vosmik

February 1987

Negatives on file at the AHPP



1D Swimming Pool
Charlotte Street Historic District
Fordyce, Dallas County
Amendment to Dallas County MRA
Photographed by Madden & Vosmik
February 1987
Negatives on file at the AHPP



1 E. Wynne-Land House (NC)
Charlotte Street Historic District
Fordyce, Dallas County
Amendment to Dallas County MRA
Photographed by Madden and Vosmik
March 1987
Negatives on file at AHPP



1 F. Fence
Charlotte Street Historic District
Fordyce, Dallas County
Amendment to Dallas County MRA
Photographed by Madden and Vosmik
March 1987
Negatives on file at AHPP



2. Langley House

Charlotte Street Historic District

Fordyce, Dallas County

Amendment to Dallas County MRA

Photographed by Madden & Vosmik

March 1987

JUL 6 1987

Negatives on file at AHPP



3. 510 Broadway

Charlotte Street Historic District

Fordyce, Dallas County

Amendment to Dallas County MRA

Photographed by Madden & Vosmik

February 1987

Negatives on file at the AHPP



4. 506 Broadway

Charlotte Street Historic District

Fordyce, Dallas County

Amendment to Dallas County MRA

Photographed by Madden & Vosmik

February 1987

Negatives on file at the AHPP



5. Kenneson House - 700 Charlotte Street
Charlotte Street Historic District
Fordyce, Dallas County
Amendment to Dallas County MRA
Photographed by Madden & Vosmik
February 1987
Negatives on file at the AHPP

JUL 6 1987



6. Atkinson House - 710 Charlotte Street
Charlotte Street Historic District
Fordyce, Dallas County
Amendment to Dallas County MRA
Photographed by Madden & Vosmik
February 1987
Negatives on file at the AHPP

JUL 6 1987



7. Hampton House - 802 Charlotte Street
Charlotte Street Historic District
Fordyce, Dallas County
Amendment to Dallas County MRA
Photographed by Madden & Vosmik
February 1987
Negatives on file at the AHPP



8. 808 Charlotte Street
Charlotte Street Historic District
Fordyce, Dallas County
Amendment to Dallas County MRA
Photographed by Madden & Vosmik
February 1987
Negatives on file at the AHPP

JUL 6 1987



9. 911 Charlotte

Charlotte Street Historic District

Fordyce, Dallas County

Amendment to Dallas County MRA

Photographed by Madden & Vosmik

February 1987

Negatives on file at the AHPP



10. 901 Charlotte

Charlotte Street Historic District

Fordyce, Dallas County

Amendment to Dallas County MRA

Photographed by Madden & Vosmik

February 1987

Negatives on file at the AHPP

JUL 6 1987



11. 811 Charlotte

Charlotte Street Historic District

Fordyce, Dallas County

Amendment to Dallas County MRA

Photographed by Madden & Vosmik

February 1987

Negatives on file at the AHPP



12.809 Charlotte (NC)

Charlotte Street Historic District

Fordyce, Dallas County

Amendment to Dallas County MRA

Photographed by Madden & Vosmik

February 1987

Negatives on file at the AHPP



13. 807 Charlotte

Charlotte Street Historic District

Fordyce, Dallas County

Amendment to Dallas County MRA

Photographed by Madden & Vosmik

February 1987

Negatives on file at the AHPP



14. Talbot House - 801 Charlotte
Charlotte Street Historic District
Fordyce, Dallas County
Amendment to Dallas County MRA
Photographed by Madden & Vosmik
February 1987
Negatives on file at the AHPP

JUL 6 1987



15. 711 Charlotte (NC)

Charlotte Street Historic District

Fordyce, Dallas County

Amendment to Dallas County MRA

Photographed by Madden & Vosmik

February 1987

Negatives on file at the AHPP



16. 709 Charlotte (NC)

Charlotte Street Historic District

Fordyce, Dallas County

Amendment to Dallas County MRA

Photographed by Madden & Vosmik

February 1987

Negatives on file at the AHPP



17. 701 Charlotte (NC)

Charlotte Street Historic District

Fordyce, Dallas County

Amendment to Dallas County MRA

Photographed by Madden & Vosmik

February 1987

Negatives on file at the AHPP



17 A. Garage to 701 Charlotte
Charlotte Street Historic District
Fordyce, Dallas County
Amendment to Dallas County MRA
Photographed by Madden & Vosmik
February 1987
Negatives on file at the AHPP



18. D. C. Gates House - 609 Charlotte
Charlotte Street Historic District
Fordyce, Dallas County
Amendment to Dallas County MRA
Photographed by Madden & Vosmik
February 1987
Negatives on file at the AHPP

JUL 6 1987

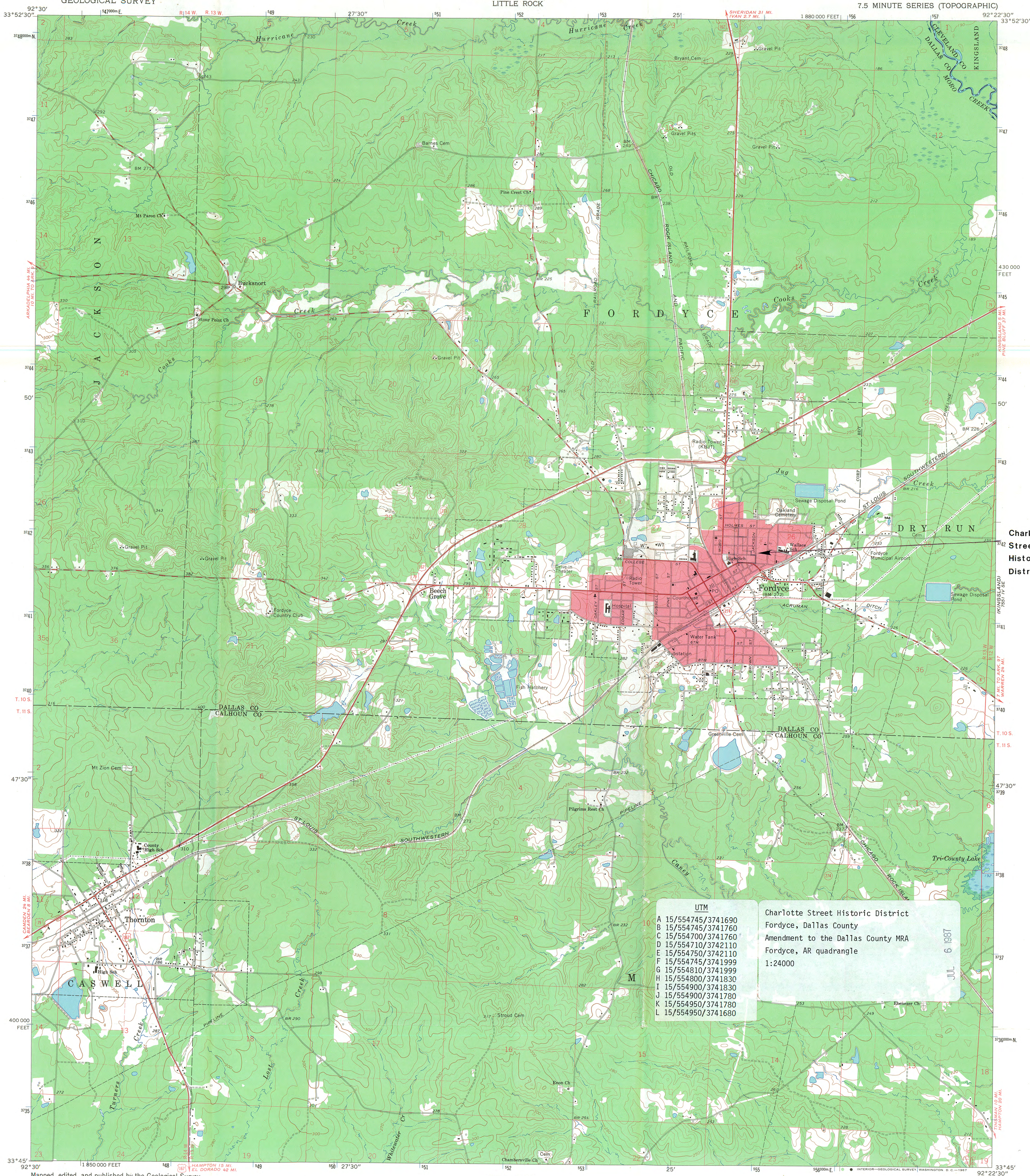

Mapped, edited, and published by the Geological Survey
Control by USGS and USC&GS
Topography by photogrammetric methods from aerial
photographs taken 1965. Field checked 1966
Polyconic projection. 1927 North American datum
10,000-foot grid based on Arkansas coordinate system, south zone
1000-meter Universal Transverse Mercator grid ticks,
zone 15, shown in blue
Red tint indicates area in which only landmark buildings are shown
Fine red dashed lines indicate selected fence and field lines where
generally visible on aerial photographs. This information is unchecked

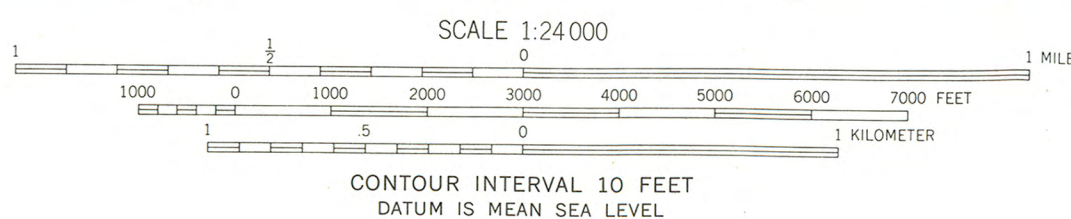
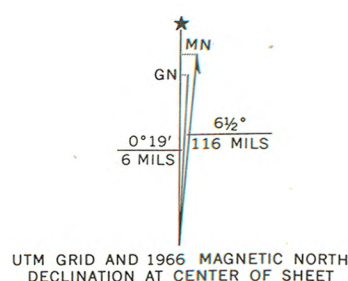

THIS MAP COMPLIES WITH NATIONAL MAP ACCURACY STANDARDS
FOR SALE BY U. S. GEOLOGICAL SURVEY, DENVER, COLORADO 80225, OR WASHINGTON, D. C. 20242
AND BY THE ARKANSAS GEOLOGICAL COMMISSION, LITTLE ROCK, ARKANSAS 72201
A FOLDER DESCRIBING TOPOGRAPHIC MAPS AND SYMBOLS IS AVAILABLE ON REQUEST



ROAD CLASSIFICATION
Heavy-duty ——— Light-duty ———
Medium-duty ——— Unimproved dirt ———
U. S. Route ——— State Route ———

FORDYCE, ARK.
N3345—W9222.5/7.5
1966
AMS 7551 IV SW—SERIES V884