

United States Department of the Interior  
National Park Service

ORIGINAL  
RECEIVED

National Register of Historic Places  
Registration Form

MAY 18 2000

663

This form is for use in nominating or requesting determinations for individual properties and districts. See instructions in *How to Complete the National Register of Historic Places Registration Form* (National Register Bulletin 16A). Complete each item by marking "x" in the appropriate box or by entering the information requested. If an item does not apply to the property being documented, enter "N/A" for "not applicable." For functions, architectural classification, materials, and areas of significance, enter only categories and subcategories from the instructions. Place additional entries and narrative items on continuation sheets (NPS Form 10-900a). Use a typewriter, word processor, or computer, to complete all items.

1. Name of Property

historic name Puunene School

other names/site number \_\_\_\_\_

2. Location

street & number \_\_\_\_\_  not for publication

city or town Puunene  vicinity

state Hawaii code HI county Maui code 009 zip code 96784

3. State/Federal Agency Certification

As the designated authority under the National Historic Preservation Act, as amended, I hereby certify that this  nomination  request for determination of eligibility meets the documentation standards for registering properties in the National Register of Historic Places and meets the procedural and professional requirements set forth in 36 CFR Part 60. In my opinion, the property  meets  does not meet the National Register criteria. I recommend that this property be considered significant  nationally  statewide  locally. ( See continuation sheet for additional comments.)

[Signature] Deputy SPS 5/15/00  
Signature of certifying official/Title Date

STATE HISTORIC PRESERVATION OFFICE  
State of Federal agency and bureau

In my opinion, the property  meets  does not meet the National Register criteria. ( See continuation sheet for additional comments.)

\_\_\_\_\_  
Signature of certifying official/Title Date

\_\_\_\_\_  
State or Federal agency and bureau

4. National Park Service Certification

- I hereby certify that the property is:
- entered in the National Register.  
 See continuation sheet.
  - determined eligible for the National Register  
 See continuation sheet.
  - determined not eligible for the National Register.
  - removed from the National Register.
  - other, (explain:)

(for) Signature of the Keeper Harold D. Bipe Date of Action 8/22/00

\_\_\_\_\_  
\_\_\_\_\_  
\_\_\_\_\_

Name of Property

County and State

5. Classification

Ownership of Property

(Check as many boxes as apply)

- private
- public-local
- public-State
- public-Federal

Category of Property

(Check only one box)

- building(s)
- district
- site
- structure
- object

Number of Resources within Property

(Do not include previously listed resources in the count.)

Contributing	Noncontributing	
1		buildings
0		sites
0		structures
0		objects
1		Total

Name of related multiple property listing

(Enter "N/A" if property is not part of a multiple property listing.)

Maui Public Schools

Number of contributing resources previously listed in the National Register

0

6. Function or Use

Historic Functions

(Enter categories from instructions)

EDUCATION/ School

Current Functions

(Enter categories from instructions)

EDUCATION/ School

7. Description

Architectural Classification

(Enter categories from instructions)

Classical Revival

Materials

(Enter categories from instructions)

foundation concrete

walls concrete

roof asphalt shingles

other

Narrative Description

(Describe the historic and current condition of the property on one or more continuation sheets.)

**8. Statement of Significance**

**Applicable National Register Criteria**

(Mark "x" in one or more boxes for the criteria qualifying the property for National Register listing.)

- A** Property is associated with events that have made a significant contribution to the broad patterns of our history.
- B** Property is associated with the lives of persons significant in our past.
- C** Property embodies the distinctive characteristics of a type, period, or method of construction or represents the work of a master, or possesses high artistic values, or represents a significant and distinguishable entity whose components lack individual distinction.
- D** Property has yielded, or is likely to yield, information important in prehistory or history.

**Criteria Considerations**

(Mark "x" in all the boxes that apply.)

Property is:

- A** owned by a religious institution or used for religious purposes.
- B** removed from its original location.
- C** a birthplace or grave.
- D** a cemetery.
- E** a reconstructed building, object, or structure.
- F** a commemorative property.
- G** less than 50 years of age or achieved significance within the past 50 years.

**Areas of Significance**

(Enter categories from instructions)

Architecture

Education

**Period of Significance**

1922

**Significant Dates**

1922

**Significant Person**

(Complete if Criterion B is marked above)

**Cultural Affiliation**

**Architect/Builder**

Unknown

**Narrative Statement of Significance**

(Explain the significance of the property on one or more continuation sheets.)

**9. Major Bibliographical References**

**Bibliography**

(Cite the books, articles, and other sources used in preparing this form on one or more continuation sheets.)

**Previous documentation on file (NPS):**

- preliminary determination of individual listing (36 CFR 67) has been requested
- previously listed in the National Register
- previously determined eligible by the National Register
- designated a National Historic Landmark
- recorded by Historic American Buildings Survey # \_\_\_\_\_
- recorded by Historic American Engineering Record # \_\_\_\_\_

**Primary location of additional data:**

- State Historic Preservation Office
- Other State agency
- Federal agency
- Local government
- University
- Other

Name of repository:

\_\_\_\_\_

Puunene School  
Name of Property

Maui, Hawaii  
County and State

### 10. Geographical Data

Acreage of Property 10.9 acres

#### UTM References

(Place additional UTM references on a continuation sheet.)

1	04	765245	2309380
Zone	Easting	Northing	
2	04	765250	2309380

3	04	765100	2309240
Zone	Easting	Northing	
4	04	765030	2309150

See continuation sheet

#### Verbal Boundary Description

(Describe the boundaries of the property on a continuation sheet.)

#### Boundary Justification

(Explain why the boundaries were selected on a continuation sheet.)

### 11. Form Prepared By

name/title Daina Penkiunas / Architectural Historian

organization State Historic Preservation Division date February 24, 1992

street & number 33 S. King St., 6th floor telephone 808-587-0047

city or town Honolulu state HI zip code 96813

#### Additional Documentation

Submit the following items with the completed form:

#### Continuation Sheets

#### Maps

A **USGS map** (7.5 or 15 minute series) indicating the property's location.

A **Sketch map** for historic districts and properties having large acreage or numerous resources.

#### Photographs

Representative **black and white photographs** of the property.

#### Additional items

(Check with the SHPO or FPO for any additional items)

#### Property Owner

(Complete this item at the request of SHPO or FPO.)

name State of Hawaii, Department of Education

street & number PO Box 2360 telephone 808-737-4743

city or town Honolulu state HI zip code 96804

**Paperwork Reduction Act Statement:** This information is being collected for applications to the National Register of Historic Places to nominate properties for listing or determine eligibility for listing, to list properties, and to amend existing listings. Response to this request is required to obtain a benefit in accordance with the National Historic Preservation Act, as amended (16 U.S.C. 470 et seq.).

**Estimated Burden Statement:** Public reporting burden for this form is estimated to average 18.1 hours per response including time for reviewing instructions, gathering and maintaining data, and completing and reviewing the form. Direct comments regarding this burden estimate or any aspect of this form to the Chief, Administrative Services Division, National Park Service, P.O. Box 37127, Washington, DC 20013-7127; and the Office of Management and Budget, Paperwork Reductions Projects (1024-0018), Washington, DC 20503.

United States Department of the Interior  
National Park Service

# National Register of Historic Places Continuation Sheet

Section number 7 Page 1

---

The former Puunene School at present serves as a county educational resource center and sits in the midst of sugar fields. When the two story concrete building was constructed in 1922, it was in the heart of a thriving plantation community.

The school is entered by a short flight of steps which lead to a small portico supported by two free standing Tuscan columns. The large bays of all the elevations are divided by pilasters. The corner pilaster wraps around the facade to the side elevation. The front facade rhythm is A/A/B/C/B/A/A. The A bays have three double windows per floor. The B bay has two narrow ones. The C bay corresponds to the portico. Above the portico are four narrow windows.

In 1922, the new \$60,000 school replaced a series of wooden buildings, located further makai from the present school building. The concrete structure had nineteen classrooms located on two floors, as well as two school offices. It was also noted at the time of its construction that it was to contain two indoor lavatories. The rooms are arranged on either side of a central corridor. From the portico one enters an entry lobby which has doors to the offices on either side and contains a centrally placed staircase. The staircase rises almost its full height before dividing at right angles into two separate stairs opening on to the second story corridor. The original room configurations have been altered; several partitions have been removed to allow for greater open spaces. Many of the classrooms originally had large wooden folding doors between them which allowed for joining of rooms for assemblies. All of these wooden doors have been removed. The original five panel classroom doors remain. The classrooms all had clerestory ventilation opening onto the hallway.

All of the original windows have been removed and replaced with jalousies. A concrete fire stair has been added to both ends of the building, partially obscuring the exterior pilasters.

Located on the school grounds are a number of wood buildings which are not included in the nomination. Directly behind the school is a shed with multiple drinking fountains over a trough, a feature commonly found at older schools.

**United States Department of the Interior  
National Park Service**

**National Register of Historic Places  
Continuation Sheet**

Section number 8 Page 1

---

The Puunene School is significant as a surviving architectural school type and for its role in the history of education in Maui.

The 1922 concrete construction building replaced the earlier Puunene school which had been housed in a series of wooden buildings. The ten acre site for the new school was donated by Hawaiian Commercial and Sugar Company. In June of 1922, the contract for construction was awarded to E.C. Mellor, with \$60,000 allocated for the building's construction. Newspaper accounts indicate that a county engineer prepared the floor plans and designed the "plain and utilitarian" exterior.

The Puunene area was growing rapidly in the first quarter of the century. According to a newspaper account of 1913, the old school at Puunene housed 350 students in four rooms. After the new school was built, enrollment continued to grow and Puunene became the largest elementary school on Maui with an enrollment of about 1000 students in grades one through eight from nearby communities.

In the 1950s the Puunene area went into decline as many families moved to Kahului. With the decrease in resident students, other educational functions were transferred to Punnene. In the 1950s and 1960s classes for the moderately retarded and emotionally handicapped students were housed on the Puunene campus. In 1979, the number of pupils had declined significantly; the K-6 enrollment numbered 67, and special education classes had 49 students. With the continuing decline in student numbers, the school assumed a new role as a Department of Education resouce center.

**United States Department of the Interior  
National Park Service**

**National Register of Historic Places  
Continuation Sheet**

Section number 9, 10 Page 1

---

9. Bibliography:

Maui News

---

10. Verbal Boundary Description:

This nomination includes all of the land owned by the Hawaii State Department of Education in 1992 located in TMK: 3-8-06: 08.

Boundary Justification:

This is the property historically associated with the school.

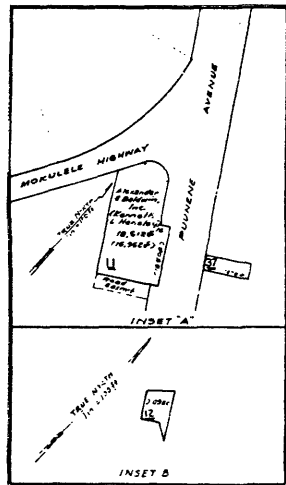
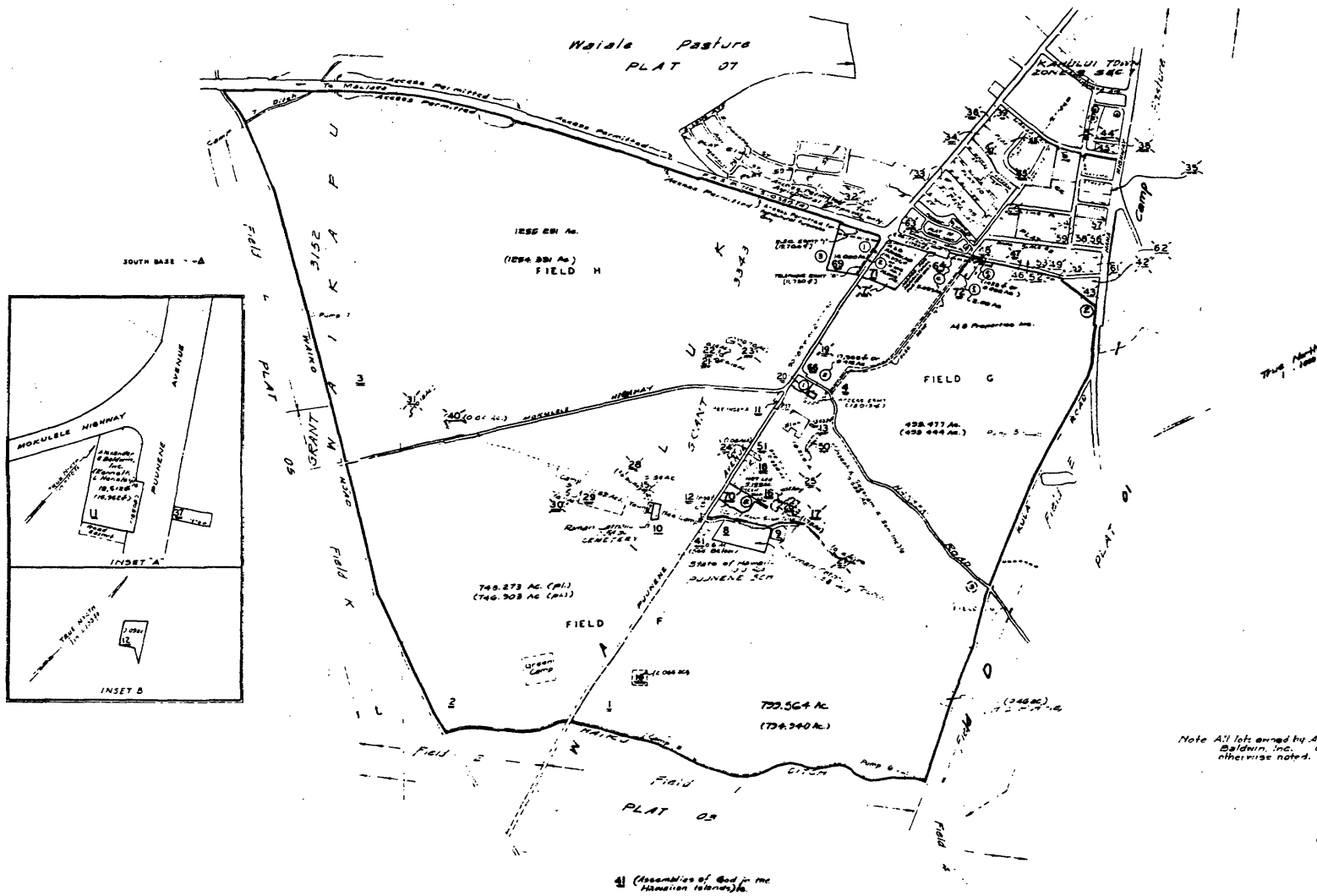

- 51 Corciano P. Salazar, Casiano T. Pineda, 1025 W. Amos, Casiano Tagalec 1/2
- 18 Catholic Church, Church of the Gospel of Jesus Christ 1/2

Note: All lots owned by Alexander & Baldwin, Inc. unless otherwise noted.

728,7  
 2,745,242,639  
 2,745,242,639  
 Parcels Dropped: 35,192,433,40  
 689,448 26,271,046,134  
 2,745,242,639

TERRITORY OF HAWAII		
TAX MAP		
SECOND DISTRICT		
ZONE	SEC.	PLAT
3	8	06
CONTAINING PARCELS		
SCALE: 1 in = 1000 ft		

41 (Assemblies of God in the Hawaiian Islands) 1/2

By Order of the Board of Tax Assessors  
 2 450  
 FOR WAIKAPU - WAILUKU, MAUI

2 450

FOR WAIKAPU - WAILUKU, MAUI

SUBJECT TO CHANGE



**United States Department of the Interior  
National Park Service**

**National Register of Historic Places  
Continuation Sheet**

Section number \_\_\_\_\_ Page \_\_\_\_\_

---

**SUPPLEMENTARY LISTING RECORD**

**NRIS Reference Number: 00000663**

**Date Listed: 08/22/00**

**Property Name: Puunene School**

**County: Maui**

**State: HI**

**Multiple Name: Maui Public Schools MPS**

-----  
This property is listed in the National Register of Historic Places in accordance with the attached nomination documentation subject to the following exceptions, exclusions, or amendments, notwithstanding the National Park Service certification included in the nomination documentation.

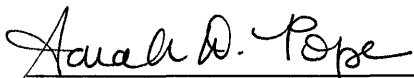

08/22/00

**Signature of the Keeper**

**Date of Action**

=====

**Amended Items in Nomination:**

The following amendments are hereby made to the documentation and confirmed with the HI SHPO:

Section 2: Location

A more specific address is: Jct. of Puunene Ave. and Mokulele Hwy.

Section 3: State/Federal Agency Certification

A level of significance has not been marked. The level of significance is local.

Section 8: Statement of Significance

The Period of Significance should be extended to incorporate the building's on-going use as a school. The Period of Significance is changed to 1922-1950, reflecting the 50 year cut-off date.

Photographs

The photographs date from 1994. The Hawaii SHPO confirmed that the property has not been altered since 1994, is in the same condition.

**DISTRIBUTION: National Register property file; Nominating Authority**