

PH0011020

NATIONAL REGISTER OF HISTORIC PLACES  
INVENTORY - NOMINATION FORM

(Type all entries - complete applicable sections)

STATE: Delaware	
COUNTY: Kent	
FOR NPS USE ONLY	
ENTRY NUMBER	DATE
	APR 24 1973

1. NAME

COMMON:  
Ivy Dale Farm

AND/OR HISTORIC:  
Ivy Green, Hoffecker Farm

2. LOCATION

STREET AND NUMBER: *Smyrna - with Dist. 9*  
Box 172, Delaware Route 12

CITY OR TOWN:  
Smyrna

STATE: Delaware CODE: 10 COUNTY: Kent CODE: 001

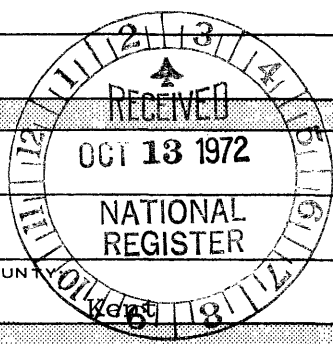

3. CLASSIFICATION

CATEGORY (Check One)	OWNERSHIP	STATUS	ACCESSIBLE TO THE PUBLIC
<input type="checkbox"/> District <input type="checkbox"/> Site <input type="checkbox"/> Object <input checked="" type="checkbox"/> Building <input type="checkbox"/> Structure	<input type="checkbox"/> Public <input checked="" type="checkbox"/> Private <input type="checkbox"/> Both	<input checked="" type="checkbox"/> Occupied <input type="checkbox"/> Unoccupied <input type="checkbox"/> Preservation work in progress <input type="checkbox"/> In Process <input type="checkbox"/> Being Considered	Yes: <input type="checkbox"/> Restricted <input type="checkbox"/> Unrestricted <input checked="" type="checkbox"/> No
PRESENT USE (Check One or More as Appropriate)			
<input type="checkbox"/> Agricultural <input type="checkbox"/> Commercial <input type="checkbox"/> Educational <input type="checkbox"/> Entertainment	<input type="checkbox"/> Government <input type="checkbox"/> Industrial <input type="checkbox"/> Military <input type="checkbox"/> Museum	<input type="checkbox"/> Park <input checked="" type="checkbox"/> Private Residence <input type="checkbox"/> Religious <input type="checkbox"/> Scientific	<input type="checkbox"/> Transportation <input type="checkbox"/> Other (Specify) _____ <input type="checkbox"/> Comments _____

4. OWNER OF PROPERTY

OWNER'S NAME:  
Mr. and Mrs. Edward S. Wilson, Jr.

STREET AND NUMBER:  
Box 172, R.D.1

CITY OR TOWN: Smyrna STATE: Delaware CODE: 10

5. LOCATION OF LEGAL DESCRIPTION

COURTHOUSE, REGISTRY OF DEEDS, ETC.:  
Kent County Court House

STREET AND NUMBER:  
The Green

CITY OR TOWN: Dover STATE: Delaware CODE: 10

6. REPRESENTATION IN EXISTING SURVEYS

TITLE OF SURVEY:

DATE OF SURVEY:  Federal  State  County  Local

DEPOSITORY FOR SURVEY RECORDS:

STREET AND NUMBER:

CITY OR TOWN: STATE: CODE:

SEE INSTRUCTIONS

STATE:

COUNTY:

ENTRY NUMBER

DATE

FOR NPS USE ONLY

7. DESCRIPTION

CONDITION	(Check One)					
	<input type="checkbox"/> Excellent	<input checked="" type="checkbox"/> Good	<input type="checkbox"/> Fair	<input type="checkbox"/> Deteriorated	<input type="checkbox"/> Ruins	<input type="checkbox"/> Unexposed
	(Check One)			(Check One)		
	<input checked="" type="checkbox"/> Altered	<input type="checkbox"/> Unaltered	<input type="checkbox"/> Moved	<input checked="" type="checkbox"/> Original Site		

DESCRIBE THE PRESENT AND ORIGINAL (if known) PHYSICAL APPEARANCE

SEE INSTRUCTIONS

From visual evidence and residents' accounts, it is logical to assume that Ivy Dale was originally a modest house, probably erected on the "Resurrection Manor" plan, with a rear kitchen outbuilding. Toward the middle of the nineteenth century, however, the house underwent some expansion to accommodate the more lavish taste of its Victorian occupants. Thus, the southwest frontage grew to five bays; a center hall now serves flanking rooms; and a rear wing has joined the kitchen to the main house block.

The southwest facade has been relaid with a seven-course common bond veneer. It has also been graced by a frame porch covering the center three bays, and a scrolled, bracketed cornice. Three dormers pierce the roof.

The brickwork has been relaid on both the southeast gable wall and a portion of the northeast wall.

The house plan is basically Georgian. The southeast room is the finer, as it is graced by a marble mantelpiece. The detailing is quite restrained, and includes splayed window casings and paneled wainscots under the windows. The hall stair railing describes an oval plan, and the hall is further distinguished by an arched, double-door entry and a rosette chandelier medallion.

The rear wing, located to the northeast at cross axis to the main house block, contains another hall, a dining room, and the kitchen. The kitchen, though remodeled, still retains an enclosed winding stair access to servants' quarters above. A straight flight of stairs in the rear hall communicates with a rear bedroom and the northwest bed chamber. The second floor of the main portion of the house is similar in disposal to the first floor.

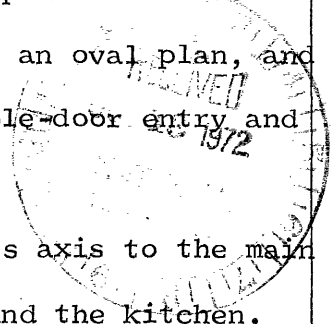

## SIGNIFICANCE

PERIOD (Check One or More as Appropriate)

 Pre-Columbian 16th Century 18th Century 20th Century 15th Century 17th Century 19th Century

SPECIFIC DATE(S) (If Applicable and Known)

1786

AREAS OF SIGNIFICANCE (Check One or More as Appropriate)

Aboriginal

 Prehistoric Historic Agriculture Architecture Art Commerce Communications Conservation Education Engineering Industry Invention Landscape Architecture Literature Military Music Political Religion/Phi-

losophy

 Science Sculpture Social/Human-

itarian

 Theater Transportation Urban Planning Other (Specify)

STATEMENT OF SIGNIFICANCE

Ivy Dale Farm is situated on a tract that was originally a portion of "Pearman's Choice," granted by William Penn to Henry Pearman in 1684. Although Pearman subsequently sold much of the original tract, a portion descended to his daughter, who sold the land to William Cahoon.

In 1748 Cahoon sold his land to John Joy. By 1786 a house was located on the property, for John Joy willed to his sons the land "on which he dwelt." The land was described as "three contiguous pieces of Pearman's Choice, bought of three different claimers." In 1817 the property, known as a "mansion plantation," descended to Edward Joy Morris.

In 1837 Edward Joy Morris sold the Edward Joy farm to Joseph Hoffecker, a descendant of Henry Hoffecker, a German immigrant who settled near Smyrna. Joseph Hoffecker realized considerable prosperity from the farm lands. Thus, in 1845 he rebuilt the Joy house to suit his improved position.

When Joseph Hoffecker died in 1851, the farm, then called "Ivy Green," was inherited by John H. Hoffecker, a leading entrepreneur in the Smyrna area, known for his fruit-canning business. "Ivy Green" consisted of two hundred twenty-five acres, planted mostly in fruit

SEE INSTRUCTIONS

**9. MAJOR BIBLIOGRAPHICAL REFERENCES**

Biographical and Genealogical History of the State of Delaware.  
 Chambersburg, Pa.: J. M. Runk and Company, 1899. p. 948.  
 Kent County Deed Records, State of Delaware: Volume 1, N p. 253;  
 volume 1, Z p. 130; volume 3, L p. 70.  
 Scharf, J. Thomas. History of Delaware. Philadelphia: L. J.  
 Richards and Company 1888, vol. 2: 1107-1108.

**10. GEOGRAPHICAL DATA**

LATITUDE AND LONGITUDE COORDINATES DEFINING A RECTANGLE LOCATING THE PROPERTY			LATITUDE AND LONGITUDE COORDINATES DEFINING THE CENTER POINT OF A PROPERTY OF LESS THAN TEN ACRES		
CORNER	LATITUDE	LONGITUDE	LATITUDE		LONGITUDE
	Degrees Minutes Seconds	Degrees Minutes Seconds	Degrees	Minutes	Seconds
NW	0 ' "	0 ' "	39°	17'	13"
NE	0 ' "	0 ' "	75°	34'	47"
SE	0 ' "	0 ' "			
SW	0 ' "	0 ' "			

APPROXIMATE ACREAGE OF NOMINATED PROPERTY: **One acre**

LIST ALL STATES AND COUNTIES FOR PROPERTIES OVERLAPPING STATE OR COUNTY BOUNDARIES

STATE:	CODE	COUNTY	CODE

**11. FORM PREPARED BY**

NAME AND TITLE:  
**Mr. Vincent Rogers**

ORGANIZATION: **Division of Historical and Cultural Affairs**      DATE: **9/8/72**

STREET AND NUMBER:  
**Hall of Records**

CITY OR TOWN: **Dover**      STATE: **Delaware**      CODE: **10**

**12. STATE LIAISON OFFICER CERTIFICATION**

**NATIONAL REGISTER VERIFICATION**

As the designated State Liaison Officer for the National Historic Preservation Act of 1966 (Public Law 89-665), I hereby nominate this property for inclusion in the National Register and certify that it has been evaluated according to the criteria and procedures set forth by the National Park Service. The recommended level of significance of this nomination is:

National  State  Local

Name **E. Berkeley Tompkins**  
 Dr. E. Berkeley Tompkins

Title **Director, Div. of Historical and Cultural Affairs**

Date **10-6-72**

I hereby certify that this property is included in the National Register.

**Robert M. Utley**  
 Chief, Office of Archeology and Historic Preservation

Date **4/24/73**

ATTEST: **[Signature]**  
 Keeper of The National Register

Date **4 24 73**

SEE INSTRUCTIONS

NATIONAL REGISTER OF HISTORIC PLACES  
INVENTORY - NOMINATION FORM

(Continuation Sheet)

STATE Delaware	
COUNTY Kent	
FOR NPS USE ONLY	
ENTRY NUMBER	DATE
	APR 24 1973

(Number all entries)

8. STATEMENT OF SIGNIFICANCE (continued)---

trees. John H. Hoffecker served as a member of the United States House of Representatives, and as speaker of the Delaware House of Representatives.

In 1877 Walter O. Hoffecker became manager of his father's farm lands. At the death of John H. Hoffecker in 1900, Walter Hoffecker gained outright control. Like his father, Walter Hoffecker was prominent in public affairs; he too served as a member of the United States House of Representatives, having filled the vacancy left by the death of his father.

During the first half of the twentieth century, the farm now known as "Ivy Dale", passed out of the hands of the Hoffecker family. Nevertheless, the house still stands amid the fields of a working farm.

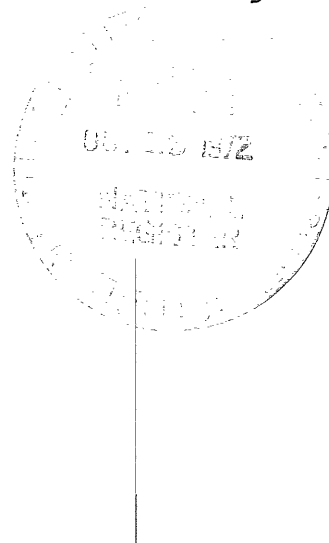

(KENTON)

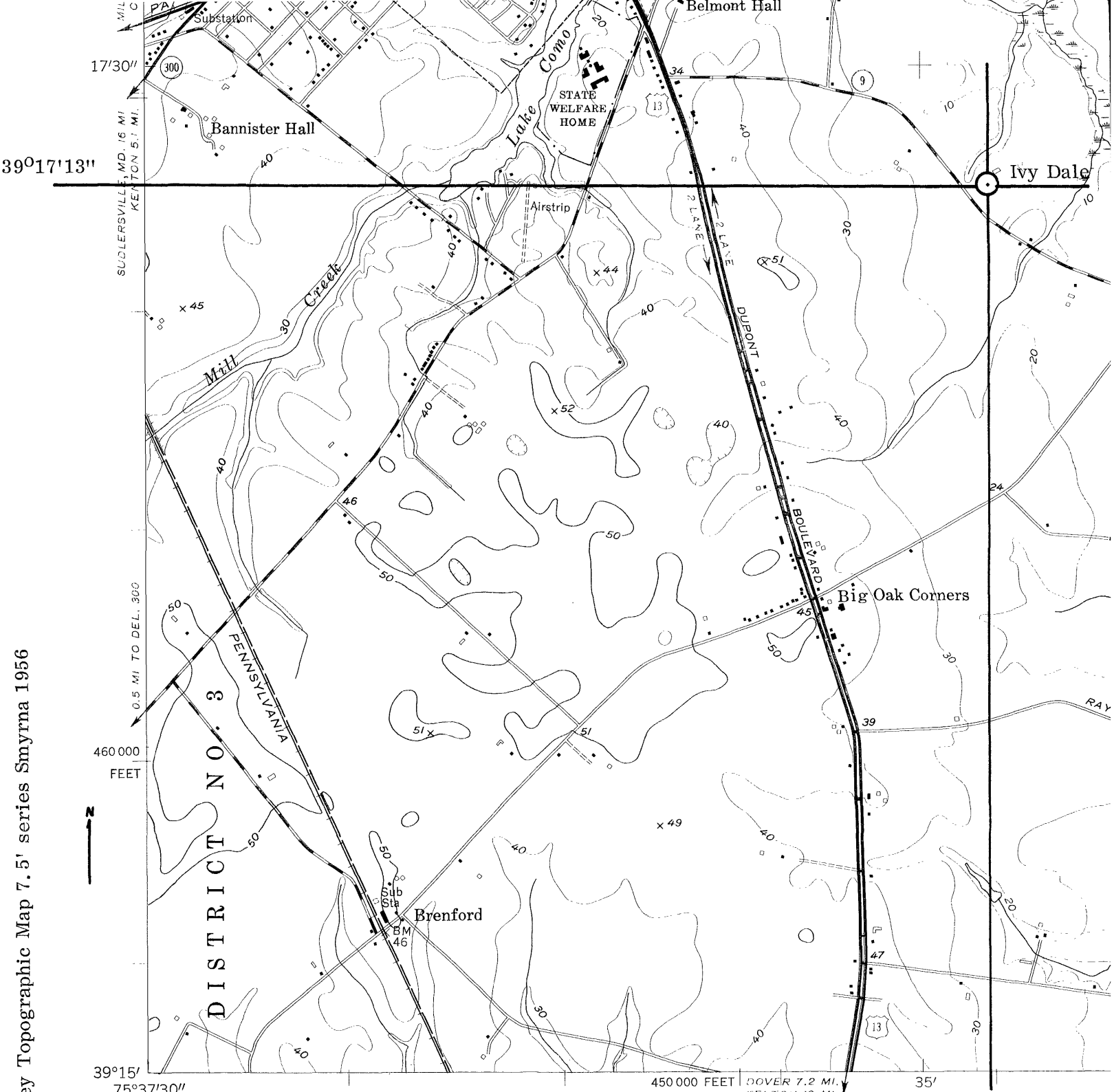

Mapped by U. S. Coast and Geodetic Survey  
 Edited and published by the Geological Survey  
 Control by USC&GS (C) and USGS

Culture and drainage in part compiled from aerial photographs  
 taken 1946. Topography by planetable surveys 1947.  
 Revised by USGS 1956

Hydrography compiled from USC&GS chart 294 (1951)

Polyconic projection. 1927 North American datum  
 10,000-foot grid based on Delaware coordinate system  
 1,000-meter Universal Transverse Mercator grid ticks,  
 zone 18, shown in blue

Unchecked elevations are shown in brown

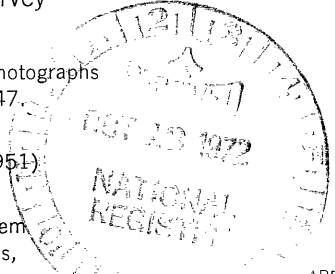

TRUE NORTH  
 MAGNETIC NORTH  
 APPROXIMATE MEAN DECLINATION, 1956

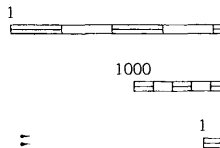

75°34'47"

DEPT  
 SHC  
 TH  
 FOR S  
 A FOLDER DE