

PLANK HOUSES OF GOSHEN, NEW HAMPSHIRE
 THEMATIC GROUP NOMINATION TO THE NATIONAL REGISTER
 INDIVIDUAL PROPERTY INVENTORY FORM

Site # 18

PROPERTY NAME: <i>The Williamson House</i> LOCATION: <i>Messer Road (precise location withheld)</i>	OWNER: <i>Esther Williamson (Mrs. Stanley)</i> ADDRESS: <i>PO Box #1 Wendell NH 03783</i>
UTM REFERENCES: USGS QUADRANGLE: <i>Sunapee NH 15' series</i>	ACREAGE: <i>Approximately 30</i> VERBAL BOUNDARY DESCRIPTION: <i>(See continuation sheet)</i>
PHYSICAL DESCRIPTION: <p><i>The Williamson House is a one-and-a-half-story kneewall house. The main block is roughly 38' x 30', and five bays across by four deep. The exterior is clapboarded and the building rests on a granite foundation. The windows are 6/6 sash with plain surrounds. The entrance door is in the ell which is roughly 31' x 30', four bays by three. This section is recessed to accommodate a porch. The door and all windows have plain surrounds. The terraced area on the opposite side of the house seems to indicate that the original road once passed on that side, with an entrance door having been located on that elevation.</i></p> <p><i>Behind the house is a sugar house and on the opposite side of Messer Road from the house is a barn. The balance of the property is in tillage.</i></p>	
STATEMENT OF SIGNIFICANCE: <p><i>This is the only house in the Goshen plank group to be constructed of two-inch plank. Walter R. Nelson described its construction this way, "There are no corner posts, so must be load-bearing. The planks on the back of the structure had been hewed instead of sawed, because they show rough axe marks. The planks here are pinned to the frame, instead of the usual mortise and tenon method used in the 3-inch plank houses."</i></p> <p><i>The farm was occupied by Isaac Messer prior to 1860 and the house was probably built for him around 1850. It remained in the Messer family until the 1940s when it was acquired by the present owners.</i></p>	
MAP: (Indicate North in Circle)  <i>(See continuation sheet)</i>	PHOTOGRAPH:
RECORDED BY: <i>Doris Newman</i> ADDRESS: <i>Goshen NH 03752</i> DATE: <i>3/7/83</i>	DESCRIPTION OF VIEW: <i>North & west elevations</i> PHOTOGRAPHER: <i>Leslie Goat Feb. 1983</i> NEGATIVE WITH: <i>Town Clerk, Goshen NH</i>

PLANK HOUSES OF GOSHEN, NEW HAMPSHIRE
THEMATIC GROUP NOMINATION TO THE NATIONAL REGISTER
INDIVIDUAL PROPERTY INVENTORY FORM

CONTINUATION SHEET

SITE NUMBER: # 18 CONTINUATION SHEET NUMBER: # 2
PROPERTY NAME: The Williamson House

Boundary Description and Justification:

Boundaries of the nominated property are highlighted in yellow on the attached sketch map. These boundaries represent the acreage historically associated with the house.

UTM References:

- A.) Easting: 7-34-150 Northing: 48-01-790
- B.) Easting: 7-34-160 Northing: 48-01-375
- C.) Easting: 7-33-750 Northing: 48-01-800
- D.) Easting: 7-33-750 Northing: 48-01-650

PLANK HOUSES OF GOSHEN, NEW HAMPSHIRE
THEMATIC GROUP NOMINATION TO THE NATIONAL REGISTER
INDIVIDUAL PROPERTY INVENTORY FORM

CONTINUATION SHEET

SITE NUMBER: #18

CONTINUATION SHEET NUMBER: #3

PROPERTY NAME: The Williamson House

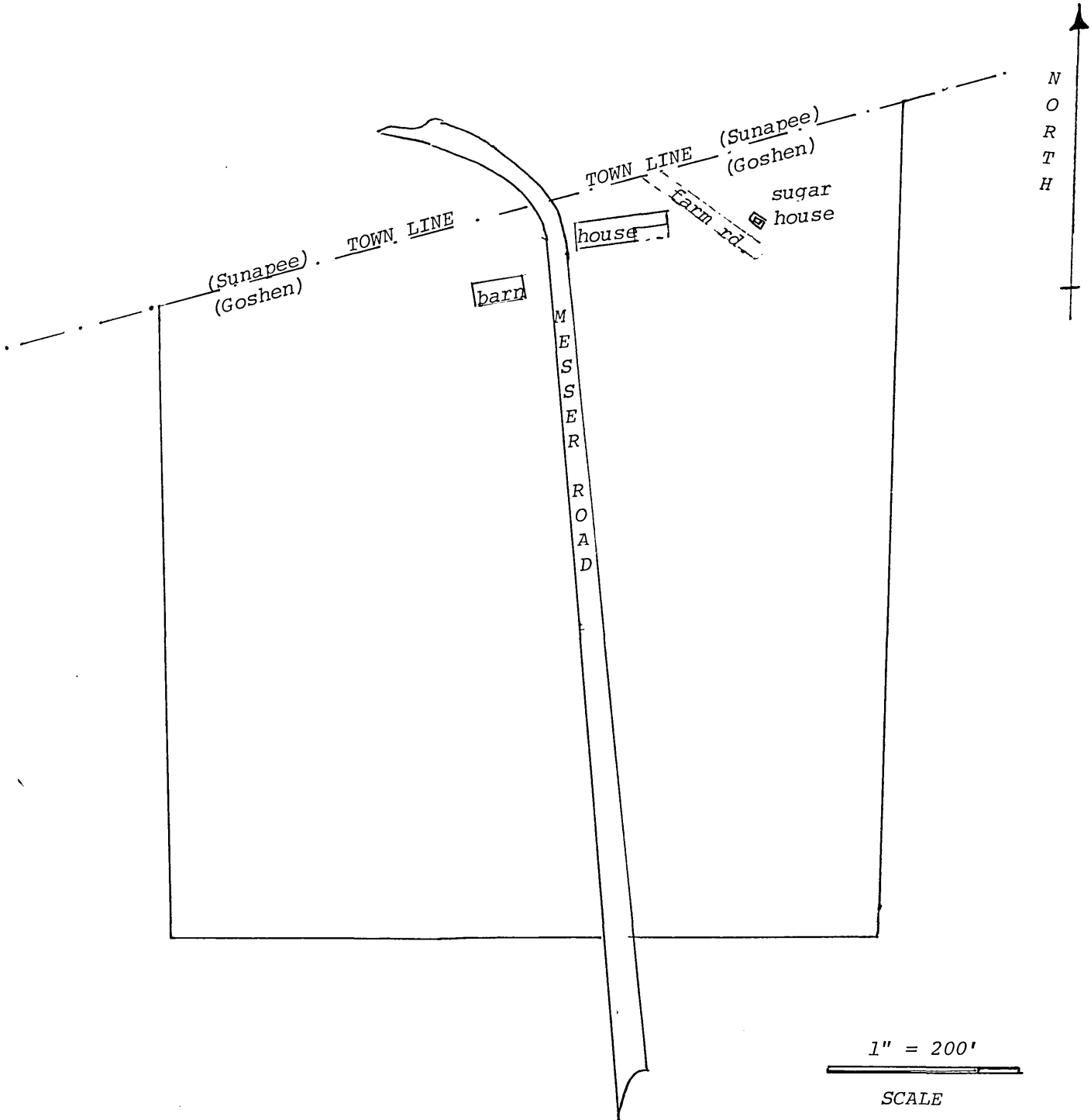

**United States Department of the Interior
National Park Service**

**National Register of Historic Places
Inventory—Nomination Form**

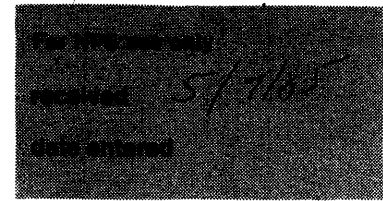

Continuation sheet Item number Page 2 of 2

Multiple Resource Area
Thematic Group

Name Plank Houses of Goshen New Hampshire Multiple Resource Area
State Sullivan County, NEW HAMPSHIRE

Nomination/Type of Review	Entered in the National Register	for Keeper	Date/Signature
11. Pike House	Entered in the National Register	for Keeper	<u>Delores Byers</u> 6/21/85
		Attest	_____
12. Purnell House	Entered in the National Register	for Keeper	<u>Delores Byers</u> 6/21/85
		Attest	_____
13. Scranton House	Entered in the National Register	for Keeper	<u>Delores Byers</u> 6/21/85
		Attest	_____
14. Seavey House	Entered in the National Register	for Keeper	<u>Delores Byers</u> 6/21/85
		Attest	_____
15. Stelljes House	Entered in the National Register	for Keeper	<u>Delores Byers</u> 6/21/85
		Attest	_____
16. Welcome Acres	Entered in the National Register	for Keeper	<u>Delores Byers</u> 6/21/85
		Attest	_____
17. Williamson House	Entered in the National Register	for Keeper	<u>Delores Byers</u> 6/21/85
		Attest	_____
18. Windswept Acres- Powers House	Entered in the National Register	for Keeper	<u>Delores Byers</u> 6/21/85
		Attest	_____
19.		Keeper	_____
		Attest	_____
20.		Keeper	_____
		Attest	_____