

UNITED STATES DEPARTMENT OF THE INTERIOR
NATIONAL PARK SERVICE

**NATIONAL REGISTER OF HISTORIC PLACES
INVENTORY -- NOMINATION FORM**

FOR FEDERAL PROPERTIES

FOR NPS USE ONLY	
RECEIVED	JAN 20 1983
DATE ENTERED	

SEE INSTRUCTIONS IN HOW TO COMPLETE NATIONAL REGISTER FORMS
TYPE ALL ENTRIES -- COMPLETE APPLICABLE SECTIONS

1 NAME

HISTORIC

Visitor Center, Cedar Breaks National Monument
AND/OR COMMON

N/A

2 LOCATION

STREET & NUMBER

N/A

off UT 14

N/A

NOT FOR PUBLICATION

CITY, TOWN

Cedar City v.c.

CONGRESSIONAL DISTRICT

~~Cedar Breaks National Monument~~

VICINITY OF

Second

STATE

Utah

CODE

049

COUNTY

Iron

CODE

021

3 CLASSIFICATION

CATEGORY

- DISTRICT
- BUILDING(S)
- STRUCTURE
- SITE
- OBJECT

OWNERSHIP

- PUBLIC
- PRIVATE
- BOTH

PUBLIC ACQUISITION

- IN PROCESS
- BEING CONSIDERED

STATUS

- OCCUPIED
- UNOCCUPIED
- WORK IN PROGRESS

ACCESSIBLE

- YES: RESTRICTED
- YES: UNRESTRICTED
- NO

PRESENT USE

- AGRICULTURE
- MUSEUM
- COMMERCIAL
- PARK
- EDUCATIONAL
- PRIVATE RESIDENCE
- ENTERTAINMENT
- RELIGIOUS
- GOVERNMENT
- SCIENTIFIC
- INDUSTRIAL
- TRANSPORTATION
- MILITARY
- OTHER:

4 AGENCY

REGIONAL HEADQUARTERS: (If applicable)

National Park Service, Rocky Mountain Region

STREET & NUMBER

655 Parfet Street

CITY, TOWN

Lakewood

N/A

VICINITY OF

STATE

Colorado

5 LOCATION OF LEGAL DESCRIPTION

COURTHOUSE,
REGISTRY OF DEEDS, ETC.

Iron County Courthouse

STREET & NUMBER

83 South 100 East

CITY, TOWN

Parowan

STATE

Utah

6 REPRESENTATION IN EXISTING SURVEYS

TITLE

List of Classified Structures Inventory

DATE

March 1976

FEDERAL STATE COUNTY LOCAL

DEPOSITORY FOR
SURVEY RECORDS

National Park Service, Rocky Mountain Regional Office

CITY, TOWN

Lakewood

STATE

Colorado

7 DESCRIPTION

CONDITION

EXCELLENT
 GOOD
 FAIR

DETERIORATED
 RUINS
 UNEXPOSED

CHECK ONE

UNALTERED
 ALTERED

CHECK ONE

ORIGINAL SITE
 MOVED DATE _____

DESCRIBE THE PRESENT AND ORIGINAL (IF KNOWN) PHYSICAL APPEARANCE

The Visitor Center, Cedar Breaks National Monument, is located off Rim Road in the southeast corner of the monument. The building is a focal point for viewing the multi-colored amphitheater which is slowly being formed from the western edge of the rolling green alpine meadow.

Built in 1937 as a Civilian Conservation Corps project, the rustic style building is harmonious with the natural setting and retains its architectural and historical integrity.

The one-story, 2-room rectangular shape building has 606 square feet with a 150 square foot covered porch. The log constructed building is on a stone masonry foundation. The walls are brown painted peeled log with saddlenotched corners and buttressed log crowning. A battered stone masonry chimney with a 12 foot base is on the east end. The wood shingled gable roof has exposed peeled log rafters and purlins. The porch columns are large peeled logs and the porch has a flagstone floor. A 29' x 6'6" porch addition was constructed in 1954. The porch extends the length of the north elevation. Both the porch and south elevations have plate glass windows. These windows replaced the original 6 light casement sash windows. During the 1954 renovation, a closet at the southeast corner of the building was converted into an office. These changes have not lessened the integrity of the building in conveying the expression of architectural design and construction technology. The building retains the essential physical features that makes it a good example of peeled log and stone construction for park buildings of the 1930's. The building is on its original location; it is in poor condition. The building is currently being used as the visitor center and museum, however, a larger facility is needed to meet visitor demands.

The survey of the Visitor Center, Cedar Breaks National Monument was completed by Lance Olivierri, a consultant on historic properties, and under the supervision of Supervisory Historical Architect Rodd L. Wheaton during March 1978. Mr. Olivierri used the criteria established by the National Register of Historic Places for his evaluations and the structure was entered on the Rocky Mountain Regional Office List of Classified Structures Inventory.

8 SIGNIFICANCE

PERIOD	AREAS OF SIGNIFICANCE -- CHECK AND JUSTIFY BELOW			
PREHISTORIC	<input type="checkbox"/> ARCHEOLOGY-PREHISTORIC	<input type="checkbox"/> COMMUNITY PLANNING	<input type="checkbox"/> LANDSCAPE ARCHITECTURE	<input type="checkbox"/> RELIGION
1400-1499	<input type="checkbox"/> ARCHEOLOGY-HISTORIC	<input type="checkbox"/> CONSERVATION	<input type="checkbox"/> LAW	<input type="checkbox"/> SCIENCE
1500-1599	<input type="checkbox"/> AGRICULTURE	<input type="checkbox"/> ECONOMICS	<input type="checkbox"/> LITERATURE	<input type="checkbox"/> SCULPTURE
1600-1699	<input checked="" type="checkbox"/> ARCHITECTURE	<input type="checkbox"/> EDUCATION	<input type="checkbox"/> MILITARY	<input type="checkbox"/> SOCIAL/HUMANITARIAN
1700-1799	<input type="checkbox"/> ART	<input type="checkbox"/> ENGINEERING	<input type="checkbox"/> MUSIC	<input type="checkbox"/> THEATER
1800-1899	<input type="checkbox"/> COMMERCE	<input type="checkbox"/> EXPLORATION/SETTLEMENT	<input type="checkbox"/> PHILOSOPHY	<input type="checkbox"/> TRANSPORTATION
1900-	<input type="checkbox"/> COMMUNICATIONS	<input type="checkbox"/> INDUSTRY	<input type="checkbox"/> POLITICS/GOVERNMENT	<input checked="" type="checkbox"/> OTHER (SPECIFY) Park Development
		<input type="checkbox"/> INVENTION		

SPECIFIC DATES 1937 BUILDER/ARCHITECT Civilian Conservation Corps National Park Service

STATEMENT OF SIGNIFICANCE

The Visitor Center, Cedar Breaks National Monument, is regionally significant in the area of architecture. The peeled log and stone masonry construction was one style of rustic architecture used by the National Park Service during the significant park building program in the 1930's as a part of the Public Works Administration. Although, the actual construction of this building was completed by the Civilian Conservation Corps, the philosophy that required each building to be individually designed for its specific location was that of the National Park Service. The craftsmanship of the log and masonry construction reflects the pioneer spirit of using native materials and exemplifies the "hearth and home" quality of rustic architecture. The design of the Visitor Center is a good example of a park structure which is harmonious with the natural setting and supports the "primary purpose in setting aside Park areas, which is to conserve them as nearly as possible in the natural state."

Wheaton, Rodd L.
 "Building for the National Parks in the Rocky Mountain West, 1872-1966."

9 MAJOR BIBLIOGRAPHICAL REFERENCES

Building Maintenance File. Cedar Breaks National Monument, 1955, National Park Service Rocky Mountain Regional Office, Denver, Colorado.
 List of Classified Structures Inventory. National Park Service, Rocky Mountain Regional Office, Denver, Colorado.
 Tweed, William, Soullier, Laura, and Law, Henry. National Park Service Rustic Architecture: 1916-1942. National Park Service; 1977. (see continuation sheet)

10 GEOGRAPHICAL DATA

ACREAGE OF NOMINATED PROPERTY Less than 1 acre
 UTM REFERENCES

A	112	337900	4164950	B			
	ZONE	EASTING	NORTHING		ZONE	EASTING	NORTHING
C				D			

VERBAL BOUNDARY DESCRIPTION

The Visitor Center is at the Point Supreme Overlook and off the north side of Rim Road. The Visitor Center is more than a mile from the Monument's south entrance. The nominated area is approximately 850 sq. ft. and less than one acre.

*Centered on the building
 (per phone call to Karen Rehn, NPS, 8/10/83 - '85)*

LIST ALL STATES AND COUNTIES FOR PROPERTIES OVERLAPPING STATE OR COUNTY BOUNDARIES

STATE	CODE	COUNTY	CODE
N/A	N/A	N/A	N/A
STATE	CODE	COUNTY	CODE
N/A	N/A	N/A	N/A

11 FORM PREPARED BY

NAME / TITLE

Mary Shivers Culpin, Architectural Historian

ORGANIZATION

National Park Service

STREET & NUMBER

655 Parfet

CITY OR TOWN

Lakewood

DATE

July 27, 1982

TELEPHONE

(303) 234-2764

STATE

Colorado

12 CERTIFICATION OF NOMINATION

STATE HISTORIC PRESERVATION OFFICER RECOMMENDATION

YES ___ NO ___ NONE ___

See attached

STATE HISTORIC PRESERVATION OFFICER SIGNATURE

In compliance with Executive Order 11593, I hereby nominate this property to the National Register, certifying that the State Historic Preservation Officer has been allowed 90 days in which to present the nomination to the State Review Board and to evaluate its significance. The evaluated level of significance is ___ National ___ State Local.

FEDERAL REPRESENTATIVE SIGNATURE

Edumo Island

DATE

6/30/83

TITLE

Chief Historian, Div. of History

FOR NPS USE ONLY

I HEREBY CERTIFY THAT THIS PROPERTY IS INCLUDED IN THE NATIONAL REGISTER

DATE

8/4/85

DIRECTOR, OFFICE OF ARCHEOLOGY AND HISTORIC PRESERVATION

ATTEST:

DATE

KEEPER OF THE NATIONAL REGISTER

UNITED STATES DEPARTMENT OF THE INTERIOR
NATIONAL PARK SERVICE

FOR NPS USE ONLY

RECEIVED

DATE ENTERED

**NATIONAL REGISTER OF HISTORIC PLACES
INVENTORY -- NOMINATION FORM**

CONTINUATION SHEET

ITEM NUMBER 9

PAGE 1

Wheaton, Rodd L.

"Building for the National Parks in the Rocky Mountain West, 1872-1966."
unpublished manuscript, 1980.

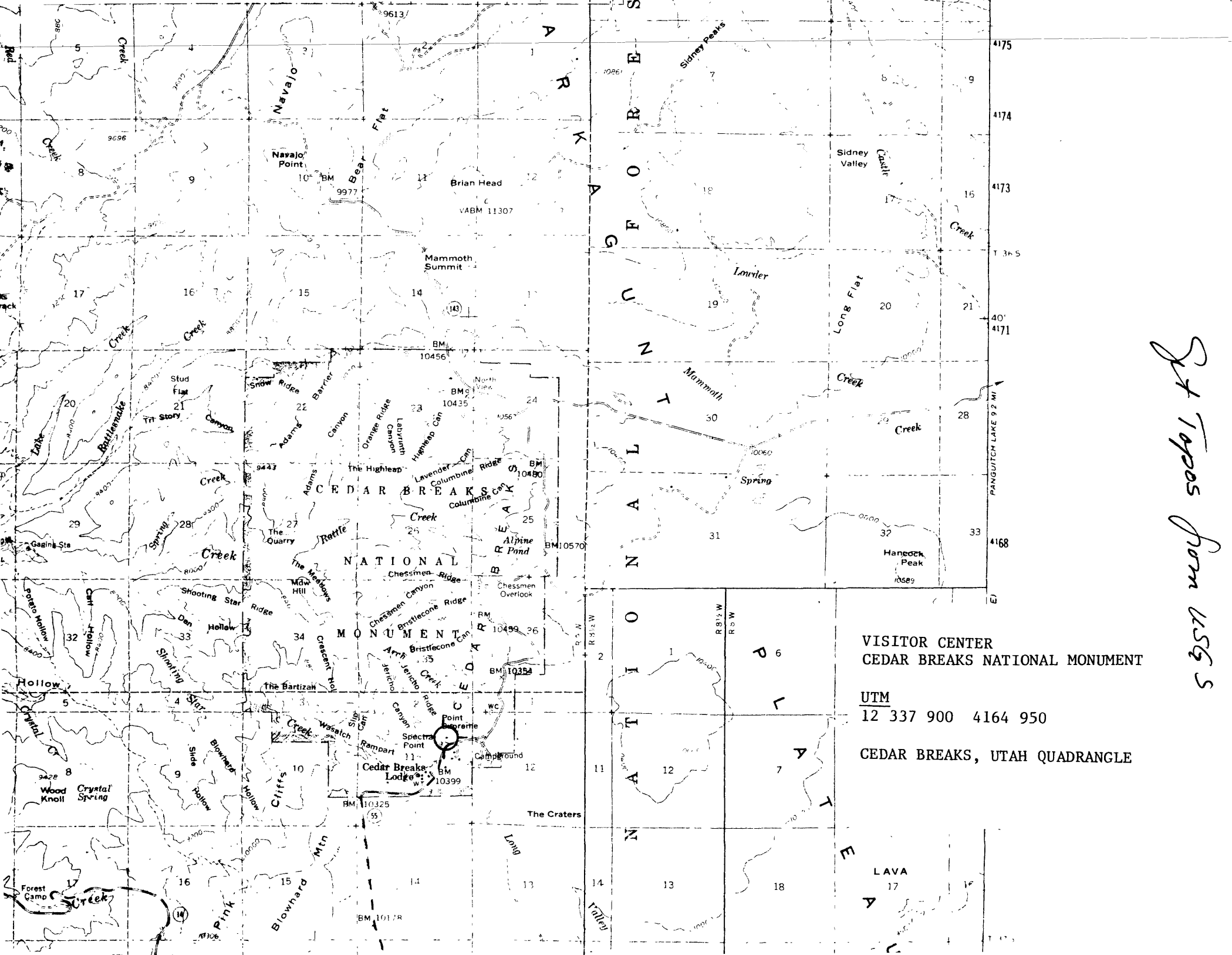

VISITOR CENTER
CEDAR BREAKS NATIONAL MONUMENT

UTM
12 337 900 4164 950

CEDAR BREAKS, UTAH QUADRANGLE

St Topos from USGS

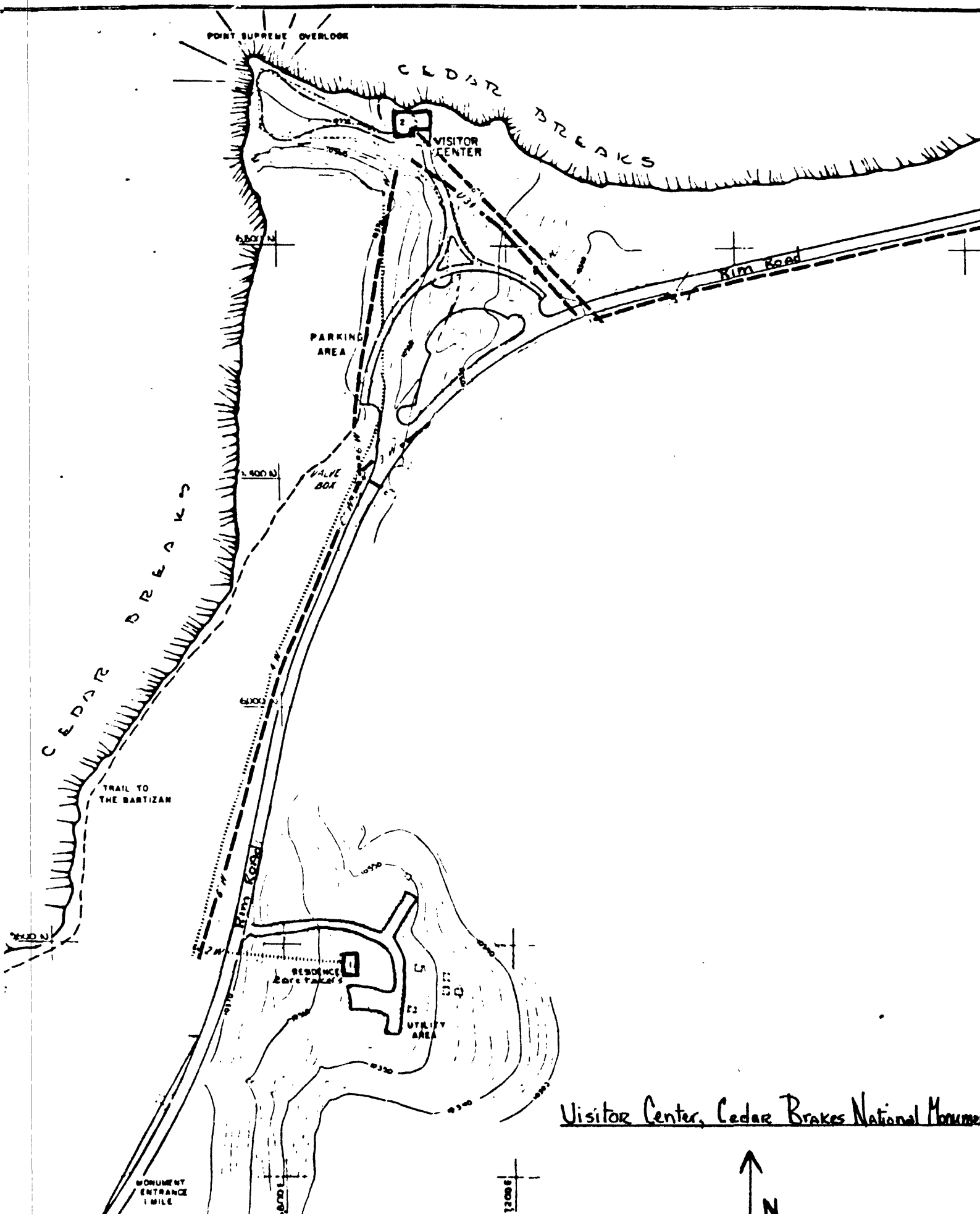

Visitor Center, Cedar Brakes National Monument

