

United States Department of the Interior
National Park Service

National Register of Historic Places
Continuation Sheet

Section number CZ 5 Page 2 Pechan House

The west exterior wall of the center bay is of wood frame construction and appears to be original. Either the builder planned to expand in a perpendicular ell from the center of the structure at a later date, or he exhausted his supply of timber and resorted to boards. In any case, the house is a pure example of permanent log building.

8. 1869-1899; Architecture, Exploration/Settlement, Czech Ethnic.

Specific date, early 1870's. Frantisek (Frank) Pechan, builder.

Significant in architecture, the Pechan House is the best example of Czech coaxial linear houses in the survey area. It is also the purest and best preserved Czech log structure known to exist in the state. At present it is not in immediate danger of irreversible deterioration, but measures must be taken soon to keep weather and vermin out of the house. Its secluded location and frequent visits by the owner, who stores machinery in a nearby barn, prevent vandalism. Registration is the first step in the protection and preservation of this important structure.

The Pechan Log House is also significant in the history of Czech settlement in the state. Frantisek (Frank) Pechan was born in Bohemia in 1851. He came to Dakota Territory with his father and mother, Joseph and Ludmila, as a member of the first Czech expedition from Chicago in 1869. Frank died in 1919 and is buried in the Lakeport Czech Catholic cemetery (on the site of the "Old Catholic Church" nominated in 1977, see Item 7 overview) about two miles west of the the Pechan House. The family, however, claimed no religious affiliation after the breakup of the Lakeport parish in the early 20th Century. Frank's son Joseph (1878-1940) inherited the farm, but lost it to a mortgage company during the Great Depression of the 1930's. Presently, it is owned by Alfred Nedved, who is married to the great granddaughter of Joseph Pechan Sr., Helen Cwach. Her father, Emil, was the son of Mathias Cwach and Josephine Pechan, the latter being the daughter of Joseph Pechan Sr. and the sister of Frank Pechan.

Major biographical source: Dvorak (1980), 21-3, 29; Helen Nedved, Joseph Pechan, n.p., privately printed, n.d., 2-8, 15.

United States Department of the Interior
National Park Service

**National Register of Historic Places
Continuation Sheet**

Section number CZ 5 Page 3 Pechan House

10. Acreage: less than one acre. Scale: 1:24,000.
Quad.: Tabor N.E. UTM: 14/ 619190/ 4752110.

The boundaries of this site are imaginary lines that connect to form a rectangle that is centered on the rectangular house. Each line lies 10 feet from the exterior walls of the house. The site is located in the Northeast Quarter of the Southeast Quarter of Section 35, Township 94 North, Range 57 West, in Yankton County.

United States Department of the Interior
National Park Service

National Register of Historic Places Continuation Sheet

Section number CZ 5 Page 4 Pechan House

SITE PLAN OF CZ 5 ON REVERSE SIDE

SITE PLAN (Complete inventory of all structures, their function, dates & details of construction, and surrounding vegetation) WITH NORTH ARROW



SITE NAME: Pechan Log House
CZ SURVEY #: 5

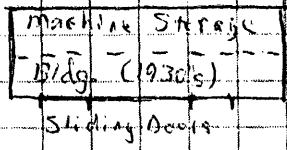
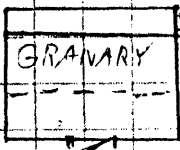

House built about 1910

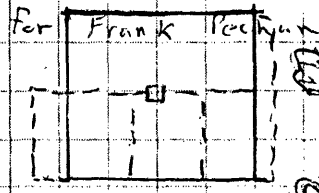

(Field)
← 1/8 mi →

Field Stone Rubble Pile

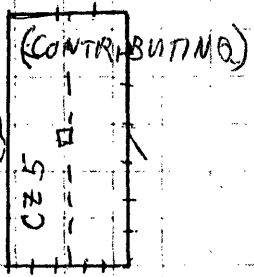

(SHELTER BELT)

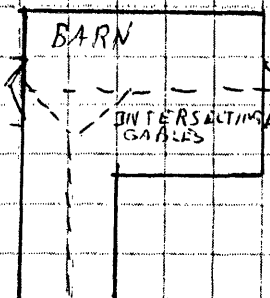

(Built probably by Frank or Young Joseph Pechan)

(Field)

(Field)

← 1/4 mi →

FIELD ROAD