

687

NPS Form 10-900
(Rev. 10-90)

OMB No. 1024-0018

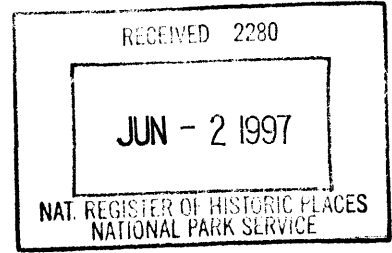

United States Department of the Interior
National Park Service

NATIONAL REGISTER OF HISTORIC PLACES
REGISTRATION FORM

This form is for use in nominating or requesting determinations for individual properties and districts. See instructions in How to Complete the National Register of Historic Places Registration Form (National Register Bulletin 16A). Complete each item by marking "x" in the appropriate box or by entering the information requested. If any item does not apply to the property being documented, enter "N/A" for "not applicable." For functions, architectural classification, materials, and areas of significance, enter only categories and subcategories from the instructions. Place additional entries and narrative items on continuation sheets (NPS Form 10-900a). Use a typewriter, word processor, or computer, to complete all items.

1. Name of Property

historic name Union Monument

other names/site number JF-EC-20

2. Location

street & number Cave Hill Cemetery not for publication NA
city or town Louisville vicinity NA
state Kentucky code KY county Jefferson code 056
zip code 40204

3. State/Federal Agency Certification

As the designated authority under the National Historic Preservation Act of 1986, as amended, I hereby certify that this X nomination request for determination of eligibility meets the documentation standards for registering properties in the National Register of Historic Places and meets the procedural and professional requirements set forth in 36 CFR Part 60. In my opinion, the property X meets does not meet the National Register Criteria. I recommend that this property be considered significant nationally statewide X locally. (See continuation sheet for additional comments.)

David L. Morgan 4-23-97
Signature of certifying official Date
David L. Morgan, SHPO
Kentucky Heritage Council, State Historic Preservation Office
State or Federal agency and bureau

In my opinion, the property meets does not meet the National Register criteria. (See continuation sheet for additional comments.)

Signature of commenting or other official Date

State or Federal agency and bureau

4. National Park Service Certification

I, hereby certify that this property is:

- entered in the National Register See continuation sheet.
- determined eligible for National Register See continuation sheet.
- determined not eligible for the National Register
- removed from the National Register other (explain):

Edson H. Beall 7/17/97
 Signature of Keeper Date of Action

5. Classification

Ownership of Property (Check as many boxes as apply)

- private
- public-local
- public-State
- public-Federal

Category of Property (Check only one box)

- building(s)
- district
- site
- structure
- object

Number of Resources within Property

Contributing	Noncontributing	
<input type="checkbox"/>	<input type="checkbox"/>	buildings
<input type="checkbox"/>	<input type="checkbox"/>	sites
<input type="checkbox"/>	<input type="checkbox"/>	structures
<input type="checkbox"/>	<input type="checkbox"/>	objects
<input type="checkbox"/>	<input type="checkbox"/>	Total

Number of contributing resources previously listed in the National Register 0

Name of related multiple property listing (Enter "N/A" if property is not part of a multiple property listing.)

Civil War Monuments in Kentucky, 1861-1935

6. Function or Use

Historic Functions (Enter categories from instructions)

Cat: Other: Civil War Monument Sub: _____

Current Functions (Enter categories from instructions)

Cat: Other: Civil War Monument Sub: _____

7. Description

Architectural Classification (Enter categories from instructions)

NA

Materials (Enter categories from instructions)

foundation _____

roof NA

walls NA

other Granite

Bronze

Narrative Description (Describe the historic and current condition of the property on one or more continuation sheets.)
(See attached)

8. Statement of Significance

Applicable National Register Criteria (Mark "x" in one or more boxes for the criteria qualifying the property for National Register listing)

A Property is associated with events that have made a significant contribution to the broad patterns of our history.

B Property is associated with the lives of persons significant in our past.

C Property embodies the distinctive characteristics of a type, period, or method of construction or represents the work of a master, or possesses high artistic values, or represents a significant and distinguishable entity whose components lack individual distinction.

D Property has yielded, or is likely to yield information important in prehistory or history.

Criteria Considerations (Mark "X" in all the boxes that apply.)

A owned by a religious institution or used for religious purposes.

B removed from its original location.

C a birthplace or a grave.

D a cemetery.

E a reconstructed building, object, or structure.

F a commemorative property.

G less than 50 years of age or achieved significance within the past 50 years.

Areas of Significance (Enter categories from instructions)

Social History

Period of Significance 1914 - 1935

Significant Dates 1914

Significant Person (Complete if Criterion B is marked above)
NA

Cultural Affiliation NA

Architect/Builder Unknown

Narrative Statement of Significance (Explain the significance of the property on one or more continuation sheets.)
(SEE ATTACHED)

9. Major Bibliographical References

(Cite the books, articles, and other sources used in preparing this form on one or more continuation sheets.)

Previous documentation on file (NPS)

- preliminary determination of individual listing (36 CFR 67) has been requested.
- previously listed in the National Register
- previously determined eligible by the National Register
- designated a National Historic Landmark
- recorded by Historic American Buildings Survey # _____
- recorded by Historic American Engineering Record # _____

Primary Location of Additional Data

- State Historic Preservation Office
- Other State agency
- Federal agency
- Local government
- University
- Other

Name of repository: _____

10. Geographical Data

Acreage of Property Less than one acre

UTM References (Place additional UTM references on a continuation sheet)

Zone Easting	Northing	Zone Easting	Northing	
1 16 611820	4233940	3	_____	Quad. - <u>Louisville East</u>
2	_____	4	_____	
See continuation sheet.				

Verbal Boundary Description (Describe the boundaries of the property on a continuation sheet.)

(See attached)

Boundary Justification (Explain why the boundaries were selected on a continuation sheet.)

11. Form Prepared By

name/title Joseph E. Brent, Historic Sites Data Coordinator

organization Kentucky Heritage Council date _____

street & number 300 Washington Street telephone (502) 564-7005

city or town Frankfort state KY zip code 40601

Additional Documentation

Submit the following items with the completed form:

Continuation Sheets

Maps

A USGS map (7.5 or 15 minute series) indicating the property's location.

A sketch map for historic districts and properties having large acreage or numerous resources.

Photographs

Representative black and white photographs of the property.

Additional items (Check with the SHPO or FPO for any additional items)

Property Owner

(Complete this item at the request of the SHPO or FPO.)

name Leroy Squires, Superintendent

Cave Hill Cemetery

street & number 701 Baxter Avenue telephone _____

city or town Louisville state KY zip code 40204

Paperwork Reduction Act Statement: This information is being collected for applications to the National Register of Historic Places to nominate properties for listing or determine eligibility for listing, to list properties, and to amend existing listings. Response to this request is required to obtain a benefit in accordance with the National Historic Preservation Act, as amended (16 U.S.C. 470 et seq.).

Estimated Burden Statement: Public reporting burden for this form is estimated to average 18.1 hours per response including the time for reviewing instructions, gathering and maintaining data, and completing and reviewing the form. Direct comments regarding this burden estimate or any aspect of this form to the Chief, Administrative Services Division, National Park Service, P.O. Box 37127, Washington, DC 20013-7127; and the Office of Management and Budget, Paperwork Reductions Project (1024-0018), Washington, DC 20503.

United States Department of the Interior
National Park Service

NATIONAL REGISTER OF HISTORIC PLACES
CONTINUATION SHEET

Union Monument
Jefferson County, Kentucky

Section number 7, 8, 10

Page 1

Description The Union Monument in Cave Hill cemetery is a simple rough cut granite monument. It is approximately six feet high and three wide feet and approximately 18 inches deep. It is a tombstone shaped monument with a rounded top. It has on its face a bronze plaque with the words: "In Memory of Unknown Union Soldiers in This Cemetery 1861-1865 Erected by Kentucky Comrades -- 1914."

Statement of Significance The Union Monument meets National Register criterion A and is significant within the context of "Civil War Monuments in Kentucky, 1861-1935." This simple monument was erected in 1914 adjacent to the portion of Cave Hill Cemetery that contains the burials of Civil War soldiers. It was erected by other Kentucky Union veterans to commemorate those unknown soldiers buried in the plot. It is a good example of the property type "tombstone."

Verbal Boundary Description - The Union Monument whose boundaries form a circle with a radius of ten feet centered on the monument located in the National Cemetery portion of Cave Hill Cemetery.

Verbal Boundary Justification - The area associated with the monument is restricted to the ground on which the monument sits and a small buffer around it. The setting outside such a restricted area is not seen as critically important to maintaining an integrity of association. Because the focus of the multiple property submissions is the significance of the monuments, their proposed area of listing will reflect that they have been considered by-and-large, in isolation from their surrounds.

United States Department of the Interior
National Park Service

NATIONAL REGISTER OF HISTORIC PLACES
CONTINUATION SHEET

Union Monument
Jefferson County, Kentucky

Section number _9_

Page 1

Books:

Baruch, Mildred, C. And Ellen J. Beckman, Civil War Union Monuments, (Washington, D. C., Daughters of Union Veterans of the Civil War, 1978)

Coulter, E. Merton, The Civil War and Readjustment in Kentucky, (Chapel Hill, University of North Carolina Press, 1926)

Harrison, Lowell, H., The Civil War in Kentucky, (Lexington, University of Kentucky Press, 1975)

Kleber, John E., etal, The Kentucky Encyclopedia, (Lexington, University Press of Kentucky, 1992)

McConnell, Stuart, Glorious Contentment: The Grand Army of the Republic, 1865-1900, (Chapel Hill, NC, University of North Carolina Press, 1992)

Tapp, Hambelton and James C. Klotter, Kentucky: Decades of Discord: 1865-1900, (Frankfort, KY, Kentucky Historical Society, 1977)

Thomas, Samuel W., Cave Hill Cemetery: A Pictorial Guide and Its History, (Louisville, 1985).

CAVE HILL CEMETERY
"Youth and beauty, the strong man and the feeble, the rich and the poor, the loved one and the stranger, gather here."

"Let the place of graves be rural and beautiful. Let it be under the free air and the cheerful light of heaven."

"Let trees be planted there. Let the opening year invite to their branches the springing leaf and birds of song, and when the leaves and birds are gone, let the winds summon from their boughs sweet and melancholy strains."

"Let the tokens of fond remembrance in the shrub and flower be there. Let the murmuring of the gentle rill be there."

"There let the rising sun cast westward the shadows, admonishing us of life's decline, and then let the evening shadows point to the eastern sky, in promise of another and brighter day."

"Amidst everchanging beauty and harmony where decay and renovation of nature may perpetually remind us that we must die, and that to die is to live again. There, let the dust return to earth as it was."

Dedicatory Address
 by Rev. E.P. Humphrey, D.D.
 July 24, 1848

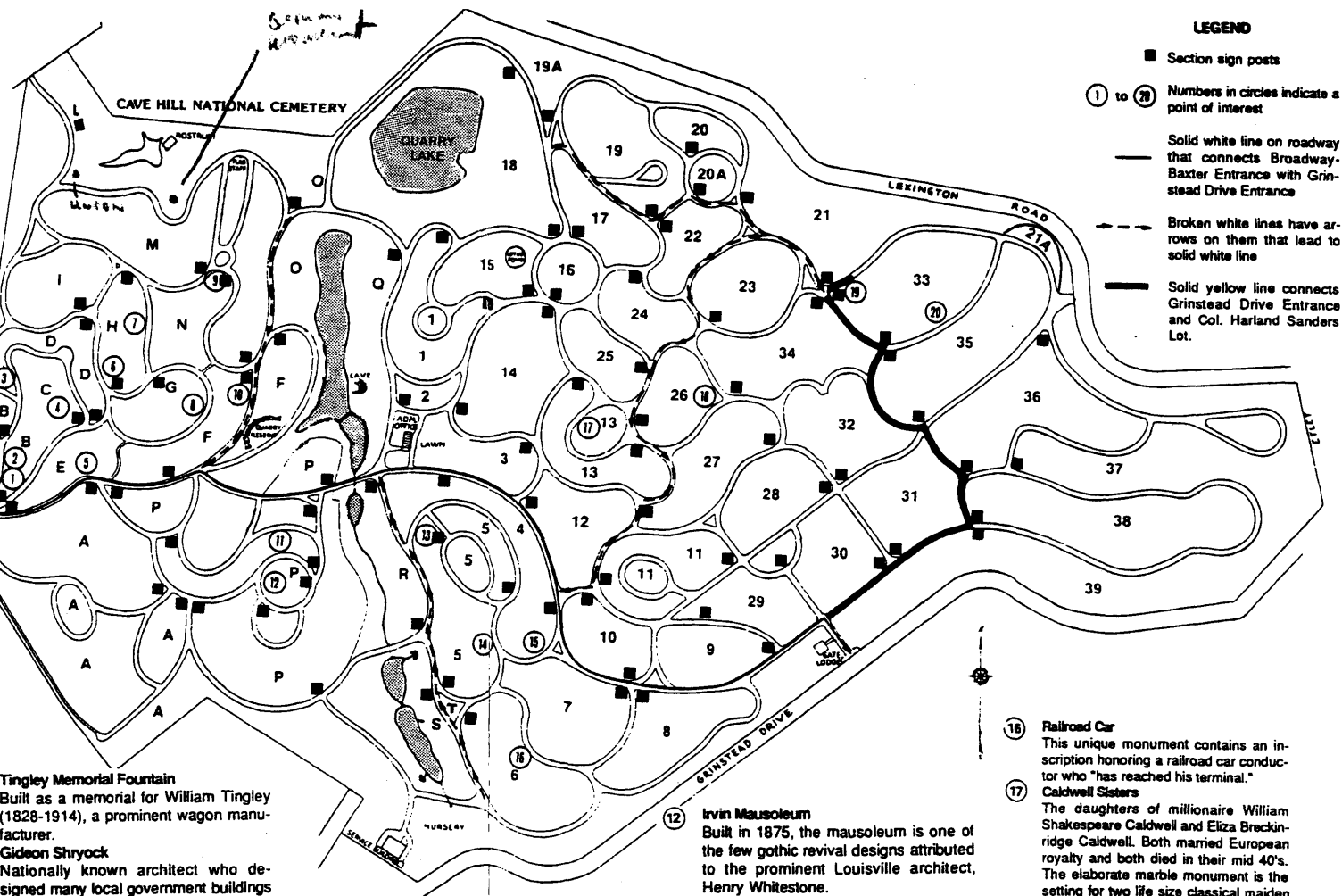

LEGEND

- Section sign posts
- ① to ⑳ Numbers in circles indicate a point of interest
- Solid white line on roadway that connects Broadway-Baxter Entrance with Grinstead Drive Entrance
- - - Broken white lines have arrows on them that lead to solid white line
- Solid yellow line connects Grinstead Drive Entrance and Col. Harland Sanders Lot.

POINTS OF INTEREST

- ① **Wilder Lot**
This monument is the work of Robert E. Launitz, "The father of monumental art in America," and was built in memory of Minnie, the Wilder's only child, who died at the age of seven.
- ② **James Guthrie**
Mr. Guthrie was prominent in local, state and national affairs, and was president of L & N Railroad.
- ③ **Lithgow Monument**
Features marble sculptures of Gabriel and four figures representing Faith, Hope, Mercy and Religion.
- ④ **Preston Pope Satterwhite**
The lot contains the "Temple of Love," which was built in 1927-28 as a memorial to Mrs. Satterwhite. The dome shelters a statue of Aphrodite, the Goddess of Love.

- ⑤ **Tingley Memorial Fountain**
Built as a memorial for William Tingley (1828-1914), a prominent wagon manufacturer.
- ⑥ **Gideon Shryock**
Nationally known architect who designed many local government buildings including the County Court House.
- ⑦ **Rustic Shelter House**
Cave Hill's first office built during the Civil War.
- ⑧ **Douglass Lot**
The family donated land to Cave Hill with stipulation that they be permitted to have a fence around their lot.
- ⑨ **Tiffany Vase**
This monument was designed by Tiffany's of New York.

- ⑩ **Jim Porter**
The "Kentucky Giant" was a Louisville coffee house owner and stood 7 feet 8 inches in height (or as he jocularly expressed it, 6 feet 20 inches tall).
- ⑪ **George Rogers Clark**
The "Founder of Louisville" and "Washington of the West" who was originally buried at his home in Locust Grove and reburied in Cave Hill in 1869.

- ⑫ **Irvin Mausoleum**
Built in 1875, the mausoleum is one of the few gothic revival designs attributed to the prominent Louisville architect, Henry Whitestone.
- ⑬ **Elks Rest**
A life size bronze elk stands on this lot which was purchased for the burial of members of this fraternal organization.
- ⑭ **Nicola Mershall**
Creator of the Confederate uniform and flag of the Confederacy. Portrait painter of Jefferson Davis and Abraham Lincoln.
- ⑮ **Schoolhouse Monument**
This miniature schoolhouse monument honors the lot owner, who was a teacher.

- ⑯ **Railroad Car**
This unique monument contains an inscription honoring a railroad car conductor who "has reached his terminal."
- ⑰ **Caldwell Sisters**
The daughters of millionaire William Shakespeare Caldwell and Eliza Breckinridge Caldwell. Both married European royalty and both died in their mid 40's. The elaborate marble monument is the setting for two life size classical maiden statues.
- ⑱ **J. Graham Brown Mausoleum**
Prominent Louisville businessman and philanthropist.
- ⑲ **Col. Harland Sanders**
Founder of Kentucky Fried Chicken Company. The columned monument features a bronze bust, done by the Colonel's daughter Margaret.
- ⑳ **Gheens Mausoleum**
Features the Lord's Supper on the stained glass window to the rear of the sarcophagus.