

UNITED STATES DEPARTMENT OF THE INTERIOR
NATIONAL PARK SERVICE

FOR NPS USE ONLY

RECEIVED OCT 10 1979

DATE ENTERED

10/19/79

NATIONAL REGISTER OF HISTORIC PLACES
INVENTORY -- NOMINATION FORM

SEE INSTRUCTIONS IN HOW TO COMPLETE NATIONAL REGISTER FORMS
TYPE ALL ENTRIES -- COMPLETE APPLICABLE SECTIONS

1 NAME

HISTORIC

Herndon, Dr. H.C., House

AND/OR COMMON

Sunrise Acres

2 LOCATION

STREET & NUMBER

Ky. 227 (Rt.#3) north of Great Crossing Village

NOT FOR PUBLICATION

CITY, TOWN

Georgetown

VICINITY OF

CONGRESSIONAL DISTRICT

6

STATE

Kentucky

CODE

021

COUNTY

Scott

CODE

209

3 CLASSIFICATION

CATEGORY	OWNERSHIP	STATUS	PRESENT USE
<input type="checkbox"/> DISTRICT	<input type="checkbox"/> PUBLIC	<input checked="" type="checkbox"/> OCCUPIED	<input type="checkbox"/> AGRICULTURE <input type="checkbox"/> MUSEUM
<input checked="" type="checkbox"/> BUILDING(S)	<input checked="" type="checkbox"/> PRIVATE	<input type="checkbox"/> UNOCCUPIED	<input type="checkbox"/> COMMERCIAL <input type="checkbox"/> PARK
<input type="checkbox"/> STRUCTURE	<input type="checkbox"/> BOTH	<input type="checkbox"/> WORK IN PROGRESS	<input type="checkbox"/> EDUCATIONAL <input checked="" type="checkbox"/> PRIVATE RESIDENCE
<input type="checkbox"/> SITE	PUBLIC ACQUISITION	ACCESSIBLE	<input type="checkbox"/> ENTERTAINMENT <input type="checkbox"/> RELIGIOUS
<input type="checkbox"/> OBJECT	<input type="checkbox"/> IN PROCESS	<input checked="" type="checkbox"/> YES: RESTRICTED	<input type="checkbox"/> GOVERNMENT <input type="checkbox"/> SCIENTIFIC
	<input type="checkbox"/> BEING CONSIDERED	<input type="checkbox"/> YES: UNRESTRICTED	<input type="checkbox"/> INDUSTRIAL <input type="checkbox"/> TRANSPORTATION
		<input type="checkbox"/> NO	<input type="checkbox"/> MILITARY <input type="checkbox"/> OTHER:

4 OWNER OF PROPERTY

NAME

Mrs. J.M. Taylor, Mr. J.M.F. Taylor

STREET & NUMBER

Route 2

CITY, TOWN

Georgetown

VICINITY OF

STATE

Kentucky 40324

5 LOCATION OF LEGAL DESCRIPTION

COURTHOUSE,
REGISTRY OF DEEDS, ETC.

Scott County Courthouse

STREET & NUMBER

East Main Street

CITY, TOWN

Georgetown

STATE

Kentucky 40324

6 REPRESENTATION IN EXISTING SURVEYS

TITLE

Survey of Historic Sites in Kentucky

DATE

1971

FEDERAL STATE COUNTY LOCAL

DEPOSITORY FOR
SURVEY RECORDS

Kentucky Heritage Commission

CITY, TOWN

Frankfort

STATE

Kentucky

7 DESCRIPTION

CONDITION		CHECK ONE	CHECK ONE
<input checked="" type="checkbox"/> EXCELLENT	<input type="checkbox"/> DETERIORATED	<input type="checkbox"/> UNALTERED	<input checked="" type="checkbox"/> ORIGINAL SITE
<input type="checkbox"/> GOOD	<input type="checkbox"/> RUINS	<input checked="" type="checkbox"/> ALTERED	<input type="checkbox"/> MOVED DATE _____
<input type="checkbox"/> FAIR	<input type="checkbox"/> UNEXPOSED		

DESCRIBE THE PRESENT AND ORIGINAL (IF KNOWN) PHYSICAL APPEARANCE

The Henry C. Herndon House faces east toward Kentucky Highway 227. The land surrounding the house provides protection from most of the new construction along the pike. The structure retains much of the visual integrity it must have had at the time of construction.

In keeping with the structure's date, the Herndon House reflects the transition between the Greek Revival and Italianate styles. Paired brick pilasters, painted white, separate the three bays on the main facade. The cornice boasts paired brackets with pendants, as does the one-bay, tetrastyle, pedimented portico. Cast iron hoodmolds top the triple windows.

The main entrance contains a transom and sidelights with panelled aprons beneath. The surround itself is bracketed with side panels and a balcony cover overhead.

The five-bay west elevation differs from the front only in that the pilasters are single and only one window (center bay) contains sidelights. A 20th century porte-cochere projects from the entrance element. The treatment of the door frame is similar to that of the front, but not so elaborate. The two-story gallery on the east side has been enclosed and a modern sunporch added.

At the end of this section is the two-story brick kitchen wing, which appears to be much older than the main block. Although both sections are two stories in height, the kitchen roofline is lower. The window openings are smaller and topped by plain lintels. Two 20th century shed additions flank the kitchen block.

The interior retains much of its original integrity. A circular staircase graces the main entrance hall and the woodwork throughout, although simple, is beautifully carved. The parlor mantle appears to be a later addition.

Four outbuildings are to be included in the nomination. They include the following: a 20th century garage, 19th century frame shed, tenant house and a brick smokehouse. The frame tenant house is 1½ stories in height with a steeply pitched roof and a center door.

The nominated boundaries are set to include the house and 4 outbuildings, three of which are contributing structures, and the land immediately surrounding them necessary to retain the visual qualities of the complex.

8 SIGNIFICANCE

PERIOD

AREAS OF SIGNIFICANCE -- CHECK AND JUSTIFY BELOW

<input type="checkbox"/> PREHISTORIC	<input type="checkbox"/> ARCHEOLOGY-PREHISTORIC	<input type="checkbox"/> COMMUNITY PLANNING	<input type="checkbox"/> LANDSCAPE ARCHITECTURE	<input type="checkbox"/> RELIGION
<input type="checkbox"/> 1400-1499	<input type="checkbox"/> ARCHEOLOGY-HISTORIC	<input type="checkbox"/> CONSERVATION	<input type="checkbox"/> LAW	<input type="checkbox"/> SCIENCE
<input type="checkbox"/> 1500-1599	<input type="checkbox"/> AGRICULTURE	<input type="checkbox"/> ECONOMICS	<input type="checkbox"/> LITERATURE	<input type="checkbox"/> SCULPTURE
<input type="checkbox"/> 1600-1699	<input checked="" type="checkbox"/> ARCHITECTURE	<input type="checkbox"/> EDUCATION	<input type="checkbox"/> MILITARY	<input type="checkbox"/> SOCIAL/HUMANITARIAN
<input type="checkbox"/> 1700-1799	<input type="checkbox"/> ART	<input type="checkbox"/> ENGINEERING	<input type="checkbox"/> MUSIC	<input type="checkbox"/> THEATER
<input checked="" type="checkbox"/> 1800-1899	<input type="checkbox"/> COMMERCE	<input type="checkbox"/> EXPLORATION/SETTLEMENT	<input type="checkbox"/> PHILOSOPHY	<input type="checkbox"/> TRANSPORTATION
<input type="checkbox"/> 1900-	<input type="checkbox"/> COMMUNICATIONS	<input type="checkbox"/> INDUSTRY	<input type="checkbox"/> POLITICS/GOVERNMENT	<input type="checkbox"/> OTHER (SPECIFY)
		<input type="checkbox"/> INVENTION		

SPECIFIC DATES

mid 1850's

BUILDER/ARCHITECT

STATEMENT OF SIGNIFICANCE

Although traditionally said to contain portions of an earlier house on the site, the house now known as "Sunrise Acres" is essentially a large mid-19th century residence that vividly represents the transition from pure Greek Revival to the more ornamented Italianate style of the period.¹ The main block of the house was constructed for Dr. Henry C. Herndon, a prominent local physician in Scott County, Kentucky.

Henry Clay Herndon (1815-1891), son of John and Patsy Herndon from Orange County, Virginia, was born in Scott County, Kentucky. He attended Georgetown College and was one of the first graduates of that institution in 1833. After two years at Transylvania University, he began the practice of medicine in Chicot County, Arkansas. Dr. Herndon returned to Scott County after one and one-half years and located in the northern section. After three years, in 1851, he moved to this 276-acre farm near Great Crossing, and lived here until his death.

Basically Greek Revival in shape, the Herndon House exemplifies a well-designed transition to the Italianate style. The attenuated columns and pilasters, the paired brackets, and pendants on the cornice, the lavish cast iron hoodmolds over single and triple windows, all give a later Victorian character to the cubic Grecian block. The interior, with much of the original woodwork remaining, lends added significance to the site.

¹Some sources state that this was also the site of an earlier house, built by James Johnson, an early settler of Scott County.

UNITED STATES DEPARTMENT OF THE INTERIOR
NATIONAL PARK SERVICE

**NATIONAL REGISTER OF HISTORIC PLACES
INVENTORY -- NOMINATION FORM**

FOR NPS USE ONLY	
RECEIVED	OCT 10 1979
DATE ENTERED	APR 10 1980

Herndon, Dr. H.C., House
Scott County, Kentucky

CONTINUATION SHEET

ITEM NUMBER 9 PAGE 2

Perrin, William H. (ed.) History of Fayette County. Chicago: 1882, p.843.

Scott County deed and will books.

"Scott County Woman's Club Holiday Heritage Tour and Wassail."
Pamphlet, Georgetown, December 2-3, 1972.

UNITED STATES DEPARTMENT OF THE INTERIOR
NATIONAL PARK SERVICE

**NATIONAL REGISTER OF HISTORIC PLACES
INVENTORY -- NOMINATION FORM**

Herndon, Henry C., House
Scott County
Kentucky

CONTINUATION SHEET

ITEM NUMBER 10 PAGE 2

FOR NPS USE ONLY	
RECEIVED	APR 7 1980 10
DATE ENTERED	

Verbal Boundary Description:

Beginning at the northwest corner of the service road southeast of the house (see U.S.G.S. map) and Ky. 227, extending southwest along the service road for 300', northwest 300' along the fence line, northeast 300' along fence line to Ky. 227, southeast along the west side of Ky. 227 to the point of origin.

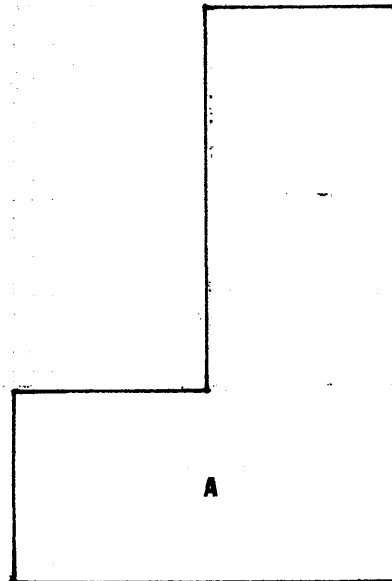
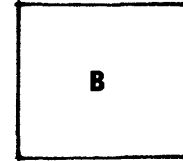
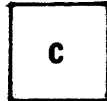
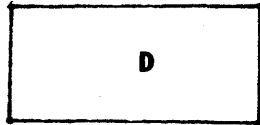

Henry C. Herndon House
Scott County, Kentucky
Jayne Henderson
Kentucky Heritage Commission
Frankfort, Kentucky
Diagram 1
A. Main house
B. Garage
C. Smokehouse
D. Tenant house
E. Frame shed

Not to scale

