

United States Department of the Interior
National Park Service

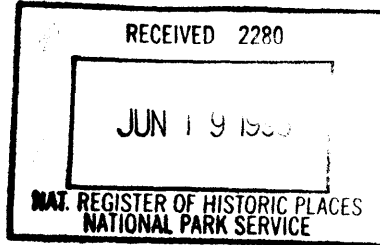

National Register of Historic Places
Registration Form

This form is for use in nominating or requesting determinations for individual properties and districts. See instructions in *How to Complete the National Register of Historic Places Registration Form* (National Register Bulletin 16A). Complete each item by marking "x" in the appropriate box or by entering the information requested. If an item does not apply to the property being documented, enter "N/A" for "not applicable." For functions, architectural classification, materials, and areas of significance, enter only categories and subcategories from the instructions. Place additional entries and narrative items on continuation sheets (NPS Form 10-900a). Use a typewriter, word processor, or computer, to complete all items.

1. Name of Property

historic name Etowah Historic District

other names/site number n/a

2. Location

street & number roughly bounded by 5th St., Washington Ave., 11th St., and Indiana Ave. not for publication

city or town Etowah vicinity

state Tennessee code TN county McMinn code 107 zip code 37331

3. State/Federal Agency Certification

As the designated authority under the National Historic Preservation Act, as amended, I hereby certify that this nomination request for determination of eligibility meets the documentation standards for registering properties in the National Register of Historic Places and meets the procedural and professional requirements set forth in 36 CFR Part 60. In my opinion, the property meets does not meet the National Register criteria. I recommend that this property be considered significant nationally statewide locally. (See continuation sheet for additional comments.)

Herbert L. Hays 6/12/96
Signature of certifying official/Title Date

Deputy State Historic Preservation Officer/ Tennessee Historical Commission
State of Federal agency and bureau

In my opinion, the property meets does not meet the National Register criteria. (See continuation sheet for additional comments.)

Signature of certifying official/Title Date

State or Federal agency and bureau

4. National Park Service Certification

I hereby certify that the property is:

- entered in the National Register. See continuation sheet.
- determined eligible for the National Register See continuation sheet.
- determined not eligible for the National Register.
- removed from the National Register.
- other, (explain:)

Elson H. Beall
Signature of the Keeper
**Entered in the
National Register**

Date of Action
7-25-96

Etowah historic district
Name of Property

McMinn County, TN
County and State

5. Classification

Ownership of Property
(Check as many boxes as apply)

- private
- public-local
- public-State
- public-Federal

Category of Property
(Check only one box)

- building(s)
- district
- site
- structure
- object

Number of Resources within Property
(Do not include previously listed resources in the count.)

Contributing	Noncontributing	
185	12	buildings
		sites
		structures
		objects
185	12	Total

Name of related multiple property listing
(Enter "N/A" if property is not part of a multiple property listing.)

n/a

Number of contributing resources previously listed in the National Register

0

6. Function or Use

Historic Functions
(Enter categories from instructions)

DOMESTIC: single dwelling
DOMESTIC: secondary structure
EDUCATION: school
SOCIAL: meeting hall
RELIGION: religious facility

Current Functions
(Enter categories from instructions)

DOMESTIC: single dwelling
DOMESTIC: secondary structure
SOCIAL: meeting hall
RELIGION: religious facility
RECREATION: sports facility

7. Description

Architectural Classification
(Enter categories from instructions)

Colonial Revival
Bungalow

Materials
(Enter categories from instructions)

foundation BRICK/CONCRETE
walls weatherboard
aluminum/vinyl/asbestos
roof ASPHALT/METAL
other STUCCO

Narrative Description

(Describe the historic and current condition of the property on one or more continuation sheets.)

Name of Property

County and State

8. Statement of Significance

Applicable National Register Criteria

(Mark "x" in one or more boxes for the criteria qualifying the property for National Register listing.)

[X] A Property is associated with events that have made a significant contribution to the broad patterns of our history.

[] B Property is associated with the lives of persons significant in our past.

[X] C Property embodies the distinctive characteristics of a type, period, or method of construction or represents the work of a master, or possesses high artistic values, or represents a significant and distinguishable entity whose components lack individual distinction.

[] D Property has yielded, or is likely to yield, information important in prehistory or history.

Criteria Considerations

(Mark "x" in all the boxes that apply.)

Property is: n/a

[] A owned by a religious institution or used for religious purposes.

[] B removed from its original location.

[] C a birthplace or grave.

[] D a cemetery.

[] E a reconstructed building, object, or structure.

[] F a commemorative property.

[] G less than 50 years of age or achieved significance within the past 50 years.

Areas of Significance

(Enter categories from instructions)

Architecture

Community Planning & Development

Industry

Period of Significance

1907-1946

Significant Dates

n/a

Significant Person

(Complete if Criterion B is marked above)

n/a

Cultural Affiliation

n/a

Architect/Builder

various

Narrative Statement of Significance

(Explain the significance of the property on one or more continuation sheets.)

9. Major Bibliographical References

Bibliography

(Cite the books, articles, and other sources used in preparing this form on one or more continuation sheets.)

Previous documentation on file (NPS): n/a

[] preliminary determination of individual listing (36 CFR 67) has been requested

[] previously listed in the National Register

[] previously determined eligible by the National Register

[] designated a National Historic Landmark

[] recorded by Historic American Buildings Survey #

[] recorded by Historic American Engineering Record #

Primary location of additional data:

[X] State Historic Preservation Office

[] Other State agency

[] Federal agency

[] Local government

[] University

[] Other

Name of repository:

Etowah Historic District
Name of Property

McMinn County, Tennessee
County and State

10. Geographical Data

Acreage of Property approximately 69 acres

UTM References

(Place additional UTM references on a continuation sheet.)

Etowah, TN 125 SE

1

16	724410	3912190
Zone	Easting	Northing

2

16	724880	3912000
Zone	Easting	Northing

3

16	724520	3911150
Zone	Easting	Northing

4

16	724150	3911410
Zone	Easting	Northing

See continuation sheet

Verbal Boundary Description

(Describe the boundaries of the property on a continuation sheet.)

Boundary Justification

(Explain why the boundaries were selected on a continuation sheet.)

11. Form Prepared By

name/title Karen L. Daniels/ Historic Preservation Planner
organization Southeast Tennessee Development District date January 1996
street & number P. O. Box 4757 telephone 423/266-5781
city or town Chattanooga state Tennessee zip code 37405-0757

Additional Documentation

Submit the following items with the completed form:

Continuation Sheets

Maps

A USGS map (7.5 or 15 minute series) indicating the property's location.

A Sketch map for historic districts and properties having large acreage or numerous resources.

Photographs

Representative black and white photographs of the property.

Additional items

(Check with the SHPO or FPO for any additional items)

Property Owner

(Complete this item at the request of SHPO or FPO.) There are more than 50 property owners. the local news-paper is the :

name Daily Post Athenian
street & number P. O. Box 340 telephone 423/745-5664
city or town Athens state Tennessee zip code 37303-0340

Paperwork Reduction Act Statement: This information is being collected for applications to the National Register of Historic Places to nominate properties for listing or determine eligibility for listing, to list properties, and to amend existing listings. Response to this request is required to obtain a benefit in accordance with the National Historic Preservation Act, as amended (16 U.S.C. 470 et seq.).

Estimated Burden Statement: Public reporting burden for this form is estimated to average 18.1 hours per response including time for reviewing instructions, gathering and maintaining data, and completing and reviewing the form. Direct comments regarding this burden estimate or any aspect of this form to the Chief, Administrative Services Division, National Park Service, P.O. Box 37127, Washington, DC 20013-7127; and the Office of Management Systems (1024-0018), Washington, DC 20503.

United States Department of the Interior
National Park Service

National Register of Historic Places Continuation Sheet

Section number 7 Page 1 Etowah Historic District
McMinn County, Tennessee

Description

The early houses in the Etowah Historic District were built between 1907 and 1910 were of simple frame construction with little architectural ornamentation. Many were plain rectangular plans, although there were also a large number built in the gable front and wing plan. The early houses are predominantly 1 or 1.5 stories, with brick foundations. Roofing was pressed metal tiles, or metal roll roofing. Few original roofs remain, most have been replaced with asphalt shingles.

Houses built after circa 1910 were built with more architectural ornamentation in the Bungalow or Colonial Revival styles. These houses are more elaborate than the earlier houses. Some earlier houses were remodeled into Colonial Revival or Bungalow styles by alterations to porches or the addition of details such as knee brace brackets.

The Colonial Revival houses in the district tend to be 1 or 1.5 story, have weatherboard siding, front porches with classical columns or square supports. They have wood door and window surrounds and cornerboards. Many have transoms over the doors. The roofs vary between gable and hip, most originally had pressed metal shingles or rolled metal roofs, now most have asphalt shingle roofs. There are a few post 1946 Colonial Revival style houses.

The Bungalow style began appearing in Etowah circa 1915 and was the dominant style built in the 1920s. The Bungalows are 1 or 1.5 stories with weatherboard siding, front gable roofs, knee brace brackets, and exposed rafter tails. They have 2/3 or full front porches. Porch columns are tapered posts on brick or stone columns. Roofs originally had wood or asbestos shingles, now they have asphalt shingles.

There are a number of currently vacant lots located within the district boundaries. Most of these lots originally had houses which were built prior to 1925. The houses were vacated after the railroad repair shops were closed and the division headquarters moved. During the 1930s many houses were abandoned because the owners left the community in search of work. The population of Etowah peaked in 1920 at over 4000 residents, this dropped to 3000 in the 1930s and 1940s. The houses which were abandoned were demolished by the city, or burned, and by 1950 these lots had

United States Department of the Interior
National Park ServiceNational Register of Historic Places
Continuation SheetSection number 7 Page 2 Etowah Historic District
McMinn County, Tennessee

become side yards to the remaining residences. The vacant lots do not detract from the district because they help explain the effects of the closing of the one industry, the railroad, in the community.

The buildings which contribute to the integrity of the district by age, architectural style or association with the early development of the community are marked as contributing resources (c). Those resources which are noncontributing (nc) to the integrity of the district are not yet fifty years old or have been substantially altered.

InventoryEighth Street

1. 516 Eighth Street. Bungalow, c1915. 1 story, brick foundation, weatherboard siding, asphalt shingle gable roof, rectangular plan. (c)
2. 522 Eighth Street. Colonial Revival, c1910. 1 story, brick foundation, weatherboard siding, asphalt shingle pyramid roof, square plan. (c)

Georgia Avenue

3. 500 Georgia Avenue. Colonial Revival, c1910. 1 story, rusticated concrete block foundation, weatherboard siding, asphalt shingle pyramid roof, rectangular plan, round columns, dentil molding on porch. (c)
4. 501 Georgia Avenue. Ranch, c1960. 1 story, concrete foundation, wood and brick veneer siding, asphalt shingle gable roof, rectangular plan, attached carport. (nc)
5. 506 Georgia Avenue. Colonial Revival, c1910. 1 story, rusticated concrete block foundation, aluminum siding, asphalt shingle pyramid roof, rectangular plan, full front porch, replacement column porch supports. (c)

United States Department of the Interior
National Park Service

National Register of Historic Places
Continuation Sheet

Section number 7 Page 3

Etowah Historic District
McMinn County, Tennessee

6. 510 Georgia Avenue. Colonial Revival, c1910. 1.5 story, stuccoed foundation, aluminum siding, irregular plan, full front porch, replacement columns. (c)

Shed. c1980. board and batten siding, metal gable roof. (nc)

7. 511 Georgia Avenue. Bungalow, c1915. 1 story, stone veneer foundation, weatherboard siding, asphalt shingle gable roof, rectangular plan, knee brace brackets, wood porch supports on stone piers, replacement porch balustrade. (c)

Garage. c1920. 1 story, weatherboard siding, brick pier foundations, asphalt shingle gable roof, swing doors. (c)

8. 519 Georgia Avenue. Bungalow, c1915. 1.5 story, stuccoed brick foundation, weatherboard siding, asphalt shingle gable roof, irregular plan, knee brace brackets, front portico, panelled door. (c)

9. 522 Georgia Avenue. Bungalow, c1920. 1 story, brick foundation, vinyl siding, asphalt shingle gable roof, rectangular plan, knee brace brackets, full front porch, tapered wood columns on brick piers. (c)

Shed. c1920. 1 story, weatherboard siding, asphalt shed roof, panel doors. (c)

10. 523 Georgia Avenue. Bungalow, c1915. 1 story, stuccoed foundation, weatherboard siding, asphalt shingle gable roof, rectangular plan, front porch, tapered columns on stuccoed piers, knee brace brackets. (c)

11. 528 Georgia Avenue. Colonial Revival, c1910. 1.5 story, weatherboard siding, asphalt shingle gable roof, rectangular plan, multi-light stationary windows, full front porch with round columns, cornerboards, shed dormer. (c)

United States Department of the Interior
National Park Service

**National Register of Historic Places
Continuation Sheet**

Section number ⁷ _____ Page ⁴ _____

Etowah Historic District
McMinn County, Tennessee

12. 530 Georgia Avenue. Colonial Revival, c.1910. 1 story, brick foundation, weatherboard siding, asphalt shingle pyramid roof, irregular plan, wood window and door surrounds, corner boards, wrap around porch, wood panel doors, returns in gable, replacement porch supports. (c)

Shed. c 1920. 1 story, vertical board siding, asphalt shingle hip roof. (c)

13. 600 Georgia Avenue. Colonial Revival, c1910. 1 story, stuccoed foundation, aluminum siding, asphalt shingle pyramid roof, irregular plan, round porch columns. (c)

14. 613 Georgia Avenue. Bungalow, c1930. 1 story, brick foundation, aluminum siding, asphalt shingle gable roof, rectangular plan, 2/3 front porch. (c)

15. 614 Georgia Avenue. Colonial Revival, c1910. 1 story, brick foundation, weatherboard siding, asphalt shingle pyramid roof, rectangular plan, wood door and window surrounds, cornerboards, replacement porch supports. (c)

16. 615 Georgia Avenue. Colonial Revival, c1915. 1 story, stuccoed foundation, board and batten siding, asphalt shingle hip roof, irregular plan. (c)

17. 619 Georgia Avenue. Colonial Revival, c.1910. 1 story, brick foundation, weatherboard siding, asphalt shingle pyramid roof, rectangular plan. (c)

18. 622 Georgia Avenue. Colonial Revival, c1910. 1 story, brick foundation, asbestos shingle siding, asphalt shingle pyramid roof, irregular plan, round porch columns, returns in gable front. (c)

19. 621 Georgia Avenue. Colonial Revival, c1910. 1 story, brick foundation, weatherboard and brick veneer siding, asphalt shingle pyramid roof, irregular plan, 2/3 front porch. (c)

United States Department of the Interior
National Park Service

**National Register of Historic Places
Continuation Sheet**

Section number 7 Page 5

Etowah Historic District
McMinn County, Tennessee

20. 627 Georgia Avenue. Colonial Revival, c1910. 1 story, brick foundation, weatherboard siding, irregular plan, front porch with metal columns. (c)

21. 628 Georgia Avenue. Bungalow, c1920. 1 story, brick foundation, weatherboard siding, asphalt shingle gable roof, rectangular plan, knee brace brackets, paired wood porch columns on brick piers, wood window surrounds. (c)

22. 631 Georgia Avenue. Colonial Revival, c1910. 1 story, brick foundation, weatherboard siding, asphalt shingle pyramid roof, rectangular plan, wood window and door surrounds. (c)

23. 710 Georgia Avenue. Colonial Revival, c1910. 1 story, brick foundation, weatherboard siding, asphalt shingle gable roof, irregular plan, full front porch. (c)

Garage. c1930. 1 story, concrete foundation, weatherboard siding, asphalt shingle gable roof. (c)

24. 714 Georgia Avenue. Colonial Revival. c1950. 1 story, concrete block foundation, aluminum siding, asphalt shingle gable roof, rectangular plan. (nc)

25. 715 Georgia Avenue. Ranch. c1970. 1 story, concrete block foundation, vinyl siding, asphalt shingle gable roof, rectangular plan. (nc)

26. 721 Georgia Avenue. Bungalow, c1920. 1 story, concrete block foundation, weatherboard siding, asphalt shingle gable roof, rectangular plan, full front porch. (c)

27. 725 Georgia Avenue. Bungalow, c1920. 1 story, concrete block foundation, weatherboard siding, asphalt shingle gable roof, rectangular plan, full front porch. (c)

28. 726 Georgia Avenue. Bungalow, c1920. 1 story, brick foundation, brick siding, asphalt shingle gable roof, rectangular plan. (c)

United States Department of the Interior
National Park Service

**National Register of Historic Places
Continuation Sheet**

Section number 7 Page 6

Etowah Historic District
McMinn County, Tennessee

29. 727 Georgia Avenue. Colonial Revival, c1915. 1 story, brick foundation, weatherboard siding, asphalt shingle pyramid roof, square plan. (c)
30. 731 Georgia Avenue. Bungalow, c1920. 1 story, concrete block foundation, weatherboard siding, asphalt shingle hip roof, irregular plan, full front porch. (c)
31. 800 Georgia Avenue. Bungalow, c1915. 1 story, stuccoed foundation, weatherboard siding, asphalt shingle gable roof, rectangular plan. (c)
32. 805 Georgia Avenue. St. Paul's United Methodist Church. Gothic Revival, c1920. 2 story, brick foundation, brick siding, standing seam metal gable roof, irregular plan, tower. (c)
33. 810 Georgia Avenue. Colonial Revival, c1915. 1 story, brick foundation, aluminum siding, asphalt shingle gable roof, irregular plan. (c)
34. 814 Georgia Avenue. Bungalow, c1915. 1 story, brick foundation, vertical board siding, asphalt shingle gable roof, square plan. (c)
35. 822 Georgia Avenue. Bungalow, c1915. 1 story, brick foundation, weatherboard siding, asphalt shingle gable roof, rectangular plan. (c)
36. 900 Georgia Avenue. Colonial Revival, c1910. 1 story, brick foundation, weatherboard siding, asphalt shingle gable roof, irregular plan. (c)
37. 905 Georgia Avenue. Mobile Home, c1970. 1 story, concrete block foundation, aluminum siding, asphalt shingle gable roof, rectangular plan. (nc)
38. 909 Georgia Avenue. Colonial Revival, c1910. 1 story, brick foundation, asbestos siding, asphalt shingle gable roof, irregular plan. (c)
39. 910 Georgia Avenue. Colonial Revival, c1910. 1 story, brick foundation, weatherboard siding, asbestos shingle gable roof, rectangular plan. (c)

United States Department of the Interior
National Park Service

**National Register of Historic Places
Continuation Sheet**

Section number 7 Page 7

Etowah Historic District
McMinn County, Tennessee

40. 918 Georgia Avenue. Bungalow influence, c1915. 1.5 story, brick foundation, asbestos siding, asphalt shingle gable roof, irregular plan, 2 story corner tower. (c)
41. 919 Georgia Avenue. Colonial Revival, c1910. 1 story, brick foundation, weatherboard siding, asphalt shingle gable roof, irregular plan. (c)
42. 930 Georgia Avenue. Colonial Revival, c1920. 2 story, rusticated concrete block foundation, rusticated concrete block siding, asphalt shingle hip roof, rectangular plan, two story porch with concrete piers. (c)
43. 931 Georgia Avenue. Bungalow, c1915. 1 story, brick foundation, weatherboard siding, asphalt shingle gable roof, rectangular plan. (c)
44. 1000 Georgia Avenue. Bungalow, c1920. 1 story, concrete block foundation, weatherboard siding, asphalt shingle gable roof, rectangular plan. (c)
45. 1005 Georgia Avenue. Colonial Revival, c1910. 1 story, brick foundation, weatherboard siding, asphalt shingle gable roof, irregular plan. (c)
46. 1009 Georgia Avenue. Bungalow, c1920. 1 story, concrete block foundation, weatherboard siding, asphalt shingle gable roof, rectangular plan. (c)
47. 1010 Georgia Avenue. Bungalow, c1915. 1 story, brick foundation, brick siding, asphalt shingle gable roof, rectangular plan. (c)
48. 1013 Georgia Avenue. Bungalow, c1920. 1 story, concrete block foundation, weatherboard siding, asphalt shingle gable roof, rectangular plan. (c)
49. 1014 Georgia Avenue. Bungalow, c1920. 1 story, brick foundation, weatherboard siding, asphalt shingle gable roof, irregular plan. (c)

National Register of Historic Places Continuation Sheet

Section number 7 Page 8

Etowah Historic District
McMinn County, Tennessee

50. 1015 Georgia avenue. Bungalow, c1920. 1 story, brick foundation, asbestos siding, asphalt shingle gable roof, rectangular plan. (c)

51. 1017 Georgia Avenue. Colonial Revival, c1920. 1 story, brick foundation, vinyl siding, asphalt shingle gable roof, rectangular plan. (c)

52. 1021 Georgia Avenue. Bungalow, c1915. 1 story, brick foundation, asbestos siding, asphalt shingle gable roof, rectangular plan. (c)

53. 1022 Georgia Avenue. Bungalow, c1920. 1 story, concrete block foundation, weatherboard siding, asphalt shingle gable roof, rectangular plan. (c)

54. 1026 Georgia Avenue. Bungalow, c1920. 1 story, concrete block foundation, weatherboard siding, asphalt shingle gable roof, irregular plan. (c)

55. 1030 Georgia Avenue. Bungalow, c1920. 1.5 story, brick foundation, brick siding, asphalt shingle gable roof, irregular plan. (c)

56. 1031 Georgia Avenue. Bungalow, c1920. 1 story, concrete block foundation, weatherboard siding, asphalt shingle gable roof, rectangular plan. (c)

Garage. c1915. 1 story, concrete foundation, weatherboard siding, asphalt shingle gable roof, rectangular plan. (c)

Indiana Avenue

57. 500 Indiana Avenue. Elementary School Addition (currently Recreation Center). Craftsman, 1922. 2 story, stuccoed brick foundation, brick siding, asphalt shingle hipped roof, irregular plan, exposed rafters under roof, plaques between first and second floors, concrete steps, round head arches above first story windows, rear addition. (c)

Picnic shelter, c.1985. Asphalt shingle hipped roof. (nc)

United States Department of the Interior
National Park Service

National Register of Historic Places
Continuation Sheet

Section number 7 Page 9

Etowah Historic District
McMinn County, Tennessee

58. 501 Indiana Avenue. Colonial Revival, c1907. 1 story, brick foundation, vinyl siding, asphalt shingle cross gable roof, rectangular plan, tapered brick porch columns, 9 light door. (c)
59. 511 Indiana Avenue. Bungalow, c1915. 1 story, brick foundation, weatherboard siding, asphalt shingle gable roof, rectangular plan, full front porch, tapered columns on brick piers, knee brace brackets. (c)
60. 515 Indiana Avenue. Colonial Revival, c1907. 1 story, stuccoed foundation, weatherboard siding, asphalt shingle cross gable roof, irregular plan, dentil molding on porch, eyebrow dormers, carport addition. (c)
61. 519 Indiana Avenue. Colonial Revival, c1910. 1 story, brick foundation, aluminum siding, asphalt shingle gable roof, rectangular plan, knee brace brackets, full front porch with replacement supports. (c)
62. 521 Indiana Avenue. Colonial Revival, c1915. 1 story, brick foundation, vinyl siding, asphalt shingle gable roof, rectangular plan, full front porch with replacement posts. (c)
63. 600 Indiana Avenue. Ranch, c1970. 1 story, concrete block foundation, vinyl siding, asphalt shingle gable roof, rectangular plan. (nc)
64. 616 Indiana Avenue. Colonial Revival, c1930. 1 story, concrete block foundation, pressed board siding, asphalt shingle gable roof, irregular plan. (c)
65. 619 Indiana Avenue. Bungalow, c1920. 1 story, brick foundation, brick siding, asphalt shingle gable roof, rectangular plan, tapered posts on brick piers, knee brace brackets, sidelights around door. (c)
66. 620 Indiana Avenue. Bungalow, c1925. 1 story, concrete block foundation, asbestos siding, asphalt shingle gable roof, irregular plan, front porch enclosed, knee brace brackets. (c)

United States Department of the Interior
National Park ServiceNational Register of Historic Places
Continuation SheetSection number 7 Page 10Etowah Historic District
McMinn County, Tennessee

67. 727 Indiana Avenue. Bungalow, c1930. 1 story, concrete block foundation, asbestos shingle siding, asphalt shingle gable roof, rectangular plan. (c)
68. 730 Indiana Avenue. Colonial Revival, c1910. 1 story, concrete block foundation, weatherboard siding, asphalt shingle gable roof, rectangular plan. (c)
69. 800 Indiana Avenue. Ranch, c1960. 1 story, stone veneer foundation, aluminum siding, asphalt shingle gable roof, rectangular plan. (nc)
70. 805 Indiana Avenue. Ranch, c1970. 1 story, brick veneer foundation, brick siding, asphalt shingle gable roof, rectangular plan. (nc)
71. 806 Indiana Avenue. Colonial Revival, c1910. 1 story, brick foundation, brick siding, asphalt shingle gable roof, irregular plan. (c)
72. 810 Indiana Avenue. Colonial Revival, c1910. 1 story, brick foundation, vinyl siding, asphalt shingle gable roof, irregular plan. (c)
73. 811 Indiana Avenue. Bungalow, c1935. 1 story, concrete block foundation, asbestos shingle siding, asphalt shingle gable roof, rectangular plan. (c)
74. 812 Indiana Avenue. Colonial Revival, c1910. 1 story, brick foundation, weatherboard siding, asphalt shingle gable roof, irregular plan. (c)
75. 819 Indiana Avenue. Bungalow, c1935. 1 story, concrete block foundation, aluminum siding, asphalt shingle gable roof, rectangular plan. (c)
76. 820 Indiana Avenue. Colonial Revival, c1910. 1 story, brick foundation, weatherboard siding, asphalt shingle pyramid roof, irregular plan. (c)

National Register of Historic Places Continuation Sheet

Section number 7 Page 11

Etowah Historic District
McMinn County, Tennessee

77. 830 Indiana Avenue. Colonial Revival, c1910. 1 story, brick foundation, weatherboard siding, asphalt shingle pyramid roof, square plan. (c)
78. 831 Indiana Avenue. Bungalow, c1930. 1 story, concrete block foundation, weatherboard siding, asphalt shingle pyramid roof, square plan. (c)
79. 900 Indiana Avenue. Bungalow, c1915. 1 story, brick foundation, weatherboard siding, asphalt shingle hip roof, irregular plan, concrete block porch columns. (c)
80. 905 Indiana Avenue. Colonial Revival, c1910. 1 story, brick foundation, weatherboard siding, asphalt shingle gable roof, irregular plan. (c)
81. 911 Indiana Avenue. Colonial Revival, c1910. 2 story, brick foundation, vinyl siding, asphalt shingle gable roof, irregular plan. (c)
82. 930 Indiana Avenue. Colonial Revival, c1910. 1 story, brick foundation, weatherboard siding, asphalt shingle gable roof, irregular plan. (c)
83. 931 Indiana Avenue. Colonial Revival, c1910. 1 story, brick foundation, weatherboard siding, asphalt shingle gable roof, irregular plan. (c)
84. 1009 Indiana Avenue. Colonial Revival, c1910. 1 story, brick foundation, weatherboard siding, asphalt shingle gable roof, irregular plan. (c)
85. 1017 Indiana Avenue. Colonial Revival, c1910. 1 story, brick foundation, weatherboard siding, asphalt shingle gable roof, irregular plan. (c)

Louisiana Avenue

86. 500 Louisiana Avenue. Colonial Revival, c1910. 1 story, brick foundation, asbestos siding, pressed metal pyramid roof, irregular plan, full front porch. (c)

United States Department of the Interior
 National Park Service

National Register of Historic Places
 Continuation Sheet

Section number 7 Page 12

Etowah Historic District
 McMinn County, Tennessee

87. 508 Louisiana Avenue. Colonial Revival, c1910. 1 story, brick foundation, asbestos siding, asphalt shingle gable roof, irregular plan, front corner porch. (c)

88. 524 Louisiana Avenue. Bungalow, c1920. 1 story, brick foundation, weatherboard siding, asphalt shingle gable roof, rectangular plan, front corner porch, knee brace brackets. (c)

89. 530 Louisiana Avenue. Bungalow, c1910. 1 story, rusticated concrete block foundation rusticated concrete block siding, asphalt shingle cross gable roof, rectangular plan, full front porch with square columns, sidelight around door filled in. (c)

90. 825 Louisiana Avenue. Bungalow, c1920. 1 story, concrete block foundation, weatherboard siding, asphalt shingle gable roof, irregular plan. (c)

91. 827 Louisiana Avenue. Colonial Revival, c1910. 1 story, brick foundation, weatherboard siding, asphalt shingle gable roof, irregular plan. (c)

92. 831 Louisiana Avenue. Colonial Revival, c1910. 1 story, brick foundation, weatherboard siding, asphalt shingle gable roof, irregular plan. (c)

United States Department of the Interior
National Park Service

National Register of Historic Places
Continuation Sheet

Section number 7 Page 13

Etowah Historic District
McMinn County, Tennessee

Ninth Street

93. 330 Ninth Street. Shell Gas Station. Streamline, c1930. 1 story, concrete block foundation, concrete block walls, flat roof, rectangular plan, portico over gas pump. (c)

94. 416 Ninth Street. Colonial Revival, c1910. 1 story, brick foundation, weatherboard siding, asphalt shingle pyramid roof, rectangular plan. (c)

95. 419 Ninth Street. Colonial Revival, c1910. 1 story, weatherboard siding, asphalt shingle pyramid roof, rectangular plan. (c)

96. 510 Ninth Street. Colonial Revival. c1960. 1 story, concrete block foundation, asbestos siding, asphalt shingle gable roof, rectangular plan. (nc)

97. 512 Ninth Street. Colonial Revival, c1915. 1 story, weatherboard foundation, weatherboard siding, asphalt shingle gable roof, rectangular plan. (c)

98. 517 Ninth Street. Bungalow, c1915. 1 story, brick foundation, aluminum siding, asphalt shingle gable roof, rectangular plan. (c)

Pennsylvania Avenue

99. 500 Pennsylvania Avenue. Bungalow, c1920. 1.5 story, brick foundation, weatherboard siding, asphalt shingle gable roof, rectangular plan, knee brace brackets, square porch supports. (c)

100. 506 Pennsylvania Avenue. Bungalow, c1920. 1.5 story, brick foundation, weatherboard siding, asphalt shingle gable roof, rectangular plan, round porch supports, knee brace brackets. (c)

101. 510 Pennsylvania Avenue. bungalow, c1920. 1 story, brick foundation, weatherboard siding, asphalt shingle gable roof, rectangular plan, knee brace brackets, square porch columns. (c)

102. 512 Pennsylvania Avenue. Colonial Revival, c1910. 1 story, brick foundation, weatherboard siding, asphalt shingle gable roof, rectangular plan, entrance porch. (c)

National Register of Historic Places Continuation Sheet

Section number 7 Page 14

Etowah Historic District
McMinn County, Tennessee

103. 514 Pennsylvania Avenue. Bungalow, c1920. 1 story, brick foundation, asbestos siding, asphalt shingle gable roof, rectangular plan, tapered wood columns on porch, knee brace brackets, exposed rafters. (c)

104. 526 Pennsylvania Avenue. Bungalow, c1925. 1 story, brick foundation, weatherboard siding, asphalt shingle gable roof, rectangular plan, knee brace brackets, exposed beams, tapered wood porch columns on brick piers. (c)

105. 531 Pennsylvania Avenue. Boy Scout Lodge. Tudor Revival, c1933. 1 story, stone foundation, stone siding, asphalt shingle gable roof, side porch, terraced yard, round arch wood door. (c)

106. 600 Pennsylvania Avenue. Colonial Revival, c1910. 1 story, brick foundation, aluminum siding, asphalt shingle pyramid roof, irregular plan, round columns on wrap around porch. (c)

107. 601 Pennsylvania Avenue. Colonial Revival, c1910. 1 story, brick foundation, aluminum siding, asphalt shingle gable roof, irregular plan, porte-cochere. (c)

108. 609 Pennsylvania Avenue. Bungalow, c1915. 1 story, stuccoed foundation, weatherboard and vertical board siding, asphalt shingle pyramid roof, irregular plan, tapered columns on brick piers. (c)

109. 611 Pennsylvania Avenue. Bungalow, c1930. 1 story, brick foundation, brick siding, asphalt shingle gable roof, irregular plan, brick porch supports on wrap around porch, stuccoed gable over porch, knee brace brackets, some casement windows, porte-cochere. (c)

110. 612 Pennsylvania Avenue. Bungalow, c1920. 1 story, brick foundation, weatherboard siding, asphalt shingle gable roof, irregular plan. (c)

111. 617 Pennsylvania Avenue. Colonial Revival, c1910. 1 story, stuccoed foundation, weatherboard siding, asphalt shingle hip roof, irregular plan, wrap around screened porch. (c)

United States Department of the Interior
National Park Service

National Register of Historic Places Continuation Sheet

Section number 7 Page 15

Etowah Historic District
McMinn County, Tennessee

112. 618 Pennsylvania Avenue. Colonial Revival, c1910. 2 story, brick foundation, vinyl siding, asphalt shingle hip roof, irregular plan, addition above wrap around porch, porch columns on brick piers. (nc, alterations)

113. 623 Pennsylvania Avenue. Colonial Revival, c1910. 1 story, brick foundation, weatherboard siding, asphalt shingle hip roof, irregular plan, wrap around porch with pair wood column supports, wood window and door surrounds, Queen Anne windows. (c)

114. 626 Pennsylvania Avenue. Colonial Revival, c1910. 1.5 story, brick foundation, brick siding, rectangular plan, front porch with paired wood columns, segmentally arched windows, sidelights around door. (c)

115. 630 Pennsylvania Avenue. Ranch, c1965. 1 story, brick foundation, brick siding, asphalt shingle pyramid roof, rectangular plan, front porch with metal supports. (nc)

116. 631 Pennsylvania Avenue. Colonial Revival, c1910. 1 story, stuccoed foundation, aluminum siding, asphalt shingle hip roof, irregular plan, replacement porch columns, Queen Anne windows, wrap around porch. (c)

117. 700 Pennsylvania Avenue. Bungalow, c1930. 1 story, concrete block foundation, asbestos siding, asphalt shingle gable roof, rectangular plan, full front porch. (c)

118. 706 Pennsylvania Avenue. Colonial Revival, c1910. 1 story, brick foundation, weatherboard siding, asphalt shingle pyramid roof, square plan, full front porch. (c)

119. 709 Pennsylvania Avenue. Colonial Revival, c1910. 1 story, brick foundation, weatherboard siding, asphalt shingle gable roof, rectangular plan, full front porch. (c)

120. 710 Pennsylvania Avenue. Colonial Revival, c1910. 1 story, brick foundation, weatherboard siding, asphalt shingle pyramid roof, square plan. (c)

United States Department of the Interior
National Park Service

National Register of Historic Places
Continuation Sheet

Section number 7 Page 16

Etowah Historic District
McMinn County, Tennessee

121. 714 Pennsylvania Avenue. Colonial Revival, c1910. 1 story, brick foundation, weatherboard siding, asphalt shingle gable roof, irregular plan. (c)

Shed. c1920. 1 story, concrete foundation, weatherboard siding, asphalt shingle gable roof. (c)

122. 717 Pennsylvania Avenue. Bungalow, c1930. 1 story, concrete block foundation, concrete block siding, asphalt shingle gable roof, rectangular plan. (c)

123. 721 Pennsylvania Avenue. Bungalow, c1920. 1 story, concrete block foundation, weatherboard siding, asphalt shingle pyramid roof, square plan. (c)

124. 731 Pennsylvania Avenue. Bungalow, c1920. 1 story, concrete block foundation, weatherboard siding, asphalt shingle gable roof, square plan. (c)

125. 800 Pennsylvania Avenue. Colonial Revival, c1910. 1 story, brick foundation, weatherboard siding, asphalt shingle gable roof, irregular plan. (c)

126. 806 Pennsylvania Avenue. Colonial Revival, c1910. 1 story, brick foundation, weatherboard siding, asphalt shingle gable roof, irregular plan. (c)

127. 809 Pennsylvania Avenue. Colonial Revival, c1910. 1 story, brick foundation, weatherboard siding, asphalt shingle pyramid roof, square plan. (c)

128. 810 Pennsylvania Avenue. Colonial Revival, c1910. 1 story, brick foundation, weatherboard siding, asphalt shingle gable roof, rectangular plan. (c)

129. 814 Pennsylvania Avenue. Colonial Revival, c1910. 1 story, brick foundation, weatherboard siding, asphalt shingle gable roof, irregular plan. (c)

130. 817 Pennsylvania Avenue. Colonial Revival, c1910. 1 story, brick foundation, vinyl siding, asphalt shingle gable roof, irregular plan. (c)

National Register of Historic Places Continuation Sheet

Section number 7 Page 17

Etowah Historic District
McMinn County, Tennessee

131. 818 Pennsylvania Avenue. Colonial Revival, c1910. 1 story, brick foundation, weatherboard siding, pressed metal shingle gable roof, irregular plan. (c)
132. 821 Pennsylvania Avenue. Colonial Revival, c1910. 1 story, brick foundation, weatherboard siding, corrugated metal gable roof, rectangular plan. (c)
133. 822 Pennsylvania Avenue. Colonial Revival, c1910. 1 story, brick foundation, weatherboard siding, asphalt shingle gable roof, irregular plan. (c)
134. 825 Pennsylvania Avenue. Colonial Revival, c1910. 1 story, brick foundation, weatherboard siding, asphalt shingle gable roof, irregular plan. (c)
135. 827 Pennsylvania Avenue. Bungalow, c1920. 1 story, concrete block foundation, asbestos siding, asphalt shingle gable roof, irregular plan. (c)
136. 830 Pennsylvania Avenue. Colonial Revival, c1910. 1 story, brick foundation, weatherboard siding, asphalt shingle gable roof, irregular plan. (c)
137. 900 Pennsylvania Avenue. Colonial Revival, c1910. 1 story, brick foundation, asbestos siding, asphalt shingle gable roof, irregular plan. (c)
138. 906 Pennsylvania Avenue. Colonial Revival, c1920. 2 story, brick foundation, brick siding, asphalt shingle gable roof, irregular plan. (c)
139. 909 Pennsylvania Avenue. Bungalow, c1915. 1 story, brick foundation, aluminum siding, asphalt shingle gable roof, rectangular plan. (c)
140. 910 Pennsylvania Avenue. Colonial Revival, c1910. 1 story, brick foundation, aluminum siding, asphalt shingle gable roof, irregular plan. (c)
141. 913 Pennsylvania Avenue. Colonial Revival, c1910. 1 story, brick foundation, weatherboard siding, asphalt shingle gable roof, irregular plan. (c)

National Register of Historic Places Continuation Sheet

Section number 7 Page 18

Etowah Historic District
McMinn County, Tennessee

142. 918 Pennsylvania Avenue. Colonial Revival, c1910. 1 story, brick foundation, vinyl siding, asphalt shingle gable roof, irregular plan. (c)
143. 920 Pennsylvania Avenue. Colonial Revival, c1910. 1 story, brick foundation, weatherboard siding, asphalt shingle gable roof, rectangular plan. (c)
144. 923 Pennsylvania Avenue. Colonial Revival, c1910. 1 story, rusticated concrete block foundation, rusticated concrete block siding, asphalt shingle gable roof, rectangular plan. (c)
145. 926 Pennsylvania Avenue. Bungalow, c1920. 1 story, concrete block foundation, weatherboard siding, asphalt shingle gable roof, irregular plan. (c)
146. 930 Pennsylvania Avenue. Colonial Revival, c1910. 1 story, brick foundation, weatherboard siding, asphalt shingle gable roof, irregular plan. (c)
147. 1000 Pennsylvania Avenue. Bungalow, c1920. 1 story, concrete block foundation, asbestos siding, asphalt shingle gable roof, rectangular plan. (c)
148. 1001 Pennsylvania Avenue. Colonial Revival, c1910. 1 story, brick foundation, weatherboard siding, asphalt shingle gable roof, irregular plan. (c)
149. 1010 Pennsylvania Avenue. Colonial Revival, c1910. 1 story, brick foundation, asbestos siding, asphalt shingle gable roof, irregular plan. (c)
150. 1014 Pennsylvania Avenue. Bungalow, c1930. 1 story, concrete block foundation, asbestos siding, asphalt shingle gable roof, rectangular plan. (c)
151. 1015 Pennsylvania Avenue. Colonial Revival, c1910. 1 story, brick foundation, weatherboard siding, asphalt shingle gable roof, irregular plan. (c)
152. 1020 Pennsylvania Avenue. Bungalow, c1920. 1 story, brick foundation, brick siding, asphalt shingle gable roof, rectangular plan. (c)

United States Department of the Interior
National Park Service

**National Register of Historic Places
Continuation Sheet**

Section number 7 Page 19

Etowah Historic District
McMinn County, Tennessee

153. 1021 Pennsylvania Avenue. Colonial Revival, c1910. 1 story, brick foundation, vinyl siding, asphalt shingle hip roof, irregular plan. (c)

154. 1022 Pennsylvania Avenue. Colonial Revival, c1910. 1 story, brick foundation, vinyl siding, asphalt shingle hip roof, rectangular plan. (c)

155. 1023 Pennsylvania Avenue. Colonial Revival, c1910. 1 story, brick foundation, weatherboard siding, asphalt shingle gable roof, irregular plan. (c)

156. 1030 Pennsylvania Avenue. Colonial Revival, c1910. 1 story, brick foundation, aluminum siding, asphalt shingle hip roof, irregular plan. (c)

Seventh Street

157. 526 Seventh Street. Bungalow, c1930. 1 story, concrete block foundation, asbestos siding, asphalt shingle hip roof, rectangular plan, front porch with square columns. (c)

158. 530 Seventh Street. Tudor Revival, c1915. 1 story, brick foundation, brick siding, clay tile gable roof, irregular plan, portico. (c)

Sixth Street

159. 400 Sixth Street. Colonial Revival, c1910. 1 story, brick foundation, weatherboard siding, aluminum windows, asphalt shingle pyramid roof, irregular plan, Ionic columns on porch. (c)

160. 417 Sixth Street. Bungalow, c1915. 1 story, brick foundation, weatherboard siding, asphalt shingle hip roof, rectangular plan, brackets, exposed beams, front porch with tapered columns on brick piers. (c)

161. 422 Sixth Street. Colonial Revival, c1910. 1.5 story, concrete foundation, aluminum siding, asphalt shingle hip roof, rectangular plan, shed roof dormer, 2/3 front porch. (c)

National Register of Historic Places Continuation Sheet

Section number 7 Page 20

Etowah Historic District
McMinn County, Tennessee

162. 431 Sixth Street. Colonial Revival, c1910. 1 story, stuccoed foundation, aluminum siding, asphalt shingle pyramid roof, irregular plan, wrap around porch, partially enclosed porch, returns in gable. (c)

163. 523 Sixth Street. Bungalow, c1915. 1 story, brick foundation, weatherboard siding, asphalt shingle gable roof, rectangular plan, knee brace brackets, tapered posts on brick piers. (c)

164. 560-A Sixth Street. Colonial Revival, c1915. 1 story, brick foundation, pressed board (on addition) and weatherboard siding, asphalt shingle gable roof, rectangular plan, side carport, small rear addition. (c)

165. 600 Sixth Street. Colonial Revival, c1910. 1 story, stuccoed foundation, asbestos siding, asphalt shingle gable roof, rectangular plan, front entrance porch, side addition. (c)

166. 621 Sixth Street. Ranch, c1970. 1 story, brick veneer foundation, brick veneer siding, asphalt shingle gable roof, rectangular plan. (c)

167. 623 Sixth Street. Bungalow, c1930. 1 story, brick foundation, weatherboard siding, asphalt shingle cross gable roof, irregular plan, porte-cochere, tapered wood columns on brick piers, full front porch, exposed rafter ends, sidelights around door. (c)

Washington Avenue

168. 610 Washington Avenue. Colonial Revival, c1910. 1.5 story, brick foundation, weatherboard siding, asphalt shingle gable roof, rectangular plan, enclosed front porch, gable dormer, wood window surrounds. (c)

169. 614 Washington Avenue. Colonial Revival, c1920. 1 story, stuccoed foundation, weatherboard siding, asphalt shingle gable roof, rectangular plan. (c)

170. 618 Washington Avenue. Colonial Revival, c1910. 1 story, brick foundation, weatherboard siding, asphalt shingle gable roof, irregular plan, enclosed porch. (c)

**United States Department of the Interior
 National Park Service**

**National Register of Historic Places
 Continuation Sheet**

Section number 7 Page 21

Etowah Historic District
 McMinn County, Tennessee

171. 622 Washington Avenue. Bungalow, c1920. 1 story, brick foundation, aluminum siding, asphalt shingle gable roof, rectangular plan, knee brace brackets, replacement porch posts. (c)

172. 626 Washington Avenue. Colonial Revival, c1910. 2 story, brick foundation, weatherboard siding, asphalt shingle gable roof, rectangular plan, square porch supports. (c)

173. 630 Washington Avenue. Colonial Revival, c1910. 1 story, brick foundation, weatherboard siding, asphalt shingle gable roof, irregular plan, sidelights around door, square column porch supports. (c)

Garage. c1915. 1 story, weatherboard siding, asphalt shingle gable roof, concrete foundation. (c)

174. 700 Washington Avenue. Colonial Revival, c1910. 2 story, brick foundation, aluminum siding, asphalt shingle gable roof, irregular plan. (c)

175. 706 Washington Avenue. Colonial Revival, c1910. 2 story, brick foundation, asbestos siding, asphalt shingle hip roof, irregular plan. (c)

176. 714 Washington Avenue. Colonial Revival, c1910. 1 story, brick foundation, weatherboard siding, asphalt shingle gable roof, irregular plan. (c)

177. 718 Washington Avenue. Colonial Revival, c1910. 1 story, brick foundation, aluminum siding, asphalt shingle gable roof, irregular plan. (c)

178. 720 Washington Avenue. Bungalow, c1915. 1 story, brick foundation, brick siding, asphalt shingle gable roof, rectangular plan. (c)

179. 830 Washington Avenue. First Baptist Church. Colonial Revival, c1920. 2 story, brick foundation, brick siding, asphalt shingle cross gable roof, irregular plan. (c)

United States Department of the Interior
National Park ServiceNational Register of Historic Places
Continuation SheetSection number 7 Page 22Etowah Historic District
McMinn County, Tennessee

180. 900 Washington Avenue. Colonial Revival, c1910. 1 story, brick foundation, weatherboard siding, asphalt shingle gable roof, rectangular plan. (c)
181. 906 Washington Avenue. Colonial Revival, c1910. 1 story, brick foundation, brick siding, asphalt shingle gable roof, rectangular plan. (c)
182. 910 Washington Avenue. Bungalow, c1920. 1 story, brick foundation, weatherboard siding, asphalt shingle gable roof, rectangular plan. (c)
183. 914 Washington Avenue. Bungalow, c1930. 1 story, concrete block foundation, asbestos siding, asphalt shingle gable roof, rectangular plan. (c)
184. 918 Washington Avenue. Colonial Revival, c1910. 1 story, brick foundation, weatherboard siding, asphalt shingle pyramid roof, square plan. (c)
185. 922 Washington Avenue. Colonial Revival, c1910, 1 story, brick foundation, weatherboard siding, asphalt shingle gable roof, rectangular plan. (c)
186. 926 Washington Avenue. Bungalow, c1915. 2 story, brick foundation, weatherboard siding, asphalt shingle gable roof, rectangular plan. (c)
187. 930 Washington Avenue. Colonial Revival, c1915. 1 story, brick foundation, weatherboard siding, asphalt shingle gable roof, irregular plan. (c)
188. 1000 Washington Avenue. Bungalow, c1915. 2 story, brick foundation, weatherboard siding, asphalt shingle gable roof, square plan. (c)

United States Department of the Interior
National Park Service

National Register of Historic Places Continuation Sheet

Section number 8 Page 23 Etowah Historic District
McMinn County, Tennessee

Significance

The Etowah Historic District is eligible for the National Register of Historic Places under criteria A and C for significance in industry, community planning and development, and architecture. The district represents the earliest phase of Etowah's development beginning in 1907 when construction on the railroad brought hundreds of people to the boggy farmland. The district contains the residential part of Etowah designed by Louisville & Nashville (L&N) Railroad Civil Engineers and plated in 1907. The residential development of the district followed the plan.

Etowah was designed by engineers with the L&N Railroad. Their names are currently unknown, as they did not sign the maps which were kept in Etowah, or the ones recorded at the McMinn County courthouse. The town was designed to have separate residential, commercial and industrial sections. The industrial area was located east of Tennessee Avenue. The commercial area was located on the west side of Tennessee Avenue between Eleventh Street and Second Street. There was some commercial space on Ohio Avenue between Ninth Streets and Sixth Street. Residential development filled the rest of the plan.

The city blocks were 240 x 400 feet with north/south streets named after states, and East/West streets numbered. A 15 foot wide alley runs North/South through each block. Building lots are 50 feet wide by 120 feet deep.

The Etowah Historic District contains most of the residential areas designated in the original plat for Etowah registered in 1907. The original plan began at Third Street and ended at Eleventh Street. The first Etowah Addition, registered in 1908, contained the area north of Third Street, and the Second Etowah Addition, registered in 1909, contained the area south of Eleventh Street. The areas between the district boundaries and the original plat boundaries were excluded from this nomination due to numerous alterations which affected the integrity of the areas.

The original plat also contained areas for commercial and industrial development. The commercial development was originally located on the west side of Tennessee Avenue, some side streets extending from Tennessee Avenue, and parts of Ohio Avenue. These areas have been substantially altered since developed, and lack historic integrity. The industrial area was located east of Tennessee Avenue, and has been altered significantly due to the changing technology of the railroad industry. The industrial section does not have historic integrity.

United States Department of the Interior
National Park Service

National Register of Historic Places Continuation Sheet

Section number 8 Page 24 Etowah Historic District
McMinn County, Tennessee

Etowah was one of many communities created by the railroad industry in the United States. As railroads laid more track into areas which were not developed, and as they worked to make the industry more efficient, they created towns to house the workers. These towns were planned by engineers from the railroad incorporating the latest progressive community planning ideas. Some railroads kept possession of the towns while others sold workers the houses.

The district is significant in industry because it represents the growth of the railroad in east Tennessee, especially in Etowah where the railroad was the primary source of employment. In the early twentieth century the L&N Railroad and the Southern Railroad were competing for business on the routes between Cincinnati and Atlanta. The L&N had an existing route through east Tennessee that went through the Hiwassee River Gorge. The gorge created problems because of a 1400 foot elevation difference between the banks of the river. To make the elevation change the Bald Mountain Loop had been constructed in the 1880s. This route slowed trains on the L&N line. To make their route more efficient the L&N decided to move their main line west to avoid the gorge.

The L&N identified two sites in southeast Tennessee along the new line to build repair shops and place a division headquarters. One location considered by the railroad was at Tellico Junction (now Englewood, McMinn County), a textile town. The mill owners at Tellico Junction did not want to sell land to the railroad. The L&N then approached the Wetmore family about land near Delano, in Polk County. The family decided not to sell their farm because it was a favorite vacation spot. The railroad then found a location between the two sites where the owners were willing to sell and the development of Etowah began.

The L&N moved its repair shops from Blue Ridge, Georgia (on the old line) to Etowah. This centralized operations. The old line continued to be used, because it served the copper mines and acid plants in the Copper Basin in southeast Polk County.

The L&N railroad operated in Etowah beginning in 1907. The repair shops performed repairs on the wooden cars used at the time. The railroad continued to expand in the 1910s adding workers to the repair shops and increasing the number of trains running through Etowah. By 1920 there were over 4000 people in Etowah, most of them dependent on the railroad for their jobs. When World War I began the federal government took over the railroads, increased wages and safety, and shortened hours.

United States Department of the Interior
National Park Service

National Register of Historic Places Continuation Sheet

Section number 8 Page 25 Etowah Historic District
McMinn County, Tennessee

After World War I, when control of the railroads returned to the companies, they found their profits had decreased. To help improve the bottom line the companies cut wages and increased hours. Also during this time the railroads began to use steel cars, replacing wooden ones. In 1922 the railroads attempted to cut wages again, and this precipitated the nationwide shopmen's strike which began in July 1922. The workers in the Etowah shops joined the strike, and remained out for seven months.

In 1925, in a wave of consolidations, the Etowah and Knoxville divisions were consolidated into one division based in Knoxville. This was a blow to Etowah, which was accustomed to the prestige of being division headquarters. Many in the town felt that it was being punished by the L&N for participating in the 1922 strike. Actually the move was part of an effort to increase efficiency on the part of the L&N, similar to the effort that had created Etowah years before.

Beginning in 1927 the L&N began laying off shop workers in the Etowah repair shops as more of its stock was steel. By 1932 all the workers in the Etowah shops were laid off or had been transferred elsewhere. The departure of the railroad crippled Etowah's economy since the railroad was the only industry in the town, and the major employer. Many people left Etowah after the shops closed. The loss of the L&N jobs, combined with the pressures of the Great Depression caused the two banks in the town to close. Many commercial establishments closed, and many people deserted their homes. Etowah did not begin to recover until the 1950s when other industries, primarily textile, began to come to town.

Etowah is significant to the architectural history of McMinn County because most of its housing was built in the twenty-five year period between 1905 and 1930, and because it is a large collection of workers housing.

People could purchase land from the Real Estate division of the L&N Railroad, the Louisville Property Company. The railroad did not build any houses for workers in Etowah, all the commercial and residential development was done by individuals.

The houses were primarily built in two architectural styles, the Colonial Revival was dominant between 1910 and circa 1920, and the Bungalow was dominant in new construction after circa 1920. Because there was no attempt to segregate people by occupation, the housing and the detailing on housing is mixed throughout the district.

All the housing in the district is now single family, there are no duplexes.

United States Department of the Interior
National Park Service

National Register of Historic Places Continuation Sheet

Section number 8 Page 26 Etowah Historic District
McMinn County, Tennessee

Until the 1930s boarding houses were common in Etowah. There were several large boarding houses (non-extant) near Tennessee Avenue outside of the residential district, and many families had one or two boarders.

The Colonial Revival houses tend to have little architectural embellishment, and are frequently a cross of Queen Anne floor plans, forms, and wraparound porches with Colonial Revival detailing such as gable returns, classical columns, and transoms. This was a fairly common phenomenon in the late nineteenth and early twentieth centuries as the popularity of the Queen Anne declined.

The Bungalow style houses began appearing circa 1915 and was the most common style of house built after 1920. These houses tend to have much more detailing than the Colonial Revival houses. These details include knee brace brackets, exposed rafter ends, and massive porch supports on brick piers.

The other communities in McMinn County developed over a longer period than Etowah did, and therefore do not possess the architectural cohesiveness of Etowah. This makes Etowah distinct in the county.

The Etowah historic district has a unique history in McMinn County as a planned industrial community. It is eligible for the National Register of Historic Places under criterion A for the growth and changes which the railroad industry which created it, and under community planning and development as a planned community which retains its historic features of its original plan. The district is also eligible under criterion C as a distinct group of architecturally related buildings that are good representations of the popular Bungalow and Colonial Revival styles.

United States Department of the Interior
National Park ServiceNational Register of Historic Places
Continuation SheetSection number 9 Page 27Etowah Historic District
McMinn County, TennesseeBibliography

- Akins, Bill, ed. Hard Times Remembered: A Study of the Depression in McMinn County. Athens, TN: McMinn County Historical Society, 1983.
- "Birth of a City." Polk County News. 8 June 1978.
- "Boarding Houses and Hotels Were Many." Etowah Enterprise, 16 August 1956.
- Byrum, C. Stephen. McMinn County. Memphis, TN: Memphis State University Press, 1984.
- Caldwell, Linda Damron, et. al. Growing Up With the L&N. Etowah, TN: Etowah Arts Commission, 1989.
- Clayton, Vallie. Oral Interview 24 October 1988 by Sandra Brewer.
- "Coca-cola has been bottled here since 1924." Etowah Enterprise, 16 August 1956.
- Deeds, McMinn County, Tennessee.
- Etowah, McMinn County, Tennessee. Sanborn Map Company, 1916.
- Etowah, McMinn County, Tennessee. Sanborn Map Company, 1925.
- Etowah, McMinn County, Tennessee. Sanborn Map Company, 1930.
- Etowah, McMinn County, Tennessee. Sanborn Map Company, 1937.
- Farris, Robert E. Chronology of the Samuel K. Farris Family. unpublished manuscript at the Etowah Arts Commission.
- Fourteenth U. S. Census. Town of Etowah, McMinn County, Tennessee, Third Civil District, 1920.
- Keith, Charles Fleming. A Review of McMinn County, Tennessee 1819-1963. n.d.
- "Industrial Development of Etowah Has Come in Past Few Years." Etowah Enterprise, 16 August 1956.

United States Department of the Interior
National Park Service

National Register of Historic Places Continuation Sheet

Section number 9 Page 28 Etowah Historic District
McMinn County, Tennessee

Jones, James B., Jr. The Development of Motor Tourism in Tennessee's Southeastern Corridor, Circa 1910-1945: A Case Study Exploring Options for the Recognition and Preservation of Cultural Resources Associated with One Aspect of the More Recent Past. Nashville, TN: Tennessee Historical Commission, Study Unit Number 11, 1991.

"Making of a City." Chattanooga News-Free Press. 28 May 1978.

McMinn County, Tennessee Citizens Handbook. Etowah, TN: Mountain View Elementary School, 1971.

Semi-Weekly Post 16 December 1922.

Thirteenth U. S. Census. McMinn County, Tennessee, Third Civil District, 1910.

Tilford, John E. L&N: It's First 100 Years. New York: Newcomer Society in North America, 1951.

"Twelve Point Program." Etowah Enterprise, 2 August 1956.

Wiggins, Genevieve & Bill Akins, eds. "Over Here" and After: McMinn County During World War I and the Twenties. Athens, TN: McMinn County Historical Society, 1986.

United States Department of the Interior
National Park Service

National Register of Historic Places Continuation Sheet

Section number 10 Page 29 Etowah Historic District
McMinn County, Tennessee

Verbal Boundary Description and Justification

The Etowah Historic District is roughly bounded by Fifth Street, Indiana Avenue, Eleventh Street, and Washington Avenue. It contains buildings on the west side of Washington Avenue between Sixth Street and 11th Street (even street numbers between 610 and 1000 Washington Avenue); buildings on Pennsylvania Avenue between Fifth Street and Eleventh Street (street numbers 500-1030 Pennsylvania Avenue); buildings on Georgia Avenue between Fifth Street and Eleventh Street (street numbers 500-1031 Georgia Avenue); buildings on both sides of Indiana Avenue between Fifth Street and Seventh Street, east side of street between Seventh Street and Eighth Street, both sides of street between Eighth Street and Tenth Street, and east side of street between Tenth Street and Eleventh Street; and buildings on both sides of Louisiana Avenue between Fifth Street and Sixth Street, and on the east side between Eighth Street and Ninth Street. See attached Etowah, McMinn County, Tennessee tax map.

The boundaries of the Etowah Historic District were drawn to encompass most of the residential properties in the original plat of Etowah registered in 1907. Areas with many vacant lots or buildings which have been substantially altered have been excluded. The area contains a high number of historic buildings which retain integrity.

United States Department of the Interior
National Park Service

**National Register of Historic Places
Continuation Sheet**

Section number _____ Photo _____ Page 30

Etowah Historic District
McMinn County, Tennessee

Etowah Historic District
Etowah, McMinn County, Tennessee
Photo by: Karen L. Daniels
Date: January 1995
Negatives: Tennessee Historical Commission
Nashville, Tennessee

#1 of 25
Pennsylvania Avenue South from Ninth Street.

#2 of 25
Pennsylvania Avenue South from Ninth Street.

#3 of 25
Pennsylvania Avenue South from Sixth Street.

#4 of 25
918 Georgia Avenue--site 40.

#5 of 25
930 Georgia Avenue--site 42.

#6 of 25
Georgia Avenue South from Ninth Street.

#7 of 25
Indiana Avenue North from Ninth Street.

#8 of 25
Pennsylvania Avenue North from 7th Street.

#9 of 25
Indiana Avenue North from 6th Street.

#10 of 25
Sixth Street from Indiana Avenue.

#11 of 25
Sixth Street from Indiana Avenue.

#12 of 25
Indiana Avenue from site 57.

United States Department of the Interior
National Park Service

**National Register of Historic Places
Continuation Sheet**

Section number _____ Photo _____ Page 31

Etowah Historic District
McMinn County, Tennessee

#13 of 25

Louisiana Avenue from site 57.

#14 of 25

500 Indiana Avenue--site 57.

#15 of 25

Georgia Avenue South from Sixth Street

#16 of 25

Georgia Avenue North from Sixth Street

#17 of 25

Georgia Avenue South from Seventh Street

#18 of 25

Georgia Avenue between Eighth Street and Ninth Street

#19 of 25

Washington Avenue between Ninth Street and Tenth Street

#20 of 25

Washington Avenue North from Seventh Street

#21 of 25

Georgia Avenue between Fifth Street and Sixth Street

#22 of 25

Indiana Avenue South from Seventh Street

#23 of 25

Eighth Street West from Indiana Avenue

#24 of 25

Indiana Avenue South from Ninth Street

#25 of 25

Louisiana Avenue South from Eighth Street

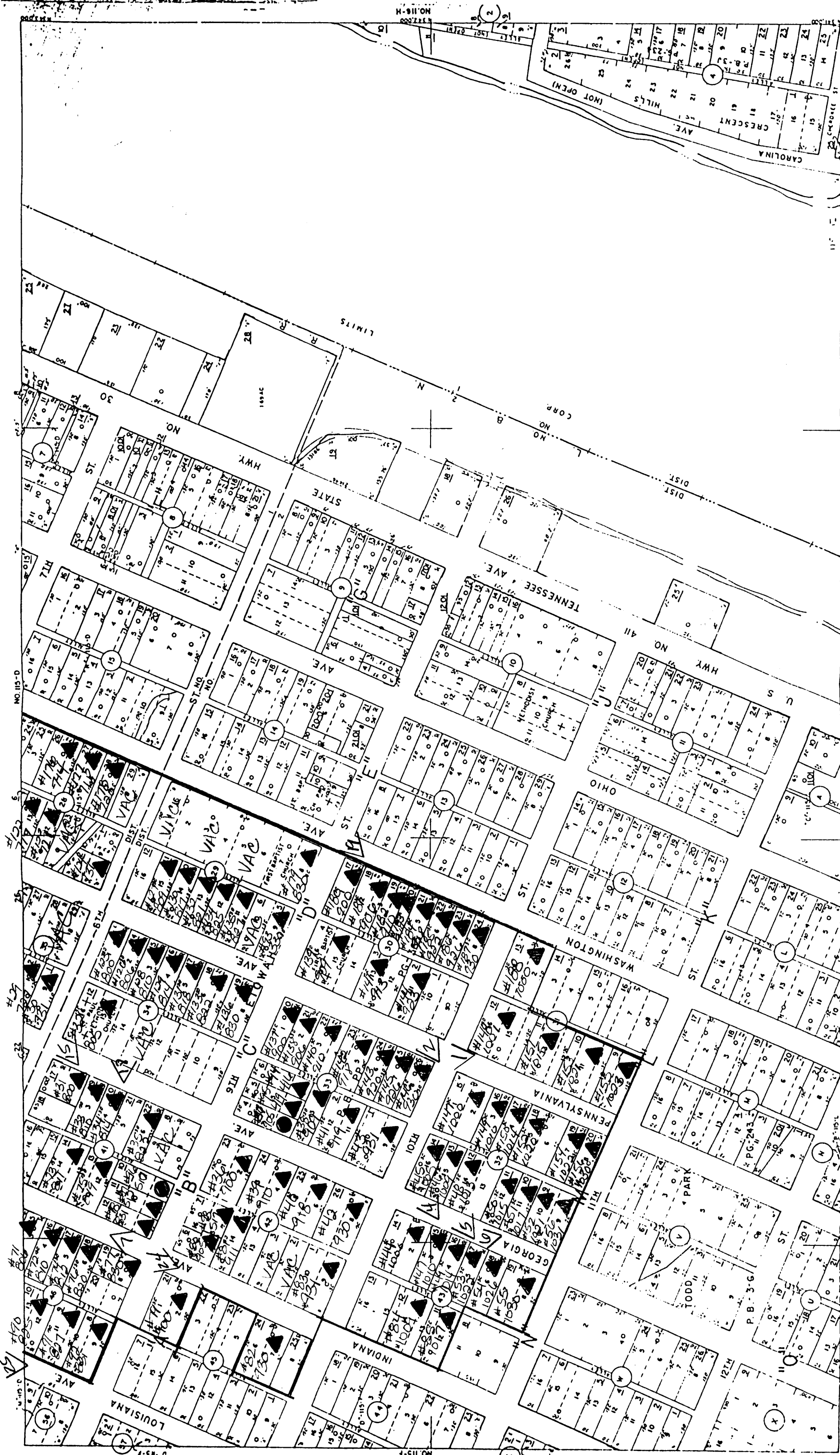

Etowah Historic District
 McMinn County, Tennessee
 Scale: 1" = 100'

PREPARED BY
 TOBIN ROUNTREY, INC.
 1000 ...
 1993 ANALYSIS SYSTEMS, INC.
 1651 AEG DR

- 1 PARCEL NUMBER
- 2 PARCEL HOOK
- 3 INTERIOR TRACT LINE
- 4 DISTRICT LINE
- 5 SUBD. LOT #
- 6 PARCEL OUTLINE
- 7 MAC DEED ACREAGE
- 8 C.A.C. CALCULATED ACREAGE
- 9 IMPROVEMENT
- 10 FENCE
- 11 CEMETERY
- 12 CHURCH
- 13 SCHOOL
- 14 WOODED AREA
- 15 POND
- 16 CREEK
- 17 STATE LINE
- 18 CO LINE
- 19 CORPS LIMITS
- 20 TRANSMISSION LINE
- 21 ROAD
- 22 RAILROAD
- 23 RIDGE LINE

● Contributing Buildings
 ○ Non-contributing Buildings

← Boundary
 < Indicates direction camera facing

115-C	115-D	116-A
115-F	115-E	116-H
115-K	115-L	116-I

REVISIONS	DATE	BY
1	12/17/93	J.R.
2	1/10/94	J.R.
3	1/10/94	J.R.
4	1/10/94	J.R.
5	1/10/94	J.R.
6	1/10/94	J.R.
7	1/10/94	J.R.
8	1/10/94	J.R.
9	1/10/94	J.R.
10	1/10/94	J.R.

SCALE	DATE OF PLOT	DATE COMPILED	MAP NO.
1" = 100'	12/17/93	1/10/94	115-E
ETOWAH			115-E
MCMINN CO TENN			115-E
DISTRICT 1			115-E



Etowah Historic District
McMinn County, Tennessee

PREPARED BY
TOBIN ROUNTREY INC.

©1993 ANALYSIS SYSTEMS, INC.
ST. LOUIS, MO 63103
SAN ANTONIO, TX 78204

(615) 453-0849

● Contributing primary buildings
▲ Noncontributing primary buildings

Scale: 1" = 100'
Boundary

- 31 (C) PARCEL NUMBER
- PARCEL HOOK
- INTERIOR TRACT LINE
- - - DISTRICT LINE
- 29 SUBD. LOT #
- PARCEL OUTLINE
- 24 AC. DEED ACREAGE
- 25 AC. CALCULATED ACREAGE

- 32 (C) PARCEL & CONTROLLING MAP #
- IMPROVEMENT
- - - FENCE
- ☐ CEMETERY
- ☐ CHURCH
- ☐ SCHOOL
- ☐ WOODED AREA
- ☐ POND

- CREEK
- STATE LINE
- CO. LINE
- CORPS LIMITS
- TRANSMISSION LINE
- ROAD
- RAILROAD
- RIDGE LINE

-105-N	-105-M	-106-P
-115-C	-115-D	-116-A
-115-F	-115-E	-116-H

REVISIONS		
1	11-83	11-83
2	12-84	12-84
3	10-72	10-72
4	10-78	10-78
5	12-86	12-86

ETOWAH MCMINN CO. TENN.		MAP NO
SCALE 1" = 100'	DISTRICT 2	115-D
DATE OF PLATING DEC. 1983		
DATE COMPILED JUNE 1, 1985		

< Indicates direction camera facing