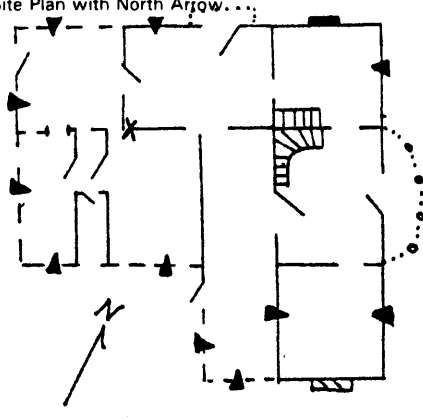

DEC 20 1988

KENTUCKY HISTORIC RESOURCES INVENTORY

Site No. WS-37

1. Historic Name(s) Thos. H. Williams House Original Owner Thomas Head Williams		22. ADD/County Lincoln Trail/Wash. 1115	
2. Present Name As above		23. U.S.G.S. Quadrant (15'/75') Brush Grove 	
3. Location W. side Hardesty Rd., 10 mi. NW of Springfield		24. UTM Reference 16 457460 41184920 Zone Easting Northing	
4. Owner's Name Homer Hardin		25. Coordinate Accuracy 	
5. Owner's Address Rt. 1, Springfield, Ky. 40069		26. Prehistoric Site Object Historic Site Structure Building Other	
6. Open to Public Yes <input type="checkbox"/> No <input checked="" type="checkbox"/>	7. Visible from road Yes <input checked="" type="checkbox"/> No <input type="checkbox"/>	8. Ownership <input checked="" type="checkbox"/> Private <input type="checkbox"/> Local <input type="checkbox"/> State <input type="checkbox"/> Federal	
9. Local Contact/Organization Owner		27. National Register District Name: N/A 	
10. Site Plan with North Arrow... 	11. Architect unknown		28. Significance Evaluation NR
	12. Builder unknown		29. Status _____ Date _____ National Landmark <input type="checkbox"/> National Register <input type="checkbox"/> Landmark Certificate <input type="checkbox"/> Kentucky Survey <input type="checkbox"/> Local Landmark <input type="checkbox"/> HABS/HAER <input type="checkbox"/>
	13. Date 1850-1875A 4 B. <input type="checkbox"/>		
	14. Style A. Greek Rev. C B. <input type="checkbox"/>		
	15. Original Use Sing. fam. res. A		
16. Present use Sing. fam. res.			
17. Condition Good B		30. Historic Theme Primary Architecture C Secondary _____ Other _____	
3. Description 3 bay, 2 story, frame w/external end chimney of brick on NW; chimney removed from SE end; decorative circular porch on facade w/plate at center indicating HOME, NEW YORK; central entrance has sidelights; cornice window heads on facade; all facade windows have sidelights <small>(Continue on Back)</small>		31. Endangered Yes <input type="checkbox"/> No <input checked="" type="checkbox"/>	
19. History According to a local source, the same person built this home that built WS-18. The bricks for the chimneys were fired in a kiln nearby.		32. Preservation Project Status 	
20. Significance This property is significant under criterion C. A unique Greek Revival center-passage house with its tripartite windows and its interior woodwork.		33. ATTACH PHOTO Actual Cost in \$1,000s 	
1. Source of Information A. B. Lewis, Interview, 1/83 WC Deed 108/209; Comm. Deed 5/109		34. Prepared by: Joe DeSpain	
		35. Organization Green Co. Hist. Soc., Inc.	
		36. Date Jan., 1983	
		37. Revision Dates 1/87	
		38. Staff Review	

DESCRIPTION: (cont.) dentil work under cornice resembles scroll rather than rectangular work. INTERIOR: simple Greek Rev. mantels w/oversized pilasters; window and door frames and baseboards are all oversized in width; window and door heads break into 4 sections w/a rounded cornice mold, a plain board, a half round, then a plain board just at the top of the door or window; the central hallway contains an open string spiral staircase w/ simple brackets; 4 paneled window aprons in front rooms; the middle room in the ell are chair rails and door frames w/pronounced architrave w/shoulders. The westernmost room in the ell is a board and batten addition.



KENTUCKY HISTORIC RESOURCE INVENTORY SUPPLEMENT
BOUNDARY AND LOCATION INFORMATION

Historic Property Name Thomas H. Williams House Site # WS-37

Multiple Resource/Thematic Nomination Title Washington County Multiple Resource Area

U.T.M. Coordinates - List multiple UTM's if property is ten or more acres.

A. 16 657460 4184920 D. _____

B. _____ E. _____

C. _____ F. _____

Verbal Boundary Description Acreage approx. 1 acre

Point A is located 70 feet north of the north end of the primary facade of the house. Beginning at point A where a fence intersects the Hardesty Road, proceeding 175 feet southwest from that point to point B, southeast 100 feet with fence to intersection with a fence to point C, then northeast 175 feet with fence to point D, thence 100 ft along Hardesty Rd. to point of origin. The boundaries were drawn to include the house and domestic-related space as defined by fences. There are no outbuildings.

The nominated area contains one contributing building.

Sketch of Site Plan (Showing outbuildings, structures, landscape features and the site boundary as described above.)

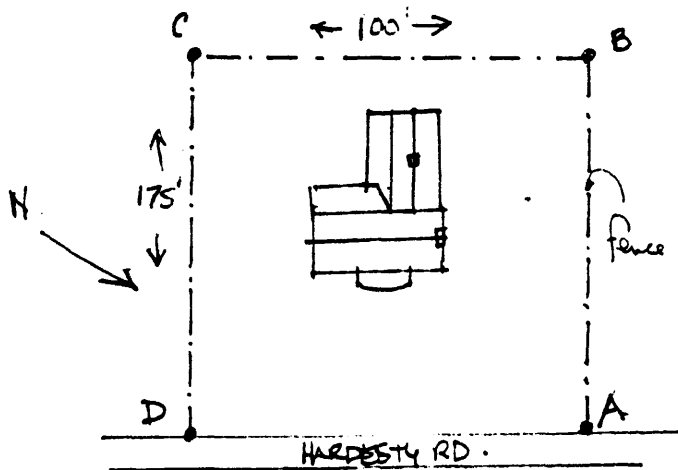

Official Courthouse Property Reference:

Washington County Courthouse, Springfield, Kentucky