

United States Department of the Interior
National Park Service
National Register of Historic Places Registration Form

DEC 04 2015

Nat. Register of Historic Places
National Park Service

This form is for use in nominating or requesting determinations for individual properties and districts. See instructions in National Register Bulletin, *How to Complete the National Register of Historic Places Registration Form*. If any item does not apply to the property being documented, enter "N/A" for "not applicable." For functions, architectural classification, materials, and areas of significance, enter only categories and subcategories from the instructions.

1. Name of Property

Historic name: Pinson Hills Historic District

Other names/site number: N/A

Name of related multiple property listing:
N/A

(Enter "N/A" if property is not part of a multiple property listing)

2. Location

Street & number: Parts of Cedar St., Center Point Rd., Church St., Cole Ave., Leslie Dr., Main St., Mountain St., Pinewood Dr., Pinson St., Silver Lake Road, Spraul Ave., Walnut St.

City or town: Pinson State: AL County: Jefferson

Not For Publication: Vicinity:

3. State/Federal Agency Certification

As the designated authority under the National Historic Preservation Act, as amended,

I hereby certify that this X nomination request for determination of eligibility meets the documentation standards for registering properties in the National Register of Historic Places and meets the procedural and professional requirements set forth in 36 CFR Part 60.

In my opinion, the property X meets does not meet the National Register Criteria. I recommend that this property be considered significant at the following level(s) of significance:

 national statewide X local

Applicable National Register Criteria:

X A B X C D

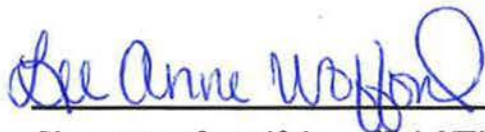

/Deputy State Historic Preservation Officer November 30, 2015

Signature of certifying official/Title:

Date

Alabama Historical Commission

State or Federal agency/bureau or Tribal Government

Pinson Hills Historic District
Name of Property

Jefferson County, AL
County and State

In my opinion, the property ___ meets ___ does not meet the National Register criteria.

Signature of commenting official: **Date**

Title : **State or Federal agency/bureau
or Tribal Government**

4. National Park Service Certification

I hereby certify that this property is:

- entered in the National Register
- determined eligible for the National Register
- determined not eligible for the National Register
- removed from the National Register
- other (explain): _____

Joe Edson H. Beall *1-19-16*
Signature of the Keeper Date of Action

5. Classification

Ownership of Property

(Check as many boxes as apply.)

- Private:
- Public – Local
- Public – State
- Public – Federal

Category of Property

(Check only one box.)

- Building(s)
- District
- Site

Pinson Hills Historic District
Name of Property

Jefferson County, AL
County and State

Structure

Object

Number of Resources within Property

(Do not include previously listed resources in the count)

Contributing	Noncontributing	
<u>107</u>	<u>16</u>	buildings
<u>1</u>	<u> </u>	sites
<u>2</u>	<u> </u>	structures
<u> </u>	<u> </u>	objects
<u>110</u>	<u>16</u>	Total

Number of contributing resources previously listed in the National Register 0

6. Function or Use

Historic Functions

(Enter categories from instructions.)

- DOMESTIC: Single Dwelling, Multiple Dwelling
 - RELIGION: Religious Facility, Church-related Residence
 - FUNERARY: Cemetery
 - EDUCATION: School
 - AGRICULTURE/SUBSISTENCE: Agricultural Outbuilding
- _____
- _____

Current Functions

(Enter categories from instructions.)

- DOMESTIC: Single Dwelling, Multiple Dwelling
 - RELIGION: Religious Facility, Church-related Residence
 - FUNERARY: Cemetery
- _____
- _____
- _____

Pinson Hills Historic District
Name of Property

Jefferson County, AL
County and State

7. Description

Architectural Classification

(Enter categories from instructions.)

LATE VICTORIAN

LATE 19TH CENTURY AND 20TH CENTURY REVIVALS: Classical Revival

LATE 19TH AND EARLY 20TH CENTURY AMERICAN MOVEMENTS:

Bungalow/Craftsman

MODERN MOVEMENT: Ranch Style

OTHER: Minimal Traditional

Materials: (enter categories from instructions.)

Principal exterior materials of the property:

BRICK

CONCRETE

METAL: Tin, Aluminum

WOOD: Weatherboard

ASPHALT

STONE: Limestone

ASBESTOS

SYNTHETIC: Vinyl

Narrative Description

(Describe the historic and current physical appearance and condition of the property. Describe contributing and noncontributing resources if applicable. Begin with a **summary paragraph** that briefly describes the general characteristics of the property, such as its location, type, style, method of construction, setting, size, and significant features. Indicate whether the property has historic integrity.)

The district contains the following street numbers:

Cedar Street

4247, 4276, 4286, 4296

Center Point Road

4204, 4204 (a), 4421, 4421 (a), 4221 (b)

Church Street

4421

Pinson Hills Historic District

Jefferson County, AL
County and State

Name of Property

Cole Avenue

6205, 6210, 6211, 6216, 6225, 6264, 6264 (a), 6279, 6279 (a)

Leslie Drive

6201

Main Street

4397, 4397 (a), 4397 (b), 4403, 4403 (a), 4403 (b), 4407, 4413, 4413 (a), 4420, 4420 (a), 4445, 4455, 4455 (a), 4456, 4461, 4479, 4507

Mountain Street

4325, 4325 (a), 4339, 4374

Pinewood Drive

6424, 6424 (a), 6439, 6449, 6469, 6469 (a), 6470, 6480, 6487, 6487 (a), 6497, 6507, 6510, 6519

Pinson Street

4211, 4211 (a), 4214, 4226, 4231, 4238, 4247, 4248, 4258, 4263, 4263 (a), 4277, 4277 (a), 4282, 4282 (a), 4296, 4296 (a), 4297, 4297 (a), 4311, 4318, 4323, 4337, 4347, 4348, 4357, 4358, 4359

Silver Lake Road

4207, 4225, 4231, 4235, 4239

Spraul Avenue

6207, 6207 (a), 6214, 6214 (a), 6217, 6218, 6218 (a), 6230, 6231, 6244, 6245, 6255, 6268, 6268 (a), 6272, 6275, 6279, 6279 (a)

Walnut Street

4207, 4217, 4227, 4227 (a), 4227 (b), 4233, 4246, 4247, 4247 (a), 4247 (b), 4267, 4285, 4285 (a), 4285 (b), 4285 (c), 6201, 6202, 6211, 6231, 6253

Summary Paragraph

The Pinson Hills Historic District includes approximately forty (40) acres and is within the city limits of Pinson, Jefferson County, Alabama, a suburb located northeast of Birmingham. The area is mostly flat but with some moderate hills. There is one main thoroughfare, Main Street, known historically as the Old Huntsville Road or Clay Pinson Road, and, more recently, as Bud Holmes Road. Pinson Hills Historic District is located in the northeast section of Pinson, and is a predominantly residential district. In addition to residential structures and outbuildings, the district includes the town's only historic school (Inv. #6); two churches including the oldest extant church building in Pinson, the c. 1872 Presbyterian Church (Inv. #5), and the Classical Revival style 1955 Pinson United Methodist Church (Inv. # 26); and a beautiful historic cemetery (Inv. #20) dating to 1876.

Pinson Hills Historic District

Jefferson County, AL

Name of Property

County and State

This district was sparsely settled between 1872 and 1900, with agrarian areas lying just outside the commercial and residential core of Pinson. It evolved into a neighborhood of bungalows and cottages on large lots in the early decades of the twentieth century. After World War II, infill housing comprised largely of Minimal Traditional and Ranch style residences, turned this district into a postwar subdivision that incorporated such earlier resources as the Presbyterian Church (Inv. #5), the cemetery associated with the Methodist Church (Inv. #20), the rubble stone school (Inv. #6), and a variety of early twentieth century houses within its boundaries.

Archaeological Component:

Although a full archaeological survey has not been undertaken throughout Pinson Valley, a partial survey has revealed valuable archaeological resources and further study would likely reveal additional resources.

****Unless indicated by (NC) for Non-contributing resources, all resources will be considered Contributing resources. Sources deemed Non-contributing are those that are less than 50 years old, where remodeling has substantially obscured the historical materials, and/or where additions overwhelm the historical appearance. Examples are buildings that have had a combination of alterations that post-date the POS, such as additional siding, window replacements, porch enclosures, and/or significant front or side additions. One alteration in and of itself does not deem the entire resource as non-contributing.**

Narrative Description

The overall environment of the Pinson Hills Historic District has been rural until the last approximately fifteen (15) years. Since then, suburban development has proceeded primarily because of its proximity to the City of Birmingham and the growth of its suburbs. While the city of Pinson is only sixteen (16) miles northeast of Birmingham it has, until the last fifteen (15) years, moreover, remained a predominantly rural enclave loosely tied to suburban growth in Birmingham. Currently, the town is growing rapidly in a suburban pattern but is also dedicated to preserving its historic character.

The Pinson Hills Historic District includes 126 resources, of which 110 are contributing. The oldest is the c. 1872 Pinson Presbyterian Church (Inv. # 5) and the newest are c. 1960 Ranch style houses (Inv. # 8, 85). The oldest resources are concentrated in the northern and west central portions of the district on Center Point Road, Main Street, and Pinewood Drive. In addition to the c. 1872 weatherboard Presbyterian church, there is one (1) c. late 1910 Victorian era house (Inv. # 21); and twelve (12) c. 1925 houses. Nine (9) houses are simple, one story weatherboard bungalows (Inv. #s 14, 19, 32, 64, 68, 69, 71, 84, 86) scattered evenly throughout the district; three are Craftsman style bungalows including one excellent rubble stone style with a two story rubble stone tenant house/garage (Inv. # 22, 22 a); and one is a late Victorian era hipped cottage (Inv. #23). Except for the hipped cottage, all have front or side gable roofs, and several of these roofs are tin (Inv. # 16).

The remaining houses, which make up the majority, were built c. 1940, c. 1945 and in c. 1950, c. 1955, and c. 1960 during the "baby boom" and suburbanization periods. These include c. 1940 and c. 1945 weatherboard or asbestos shingled bungalows a few having been refaced after the

Pinson Hills Historic District

Jefferson County, AL

Name of Property

County and State

period of significance with vinyl siding; c. 1945 (Inv. #s 15, 17, 25) and c. 1950 (Inv. #s 31, 50) Minimal Traditional styles; or c. 1955 (Inv. #s 37, 38, 52) or c. 1960 (Inv. # 55, 63) mostly brick Ranch style houses. Many have nice wrought iron railing (Inv. # 61), or garage bays (Inv. #58). There is also one c. 1960 (Inv. # 11) variegated brick Ranch style duplex with a hip roof (Inv. # 21).

Most houses have hip, side gable or front gable roofs and double hung wood 2:2, 1:1, 4:4, or 6:6 windows, some of which were replaced after the POS with aluminum. Concrete block or brick foundations are prominent, as are brick chimneys. Many retain front porches though a few have been remodeled.

The district is bounded by Center Point Road, a major thoroughfare, on the west; Pinson Street on the south; Walnut Street, Cole Avenue, and Pinewood Drive on the east; and Church Street on the north. In addition, Bud Holmes Road/Main Street, a major thoroughfare, follows an east to west path and forms a boundary in the northwest portion of the district. The western side of Center Point Road forms the eastern boundary of the Pinson Main Street Historic District; and to the northeast and south is c. 1980 – present residential and suburban development.

Pinson Hills Historic District retains its integrity with regards to location, design, setting, materials, workmanship, feeling, and association.

Location and Setting: The resources in the historic district remain in their original locations. The physical environment of the historic district, although threatened by development and punctured with a few vacant lots, has remained intact since 1960.

Design: The layout and composition of the district reflect residential suburban development patterns prominent from the late 19th century and into the post-World War II era.

Materials: The original materials from the late-19th and early- to mid-20th centuries have been retained in exterior cladding, windows, roofing, and foundation for the majority of the resources in the district. Though a few of the residential resources have added vinyl siding, it does not detract from the district's overall integrity of materials.

Workmanship: The use of wood, concrete, brick, asbestos, and limestone all illustrate the aesthetic principles typical of the late 19th and early-to-mid 20th century religious and residential architectural styles present throughout the district.

Feeling: Pinson Hills Historic District retains a strong sense of feeling, conveying the important role the district played in Pinson's residential development between 1872 and 1960.

Association: Pinson Hills Historic District retains its association with the local establishment and evolution of residential development and architecture between 1872 and 1960.

Pinson Hills Historic District
Name of Property

Jefferson County, AL
County and State

Inventory

Information for the inventory was compiled from historic research and field surveys by Pamela Sterne King, Preservation Consultant between 2013 and 2015.

Cedar Street

1. House. 4247 Cedar Street. c. 1955.
One story Ranch style house with pink brick on the bottom half and weatherboard on the top half, side gable roof, 2:2 double hung wood windows, stoop with a front gable roof with very decorative wrought iron posts, and a rear left elevation wing. There is also a right elevation carport, 2nd entrance stoop with wrought iron posts, and a brick foundation.
2. House. 4276 Cedar Street. c. 1945.
One story Minimal Traditional house oriented on the corner of Cedar Street and Cole Avenue, with 2:2 double hung wood windows, front fixed wood window flanked by 2:2 double hung windows, right open carport, and concrete block foundation. Modern aluminum siding and a metal hip roof post-date the POS.
3. House. 4286 Cedar Street. c. 1950.
One story Ranch style house with wood siding, ½ basement, metal casement windows including at the corners, brick chimney, cut stone sills, entrance bay with a brick tile floor, and a concrete block foundation. There is also a metal hip roof that post-dates the POS.
4. House. 4296 Cedar Street. c. 1950.
One story Ranch style house with brick on the bottom ½ and wood siding on the top ½, hip roof, 2:2 double hung wood windows, right side carport with wrought iron posts, front stoop with a hip roof and wrought iron posts, and concrete block foundation.

Center Point Road

5. Presbyterian Church/now Christ Chapel. 4204 Center Point Road. c. 1872.
One story with basement, weatherboard church with wood knee braces, front gable roof, single pane windows, and a rock foundation. There is a central projecting gabled entrance bay with wood knee braces and wood double doors. A steeple rises from the roof of the entrance bay and is only partially incorporated into it; the steeple is 4-sided with wood vents on each elevation. There is also modern aluminum siding that post-dates the POS.
 - a. c. 1925. Bungalow/Church parish.

Pinson Hills Historic District

Name of Property

Jefferson County, AL

County and State

One story weatherboard bungalow/now church parish with wood knee braces, side gable roof, partial front porch with a front gable, 6:6 double hung wood windows, left side exterior brick chimney, and a brick foundation. There are also a modern standing seam metal roof and vinyl siding that post-date the POS.

6. Pinson School. 4421 Center Point Road. c. 1922; c. 1934; c. 1949; c. 1955; c. 1960. One story rock school building with a central recessed entrance bay. There is a rock soldier course, 6:6 double hung wood windows (covered now with plywood), 4:4 double hung wood windows on the rear, and concrete foundation. The main roof configuration is a hip roof that is punctuated in the center with a side gable roof displaying stuccoed gables over slightly extended bays that flank the central entrance on the facade. There is a c. 1949 rear lunchroom addition with a rounded tin roof and metal casement windows which is connected to the main school by a covered walkway; c. 1955 rear one story concrete block classroom addition; and a c. 1960 concrete block classroom addition.

This is a fine vernacular school that was enlarged during the New Deal with WPA funds and added to during the “baby boom” of the mid- 1950’s – c. 1960 when people were moving to Pinson and enlarging their families, thus requiring larger school facilities.

- a. Athletic field and Dugout. c. 1950.
Grass and dirt athletic field with a one story concrete block dugout that has a flat roof.
- b. Storage Building. c. 1950.
One story concrete block storage building with a front gable and concrete foundation.

Church Street

7. House. 4421 Church Street. c. 1945.
One story weatherboard Minimal Traditional house with a hip roof, 2:2 double hung wood windows, and a concrete block foundation. The recessed entrance faces Pinewood Drive.

Cole Avenue

8. House. 6205 Cole Avenue. c. 1960.
One story Ranch style house clad in weatherboard and Perma-Stone with a side gable roof covered in metal, 2:2 double hung wood windows, massive front chimney clad in Perma-Stone on the right side, Perma-Stone stone on the bottom ½ of the right front bay, recessed stoop bay with wrought iron posts and stone steps.
9. House. 6210 Cole Avenue. c. 1945.

Pinson Hills Historic District

Jefferson County, AL

Name of Property

County and State

- One story Minimal Traditional house with asbestos shingles, side gable roof, 6:6 double hung wood windows, honey brick chimney, partial front porch with a shed roof and exposed rafter tails, and a cement foundation.
10. House. 6211 Cole Avenue. c. 1945.
One story bungalow, side gable roof with two left front gables, 2:2 double hung wood windows, large left side exterior brick chimney, extended front porch with wrought iron posts, and a concrete block foundation. There is also modern vinyl siding that post-dates the POS.
11. Duplex. 6216 Cole Avenue. c. 1960.
One story brown variegated brick duplex with a hip roof, 2:2 double hung wood windows with wood shutters, single front central stoop with two entrances and wrought iron posts, and a brick foundation.
12. House. 6225 Cole Avenue. c. 1955.
One story brick Ranch style house with a hip roof, exterior left elevation brick chimney, left front recessed porch with wrought iron posts and rail, and brick foundation and brick steps.
13. House. 6264 Cole Avenue. c. 1945.
One story Minimal Traditional house with asbestos shingles, hip roof, 2:2 double hung wood windows, left elevation carport, front stoop with a concrete floor, and a concrete foundation.
a. Garage. c. 1945
One story concrete block garage with a front gable with wood vent, original wood and glass garage door, and concrete foundation.
14. House. 6279 Cole Avenue. c. 1925.
One story weatherboard bungalow with a clipped gable roof; 4:1 double hung wood windows; and left side extended bay porch with a clipped gable roof, and rubble stone columns and parapet wall. There is also a brick chimney and a rubble stone foundation.
a. Garage. c. 1925.
One story weatherboard garage with a front gable, exposed rafter tails, and a concrete block foundation.

Leslie Drive

15. House. 6201 Leslie Drive. c. 1945.
One story Minimal Traditional house with wood siding, hip roof, 9:9 and 6:6 double hung wood windows, off center recessed entrance bay, and a concrete block foundation.

Main Street (also known as Bud Holmes Road)

Pinson Hills Historic District
Name of Property

Jefferson County, AL
County and State

16. House. 4397 Main Street. c. 1925.
One story weatherboard bungalow with exposed wood rafters; tin roof, front gable roof; brick foundation; full front porch with a front gable, square brick columns and decorative brick porch wall. There are 2:2 double hung wood windows, and a decorative wood vent in the porch gable.
 - a. Shed. c. 1925.
One story weatherboard building with a front tin gable roof and exposed rafters.
 - b. Garage/Utility Building. c. 1925.
One story garage/utility building with wood siding, exposed rafter tails, and a front gable roof with modern standing seam metal roof that post-dates the POS.

17. House. 4403 Main Street. c. 1945.
One story Minimal Traditional house with a side gable roof, 2:2 double hung wood windows, concrete block foundation, and a carport on the left elevation with a shed roof supported by plain metal posts that post-dates the POS. Modern vinyl siding post-dates the POS.
 - a. Garage. c. 1945.
One story garage with a front gable roof and concrete foundation. Vinyl siding post-dates the POS.
 - b. Shed. (NC) c. 2000.
One story shed with a side gable roof, vinyl siding, off central entrance stoop, and a concrete foundation.

18. House. 4407 Main Street. (NC) c. 2000.
One story house with side gable roof, vinyl siding, extended front entrance bay, 6:6 double hung aluminum windows, and brick foundation.

19. House/now Precious Angels Too Day Care. 4413 Main Street. c. 1925.
One story weatherboard (on the top) and brick (on the bottom that post-dates the POS) bungalow with 2:2 double hung wood windows, central entrance bay, front gable roof, full front porch with c. 1945 wrought iron railing, interior brick chimney and a stucco foundation.
 - a. c. 1945.
One story weatherboard and concrete block garage with a front gable, and concrete block foundation.

20. Marvin's Hills Cemetery. 4420 Main Street. 1876.
Large cemetery with a mainly informal setting with relatively ornate and elaborately carved headstones situated around a narrow dirt road. The earliest graves, dating

Pinson Hills Historic District

Jefferson County, AL

Name of Property

County and State

from 1876 to the 1890s, are mostly in the northern section of the cemetery adjacent to Pinson United Methodist Church. This is an active cemetery.

a. Entrance Wall.

Free standing c. 1955 curved brick, with limestone coping, entranceway off Church Street.

21. House. 4445 Main Street. c. 1910.

One story "L" shaped weatherboard cottage with 4:4 double hung wood windows, cross gable roof, decorative geometric shingles in the front gable, left recessed screened porch bay, and a brick foundation.

22. House. 4455 Main Street. c. 1925.

Craftsman style rubble stone bungalow comprised of a main 1½ story, front gabled block connected to a rear, 2 story, side-gabled block. There are 4:4 double hung wood windows, exposed wood rafter tails, rubble stone chimney, screened front porch with a porte-cochere extending off to its right, and a rubble stone foundation. The front porch and porte-cochere share a secondary roof.

a. c. 1925. Tenant house/garage.

Two story rubble stone tenant house/garage with a front gable roof and 6:6 double hung wood windows.

This property is listed on the Jefferson County Historical Commission Register.

23. House. 4456 Main Street. c. 1925.

One story house with a steep hip roof punctuated by gables on its front and side elevations, central entrance, two interior brick chimneys, and full front porch with square wood columns supporting a shed roof. Modern vinyl siding and 1:1 double hung aluminum windows post-date the POS.

24. House. 4461 Main Street. c. 1945.

One story Minimal Traditional house with a side gable main roof, projecting entrance bay with a stoop and front gable roof, 2:2 double hung wood windows, two interior brick chimneys, and a brick foundation. There is modern vinyl siding that post-dates the POS.

25. House. 4479 Main Street. c. 1945.

One story Ranch style house with a side gable roof, slightly recessed bay stoop with a gable roof on the right end of facade, paired 1:1 double hung wood windows on façade along with a massive off center bottle shaped concrete block chimney, and a brick foundation with a series of metal rectangular vent grills. Vinyl siding post-dates the POS.

Pinson Hills Historic District

Jefferson County, AL

Name of Property

County and State

26. Marvin's Chapel Methodist Church/now Pinson United Methodist Church. 4507 Main Street. 1955.
Two story, with basement, Classical Revival style brick church with a pedimented portico displaying wood modillions, and round wood columns with simple capitals; 8:8 double hung steel windows with cast stone keystones above on the front elevation; round-arched windows on the side elevations with 9:9 double hung steel windows beneath the transom and a central cast stone keystone; central wood steeple with a brick base with circular windows and wood modillions; central double wood entrance in a pedimented frontispiece, and a brick foundation. There is also a rear right two story wing. A modern two story brick addition post-dates the POS.

Mountain Street

27. House. 4325 Mountain Street. (NC) c. 2000.
One story modern "L" shaped log house with a cross gable roof, 1:1 double hung wood windows, loose rock foundation, full front porch with loose rock piers.
a. Garage. (NC) c. 2000.
One story wood garage with a front gable and concrete block foundation.
28. House. 4339 Mountain Street. c. 1945.
One story bungalow with a front gable roof, full front porch with wrought iron railing, 2:2 double hung wood windows, and a concrete block foundation. There is also modern vinyl siding that post-dates the POS.
29. House. 4374 Mountain Street. c. 1950.
One story Ranch style house with asphalt shingles, hip roof, 2:2 double hung wood windows, left side single car garage bay in the foundation bay, right side recessed entrance bay, and concrete block foundation.

Pinewood Drive

30. House. 6424 Pinewood Drive. (NC) c. 1970.
One story house with wood siding, recessed entrance bay, 6:6 double hung aluminum windows, front gable roof, and brick foundation.
a. Garage. c. 1925.
One story garage with a front gable roof; and vinyl siding that post-dates the POS.
31. House. 6439 Pinewood Drive. c. 1950.
One story weatherboard (on sides) Minimal Tradition house with a side gable roof, off center entrance, and concrete block foundation. There is modern vinyl siding on the front façade, 1:1 double hung aluminum windows, and Victorian era-style wood trim that post-dates the POS.
32. House. 6449 Pinewood Drive. c. 1925; c. 1945.

Pinson Hills Historic District

Jefferson County, AL

Name of Property

County and State

- One story bungalow with a side gable roof, c. 1945 asbestos shingles, full front porch with a front gable and large rubble stone columns, rubble stone porch wall, 4:1 double hung wood windows, and a rubble stone foundation.
33. House. 6469 Pinewood Drive. c. 1940.
One story weatherboard (on the sides) "L" shaped house with a brick foundation; side gable main roof as well as a gable on the left front elevation; rear elevation carport; and original wood and glass-pane door. There is also a right side extended porch bay with a front gable. Modern 6:6 double hung aluminum windows and vinyl siding post-date the POS.
- a. House. c. 1925.
One story weatherboard shotgun house with 2:2 double hung wood windows, front gable roof, right elevation entrance, and concrete block foundation piers.
34. House. 6470 Pinewood Drive. c. 1960.
One story "L" shaped house with asphalt shingles, cross gable roof, 6:6 double hung wood windows, front porch with round wood columns, right side carport, and a cement slab foundation.
35. House. 6480 Pinewood Drive. (NC) c. 2000.
One story brick contemporary house with a side gable roof, 1:1 double hung aluminum windows, right side porch, left side garage, and a concrete foundation.
36. House. 6487 Pinewood Drive. c. 1940.
One story L shaped wood house with a cross gable roof, 6:6 double hung aluminum windows, brick foundation, and a right side exterior stone chimney.
- a. House. c. 1940.
One story house with a side gable, two window openings that are boarded up, central entrance, exposed wood rafters, and concrete foundation.
37. House. 6497 Pinewood Drive. c. 1955.
One story brick Ranch style house with a hip roof, 2:2 double hung wood windows, left recessed porch bay with decorative wrought iron rail and posts, and a brick foundation. A wooden access ramp has been installed on the façade that post-dates the POS.
38. House. 6507 Pinewood Drive. c. 1955.
One story Ranch style house with a hip roof, 6:6 double hung wood windows, right side recessed entrance bay with a stoop and wrought iron posts, right side exterior brick chimney, and a brick and stucco foundation. Modern vinyl siding post-dates the POS.
39. House. 6510 Pinewood Drive. c. 1955.

Pinson Hills Historic District

Jefferson County, AL

Name of Property

County and State

One story Ranch style house with asbestos shingles, 6:6 double hung wood windows; front fixed 24 - paned wood "picture" window flanked by 4:4 double hung wood windows; hip roof; interior brick chimney; recessed front porch bay with a brick foundation and wrought iron railing; and a left side carport with wrought iron posts.

40. House. 6519 Pinewood Drive. c. 1955.
One story brick Ranch style house with a hip roof; extended front entrance bay with wrought iron railing and a hip roof; 2:2 double hung wood windows with brick sills; and a brick foundation.

Pinson Street

41. House. 4211 Pinson Street. c. 1945.
One story bungalow with stone veneer; side gable roof; steel casement windows with concrete sills; left front extended porch bay with a wood rail and gable with a front vent; and a brick chimney. There is also a brick foundation.
a. Shed. (NC) c. 1970.
One story prefabricated aluminum shed with a front gable.
42. House. 4214 Pinson Street. c. 1955.
One story brick Ranch style house with a hip roof, 6:6 double hung wood windows, central entrance with a 20-paned fixed wood window flanked by 4:4 double hung wood windows to its right, interior brick chimney, and left side screened porch with a carport on its left side.
43. House. 4226 Pinson Street. c. 1945.
One story Minimal Traditional house with hip roof, 2:2 double hung wood windows, front stoop with a hip roof and wrought iron posts, brick chimney, and concrete block foundation. Modern vinyl siding post-dates the POS.
44. House. 4231 Pinson Street. c. 1955.
One story brick Ranch style house with 8:8 double hung wood windows, right side garage bay, hip roof, brick chimney, left side screened porch, central interior brick chimney, central fixed wood 20-pane window flanked by 4:4 double hung wood windows, recessed front stoop with wrought iron posts and rail, and a concrete foundation.
45. House. 4238 Pinson Street. c. 1955.
One story brick Ranch style house with a garage/basement bay on the right elevation, hip roof, 8:8 double hung wood windows, front recessed stoop with wrought iron posts, interior brick chimney, brick foundation, and a brick retaining wall along the driveway.
46. House. 4247 Pinson Street. c. 1940.

Pinson Hills Historic District

Jefferson County, AL

Name of Property

County and State

- One story Minimal Traditional house with asbestos shingles, hip roof, 6:6 left side double hung wood windows, and a concrete block foundation. The front façade has a front extended screened porch bay with a hip roof and square wood columns, right side “picture” window flanked by 4:4 double hung wood windows, and a right side open terrace with wrought iron rail and concrete floor. There is also a concrete foundation.
47. House. 4248 Pinson Street. c. 1945.
One story L-shaped red brick Ranch style house with a hip roof, front recessed entrance stoop with wrought iron rail, fixed wood windows, concrete slab foundation, and a left side one-car built in garage.
48. House. 4258 Pinson Street. (NC) c. 1975.
One story brown brick house with 12:6 double hung aluminum windows, side gable roof, front stoop, and concrete foundation.
49. House. 4263 Pinson Street. c. 1955.
One story brick Ranch style house with a hip roof, massive front rock chimney on the left elevation, carport on the left elevation, 6:6 double hung wood windows, front extended bay with a hip roof, multiple fixed wood windows flanked by 6:6 double hung wood windows, recessed entrance bay with wrought iron posts, and a concrete foundation.
a. c. 1958. Garage apartment.
Two story rear garage apartment with a side gable roof, 6:6 double hung aluminum windows on the 2nd floor that post-date the POS, and a concrete foundation. It has modern vinyl siding that post-dates the POS.
50. House. 4277 Pinson Street. c. 1950.
One story Minimal Traditional house with a hip roof, 1:1 double hung wood windows, central brick chimney, stone foundation, and a right side carport. Modern vinyl siding post-dates the POS.
a. Garage. c. 1950.
One story weatherboard garage with a side gable roof.
51. House. 4282 Pinson Street. c. 1945.
One story weatherboard Minimal Traditional house with a hip roof, 2:2 double hung wood windows, screened porch with decorative wood framing on the left elevation, and a brick chimney. There is also a concrete block foundation with multiple vents.
a. Garage (NC) c. 1985.
Modern two bay garage with vinyl siding that post-dates the POS.
52. House. 4296 Pinson Street. c. 1955.
One story brick Ranch style house with a hip roof and projecting wood gabled vent, 2:2 double hung wood windows, off center recessed entrance bay with a stoop and wrought iron rail.

Pinson Hills Historic District

Name of Property

Jefferson County, AL

County and State

- a. Tenant house. c. 1955.
One story weatherboard house with a side gable roof, six operational wood windows, and a concrete foundation.
53. House. 4297 Pinson Street. c. 1950.
One story Minimal Traditional house with a hip roof, 2:2 double hung wood windows, fixed wood window flanked by 2:2 double hung wood windows, interior brick chimney on the left elevation, and a concrete foundation. Modern vinyl siding post-dates the POS.
 - a. Garage. c. 1950.
Two bay garage with a front gable, and modern vinyl siding that post-dates the POS.
54. House. 4311 Pinson Street. c. 1955.
One story Ranch style house with a hip roof, 2:2 double hung wood windows with wood shutters, right side front stoop with wrought iron posts, concrete foundation, and a brick chimney. There is brick on the bottom ½, and modern weatherboard on the top ½. There is also an open left side carport with a concrete foundation.
55. House. 4318 Pinson Street. c. 1955.
One story brick Ranch style house with a hip roof, front stoop, right side open carport, brick window sills, and a concrete foundation. Modern 1:1 aluminum windows post-date the POS.
56. House. 4323 Pinson Street. c. 1955.
One story brick (bottom) and asbestos shingle (top) Ranch style house with a hip roof, right side carport, recessed multiple bay front porch with decorative wrought iron posts, 2:2 double hung wood windows, and a concrete foundation.
57. House. 4337 Pinson Street. c. 1945.
One story Minimal Traditional house with wood shingles; 2:2 double hung wood windows; side gable roof; right extended entrance bay with an open porch and four square wood posts with simple wood caps; and a concrete block foundation.
58. House. 4347 Pinson Street. c. 1955.
One story brick Ranch style house with a side gable roof, 6:6 double hung wood windows, brick foundation, and left side bay with built in garage. To the right of the garage is a stoop with square wood columns, wrought iron rail and brick steps.
59. House. 4348 Pinson Street. c. 1955.
One story asbestos shingle and brick (right side) Ranch style house with a side gable roof; 2:2 double hung wood windows; left side carport with wrought iron posts; central extended front bay with a stoop, wrought iron posts and brick steps; right side wing faced with asbestos shingles; and a concrete block foundation.

Pinson Hills Historic District

Jefferson County, AL
County and State

Name of Property

60. House. 4357 Pinson Street. c. 1945.
One story Minimal Traditional house with asbestos shingles; side gable roof; 2:2 double hung wood windows; left side extended garage bay; recessed front porch bay with one square wood column with simple wood cap; and a brick foundation.
61. Robertson House. 4358 Pinson Street. c. 1955.
One story brick Ranch style house with a hip roof, front stoop with a curved wrought iron rail, extended front bay with a stoop and flat roof, and a concrete foundation. Modern 1:1 double hung aluminum windows post-date the POS.
62. House. 4359 Pinson Street. c. 1955.
One story brick Ranch style house with a side gable roof, 2:2 double hung wood windows, right side carport, front stoop, and a concrete foundation.

Silver Lake Road

63. Duplex/ now House. 4207 Silver Lake Road. c. 1955.
One story brick Ranch style house built originally as a duplex. There is a hip roof; 2:2 double hung wood windows; two entrance bay stoops with hip roofs, and wood posts and rail; rear left elevation carport; second carport on the right elevation; and a brick foundation.
64. House. 4225 Silver Lake Road. c. 1925.
One story weatherboard bungalow with a front gable roof, exposed wood rafter tails, 4:1 double hung wood windows, full front porch with square brick columns, and a concrete block foundation.
65. House. 4231 Silver Lake Road. (NC) c. 1975.
One story house that may have been constructed earlier but was completely remodeled c. 1975. It has a hip roof, vinyl siding, brick front, 4:1 double hung aluminum windows, right side built in garage, and a concrete foundation.
66. House. 4235 Silver Lake Road. (NC) c. 1945.
One story L-shaped house with a cross gable roof, concrete block foundation, and recessed porch. It has been substantially remodeled with modern vinyl siding, 1:1 double hung aluminum windows, and partially enclosed porch that post-date the POS.
67. House. 4239 Silver Lake Road. c. 1945.
One story bungalow with a front gable roof with wood vent and clad in asbestos shingles, recessed entrance bay on the left corner that has been enclosed to create a screen porch, 1:1 double hung wood windows, and a concrete block foundation. The front gable roof has a modern standing seam metal that post-dates the POS.

Pinson Hills Historic District
Name of Property

Jefferson County, AL
County and State

Spraul Avenue

68. House. 6207 Spraul Avenue. c. 1940.
One story bungalow with side gable roof; 2:2 double hung wood windows; off center recessed entrance stoop with wrought iron rail and posts that was enclosed with aluminum siding after the POS; brick cheek walls; projecting left side bay left of the entrance with a front gable; and a brick foundation. There is also a fixed wood window flanked by double hung 2:2 wood windows on the right front elevation.
- a. Garage. c. 1940.
One story concrete block garage/storage with a free standing wood carport attached to the front.
69. House. 6214 Spraul Avenue. c. 1925.
One story bungalow with front tin gable roof, brick chimney, 4:1 double hung wood windows, and full front porch with square wood columns. There is also modern aluminum siding that post-dates the POS.
- a. Garage. c. 1925.
One story weatherboard garage with a front gable roof and concrete foundation.
70. Moon House. 6217 Spraul Avenue. c. 1955.
One story brick Ranch style house with a hip roof, left side front stoop with wrought iron posts, 2:2 double hung wood windows, open left side carport, and a brick foundation.
71. House. 6218 Spraul Avenue. c. 1925.
One story weatherboard bungalow with a front tin gable roof, front entrance bay with original wood and screen door, 4:1 double hung wood windows, and a stone foundation.
- a. Garage. c. 1925.
One story weatherboard garage with a front gable roof.
72. House. 6230 Spraul Avenue. c. 1945.
One story bungalow with side gable roof, 4:1 double hung wood windows, attached front porch with a front gable roof that was enclosed in glass after the POS; brick chimney, and a brick foundation. It has modern vinyl siding and a standing seam metal roof that post-date the POS.
73. House. 6231 Spraul Avenue. c. 1955.
One story Ranch style brick house with a side gable roof; front central extended bay with a gable roof and a central single pane window flanked by metal casement windows; metal casement windows throughout; off center interior brick chimney; right side recessed stoop with a gable roof; left end screened porch with a side gable; and a concrete foundation. There is modern vinyl siding and a half-moon window in the front central extended bay that post-date the POS.

Pinson Hills Historic District

Name of Property

Jefferson County, AL

County and State

74. House. 6244 Spraul Avenue. c. 1945.
One story weatherboard bungalow with a side gable roof and exposed wood rafter tails; front attached porch with a front gable roof and square wood columns; exterior brick chimney on the right side; right side entrance bay wing with the original 4:1 wood and glass door, and a concrete foundation.
75. House. 6245 Spraul Avenue. c. 1945.
One story bungalow with wood shingles, a complex hip and gable roof with a front gable with a wood vent, 6:6 double hung wood windows, recessed entrance bay at corner with wrought iron posts, interior brick chimney, and a concrete block foundation.
76. House. 6255 Spraul Avenue. c. 1950.
One story asbestos shingles (top half) and brick (bottom half) Minimal Traditional house with a side gable roof, center brick chimney, 6:6 double hung wood windows, central porch bay with a flat roof and wrought iron posts, and a brick foundation.
77. House. 6268 Spraul Avenue. c. 1950.
One story bungalow with asbestos shingles, 2:2 double hung wood windows, concrete block foundation, and an off central stoop with a brick floor and wrought iron posts. There is also a modern hip metal roof that post-dates the POS.
a. c. 1945. Garage.
One story weatherboard garage with a front gable roof.
78. House. 6272 Spraul Avenue. c. 1950.
One story bungalow with asbestos shingles, hip roof, 2:2 double hung wood windows, left porch bay with a hip roof and square wood columns, and a concrete block foundation.
79. House. 6275 Spraul Avenue. c. 1950.
One story Minimal Traditional house with a gable on hip roof; asbestos shingles; partial front porch with a hip roof and wrought iron columns; and a concrete block foundation. It has modern 9:6 double hung aluminum windows that post-date the POS.
80. House. 6279 Spraul Avenue. c. 1955.
One story concrete block house with a side gable roof, off center entrance bay, and a concrete block foundation. Windows are boarded up.
a. Storage shed/Plumber's Shop. c. 1940.
One story weatherboard storage shed with rear screened bay with a spraddle roof and overhanging eaves, and a concrete foundation. When the main house was built the owner used this building for his plumbing business.

Pinson Hills Historic District

Name of Property

Walnut Street

Jefferson County, AL

County and State

81. House. 4207 Walnut Street. c. 1950.
One story house with oversized bricks, front gable roof with asbestos shingles, front stoop bay with a gable and round wood columns, and a brick foundation. There are modern 6:6 double hung aluminum windows that post-date the POS.
82. House. (NC) 4217 Walnut Street. c. 1990.
One story brick house with a side gable roof, 9:6 double hung aluminum windows, central extended front bay, and a concrete foundation.
83. House. 4227 Walnut Street. (NC) c. 1985
One story brick house with a side gable roof that may have an earlier construction date but was completely remodeled c. 1985. It has modern 9:6 double hung aluminum windows and vinyl siding that post-date the POS.
 - a. Garage. c. 1945.
One story garage with front gable roof and exposed rafters. Modern vinyl siding post-dates the POS.
 - b. House. (NC) c. 1985.
Two story house (possibly constructed earlier but completely remodeled) with vinyl siding, 6:6 double hung aluminum windows, low front gable roof, and large garage bay on the front that post-date the POS.
84. House. 4233 Walnut Street. c. 1925; c. 1945.
One story bungalow with gable on hip roof, wood rafter tails, pairs of 4:4 double hung wood windows, and off center front porch with a front gable and square wood columns on brick piers. There is c. 1945 asbestos shingle siding.
85. House. 4246 Walnut Street. c. 1960.
One story brick Ranch style house with a hip roof; right recessed bay with cut stone surround and brick steps; interior brick chimney; left side carport with pine exterior wall and wrought iron posts; and a brick foundation. It has modern 6:6 double hung aluminum windows and a metal access ramp on the main facade that post-date the POS.
86. House. 4247 Walnut Street. c. 1925.
One story weatherboard bungalow with a front gable roof with exposed wood rafter tails, 4:4 double hung wood windows, full front porch with square wood columns on brick piers, a full-length metal awning, and a concrete block foundation.
 - a. Utility building. c. 1945.
One story concrete block utility building with fixed 4-paned windows and a front gable roof.
 - b. Garage. c. 1925.
One story weatherboard garage with a front gable roof.

Pinson Hills Historic District

Jefferson County, AL

Name of Property

County and State

87. House. 4267 Walnut Street. (NC) c. 1985.
One and ½ story orange brick house with 9:9 double hung aluminum windows, side gable roof with vinyl siding, partial porch with wood posts, and a built in garage.
88. House. 4285 Walnut Street. c. 1945.
One story brick bungalow with a cross gable roof; 2:2 double hung wood windows; right side porch with a gable; garage bay facing the street; and a brick foundation wall. There is also a two story rear addition with brick, as well as, modern vinyl siding that post-dates the POS; 1:1 double hung wood windows; and a flat roof.
- a. Garage/apartment. c. 1945.
Two story garage/apartment with a side gable roof, 6:6 double hung wood windows, side stoop with concrete steps, concrete foundation, and wrought iron posts.
- b. Shed. c. 1945.
One story wood shed with a front gable roof and concrete foundation.
- c. Pool. c. 1945.
In-ground concrete pool.
89. House. 6201 Walnut Street c. 1955.
One story bungalow with Craftsman influences that was refaced with vinyl siding after the POS. There are 6:6 double hung aluminum windows that post-date the POS; side gable roof; full front porch with a brick wall with concrete caps, and a series of four brick piers with tapered wood columns; off center front entrance; and a concrete foundation.
90. House. 6202 Walnut Street c. 1955.
One story Minimal Traditional house with 4:4 and 8:8 double hung wood windows, side gable roof, right front gable over an extended bay, partial recessed bay with a concrete floor and turned mill posts, left octagonal bay, one brick chimney, and brick foundation. There is modern aluminum siding that post-dates the POS.
91. House. 6211 Walnut Street. c. 1945.
One and one half story weatherboard Minimal Traditional house with two gabled front dormers, side gable roof, octagonal left bay, full front porch with a flat roof with round fluted columns, and a brick chimney. There are also 4:4 and 6:6 double hung wood windows, rear stoop with a flat roof, and a brick foundation.
92. House. 6231 Walnut Street (NC) c. 1975.
One story brick Ranch style house with a cross gable roof, recessed entrance, 9:9 double hung wood windows, and a concrete foundation.
93. House. 6253 Walnut Street c. 1955.
One story brick Ranch style house with a hip roof, 2:2 double hung wood windows, right side carport with wrought iron posts, extended front bay with a hipped stoop and wrought iron posts, and a concrete foundation.

Pinson Hills Historic District
Name of Property

Jefferson County, AL
County and State

8. Statement of Significance

Applicable National Register Criteria

(Mark "x" in one or more boxes for the criteria qualifying the property for National Register listing.)

- A. Property is associated with events that have made a significant contribution to the broad patterns of our history.
- B. Property is associated with the lives of persons significant in our past.
- C. Property embodies the distinctive characteristics of a type, period, or method of construction or represents the work of a master, or possesses high artistic values, or represents a significant and distinguishable entity whose components lack individual distinction.
- D. Property has yielded, or is likely to yield, information important in prehistory or history.

Criteria Considerations

(Mark "x" in all the boxes that apply.)

- A. Owned by a religious institution or used for religious purposes
- B. Removed from its original location
- C. A birthplace or grave
- D. A cemetery
- E. A reconstructed building, object, or structure
- F. A commemorative property
- G. Less than 50 years old or achieving significance within the past 50 years

Areas of Significance

(Enter categories from instructions.)

COMMUNITY PLANNING AND DEVELOPMENT
ARCHITECTURE

Pinson Hills Historic District
Name of Property

Jefferson County, AL
County and State

Period of Significance

c. 1872-c.1960

Significant Dates

N/A

Significant Person

(Complete only if Criterion B is marked above.)

N/A

Cultural Affiliation

N/A

Architect/Builder

N/A

Period of Significance (justification)

The period of significance extends from c. 1872 when local Presbyterians built the Presbyterian Church (Inv. # 5) to c. 1960 when Pinson's last residential resources of the post-World War II suburbanization era were built (Inv. # 8, 85).

Statement of Significance Summary Paragraph (Provide a summary paragraph that includes level of significance, applicable criteria, justification for the period of significance, and any applicable criteria considerations.)

The Pinson Hills Historic District is locally significant under **Criterion A: Community Planning and Development**. In c. 1870 this sparsely settled agrarian area lay just outside Pinson, but by the early decades of the twentieth century, it had evolved into a neighborhood of bungalows and cottages on large lots. After World War II, infill housing consisting largely of

Pinson Hills Historic District

Jefferson County, AL

Name of Property

County and State

Minimal Traditional and Ranch style residences turned this district into a postwar subdivision that incorporated such earlier resources as the c. 1872 Presbyterian Church, the c. 1876 cemetery associated with the Methodist Church, as well as its expanded c. 1922 rubble stone school and a variety of early twentieth century houses. By then Pinson Hills had a cohesive, identifiable boundary.

The Pinson Hills Historic District is locally significant under **Criterion C: Architecture** for its collection of architectural styles that are representative of the district's period of significance.

Narrative Statement of Significance (Provide at least **one** paragraph for each area of significance.)

CRITERION A: COMMUNITY PLANNING AND DEVELOPMENT

The resources comprising the Pinson Hills Historic District illustrate the economic development and population growth that occurred in Pinson beginning in the late 19th century and continuing up to c. 1960. A small rural community that eventually became Pinson existed in the Pinson Valley before the Civil War. Nearby farming families established both Presbyterian and Methodist churches and a cemetery here in the late nineteenth century. The opening of the Bradford mines just north of this community, and the coming of two railroads in the 1880s caused a building boom in Pinson. The 1871 founding of Birmingham only 16 miles to the southwest also generated growth in Pinson Valley. Pinson's population grew to 500 by 1900, but, twenty years later, the town could claim over two thousand residents. This growth is represented in the district by a late Victorian cottage (Inv. # 21). However, the paucity of resources dating from this early period probably occurs because other Pinson neighborhoods absorbed this development and because some of this district's early resources were lost to later suburbanization. A new school for the children of Pinson Valley was completed in 1922 bringing additional families into the Pinson Hills neighborhood. Construction tapered off due to the Great Depression and the country's World War II mobilization, which largely depleted domestic building. The post-war period saw a boom in residential construction nationwide. This boom is expressed in the Pinson Hills Historic District by its wide variety of Minimal Traditional and Ranch style houses.

CRITERION C: ARCHITECTURE

The Pinson Hills Historic District documents Pinson's residential, religious, educational and funerary resources from 1872 to c. 1960. Its religious resources consist of the c. 1872 Presbyterian Church (the oldest extant church in Pinson) and its later parish hall (Inv. #s 5 & 5a) and the 1955 Classical Revival style Methodist Church (Inv. # 26) and its Marvin's Hills Cemetery (Inv. # 20). The town's only historic school, a one story rubble stone building, is in the district (Inv. #6). The remaining resources are residential, including one late Victorian era L-cottage (Inv. # 21) which is the oldest house in the district, a variety of 1920s simple and Craftsman bungalows, and a collection of bungalows, Minimal Traditional houses and Ranch style houses dating from c. 1940 up through c. 1960.

Developmental history/additional historic context information (if appropriate)

Pinson Hills Historic District

Jefferson County, AL

Name of Property

County and State

By 1816, white settlement had begun in the Alabama Territory in general and in Pinson Valley in particular. Soon afterwards, Baptists organized their first church. Within two years, the surrounding county, Jefferson County, had been established and the State began selling land grants. By the 1830s, the Pinson Valley area had become known as Hagood's Crossings; according to an unpublished history, Dr. Zachariah Hagood was the "first Post Office Clerk in the crossroads location."¹ Upon his retirement in 1845, three other Hagoods followed as post master.

By the early 1850s, horse traders from Pinson, Tennessee, who camped in the area with mules and horses to sell or trade to nearby landowners, moved into Hagood's Crossings. By 1852, moreover, they had renamed the community Mt. Pinson.² By the Civil War, Mt. Pinson had many more dwellings and commercial buildings, a school, and a train depot. During the war, a bloom furnace and forge made iron supplies for Confederate troops nearby and, consequently, Union raiders destroyed them.³ Although a cemetery and archaeological resources – including, especially, a Native American cave -- remain from this early period, they are not within the boundaries of the district.

Around 1872, Pinson Presbyterians built a simple weatherboard church with a central steeple tower and a rock foundation (Inv. # 5) which is listed on the Jefferson County Register of Historic Places. Four years later, Methodists organized Marvin's Chapel Methodist Church, named for Bishop Enoch M. Marvin, and also established Marvin Hills Cemetery where residents continue to receive burial (Inv. # 20).⁴ Rev. W. C. McCoy, the church's organizer, was part of the Methodist Jones Valley Circuit which at that time included nine congregations. It was he who gathered the original 25 charter members including some who transferred from nearby Taylor's Chapel Methodist Church and Smith's Chapel Methodist Church. Thomas Massey and David Hanby each gave three acres for the church building. Massey owned a saw mill near Turkey Creek and furnished material for the building. A Mr. Milner of nearby New Castle "hand-dressed" the ceiling, and William E. Taylor made the alter rail. McCoy, also a carpenter, built the pulpit.⁵ This original church is no longer extant.

In 1871 the city of Birmingham was founded sixteen (16) miles southwest of Pinson and, within a few years, it was experiencing its first serious building boom. As a result, farm, freight and mineral products were being produced and readied for transport faster than rails were built.⁶ By the 1880s, Birmingham's Sloss-Sheffield Iron and Steel Company opened Bradford Mines north of Pinson. Some miners lived in its company town, while other miners commuted back and forth from Pinson. This industrial operation promised to be a boon to the area, but it needed adequate transportation to meet its full potential. Fortunately, by 1887, Pinson's first railroad had been established; two (2) years later, Birmingham's new Mineral Railroad (later part of the Louisville

¹ Nancy Pinson, Student research for Pamela Sterne King, University of Alabama at Birmingham, 2005.

² Pinson, 2005.

³ Ibid.

⁴ Pamela Sterne King, Interview with Courtney Vincent, 12-4-11

⁵ Ruby Holland Trammell, Marinelle Stone Pettus, Mary Lou Taylor, Pinson United Methodist Church: Church History 1876-2010, 2010, p. 1.

⁶ Pamela Sterne King, Interview with John Churchwell, 2-4-13.

Pinson Hills Historic District

Jefferson County, AL

Name of Property

County and State

& Nashville system) added approximately sixty miles of rail line. Part of it came straight through Pinson.⁷

By c. 1900, Pinson's population had grown to five hundred (500) residents.⁸ In 1901, a rural delivery route came to Pinson primarily because the *Birmingham Ledger* was being delivered, and, according to one history, "people wanted their news fresh." According to a 1978 Jefferson County Commission study, H. A. Taylor delivered Route #1 by horse and buggy to the nearby communities of Clay, Chalkville, Mt. Calvery and back to Mt. Pinson. In addition, he later ran a second route.⁹ At the same time, growth in Pinson Valley concentrated on and around Main Street, including in the Pinson Hills Historic District. One house remains from this period, a c. 1910 one story L shaped house (Inv. # 21) on Main Street.

By 1920, Pinson's population was over two thousand (2000) residents, and, like many places throughout the United States, the community grew significantly until the Great Depression halted most new construction. In Pinson's case education triggered another boom. In 1921, according to Leah Rawls Atkins' Valley in the Hills, Pinson Valley residents needed a new school and petitioned Jefferson County for funding. Unfortunately, the county was unable to help them so citizens collected donations to purchase the land, and hauled in rocks to build the school themselves.¹⁰ In September 1922, the beautiful six-room rock building opened. As the community grew residents had to enlarge the building. In 1934-35, the community got WPA funding to finish the annex.¹¹ Later, in 1949, an auditorium and lunchroom were added; in c. 1955, according to Mayor Hoyt Sanders, a rear classroom addition was built and, in c. 1960, three additional class rooms were built and a library established (Inv. #6).¹²

Construction of Pinson School convinced many families to move to the valley, establish roots, and build homes on farmsteads being subdivided for new development.¹³ Twelve (12) c. 1925 houses remain from this period including on Main Street (Inv. # 16, 19), Cole Avenue (Inv. # 14), Pinewood Drive (Inv. # 32), Silver Lake Road (Inv. # 64), Spraul Avenue (Inv. #s 68, 69, 71), and Walnut Street (Inv. #s 84, 86). Most are simple bungalows, but there are also several fine Craftsman style bungalows, including a rubble stone house with a two story rubble stone tenant house on Main Street (Inv. # 22).

But, like most American towns and cities in the 1930s, the Great Depression stopped Pinson's economic boom until World War II restarted it. In 1929 one passenger train was discontinued and, in the 1930s, another was removed. This unfortunate development ended all routine passenger and freight service in and out of Pinson.¹⁴

⁷ Ibid.

⁸ Ibid.

⁹ Eugene Thompson Akin, "Echoes from Turkey Creek in Jefferson County, Bull Frog Bend," Jefferson County Historical Commission, 1978.

¹⁰ Leah Rawls Atkins, Valley in the Hills, Windsor Publications, Inc., 1981, pp. 136-137.

¹¹ Bolton, p. 15.

¹² Pamela Sterne King, Personal Interview with Hoyt Sanders, 2-4-13.

¹³ Ibid.

¹⁴ Ibid., p. 26.

Pinson Hills Historic District

Name of Property

Jefferson County, AL

County and State

In 1940, Pinson's population swelled to 3,500.¹⁵ According to Mayor Sanders, war in Europe stoked the local economy which led to new residential development. Subsequent building waves occurred in c. 1945 and c. 1950.¹⁶ In 1950 and 1951, two new large subdivisions were added to Pinson Hills both of which retained bungalows from earlier decades. The first was added on June 21, 1950 on land previously known as "Mrs. Carrie J. Spraul's Subdivision." Renamed the Johnson and Roddam annex, it was owned by J. H. Roddam and M. E. Johnson and included eighteen 100 feet by 137.5 feet (one was 147.5 feet) lots on the south side of Walnut Street and north side of Pinson Street.¹⁷

The second new subdivision was platted by the county on October 12, 1951. Known as J. E. Marsh's Addition to Pinson, it is located immediately east of Bud Holmes Road/Main Street in the north end of the district. Its largest lots run from 101.37 feet x 175.05 feet to 150 feet x 231.36 feet and lie between Bud Holmes Road/Main Street and Pinewood Drive. Additional, somewhat smaller, lots lay outside the District.¹⁸ Four (4) c. 1955 houses remain on Pinewood Drive, all of which are Ranch style houses clad in either weatherboard or asbestos shingles, and wrought iron railings popular at the time (Inv. #s 37 - 40).

With so much investment and growth, perhaps it is no surprise that Pinson citizens wanted an updated image and, in 1952, Mt. Pinson changed its name to Pinson.¹⁹ Growth was further encouraged about a year later when, according to Mayor Sanders, the nearby town of Trussville agreed to connect Pinson residents and businesses to its gas and water utilities.²⁰ At the same time, the Marvin Hills congregation made significant improvements to its sanctuary. Nevertheless, the congregation later voted to construct a brand new facility which it completed in 1955. The Classical Revival church (Inv. #26) was built under the direction of a building committee comprised of George M. Little, J. P. Robertson, James A. Trammell, Jr., Roscoe Hicks, L. B. Burch and James Womack. Rev. John Weathers was the serving pastor (1953 - 1956). Located adjacent to Marvin's Hill Cemetery (Inv. # 20) it is the finest building in the Pinson Hills Historic District. In 1968, under the tutelage of Rev. W. W. Woodburne, Marvin's Chapel Methodist Church became Pinson United Methodist Church, and, in 1991, the Asbury Center education building was completed.²¹

Pinson's impressive construction boom continued into the late 1950s. Several good examples of early Ranch style houses remain from c. 1955 on Walnut Street (Inv. #s 89, 93), Spraul Avenue (Inv. #s 70, 73) and Pinson Street (Inv. # 42, 44, 52, 52(a), 55, 58, 62) in the southern part of the district. In 1960, moreover, Pinson's population reached 5,942; three single family houses (Inv. #s 8, 34, 85), and one of the district's two duplexes (Inv. # 11), remain from that period. Five years later, Pinson had 6,560 residents; and by the end of the decade, the number reached over

¹⁵ Bolton, "A Sociological Study of the Pinson Community," unpublished paper, p. 26.

¹⁶ King, Personal Interview with Hoyt Sanders, 2-4-13.

¹⁷ Probate Court subdivision map, 1950.

¹⁸ Ibid.

¹⁹ Bolton, p. 26.

²⁰ King, Personal Interview with Hoyt Sanders, 2-4-13.

²¹ Ibid., pp. 1 - 6.

Pinson Hills Historic District

Name of Property

Jefferson County, AL

County and State

seven thousand (7,000) residents.²² During the next decade, Pinson's growth sped up even more and, by the 1990s and 2000s, development proved difficult to control. In 2004, the town incorporated and is currently working to preserve its historical character while keeping up with the demand for new construction.

9. Major Bibliographical References

Bibliography (Cite the books, articles, and other sources used in preparing this form.)

Akin, Eugene Thomason. "Echoes from Turkey Creek in Jefferson County, Bull Frog Bend," Jefferson County Historical Commission, 1978.

Alabama Christian Advocate, 7-26-55.

Atkins, Leah Rawls. *The Valley and the Hills*. Windsor Publications, Inc. 1981.

Bolton, Harriet. "A Sociological Study of the Pinson Community," (unpublished), May 6, 1969.

Cochran, Margaret. "Pinson, Jefferson, Alabama 1818 (Hagoods Crossroads – 1971)".

Jefferson County Subdivision Map. Probate Court. 1950.

King, Pamela Sterne. Personal Interview with Courtney Vincent. 12-4-11.

King, Pamela Sterne. Personal Interview with John Churchwell. 2-4-13.

King, Pamela Sterne. Personal Interview with Hoyt Sanders. 2-4-13; 8-1-13.

Marvin Hills Cemetery Sign.

Pinson, Nancy. Student research for Pamela Sterne King. University of Alabama at Birmingham: Department of History. 2005.

Pinson, Nancy. Student paper for Pamela Sterne King. University of Alabama at Birmingham: Department of History. 2007.

Trammell, Ruby Holland; Pettus, Marillelle Stone; and Taylor, Mary Lou. Pinson United Methodist Church: Church History 1876 – 2010. 2010.

Previous documentation on file (NPS):

²² Bolton.

Pinson Hills Historic District
Name of Property

Jefferson County, AL
County and State

- preliminary determination of individual listing (36 CFR 67) has been requested
- previously listed in the National Register
- previously determined eligible by the National Register
- designated a National Historic Landmark
- recorded by Historic American Buildings Survey # _____
- recorded by Historic American Engineering Record # _____
- recorded by Historic American Landscape Survey # _____

Primary location of additional data:

- State Historic Preservation Office
- Other State agency
- Federal agency
- Local government
- University
- Other
- Name of repository: _____

Historic Resources Survey Number (if assigned): _____

10. Geographical Data

Acreage of Property 40

Use either the UTM system or latitude/longitude coordinates

Latitude/Longitude Coordinates

Datum if other than WGS84: _____
(enter coordinates to 6 decimal places)

- | | |
|------------------------|-----------------------|
| 1. Latitude: 33.692832 | Longitude: -86.680004 |
| 2. Latitude: 33.684398 | Longitude: -86.681892 |
| 3. Latitude: 33.692565 | Longitude: -86.674970 |
| 4. Latitude: 33.684324 | Longitude: -86.676387 |

Or

UTM References

Datum (indicated on USGS map):

- NAD 1927 or NAD 1983

Pinson Hills Historic District
Name of Property

Jefferson County, AL
County and State

- | | | |
|----------|-----------|-----------|
| 1. Zone: | Easting: | Northing: |
| 2. Zone: | Easting: | Northing: |
| 3. Zone: | Easting: | Northing: |
| 4. Zone: | Easting : | Northing: |

Verbal Boundary Description (Describe the boundaries of the property.)

The Pinson Hills Historic District is bounded by Center Point Road on the west; Pinson Street on the south; Walnut Street, Cole Avenue, and Pinewood Drive on the east; and Church Street on the north. In addition, Bud Holmes Road/Main Street, a major thoroughfare, follows an east to west path and forms a boundary in the northwest portion of the district. The western side of Center Point Road forms the eastern boundary of the Pinson Main Street Historic District; and to the north east and south of the Pinson Hills Historic District is post- c. 1980s residential and suburban development.

Boundary Justification (Explain why the boundaries were selected.)

The Pinson Hills Historic District includes all of the contributing contiguous resources located within the Pinson Hills neighborhood and is shown on the attached Pinson Hills Historic District map.

11. Form Prepared By

name/title: Pamela Sterne King (reviewed by Jennifer K. Bailey, AHC Architectural Historian)

organization: PSKing Associates

street & number: 3307 Altaloma Way

city or town: Birmingham state: AL zip code: 35216

e-mail psking@uab.edu

telephone: 205-908-3975

date: September 17, 2015

Additional Documentation

Submit the following items with the completed form:

Pinson Hills Historic District
Name of Property

Jefferson County, AL
County and State

- **Maps:** A **USGS map** or equivalent (7.5 or 15 minute series) indicating the property's location.
- **Sketch map** for historic districts and properties having large acreage or numerous resources. Key all photographs to this map.
- **Additional items:** (Check with the SHPO, TPO, or FPO for any additional items.)

Photographs

Submit clear and descriptive photographs. The size of each image must be 1600x1200 pixels (minimum), 3000x2000 preferred, at 300 ppi (pixels per inch) or larger. Key all photographs to the sketch map. Each photograph must be numbered and that number must correspond to the photograph number on the photo log. For simplicity, the name of the photographer, photo date, etc. may be listed once on the photograph log and doesn't need to be labeled on every photograph.

Photo Log

Name of Property: Pinson Hills Historic District

City or Vicinity: Pinson

County: Jefferson State: AL

Photographer: Pamela Sterne King

Date Photographed: 11-20-11; 7-15-2013; 7-18-2013; 7-26-2013; 7-14-14; 9-17-15

Description of Photograph(s) and number, include description of view indicating direction of camera:

Pinson Hills Historic District

Jefferson County, AL

Name of Property

County and State

- 1 of 25 . Presbyterian Church and Parrish, 4204 Center Point Road, view of front elevations facing east
- 2 of 25 . Center Point Road streetscape, view facing NE
- 3 of 25 . Pinson School, 4421 Center Point Road, view of front facing SE
- 4 of 25 . House, 4207 Walnut Street view of front elevation facing south
- 5 of 25 . Spraul Avenue streetscape, view facing north
- 6 of 25 . House, 6279 Cole Avenue, view of front/side elevations, camera facing south
- 7 of 25 . House, 4214 Pinson Street, view of front facade facing north
- 8 of 25 . House, 4455 Main Street, view of front elevation, view facing southeast
- 9 of 25 . Main Street streetscape, view facing NE
- 10 of 25 . Pinson United Methodist Church, 4507 Main Street, view of front elevation, facing east
- 11 of 25 . Marvin Hills Cemetery, 4420 Main Street, view facing NW
- 12 of 25 . House, 4286 Cedar Street, view of windows, stone sills, facing north
- 13 of 25 . House, 6205 Cole Avenue, view of front elevation, facing east
- 14 of 25 . Cole Avenue Streetscape, view facing NE
- 15 of 25 . House, 4456 Main Street, view of front/side facades, camera facing NE
- 16 of 25 . House, 4479 Main Street, view of front facing SW
- 17 of 25 . House, 4247 Cedar Street, view of front façade facing SW
- 18 of 25 . House, 6245 Spraul Avenue, view of front side facing NE
- 19 of 25 . Spraul Avenue Streetscape, view facing NE
- 20 of 25 . Walnut Street Streetscape, view facing east
- 21 of 25 . House, 4374 Mountain Street, view of front façade facing NE
- 22 of 25 . House, 4247 Pinson Street, view of front/side facades, facing SE
- 23 of 25 . House, 6201 Walnut Street, view of front facing east
- 24 of 25 . House, 4403 Main Street, view of front/side elevations, camera facing SW
- 25 of 25 . House, 4311 Pinson Street, view of front elevation, camera facing south

Paperwork Reduction Act Statement: This information is being collected for applications to the National Register of Historic Places to nominate properties for listing or determine eligibility for listing, to list properties, and to amend existing listings. Response to this request is required to obtain a benefit in accordance with the National Historic Preservation Act, as amended (16 U.S.C.460 et seq.).

Estimated Burden Statement: Public reporting burden for this form is estimated to average 100 hours per response including time for reviewing instructions, gathering and maintaining data, and completing and reviewing the form. Direct comments regarding this burden estimate or any aspect of this form to the Office of Planning and Performance Management, U.S. Dept. of the Interior, 1849 C. Street, NW, Washington, DC.

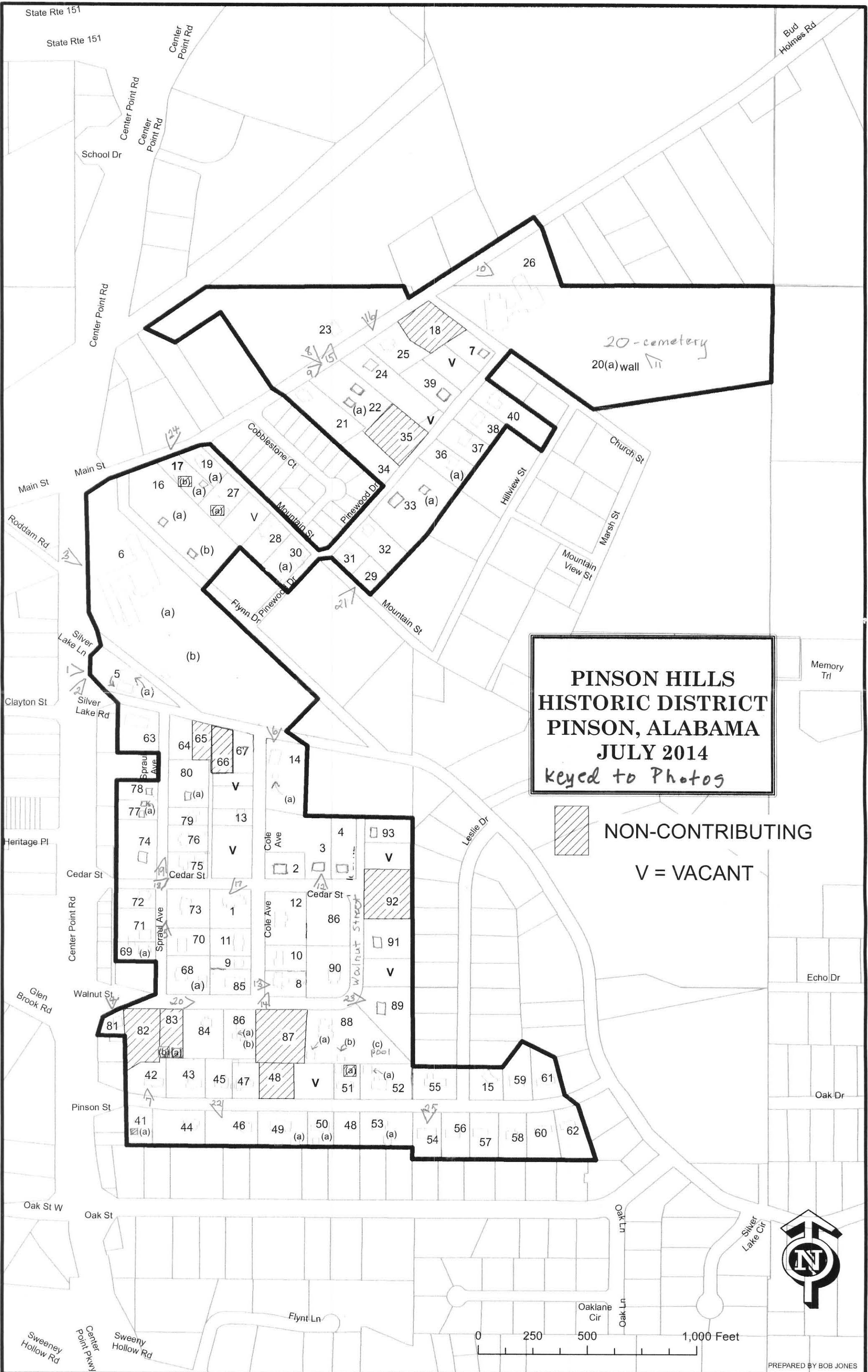

**PINSON HILLS
HISTORIC DISTRICT
PINSON, ALABAMA
JULY 2014**
keyed to Photos

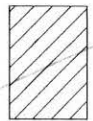

NON-CONTRIBUTING

V = VACANT



0 250 500 1,000 Feet

PINSON HIBUS HISTORIC DISTRICT, PINSON, JEFFERSON CO., AL

1. 33.692832, -86.680004
2. 33.684398, -86.681892

3. 33.692545, -86.674970
4. 33.684324, -86.676387

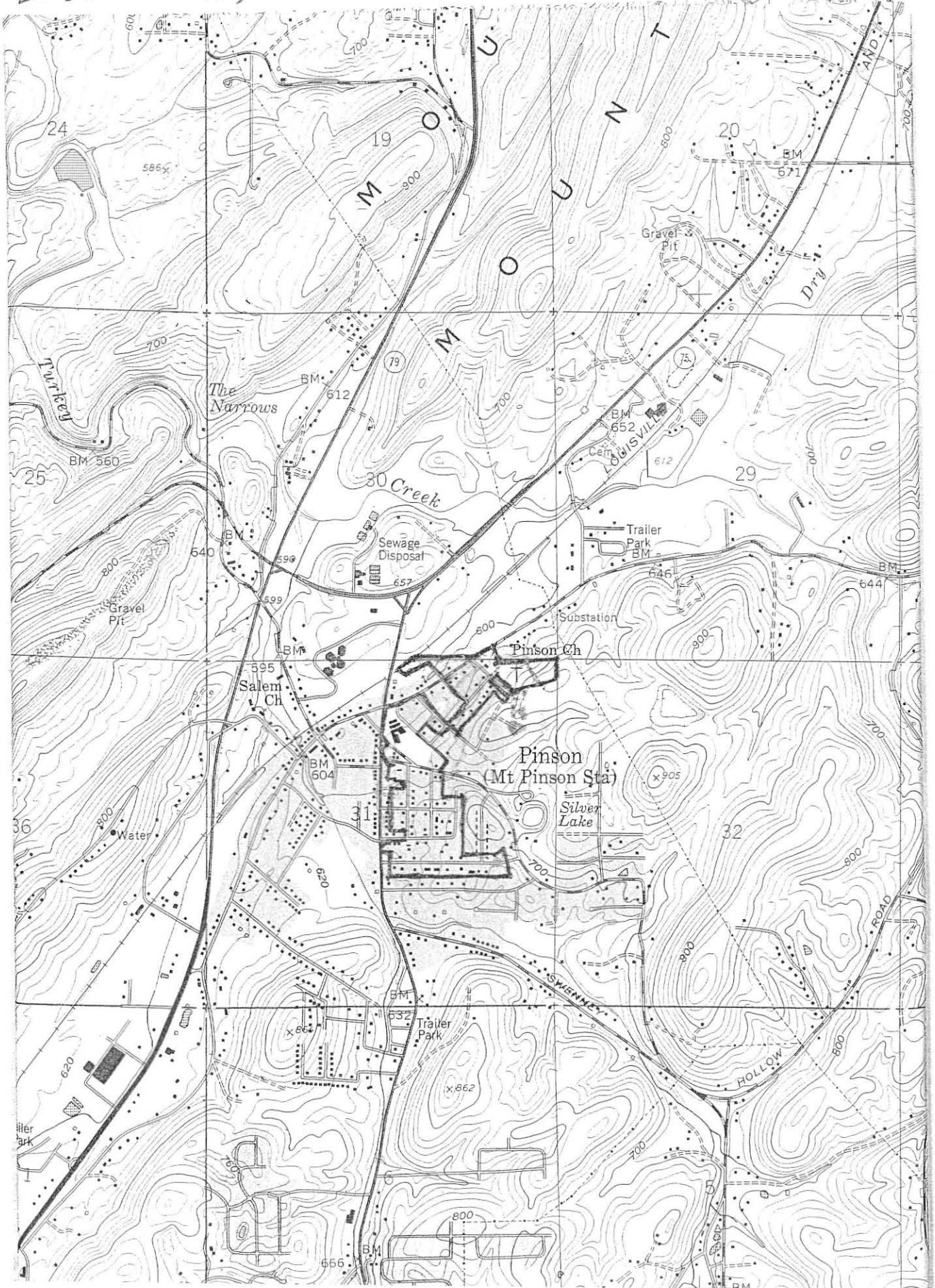



St. Luke's

St. Luke's





ATTENTION!
DO NOT LEAVE
ANY VEHICLES OR
PERSONAL PROPERTY
FOR SALE
IN THIS AREA.
NO
OVERNIGHT PARKING

07/26/2013









07/18/2013









FAIR

PHILLIPS

POSEY

FANNIE

COLLINS

07/15



07/18/201



6705

07/18/

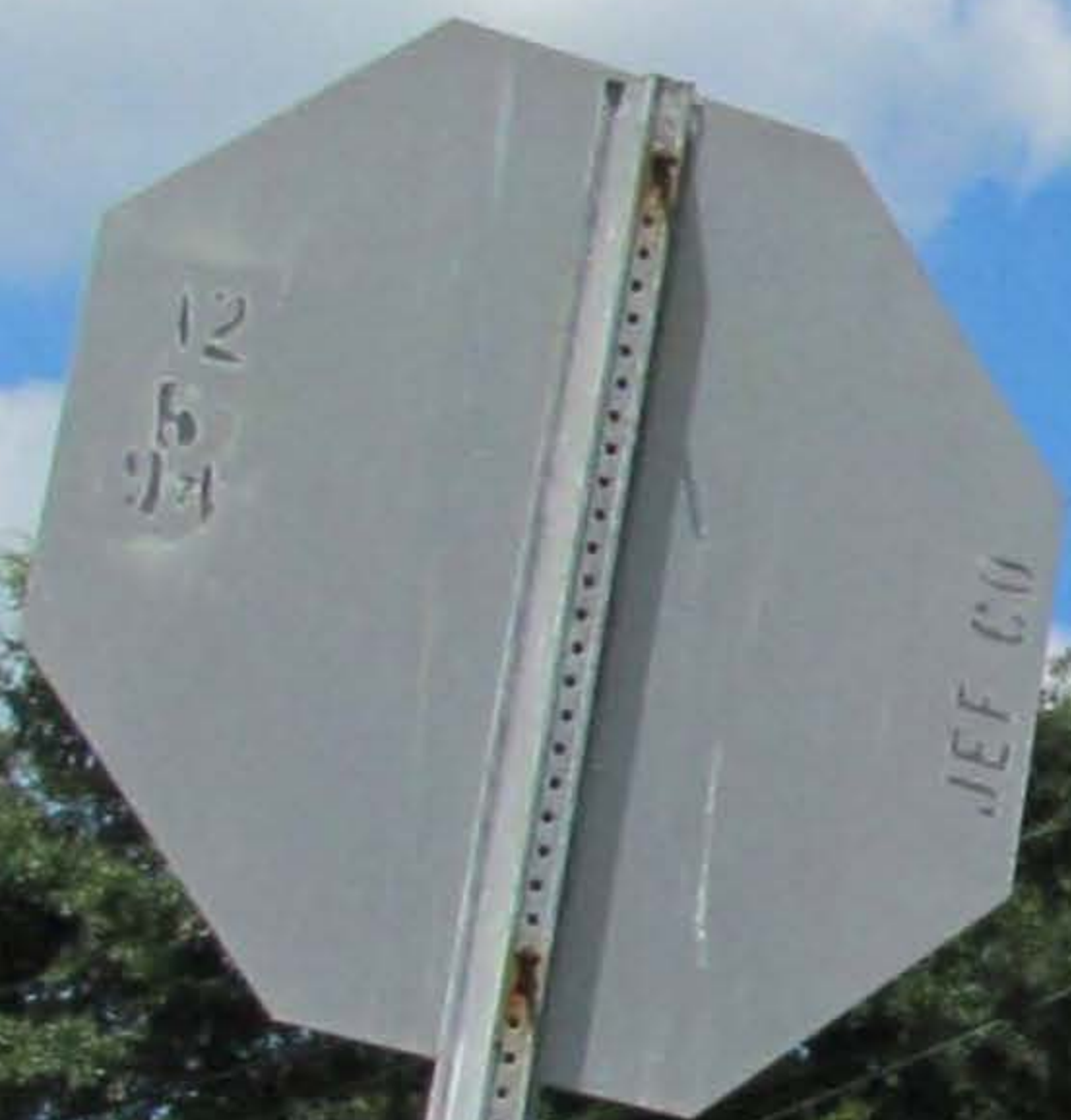

07/18/2013



07/18/2013



NEW PRICE
TOTALLY
RENOVATED
FOR SALE
ARC
Beverly Hill
DISCOUNT 10%
www.arc.com
800-452-4529

07/26/2019



07/26/2



07/26/2013



07/26/



07/26/2013



07/15/2019



07/18/2019



09/17/2015



07/26/2013



07/14/2014

UNITED STATES DEPARTMENT OF THE INTERIOR
NATIONAL PARK SERVICE

NATIONAL REGISTER OF HISTORIC PLACES
EVALUATION/RETURN SHEET

REQUESTED ACTION: NOMINATION

PROPERTY NAME: Pinson Hills Historic District

MULTIPLE NAME:

STATE & COUNTY: ALABAMA, Jefferson

DATE RECEIVED: 12/04/15 DATE OF PENDING LIST: 01/04/16
DATE OF 16th DAY: 01/19/16 DATE OF 45th DAY: 01/19/16

REFERENCE NUMBER: 15000975

REASONS FOR REVIEW:

APPEAL: N DATA PROBLEM: N LANDSCAPE: N LESS THAN 50 YEARS: N
OTHER: N PDIL N PERIOD: N PROGRAM UNAPPROVED: N
REQUEST: Y SAMPLE: N SLR DRAFT: N NATIONAL: N

COMMENT WAIVER: N

ACCEPT RETURN REJECT 01.19.16 DATE

ABSTRACT/SUMMARY COMMENTS:

RECOM./CRITEREA _____

REVIEWER _____ DISCIPLINE _____

TELEPHONE _____ DATE _____

DOCUMENTATION see attsched comments Y/N

If a nomination is returned to the nominating authority, the nomination is no longer under consideration by the NPS.



STATE OF ALABAMA
ALABAMA HISTORICAL COMMISSION
468 SOUTH PERRY STREET
MONTGOMERY, ALABAMA 36130-0900

November 30, 2015

LISA D. JONES
ACTING EXECUTIVE DIRECTOR
STATE HISTORIC PRESERVATION OFFICER

RECEIVED 2280

DEC 04 2015

Nat. Register of Historic Places
National Park Service

TEL: 334-242-3184

FAX: 334-240-3477

Ms. Stephanie Toothman
Keeper of the National Register
U. S. Department of the Interior, NPS
Cultural Resources
National Register, History & Education Programs
1201 "I" Street NW (2280)
Washington, D. C. 20005

Dear Ms. Toothman:

Enclosed please find the nomination and supporting documentation to be considered for listing the following Alabama resource in the National Register of Historic Places:

Pinson Hills Historic District
Pinson, Jefferson County, Alabama

Your consideration of the enclosed National Register of Historic Places nomination is appreciated.

Sincerely,

Lee Anne Wofford
Deputy State Historic Preservation Officer

LAW/jkb/nw

Enclosures