

filled SEP 24 1988

Iowa Site Inventory

Division of Historic Preservation
Iowa State Historical Department
26 E. Market St., Iowa City, Iowa 52240

Site Number 32
District Name _____
Map Reference # 32

Identification

1. Site Name Nieland House
2. Village/Town/City Guttenberg Township Jefferson County Clayton
3. Street Address 715 South First
4. Legal Location G 26 12
Urban: subdivision block range parcel section
Rural: township % section of 1/4 section
5. UTM Location: zone 15 easting 655,760 northing 4,737,760; Acreage -.1 Acre
6. Owner(s) Name Lena Nieland
7. Owner(s) Address 715 South First Guttenberg Iowa 52052
(Street address) (City) (State) (Zip)
8. Use: Present Residence Original Residence

Description

9. Date of Construction Pre-1886 Architect/Builder "Unknown"
10. Building Type:
 single-family dwelling industrial other institutional religious
 multiple-family dwelling educational public agricultural
 commercial
11. Exterior Walls: clapboard stone brick board and batten shingles stucco
 other _____
12. Structural System: wood frame with interlocking joints wood frame with light members (balloon frame)
 masonry load-bearing walls iron frame steel frame with curtain walls reinforced concrete
 other _____
13. Condition: excellent good fair deteriorated
14. Integrity: original site moved—if so, when? _____
Notes on alterations, additions (with dates and architect, if known) and any other notable features of building and site: _____
15. Related Outbuildings and Property: barn other farm structures carriage house garage privy
 other _____
16. Is the building endangered? no yes—if so, why? _____
17. Surroundings of the building: open land woodland scattered outbuildings densely built-up commercial
 industrial residential other _____

18. Map

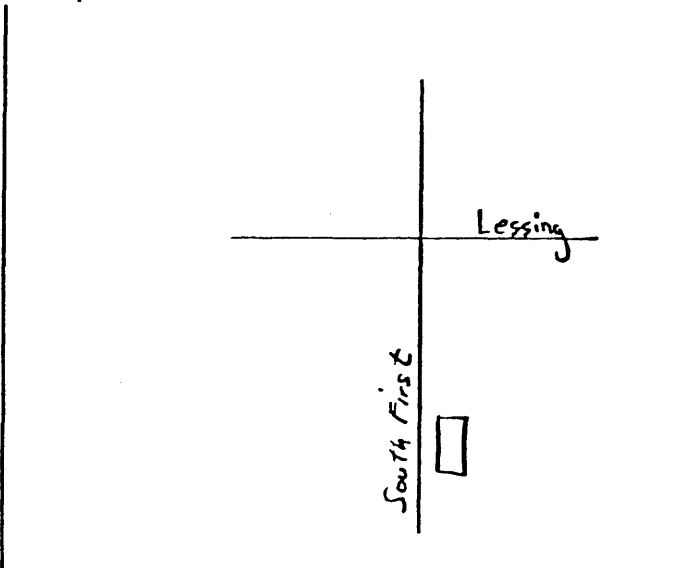

19. Photo

Roll 1232 Frame 10 View SW

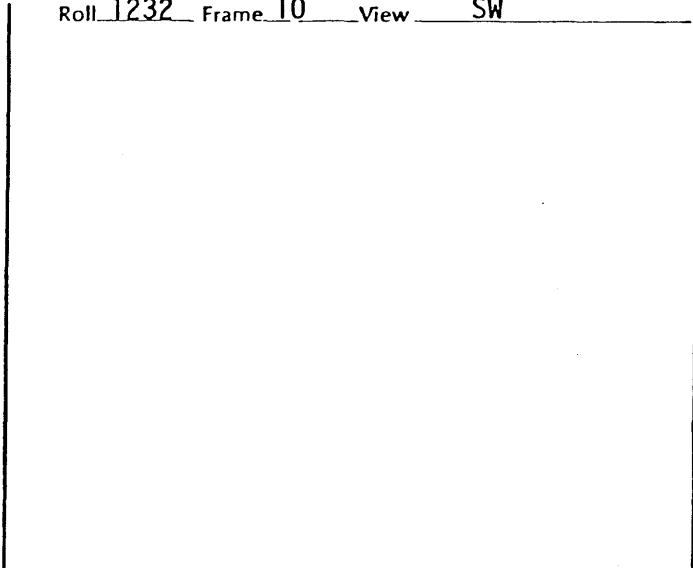

Significance

(Indicate sources of information for all statements)

20. Architectural significance

- a. Key structure/individually may qualify for the National Register
- b. Contributing structure
- c. Not eligible/intrusion

Very early two-story brick residence, symmetrical fenestration, central door on first floor, but only four small windows along eaves on second floor - all in north 2/3 of front. No chimney. Single story frame addition across rear and second addition, single story behind that. Half basement beneath original brick.

21. Historical Significance

Theme(s) _____, "Saltbox Style" _____

- a. Key structure/individually may qualify for the National Register
- b. Contributing structure
- c. Not eligible/intrusion

Previous owners included Royland and Albert Zaph, Eldon Parker, _____, Eahns.

22. Sources (for primary and secondary sources, give complete facts of publication: author, title, place of publication, date, etc.):

Sanborn Map: 1886
High School Survey

Prepared by James E. Jacobsen Date November 2, 1979
Address E. 12th & Grand, Des Moines, Iowa 50319 Telephone (515) 281-4137
Organization Office of Historic Preservation

For Division of Historic Preservation Use Only

1. Office Information Sources on this Property

- County Resource File
- Windshield Survey
- National Register
- Grants-In-Aid: _____
- Determination of Eligibility

Review and Compliance Project:

- Other _____
- Other _____
- Other _____

2. Subject Traces

- a. _____
- b. _____
- c. _____
- d. _____
- e. _____

3. Photo Images _____

- _____
- _____
- _____
- _____

Iowa Site Inventory

Division of Historic Preservation
Iowa State Historical Department
26 E. Market St., Iowa City, Iowa 52240

Site Number 32

Continuation Sheet

Item Number(s) STATEMENT OF SIGNIFICANCE/ Architectural--X- Historical----

"Saltbox Style": The five bay Nieland House is a local version of the New England Saltbox. Unique to the structure are the four small windows located beneath the second floor eaves. Also of note is the lack of bay symmetry on the gabled side of the house.