

UNITED STATES DEPARTMENT OF THE INTERIOR
NATIONAL PARK SERVICE

FOR NPS USE ONLY
RECEIVED **JAN 16 1984**
DATE ENTERED

**NATIONAL REGISTER OF HISTORIC PLACES
INVENTORY -- NOMINATION FORM**

SEE INSTRUCTIONS IN *HOW TO COMPLETE NATIONAL REGISTER FORMS*
TYPE ALL ENTRIES -- COMPLETE APPLICABLE SECTIONS

1 NAME

HISTORIC

STAR JOURNAL MODEL HOME

AND/OR COMMON

Same

2 LOCATION

STREET & NUMBER

2920 High Street

n/a NOT FOR PUBLICATION

CITY, TOWN

CONGRESSIONAL DISTRICT

Pueblo

n/a VICINITY OF

STATE

CODE

COUNTY

CODE

Colorado

08

Pueblo

101

3 CLASSIFICATION

CATEGORY

OWNERSHIP

STATUS

PRESENT USE

DISTRICT

PUBLIC

OCCUPIED

AGRICULTURE

MUSEUM

BUILDING(S)

PRIVATE

UNOCCUPIED

COMMERCIAL

PARK

STRUCTURE

BOTH

WORK IN PROGRESS

EDUCATIONAL

PRIVATE RESIDENCE

SITE

PUBLIC ACQUISITION

ACCESSIBLE

ENTERTAINMENT

RELIGIOUS

OBJECT

n/a IN PROCESS

YES: RESTRICTED

GOVERNMENT

SCIENTIFIC

n/a BEING CONSIDERED

YES: UNRESTRICTED

INDUSTRIAL

TRANSPORTATION

NO

MILITARY

OTHER:

4 OWNER OF PROPERTY

NAME

Frank C. Jr. and Sheila R. Lee

STREET & NUMBER

2920 High Street

CITY, TOWN

STATE

Pueblo

n/a VICINITY OF

Colorado

5 LOCATION OF LEGAL DESCRIPTION

COURTHOUSE,
REGISTRY OF DEEDS, ETC.

Pueblo County Courthouse

STREET & NUMBER

10th & Main Streets

CITY, TOWN

STATE

Pueblo

Colorado

6 REPRESENTATION IN EXISTING SURVEYS

TITLE Pueblo Historical & Architectural Survey; and
Colorado Inventory of Historic Sites

DATE

Ongoing

FEDERAL STATE COUNTY LOCAL

DEPOSITORY FOR
SURVEY RECORDS

State Historic Preservation Office

CITY, TOWN

STATE

Denver

Colorado

7 DESCRIPTION

CONDITION
 EXCELLENT
 GOOD
 FAIR
 DETERIORATED
 RUINS
 UNEXPOSED

CHECK ONE
 UNALTERED
 ALTERED

CHECK ONE
 ORIGINAL SITE
 MOVED DATE _____

DESCRIBE THE PRESENT AND ORIGINAL (IF KNOWN) PHYSICAL APPEARANCE

The idea of the "Star Journal Model Home" was conceived by the owners of the Star Journal Publishing Company in September, 1926. It was to be designed and built by the finest architect and contractor in Southern Colorado, using the highest quality of materials available. The home was to be a showcase in which the most skilled Southern Colorado artisans would be invited to exhibit their craft, and the house was to possess the most modern conveniences. As a promotional item, the entire project was extensively documented through both stories and pictures which appeared in the Star Journal newspaper between September of 1926 and January of 1927. Following are excerpts taken from these articles:

Model Home Most Unique in Details

"The Star Journal Model Home to be built in the exclusive Golf Club residential district will be of English style and will be of two story dark red brick, it was announced by Walter deMordaunt, architect in charge. Red sandstone trimmings will be used on the exterior."

Star Journal
Sunday, October 21, 1926
"Model Home Section," Page 1.

"The Star Journal Model Home is one of the strongest and best built homes in Pueblo, and is more than good enough for anyone to live in," stated Walter DeMordaunt, architect of the new home.

"Plans are being made for one of the biggest opening celebrations ever held by the building industry in this city on January 23."

Star Journal
January 9, 1927
"Model Home Section," Page 1.

Star-Journal Model Home Open To Public Today!

"Last September the Star Journal made plans and arrangements to present to Puebloans a home that would be near to perfection that is possible to build."

"The type of home decided upon was early English an exact likeness of the homes that adorn the beautiful countrysides of England."

Star Journal
January 23, 1927
"Model Home Section," Page 1.

**United States Department of the Interior
National Park Service**

**National Register of Historic Places
Inventory—Nomination Form**

For NPS use only
received
date entered

Continuation sheet STAR JOURNAL MODEL HOME

Item number 7

Page 2

Description (Cont'd):

"To those contemplating visiting the new home which is open today for public inspection, particular attention is called to the stone trimming chisled by a sub-contractor, J.C. Roy. One of these cornerstones once adorned a place in the old Grand Opera House and was used just as it came from the old building that formerly stood at Fourth and Main until it was destroyed by fire a few years ago. As a curio the brick and stone work in the new model home shows an ideal combination of these two building materials in a most pleasing manner."

Star Journal
Sunday, January 23, 1927
'Model Home Section,' Page 5.

Early Englishlines of New Home Present Picturesque View

"The new Star Journal home is one of the most picturesque bits of architecture in this city. As you draw near its attractiveness and its home like effect seem to welcome you."

Star Journal
January 30, 1927
'Model Home Section,' Page 1.

"The model home which the Star Journal is sponsoring is located on High Street, designed by Walter deMordaunt, architect, and built by M. J. Moore, contractor. Business firms of the city have combined forces in an effort to perfect the interior of this charming home."

Star Journal
Sunday, January 30, 1927
'Model Home Section,' Page 1.

"Richness and artistry are the chief characteristics of the dining room in the Star Journal Model Home. The dining room suite is of the period of the Spanish Renaissance."

Star Journal
Sunday, January 30, 1927
'Model Home Section,' Page 1.

**United States Department of the Interior
National Park Service**

**National Register of Historic Places
Inventory—Nomination Form**

For NPS use only

received

date entered

Continuation sheet STAR JOURNAL MODEL HOME

Item number 7

Page 3

Description (Cont'd):

The home is located at 2920 High Street in the Grandview Addition Subdivision. It was designed by architect Walter de Mordaunt as a regional adaptation of Sir Edward Lutchens English Country style. The contractors and artisans invited to work on the house include M. J. Moore, general contractor; Birch Manufacturing; C. J. Roy, stone masonry; D. E. Burke, plumbing contractor; Newton Lumber Company; lumber, stucco, and mill work; D. A. Burrough, contractor; and Fred W. Innes, painting and decorating. Additionally, the subdivision in which the home was constructed was to be a showplace of Pueblo, with zoning restrictions and possessing homes with convenience of style at an affordable cost.

The house is one and one-half stories. It is of brick and sandstone construction with a steep gable roof. The textured brick, commonly called tapestry brick, is of hard burned clay reflecting purple and red hues. The sandstone creating the arched front entrance, supporting the eaves at the corner of the structure, and decoratively integrated into the brick work facade, was cut from stone salvaged from the old Grand Opera House. Some of this stone is decoratively carved. The combination of brick and cut stone create a unique exterior finish. The ends of the multi-gabled roof possess an "Oriental" stucco finish, keeping with the English design of the house. The ends of the rafters are exposed under the eaves and are decoratively cut in a curved pattern.

The dominant architectural features include the arched entryway, dormer window, and centrally located chimney on the front (west) facade; the prominent bay window of the south facade; and the red flagstone terrace with French entry doors at the rear or east facade.

A small detached one-car garage, located along the north property line with an entrance off High Street, is constructed of the same materials and reflects the style of the house. In 1982, the present owner built a larger garage at the rear of the property with access off the alley. This structure is also built of the same materials, including the shingles which were purchased from a New York manufacturer, and accurately reflects the style and proportion of the house and original garage. A brick and stucco fence have also been constructed along the rear property line.

The first floor of the structure contains a living room, dining room, breakfast nook, and a kitchen. The front entryway has a purple glazed tile floor and a small coat closet. The living room exhibits a commitment to providing for natural lighting and cross ventilation. On the east side of the living room are the French doors leading into the patio. The south side of the living room has the large bay window, and the west side a casement window. Another dominant feature of the living room is the fireplace which is located in a two-foot deep inset on the west wall. The fireplace is flanked by a combination wood box seat to the right and highly detailed bookshelves and a leaded glass window to the left. The ceiling of the fireplace inset is supported by a massive hand doweled oak beam. The fireplace itself has a wood mantle and is decorated above with glazed brick with raised designs. The floor in front of the fireplace is the same as that found in the entrance way.

**United States Department of the Interior
National Park Service**

**National Register of Historic Places
Inventory—Nomination Form**

For NPS use only

received

date entered

Continuation sheet STAR JOURNAL MODEL HOME

Item number 7

Page 4

Description (Cont'd):

The French doors which open to the terrace on the east are double constructed, with both interior and exterior doors. The terrace on the east took the place of the large front porch which was popular at the time, and the houses shaded the terrace from the western sun.

The walls of both the up and downstairs are of "tiffany finish." The floors are of both red and blonde oak. The "Riddle Fitments," lighting fixtures, are manufactured from wrought iron. Fixtures include the two small internally wired fitment on the fireplace mantel, two fitments in the bay window, and one suspended from the ceiling in the dining room. The fitment which was suspended from the living room ceiling is gone.

An oak staircase, manufactured by a Pueblo company, ascends to the second floor. The staircase is intact and possesses the original finish. The second floor includes two spacious bedrooms, a small room which was originally intended to be a sewing room, and a bathroom. The bedrooms all have large electrically lighted clothes closets, which were an innovation in 1926. The upstairs doors were originally finished in French gray on the hallway side. All of the trim was painted ivory enamel.

United States Department of the Interior
National Park Service

National Register of Historic Places
Inventory—Nomination Form

For NPS use only
received
date entered

Star Journal Model Home, Pueblo, Co.
Continuation sheet

Item number 7

Page 5

1"=20'

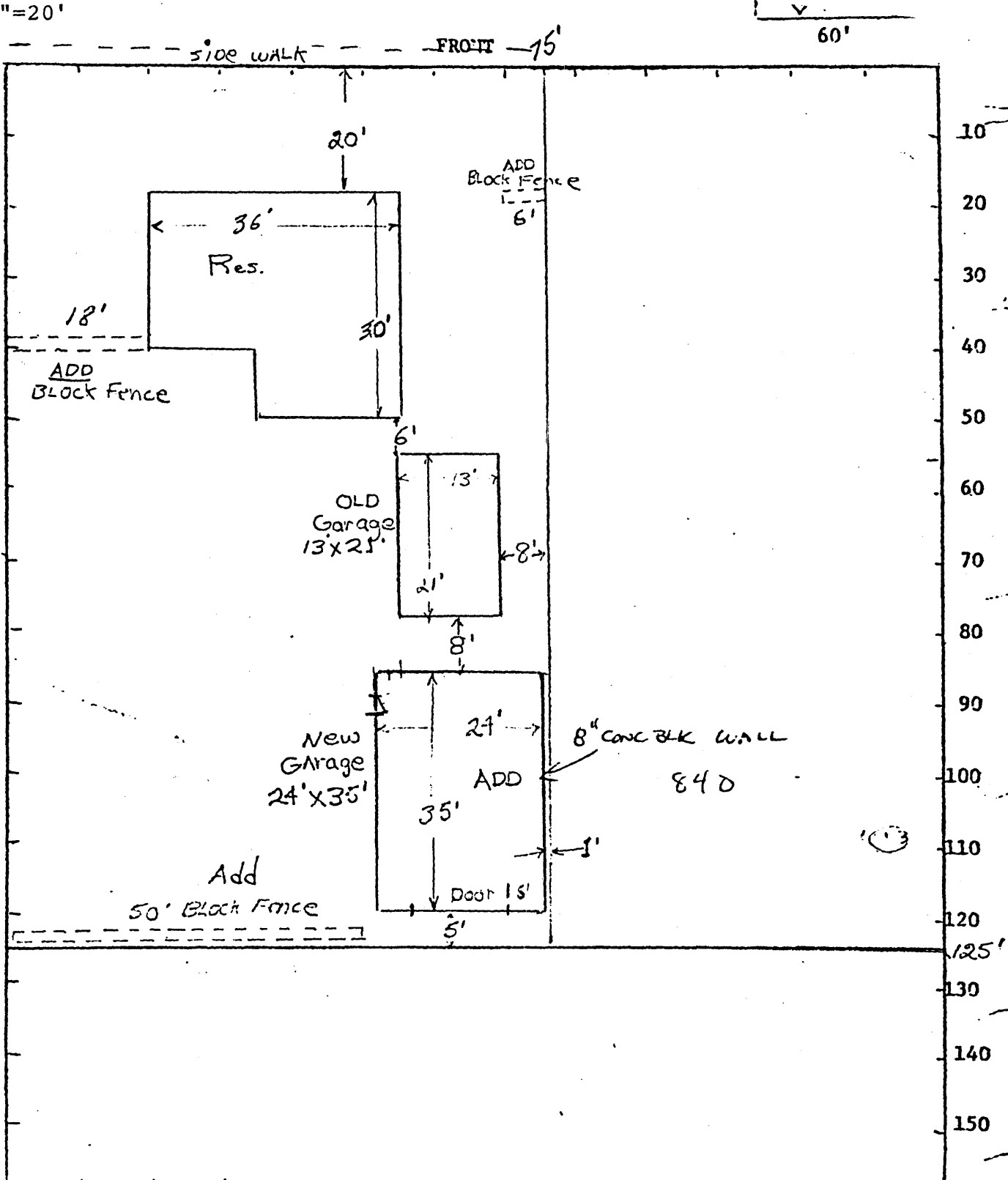

Map is from the legal description of the lot (Lots 7-8-9,
Block 24, Grandview Place Subdivision.

8 SIGNIFICANCE

PERIOD	AREAS OF SIGNIFICANCE -- CHECK AND JUSTIFY BELOW				
<input type="checkbox"/> PREHISTORIC	<input type="checkbox"/> ARCHEOLOGY-PREHISTORIC	<input type="checkbox"/> COMMUNITY PLANNING	<input type="checkbox"/> LANDSCAPE ARCHITECTURE	<input type="checkbox"/> RELIGION	
<input type="checkbox"/> 1400-1499	<input type="checkbox"/> ARCHEOLOGY-HISTORIC	<input type="checkbox"/> CONSERVATION	<input type="checkbox"/> LAW	<input type="checkbox"/> SCIENCE	
<input type="checkbox"/> 1500-1599	<input type="checkbox"/> AGRICULTURE	<input type="checkbox"/> ECONOMICS	<input type="checkbox"/> LITERATURE	<input type="checkbox"/> SCULPTURE	
<input type="checkbox"/> 1600-1699	<input checked="" type="checkbox"/> ARCHITECTURE	<input type="checkbox"/> EDUCATION	<input type="checkbox"/> MILITARY	<input type="checkbox"/> SOCIAL/HUMANITARIAN	
<input type="checkbox"/> 1700-1799	<input type="checkbox"/> ART	<input type="checkbox"/> ENGINEERING	<input type="checkbox"/> MUSIC	<input type="checkbox"/> THEATER	
<input type="checkbox"/> 1800-1899	<input type="checkbox"/> COMMERCE	<input type="checkbox"/> EXPLORATION/SETTLEMENT	<input type="checkbox"/> PHILOSOPHY	<input type="checkbox"/> TRANSPORTATION	
<input type="checkbox"/> 1900-	<input type="checkbox"/> COMMUNICATIONS	<input type="checkbox"/> INDUSTRY	<input type="checkbox"/> POLITICS/GOVERNMENT	<input type="checkbox"/> OTHER (SPECIFY)	
		<input type="checkbox"/> INVENTION			

SPECIFIC DATES	September, 1926 to January, 1927	BUILDER/ARCHITECT	M.J. Moore, General Contractor Walter de Mordaunt, Architect
----------------	-------------------------------------	-------------------	---

STATEMENT OF SIGNIFICANCE

Due to the extensive documentation, the "Star Journal Model Home" is significant as a "text book" period piece, and because the finest artisans of Southern Colorado were invited to contribute to the structure, it is also significant for its association with these individuals. Again, due to the extensive documentation, the thoughts of these artists as they related to their work was recorded.

The structure exhibits the "high style" of the time within the parameters of "convenient living" and "cost." It also indirectly expresses the aspirations of Southern Colorado, immediately prior to the depression of the 1930's, as expressed by the owners of the most widely read newspaper in Southern Colorado. The structure was built of the finest materials, displayed the talents of the most prominent individuals working in the design and building construction trades, and possessed the most modern conveniences. Through its promotion of the "model home," the newspaper spread the concept of "modern living" throughout Southern Colorado. The undertaking of this project exemplifies the lead role taken by the newspaper in promoting the development of Pueblo and Southern Colorado.

Of all the artisans who contributed to the model home, the architect, Walter de Mordaunt, gained the most prominence in his career. He was the most prominent architect in Pueblo during the forty-year period between 1920 and 1960. The model home was designed by de Mordaunt shortly after he left the employ of William H. Stickney to begin his own firm. Even though the "Model Home" was an early design effort of de Mordaunt's, Project No. 14 in de Mordaunt's workbook, it exhibits many of the qualities which are exhibited on de Mordaunt's more famous later public buildings.

De Mordaunt was not as interested in style as he was in structure. As with the adaptation of the English country style in the design of the model home, his structures mirrored the larger styles of the times and the wishes of his clients. De Mordaunt built structures in the Gothic, Art Nouveau, mission, and adobe styles. His personal touch exhibited in each of his buildings, as in the model home, was the employ of local artisans whose purpose was to execute unique architectural pieces for each of the structures he designed. J. C. Roy, the stone cutter employed in the building of the "model home," also worked on several other structures for de Mordaunt.

The other individuals and firms associated with the structure include M. J. Moore, general contractor; Birch Manufacturing; C. J. Roy, stone masonry; D. E. Burke, plumbing contractor; Newton Lumber Company, lumber, stucco and mill work; D. A. Burrough, contractor; and Fred W. Innes, painting and decorating.

9 MAJOR BIBLIOGRAPHICAL REFERENCES

- Star Journal, 'Model Home Section,' Sunday, October 21, 1926, Page 1.
- Star Journal, 'Model Home Section,' January 9, 1927, Page 1.
- Star Journal, 'Model Home Section,' January 23, 1927, Page 1.
- Star Journal, 'Model Home Section,' January 30, 1927, Page 1.

10 GEOGRAPHICAL DATA

ACREAGE OF NOMINATED PROPERTY .21

QUADRANGLE NAME Northwest Pueblo, Colo.

QUADRANGLE SCALE 1:24000

UTM REFERENCES

A 1,3 5,3,2,7,3,0 4,2,3,8,8,1,0

B

C

D

E

F

G

H

VERBAL BOUNDARY DESCRIPTION

All of Lots 7, 8, and 9, in Block 24, Grandview Addition Subdivision.

LIST ALL STATES AND COUNTIES FOR PROPERTIES OVERLAPPING STATE OR COUNTY BOUNDARIES

STATE	CODE	COUNTY	CODE
n/a			

STATE	CODE	COUNTY	CODE

11 FORM PREPARED BY

NAME / TITLE

Frank & Sheila Lee (Owners) and

August 5, 1983

ORGANIZATION

James F. Munch, Pueblo Regional Planning Commission (PRPC)

August 5, 1983

STREET & NUMBER

Lee--2920 High Street; PRPC--P. O. Box 1427, 1 City Hall Place--543-6006

CITY OR TOWN

Pueblo

STATE

Colorado

12 STATE HISTORIC PRESERVATION OFFICER CERTIFICATION

THE EVALUATED SIGNIFICANCE OF THIS PROPERTY WITHIN THE STATE IS:

NATIONAL

STATE

LOCAL x

As the designated State Historic Preservation Officer for the National Historic Preservation Act of 1966 (Public Law 89-665), I hereby nominate this property for inclusion in the National Register and certify that it has been evaluated according to the criteria and procedures set forth by the National Park Service.

STATE HISTORIC PRESERVATION OFFICER SIGNATURE

Barbara Sudler

TITLE

State Historic Preservation Officer

DATE

January 3, 1984

FOR NPS USE ONLY

I HEREBY CERTIFY THAT THIS PROPERTY IS INCLUDED IN THE NATIONAL REGISTER

Alvina Egan
KEEPER OF THE NATIONAL REGISTER

Entered in the
National Register

DATE

2/16/84

ATTEST:

DATE

CHIEF OF REGISTRATION