

United States Department of the Interior
National Park Service

National Register of Historic Places
Inventory—Nomination Form

For NPS use only

received **AUG 26 1983**
date entered **SEP 22 1983**

See instructions in *How to Complete National Register Forms*
Type all entries—complete applicable sections

1. Name

historic Territorial Commercial District of Chouteau

and/or common

2. Location

street & number Main Street N/A not for publication

city, town Chouteau N/A vicinity of

state Oklahoma code 40 county Mayes code 97

3. Classification

Category	Ownership	Status	Present Use	
<input checked="" type="checkbox"/> district	<input type="checkbox"/> public	<input checked="" type="checkbox"/> occupied	<input type="checkbox"/> agriculture	<input type="checkbox"/> museum
<input type="checkbox"/> building(s)	<input checked="" type="checkbox"/> private	<input type="checkbox"/> unoccupied	<input checked="" type="checkbox"/> commercial	<input type="checkbox"/> park
<input type="checkbox"/> structure	<input type="checkbox"/> both	<input type="checkbox"/> work in progress	<input type="checkbox"/> educational	<input type="checkbox"/> private residence
<input type="checkbox"/> site	Public Acquisition	Accessible	<input type="checkbox"/> entertainment	<input type="checkbox"/> religious
<input type="checkbox"/> object	N/A in process	<input type="checkbox"/> yes: restricted	<input type="checkbox"/> government	<input type="checkbox"/> scientific
	N/A being considered	<input checked="" type="checkbox"/> yes: unrestricted	<input type="checkbox"/> industrial	<input type="checkbox"/> transportation
		<input type="checkbox"/> no	<input type="checkbox"/> military	<input type="checkbox"/> other:

4. Owner of Property

name Multiple Ownership (See Continuation Sheet)

street & number

city, town _____ vicinity of _____ state _____

5. Location of Legal Description

courthouse, registry of deeds, etc. Office of County Clerk

street & number Mayes County Courthouse

city, town Pryor state Oklahoma 74361

6. Representation in Existing Surveys

title Oklahoma Landmarks Inventory has this property been determined eligible? yes no

date 1983 federal state county local

depository for survey records Oklahoma Historical Society - State Historic Preservation Office

city, town Oklahoma City state Oklahoma 73105

7. Description

Condition		Check one	Check one
<input type="checkbox"/> excellent	<input type="checkbox"/> deteriorated	<input checked="" type="checkbox"/> unaltered	<input checked="" type="checkbox"/> original site
<input checked="" type="checkbox"/> good	<input type="checkbox"/> ruins	<input type="checkbox"/> altered	<input type="checkbox"/> moved date _____
<input type="checkbox"/> fair	<input type="checkbox"/> unexposed		

Describe the present and original (if known) physical appearance

The Territorial Commercial District of Chouteau is comprised of three commercial buildings all constructed in 1903. Sharing common walls, they all have red brick finishes, flat roofs, and parapets. The district is bounded by Main Street on the south, Railroad Street on the east, town water tower and open space to the rear, and an alley on the west. The three buildings are located in Block 15 of the original townsite of Chouteau which retains the scale and density in the downtown area that it possessed when the buildings were constructed. Although some of the windows and doors have been replaced and some of the brickwork has been painted, the basic integrity of the district's buildings has been preserved. The facade and east side storefronts are set back equidistant from the sidewalks. The district reflects the small town commercial style of architecture prevalent in the Midwest around the turn of the century. As a forerunner to the Chicago Commercial style, the three buildings feature two-story pilasters separating store fronts and accentuating corners, cornices of moderate projection, and brickwork friezes below second story cornices. A focal point of small town commercial buildings were cutaway entries on the corner of buildings which is used on the southeast corner of the Gray and Atkins Merchantile Store (No. 1 on Sketch Map). Additional features include the use of semielliptical, round, and segmental arches over door and window openings. Large display windows dominate first floor fenestration, whereas second floor windows are single 1/1 double-hung sash types of rectangular shape. With no intrusions, the nominated district retains the same overall scale, proportion, and environmental setting as when it was constructed approximately 80 years ago.

Buildings contributing to the character of the district:

1. Gray and Atkins Merchantile Store (1903): 2-stories, red brick finish with native stone base on facade and east side, cutaway entry on southeast corner, 2-story pilasters separate store fronts and accentuate corners, semielliptical and round arches over door and some window openings in first floor, segmental arches over window openings in second floor, moderately projecting cornice, brickwork frieze (Photo Nos. 1-5 and No. 1 on sketch map).
2. Will Crockett's General Store (1903): 1-story, red brick, flat roof, brickwork frieze, pilasters separating store fronts (Photo Nos 1-2 and No2 on sketch map).
3. Griffin's Grocery and Chouteau Cafe (1903): 2-stories, red brick, moderately projecting cornice, 2-story pilasters separating store fronts and accentuating corners, brickwork frieze, semielliptical arches over window openings on west side (Photo Nos. 7-8 and No. 3 on sketch map).

Non-conforming intrusions detracting from the integrity of the district:

None

**United States Department of the Interior
National Park Service**

**National Register of Historic Places
Inventory—Nomination Form**

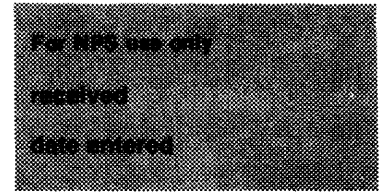

Continuation sheet Owner of Property

Item number 4

Page 1

~~L C Trout~~
~~1528 South Yorktown~~
~~Tulsa, Oklahoma 74104~~
120 Moore
Santa Fe, NM
87501

Building 1 on Sketch Map

John M. Crockett
321 South Gray Place (Home)
Chouteau, Oklahoma 74337

Building 2 on Sketch Map

or

213 N.E. First Street (Office)
Pryor, Oklahoma 74361

Choteau Developments
P.O. Box 435
Chouteau, Oklahoma 74337

Building 3 on Sketch Map

United States Department of the Interior
National Park Service

National Register of Historic Places
Inventory—Nomination Form

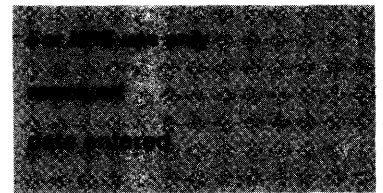

Continuation sheet Description

Item number 7

Page 1

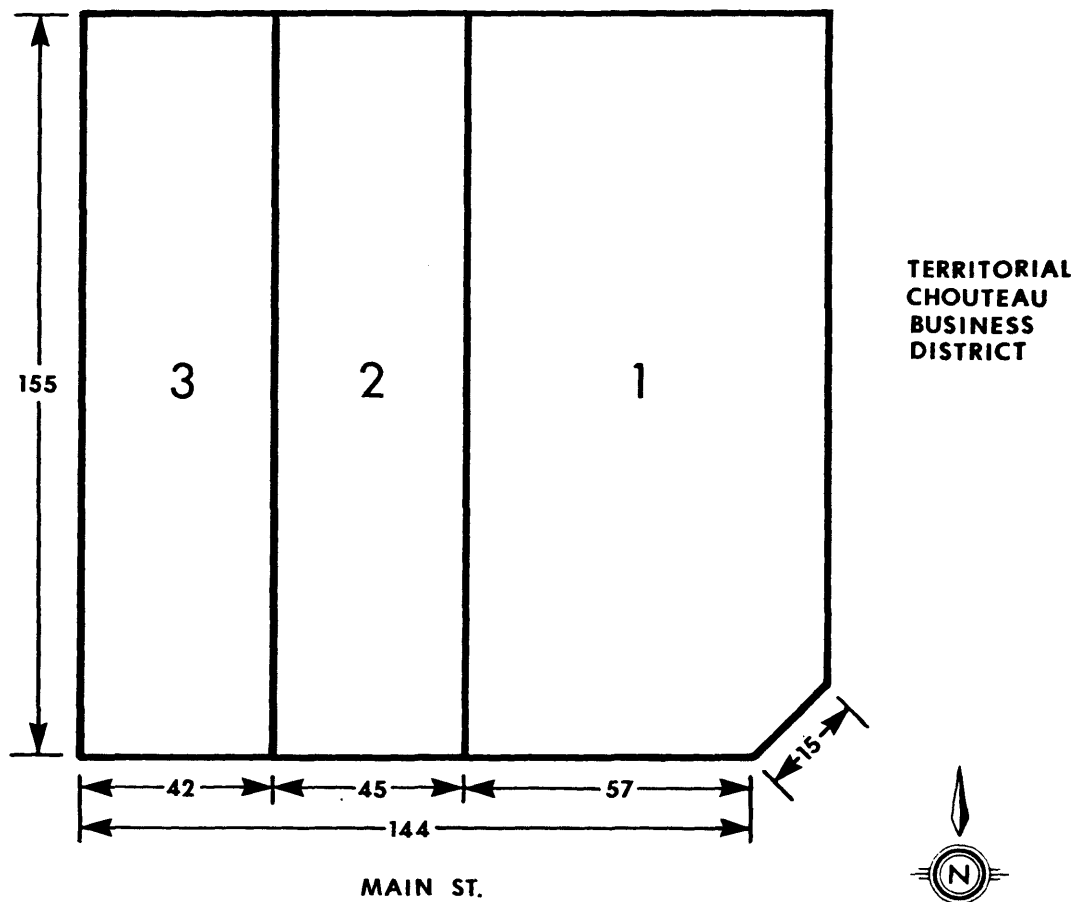

8. Significance

Period	Areas of Significance—Check and justify below			
<input type="checkbox"/> prehistoric	<input type="checkbox"/> archeology-prehistoric	<input type="checkbox"/> community planning	<input type="checkbox"/> landscape architecture	<input type="checkbox"/> religion
<input type="checkbox"/> 1400-1499	<input type="checkbox"/> archeology-historic	<input type="checkbox"/> conservation	<input type="checkbox"/> law	<input type="checkbox"/> science
<input type="checkbox"/> 1500-1599	<input type="checkbox"/> agriculture	<input type="checkbox"/> economics	<input type="checkbox"/> literature	<input type="checkbox"/> sculpture
<input type="checkbox"/> 1600-1699	<input checked="" type="checkbox"/> architecture	<input type="checkbox"/> education	<input type="checkbox"/> military	<input type="checkbox"/> social/
<input type="checkbox"/> 1700-1799	<input type="checkbox"/> art	<input type="checkbox"/> engineering	<input type="checkbox"/> music	<input type="checkbox"/> humanitarian
<input type="checkbox"/> 1800-1899	<input checked="" type="checkbox"/> commerce	<input type="checkbox"/> exploration/settlement	<input type="checkbox"/> philosophy	<input type="checkbox"/> theater
<input checked="" type="checkbox"/> 1900-	<input type="checkbox"/> communications	<input type="checkbox"/> industry	<input type="checkbox"/> politics/government	<input type="checkbox"/> transportation
		<input type="checkbox"/> invention		<input type="checkbox"/> other (specify)

Specific dates 1903-Present **Builder/Architect** Unknown

Statement of Significance (in one paragraph)

The Territorial Commercial District of Chouteaus is both historically and architecturally significant because it: (1) one of the oldest commercial districts in northeastern Oklahoma having been constructed in 1903 during the Indian Territorial Period, and (2) represents one of the best examples of small town Midwestern Commercial style of architecture still intact in northeastern Oklahoma.

Chouteau is one of the oldest towns in Oklahoma having been founded in 1871 when it was a part of the Cherokee Nation, Indian Territory. Because of the French fur trading operations in the early 1800s in the area around Chouteau the town was named in honor of Jean Pierre Chouteau of the Chouteau Fur Trading Company of St. Louis which had trading posts along the Grand River of northeastern Oklahoma. Chouteau began as one of the principal railway centers in the Cherokee Nation because the first railroad in Oklahoma, the Missouri, Kansas, and Texas, laid tracks through the area in 1871. Because of its importance as a freight and passenger center, Chouteau soon developed commercial services to serve the needs of the surrounding community. In addition to its significance as a rail center, Chouteau became a rural market center for the farmers living in the vicinity of the town. The agricultural-oriented area likewise needed goods and services for the rural residents living in the locale. Cotton was the major crop and Chouteau became a major processing and exporting center for cotton producers in the area.

As a result of the necessity for goods and services, a well-developed commercial district emerged in Chouteau. The original wood frame buildings constructed when the town was founded were destroyed by fire ca. 1900, however, the merchants quickly erected a new, more permanent business district constructed of red brick materials in 1903.

Gray and Atkins Mercantile Store (No. 1 on sketch map) was the first business of its type in Chouteau. The two-story building has served the community as a multi-purpose commercial structure during its 80 year history. As one long-term resident recalled, that building has housed businesses which sold goods ranging from "baby bottles to coffins". Prior to World War II, a section of the building's first floor served as the United States Post Office for Chouteau and the second floor provided office space for the local telephone exchange services. The Chouteau Drug currently occupies the first floor of the front half of the building and the rear part of the first floor houses a loan office, teen parlor, and recreation center. The second floor, which once provided office space for physicians and attorneys, is presently used as sleeping rooms.

Will Crockett's General Store (No. 2 on sketch map) has also housed a variety of businesses. Since 1907 Crockett's Land Company has held office space in the one story structure. Following Crockett's General Store were a host of business occupants including a dress shop, real estate office, an insurance agency, and Oklahoma Tire and Supply Company (OTASCO).

The Griffin's Grocery and Chouteau Cafe Building (No. 3 on sketch map) has likewise been a multi-purpose commercial structure. Other first floor occupants have included a drug store, furniture store, and jewelry store. Current businesses include an insurance agency and real estate office. During its early history, the second floor of the building was used for professional office space, however in recent years, local organizations have used it for meeting rooms.

9. Major Bibliographical References

Interview with Juanita Cherry, August, 1982.
 Ruth, Kent, Oklahoma Travel Handbook. Norman: University of Oklahoma Press, 1977.
 Morris, John W., Historical Atlas of Oklahoma. Norman: University of Oklahoma Press, 1976.

10. Geographical Data

Acreeage of nominated property less than one acre

Quadrangle name Chouteau, OK

Quadrangle scale 7.5"

UTM References

A

1	5	2	8	9	1	6	0	4	0	0	7	0	0	0
Zone		Easting					Northing							

B

Zone		Easting					Northing						

C

Zone		Easting					Northing						

D

Zone		Easting					Northing						

E

Zone		Easting					Northing						

F

Zone		Easting					Northing						

G

Zone		Easting					Northing						

H

Zone		Easting					Northing						

Verbal boundary description and justification

(See Continuation Sheet)

List all states and counties for properties overlapping state or county boundaries

state N/A code county code

state code county code

11. Form Prepared By

name/title Claudia Craig supervised by Dr. George Carney

organization Northeast Oklahoma Counties Survey date February, 1983

street & number Oklahoma State University telephone 405/624-6250

city or town Stillwater state Oklahoma 74078

12. State Historic Preservation Officer Certification

The evaluated significance of this property within the state is:

national state local

As the designated State Historic Preservation Officer for the National Historic Preservation Act of 1966 (Public Law 89-665), I hereby nominate this property for inclusion in the National Register and certify that it has been evaluated according to the criteria and procedures set forth by the National Park Service.

State Historic Preservation Officer signature C Emmet Calf date 5/5/83

title date

For NPS use only

I hereby certify that this property is included in the National Register

for Melissa Byers
 Keeper of the National Register

Entered in the
 National Register

date 9/22/83

Attest: date

Chief of Registration

**United States Department of the Interior
National Park Service**

**National Register of Historic Places
Inventory—Nomination Form**

For NPS use only
received
date entered

Continuation sheet Significance

Item number 8

Page 1

The three buildings in the Chouteau Territorial Commercial District provide an excellent example of the architectural style used in small Midwestern towns around the turn of the century. Characteristic of this design is the cutaway entry on the southeast corner of the Gray and Atkins Building. As a forerunner to the Chicago Commercial School, the buildings feature two-story pilasters extending above roof lines, which separate store fronts and accentuate corners; moderately projecting cornices on the upper termination of facades; and brickwork friezes. First floor facades are filled with numerous openings, especially large display windows. Second floor fenestration consists of single 1/1 double-hung sash windows of rectangular shape topped with segmental arches. Semielliptical and round arches are used over first floor openings.

Although occupancy has varied and ownership has changed, the Territorial Commercial District has continuously served the commercial needs of Chouteau and surrounding area for approximately 80 years.

**United States Department of the Interior
National Park Service**

**National Register of Historic Places
Inventory—Nomination Form**

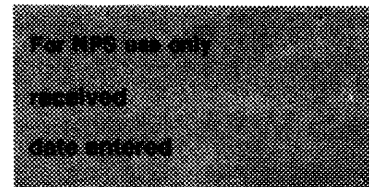

Continuation sheet Verbal Boundary

Item number 10

Page 1

Gray and Atkins Mercantile Store
(No. 1 on sketch map - now Chouteau Drug)

- East 107' of Lots 20-25, Block 15,
Original Townsite of Chouteau, OK

Will Crockett's General Store
(No. 2 on sketch map)

- East 21.75' of West 43.5' of Lots 20-25, Block 15,
Original Townsite of Chouteau, OK

Griffin's Grocery/Chouteau Cafe
(No. 3 on sketch map)

- West 21.75' of Lots 20-25, Block 15,
Original Townsite of Chouteau, OK