

UNITED STATES DEPARTMENT OF THE INTERIOR
NATIONAL PARK SERVICE

FOR NPS USE ONLY
RECEIVED SEP 18 1979
OCT 25 1979
DATE ENTERED

**NATIONAL REGISTER OF HISTORIC PLACES
INVENTORY -- NOMINATION FORM**

SEE INSTRUCTIONS IN HOW TO COMPLETE NATIONAL REGISTER FORMS
TYPE ALL ENTRIES -- COMPLETE APPLICABLE SECTIONS

1 NAME

HISTORIC Pacific Electric Railway Company Depot
AND/OR COMMON

LOCATION

STREET & NUMBER Hwy.
18132 Imperial Highway
CITY, TOWN Yorba Linda VICINITY OF
STATE California CODE 06 COUNTY Orange CODE 059
--- NOT FOR PUBLICATION
CONGRESSIONAL DISTRICT

CLASSIFICATION

CATEGORY	OWNERSHIP	STATUS	PRESENT USE
<input checked="" type="checkbox"/> DISTRICT	<input type="checkbox"/> PUBLIC	<input checked="" type="checkbox"/> OCCUPIED	<input type="checkbox"/> AGRICULTURE <input type="checkbox"/> MUSEUM
<input type="checkbox"/> BUILDING(S)	<input checked="" type="checkbox"/> PRIVATE	<input type="checkbox"/> UNOCCUPIED	<input checked="" type="checkbox"/> COMMERCIAL <input type="checkbox"/> PARK
<input type="checkbox"/> STRUCTURE	<input type="checkbox"/> BOTH	<input type="checkbox"/> WORK IN PROGRESS	<input type="checkbox"/> EDUCATIONAL <input type="checkbox"/> PRIVATE RESIDENCE
<input type="checkbox"/> SITE	PUBLIC ACQUISITION	<input checked="" type="checkbox"/> ACCESSIBLE	<input type="checkbox"/> ENTERTAINMENT <input type="checkbox"/> RELIGIOUS
<input type="checkbox"/> OBJECT	<input type="checkbox"/> IN PROCESS	<input type="checkbox"/> YES: RESTRICTED	<input type="checkbox"/> GOVERNMENT <input type="checkbox"/> SCIENTIFIC
	<input type="checkbox"/> BEING CONSIDERED	<input type="checkbox"/> YES: UNRESTRICTED	<input type="checkbox"/> INDUSTRIAL <input type="checkbox"/> TRANSPORTATION
		<input type="checkbox"/> NO	<input type="checkbox"/> MILITARY <input type="checkbox"/> OTHER:

OWNER OF PROPERTY

NAME Southern Pacific Land Company

STREET & NUMBER
1 Market Plaza

CITY, TOWN San Francisco VICINITY OF STATE California 94105

LOCATION OF LEGAL DESCRIPTION

COURTHOUSE, REGISTRY OF DEEDS, ETC. Orange County Recorder

STREET & NUMBER
630 N. Broadway

CITY, TOWN Santa Ana STATE California

6 REPRESENTATION IN EXISTING SURVEYS

TITLE
none

DATE
--- FEDERAL --- STATE --- COUNTY --- LOCAL

DEPOSITORY FOR SURVEY RECORDS

CITY, TOWN STATE

7 DESCRIPTION

CONDITION

EXCELLENT
 GOOD
 FAIR

DETERIORATED
 RUINS
 UNEXPOSED

CHECK ONE

UNALTERED
 ALTERED

CHECK ONE

ORIGINAL SITE
 MOVED DATE _____

DESCRIBE THE PRESENT AND ORIGINAL (IF KNOWN) PHYSICAL APPEARANCE

The building is a combination passenger and freight depot constructed in 1911. The single story wooden building is sheathed in horizontal siding and is capped with a ballcast hipped roof. The west end is an open waiting area under a portico supported by Doric columns; the ticket office and interior waiting room is reached through this section. A small gable projects from the roofline on the south side of the building, extending over a slanted bay window facing the area formerly occupied by tracks. The east end of the building was the freight area; this section has been modernized for use as a nursery office. The major change in this section is the addition of vertical siding and new aluminum frame windows. This modernization occupies only a small portion of the building and does not detract from the overall appearance and character of the depot. Original windows and doors remain throughout the remainder of the building.

The major change in the setting occurred with the removal of the railroad tracks in 1951, and the subsequent conversion of the grounds for use as a nursery. A low wooden fence and landscaping have been added around the nursery office section, and the area formerly occupied by the tracks is used for storage of plants in metal nursery containers.

Overall, the integrity of the building is high and still conveys a strong historical feeling. The depot remains a good example of its type and period, and is one of the local community's few remaining historical structures.

8 SIGNIFICANCE

PERIOD	AREAS OF SIGNIFICANCE -- CHECK AND JUSTIFY BELOW			
<input type="checkbox"/> PREHISTORIC	<input type="checkbox"/> ARCHEOLOGY-PREHISTORIC	<input type="checkbox"/> COMMUNITY PLANNING	<input type="checkbox"/> LANDSCAPE ARCHITECTURE	<input type="checkbox"/> RELIGION
<input type="checkbox"/> 1400-1499	<input type="checkbox"/> ARCHEOLOGY-HISTORIC	<input type="checkbox"/> CONSERVATION	<input type="checkbox"/> LAW	<input type="checkbox"/> SCIENCE
<input type="checkbox"/> 1500-1599	<input type="checkbox"/> AGRICULTURE	<input type="checkbox"/> ECONOMICS	<input type="checkbox"/> LITERATURE	<input type="checkbox"/> SCULPTURE
<input type="checkbox"/> 1600-1699	<input type="checkbox"/> ARCHITECTURE	<input type="checkbox"/> EDUCATION	<input type="checkbox"/> MILITARY	<input type="checkbox"/> SOCIAL/HUMANITARIAN
<input type="checkbox"/> 1700-1799	<input type="checkbox"/> ART	<input type="checkbox"/> ENGINEERING	<input type="checkbox"/> MUSIC	<input type="checkbox"/> THEATER
<input type="checkbox"/> 1800-1899	<input type="checkbox"/> COMMERCE	<input type="checkbox"/> EXPLORATION/SETTLEMENT	<input type="checkbox"/> PHILOSOPHY	<input checked="" type="checkbox"/> TRANSPORTATION
<input checked="" type="checkbox"/> 1900-	<input type="checkbox"/> COMMUNICATIONS	<input type="checkbox"/> INDUSTRY	<input type="checkbox"/> POLITICS/GOVERNMENT	<input type="checkbox"/> OTHER (SPECIFY)
		<input type="checkbox"/> INVENTION		

SPECIFIC DATES	1911	BUILDER/ARCHITECT	Pacific Electric Railway
----------------	------	-------------------	--------------------------

STATEMENT OF SIGNIFICANCE

The Yorba Linda depot is one of the last surviving structures associated with the nation's largest suburban electric transportation system, the Pacific Electric Railway. Only a few depots from this vast system still exist; the Yorba Linda depot is an intact example of the combination passenger and freight facilities constructed by the railroad in smaller communities throughout the Los Angeles Basin in the early 20th century. It was important as a focal point for transportation and rail commerce in the local community, and provided convenient rail access to the major metropolitan areas to the west. The building remains as one of the few historic structures in this area of rapid suburban growth.

The Yorba Linda depot was constructed in 1911 when Pacific Electric Railway extended its Whittier line into the local area. The structure combined freight and passenger operations under one roof, and was a typical design used by Pacific Electric--similar depots were built at La Habra, Glendora, Covina and Watts. Today, few depots remain from this system which was once one of the major factors contributing the the growth and development of Southern California.

When in use by the interurban electric railway system, the depot was a central point of activity in Yorba Linda. The red cars made nine daily runs to Los Angeles from the depot. Passenger service continued until January, 1938, when the advent of improved highways and increased use of the private automobile reduced ridership, making continued operation of passenger service economically infeasible. The rails along the line were used for freight movement until 1951, when they were removed.

The Yorba Linda Pacific Electric depot remains as one of the community's last tangible links with its past. Today the old depot serves as commercial offices, but faces an uncertain future with developmental pressure threatening the property.

9 MAJOR BIBLIOGRAPHICAL REFERENCES

Butz, March, 1970, Yorba Linda, It's History

Frisbee, Don, 1979, Former Packing House Office Manager, Telephone Conversation between Frisbee and Westec Services, Inc., Environmental Consultants, January, 1979.

Walker, James, Jr., 1979, President, Orange Empire Railway Museum, Perris, California. Telephone conversation with Westec Services, Inc., January 1979. (continued)

10 GEOGRAPHICAL DATA

UTM NOT VERIFIED

ACREAGE OF NOMINATED PROPERTY .07 acre

UTM REFERENCES Yorba Linda, California Quadrangle Scale: 1:24000

A	1 1	4 2 4 5 4 0	3 7 5 0 1 8 0	B			
	ZONE	EASTING	NORTHING		ZONE	EASTING	NORTHING
C				D			

VERBAL BOUNDARY DESCRIPTION

Property is located at 18132 Imperial Highway, Yorba Linda, California, and occupies the western end of Orange County assessor's parcel 334-391-1, as shown on the attached map.

LIST ALL STATES AND COUNTIES FOR PROPERTIES OVERLAPPING STATE OR COUNTY BOUNDARIES

STATE	CODE	COUNTY	CODE
STATE	CODE	COUNTY	CODE

11 FORM PREPARED BY

NAME / TITLE

Steve Rudometkin, Superintendent of Recreation

May 8, 1979

ORGANIZATION

4845 Main Street

DATE

(714) 524-5000

STREET & NUMBER

Yorba Linda

TELEPHONE

California 92686

CITY OR TOWN

STATE

12 STATE HISTORIC PRESERVATION OFFICER CERTIFICATION

THE EVALUATED SIGNIFICANCE OF THIS PROPERTY WITHIN THE STATE IS:

NATIONAL

STATE

LOCAL

As the designated State Historic Preservation Officer for the National Historic Preservation Act of 1966 (Public Law 89-665), I hereby nominate this property for inclusion in the National Register and certify that it has been evaluated according to the criteria and procedures set forth by the National Park Service.

STATE HISTORIC PRESERVATION OFFICER SIGNATURE

Kenneth M. Ellison

TITLE

DATE

9-12-79

FOR NPS USE ONLY

I HEREBY CERTIFY THAT THIS PROPERTY IS INCLUDED IN THE NATIONAL REGISTER

Carol Shull

DATE

10-25-79

DIRECTOR, OFFICE OF ARCHEOLOGY AND HISTORIC PRESERVATION

KEEPER OF THE NATIONAL REGISTER

ATTEST:

DATE

10-24-79

KEEPER OF THE NATIONAL REGISTER

FHR-8-300A
(11/78)

UNITED STATES DEPARTMENT OF THE INTERIOR
HERITAGE CONSERVATION AND RECREATION SERVICE

**NATIONAL REGISTER OF HISTORIC PLACES
INVENTORY -- NOMINATION FORM**

FOR HCRS USE ONLY	
RECEIVED	SEP 18 1979
DATE ENTERED	OCT 25

CONTINUATION SHEET

ITEM NUMBER 9 PAGE 2

Westec Services, Inc., 1979, Draft Environmental Impact Report, Office Park, Yorba Linda, California.

Duke, Donald, 1958, Pacific Electric Railway, Golden West Books, San Marino, California.

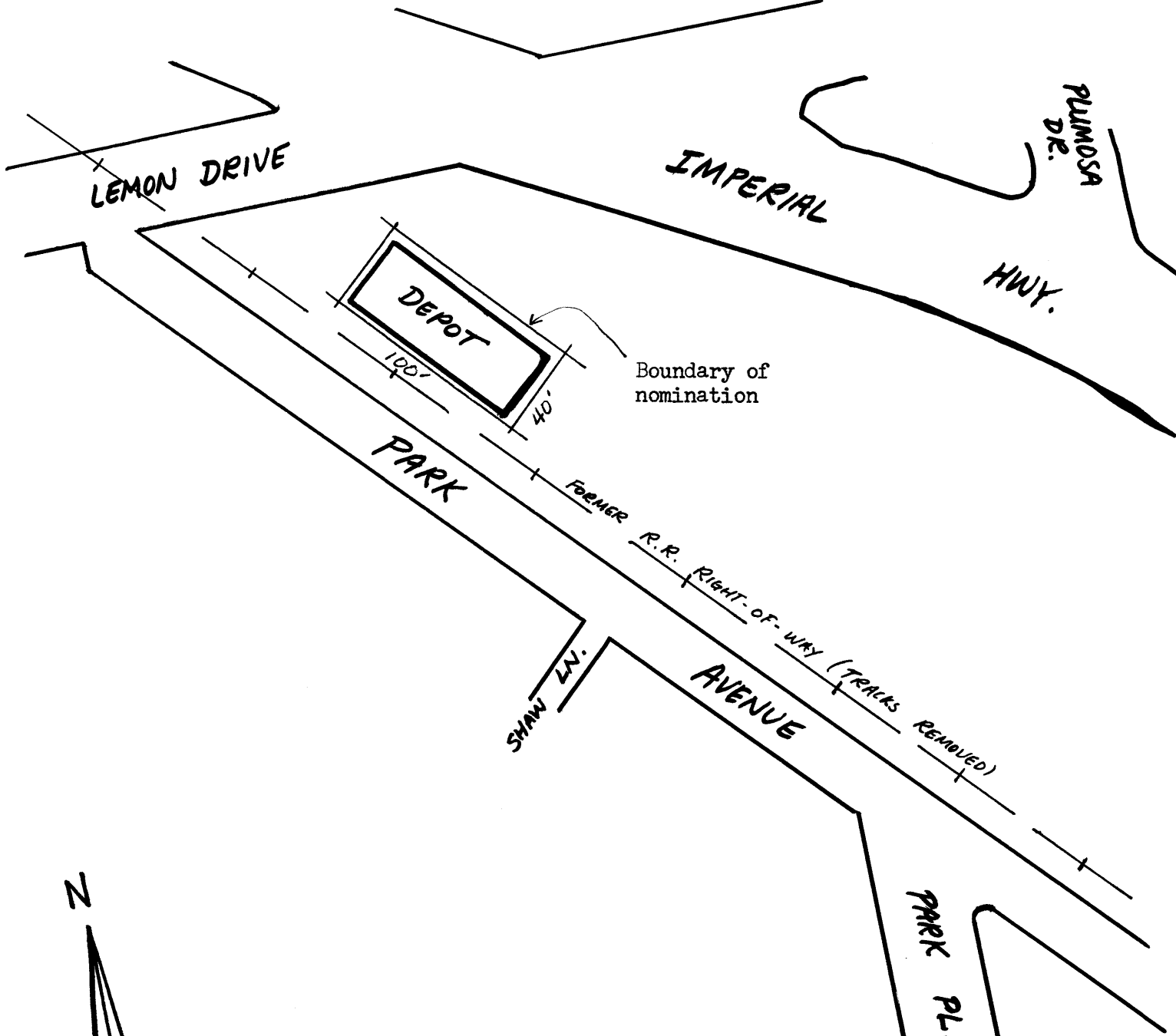

Boundary of nomination

Map drawn to scale based upon
 County of Orange Assessor's Map,
 Book 334, Page 39.

PACIFIC ELECTRIC RAILWAY COMPANY DEPOT
 18132 Imperial Highway
 Yorba Linda, Orange County, California

