

250

United States Department of the Interior
National Park Service

National Register of Historic Places
Registration Form

RECEIVED 2280

APR 01 2016

Nat. Register of Historic Places
National Park Service

This form is for use in nominating or requesting determinations for individual properties and districts. See instructions in *How to Complete the National Register of Historic Places Registration Form* (National Register Bulletin 16A). Complete each item by marking "x" in the appropriate box or by entering the information requested. If any item does not apply to the property being documented, enter "N/A" for "not applicable." For functions, architectural classification, materials, and areas of significance, enter only categories and subcategories from the instructions. Place additional entries and narrative items on continuation sheets (NPS Form 10-900a). Use a typewriter, word processor, or computer, to complete all items.

1. Name of Property

historic name Federalsburg West Historic District

other names CAR-338

2. Location

street & number Roughly bounded by Railroad Ave., University Ave., Bloomingdale Ave., Denton Rd., Idlewild Rd., and Marshyhone Creek

not for publication

city or town Federalsburg

vicinity

state Maryland code MD county Caroline code 011 zip code 21632

3. State/Federal Agency Certification

As the designated authority under the National Historic Preservation Act of 1966, as amended, I hereby certify that this nomination request for determination of eligibility meets the documentation standards for registering properties in the National Register of Historic Places and meets the procedural and professional requirements set forth in 36 CFR Part 60. In my opinion, the property meets does not meet the National Register criteria. I recommend that this property be considered significant nationally statewide locally. (See continuation sheet for additional comments).

Kirah Hight
Signature of certifying official/Title

3-25-16
Date

Director/SHPO, Maryland Historical Trust
State or Federal agency and bureau

In my opinion, the property meets does not meet the National Register criteria. (See continuation sheet for additional comments).

Signature of certifying official/Title

Date

State or Federal agency and bureau

4. National Park Service Certification

I hereby, certify that this property is:

- entered in the National Register.
 - See continuation sheet.
- determined eligible for the National Register.
 - See continuation sheet.
- Determined not eligible for the National Register.
- removed from the National Register.
- other (explain): _____

Signature of the Keeper

Date of Action

Patrick Andrews

5/12/2016

5. Classification

Ownership of Property

(Check as many boxes as apply)

- private
- public-local
- public-State
- public-Federal

Category of Property

(Check only one box)

- building(s)
- district
- site
- structure
- object

Number of Resources within Property

(Do not include previously listed resources in the count)

Contributing	Noncontributing	
429	28	buildings
1		sites
2		structures
		objects
432	28	Total

Name of related multiple property listing

(Enter "N/A" if property is not part of a multiple property listing)

N/A

number of contributing resources previously listed in the National Register

2

6. Function or Use

Historic Functions

(Enter categories from instructions)

DOMESTIC/single dwelling/multiple dwelling
 COMMERCE/TRADE/business/organizational,
 financial institution/specialty store/department store/
 warehouse
 SOCIAL/meeting hall
 RELIGION/religious facility/church related residence
 RECREATION/CULTURE/theater
 TRANSPORTATION/rail-related
 INDUSTRY/manufacturing facility

Current Functions

(Enter categories from instructions)

DOMESTIC/single dwelling/multiple dwelling
 COMMERCE/TRADE/business/organizational, specialty
 store
 SOCIAL/meeting hall
 RELIGION/religious facility
 RECREATION/CULTURE/museum

7. Description

Architectural Classification

(Enter categories from instructions)

EARLY REPUBLIC/Federal/vernacular
 MID-19TH CENTURY/Greek Revival
 LATE VICTORIAN/Gothic/Italianate/Second Empire/
 LATE 19TH 20TH CENTURY REVIVALS/Classical Rev.
 LATE 19TH and EARLY 20TH CENTURY AMERICAN
 MOVEMENTS/Bungalow/Craftsman/Four-Square

Materials

(Enter categories from instructions)

foundation BRICK or CONCRETE BLOCK
 walls WOOD/Weatherboard./Shingle
 SYNTHETICS/Vinyl
 roof ASPHALT
 other

Narrative Description

(Describe the historic and current condition of the property on one or more continuation sheets)

8. Statement of Significance

Applicable National Register Criteria

(Mark "x" in one or more boxes for the criteria qualifying the property for National Register listing)

- A Property is associated with events that have made a significant contribution to the broad pattern of our history.
- B Property associated with the lives of persons significant in our past.
- C Property embodies the distinctive characteristics of a type, period, or method of construction or represents the work of a master, or possesses high artistic values, or represents a significant and distinguishable entity whose components lack individual distinction.
- D Property has yielded, or is likely to yield, information important in prehistory or history.

Criteria Considerations

(Mark "x" in all the boxes that apply)

Property is:

- A owned by a religious institution or used for religious purposes.
- B removed from its original location.
- C a birthplace or grave.
- D a cemetery.
- E a reconstructed building, object, or structure.
- F a commemorative property.
- G less than 50 years of age or achieved significance within the past 50 years.

Narrative Statement of Significance

(Explain the significance of the property on one or more continuation sheets)

Area of Significance

(Enter categories from instructions)

ARCHITECTURE

Period of Significance

1790-1964

Significant Dates

1791, 1823, 1844, 1868, 1880

Significant Person

(Complete if Criterion B is marked above)

N/A

Cultural Affiliation

N/A

Architect/Builder

9. Major Bibliographical References

Bibliography

(Cite the books, articles, and other sources used in preparing this form on one or more continuation sheets)

Previous documentation on files (NPS):

- preliminary determination of individual listing (36 CFR 67) has been requested
- previously listed in the National Register
- previously determined eligible by the National Register
- designated a National Historic Landmark
- recorded by Historic American Buildings Survey # _____
- recorded by Historic American Engineering Record # _____

Primary location of additional data:

- State Historic Preservation Office
- Other State agency
- Federal agency
- Local government
- University
- Other

Name of repository:

Federalsburg West Historic District, CAR-338
Name of Property

Caroline County, Maryland
County and State

10. Geographical Data

Acreage of Property Approximately 275 acres Federalsburg, MD quad

UTM References

(Place additional UTM references on a continuation sheet)

1	<input type="text"/>	<input type="text"/>	<input type="text"/>	3	<input type="text"/>	<input type="text"/>	<input type="text"/>
	Zone	Easting	Northing		Zone	Easting	Northing
2	<input type="text"/>	<input type="text"/>	<input type="text"/>	4	<input type="text"/>	<input type="text"/>	<input type="text"/>

See continuation sheet

Verbal Boundary Description

(Describe the boundaries of the property on a continuation sheet)

Boundary Justification

(Explain why the boundaries were selected on a continuation sheet)

11. Form Prepared By

name/title Paul Baker Touart, Architectural Historian
Organization Consultant date 11.30.2014
street & number Cedar Hill, Box 5 telephone 410-651-1094
city or town Westover state Maryland zip code 21871

Additional Documentation

Submit the following items with the completed form:

Continuation Sheets

Maps

A **USGS map** (7.5 or 15 minute series) indicating the property's location.

A **Sketch map** for historic districts and properties having large acreage or numerous resources.

Photographs

Representative **black and white photographs** of the property.

Additional Items

(Check with the SHPO or FPO for any additional items)

Property Owner

(Complete this item at the request of SHPO or FPO)

name Numerous
street & number _____ telephone _____
city or town _____ state _____ zip code _____

Paperwork Reduction Statement: This information is being collected for applications to the National Register of Historic Places to nominate properties for listing or determine eligibility for listing, to list properties, and to amend existing listings. Response to this request is required to obtain a benefit in accordance with the National Historic Preservation Act, as amended (16 U.S.C. 470 *et. seq.*).

Estimated Burden Statement: Public reporting burden for this form is estimated to average 18.1 hours per response including the time for reviewing instructions, gathering and maintaining data, and completing and reviewing the form. Direct comments regarding this burden estimate or any aspect of this form to the Chief, Administrative Services Division, National Park Service, P.O. Box 37127, Washington, DC 20013-7127; and the Office of Management and Budget, Paperwork Reductions Project (1024-0018), Washington, DC 20503.

United States Department of the Interior
National Park Service

National Register of Historic Places Continuation Sheet

CAR-338
Federalburg West Historic District

Name of Property

Caroline County, Maryland

County and State

Section 7 Page 1

Description Summary:

The Town of Federalburg is located on the Marshyhope Creek, a tributary of the Nanticoke River, in southern Caroline County, Maryland. The Federalburg West Historic District comprises the part of the town on the west side of Marshyhope Creek with primary road access provided by MD Routes 307 and 309, both of which intersect the Federalburg By-Pass that rings the western and southern sections of the town. MD Route 307 is an east/west route and is an extension of Academy Avenue, whereas MD 319 is an extension of Bloomingdale Avenue and Main Street. Central Avenue bisects the historic district and crosses the Marshyhope Creek.

The Federalburg West Historic District is located partially on a floodplain of the Marshyhope Creek as well as higher ground on which the town expanded during the late 19th and early 20th centuries. The corridor of the Maryland-Delaware Railroad, located parallel to Railroad Avenue, forms the southern boundary of the historic area.

The buildings that define the Federalburg West Historic District range in date from the early 19th century to the mid 20th century. The largest concentration of resources date between 1880 and 1950 when the town experienced explosive growth as a center of commerce and industry in the southern end of Caroline County servicing northeastern Dorchester County and Sussex County, Delaware. Due to several downtown fires and floods, the early housing stock of the district is reduced to three dwellings dating from the first quarter of the 19th century. The property known as Exeter, CAR-70, already listed on the National Register, stands on the northeast side of the district and it dates to the first quarter of the 19th century. The house known as Sandy Hill, located at 324 South Main Street, is another prominent structure that retains original vernacular building finishes, including beaded weatherboards and an exposed brick firewall on its north gable end. A smaller story-and-a-half house standing at 311 North Main Street, is more typical of the small one- or two-room plan dwellings that defined Federalburg in its first generation of development.

The district also retains a few structures dating from the third quarter of the 19th century, and prominent among them is the Christ United Methodist Church on South Main Street, erected in 1871-72 by the Federalburg Presbyterians. It was later acquired and enlarged by the town's Methodist Protestant congregation. The Greek Revival influenced frame church has a bold pediment and classically inspired front entrance distinctive for its semi-circular designed transom lights.

The majority of the district, however, is defined by houses, outbuildings, commercial buildings and churches dating from the late 19th and early to mid 20th centuries. Following

United States Department of the Interior
National Park Service

National Register of Historic Places Continuation Sheet

CAR-338
Federalburg West Historic District

Name of Property

Caroline County, Maryland

County and State

Section 7 Page 2

prevailing national trends in the late Victorian Gothic, Second Empire, and Italianate, Neoclassical, bungalow, four-square, Colonial Revival and early Ranch style house designs. The collection also includes dwellings built in response to popular literature during the pre and post World War II period. Greatly facilitating the construction of the late 19th and 20th century buildings was the industrialization of the construction industry, which produced a variety of building products that were shipped to Federalburg by railroad or steamboat. There is a particularly high percentage of buildings that incorporate early and later rock-faced and other patterned, mass-produced concrete blocks in foundation and wall construction.

General Description:

The Federalburg West Historic District is located on the north and west sides of the floodplain and upland surrounding the Marshyhope Creek in this Caroline County town of 2,700 residents. Principal road access is provided by MD Routes 306 and 307 from the east and west, and the Old Denton Road and MD Route 577 from the north and south. During the late 20th century a by-pass was introduced on the south and west sides of Federalburg. Central Avenue, East and West, extends through the heart of the town and crosses the Marshyhope Creek. Federalburg East Historic District, delineated with its own boundary, is not part of this nomination.

The Federalburg West Historic District contains 432 Contributing and 28 Non-Contributing Resources as enumerated on the resource list below. The contributing resources include one dwelling, Exeter (CAR-70) that dates to the first quarter of the 19th century, and two other structures estimated to date around 1825-50. Another forty-nine (49) resources were classified as dating from the second half of the 19th century, whereas the largest majority date from the period stretching from 1900 to 1960.

Part of the central business district of Federalburg was ravaged by fire in 1898, and during the decades that followed masonry buildings of brick, stuccoed terra cotta blocks, and rusticated or paneled concrete blocks replaced the frame buildings that defined the center of town during the 19th century. Principal buildings and structures defining the business district include the former Federalburg Bank and the former First National Bank, both neoclassically inspired brick structures; the Nanticoke Masonic Lodge, a textured stucco hollow core terra cotta block building with Colonial Revival detailing, the brick walled Federal Theater, now housing the town offices, the rusticated concrete block W. R. Breeding building, the former Federalburg Presbyterian Church, the Union M. E. Church, and the poured concrete Central Avenue bridge as well as a score of prominent dwellings.

United States Department of the Interior
National Park Service

National Register of Historic Places Continuation Sheet

CAR-338
Federalsburg West Historic District

Name of Property

Caroline County, Maryland

County and State

Section 7 Page 3

The earliest housing that defines the district includes three principal dwellings, Exeter, Sandy Hill, and the story-and-a-half frame house at 311 North Main Street. Resting on low brick foundations, the houses retain portions of beaded weatherboard siding, and follow side hall/parlor and center hall/single pile plans. 311 North Main Street repeats a story-and-a-half, three-bay house form that was typical of the early architecture of the town during its formative decades.

The second half of the 19th century was a period of distinct change and transformation in construction with the industrialization of the building process. At the same time American architects published a new generation of style books that influenced domestic designs throughout the region. While the vernacular side hall/parlor and center hall/single pile plans still remained popular, the exteriors were often built with stylish features such as a Second Empire mansard roof in the case of the E. R. Goslin house on West Central Avenue, or a bracketed cornice and/or turned post front porch with decorative, mass-produced corner brackets. The second half of the 19th century was a period when asymmetrical floor plans and exterior elevations contrasted with the vernacular plans of the previous generation. Brick was universally used for foundations and single-flue chimney stacks for more efficient stove heat. Many houses along North and South Main Street, Bloomingdale Avenue, and West Central Avenue as well as other side streets were erected with these design priorities.

The asymmetrical and symmetrical plan house types with mass-produced bracketed and sawn decoration remained popular after the turn of the 20th century. The early to mid 20th century is the period during which the lion's-share of resources in the Federalsburg West District were erected. The favored foundation and wall material turned to mass-produced concrete blocks with various finishes including rock-faced or rusticated, paneled or cobblestone surfaces. A new generation of houses types including Queen Anne influenced dwellings with projecting two-story pavilions, four-square house forms with steeply pitched hip roofed and hip or gable roofed dormers and porches, and a wide variety of bungalow style houses, mostly story-and-a-half dwellings with engaged porches. Rusticated block or brick foundations and porch post plinths are found throughout the town. In a few cases the porch columns are made of cast concrete (e.g., 302-04 South Main Street and 316 Holt Street). Many of the early 20th bungalow influenced dwellings have Craftsman style stick brackets supporting extended eaves.

The early to mid 20th century dwellings that were erected during the 1920s, 1930s and 1940s represent a range of popular house forms, many of which were published in national magazines, builders' journals, newspapers, and periodicals that reached every corner of the country. After World War I, a group of architects based in Minnesota created the Architects' Small House Service Bureau, and the organization published a monthly journal entitled, *The*

United States Department of the Interior
National Park Service

National Register of Historic Places Continuation Sheet

CAR-338
Federalsburg West Historic District

Name of Property

Caroline County, Maryland

County and State

Section 7 Page 4

Small Home. The organization grew to a point of having regional offices across the country. Many small to medium sized houses in Federalsburg repeat designs similar to those published in plan and elevation.¹ The organization published journals between its founding in 1919 to 1942.

The houses that express these popular designs were erected largely in frame construction but there are a few brick examples, some of which have the rustic look that “klinker” brick provided in evoking a rustic English cottage. The most popular designs, as implemented nationwide, were those that evoked a conservative Colonial Revival street elevation. These houses are particularly evident within the 200 and 300 blocks of West Central Avenue, Maple and Academy streets, and Bloomingdale Avenue.

The 1950s and 1960s ushered in various versions of the nationally popular Ranch style house, a single-story gable roofed structure with a medium pitch to the roof and in some cases projecting front sections and engaged porches. The Ranch style houses in the Federalsburg district are interspersed within the houses erected during the previous decades as town lots continued to be improved.

¹ *Your Future Home, Architect-Designed Houses of the Early 1920s*, Reprint of 1923 Edition, American Institute of Architects, 1992.

United States Department of the Interior
National Park Service

National Register of Historic Places Continuation Sheet

CAR-338
Federalsburg West Historic District

Name of Property

Caroline County, Maryland

County and State

Section 7 Page 5

Federalsburg West Historic District List of Contributing and Non-Contributing Resources

North Main Street

1. 101-05 North Main Street, c. 1920-30, **Contributing**, Two-story, seven-bay by five-bay stretcher bond brick commercial block, flat roof with parapet wall featuring corbelled and dentiled cornice on street elevations, recessed entrances with plain cornice, brick jack arches span each window opening.
2. 102 North Main Street, c. 1910, **Contributing**, Federalsburg Bank, Single-story, neoclassical brick bank building with finely executed exterior detailing including narrow Roman sized brickwork, corner quoins accented with stone, stone watertable cap, round window arches flanked by Corinthian order pilasters, intricately detailed modillion block cornice, decorative iron grilles and gate survive on east (rear) of bank building, mid 20th century Modernist addition to north side executed in Roman sized brick.
3. 107 North Main Street, c. 1920-30, **Contributing**, Two-story, three-bay, stretcher bond brick commercial block with basketweave brick patterning across top of front wall, brick jack arches, altered first floor storefront.
4. 109 North Main Street, c. 1940-50, **Contributing**, One-story, two-bay brick office building, stretcher bond brick front, recessed entrance.
5. 111 North Main Street, c. 1920, **Contributing**, Two-story, two-bay brick and concrete block commercial block capped by low hip roof, replacement windows, and recessed store entrance.
6. 115 North Main Street, c. 1910-20, **Contributing**, Two-story, two-bay common bond brick commercial block with intact first floor storefront, recessed entrance and Victorian cornice with decorative end cast iron end blocks, identical cornice finishes parapet wall.
7. 117 North Main Street, c. 1940-50, **Contributing**, Single-story stretcher bond brick commercial block.
8. 112-16 North Main Street, 1919-20, **Contributing**, National Register listed Nanticoke Lodge Masonic Temple, Two-and-a-half story, 80'4" by 68'4" commercial building originally housing business storefronts on the first floor and a lodge room and theater on the second

United States Department of the Interior
National Park Service

National Register of Historic Places Continuation Sheet

CAR-338
Federalsburg West Historic District

Name of Property

Caroline County, Maryland

County and State

Section 7 Page 6

floor, textured stucco exterior with Colonial Revival details—round arched windows, neoclassical lodge entrance, recessed storefront entrances, dormered hip roof.

9. 118 North Main Street, 1930-31, (Built as the Federal Theatre) **Contributing**, Finely executed three-story, stretcher bond brick theater building now used as offices for the Federalsburg Senior Center and Federalsburg Town Hall, stretcher bond brick wall construction with projecting three-bay center section dominated by three round arched window openings accented in raised brickwork, parapet wall finishes with intricate cornice capped by brick piers interspersed with baluster form solid panels, flanking sections to projecting center section finished with diagonal basketweave brickwork and rectangular panels accented with raised brickwork, marquee awning shelters original theater entrance which has been altered. Common bond brick side wall construction. Yellow brick in southeast front corner marks the height of the 1935 flood.
10. 119 North Main Street, c. 1920-30, **Contributing**, Two-story, rusticated concrete block commercial block, decorative panel in upper face of commercial front, metal and wood cornice, cast metal end blocks with decorative floral motifs.
11. 121 North Main Street, c. 1940, **Contributing**, Single-story brick commercial block; stepped parapet façade with decorative brickwork above commercial front.
12. 123-25 North Main Street, Chambers House, c. 1870-80, **Contributing**, Two-story, three-bay side hall/parlor frame house with Victorian turned post porch, bracketed cornice and turned post porch on south side elevation.
13. 201 North Main Street, c. 1880, **Contributing**, Two-and-a-half story, three-bay Victorian frame house with projecting center pavilion, turned post porch, two-over-two sash windows.
14. 203-05 North Main Street, c. 1880, **Contributing**, Two-story, ell-shaped frame house, plain detailing with two-story commercial brick infill in corner of main façade.
15. 204-06 North Main Street, c. 1880, **Contributing**, Two-story, multi-sectioned frame house with two-story main block and single-story rear wing, converted to duplex
16. 207 North Main Street, c. 1900-10, **Contributing**, Two-story, gable-front frame house with gable roofed portico and mid 20th century side addition, single story bay window on north side.

United States Department of the Interior
National Park Service

National Register of Historic Places Continuation Sheet

CAR-338
Federalsburg West Historic District

Name of Property

Caroline County, Maryland

County and State

Section 7 Page 7

17. 208 North Main Street, c. 1910-20, **Contributing**, Two-and-a-half story Queen Anne style frame house on raised foundation, rusticated concrete block porch plinths support half Tuscan columns, colored glass windows in rectangular, diamond and circular shapes define north wall, asymmetrical front elevation with projecting pavilion capped by gable roof and trimmed with Victorian spindle work under soffit.
18. 210 North Main Street, Verizon Building, c. 1950-60, **Contributing**, Single-story stretcher bond brick building with jack arches and Colonial Revival detailing.
19. 212 North Main Street, c. 1880-90, **Contributing**, Two-story, three-bay frame house with Tuscan columned porch.
20. 213 North Main Street, c. 1900-10, **Contributing**, Two-story, ell-shaped frame house with gable roofed portico, mid 20th century side addition, single-story bay window on north side.
21. 215 North Main Street, c. 1920, **Contributing**, Story-and-a-half stretcher bond brick bungalow with well preserved details; tapered half columns rest on brick plinths, large shed roofed dormer with Craftsman style stick brackets and exposed rafter tails.
22. 214-16 North Main Street, Frampton Funeral Home, c. 1910-60, **Contributing**, Two-story, Colonial Revival style brick dwelling used as funeral home, half round lunette windows in gables, Colonial Revival entrance.
23. 217 North Main Street, c. 1920, **Contributing**, Single-story frame bungalow with shingled exterior and jerkinhead form roof, engaged shed porch with triple column corner posts, six-over-one sash windows, diamond pane upper sash in attic windows.
24. 218 North Main Street, c. 1870, **Contributing**, Two-story, three-bay, single-pile frame house with bracketed cornice, corner pilasters, bracketed window lintels, partially enclosed turned post front porch with sawn corner brackets.
25. 301 North Main Street, c. 1940-50, **Contributing**, Mid 20th century exterior with stretcher bond brickwork, colored glass windows, buttresses rise to extended eaves, 1970 Sunday School wing, 19th and 20th century cemetery on north side bordered by a brick wall.
26. 304 North Main Street, c. 1880, **Contributing**, Two-story, asymmetrical plan Victorian house with decorative sawnwork gable-front eave, two-over-two sash windows.

United States Department of the Interior
National Park Service

National Register of Historic Places Continuation Sheet

CAR-338
Federalsburg West Historic District

Name of Property

Caroline County, Maryland

County and State

Section 7 Page 8

27. 306 North Main Street, c. 1920, **Contributing**, Story-and-a-half frame bungalow with rusticated block foundation and shed roofed dormer, shed roofed porch supported by tapered posts.
28. 308 North Main Street, c. 1880, **Contributing**, Two-story, three-bay, single-pile frame house with hip roofed front porch covered with seamed tin and supported on square columns, extended eaves on gable ends with returns.
29. 310 North Main Street, c. 1900-10, **Contributing**, Two-and-a-half story, three-bay side hall plan frame house with truncated pyramidal roof missing a rooftop balustrade, two-story gable roofed side wing to south, turned post front porch with sawn corner brackets.
30. 311 North Main Street, c. 1820-40, **Contributing**, Story-and-a-half, three-bay, side hall/parlor plan frame house covered with beaded edge weatherboards, boxed cornice and gable end brick chimney stacks with corbelled bases, pair of dormers mark front elevation, shorter single-story wing to south also covered with beaded edge weatherboards, early to mid twentieth-century wing to north. This house is one of the earliest structures surviving in the Federalsburg Historic District.
31. 312 North Main Street, c. 1910-20, **Contributing**, Two-story, three-bay, frame house with hip roofed front porch, square columns, six-over-one sash windows, shed roofed dormer, single-story bay window on street façade.
32. 314-18 North Main Street, c. 1900-10, **Contributing**, Two-story, asymmetrical frame house with two-story panel-faced concrete block south gable end wing, two-story turned post porch with sawn corner brackets, diamond shaped window in gable end of north projecting pavilion, subdivided into apartments.
33. 319 North Main Street, c. 1880, **Contributing**, Two-story, three-bay frame house covered with vinyl siding, partially glazed front door, paired windows to either side of front door light first floor, turned post porch.
34. 320 North Main Street, c. 1880, **Contributing**, Two-story, two-bay, gable-front frame house covered with artificial siding and shingles in front gable, hip roofed front porch.
35. 321 North Main Street, c. 1880, **Contributing**, Two-story, asymmetrical plan Victorian house with projecting side pavilion capped by a gable front roof trimmed with sawnwork

United States Department of the Interior
National Park Service

National Register of Historic Places Continuation Sheet

CAR-338
Federalsburg West Historic District

Name of Property

Caroline County, Maryland

County and State

Section 7 Page 9

soffit decoration, turned post porch, two-over-two sash windows, early 20th century gable roofed garage featuring cobble and panel-faced style concrete blocks.

36. 323 North Main Street, c. 1870-80, **Contributing**, Two-and-a-half story, five-bay, cross-gabled frame house with original center entrance featuring heavily molded four-panel door and flanking transom and sidelights, molded window lintels, chamfered posts support porch roof with boldly sawn scroll brackets, louvered shutters on period hardware, extended eaves on gable ends, interior end brick chimney stacks, 1 ½-story rear wing with early 19th century flush panel door under shed roofed hood on sawn brackets, shed dormer on kitchen roof; a single-story gable roofed garage has cobble style concrete blocks.
37. 324 North Main Street, c. 1900, **Contributing**, Two-story, tee-shaped frame house with projecting leg of T facing to street, turned post porch wraps two sides of projecting T, embellished with sawn corner posts and a saw-tooth edge soffit decoration between corner brackets.
38. 325 North Main Street, c. 1930-40, **Contributing**, Single-story, three-bay gable roofed frame office building.
39. 326 North Main Street, c. 1900-10, **Contributing**, Two-story, L-shaped frame house with square columned front porch with rounded corner, spindle decoration under porch soffit embellished with sawn corner brackets.
40. 328 North Main Street, c. 1880-1900, **Contributing**, Two-story, two-bay, frame house with Tuscan columned porch, partially enclosed; single story bay window on side elevation.
41. 332 North Main Street, c. 1900-20, **Contributing**, Nuttle Store Building, Large single-story gable roofed store building, steeply pitched gable roof with extended eave, shed addition on north side.

South Main Street

42. 102 South Main Street, c. 1910, **Contributing**, Built as the Federalsburg Bank of the Eastern Shore, later the First National Bank, Large two-story, neoclassical tan-colored brick bank with three-bay by three-bay blockish proportions, four brick pilasters define elevations on South Main and Central Avenue facades and rise to neoclassical entablature and cornice that defines the top of the flat roofed structure, parapet wall extended above the bolded neoclassical cornice enriched with a dentiled bed molding, stone pilaster capitals and stone

United States Department of the Interior
National Park Service

National Register of Historic Places Continuation Sheet

CAR-338
Federalsburg West Historic District

Name of Property

Caroline County, Maryland

County and State

Section 7 Page 10

watertable cap, center entrance on South Main Street has narrow stone pilasters under metal awning. Central Avenue side has side entrance framed by neoclassical pilasters and entablature, south and east elevations executed in plainer finishes.

43. 103 South Main Street, c. 1880, **Contributing**, Two-story, three-bay frame house with two apartment door entrances under pent eave.
44. 105 South Main Street, c. 1900, **Contributing**, C. L. Pratt House, Finely detailed story-and-a-half Shingle style, gambrel-roofed frame house on raised brick foundation with mixture of weatherboard and shingled exterior, engaged front porch with tripartite or paired half columns supported by paneled plinths, large gable roofed dormer with enclosed pediment sheathed with fishscale shingles and multi-pane window, tripartite six-over-one sash windows flanked by smaller nine-light windows. North elevation is an asymmetrical elevation with a pent eave dividing first and second stories, paired and tripartite windows on the first floor, oriole window on second, pair of arched window units light attic.
45. 107 South Main Street, c. 1900-10, **Contributing**, Single-story brick and block commercial building with later frame second floor addition.
46. 112 South Main Street, c. 1920-40, **Contributing**, Single-story stuccoed masonry commercial block with stepped parapet false front, metal sheathed gable roof, later multi-pane display windows.
47. 113-15 South Main Street, c. 1900-10, **Contributing**, Two-story, two-part brick commercial block with recessed storefront entrances, stretcher bond brick with plain pilasters, corbelled brick cornice, formed concrete window sills and lintels.
48. 116 South Main Street, c. 1910-20, **Contributing**, Two-story, four-bay frame commercial block with stepped parapet roof disguising gable roof, reworked modern front finishes.
49. 117-19 South Main Street, 1903, W. R. Breeding Building, **Contributing**, Two-story, rusticated concrete block commercial block with datestone in second floor street elevation, two commercial storefronts on first floor with late alterations, concrete window lintels and sills, hip roof is accented on street elevation with a hip roofed dormer.
50. 118 South Main Street, c. 1900-10, **Contributing**, Two-story, four-bay by six-bay concrete block commercial block with rusticated blocks on first story and panel-faced blocks with on second story, two-story, turned post front porch accents gable-front structure, porch is

United States Department of the Interior
National Park Service

National Register of Historic Places Continuation Sheet

CAR-338
Federalsburg West Historic District

Name of Property

Caroline County, Maryland

County and State

Section 7 Page 11

supported on first story by round metal posts on small concrete bases, turned posts with corner brackets on second floor, two-over-two sash windows, two second floor doors provide access to upper porch, first floor elevation retains intact Victorian storefronts with large plate glass windows.

51. 201 South Main Street, 1871-72, Christ Methodist Church, (Built as Federalsburg Presbyterian Church and later acquired by Methodist Protestants) **Contributing**, Dominant single-story, Greek Revival inspired frame church on raised brick foundation with corner bell tower on northeast corner capped by a pyramidal roofed belfry, which replaced a very tall broach spire; highly unusual center double door entrance framed by bold neoclassical pilaster and entablature, distinctive round arched transom design in repeating segmental arcs fitted with colored glass, hooded round arched windows to each side, semi-octagonal southeast corner column formerly terminated with short spire, early 20th century (1910) Sunday School frame addition to rear has corner stone inscribed, M.P.S.S. (Methodist Protestant Sunday School).
52. 203-05 South Main Street, c. 1880, **Contributing**, Two-story, ell-shaped Victorian house with reworked first floor front as a commercial space, sidelighted entrance and bracketed eave.
53. 204 South Main Street, c. 1990, **Non-Contributing**, Subway Sandwich Shop, Single-story brick commercial block.
54. 206-08 South Main Street, c. 1880, **Contributing**, Two-story, two-bay gable-front frame house with extended eaves.
55. 207 South Main Street, c. 1870-80, **Contributing**, Two-story, three-bay single-pile frame house, center entrance, two-panel front door, two-over-two sash windows, three-over-two sash sidelights, One-and-a-half story rear wing
56. 210 South Main Street, c. 1890, **Contributing**, Two-story, asymmetrical plan Victorian frame house, pointed arch window in gable of attic, shed roofed porch supported by turned posts.
57. 216-18 South Main Street, c. 1920, **Contributing**, Two-story, concrete block apartment building, panel-faced finish to concrete blocks.

United States Department of the Interior
National Park Service

National Register of Historic Places Continuation Sheet

CAR-338
Federalsburg West Historic District
Name of Property

Caroline County, Maryland
County and State

Section 7 Page 12

58. 219 South Main Street, c. 1890, **Contributing**, J.B. Sullivan House, Two-and-a-half story, five-bay frame Victorian house with elaborate turned post front porch, spindle brackets, star shapes in circular sawnwork flank center bay entrance, cross gable on porch, one-over-one sash windows, extended eaves with returns.
59. 300 South Main Street, c. 1950-60, **Non-Contributing**, Single-story brick and concrete block service station.
60. 301 South Main Street, c. 1910-20, **Contributing**, Two-story, ell-shaped frame house with early 20th century Craftsman style porch, tapered columns on brick plinths.
61. 302-04 South Main Street, c. 1920, **Contributing**, Story-and-a-half, four-bay frame bungalow duplex, cast concrete fluted columns, pair of shed roofed dormers, bay windows on each side elevation.
62. 303 South Main Street, c. 1920-40, **Contributing**, Single-story, gable-front stuccoed and plain concrete block commercial building, recessed entrance, bracketed eave, multi-pane bay window.
63. 306 South Main Street, c. 1890-1900, **Contributing**, Two-and-a-half story, asymmetrical plan Victorian house with turned post porch, projecting three-sided pavilion with decorative trim enhancing pavilion soffit, seamed tin roof, eyebrow window and hip roofed dormer mark steeply pitched hip roof.
64. 307 South Main Street, c. 1910-20, **Contributing**, Two-and-a-half story, four-square, stuccoed frame house on rusticated block foundation, partially enclosed hip roofed front porch, square columns, hip roofed dormer marks steeply pitched hip roof.
65. 309 South Main Street, c. 1880-1890, **Contributing**, One-story, ell-shaped Victorian cottage style house with steeply pitched gable roofs and extended eaves trimmed with decorative sawnwork, first floor bay window defines projecting gable, eight-over-eight second floor window with pointed arch molded lintel, hip roofed porch supported on square columns.
66. 311 South Main Street, c. 1880-1900, **Contributing**, Two-story, asymmetrical frame house with brick veneer on street elevation, mixture of Victorian and mid 20th century Colonial Revival details, house converted to funeral home.

United States Department of the Interior
National Park Service

National Register of Historic Places Continuation Sheet

CAR-338
Federalsburg West Historic District
Name of Property

Caroline County, Maryland
County and State

Section 7 Page 13

67. 313 South Main Street, c. 1880-90, **Contributing**, Two-story, three-bay, side hall plan frame house with two-story Victorian pavilion on north side elevation, shed roofed porch with triple square columns, two-light transom, two-over-two sash windows, brick pier foundation.
68. 315 South Main Street, c. 1880-90, **Contributing**, Two-story, two-bay, gable-front frame house with heavily molded four-panel front door, two-pane transom, corner pilasters, extended eaves, two-over-two sash window in gable end.
69. 316 South Main Street, c. 1880, **Contributing**, Two-story, ell-shaped frame Victorian house with two-over-two sash windows and plain details.
70. 317 South Main Street, c. 1890, **Contributing**, Two-story, Queen Anne style frame house covered by a steeply pitched hip roof and extended by projecting gabled pavilions on side walls.
71. 319 South Main Street, c. 1920, **Contributing**, Story-and-a-half bungalow with engaged porch under gable roof, shed dormer, brick foundation, brick chimney rises on south gable end.
72. 321-23 South Main Street, c. 1850-70, **Contributing**, Federalsburg Hotel, Two-story, five-bay frame structure formerly used as a hotel, covered with a gable roof and flush gable ends, hip roofed front porch, interior end brick chimney stacks.
73. 324 South Main Street, c. 1820-1860, **Contributing**, Sandy Hill, Three-story, five-bay frame house with center hall, single-pile plan extended to rear by two-part stepped profile service wing, sheathed with beaded weatherboards, heavily molded four-panel front door framed by transom and sidelights, six-over-six sash windows, single-bay columned covered stoop, six-over-six second floor sash, and three-over-three third floor windows. Exposed brick firewall on south gable end of main block.
74. South Main Street and Railroad Avenue vicinity, 1910, **Contributing structure**, Cambridge and Seaford Railroad Bridge, Linear riveted metal girder bridge erected by Pennsylvania Steel Company of Steelton, Pa., poured concrete abutments and piers. (CAR-367)

East and West Central Avenue

75. Central Avenue Bridge over the Marshyhope Creek, CAR-367, 1910, **Contributing structure**, Luten Bridge Co., York, Pa., Poured concrete multi-arch span bridge with filled

United States Department of the Interior
National Park Service

National Register of Historic Places Continuation Sheet

CAR-338
Federalsburg West Historic District
Name of Property

Caroline County, Maryland
County and State

Section 7 Page 14

spandrels, 215' in length, poured concrete posts and rails, posts have chamfered corners, fluted iron bridge post lights made by the Union Metal Manufacturing Co., Canton, Ohio.

76. 104 East Central Avenue, c. 1910 with late 20th century alterations, **Contributing**, Two-story rectangular frame commercial block with steeply pitched hip roof, altered street elevation with stuccoed two-story porch addition.
77. 105 East Central Avenue, c. 1990-2000, **Non-Contributing**, Two-story modern commercial block.
78. 108 East Central Avenue, c. 1930-40, Heavily reworked exterior, **Non-Contributing**, Single story frame commercial block houses the Liberty Diner.
79. 117 East Central Avenue, c. 1930-40, **Contributing**, Story-and-a-half frame and brick veneered commercial block, built as gas station with steeply pitched gable roof and steeply pitched gable roofed dormers, concrete block foundation, single-story rear wing.
80. 100 West Central Avenue, mid to late 20th century, **Non-Contributing**, Single-story convenience store with two-story stuccoed addition with mock mansard roof.
81. 101-03 West Central Avenue, c. 1910-20, **Contributing**, Two-story, two-bay, hip roofed plain concrete block office building, side entrance to second floor, recessed entrance to first floor office, door topped by two-light transom.
82. 105-07 West Central Avenue, c. 1950-60, **Contributing**, Two-and-a-half story, three-bay, stretcher bond brick Colonial Revival office building with two entrances on first floor, segmental arched Colonial Revival decoration over each door, three gable roofed dormers define gable roof.
83. 106 West Central Avenue, c. 1900, **Contributing**, Two-story, Queen Anne Victorian style frame house sheathed with plain weatherboards, Tuscan columned front porch, stuccoed foundation, sawn eave trim decorate pavilion soffit.
84. 108 West Central Avenue, c. 1900-10, **Contributing**, Two-story, Queen Anne style frame house with asymmetrical elevations, Tuscan columned front porch, projecting pavilion, early 20th century frame garage.

United States Department of the Interior
National Park Service

National Register of Historic Places Continuation Sheet

CAR-338
Federalsburg West Historic District

Name of Property

Caroline County, Maryland

County and State

Section 7 Page 15

85. 109 West Central Avenue, c. 1910, **Contributing**, Two-story, Queen Anne style frame house with concrete block foundation, hip roof with projecting gables and dormers, Tuscan columned front porch.
86. 110 West Central Avenue, c. 1910-20, **Contributing**, Dr. Fred Wright House, Story-and-a-half, stuccoed frame bungalow with distinctive roof forms incorporating balustraded deck in porch roof fronting a gabled dormer. Bay window marks left side of first floor front wall.
87. 111 West Central Avenue, c. 1900-10, **Contributing**, Story-and-a-half stucco block dwelling with three-bay street elevation, steeply pitched pyramidal roof, large hip roofed dormers with diamond shaped panes in upper sash, hip roofed dormer on east side covers bay window.
88. 112 West Central Avenue, c. 1900, **Contributing**, Two-story, ell-shaped, Victorian frame house with asbestos shingle exterior and projecting gable-front pavilion, decorative sawnwork with pendant drops enhance pediment soffit.
89. 113 West Central Avenue, c. 1900-10, **Contributing**, J. J. Frampton House, Two-and-a-half story, Queen Anne influenced frame house on raised rusticated block foundation, half-length Tuscan columns, porte-cochere on west side, hip roofed dormers. interior brick chimney stacks with corbelled cap.
90. 115 West Central Avenue, c. 1900, **Contributing**, Two-and-a-half story, five-bay, center hall plan frame house on rusticated block foundation, Tuscan columned porch with two-story, gable end pavilion attached to east gable end, patterned metal shingle roof, gable roofed dormers with enclosed pediment front and diamond pane window sash, interior brick stove chimneys flank center hall, two-story service wing with Victorian turned post porch.
91. 116 West Central Avenue, c. 1900, **Contributing**, Two-story, ell-shaped Victorian house with partially glazed front door, three-sided bay pavilion with decorated soffit.
92. 117 West Central Avenue, c. 1970-80, **Contributing**, Two-story, Colonial Revival inspired Flemish bond brick house symmetrical five-bay front, central entrance, eight-over-sixteen sash windows on first floor, eight-over-eighth sash windows on second.
93. 119 West Central Avenue, c. 1910-20, **Contributing**, Two-and-a-half story, four-square stuccoed masonry house with wraparound porch, projecting windows on first and second stories, hip roofed dormers.

United States Department of the Interior
National Park Service

National Register of Historic Places Continuation Sheet

CAR-338
Federalsburg West Historic District

Name of Property

Caroline County, Maryland

County and State

Section 7 Page 16

94. 120 West Central Avenue, c. 1900-20, **Contributing**, Two-and-a-half story, two-bay frame house with hip roof and centered gable, tapered column front porch, partially glazed front door, projecting two-story pavilion on east side.
95. 122 West Central Avenue, c. 1910-20, **Contributing**, Two-and-a-half story, Queen Anne influenced frame house with steeply pitched hip roof and projecting pavilions on front and side elevations, aluminum siding and metal replacement porch posts.
96. 124 West Central Avenue, c. 1910-20, **Contributing**, Story-and-a-half frame bungalow with engaged porch, large gable roofed dormer and stick Craftsman style brackets.
97. 126 West Central Avenue, c. 1910-20, **Contributing**, Two-story, three-bay, hip roofed frame house with later colossal columned front porch, Colonial Revival scrolled pediment entrance.
98. 128 West Central Avenue, c. 1920-40, **Contributing**, One-story, asymmetrical frame and brick cottage style house with repeating gable-front street elevation, entrance in smaller projecting gable.
99. 201 West Central Avenue, c. 1920-40, **Contributing**, Story-and-a-half, Dutch Colonial style frame house with columned front porch enhanced with rooftop balustrade, Colonial Revival style front entrance.
100. 203 Central Avenue, c. 1920-40, **Contributing**, Dr. W. K. Knotts House, Two-and-a-half story, three-bay Colonial Revival style frame house with hip roofed front porch supported on square columns, gable-roof dormers with enclosed pediments, paired window, center brick chimney stack, extended eaves with returns.
101. 204 Central Avenue, c. 1910-20, **Contributing**, Story-and-a-half, frame bungalow, rusticated block foundation, large tapered columns on rusticated block plinths, gable roofed dormer with Craftsman style stick brackets.
102. 205 Central Avenue, c. 1870, **Contributing**, Edward R. Goslin House, Two-and-a-half story, three-bay, Second Empire style frame house, probably turned on the site when Central Avenue was created through the former property of town merchant E. R. Goslin (See 1877 Federalsburg Town Map, Section 10).

United States Department of the Interior
National Park Service

National Register of Historic Places Continuation Sheet

CAR-338
Federalsburg West Historic District

Name of Property

Caroline County, Maryland

County and State

Section 7 Page 17

103. 206 West Central Avenue, c. 1923, **Contributing**, Clinton S. Poole House, Two-and-a-half story, four-square frame house, paired and tripartite window units, hip roofed dormer defines hip roof.
104. 207 West Central Avenue, c. 1920, **Contributing**, Two-story, frame house with projecting gables, concrete block foundation.
105. 208 West Central Avenue, c. 1910-20, **Contributing**, Two-and-a-half story, four-square frame house with Tuscan columned porch on two sides, large gable roofed dormers on hip roof.
106. 209 West Central Avenue, c. 1910-20, **Contributing**, One-and-a-half story, frame bungalow with broad street front, gable roofed dormer with Craftsman style brackets, paired and tripartite half columns on stuccoed plinths, sidelighted front entrance.
107. 211 West Central Avenue, c. 1910-20, **Contributing**, One-and-a-half story, frame bungalow with arched openings between tapered columns, gable roofed dormer, sidelighted front entrance.
108. 213 West Central Avenue, c. 1910-20, **Contributing**, One-and-a-half story bungalow with hip roof, stuccoed posts support hip roofed porch, vented dormer, center entrance with flanking tripartite window units, partial exterior brick chimney on side elevation.
109. 215 West Central Avenue, c. 1910-20, **Contributing**, Charles Handy House, Two-and-a-half story, two-bay four-square style frame house with brick first floor finish, frame second floor, roof has kicked eaves, kicked eave dormers, Single-story garage contemporaneous with house.
110. 301 West Central Avenue, c. 1910-20, **Contributing**, Two-and-a-half story, stuccoed block house with steeply pitched hip roof, brick accents highlight window lintels and sills, watertable level, sidelighted front entrance, hip roofed dormer.
111. 302 West Central Avenue, c. 1920, **Contributing**, Arthur Johnson House, Story-and-a-half Dutch Colonial gambrel roofed frame house, gable roofed single-bay portico with arched ceiling, paired and tripartite six-over-one sash window units.
112. 304 West Central Avenue, c. 1920, **Contributing**, Two-story, three-bay Colonial Revival frame house with six-over-six sash windows, gable roofed single-bay portico.

United States Department of the Interior
National Park Service

National Register of Historic Places Continuation Sheet

CAR-338
Federalsburg West Historic District

Name of Property

Caroline County, Maryland

County and State

Section 7 Page 18

113. 305 West Central Avenue, c. 1920, **Contributing**, Two-story, three-bay, Colonial Revival frame house, brick foundation, gable roofed hood covers center entrance, hood supported on concave shaped brackets, extended eaves with returns, center brick chimney stack.
114. 306 West Central Avenue, c. 1910-20, **Contributing**, Two-story, ell-shaped concrete block and frame house, panel-faced concrete blocks on first story and asbestos shingled frame structure on second, gable end pediment projecting forward, single-pane sash windows.
115. 307 West Central Avenue, c. 1920-30, **Contributing**, Single-story, cottage style frame house with asymmetrical elevations, large cross gable adjacent to main entrance under gable roofed portico that is integrated with turned post porch that wraps around to the east side, exterior brick chimney stack.
116. 308 West Central Avenue, c. 1920-30, **Contributing**, Single-story cottage style frame house beaded vinyl weatherboards, octagonal window in facing gable, dormer on right side of roof.
117. 309 West Central Avenue, c. 1920-30, **Contributing**, Single-story frame bungalow with plain concrete block plinths and tapered half columns, center entrance with paired windows, exterior brick chimney stack, gable roofed dormer.
118. 310 West Central Avenue, c. 1920, **Contributing**, Story-and-a-half Cape Cod style frame house with Colonial Revival entrance surround, dormers roof, interior chimney, enclosed shed porch on side.
119. 311 West Central Avenue, c. 1940, **Contributing**, Single-story, mid 20th century stretcher bond brick house with asymmetrical street elevation of repeating gable fronts, half round lunette in front gable, paired and single six-over-six sash windows, single-bay brick garage in backyard.
120. 312 West Central Avenue, c. 1920-30, **Contributing**, Single-story, gable-front frame bungalow, projecting entrance gable with stick corner brackets, six-over-six sash windows, brick foundation.

United States Department of the Interior
National Park Service

National Register of Historic Places Continuation Sheet

CAR-338
Federalsburg West Historic District

Name of Property

Caroline County, Maryland

County and State

Section 7 Page 19

121. 313 West Central Avenue, c. 1920-30, **Contributing**, Single-story, asymmetrical plan frame cottage style house with off-set front projecting gable, brick chimney to right side of front door, engaged porch with entrance, square posts.
122. 315 West Central Avenue, c. 1930-40, **Contributing**, Single-story, concrete block and brick cottage style house with brick veneer on portion of street façade, brick chimney in corner, paired windows in gable, combination of metal windows and wood sash windows.
123. 316 West Central Avenue, c. 1920-40, **Contributing**, Single-story frame cottage with asymmetrical front, shed roofed front porch supported on square columns, gable front elevation defined by tripartite window, exterior brick chimney on east side has distinctive corbelled brickwork and paved shoulder.
124. 317 West Central Avenue, c. 1910-20, **Contributing**, Two-and-a-half story, four-square frame house with brick foundation and tapered columned front porch, hip roofed dormer, three-over-one sash windows, sidelighted front entrance.
125. 318 West Central Avenue, c. 1940-50, **Contributing**, Single-story, gable roofed brick cottage style house with rustic brick exterior, occasion use of rusticated klinker bricks to simulate aged appearance, dormered roof, picture window to right side of entrance under porch.
126. 319 West Central Avenue, c. 1920-30, **Contributing**, Two-and-a-half story, four-square frame house with steeply pitched hip roof and hip roofed dormer, tripartite window and sidelighted front entrance under porch.
127. 320 West Central Avenue, c. 1920-30, **Contributing**, Single-story frame Cape Cod style cottage with gable roofed portico, concrete block foundation.
128. 321 West Central Avenue, c. 1950, **Contributing**, Single-story mid 20th century brick ranch style house with stretcher bond wall pattern, center gable.
129. 322 West Central Avenue, c. 1940-50 **Contributing**, Single-story, stretcher bond brick house with low pitched jerkinhead shaped roof, eight-over-eight front windows, single-bay hip roofed porch supported on metal posts.

Morris Avenue

United States Department of the Interior
National Park Service

National Register of Historic Places Continuation Sheet

CAR-338
Federalsburg West Historic District

Name of Property

Caroline County, Maryland

County and State

Section 7 Page 20

130. 104 Morris Avenue, c. 1960-70, **Non-Contributing**, Single-story, mid twentieth century brick and concrete block office building used as Police Department and office for Public Works, large glass display windows, stainless steel frames.
131. 106 Morris Avenue, c. 1980, **Non-Contributing**, Single-story, late twentieth century office building of concrete block side wall and brick façade with hip roofed porch stretching across main elevation.
132. 110-16 Morris Avenue, c. 1920, **Contributing**, Long and Short Building, plain concrete blocks with chamfered corners, dates "1905" and "1916" and names Long & Short in raised letters and numbers on west end, reworked front with a series of offices.
133. 118 Morris Avenue, c. 1960, **Non-Contributing**, Single-story brick and concrete block commercial building with false Mansard style roof with center gable, multi-pane window units.
134. 120 Morris Avenue, c. 1950, **Contributing**, Single-story, brick and concrete block post office with double door entrance, soldier course arches over windows and door, corner brickwork defined in quoins, concrete block pilaster type buttresses on side elevations.
135. 206 Morris Avenue, c. 1920, **Contributing**, Single-story, three-bay, gable roofed cottage with gable-front porch, flush gable ends.
136. 208 Morris Avenue, c. 1920, **Contributing**, Single-story, hip roofed frame bungalow with engaged Tuscan columned porch, gable roofed dormer, gable roofed bay window on east side, plain concrete block foundation.
137. 210 Morris Avenue, c. 1920-30, **Contributing**, Single-story frame cottage style frame house with beaded vinyl siding, enclosed porch with gable front extension of gable front house, rusticated block foundation.
138. 211 Morris Avenue, c. 1910-20, **Contributing**, Two-story, frame duplex with two-story porch, enclosed.
139. 212 Morris Avenue, c. 1920-40, **Contributing**, Single-story, gable-front cottage with gable front entrance porch enclosed, plain concrete block foundation.
140. 213 Morris Avenue, c. 1960, **Contributing**, Single-story, hip roofed frame mid twentieth century frame house on plain concrete block foundation.

United States Department of the Interior
National Park Service

National Register of Historic Places Continuation Sheet

CAR-338
Federalsburg West Historic District

Name of Property

Caroline County, Maryland

County and State

Section 7 Page 21

141. 214 Morris Avenue, c. 1920-40, **Contributing**, Story-and-a-half frame bungalow with vinyl siding, gable roofed dormer, exterior brick chimney on west side.
142. 216 Morris Avenue, c. 1930-40, **Contributing**, Single-story asymmetrical cottage style house with projecting front gable, corner entrance with small covered porch.
143. 217 Morris Avenue, c. 1920-30, **Contributing**, Single-story, hip roofed frame house with center gable, enclosed porch, plain concrete block foundation.
144. 219 Morris Avenue, c. 1910-20, **Contributing**, Two-story, two-bay gable front Victorian frame house, single-story bay window on west side.
145. 221 Morris Avenue, c. 1910-20, **Contributing**, Two-story, two-bay, gable-front frame house, extended eaves, remodeled exterior.
146. 223 Morris Avenue, c. 1950, **Contributing**, Single-story, mid 20th century frame Ranch style house, low pitched gable roof.
147. 301 Morris Avenue, c. 1920-30, **Contributing**, Single-story, gable-front frame bungalow with plain concrete block foundation, partially enclosed front porch, tapered posts on concrete block plinths, six-over-one sash windows, bay window on side elevation.
148. 303 Morris Avenue, c. 1930-40, **Contributing**, Single-story, cottage style frame house.
149. 305 Morris Avenue, c. 1920-30, **Contributing**, Single-story, three-bay Cape Cod style house with gable roofed stoop, plain concrete block foundation, Colonial Revival entrance surround with fluted pilasters.
150. 306 Morris Avenue, c. 1910-20, **Contributing**, Two-story, two-bay, remodeled frame house with boxed cornice, flush gable ends.
151. 307 Morris Avenue, c. 1920-30, **Contributing**, Single-story, asymmetrical plan cottage house with projecting front gable, Colonial Revival entrance surround.
152. 308 Morris Avenue, c. 1930-40, **Contributing**, Single-story, three-bay Cape Cod frame house with gable roofed entrance portico, arched interior ceiling, paired six-over-one sash windows.

United States Department of the Interior
National Park Service

National Register of Historic Places Continuation Sheet

CAR-338
Federalsburg West Historic District

Name of Property

Caroline County, Maryland

County and State

Section 7 Page 22

153. 309 Morris Avenue, c. 1930-40, **Contributing**, Story-and-a-half, three-bay, frame house with pair of gable roofed dormers, Colonial Revival front entrance surround, single-pane sash windows.
154. 310 Morris Avenue, c. 1930-40, **Contributing**, Two-story, two-bay, gable roofed frame house with enclosed shed porch, plain detailing.
155. 311 Morris Avenue, c. 1930-40, **Contributing**, Single-story asymmetrical cottage style frame house with projecting front gable, paired and single one-over-one sash windows.
156. 312 Morris Avenue, c. 1950-60, **Contributing**, Single-story, Ranch style frame house, concrete block foundation.
157. 313 Morris Avenue, c. 1930-40, **Contributing**, Single-story, three-bay gable-roofed frame Cape Cod style house with gable-front porch, concrete block foundation.
158. 314 Morris Avenue, c. 1940, **Contributing**, Single-story, three-bay Cape Cod style frame house, shingled exterior and block foundation.
159. 315 Morris Avenue, c. 1940, **Contributing**, Single-story, asymmetrical plan cottage style house with projecting gable wing off main gable roofed house.
160. 317 Morris Avenue, c. 1940-50, **Contributing**, Single-story, mid 20th century cottage style house with asymmetrical gable roofs, plain concrete block foundation with oval inset vents, paired window units.
161. 318 Morris Avenue, c. 1930-40, **Contributing**, Single-story gable-front frame bungalow with later false-stone veneered front, corner stick brackets, paired and tripartite window units.
162. 319 Morris Avenue, c. 1980, **Non-Contributing**, Single-story, five-bay frame Ranch style house, side-lighted front entrance.
163. 320 Morris Avenue, c. 1930-40, **Contributing**, Single-story frame bungalow with gable-front street elevation, gable-front porch, flush gable ends.

Greenridge Road

164. 104 Greenridge Road, c. 1920-30, **Contributing**, Single-story asymmetrical plan frame bungalow.

United States Department of the Interior
National Park Service

National Register of Historic Places Continuation Sheet

CAR-338
Federalsburg West Historic District

Name of Property

Caroline County, Maryland

County and State

Section 7 Page 23

165. 105 Greenridge Road, c. 1920, **Contributing**, Single-story, gable-front frame bungalow enclosed porch.
166. 106 Greenridge Road, c. 1920, **Contributing**, Single-story, gable-front frame bungalow with Tuscan columned hip roofed front porch, extended eaves, two-over-two sash in gable end.
167. 107 Greenridge Road, c. 1910, **Contributing**, Two-story, two-bay, gable-front frame house with concrete block foundation.
168. 108 Greenridge Road, c. 1920, **Contributing**, Single-story, gable-front frame bungalow with gable front, one-bay wide covered porch, tapered posts on concrete block plinths.
169. 109 Greenridge Road, c. 1910, **Contributing**, Single-story, gable-front frame house with turned post gable front porch, exposed rafter tails, identical to 111 Greenridge Road only in reverse.
170. 110 Greenridge Road, c. 1910, **Contributing**, Two-story, three-bay, frame house with Tuscan columned front porch, six-over-six sash windows, extended eaves with returns.
171. 111 Greenridge Road, c. 1910, **Contributing**, Single-story, gable-front frame house with turned post front porch, mirror image to 109 Greenridge Road.
172. 117 Greenridge Road, c. 1920, **Contributing**, Two-and-a-half story, four-square frame house with two-bay elevation, hip roofed front porch partially enclosed, hip roofed dormer.
173. 119 Greenridge Road, c. 1920, **Contributing**, Single-story, Cape Cod frame house with gable roofed stoop, raised concrete block foundation, single-story gable roofed bay on side elevation.
174. 201 Greenridge Road, c. 1920, **Contributing**, Two-story, two-bay, Craftsman style frame house with side entrance, tripartite first floor window unit, paired and tripartite half posts on wooden paneled plinths, gable roof to porch, stick Craftsmen style brackets enhance porch eave and extended eave of house.
175. 202 Greenridge Road, c. 1920, **Contributing**, Two-and-a-half story, three-bay side entrance frame house with turned post porch, two-over-two sash windows, gable roofed dormer.
176. 203 Greenridge Road, c. 1930, **Contributing**, Single-story, gable-roofed Cape Cod style cottage with plain detailing.

United States Department of the Interior
National Park Service

National Register of Historic Places Continuation Sheet

CAR-338
Federalsburg West Historic District

Name of Property

Caroline County, Maryland

County and State

Section 7 Page 24

177. 204 Greenridge Road, c. 1920, **Contributing**, Two-story, gable-front frame house, side entrance, hip roofed porch, extended eaves.
178. 205 Greenridge Road, c. 1910, **Contributing**, Two-and-a-half story, three-bay, center hall, cross-gabled frame house turned post porch.
179. 206 Greenridge Road, c. 1930, **Contributing**, One-and-a-half story, dormered Cape Cod frame house, rusticated concrete block foundation, enclosed gable roofed entry with single-bay covered stoop, six-over-six sash windows, diamond cut-outs in board and batten shutters, gable roofed dormers.
180. 207 Greenridge Road, c. 1910-20, **Contributing**, Two-story, two-bay, hip roofed frame house with turned post porch.
181. 208 Greenridge Road, c. 1910, **Contributing**, Two-and-a-half story, asymmetrical frame Victorian house, rusticated block foundation, turned post porch with sawn brackets and sawn soffit decoration, main hip roof with center gable, projecting pavilion.
182. 209 Greenridge Road, c. 1910-20, **Contributing**, Two-and-a-half story, hip roofed frame house with gable roof on hip, off-center side pavilion with decorated eave, rusticated concrete block foundation.
183. 211 Greenridge Road, c. 1910-20, **Contributing**, Two-story, ell-shaped frame house converted into apartments, projecting front gable, brick foundation, extended eaves, remodeled exterior.
184. 212 Greenridge Road, c. 1910-20, **Contributing**, Two-story, two-bay, frame house, gable roof, turned post porch with sawn brackets and two-over-two sash windows.
185. 215 Greenridge Road, c. 1920, **Contributing**, One-story, three-bay frame cottage with plain exterior details.
186. 216 Greenridge Road, c. 1910-20, **Contributing**, Two-story, two-bay, gable-front frame house, with turned post, hip roofed porch, two-story gabled pavilion on side elevation, extended eaves.
187. 217 Greenridge Road, c. 1920-40, **Contributing**, Story-and-a-half, three-bay, Cape Cod style frame house, pair of gable roofed dormers, exterior brick chimney on west end, single-bay gable roofed garage in backyard.

United States Department of the Interior
National Park Service

National Register of Historic Places Continuation Sheet

CAR-338
Federalsburg West Historic District
Name of Property

Caroline County, Maryland
County and State

Section 7 Page 25

188. 218 Greenridge Road, c. 1910-20, **Contributing**, Two-story, two-bay, gable-front frame house, with extended eaves, exposed rafter tails, enclosed porch with concrete block foundation.
189. 219 Greenridge Road, c. 1930-40, **Contributing**, Single-story, gable roofed cottage with gable roofed porch, square posts, extended eaves.
190. 220 Greenridge Road, c. 1950-60, **Contributing**, Single-story frame Ranch style house with hip roofed stoop, gable and hip roofs to different sections.
191. 301 Greenridge Road, c. 1920-30, **Contributing**, Single-story, gable-front frame bungalow with hip roofed front porch, block foundation.
192. 305 Greenridge Road, c. 1950-60, **Contributing**, Single-story, mid 20th century multi-sectioned Ranch style house with front bay window, low pitched gable roof, brick foundation, large interior brick chimney stack.
193. 306 Greenridge Road, c. 1960, **Contributing**, Single-story, multi-sectioned Ranch with shed porch.
194. 307 Greenridge Road, c. 1930-40, **Contributing**, Single-story Cape Cod style house with gable roofed section extending forward, shed roofed porch.
195. 309 Greenridge Road, c. 1960, **Contributing**, Single-story, Cape Cod, medium pitched gable roof.
196. 310 Greenridge Road, c. 1970, **Non-Contributing**, Single-story Ranch style house with false stone front.
197. 311 Greenridge Road, 1962, **Contributing**, Odd Fellows Temple, Federal Lodge #35.I.O.O.F., Single-story, gable-front brick veneered lodge building with granite datestone.
198. 314 Greenridge Road, c. 1950-60, **Contributing**, Single-story Ranch style frame house with one-bay attached garage under a gable roof, picture windows flank center entrance.
199. 316 Greenridge Road, c. 1940-50, **Contributing**, Single-story, gable roofed asymmetrical cottage style house with projecting front gable, paired and single eight-over-eight and one-over-one sash windows.

United States Department of the Interior
National Park Service

National Register of Historic Places Continuation Sheet

CAR-338
Federalsburg West Historic District

Name of Property

Caroline County, Maryland

County and State

Section 7 Page 26

200. 318 Greenridge Road, c. 1950, **Contributing**, Single-story, three-bay, gable roofed mid 20th century house with stretcher bond brick exterior enhanced with rusticated "klinker" bricks, paired and single window units, flush gable ends.
201. 322 Greenridge Road, c. 1970-80, **Non-Contributing**, Single-story frame Ranch style house, vinyl siding, multi-unit picture windows to each side of center entrance.
202. Greenridge Road and University Avenue, 1947, **Contributing**, Baseball Club House and Federal Field, Two-story, gable roofed concrete block and frame construction.

Vesper Lane

203. 204 Vesper Lane, c. 1930-40, **Contributing**, Single-story, gable-roofed frame bungalow, hip roofed front porch, turned posts, plain concrete block foundation.
204. 205 Vesper Lane, c. 1910-20, **Contributing**, Two-story, gable-front frame house, remodeled exterior, vinyl siding and shingles.
205. 206 Vesper Lane, c. 1920, **Contributing**, Two-story, two-bay pyramidal roofed frame house with center brick stove chimney, square columned front porch.
206. 207 Vesper Lane, c. 1980, **Non-Contributing**, Single-story, five-bay Ranch house.
207. 208 Vesper Lane, c. 1910-20, **Contributing**, Two-story, two-bay, hip roofed frame house with shed porch, square columns, side elevation pavilion.
208. 209 Vesper Lane, c. 1920-30, **Contributing**, Single-story gable roofed bungalow with textured stucco exterior, gable roofed front porch with square columns, paired windows to each side of center entrance.
209. 210 Vesper Lane, c. 1940-50, **Contributing**, Single-story, mid 20th century frame cottage with concrete block foundation, oval concrete vents, paired and single one-over-one sash window units.
210. 211 Vesper Lane, c. 1940-50, **Contributing**, Single-story, gable-front frame house with gable roofed porch, paired six-over-one sash windows, dormers on sides of house, block foundation.

United States Department of the Interior
National Park Service

National Register of Historic Places Continuation Sheet

CAR-338
Federalsburg West Historic District

Name of Property

Caroline County, Maryland

County and State

Section 7 Page 27

211. 212 Vesper Lane, c. 1900-10, **Contributing**, Two-and-a-half story, two-bay, frame house with turned post front porch, sawn brackets, two-over-two sash windows, center gable on hip roof, two-over-two sash window lights attic.
212. 213 Vesper Lane, c. 1940-50, **Contributing**, Single-story, three-bay mid 20th century cottage style house, paired and single one-over-one sash windows.
213. 214 Vesper Lane, c. 1900, **Contributing**, Two-story, two-bay, frame house with hip roofed front porch, replacement posts, center brick chimney stack, two-story bay window on gable end.
214. 215 Vesper Lane, c. 1950-60, **Contributing**, Single-story, Ranch style frame house, medium pitched gable roof, off-center entrance.
215. 216 Vesper Lane, c. 1950-60, **Contributing**, Single-story Ranch house with medium pitched gable roof, asymmetrical front with tripartite window unit to right of entrance, two single-pane sash windows to left, plain concrete block foundation.
216. 219 Vesper Lane, c. 1910-20, **Contributing**, Two-story, two-bay, frame house with gable roof, plain block foundation with chamfered corners, two-story rear service wing.

Bloomingtondale Avenue

217. 100 Bloomingtondale Avenue, c. 1910-20, Rebuilt and Remodeled, c. 1990, **Non-Contributing**, Story-and-a-half multi-unit frame commercial block with vinyl siding, gable roofed dormers.
218. 101 Bloomingtondale Avenue, 1925 and later, **Contributing**, First Church of God, Dated ell-shaped, brick veneered church with buttresses featuring concrete block caps, corner entrance incorporated into two-story pyramidal roofed tower, mid 20th century Modernist addition to south, Hillcrest Cemetery gates to north.
219. Hillcrest Cemetery (originally Mount Pleasant Cemetery, late 19th century to mid 20th century, **Contributing site**, Town cemetery situated on hilltop, framed by roads and rusticated concrete block retaining wall, center set of concrete steps to ridge. The cemetery contains a commemorative Civil War marker erected in 1913 honoring forty-seven Civil War soldiers interred here.
220. 105 Bloomingtondale Avenue, c. 1900-10, **Contributing**, Two-story, three-bay gable roofed frame house, concrete block foundation, two-over-two sash windows, molded window lintels.

United States Department of the Interior
National Park Service

National Register of Historic Places Continuation Sheet

CAR-338
Federalsburg West Historic District
Name of Property

Caroline County, Maryland
County and State

Section 7 Page 28

221. 107 Bloomingdale Avenue, c. 1900, **Contributing**, Two-story, three-bay, gable roofed frame house, remodeled.
222. 108 Bloomingdale Avenue, c. 1880-90, **Contributing**, Two-story, ell-shaped main block with forward projecting leg, hip roofed porch, extended eaves with returns.
223. 111 Bloomingdale Avenue, c. 1920-30, **Contributing**, C. W. Jefferson House, Single-story, three-bay bungalow with tapered columns on concrete block plinths, partially glazed front door.
224. 116-18 Bloomingdale Avenue, c. 1880-90, **Contributing**, Two-story, three-bay, gable roofed frame house with turned post porch, sawn eave brackets in porch.
225. 120 Bloomingdale Avenue, c. 1880-90, **Contributing**, Two-story, three-bay frame house with hip roofed porch, square columns, brick foundation, extended eaves.
226. 121 Bloomingdale Avenue, c. 1890, **Contributing**, Two-story, two-bay gable roofed frame house.
227. 124 Bloomingdale Avenue, c. 1890, **Contributing**, Two-and-a-half story, asymmetrical frame Victorian house with projecting front pavilion.
228. 123 Bloomingdale Avenue, c. 1870-80, **Contributing**, Two-story, three-bay, gable roofed frame house with turned post porch, sawn corner brackets in porch, vinyl siding, corner pilasters covered with vinyl.
229. 125 Bloomingdale Avenue, c. 1880-90, **Contributing**, Two-story, three-bay, gable roofed frame house, turned post porch with sawn brackets, side entrance.
230. 126 Bloomingdale Avenue, c. 1890, **Contributing**, Two-story, gable-front frame Victorian with double door side entrance, turned post front porch, pair of pointed arch windows in gable-front lighting attic, two-story side pavilion.
231. 127 Bloomingdale Avenue, c. 1880, **Contributing**, Two-story asymmetrical Victorian frame house in largely original condition with brick foundation, projecting front two-story pavilion with segmental arched two-over-two sash windows, louvered shutters, gable-over three-sided pavilion sheathed with fishscale shingles and pierced by a pair of one-over-one sash windows with a carved floral decorative panel in between the two attic windows, sawn soffit decoration to pavilion, shed roofed front porch with small gable highlighting entrance bay, carved decoration in face of porch

United States Department of the Interior
National Park Service

National Register of Historic Places Continuation Sheet

CAR-338
Federalsburg West Historic District

Name of Property

Caroline County, Maryland

County and State

Section 7 Page 29

gable, decorated bargeboards to eave of entrance bay, extended eaves to main house, internal end brick chimney.

232. 128 Bloomingdale Avenue, c. 1880, c. 1920, **Contributing**, Two-story, multi-sectioned, multi-style frame house with Colonial Revival two-story, five-bay center hall main block and earlier two-story, Victorian ell with two-story three-sided bay window, bracketed eave, Colonial Revival portico entrance, six-over-six sash windows.
233. 129 Bloomingdale Avenue, c. 1960, **Contributing**, Single-story brick Ranch style house, stretcher bond wall construction, projecting center gable.
234. 201 Bloomingdale Avenue, c. 1930-40, **Contributing**, Two-story, three-bay, Colonial Revival frame house, Colonial Revival entrance, six-over-six sash windows with louvered shutters, exterior end brick chimney stack.
235. 202 Bloomingdale Avenue, c. 1970-80, **Non-Contributing**, Single-story frame Ranch style house.
236. 203 Bloomingdale Avenue, c. 1980, **Non-Contributing**, Single-story frame Ranch style house.
237. 204 Bloomingdale Avenue, c. 1930-40, **Contributing**, Single-story, five-bay brick Cape Cod style house, stretcher bond brick wall construction with soldier course arches over the windows, gable roofed side addition.
238. 205 Bloomingdale Avenue, c. 1980, **Non-Contributing**, Single-story Ranch style house.
239. 206 Bloomingdale Avenue, c. 1920-40, **Contributing**, Story-and-a-half, three-bay Dutch Colonial brick and frame house with pent eave incorporating entrance bay hood over the front door, heavy brackets support the hood, pair of six-over-one sash windows, exterior chimney, side wing.
240. 207 Bloomingdale Avenue, c. 1940, **Contributing**, Single-story brick and frame cottage style house with stretcher bond, gable roofed entrance stoop, side wing with separate entrance, paired window units.
241. 208 Bloomingdale Avenue, c. 1930 and later, **Contributing**, Dallas Blades House, Single-story, brick and frame house with center two-bay section and flanking wings and rear wing, Separate two-car garage and pump house.

United States Department of the Interior
National Park Service

National Register of Historic Places Continuation Sheet

CAR-338
Federalsburg West Historic District
Name of Property

Caroline County, Maryland
County and State

Section 7 Page 30

242. 209 Bloomingdale Avenue, c. 1930, **Contributing**, Story-and-a-half, three-bay, Cape Cod style house, gable roofed dormers, story-and-a-half side wings, eight-over-eight sash windows, single-bay garage in backyard.
243. 210 Bloomingdale Avenue, c. 1930, **Contributing**, Story-and-a-half, three-bay frame house with center cross gable and flanking dormers with steeply pitched roofs, recessed entrance, exterior brick chimney, partially glazed front door.
244. 212 Bloomingdale Avenue, c. 1960, **Contributing**, Single-story brick Ranch house with attached carport attached to gable end, shed porch supported on square posts with projecting gable, paired and tripartite window units.
245. 214 Bloomingdale Avenue, c. 1960, **Contributing**, Single-story, frame Ranch style house with projecting front gable and bay window.

Covey Williams Lane

246. Federalsburg Historical Society, c. 1910-15, c. 1930, **Contributing**, Single-story, concrete block and frame garage building rehabilitated into the headquarters of the town's historical society. Plain concrete block walls with C.W. impressed on inside surface. C. W. stands for Charles Wright, the owner of the Wright Concrete Company, which sold blocks, urns, pedestals, porch columns, lime, cement, and mortar colors.

Park Lane

247. 105 Park Lane, c. 1930-40, **Contributing**, Single-story, five-bay, Cape Cod frame house with gable roofed stoop.
248. 106 Park Lane, c. 1930, **Contributing**, Story-and-a-half brick bungalow with tapered brick piers on brick plinths, jack arches accented with limestone keystones, scroll shaped brickwork accents front steps, porch engaged under gable roof with large shed roofed dormer, three-over-one sash windows, side entrance with flanking tripartite window.
249. 108 Park Lane, c. 1930, **Contributing**, Single-story, three-bay, frame cottage with asymmetrical front, gable roof, off center brick chimney stack.
250. 109 Park Lane, c. 1930, **Contributing**, Story-and-a-half, three-bay, stretcher bond brick house with Colonial Revival details, bay window to gable end, gable roofed entrance, frame side wing.

United States Department of the Interior
National Park Service

National Register of Historic Places Continuation Sheet

CAR-338
Federalsburg West Historic District

Name of Property

Caroline County, Maryland

County and State

Section 7 Page 31

251. 110 Park Lane, c. 1930, **Contributing**, Story-and-a-half Cape Cod style house with gable roofed entrance, gable roofed dormers, single-story commercial wing to side built in brick with flat roof.
252. 123 Park Lane, c. 1940, **Contributing**, Caroline County Public Library, (Built as the Women's Club of Federalsburg) Single-story stuccoed masonry building built into slope with exposed basement on rear elevation.
253. 202 Park Lane, c. 1930, **Contributing**, Two-story, three-bay frame house with Colonial Revival details, enclosed side wing, extended eaves with returns.
254. 206-08 Park Lane, c. 1900, **Contributing**, Two-story, four-bay frame duplex with turned post porch, single decoration under porch soffit, shed roofed dormers.
255. 209 Park Lane, Park Lane Church of God, **Non-Contributing**, Single-story modern brick church.
256. 213 Park Lane, c. 1950, **Contributing**, Single-story Ranch style house with side entrance sheltered porch incorporated under gable roof, paired window units.
257. 305 Park Lane, c. 1920-40, **Contributing**, Single-story gable-front bungalow built on slope of hill, hip roofed front porch with Tuscan columns, six-over-one sash windows.
258. 310 Park Lane, c. 1920, **Contributing**, Two-story, three-bay, pyramidal roofed frame house, enclosed front porch.
259. 402 Park Lane, c. 1880-90, **Contributing**, Two-story, ell-shaped frame Victorian house with turned post porch, sawn eave brackets, projecting front pavilion to side with three-sided bay, decorative sawnwork in gable end, porch wraps three-sides of house, partially glazed front door.
260. 404 Park Lane, c. 1890, **Contributing**, Two-story, ell-shaped Victorian frame house on ridge overlooking town, projecting front bay with decorative sawnwork in eave and under the soffit, pendant drops.

Denton Road

United States Department of the Interior
National Park Service

National Register of Historic Places Continuation Sheet

CAR-338
Federalsburg West Historic District

Name of Property

Caroline County, Maryland

County and State

Section 7 Page 32

261. 109 Denton Road, c. 1930-40, **Contributing**, Single-story, plain concrete block warehouse, blocks have beveled edges, brick front with stepped parapet façade, later concrete block front section covered by a hip roof.
262. 115 Denton Road, c. 1930-40, **Contributing**, Single-story, plain concrete block commercial building, plain concrete blocks with beveled edges, later hip roofed section across main façade.
263. 116-18 Denton Road, c. 1920-30, **Contributing**, Story-and-a-half, frame duplex with gable front elevation and shed roofed dormers on each side roof slope.
264. 117 Denton Road, c. 1960-80, **Non-Contributing**, Single-story metal clad commercial building with low pitched gable front roof, poured concrete slab foundation.
265. 203 Denton Road, c. 1940, **Contributing**, Single-story frame cottage style house.
266. 206 Denton Road, c. 1960, **Contributing**, Single-story gable roofed frame Ranch style house with asymmetrical front and off-center entrance, tripartite window unit to right of front door.
267. 208 Denton Road, c. 1990, **Non-Contributing**, Single-story frame gable roofed house with plain block foundation and vinyl siding.
268. 210 Denton Road, c. 1930-40, **Contributing**, Single-story, gable-front frame bungalow with textured stucco foundation and enclosed front porch.
269. 216 Denton Road, c. 1890-1900, **Contributing**, Two-story, two-bay, gable roofed frame house, two-story rear wing, enclosed front porch, interior end brick stove chimney, extended eaves, molded window lintels.
270. 219 Denton Road, 1913, **Contributing**, Zion M. E. Church, Single-story, cruciform shaped frame church on raised rusticated block foundation, Palladian style, colored glass window in front gable, corner entrance and bell tower, shed roofed hood supported on stick brackets, open belfry with sawn corner brackets, marble datestone inscribed Zion M. E. Church, Founded 1848, Rebuilt 1873-1886, New Building, 1913.
271. 221 Denton Road, c. 1910-20, **Contributing**, Two-story, two-bay gable-roofed frame house.
272. 223 Denton Road, c. 1910-20, **Contributing**, Two-story, two-bay, gable roofed frame house.

United States Department of the Interior
National Park Service

National Register of Historic Places Continuation Sheet

CAR-338
Federalsburg West Historic District

Name of Property

Caroline County, Maryland

County and State

Section 7 Page 33

273. 231-239 Denton Road, c. 1910-30, **Contributing**, Complex of single-story, one-room plan frame tenant houses with plain detailing, artificial exterior siding.
274. 325 Denton Road, c. 1900-1910, **Contributing**, Single-story, early to mid 20th century frame warehouse.
275. 402 Denton Road, c. 1910-30, **Contributing**, (Original home to Service Trucking Co.) Early 20th century frame store building, two sections with projecting gable roofed portico, display windows, side section with gable roofed hood, extended eaves, Abandoned.
276. 403 Denton Road, c. 1910-20, **Contributing**, Single-story, gable-front, frame store, shed roofed porch collapsed, extended eaves, side additions with shed roof, display windows under front porch.
277. 404 Denton Road, c. 1940, **Contributing**, Single-story frame cottage style house with concrete block foundation and wall construction, frame gable ends.
278. 405 Denton Road, c. 1880, **Contributing**, Two-story, three-bay, side hall/double-pile plan frame house with low pitched hip roof, bracketed eave, six-over-six sash windows, interior brick stacks, heavily molded front door, transom and sidelights.
279. 406 Denton Road, c. 1900-10, **Contributing**, Two-and-a-half story, three-bay side hall/parlor plan frame house with plain concrete block foundation, off-center gable roofed dormer, center brick stove chimney, extended eaves with returns, single-width bay window on gable end.
280. 408 Denton Road, c. 1815-20, **Contributing**, Exeter, National Register listed, CAR-70, Two-story, side hall/parlor Federal style frame house with story-and-a-half two-room plan rear wing, largely original exterior finishes; shingled exterior to front section, beaded weatherboards to rear wing. Intricately detailed and individually distinctive front entrance with flush and beaded edge six-panel front door framed by neoclassical surround with triangular pediment, two-over-two sash sidelights and diagonal reeding to trim. Louvered shutters on sidelights. The front cornice has a drilled sway decoration distinctive to the region for the early nineteenth century. Exposed brick firewall on north end flanked by six-over-nine sash windows, flush gable ends trimmed with molded bargeboard. Early nineteenth century brick smokehouse stands in backyard.
281. 410 Denton Road, c. 1940, **Contributing**, Story-and-a-half, three-bay frame house with gable roofed front portico supported by Tuscan columns, paired six-over-one sash windows, small six-over-one sash windows light second floor, single-story bay window on gable end.

United States Department of the Interior
National Park Service

National Register of Historic Places Continuation Sheet

CAR-338
Federalsburg West Historic District

Name of Property

Caroline County, Maryland

County and State

Section 7 Page 34

282. 412 Denton Road, c. 1940, **Contributing**, Single-story, asymmetrical cottage style house with plain block foundation, cast concrete oval vents, forward projecting section with gable front three-sided bay.
283. 415 Denton Road, c. 1860, **Contributing**, Herring Hill (also Idlewild), Two-story, six-bay, single-pile frame house, sidelighted front entrance under flat roofed porch supported by decorative sawn posts with sawn brackets, corner pilasters, sawn eave brackets highlight cornice, enclosed pediment on street elevation, interior end brick stack, two-story rear service wing. The history of the house is associated with the mill that formerly operated on the creek, known during the late 19th and early 20th centuries as the Ildewild Mill. Two-story, frame commercial block stands in backyard, formerly operated as the Merricken Feed Store, corrugated metal siding. Small pyramidal roofed dairy stands to the east of the house.
284. 418 Denton Road, c. 1910-20, **Contributing**, Single-story, hip roofed bungalow, plain concrete block foundation, engaged porch, hip roofed dormer.
285. 504 Denton Road, c. 1920-30, **Contributing**, Two-and-a-half story, two-bay, four-square frame house with block foundation, hip roofed dormer, paired one-over-one sash window units.
286. 505-07-09 Denton Road, c. 1910-20, **Contributing**, Series of two-story, two-bay gable roofed frame houses.
287. 508 Denton Road, c. 1920, **Contributing**, Single-story, hip roofed frame bungalow with engaged porch, off-center gable on porch roof, concrete block plinths, small gable roofed dormer, single flue brick stove chimney.
288. 510 Denton Road, c. 1920, **Contributing**, Single-story frame bungalow
289. 512 Denton Road, c. 1920, **Contributing**, Single-story frame bungalow.
290. 513 Denton Road, c. 1920-30, **Contributing**, Story-and-a-half gambrel roofed frame house with gambrel roofed end facing street, block foundation, hip roofed porch, hip roofed side wing.
291. 515 Denton Road, c. 1920-30, **Contributing**, Single-story gable-front frame bungalow with collapsed front porch, abandoned.

United States Department of the Interior
National Park Service

National Register of Historic Places Continuation Sheet

CAR-338
Federalsburg West Historic District

Name of Property

Caroline County, Maryland

County and State

Section 7 Page 35

292. 516 Denton Road, c. 1920, **Contributing**, Charles Walker House, Two-story, three-bay, Colonial Revival influenced frame house with colossal columned front, sidelighted double door entrance, single-story hip roofed side wings.
293. 517 Denton Road, c. 1910, **Contributing**, Two-story, ell-shaped frame house, forward projecting bay, paired window units.
294. 519 Denton Road, c. 1920, **Contributing**, Two-and-a-half story, two-bay hip roofed frame house, gable roofed dormer, hip roofed porch with Tuscan columns, rusticated block foundation and rusticated block plinths.
295. 520 Denton Road, c. 1920, **Non-Contributing**, Fragment of single-story bungalow gable roofed porch on tapered piers.
296. 521 Denton Road, c. 1920-30, **Contributing**, Story-and-a-half, shingled frame bungalow on rusticated block foundation, large gabled dormer with door to small porch incorporated into roof.
297. 522 Denton Road, c. 1920-30, **Contributing**, Story-and-a-half bungalow with paired gable roofed dormers, enclosed shed roofed porch, paired window units.
298. 524 Denton Road, c. 1920-30, **Contributing**, Single-story, gable-front frame bungalow with enclosed front porch, rusticated block foundation.

Vernon Avenue

299. 103 Vernon Avenue, c. 1940-50, **Contributing**, Story-and-a-half, Cape Cod style brick house, brick pilasters flank center entrance, brick side wing, gable roofed dormers.
300. 105 Vernon Avenue, c. 1950, **Contributing**, Single-story, brick Ranch style house with engaged porch, gable roofed dormer with tripartite window unit, elevated block foundation.
301. 106 Vernon Avenue, c. 1925, **Contributing**, Single-story, hip-roofed frame bungalow, engaged porch with gable roofed dormer.
302. 108 Vernon Avenue, c. 1930, **Contributing**, Story-and-a-half frame bungalow with gable roofed dormer, block foundation, extended eaves.

United States Department of the Interior
National Park Service

National Register of Historic Places Continuation Sheet

CAR-338
Federalsburg West Historic District

Name of Property

Caroline County, Maryland

County and State

Section 7 Page 36

303. 110 Vernon Avenue, c. 1930, **Contributing**, Story-and-a-half shingled frame bungalow with jerkinhead roof, engaged front porch with tapered posts, shed roofed dormer with paired six-over-one sash windows, bay window on gable end covered with shed roof.
304. 112 Vernon Avenue, c. 1930, **Contributing**, Story-and-a-half frame bungalow with engaged porch, gable roofed dormer with tripartite window unit, elevated block foundation.
305. 201 Vernon Avenue, c. 1950-60, **Contributing**, Single-story, mid 20th century frame Ranch style house with plain gable roof and plain exterior details, tripartite window.
306. 203 Vernon Avenue, c. 1950, **Contributing**, Single-story, gable roofed Ranch house with plain detailing, block foundation.
307. 204 Vernon Avenue, c. 1950, **Contributing**, Single-story, cottage style house with rusticated block foundation, gable roofed entrance stoop, paired and single window units, partially glazed door.
308. 301 Vernon Avenue, c. 1940-50, **Contributing**, Single-story, frame cottage style house with projecting front gable, engaged porch, block foundation, tripartite window in front gabled section.
309. 302 Vernon Avenue, c. 1950, **Contributing**, Single-story cottage style frame house with small gable roofed stoop, remodeled.
310. 304 Vernon Avenue, c. 1950, **Contributing**, Single-story Ranch style frame house, shed roofed front porch with turned posts, breezeway connecting single bay garage.
311. 305 Vernon Avenue, c. 2005, **Non-Contributing**, Single-story Ranch style frame house.
312. 308 Vernon Avenue, c. 1950-60, **Contributing**, Single-story Ranch style frame house with hip roof, picture window.

South Park Lane

313. 102 South Park Lane, c. 1950-60, **Contributing**, Single-story, brick and frame mid 20th century house with gable roof and projecting off-center gabled wing, scroll pediment entrance surround, soldier course arches, half round lunette window in gable-front.

United States Department of the Interior
National Park Service

National Register of Historic Places Continuation Sheet

CAR-338
Federalsburg West Historic District

Name of Property

Caroline County, Maryland

County and State

Section 7 Page 37

314. 104 South Park Lane, c. 1935, **Contributing**, Story-and-a-half gable roofed house with full shed dormers, shed roofed porch with paired square columns, segmental arches between posts, exterior brick stack.
315. 106 South Park Lane, c. 1913, **Contributing**, Two-and-a-half story, four-bay, four-square frame house with raised concrete block foundation, blocks have beveled edges, wraparound porch with concrete columns, hip roofed dormers, Story-and-a-half frame garage with hip roof and hip roofed dormers.

Buena Vista Avenue

316. 101 Buena Vista Avenue, 1913, **Contributing**, John E. Elrick House, Prominent two-and-a-half story stretcher bond brick house built with Craftsman and Colonial Revival design influences; center hip roofed main block extended on front corners by hip roofed pavilions, wall construction highlighted by watertable, beltcourse and jack arch brickwork, bold flat roofed portico with square brick columns and heavily proportioned eave brackets, sidelighted entrance, open sections of walled porch flank center entrance portico, wide eave with heavy proportioned and paired eave blocks, hip roofed dormers fitted with tripartite window units, early twentieth century brick garage.
317. 105 Buena Vista Avenue, 1989, **Non-Contributing**, Single-story, late 20th century Ranch style frame house.
318. 107 Buena Vista Avenue, 1918, **Contributing**, Two-and-a-half story, two-bay, four—square frame house, raised foundation, shed porch, concrete block columns, paired and single window units, hip roofed dormers.
319. 109 Buena Vista Avenue, 1932, **Contributing**, One-and-a-half story, frame bungalow, rusticated block foundation, rusticated block plinths support tapered posts, extended eaves, open soffits.
320. 110 Buena Vista Avenue, 1922, **Contributing**, Two-and-a-half story, two-bay, four-square frame house, hip roofed porch, paired window units, six-over-one sash windows, hip roofed dormers.
321. 111 Buena Vista Avenue, c. 1870, **Contributing**, Two-story, side hall/parlor frame house on brick foundation, exposed brick firewall on gable end, extended eaves with returns.
322. 201 Buena Vista Avenue, c. 1870, **Contributing**, Two-story, three-bay frame house with Tuscan columned porch, gable over front entrance, six-over-six sash windows.

United States Department of the Interior
National Park Service

National Register of Historic Places Continuation Sheet

CAR-338
Federalsburg West Historic District

Name of Property

Caroline County, Maryland

County and State

Section 7 Page 38

323. 202 Buena Vista Avenue, c. 1938, **Contributing**, Charles Smith House, Story-and-a-half, cottage style frame house with asymmetrical gables facing street, smaller gable contains entrance, round window in gable, shed dormers on roof slopes, exterior chimney on side elevation.
324. 203 Buena Vista Avenue, c. 1940, **Contributing**, Story-and-a-half frame bungalow on raised textured stucco foundation, large gable roofed dormer with tripartite window.
325. 204 Buena Vista Avenue, c. 1903, **Contributing**, Two-story, ell-shaped frame house with two-story shed roofed infill containing entrance porch, enclosed second floor.
326. 205 Buena Vista Avenue, 1923, **Contributing**, Single-story hip roofed frame bungalow with center gable, block foundation with block plinths supporting tapered posts.
327. 206 Buena Vista Avenue, 1913, **Contributing**, Two-and-a-half story, three-bay, four-square frame house with hip roof, and hip roofed front dormer, shingled exterior, later turned post front porch.
328. 207 Buena Vista Avenue, c. 1920, **Contributing**, T. S. Holt House, Story-and-a-half frame bungalow with Tuscan columned front porch, pediment front entrance bay, three sided bay window under porch, large shed dormer with tripartite window.
329. 301 Buena Vista Avenue, 1913, **Contributing**, Stowell House, Two-and-a-half story, two-bay plain concrete block house, large pyramidal roof with gabled dormers on roof slope, wraparound porch with concrete posts, abandoned condition.
330. 303 Buena Vista Avenue, 1903, **Contributing**, Two-story, ell-shaped, frame house with patterned metal shingle roof, two-story, three-sided bay pavilion on gable end, double door entrance.
331. 304 Buena Vista Avenue, 1903, **Contributing**, Two-story, ell-shaped frame house, enclosed front porch, three-sided front pavilion.
332. 305 Buena Vista Avenue, 1923, **Contributing**, Two-and-a-half story Queen Anne influenced frame house with hip roof and projecting three-sided pavilions on front and side elevations, replacement posts on front porch.
333. 307 Buena Vista Avenue, c. 1870, **Contributing**, H. B. Messenger House, Two-story, Italianate influenced frame house fire damaged interior, siding removed to reveal planks attached to studs,

United States Department of the Interior
National Park Service

National Register of Historic Places Continuation Sheet

CAR-338
Federalsburg West Historic District

Name of Property

Caroline County, Maryland

County and State

Section 7 Page 39

double door side entrance with sidelights and transom, wide eave with low gables, off-center brick chimney stack.

334. 308 Buena Vista Avenue, 1913, **Contributing**, Two-story, three-bay, four-square frame house covered by hip roof, hip roofed porch, rusticated block foundation, hip roofed dormer.
335. 310 Buena Vista Avenue, 1905, **Contributing**, Two-story, three-bay gable roofed frame house with two-story porch.
336. 312 Buena Vista Avenue, c. 1900, **Contributing**, Two-story, three-bay gable roofed frame house with interior end brick stove chimneys.
337. 313 Buena Vista Avenue, c. 1940-50, **Contributing**, Story-and-a-half frame bungalow with brick foundation, tapered posts on brick plinths, large gable roofed dormer with tripartite window unit.
338. 314 Buena Vista Avenue, c. 1910, **Contributing**, Two-story, three-bay gable roofed frame house, remodeled.
339. 315 Buena Vista Avenue, c. 1880, **Contributing**, Two-story, asymmetrical Victorian frame house with brick foundation, two-story projecting three-sided pavilion.
340. 316 Buena Vista Avenue, c. 1930, **Contributing**, Story-and-a-half hip roofed frame bungalow with hip roofed front dormer, engaged porch with tapered posts.
341. 317 Buena Vista Avenue, c. 1920, **Contributing**, Two-story, three-bay, four-square frame house with hip roofed dormer, rusticated block foundation, turned post porch.
342. 319 Buena Vista Avenue, c. 1920, **Contributing**, Two-and-a-half story resided with T-111, block foundation.
343. 322 Buena Vista Avenue, c. 1950, **Contributing**, Single-story gable roofed frame bungalow with wide wings, enclosed hip roof front porch.
344. 323 Buena Vista Avenue, c. 1930, **Contributing**, Single-story gable roofed frame bungalow.
345. 325 Buena Vista Avenue, c. 1920, **Non-Contributing**, Fully reworked two-story, ell-shaped Victorian frame house with synthetic siding and replacement windows.

United States Department of the Interior
National Park Service

National Register of Historic Places Continuation Sheet

CAR-338
Federalsburg West Historic District

Name of Property

Caroline County, Maryland

County and State

Section 7 Page 40

Maple Avenue

346. 107 Maple Avenue, c. 1900, **Contributing**, Two-story, ell-shaped frame house with extended eaves and returns, three-over-one sash windows.
347. 113 Maple Avenue, 2009, **Non-Contributing**, Single-story, gable-front, frame bungalow with modern stuccoed block foundation.
348. 201 Maple Avenue, c. 1900, **Contributing**, Two-story, three-bay, gable-roofed single-pile frame house with hip roofed porch, seamed metal covering, single-flue brick stove chimney.
349. 202 Maple Avenue, c. 1900, **Contributing**, Two-story, two-bay, gable roofed frame house with side hall/parlor plan, hip roofed front porch.
350. 203 Maple Avenue, c. 1930, **Contributing**, Single-story cottage style frame house with asymmetrical front, in-filled corner porch, block foundation, three-sided bay front small projecting gable.
351. 204 Maple Avenue, c. 1900, **Contributing**, Two-story, three-bay, gable roofed frame house, shed roofed porch, rusticated block foundation.
352. 205 Maple Avenue, 1920, **Contributing**, Two-story, gable-front frame bungalow, enclosed porch, beveled edge concrete blocks.
353. 206 Maple Avenue, c. 1900, **Contributing**, Two-story, ell-shaped Victorian house with extended eaves, shed roofed porch.
354. 207 Maple Avenue, c. 1900, **Contributing**, Two-story, ell-shaped Victorian frame house with block foundation, turned post porch, extended eaves.
355. 208 Maple Avenue, c. 1900, **Contributing**, Two-story, ell-shaped Victorian frame house with extended eaves, hip roofed porch.
356. 210 Maple Avenue, c. 1920, **Contributing**, Two-and-a-half story, four-square frame house with hip roofed dormer, hip roofed porch.

United States Department of the Interior
National Park Service

National Register of Historic Places Continuation Sheet

CAR-338
Federalsburg West Historic District

Name of Property

Caroline County, Maryland

County and State

Section 7 Page 41

357. 211 Maple Avenue, c. 1900, **Contributing**, Two-story, ell-shaped Victorian frame house with hip roofed porch and extended eaves on main block.
358. 212 Maple Avenue, c. 1930, **Contributing**, One-and-a-half story, hip roofed frame bungalow with gable roofed dormer, engaged porch, rusticated block plinths support tapered posts, block foundation.
359. 213 Maple Avenue, c. 1940-50, **Contributing**, Single-story, bungalow with gable roof and enclosed porch.
360. 214 Maple Avenue, c. 1920, **Contributing**, Story-and-a-half hip roofed frame bungalow with gable roofed dormer, engaged porch, beveled edge blocks, beveled edge blocks with half length tapered posts.
361. 215 Maple Avenue, c. 1910, **Contributing**, Single-story, gable-front frame bungalow, rusticated block foundation, hip roofed screened in porch.
362. 216 Maple Avenue, c. 1920, **Contributing**, Single-story, hip roofed bungalow with small gable roofed side pavilion.
363. 217 Maple Avenue, 1950, **Contributing**, Single-story, frame bungalow with off-set gable-front porch supported on stick posts.
364. 218 Maple Avenue, c. 1910, **Contributing**, Single-story, gable-front textured stucco house with corner porch, turned posts, extended eaves, one-over-one sash windows.
365. 220 Maple Avenue, c. 1900, **Contributing**, Two-story, ell-shaped frame house with enclosed porch, extended eaves.
366. 221 Maple Avenue, c. 1900, **Contributing**, Two-story, three-bay hip roofed frame house, turned post porch with sawn eave brackets, single-story bay window on side elevation.
367. 223 Maple Avenue, c. 1910, **Contributing**, Story-and-a-half frame bungalow on raised stuccoed foundation, engaged front porch, Tuscan columns, hip roofed dormers.
368. 305 Maple Avenue, c. 1940, **Contributing**, Single-story, asymmetrical elevation, gable roofed frame house, side entrance porch, pent eave, forward projecting gable from main block with steeply pitched roof.

United States Department of the Interior
National Park Service

National Register of Historic Places Continuation Sheet

CAR-338
Federalsburg West Historic District

Name of Property

Caroline County, Maryland

County and State

Section 7 Page 42

369. 306 Maple Avenue, c. 1930, **Contributing**, Story-and-a-half, three-bay Cape Cod style frame house, center entrance with neoclassical entrance surround, gable roofed dormers, shed porch to side.
370. 307 Maple Avenue, c. 1940, **Contributing**, Single-story, asymmetrical elevation, gable roofed house with steeply pitched gable roofed enclosed entrance with long-sloping side with curved end like, exterior gable end brick chimney.
371. 308 Maple Avenue, c. 1930, **Contributing**, Story-and-a-half Cape Cod style frame house with off-center brick chimney stack.
372. 309 Maple Avenue, c. 1940, **Contributing**, Single-story, asymmetrical elevation, gable roofed house with steeply pitched gable roofed enclosed entrance with long sloping side with curved end, exterior brick chimney to left side of entry, clipped gable of main roof.
373. 310 Maple Avenue, c. 1930, **Contributing**, Story-and-a-half, Cape Cod house with beveled edge block foundation, gable roofed dormers, neoclassical entrance surround.
374. 311 Maple Avenue, c. 1940, **Contributing**, Single-story, gable roofed frame house with engaged porch, square posts with segmental arches between posts, three-sided bay window.
375. 312 Maple Avenue, c. 1950, **Contributing**, Single-story, mid 20th century Ranch style house with engaged porch, lower gable roofed side wing.
376. 313 Maple Avenue, c. 1920, **Contributing**, Single-story, gable-front frame bungalow, asbestos shingled exterior, extended eaves, two-over-two sash windows.
377. 314 Maple Avenue, c. 1960, **Contributing**, Single-story, stretcher bond brick Ranch style house with medium pitched gable roof incorporating engaged porch, metal supports, multi-pane picture window to left of front door.
378. 315 Maple Avenue, c. 1960, **Contributing**, Single-story, Ranch style frame house, remodeled exterior.
379. 317 Maple Avenue, c. 1930, **Contributing**, Single-story Ranch style house with forward projecting gabled section, block foundation, shed porch.

United States Department of the Interior
National Park Service

National Register of Historic Places Continuation Sheet

CAR-338
Federalsburg West Historic District

Name of Property

Caroline County, Maryland

County and State

Section 7 Page 43

380. 318 Maple Avenue, c. 1950, **Contributing**, Story-and-a-half brick and frame Cape Cod style house with gable roofed entrance, neoclassical entrance surround, block foundation with brick side wing, six-over-six sash windows.
381. 319 Maple Avenue, c. 1950, **Contributing**, Single-story, mid 20th century Ranch style frame house with plain block foundation, asymmetrical front with forward projecting gable roofed section, recessed entrance wall, east gable end wing with separate entrance under small porch.
382. 320 Maple Avenue, c. 1940, **Contributing**, Single-story, mid 20th century Ranch with forward projecting gable roofed section, shed porch, stuccoed foundation.
383. 322 Maple Avenue, c. 1960, **Contributing**, Single-story Ranch style frame house with forward projecting gable roofed section, recessed entrance, block foundation, carport to side.
384. 324 Maple Avenue, c. 1950, **Contributing**, Single-story Cape Cod style frame house with asbestos shingle, exterior two-part gable roof with center entrance, side screened in porch.
385. 325 Maple Avenue, c. 1950, **Contributing**, Single-story, mid 20th century Ranch style frame house with shingled exterior, side shed porch, three-part picture window.
386. 331 Maple Avenue, c. 1950-60, **Contributing**, Single-story, mid 20th century Modern style frame and concrete block house with one section covered with single-pitch shed roof juxtaposed against lower roofed entrance section, which is extended by single-story concrete block wing to east, attached carport on northwest corner.

Academy Avenue

387. 104-08 Academy Avenue, c. 1920, **Contributing**, Three separate single-story, gable roofed frame bungalows.
388. 105-11 Academy Avenue, c. 1930, **Contributing**, Two-story, multi-unit stretcher bond brick rowhouse block, continuous single-story porch with Tuscan columns and brick knee walls shelters entrances across front, parapet wall caps top of rowhouse block with small low pitched gables defining each unit.
389. 115 Academy Avenue, Stowell Printing Company Building, 1939 (Datestone), **Contributing**, Currently the Food Instrument Corporation) Two-story, thirteen bay brick commercial building with center entrance and flanking windows, front door is framed by stepped brickwork in alternating

United States Department of the Interior
National Park Service

National Register of Historic Places Continuation Sheet

CAR-338
Federalsburg West Historic District
Name of Property

Caroline County, Maryland
County and State

Section 7 Page 44

yellow and red brick highlighted bands, inset brick panels across front above the windows, parapet wall with four small brick turrets.

390. 202 Academy Avenue, c. 1930, **Contributing**, Howard Freeman Carpentry Shop, Single-story, gable-front frame commercial building.
391. 203 Academy Avenue, c. 1920, **Contributing**, Two-story, two-bay, frame house with concrete block foundation and concrete block plinths, tapered half columns, extended eaves, interior brick stove chimney.
392. 204 Academy Avenue, c. 1900-10, **Contributing**, Two-story, one-bay, gable-front frame house with extended eaves, shed roofed front porch.
393. 205 Academy Avenue, c. 1910, **Contributing**, Two-story, ell-shaped frame house with hip roofed porch, remodeled exterior.
394. 206 Academy Avenue, c. 1910, **Contributing**, Two-story, ell-shaped frame house with extended eaves, hip roofed front porch.
395. 208 Academy Avenue, c. 1910, **Contributing**, Two-story, three-bay gable roofed frame house with turned post front porch, extended eaves.
396. 209 Academy Avenue, c. 1910, **Contributing**, Two-story, three-bay, gable roofed frame house with enclosed front porch.
397. 211 Academy Avenue, c. 1910, **Contributing**, Two-and-a-half story, four square frame house turned post front porch with corner brackets, hip roofed dormer, two-over-two sash windows.
398. 212 Academy Avenue, c. 1900, **Contributing**, Two-story, ell-shaped frame house with three-sided bay on projecting gable, shed roofed porch (Abandoned)
399. 213 Academy Avenue, c. 1910, **Contributing**, Two-and-a-half story, three-bay side entrance frame house with center gable on hip, hip roofed turned post front porch.
400. 215 Academy Avenue, c. 1910, **Contributing**, Two-story, three-bay gable roofed frame house.
401. 216 Academy Avenue, c. 1910, **Contributing**, Two-story, three-bay side hall/parlor plan frame house with hip roofed porch on metal posts, two-over-two sash windows.

United States Department of the Interior
National Park Service

National Register of Historic Places Continuation Sheet

CAR-338
Federalsburg West Historic District

Name of Property

Caroline County, Maryland

County and State

Section 7 Page 45

402. 217 Academy Avenue, c. 1910, **Contributing**, Two-story, asymmetrical frame house with one-story bay window to right of entrance porch, turned posts, hip roof to main block with hip roofed dormer.
403. 218 Academy Avenue, c. 1910, **Contributing**, Two-and-a-half story, four square hip roofed frame house with hip roofed dormer, two-over-two sash windows, hip roofed turned post porch.
404. 220 Academy Avenue, c. 1910, **Contributing**, Two-and-a-half story, four-square frame house, infilled brick pier foundation.
405. 222 Academy Avenue, c. 1910, **Contributing**, Two-and-a-half story, asymmetrical frame house with gable on hip roof, gable roofed entrance stoop, two-story side pavilion.
406. 302 Academy Avenue, c. 1920, **Contributing**, Two-story, three-bay, single-pile frame house with hip roofed porch supported on brick posts, two-story three-sided end bay.
407. 303 Academy Avenue, c. 1910, **Contributing**, Two-story, ell-shaped Victorian frame house with projecting two-story pavilion with three-sided bay, brick foundation, turned post front porch, interior end brick chimney stack.
408. 304 Academy Avenue, c. 1910, **Contributing**, Two-story, gable-front frame house with side wing, hip roofed frame porch, bracketed eave.
409. 305 Academy Avenue, c. 1900, **Contributing**, Dr. G. C. Webb House, Two-and-a-half story, Queen Anne influenced frame house, center steeply pitched hip roofed with projecting pavilions, wraparound porch with Tuscan order half columns on plinths.
410. 306 Academy Avenue, c. 1910, **Contributing**, Two-and-a-half story, four-square frame house with enclosed porch, paired six-over-one sash windows, hip roofed dormer.
411. 307 Academy Avenue, c. 1920-, **Contributing**, Story-and-a-half, gambrel front frame house with corner porch, oval glass to front door, gambrel roofed side dormers.
412. 308-10 Academy Avenue, c. 1900, **Contributing**, T. J. Williams House, Two-story, two-bay, gable roofed frame house with side entrance, corner conical roofed tower on west gable end, two-story rear wing.

United States Department of the Interior
National Park Service

National Register of Historic Places Continuation Sheet

CAR-338
Federalsburg West Historic District

Name of Property

Caroline County, Maryland

County and State

Section 7 Page 46

413. 309 Academy Avenue, c. 1930, **Contributing**, Story-and-a-half brick cottage style house, gable roofed entrance with round arched door opening, side porch with tapered half posts on brick plinths, shed roofed dormer, gable roofed side wing.
414. 311 Academy Avenue, c. 1900, **Contributing**, Two-story, three-bay, side hall/parlor plan frame house with turned post porch, sawn brackets and sawtooth-edged soffit trim, two-story service wing, unusual single-story frame garage with eyebrow shaped dormers with multi-pane windows.
415. 403-05 Academy Avenue, c. 1910, **Contributing**, Two-story, Victorian with gable-front side entrance, two-story side wing with three-sided bay, decorative trim in soffit.
416. 407 Academy Avenue, c. 1910-20, **Contributing**, Two-and-a-half story, four-square frame house, raised beveled edge block foundation, hip roofed porch with replacement columns, diamond shaped muntin window between second floor windows.
417. 409 Academy Avenue, c. 1910-20, **Contributing**, Two-and-a-half story, frame house with brick foundation, projecting pavilions, center brick stack protrudes through pyramidal roof.
418. 411 Academy Avenue, c. 1930, **Contributing**, Story-and-a-half, brick bungalow with corner porch, stretcher bond wall construction, scroll shaped tops to side wall of brick steps, large gable roofed dormer with small Craftsman style stick brackets.
419. 412 Academy Avenue, c. 1920, **Contributing**, Two-and-a-half story, stuccoed four-square house with stuccoed square columns, porch partially enclosed, kicked eave to hip roof, hip roofed dormers.
420. 413 Academy Avenue, c. 1920, **Contributing**, Two-story, two-bay, Colonial Revival frame house with pent eave including gable roofed hood, scroll bracket supports on sidelighted entrance, pent eave wraps around side of house with identical hood over side door.
421. 415 Academy Avenue, c. 1930, **Contributing**, Story-and-a-half frame house with shingled exterior, projecting entrance with gable on shed roof, steeply pitched main roof with shed dormer.
422. 417 Academy Avenue, c. 1940, **Contributing**, Single-story, mid 20th century shingled frame house with side gable on main gable roof, sidelighted front entrance, tripartite window in forward gable, engaged porch with square posts.
423. 419 Academy Avenue, c. 1910, **Contributing**, Two-and-a-half story, three-bay frame house with raised block foundation, hip roofed front porch, hip roofed dormer, molded metal shingle roof.

United States Department of the Interior
National Park Service

National Register of Historic Places Continuation Sheet

CAR-338
Federalsburg West Historic District

Name of Property

Caroline County, Maryland

County and State

Section 7 Page 47

424. 421 Academy Avenue, c. 1920, **Contributing**, Single-story frame cottage style house with brick foundation, asymmetrical front with off center gable roofed stoop, round arched front door, tripartite window to side of entrance.
425. 423 Academy Avenue, c. 1930, **Contributing**, Story-and-a-half asymmetrical cottage style house, shingled exterior with gable roofed entrance fronting steeply pitched gable roofed main block, shed dormers to each side, gable roofed wing to left, single-story wing to right, house occupies corner of Academy and University Avenues.

Park Avenue

426. 203 Park Avenue, c. 1930, **Contributing**, Story-and-a-half, three-bay frame cottage, rusticated block foundation, shed roofed dormer.
427. 207 Park Avenue, c. 1980, **Non-Contributing**, Single-story, gable-front frame house with modern brick foundation.
428. 301 Park Avenue, c. 1990, **Non-Contributing**, Two-story, three-bay remodeled frame house.
429. 304 Park Avenue, c. 1980, **Non-Contributing**, Two-story, gable front frame house.
430. 305 Park Avenue, c. 1910, **Contributing**, Two-story, three-bay gable front frame house.
431. 307 Park Avenue, c. 1910, **Contributing**, Two-story, three-bay gable roofed frame house.
432. 308-12 Park Avenue, c. 1900, **Contributing**, Two-story, two-bay, gable-front worker housing row, block foundations, extended eaves, plain detailing.
433. 320-322 Park Avenue, c. 2000, **Non-Contributing**, Two separate, single-story, gable roofed frame Ranch houses.
434. 333 Park Avenue, c. 1900, **Contributing**, Victory Packaging, Inc. Two-story stuccoed frame and concrete block commercial building with gable roof, concrete block walled shed addition, brick and block foundation to center section, corrugated metal sheathed addition on opposite side supported on concrete block foundation.

Holt Street

United States Department of the Interior
National Park Service

National Register of Historic Places Continuation Sheet

CAR-338
Federalsburg West Historic District

Name of Property

Caroline County, Maryland

County and State

Section 7 Page 48

435. 305 Holt Street, c. 1910, **Contributing**, Two-and-a-half story, concrete block and frame four square frame house with turned post porch decorated with sawn brackets, hip roof with hip roofed dormer.
436. 306 Holt Street, c. 1910, **Contributing**, Single-story, gambrel roofed fronted concrete block and frame house, rusticated blocks on ground floor, gambrel roofed dormer on side elevation, turned post porch brackets.
437. 307-09 Holt Street, c. 1910, **Contributing**, Story-and-a-half gambrel roofed concrete block and frame duplex with rusticated concrete block corners, two-over-two sash windows, turned post porch, gable roofed dormers, rusticated concrete block bay window on gable end.
438. 308 Holt Street, c. 1910, **Contributing**, Two-story, one-bay, gable-front frame house with enclosed porch, two-story side shed addition.
439. 310 Holt Street, c. 1920, **Contributing**, Single-story, gable roofed frame bungalow with concrete block foundation, enclosed porch.
440. 311 Holt Street, c. 1910, **Contributing**, Two-story, three-bay gable roofed frame house with modern gable roofed porch.
441. 312 Holt Street, c. 1900, **Contributing**, Two-story, two-bay, gable front frame house, wraparound porch supported on square posts.
442. 313 Holt Street, c. 1910, **Contributing**, Single-story gable-front frame bungalow with shed porch on turned posts.
443. 314 Holt Street, c. 1920, **Contributing**, Two-and-a-half story, four-square frame house with pyramidal roof, center brick stove chimney, hip roofed porch on square posts, single-story bay window on side elevation.
444. 315 Holt Street, c. 1920, **Contributing**, Two-and-a-half story, four-square, stuccoed house with hip roof and hip roofed dormer.
445. 316 Holt Street, c. 1910, **Contributing**, Two-and-a-half story, four-square frame house with hip roofed porch, rusticated block plinths support cast concrete half columns, hip roofed dormer.

United States Department of the Interior
National Park Service

National Register of Historic Places Continuation Sheet

CAR-338
Federalsburg West Historic District

Name of Property

Caroline County, Maryland

County and State

Section 7 Page 49

446. 317 Holt Street, c. 1910, **Contributing**, Single-story, gable-front frame bungalow, infilled block pier foundation.
447. 320 Holt Street, early to mid 20th century, **Contributing**, Marshy Hope Hardware, Two-story frame commercial building with reworked exterior.
448. 324 Holt Street, early to mid 20th century, **Contributing**, Haines B. Holt Co., Two-story, frame warehouse facility with Tilghman's Fertilizer Company sign painted on upper door.

Railroad Avenue

449. Maryland and Delaware Railroad Station, CAR-163, c. 1880-90, **Contributing**, Single-story, hip roofed frame station supported on a brick foundation, sheathed with shingles, broad eave supported by large timber brackets, exposed rafter tails.
450. Railroad Avenue, Federal Paper and Chemical, early to mid 20th century, **Contributing**, Single-story, corrugated metal clad warehouse with concrete block foundation.
451. 405-09 Railroad Avenue, c. 1910, **Contributing**, Series of three single-story, three-bay, gable roofed frame worker houses, plain exterior detailing.

North and South University Avenue

452. 101 North University Avenue, c. 1950-60, **Contributing**, Single-story, three-bay, gable roofed frame Ranch style house with hyphen extending from gable end to joint attached garage.
453. 203 North University Avenue, c. 1920, **Contributing**, Two-and-a-half story, four-square frame house with pyramidal roof, center brick stove chimney, hip roofed porch, hip roofed dormer with paired window unit.
454. 205 North University Avenue, c. 1915, **Contributing**, Story-and-a-half, three-bay frame bungalow with gable roofed dormer, tapered post front porch, beveled edge concrete block foundation, paired window units.
455. 106 South University Avenue, c. 1980, **Non-Contributing**, Single-story, gable-roofed frame Ranch house.

United States Department of the Interior
National Park Service

National Register of Historic Places Continuation Sheet

CAR-338
Federalsburg West Historic District

Name of Property

Caroline County, Maryland

County and State

Section 7 Page 50

456. 108 South University Avenue, c. 1950, **Contributing**, Single-story mid 20th century stretcher bond rusticated stone Ranch style house, exterior brick chimney on gable end, tripartite window unit.
457. 202 South University Avenue, 1960, **Contributing**, Single-story, asymmetrical front brick house with projecting gable roofed section incorporating an engaged porch, multi-pane window units with brick sills.
458. 204 South University Avenue, c. 1950, **Contributing**, Story-and-a-half frame cottage style house with shingled exterior, asymmetrical front with engaged porch, shed roofed front dormer.
459. 206 South University Avenue, c. 1920, **Contributing**, Story-and-a-half, gable front frame bungalow with rusticated block foundation, projecting gable roofed porch, exposed rafter tails, Craftsman brackets, gable roofed side dormer, early 20th century garage.
460. 208 South University Avenue, 1930-40, **Contributing**, Single-story asymmetrical frame cottage style house with gable roofed entrance stoop, gable-front main block with gable roofed side wing.

United States Department of the Interior
National Park Service

National Register of Historic Places Continuation Sheet

CAR-338
Federalsburg West Historic District

Name of Property

Caroline County, Maryland

County and State

Section 8 Page 1

Summary Statement of Significance:

The Federalsburg West Historic District is significant locally under Criterion C for its collection of resources that reflect a wide range of vernacular forms and finishes common to the region during the period from 1820 through 1964 with a particular concentration of houses, outbuildings, churches, and commercial buildings erected during the late 19th and early to mid 20th centuries. The range of buildings that define the district reflect well the transition from hand-crafted construction materials to the fully industrialized building practices that characterized the late 19th century and the decades before and after World War II. The Federalsburg West Historic District contains the largest and most diverse collection of early to mid 20th century house types in Caroline County.

The Period of Significance, 1790-1964, spans the period between the founding of the town of Federalsburg and a date 50 years prior to the preparation of the nomination documentation. The earliest phase of the town's history is represented by the location of the Northwest Fork (now Central Avenue) Bridge. Extant resources within the district exemplify the period ca. 1820 to the early 1960s.

Resource History and Historic Context:

The town of Federalsburg (originally Federalsburgh) developed along the banks of the North West Fork of the Nanticoke River during the last decade of the 18th century. The North West Fork served as the dividing line between Caroline County to the north and Dorchester County to the south. Initially, the shallow place in the watercourse was known as "Northwest Fork ford," or "Norwes Ford" as the name was simplified in pronunciation. During the early 18th century, the river was crossed with a bridge, and logically known afterwards as "Northwest Fork bridge." By the end of the century, however, the crossing was developing into a more distinct village that was renamed Federalsburg, inspired apparently by the new term that had entered the American vocabulary as a developing nation with an emerging identity. The *Federalist*, later known as the *Federalist Papers*, was a series of articles and essays written and published by Alexander Hamilton, James Madison and John Jay in an effort to promote passage of the U.S. Constitution. The old New York City hall was renamed Federal Hall in 1789, and Congress met there to establish the new federal government. The first American political party, the Federalists, was established around 1790.² Just as the new leaders of America were developing a new identity as

² Inspiration for renaming the town Federalsburg has been credited historically to the widespread popularity of the Federalist Party that was active during the period from 1790 to 1820, however the term Federal or Federalist predates its adoption as an identity with a political party. One source on the origin of the naming Federalsburg states that the name was not adopted until the early 19th century,

United States Department of the Interior
National Park Service

National Register of Historic Places Continuation Sheet

CAR-338
Federalburg West Historic District
Name of Property

Caroline County, Maryland
County and State

Section 8 Page 2

an emergent republic and federal government, the townspeople of the village on the Northwest Fork were changing their identity to distinguish it from any other place in the state or nation. There was no other town in the new nation known by the same name during the 1790s, and it still remains as such to this day.

While the development of a village called Federalburg dates to the closing decade of the 18th century, the immediate region was settled over the course of the previous century with the earliest land patents dating from 1674 (Windsor and Shore Ditch) and 1695 (Rawley). Another principal tract, Sandy Hill, was patented in 1704, and slightly later came Exeter in 1732. The majority of surrounding patents date to the second and third quarters of the 18th century as settlement increased in Dorchester (founded c. 1669) and Queen Anne's County (founded in 1706) in Maryland and Sussex County as the lowest county in what was first part of Pennsylvania (1684) and later Delaware. Caroline was created from parts of Dorchester and Queen Anne's County in 1774.

During the early to mid 18th century a community started to form in and around the Northwest Fork bridge, the earliest mention of which dates to the first quarter of the 18th century. While early and later tracts were occupied and improved into plantations, a few key developments focused commercial activity at the crossing of the Northwest Fork. During this early period an inspection station, known as the Northwest Fork Warehouse, was sited on the west side of the waterway in Dorchester County.³ The inspectors at the warehouse were charged with the duty after the conclusion of the yearly tobacco harvest, to "take down the Scales, Ropes, and Blocks...and lay up the same, with the weights, carefully in some Part of the respective House, and preserve the Weights." The waterway, traversed by shallow draft vessels such as scows, was the principal means of trade in and out of the region until a more mature system of improved roads developed in the century that followed.

Framing the Northwest Fork on nearly every side is a high ridge approximately thirty feet above sea level through which a handful of feeder tributaries pass. The natural fall in elevation was eyed early on by area settlers as potential for industrial development. Over the course of the eighteenth century the Northwest Fork became a regional focus for sawing virgin timber and processing increasing harvests of cereal grains.

Also forming in the area around the bridge were congregations of the Quaker and Methodist faiths during the last quarter of the 18th century. In 1774, Joseph Nichols formed a

however, citations to the town "now known as Federalburg" in Caroline County land records point to a renaming of the village by the early 1790s.

³ *Archives of Maryland Online, Bacon's Laws of Maryland*, Volume 75, page 626, 1763.

United States Department of the Interior
National Park Service

National Register of Historic Places Continuation Sheet

CAR-338
Federalsburg West Historic District

Name of Property

Caroline County, Maryland

County and State

Section 8 Page 3

religious society closely associated with the Quakers, who had established themselves on the Eastern Shore of Maryland during the late 17th century. The followers of Isaac Nicols ascribed to a stricter faith than nearby Quakers and were known as the “New Quakers” or “Nicholites.”⁴ By the end of the 18th century, the Nicholites had merged with the Society of Friends.⁵ In 1784, a parcel of land was formally conveyed by John Pool and Ana his wife to Moses Leverton, Roger Wright, Henry Ward, Levin Wright, James Harris and William Dawson, “members of the Society called Nicolites or New Quakers...near the branch side on which Isaac Nicols’s grist mill stands...it being the spot where the meeting house stands adjacent to Rawley.”⁶ During the same period an early group of Methodist followers established a congregation that met in various private locations in the vicinity of the Northwest Fork bridge and later erected a chapel in the town during the early 19th century.

While early churches, mill complexes and a tobacco inspection station were key features for southern Caroline and northeastern Dorchester County, the creation of a distinct village at North West Fork bridge did not occur until the early 1790s. The decades following the Revolutionary War were generally prosperous across the Eastern Shore of Maryland, particularly as planters continued to fully embrace a shift from a commercial agriculture based on tobacco to one of grain. Bountiful and profitable harvests of wheat and corn supported a rebuilding of the domestic and plantation architecture on the Eastern Shore, and towns and villages experienced spurts of growth as well.

At the end of the eighteenth century, the land on either side of the Northwest Fork was largely held by planter Isaac Nicols, and he held title to tracts known as Rawley (east side of river) and Sandy Hill (west side of river). In 1791, John Nichols⁷, Isaac’s son, conveyed a fraction of an acre at the southeast corner of the bridge, “near the corner of Isaac Nicol’s storehouse.”⁸ In another transfer dated the same year, a lot was conveyed that described its location as “the place now called Federalsburgh.”⁹ In another deed, executed in 1793, Shadrack Willis conveyed to Ennalls Willis a lot in Federalsburgh, leased of John Nicols with a dwelling, and other houses and a garden.¹⁰ In 1794-95 the new village’s name was confirmed in print by

⁴ Carroll, Kenneth, *Quakerism on the Eastern Shore of Maryland*, Baltimore: Garamond/Pridemark Press, 1970, p. 118.

⁵ *Ibid.* p. 119.

⁶ Caroline County Land Record, 1774-86, Volume G.F.A./folio 81, compiled by R. Bernice Leonard.

⁷ Caroline County Will Record, B/194, Will of Isaac Nicols, Written 7.25.1791, proved 12.10.1791, Will abstracts by Bernice Leonard. Isaac Nicols conveyed to his son John, “the tract of land known as Rawley being the east side of the north west fork of the Nanticoke where the bridge crosses—being a part in Caroline County and part in Dorchester County.”

⁸ Caroline County Land Record, D/18, 10.5.1791, Caroline County Courthouse.

⁹ Caroline County Land Record, JR-C-241, Caroline County Courthouse, Denton, Maryland.

¹⁰ Caroline County Land Record, D/304, 1.31.1793, Caroline County Courthouse.

United States Department of the Interior
National Park Service

National Register of Historic Places Continuation Sheet

CAR-338
Federalburg West Historic District

Name of Property

Caroline County, Maryland

County and State

Section 8 Page 4

Dennis Griffith, whose *Map of Maryland* (reproduced in Section 10) located Federalburgh on the boundary of Dorchester and Caroline counties.¹¹

With increased industrial and commercial activities in and around the village, county residents pushed for better roads. In 1799, a group of area residents including mill owner Solomon Bartlett petitioned Maryland's General Assembly for two new public roads to Exeter Mills.¹² The General Assembly complied and authorized justices Moses Leverton, Cain Ross, Levin Nabb, James Wright (of Roger) and Abraham Ross to survey and lay out two roads from said mills, "one road leading from the mills went past the plantation of Thomas Watkins and connected with another road by the plantation of Nathan Wright." The second road was described as "down the north-east side of the northwest branch of Nanticoke River until it intersects the main road in or near the village of Federalburgh." When Joseph Scott drew up his geographical description of Maryland and Delaware a few years later in 1807, he described Federalburgh as "a small village, on Marshy Hope creek, partly in Dorchester and partly in Caroline counties."¹³

The early town was comprised of two principal streets; Main Street that paralleled the waterway, and Bridge Street which connected the two sides of the town as development spread along the east and west banks of the creek, which was increasingly referred to as the Marshyhope Creek. In a 1904 description of commercial and industrial activity in early Federalburgh, a writer commented on the activity of the town around 1804,

From Bridge street to the south end of Main street there were but few buildings and little business. An old school house stood near what is now Academy street, and a doctor's office some distances above. Excepting three dwellings, the east side was blank, but the river bank, from the "Point" to what is now Messenger's Landing was filled with cordwood, lumber, ship timber, tanbark, railroad ties, etc., except at the bridge and what is now Covey's warehouse, were shipyards; nearly every year a vessel was built at one or both of these places. The upper yard was a fine site for this industry, many a trim built clipper went from its ways to plow the Chesapeake and bring handsome returns to its enterprising builders.¹⁴

¹¹ Dennis Griffith, *Map of Maryland*, 1794 [1795], Maryland State Archives.

¹² Archives of Maryland Online, An Act for laying out two roads to Exeter mills in Caroline County

¹³ Joseph Scott, *A Geographical Description of the States of Maryland and Delaware; Also the Counties, Towns, Rivers, Bays, and Islands with a List of the Hundreds of Each County*, Philadelphia: Kimber, Conrad and Company, 1807.

¹⁴ Federalburg Souvenir Booklet [1904] n.p., "Sketch of Federalburg-1804" Federalburg Historical Society.

United States Department of the Interior
National Park Service

National Register of Historic Places Continuation Sheet

CAR-338
Federalsburg West Historic District

Name of Property

Caroline County, Maryland

County and State

Section 8 Page 5

The navigable Marshyhope was critical to the economic life of early Federalsburgh and the immediate region, and efforts at times to keep it unobstructed had to involve Maryland's General Assembly. In 1818, the General Assembly passed legislation that stated

*All wears and hedges already made, or hereafter to be made, in and across the said river, from the Chimney Landing to the north west fork bridge, so as to stop up the passage of boats, vessels, or scows, shall be deemed, and are hereby declared nuisances, and may be by any person taken out of the said north west fork branch of the said river, and destroyed as such.*¹⁵

The act also included a penalty of twenty dollars for each and every offense.

Another key development in the early history of the town was the construction of the Union Methodist Episcopal Church. While the congregational history traces its formation to the late eighteenth century, it is uncertain when the first building was erected near the town. A lot of land bordering Main Street and the creek was acquired by the Union Methodist Chapel trustees in 1815.¹⁶

While Federalsburgh remained relatively small in population during the first half of the 19th century, there were distinct signs of its maturing nature as a commercial center for a tri-county region of Caroline and Dorchester counties in Maryland and Sussex County, Delaware. To improve access over land, new roads were authorized through the farmland surrounding Federalsburgh; in 1829 the Maryland General Assembly passed legislation for a new road connecting Federalsburgh to the county seat in Denton, and another road on the east side of the village was established from a "new bridge across Bloomery Branch near Turner's Mill to intersect the state line near the Bethel Meeting House."¹⁷

Other infrastructure improvements authorized by the General Assembly included an act to repair or re-build the "Bridge over the North-west fork of the Nanticoke River at Federalsburg," Eccleston Brown, Minas Adams and John Rowing of Dorchester, and John Ellicott and Charles Willis of E., of Caroline, were appointed commissioners to facilitate the work at a cost no less than \$800.¹⁸ Five years later, another act authorized a portion of the school funds for Dorchester and Caroline counties to be applied for the benefit of a school to be

¹⁵ Archives of Maryland Online, William Kilty, et al., *The Laws of Maryland from the End of the Year 1799*... Volume 192, Page 2276, 1818.

¹⁶ Horsey, Eleanor, *History of Caroline County*, p. 76. Dorchester County Land Records, Cambridge, Maryland.

¹⁷ *Archives of Maryland Online*, Volume 540, folio 428, 1829.

¹⁸ *Archives of Maryland Online*, Volume 594, folio 611, 1842.

United States Department of the Interior
National Park Service

National Register of Historic Places Continuation Sheet

CAR-338
Federalburg West Historic District

Name of Property

Caroline County, Maryland

County and State

Section 8 Page 6

located within the town's boundary as it would be more convenient for children in the immediate vicinity.¹⁹

An indication of the size and growth of Federalburg during its early history is provided by the General Assembly's act to incorporate the town in 1823; allowing for formal elections, meeting schedules for the newly created commissioners, and a boundary of one-quarter of a mile from the bridge in each direction for the collection of taxes for the improvement of the village. The act authorized the house used by Robert Medford as a tavern for an election place until a town hall was built.²⁰ A second act of incorporation, executed in 1849 and passed in March 1850, formally changed the spelling of the town to Federalburg and it allowed an increased distance of one-half mile from each direction using the bridge as the center point.²¹

The population of Federalburg during the first half of the 19th century was mixed with a few hundred white residents and a small community of free blacks and slaves. Some of the free blacks occupied a now abandoned location on the east side of the town where marked stone grave markers and foundation remnants point clearly to their occupation on the edge of the wooded tracts that bordered the upper sections of the Northwest Fork. A timber reinforced earthen coffer dam was built with a roadway atop to connect the east and west sides of the high ground that bordered the Exeter millpond and creek. The free black residents of Federalburg formed their own Methodist congregation in 1848, which is represented in the historic district by the Zion M. E. Church erected in 1913.

Around 1850, Federalburg offered the surrounding region a variety of dry goods stores on one side of the creek or the another. According to Thomson's Mercantile and Professional Directory of 1851-52, Charles Willis, Charles & Elliott, Mobray & Elliott, and William A. and James Willis were proprietors of general merchandise stores on the Caroline County side of town, whereas Edward R. Goslin & Company, another dry goods merchant, was located in Dorchester. The town boasted a milliner in Mary W. Jenkins and a doctor, William L. Wingate.²²

The size and character of Federalburg at mid-century was improved greatly in the 1860s with the construction of the Dorchester and Delaware Railroad from Seaford to Cambridge. Completed in 1867-68, the spur line to the Choptank River served as one of the catalysts to transform the county seat of Dorchester as well as several villages along the route. Within the

¹⁹ *Archives of Maryland Online*, Volume 612, folio 44-45, Session Laws of 1847, Passed February 7, 1848.

²⁰ *Archives of Maryland Online*, Volume 628, folio 111, Session Laws of 1823, Passed February 23, 1824.

²¹ *Archives of Maryland Online*, Volume 613, folio 419-212, Session Laws of 1849, Passed March 1, 1850.

²² *Thomson's Mercantile and Professional Directory*, 1851-52, Federalburg Historical Society.

United States Department of the Interior
National Park Service

National Register of Historic Places Continuation Sheet

CAR-338
Federalburg West Historic District

Name of Property

Caroline County, Maryland

County and State

Section 8 Page 7

ten years that followed, Federalburg expanded beyond its previous boundaries as new businesses located there and a new generation of houses, stores, churches, and schools was erected to serve a growing population. In a summary of the town's character in 1878, *The Maryland Directory* published the following statement,

FEDERALSBURG is 24 miles from Cambridge, and is a thrifty growing village, the division line between Caroline and Dorchester counties. The N.W. fork of the Nanticoke River and the Dorchester & Delaware Rail Road pass through the village; its position, therefore, is most eligible. There are two churches, the Methodist Episcopal and Presbyterian; a wide-awake weekly newspaper, the Maryland Courier, two handsome public school buildings, several saw-mills, one flouring mill, located on one of the most extensive water-powers in the State; two temperance hotels, one foundry, and several mechanics' shops. The streets in the village are wide, most of the dwelling houses are finely shaded, and many of them have handsome flower gardens attached, while none are built of "blocks," but all have ample grounds for vegetable and fruit gardens. By a special act of Legislature, passed twelve years ago, the sale of intoxicating liquors was Prohibited, and the law has never been violated; consequently the moral standing of the community is of the highest order...Population, 1,000.²³

With the new-found investments, a growing population and prospects for future prosperity on rail, water and land, Federalburg residents started to rebuild and replace many of the houses, stores, churches, and schools with newly fashionable structures reflective of changes in architectural taste that had occurred over the course of previous decades. One of the most ambitious building projects was the construction of the Federalburg Presbyterian Church in 1871-72. Designed with a bold neoclassical, Greek Revival inspired sanctuary with a pediment front, the northeast corner was dominated by a tall bell tower and needle spire that soared above other buildings in Federalburg. A new generation of houses followed popular side hall and center hall/single-pile plans with factory produced sawn decoration in the form of eave or porch brackets, as well as factory produced doors, window sash and dimensioned lumber of all sorts necessary for construction.

A graphic representation of the town at the time was printed by Lake, Griffing, and Stevenson as part of their atlas maps of Dorchester County.²⁴ (See maps, Section 10.) The largest portion of the town including the central business district was on the west side of the Marshyhope, and a mixture of dwellings and commercial ventures lined Main Street. The town

²³ *The Maryland Directory*, J. Frank Lewis & Co., 1878, pp. 249-50.

²⁴ Graham, John L., ed. *The 1877 Atlases and Other Early Maps of the Eastern Shore of Maryland*, Wicomico Bicentennial Committee, 1976, p. 75.

United States Department of the Interior
National Park Service

National Register of Historic Places Continuation Sheet

CAR-338
Federalsburg West Historic District

Name of Property

Caroline County, Maryland

County and State

Section 8 Page 8

was spreading beyond its previous bounds; approximately 53 dwellings defined the west side. Retired merchant Edward R. Goslin financed a stylish Second Empire influenced frame house on the ridge overlooking the town, fronted by a landscaped, circular shaped entrance driveway intersecting Main Street.²⁵ (See 205 West Central Avenue) The Methodist Episcopal and Presbyterian churches occupied prominent locations, and School No. 1 was sited on a new avenue, Academy Street, at the southern end of Main. Another schoolhouse stood next to the Methodist Episcopal church at the opposite end of town. Defining the limits of the southern end of town was the newly built Dorchester & Delaware Railroad with a depot and attendant buildings. Standing nearby was a two-story house-like structure used as a hotel for traveling visitors. (See 321-23 South Main Street) Also near the railroad was the Phosphate Factory owned by J. W. Brown. At the north end, the intersection of Main, the Denton Road and the road west into Dorchester County, known as "The Point," had been a distinct limit to the village for the past half century, but new lots and new houses were being built along the Denton Road and the road west to Hunting Creek that came to be known as Bloomingdale Avenue.

The last quarter of 19th century also witnessed a distinct change in the nature of the town as the Maryland General Assembly passed an act to alter the boundary line and consolidate the two sections of Federalsburg in 1880. The act called for transferring the Dorchester part of the town into Caroline County.²⁶ According to the act, the petition of those in Dorchester, due to "divers difficulties in connection with the maintenance of public schools, and the proper administration of justice...and divers other reasons" prompted a plat to be drawn by Caroline County surveyor, John B. Isler, and a description of the metes and bounds were cited in the act that outlined the area to be conveyed.

As a unified jurisdiction the town continued to grow as the century neared its end. Just after the turn of the twentieth century a Federalsburg Souvenir booklet, printed in 1904, published a short article, "A Few Words About Our Rapid Growth in Building." The article related:

Thirty years ago, to build oneself a home in Federalsburg was a momentous undertaking, and one fraught with many difficulties, although this would hardly be guessed from the appearance of the finished article. These houses, while they were moderately roomy and comfortable, were, in most cases, built in the plainest manner, and from rather rough material. Moreover, these homes were few, and far between, as they

²⁵ Ninth Census of the United States, Population Schedule, Dorchester County, Edward R. Goslin is listed with his wife Emily and son, Edward E., along with 19-year old store clerk Frederick Conway, 12-year old Elizabeth Morris, black domestic servant Marietta Dickerson and her 4-year old daughter Georgianna. Edward R. Goslin's real estate and personal property was valued at \$17,000.

²⁶ *Archives of Maryland Online*, Session Laws of 1880, Volume 395, folio 332-333

United States Department of the Interior
National Park Service

National Register of Historic Places Continuation Sheet

CAR-338
Federalburg West Historic District

Name of Property

Caroline County, Maryland

County and State

Section 8 Page 9

were built almost entirely by those families whose ancestors for many generations back had lived their lives and died in this vicinity. They had been content to stay at home, while outsiders had been equally content to remain away. Why should they come? There was nothing to attract an ambitious person—no possible way for him to earn more than a bare living, and perhaps not that.

Times have changed since then, however, and it would take a smart person to recognize in Federalburg of today, the little town of thirty years ago.

The advent of a few enterprising persons seemed to awake the dormant energy and ambition of the people of the town, and things began to boom. The factories and other industries have brought people from a distance, and these people must have houses to live in. For several years, carpenters have been doing their utmost, but have been unable to supply the demand for houses. The demand for building lots has caused a rise in prices, although they are still remarkable cheap compared with prices of lots in other towns of less importance.

There are now about twenty-five houses in all stages of building, and many more to be completed within a year... Not only are scores of new houses being built, but the old houses are receiving attention. New rooms and porches are being added to some, some are being painted, while others are being changed into up-to-date dwellings.

Since the addition of a water works in the town, the homes may be made much more comfortable and convenient. Hot and cold water may be had with only a small additional cost. It is also possible to have our homes lighted by gas now, as the machines for making it are made in the town, and it will, no doubt, be generally used.²⁷

During the 1910s and 1920s commercial and industrial investments continued to improve Federalburg's economy and contributed to an increased population that topped 1,700 by 1930. A promotional booklet printed in 1932 recounted past history and new developments in the creek-side town and optimistic statements about the town's future were published along with pictures of a new generation of businesses, dwellings, stores, and churches. A general summary of the town's recent progress related,

Glance at the homes, the shops, the heavy, often impassable roads of the earlier period and contrast them with the present day buildings of modern construction; the streets, paved and lighted; the highways, smooth and direct; while the record of progress along civic, commercial and industrial lines is equally marked.

A large factor in this development has been the improved roads radiating in every direction and which, before such highways were common, made this town a trading

²⁷ Federalburg Souvenir Booklet [1904] "A Few Words About Our Rapid Growth in Building," n.p. Xerox copy in the Federalburg file, Caroline County Public Library, Denton, Maryland.

United States Department of the Interior
National Park Service

National Register of Historic Places Continuation Sheet

CAR-338
Federalsburg West Historic District

Name of Property

Caroline County, Maryland

County and State

Section 8 Page 10

center for a large surrounding area, resulting in a notable expansion of business prosperity.

Federalsburg, with a growing population of more than 1,700, has a business capacity equal to that of many towns double its size, drawing trade from a surrounding intensive trucking area.²⁸

Contributing to the commercial profile of Federalsburg were a number of canning companies that located in or near the town; H. B. Messenger, T. H. Chambers, E. F. Davis & W. W. R. Breeding were principal firms that operated during the early to mid 20th century.²⁹ The connection on the railroad as well as shipment by water facilitated the canning businesses as well as a host of other enterprises such as the Federalsburg Can Company and the Excelsior Pearl Works, which employed hundreds of men and women. Several principal improvements for the town during the period was the construction of a large three-story school in 1914 that supplanted a cruciform shaped frame school erected on Academy Street in the previous century. The new school was erected out of hollow terra cotta tiles covered with stucco, and it was capped by an asbestos shingle roof. It was wired with electric lights, heated by a large oil fired plant, and water was supplied by the town.

Hollow terra cotta tiles were also used in the construction of the new Federalsburg Masonic Lodge in 1919-20. The hip roofed building was covered with textured stucco and accented with Colonial Revival details.

While terra cotta blocks were used in the construction of the Federalsburg School and new Masonic Lodge, the most popular mass-produced material during the early twentieth century was rock-faced, cobble or panel-faced concrete blocks. Used throughout the business district for walls and foundations after the destructive 1898 fire, the hand-made or mass-produced blocks also were used widely for houses and accompanying outbuildings, particularly domestic garages.

During the early 20th century there were four concrete works in Federalsburg owned by Wilmer Fell Davis, J. Hall Poyner, Charles P. Wright, and O. G. Williamson. These firms advertised mass-produced concrete blocks, and other architectural materials such as cast concrete window and door sills and porch columns. Charles Wright had his initials C. W. impressed on the inside surface of the blocks, examples of which survive in the old Covey and Williams Garage, now the home of the Federalsburg Historical Society.

²⁸ J. Raymond Charles, "A Historical Souvenir of Federalsburg," n.p., 1932.

²⁹ R. Lee Burton, Jr., *Canneries of the Eastern Shore*, Centreville, Maryland: Tidewater Publishers, 1986, pp. 59-78.

United States Department of the Interior
National Park Service

National Register of Historic Places Continuation Sheet

CAR-338
Federalsburg West Historic District

Name of Property

Caroline County, Maryland

County and State

Section 8 Page 11

One of the most ambitious building projects during the 1920s and early 1930s was the construction of the Federal Theatre on North Main Street in 1930-31. Three Federalsburg businessmen, Lee Wheatley, Sam Davis, Sr., and J. E. Rosser financed construction of the impressive brick structure at the start of the Depression, and it operated continuously until the third quarter of the 20th century. Since the theater's closure it has been adapted for use by the Senior Center of Federalsburg and the Federalsburg Town Hall.

Post World War II construction continued to enlarge Federalsburg, particularly to the west along West Central, Bloomingdale, Greenridge, Maple and Academy streets. Numerous examples of post War dwellings—following popular national models such as symmetrical and asymmetrical Cape Cod style houses—line these streets, which are also intermingled with a well-represented collection of mid 20th century Ranch style houses in frame and brick construction.

Building within the district since the end of the Period of Significance has been relatively infrequent with small single-story houses, some of which are prefabricated or modular. Twenty-eight (28) resources are deemed non-contributing.

United States Department of the Interior
National Park Service

National Register of Historic Places Continuation Sheet

CAR-338
Federalsburg West Historic District

Name of Property

Caroline County, Maryland

County and State

Section 9 Page 1

Major Bibliographical References:

Burton, R. Lee, Jr. *Canneries of the Eastern Shore*, Centreville: Tidewater Publishers, 1986.

Caroline County Land Records, various volumes, Caroline County Courthouse.

Carroll, Kenneth. *Quakerism on the Eastern Shore*. Baltimore: Maryland Historical Society, 1970.

Charles, J. Raymond. *A Historical Souvenir of Federalsburg*, 1932, n.p.

Dorchester County Land Records, various volumes, Dorchester County Courthouse.

Federalsburg Souvenir Booklet, [1904], n.p. Caroline County Public Library.

Genealogical and History Files, Federalsburg Historical Society.

Graham, John L. *The 1877 Atlases and Other Early Maps of the Eastern Shore of Maryland*, Salisbury, Maryland: Wicomico Bicentennial Commission, 1976.

Hayman, John C. *Rails Along the Chesapeake: A History of Railroadng on the Delmarva Peninsula, 1827-1978*. Marvadel Publishers, 1979.

Horse, Eleanor F., *Origins of Caroline County, From Land Plats*, Volume II., Denton: Baker Printing Co., 1981.

Lewis, J. Frank. *The Maryland Directory*, Baltimore, 1878.

Archives of Maryland Online, aomol.msa.maryland.gov.

Personal Interviews with Wendy Garner, Joe Glime and Janet Bacorn, Federalsburg Historical Society.

Simpson, Pamela H. *Cheap, Quick & Easy: Imitative Architectural Materials, 1870-1930*, Knoxville: University of Tennessee Press, 1999.

Sweet's Indexed Catalogue of Building Construction, New York and Chicago: Architectural Record Co., 1906.

United States Department of the Interior
National Park Service

National Register of Historic Places Continuation Sheet

CAR-338
Federalsburg West Historic District

Name of Property

Caroline County, Maryland

County and State

Section 10 Page 1

Geographical Data:

UTM References:

- 1) 18-432463-4284795
- 2) 18-432991-4282741
- 3) 18-432201-4282434
- 4) 18-431982-4283460

Verbal Boundary Description:

Beginning at a point along the west side of the Marshyhope Creek at its junction with the north side of the railroad right-of-way for the former Maryland and Delaware Railroad at a point marked A on the accompanying district map, thence heading in a southeasterly direction for a distance of approximately 1,250' to a point marked B on the north side of the railroad right-of-way, thence in a northerly direction across Railroad Avenue on a line coincidental with Parcel 509 on accompanying map, and then by and with the back lines of Parcels, 502, 501, 500, 499, and 494, to a point marked C at the intersection with the northeast corner of parcel 494 and Academy Avenue, thence in an easterly direction by and with the south side of Academy Avenue for a distance of approximately 200' to a point marked D at the intersection of Academy Avenue and University Avenue, thence in a northerly direction by and with the west side of University Avenue for a distance of approximately 850' to a point marked E, which is the northeast corner of Parcel 81, thence in a westerly direction by and with the back lines of Parcels 81, 80, 79, 78, 77, 74, 73 to a point marked F at the northeast corner of Parcel 73 and Vesper Avenue, thence west by and with the south side of Vesper Avenue for approximately 50' to a point marked G in line with the east line of Parcel 63, thence north by and with the east lines of Parcels 63 and 48 to a point marked H a distance of approximately 300', thence in an easterly direction along the back lines of Parcels 45, 44, 40 and through Parcels 43 and 42 for a distance of approximately 300' to a point marked I, thence in a northerly direction by and with the east lines of Parcel 39 and 35 for a distance of approximately 200' crossing Bloomingdale Avenue to a point marked J, the northeast corner of Parcel 35, thence in a westerly direction along the back lines of Parcels 35, 34, 33, 32, and 31 to a point marked K, a distance of approximately 200', thence in a northerly direction along the east line of Parcel 29 in a straight course to a point marked L, a distance of approximately 300', to a point marked L, which is coincidental with the northern boundary of the town of Federalsburg, thence by and with the boundary line as well as the north line of Parcels

United States Department of the Interior
National Park Service

National Register of Historic Places Continuation Sheet

CAR-338
Federalsburg West Historic District

Name of Property

Caroline County, Maryland

County and State

Section 10 Page 2

17 and 1125 and 1124 to a point marked M, a distance of approximately 500', thence in a northerly course in a straight line coincidental with the back lines of Parcels 450, 374, 375, 376, 377, 378, 379, 380, 381, 383, 384 and 385 as indicated on accompanying map to a point on the south side of Idlewild Road marked N, a distance of approximately 950', thence in a westerly course along the south side of Idlewild Road and crossing Denton Road on a line even with the north line of Parcel 358 as indicated on said map for a distance of approximately 150' to a point marked O, thence in a southerly course along the back lines of Parcels 358, 357, 356, 355, 354, 353, 352, 350, 349, 348, 347, 346 and 344 for a distance of approximately 1200' to a point marked P on the east side of Marshyhope Creek, thence in a straight line across said creek to a Point marked P-1 on the west side of said watercourse, thence in a southerly direction by and with the west side of the Marshyhope Creek for a distance of approximately 1300' to a point marked Q, which is coincidental with the north side of East Central Avenue, thence in a westerly direction by and with the north side of East Central Avenue for a distance of approximately 125' to a point marked R on said map, thence in a southerly direction across said East Central Avenue in line with the west line of Parcel 707 to a point marked S, a distance of approximately 75', thence in an easterly direction along the back lines of Parcels 707 and 704 to a point on the west side of the Marshyhope Creek marked T, a distance of approximately 125', thence in a southerly direction by and with the west side of the Marshyhope Creek for a distance of approximately 700' to the place of beginning marked A, the said boundary encompassing approximately 275 acres more or less.

Boundary Justification:

The boundary for the Federalsburg West Historic District makes use of natural and man-made features of the landscape to frame the concentrations of historic resources that define the district; on the east side of the district the boundary follows the course of the Marshyhope Creek, on the south side the boundary follows a parallel line along the course of the former Maryland and Delaware Railroad right-of-way. The eastern boundary, for the most part, has been drawn along the course of University Avenue, and the boundary on the northeast follows along property lines separating concentrations of contributing resources included in the district from adjacent areas that are not substantially reflective of the nature of the district.

United States Department of the Interior
National Park Service

National Register of Historic Places Continuation Sheet

CAR-338
Federalburg West Historic District
Name of Property

Caroline County, Maryland
County and State

Section 10 Page 3

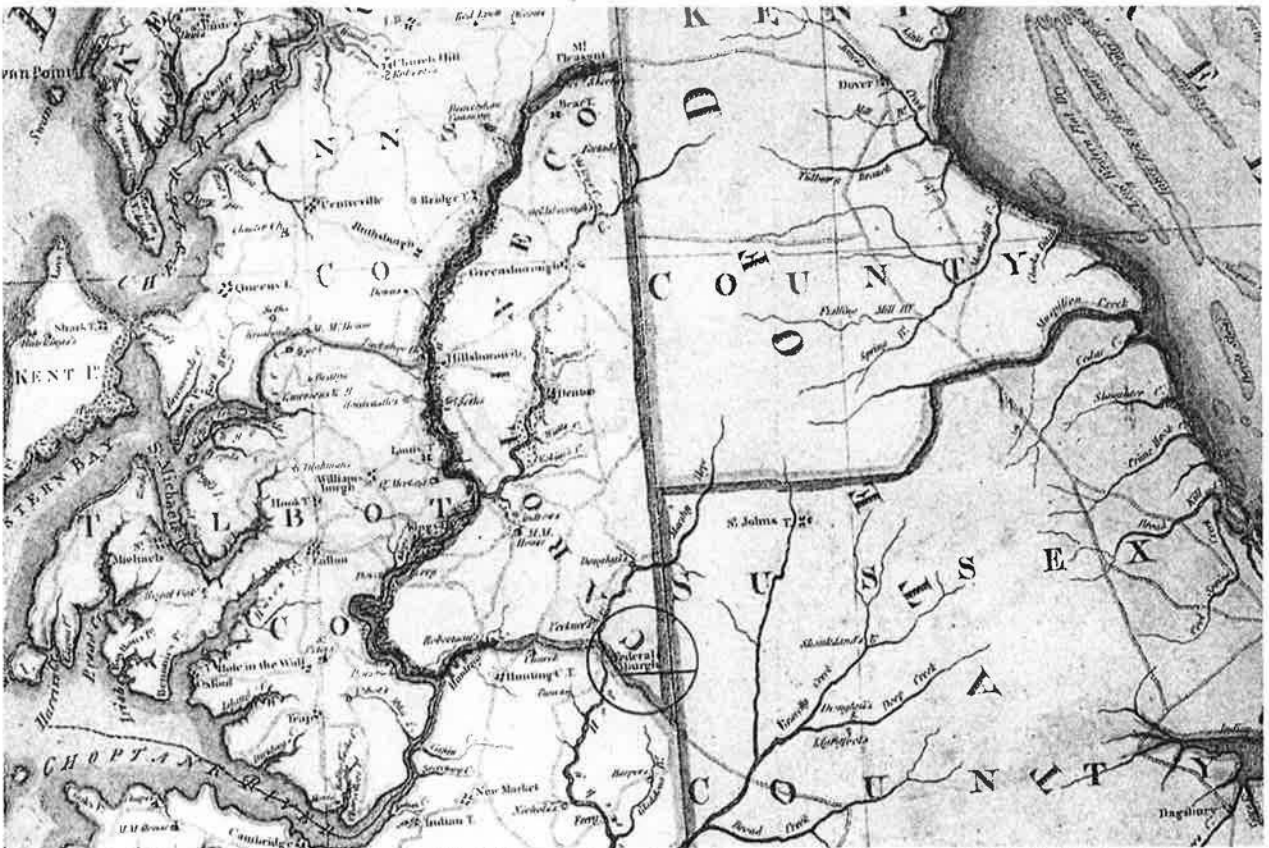

Dennis Griffith, *Map of Maryland*, 1794 [1795], Maryland State Law Library, MdHR G 1213-356, This is the first cartographic mention of Federalburg.

United States Department of the Interior
National Park Service

National Register of Historic Places Continuation Sheet

CAR-338
Federalsburg West Historic District
Name of Property

Caroline County, Maryland
County and State

Section 10 Page 4

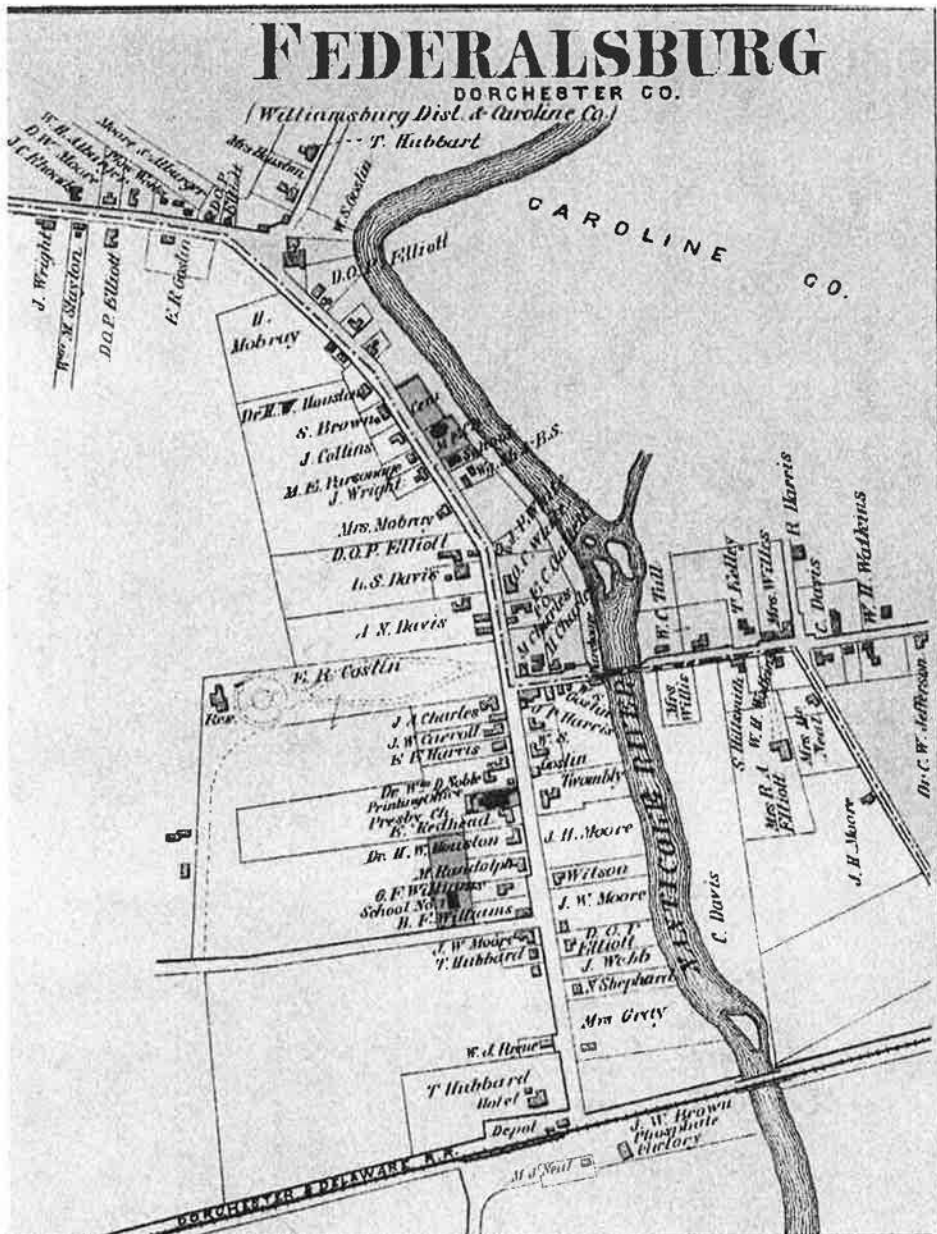

Federalsburg, Lake, Griffing, and Stevenson Atlas, 1877, The town was still divided between Caroline and Dorchester counties.

United States Department of the Interior
National Park Service

National Register of Historic Places Continuation Sheet

CAR-338
Federalburg West Historic District
Name of Property

Section 10 Page 5

Caroline County, Maryland
County and State



Federalburg, Aerial view, c. 1930, *A Historical Souvenir of Federalburg*, Stowell Printing, 1932.

FEDERLSBURG WEST H.D.
CAROLINE COUNTY, MARYLAND
PHOTOGRAPH LOCATION MAP

NUMBERS CORRESPOND TO SEQUENTIAL NUMBERS ON PRINTS

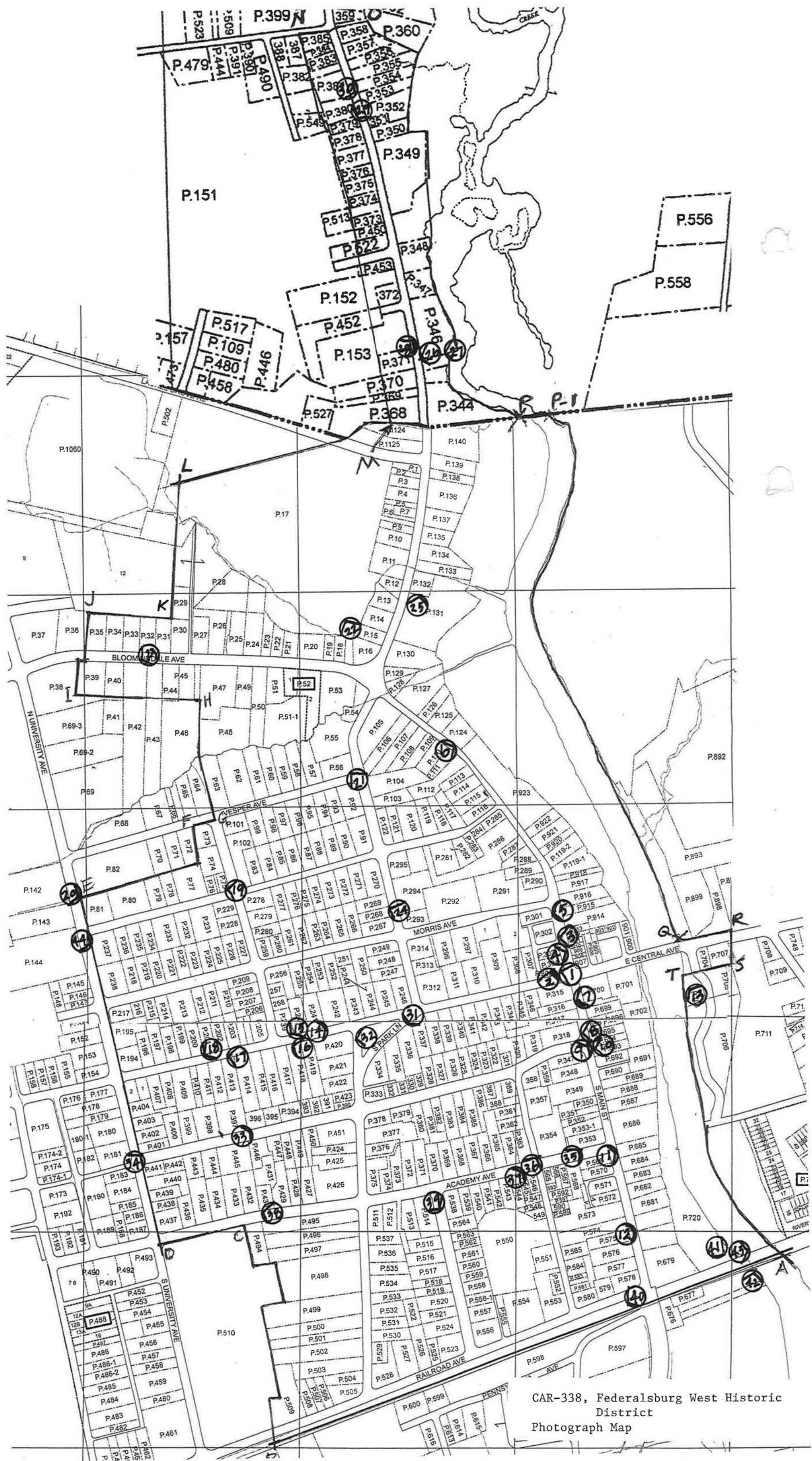

CAR-338, Federalsburg West Historic District
Photograph Map



CAR-338, Federalsburg West Historic District
Boundary Map

FEDERALSBURG WEST H.D.
CAROLINE COUNTY, MARYLAND
NATIONAL REGISTER BOUNDARY MAP

LETTERS CORRESPOND TO POINTS MENTIONED IN VERBAL BOUNDARY DESCRIPTION

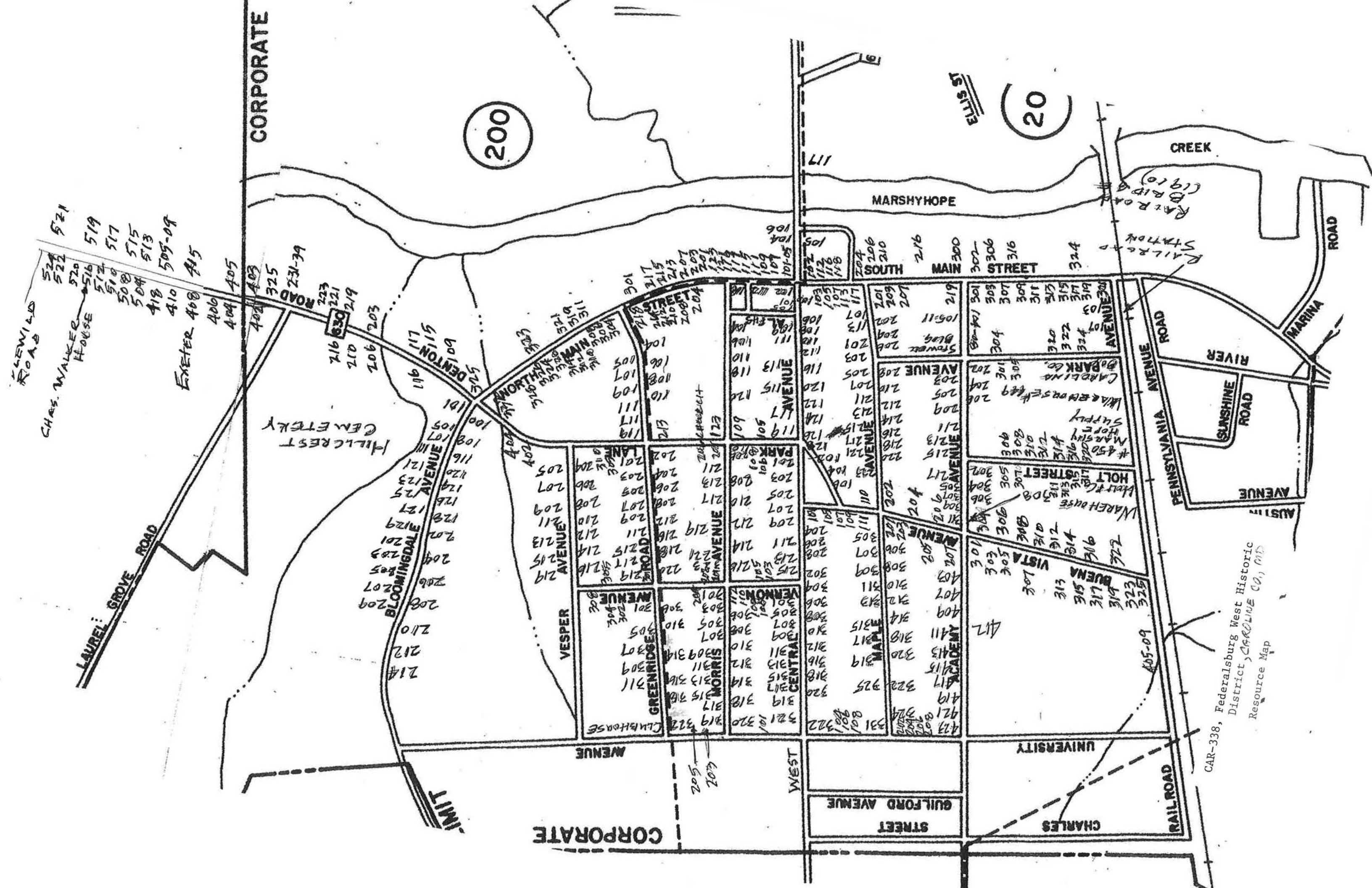

CAR-338, Federalsburg West Historic District, CAROLINE CO., MD. Resource Map

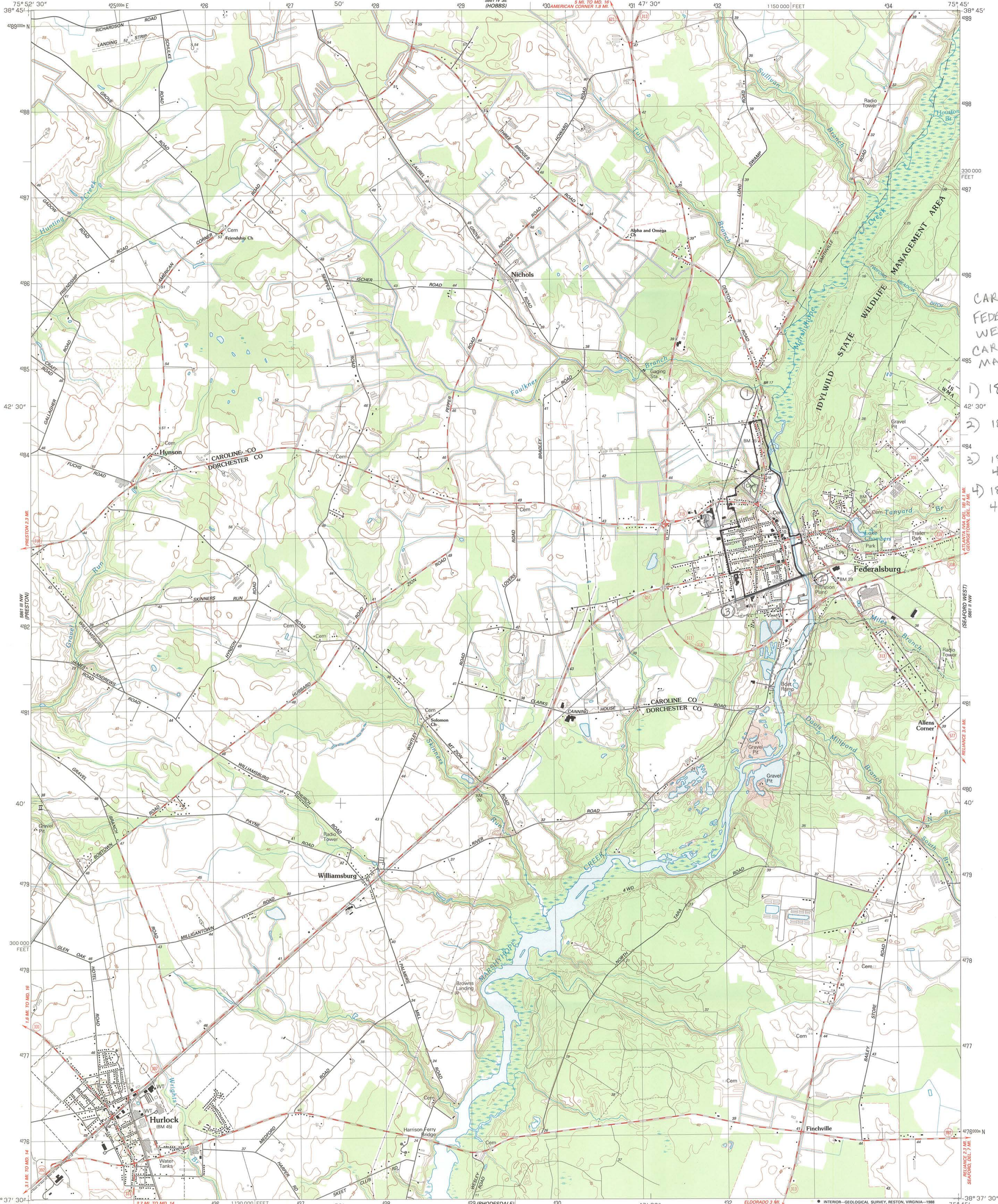

CAR-338
FEDERALSBURG
WEST H.D.
CAROLINE CO.,
MARYLAND

- 1) 18-432463-4284795
- 2) 18-432991-4282791
- 3) 18-432201-4282434
- 4) 18-431982-4283460

Produced by the United States Geological Survey

Control by USGS and NOS/NOAA
Topography by photogrammetric methods from aerial photographs taken 1980. Field checked 1982. Map edited 1988
Supersedes Army Map Service map dated 1974
Projection and 10,000-foot grid ticks: Maryland coordinate system (Lambert conformal conic)
1000-meter Universal Transverse Mercator grid, zone 18
1927 North American Datum
To place on the predicted North American Datum 1983, move the projection lines 8 meters south and 30 meters west as shown by dashed corner ticks
There may be private inholdings within the boundaries of the National or State reservations shown on this map
Fine red dashed lines indicate selected fence and field lines where generally visible on aerial photographs. This information is unchecked

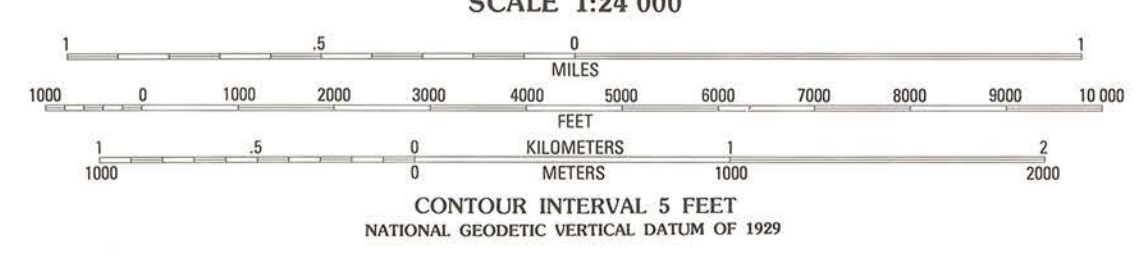
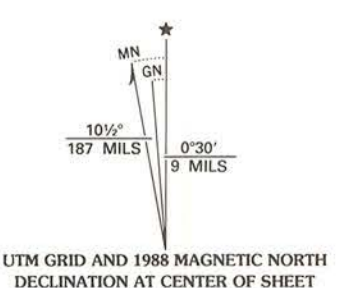

ROAD CLASSIFICATION

Primary highway, hard surface	Light-duty road, hard or improved surface
Secondary highway, hard surface	Unimproved road
Interstate Route	U. S. Route
	State Route



THIS MAP COMPLIES WITH NATIONAL MAP ACCURACY STANDARDS
FOR SALE BY U. S. GEOLOGICAL SURVEY, DENVER, COLORADO 80225, OR RESTON, VIRGINIA 22092
A FOLDER DESCRIBING TOPOGRAPHIC MAPS AND SYMBOLS IS AVAILABLE ON REQUEST

FEDERALSBURG, MD.
38075-F7-TF-024
1988
DMA 5861 III NE-SERIES V833









101





Christ United Methodist Church

CHRIST UNITED
METHODIST CHURCH
105 S. 4th
WISCONSIN 53081
PASTOR JAMES BOYD



A two-story house with brown shingled siding and a dark grey shingled roof. The house features a prominent brick chimney on the right side. The front facade has a central green door with a decorative pediment and shutters, flanked by two windows. The second floor has three windows. The house is set on a green lawn with trees in the background.

A large, leafy tree with green foliage, partially obscuring the left side of the house. The tree's branches extend across the top left of the frame.

A dense line of green trees in the background, behind the house, under a cloudy sky.

A portion of a smaller, single-story building with light-colored siding and a brick base, visible on the right edge of the image.



513

5402











GREENRIDGE RD



HILL CREST CEMETERY

ONE WAY
→





Main ST

Central Ave



SPEED LIMIT 25

102









1760

1760
05282



E&N HAIR DESIGNS
443-359-3485

TURNING HEADS
HAIR SALON
410-754-5044

103



TOWN HALL

Mayor &
Council

Senior
Center







MARYLAND & DELAWARE
RAILROAD



BUILT BY
THE PENNSYLVANIA
STEEL CO.
STEELTON PA.
1910.







A two-story house with green horizontal siding and a grey shingled roof. The house features a prominent front porch with white columns and a white railing. A utility pole stands in the foreground, partially obscuring the house. To the left, a portion of a red brick building is visible. The house has several windows, including a small dormer window in the gable and a bay window on the second floor. The house is situated on a grassy lot with a sidewalk and a street in the foreground.

A portion of a red brick building is visible on the left side of the image. It has a dark red facade and a grey shingled roof. A satellite dish is mounted on the roof. The building appears to be older and somewhat weathered.

A utility pole stands in the foreground, partially obscuring the house. It has several wires attached to it and a small antenna on top. The pole is made of wood and has a metal cross-arm.

A small antenna is mounted on the roof of the house. It has a central vertical pole and several horizontal arms extending outwards.

A large, leafy tree is visible on the right side of the image. It has a dense canopy of green leaves and a thick trunk. The tree is situated behind the house and partially obscures the background.

A sidewalk and a street are visible in the foreground. The sidewalk is made of concrete and runs along the edge of the property. The street is paved with asphalt and has a curb on the left side.



長城 GREAT WALL RESTAURANT
CHINESE FOOD EAT IN & TAKE OUT TEL: 754-8816

MAPLE

SOUTH MAIN





MAPLE AVE
SOUTH

RAIN BIN

OPEN

HUB
ANTIQUE







J. W. STOWELL

PRINTING CO.

1939



















UNITED STATES DEPARTMENT OF THE INTERIOR
NATIONAL PARK SERVICE

NATIONAL REGISTER OF HISTORIC PLACES
EVALUATION/RETURN SHEET

REQUESTED ACTION: NOMINATION

PROPERTY NAME: Federalsburg West Historic District

MULTIPLE NAME:

STATE & COUNTY: MARYLAND, Caroline

DATE RECEIVED: 4/01/2016
DATE OF 16TH DAY: 05/06/2016
DATE OF WEEKLY LIST:

DATE OF PENDING LIST: 4/21/2016
DATE OF 45TH DAY: 05/17/2016

REFERENCE NUMBER: 16000250

Appeal: N Data Problem: N Landscape: N Less than 50 Years: N
Other: N PDIL: N Period: N Program Unapproved: N
Request: N Sample: N SLR Draft: N National: N

Comment Waiver: N

ACCEPT RETURN REJECT 5/12/2016 DATE

ABSTRACT/SUMMARY COMMENTS:

RECOM./CRITERIA Accept C

REVIEWER Patricia Andrews Discipline Historian

DATE 5/12/2016

DOCUMENTATION see attached comments Y/N see attached SLR Y/N

If a nomination is returned to the nominating authority, the nomination is no longer under consideration by the NPS



Maryland Department of Planning
Maryland Historical Trust

Larry Hogan, Governor
Boyd Rutherford, Lt. Governor

David R. Craig, Secretary
Wendi W. Peters, Deputy Secretary

RECEIVED 2280

APR 01 2016

Nat. Register of Historic Places
National Park Service

March 29, 2016

Mr. J. Paul Loether, Chief
National Register of Historic Places
National Park Service
1201 I (Eye) Street, N.W.
2280
Washington, D.C. 20005

RE: Federalsburg West Historic District (CAR-338)
Caroline County, MD

Dear Paul:

Enclosed is documentation for nominating the Federalsburg West Historic District, Caroline County, Maryland to the National Register of Historic Places. No objections were received from property owners. The state review board concurs in my recommendation for listing. Should you have questions in this matter, please contact Peter Kurtze at (410) 514-7649.

Sincerely,

Elizabeth Hughes
Director-State Historic
Preservation Officer

EH/pek

Encl.: NR form, maps
Photographs/DVD
legal notice

1/30/15

The Berea-Biddle Street Historic District in Baltimore City was listed in the National Register of Historic Places on December 29, 2014.

The Brewers Hill Historic District in Baltimore City was listed in the National Register of Historic Places on December 22, 2014.

The Auchentoroly Terrace Historic District, roughly bounded by Liberty Heights Ave., Reisterstown Rd., Fulton Ave. and Auchentoroly Terrace in the city of Baltimore;

The Edmondson Village Historic District, roughly bounded by U. S. Route 40, N. Woodington Rd., Kevin Rd., Seminole Ave., Stokes Dr., Allendale St., Geiston Dr. and N. Hilton St. in the city of Baltimore;

The Midtown Edmondson Historic District, roughly bounded by Fulton Ave., U.S. Route 40, N. Bentalou St. and the Northeast Corridor (NEC) railway line in the city of Baltimore;

The McDonogh Place Historic District, roughly bounded by N. Broadway, E. Eager St., McDonogh St., and E. Chase St. in the city of Baltimore; and

The **Federalsburg West Historic District**, roughly bounded by Marshyhope Creek, Railroad Ave., University Ave., Bloomingdale Ave., and extending along Denton Rd. to Illewild Rd. in the town of Federalsburg, Caroline County, will be considered by the Governor's Consulting Committee for nomination to the National Register of Historic Places on Tuesday, March 3, 2015.

The National Register is the official list of historic properties recognized by the Federal government for their significance in American history, architecture, archaeology, engineering, and culture. In Maryland, the nomination process is administered by the Maryland Historical Trust. The meeting will be held at 100 Community Place, Room 3 606, Crownsville, MD 21032, beginning at 10:00 a.m. Interested parties are welcome to attend this meeting.

Listing in the National Register results in the following for historic properties:

1. **Consideration in planning for Federal, federally or state funded, licensed and assisted projects.** Federal and state legislation requires that Federal agencies allow the Advisory Council on Historic Preservation and state agencies, including the Maryland Historical Trust, opportunity to comment on all projects affecting historic properties listed in the National Register. For further information please refer to Section 36, Code of Federal Regulations, Part 800 and State Finance and Procurement Article, Section 5A-323 et seq, or call the Office of Preservation Services of the Maryland Historical Trust at (410) 514-7630.

2. **Eligibility for Federal tax provisions.** If a property is listed in the National Register, certain Federal tax provisions may apply. The Tax Reform Act of 1986 revises the historic preservation tax incentives authorized by Congress in the Tax Reform Act of 1976, the Revenue Act of 1978, the Tax Treatment Extension Act of 1980, the Economic Recovery Tax Act of 1981, and the Tax Reform Act of 1984, and as of January 1, 1987, provides for a 20 percent investment tax credit with a full adjustment to basis for rehabilitating historic commercial, industrial, and rental residential buildings. The former 15 percent and 20 percent Investment Tax Credits (ITCs) for rehabilitation of older commercial buildings are combined into a single 10 percent ITC for commercial or industrial buildings built before 1936.

The Tax Treatment Extension Act of 1980 provides Federal tax deductions for charitable contributions for conservation purposes of partial interests in historically important land areas or structures. Whether these provisions are advantageous to a property owner is dependent upon the particular circumstances of the property and the owner. Because tax aspects outlined above are complex, individuals should consult legal counsel or the appropriate local Internal Revenue Service office for assistance in determining the tax consequences of the above provisions. For further information on certification requirements, please refer to 36 CFR 67 or contact the Office of Preservation Services of the Maryland Historical Trust at (410) 514-7628.

3. **Eligibility for a Maryland income tax credit for the rehabilitation of historic structures.** For further information on the Maryland Sustainable Communities Rehabilitation Tax Credit program, contact the Office of Preservation Services of the Maryland Historical Trust at (410) 514-7628 or visit mht.maryland.gov/taxCredits.shtml.

4. **Consideration of historic values in the decision to issue a surface coal mining permit where coal is located.** In accord with the Surface Mining Control and Reclamation Act of 1977, there must be consideration of historic values in the decision to issue a surface coal mining permit where coal is located. For further information, please refer to 30 CFR 700 et seq.

5. **Eligibility to apply for federal and state grants and state low interest loans for historic preservation projects.** To determine the present status of such grants and loans, contact the Office of Preservation Services of the Maryland Historical Trust at (410) 514-7628.

Owners of private properties nominated to the National Register have an opportunity to concur in or object to listing in accord with the National Historic Preservation Act and 36 CFR 60. Any owner or partial owner of private property who chooses to object to listing may submit to the State Historic Preservation Officer a notarized statement certifying that the party is the sole or partial owner of the private property and objects to the listing. Each owner or partial owner of private property has one vote regardless of what portion of the property that party owns. If a majority of private property owners object, a property will not be listed; however, the State Historic Preservation Officer shall submit the nomination to the Keeper of the National Register of Historic Places for a determination of eligibility of the property for listing in the National Register. If the property is determined to be eligible for listing, although not formally listed, Federal agencies will be required to allow the Advisory Council on Historic Preservation and state agencies, including the Maryland Historical Trust, an opportunity to comment before the agency may fund, license, or assist a project which will affect the property. If you choose to object to the listing of your property, the **notarized objection** must be submitted to Elizabeth Hughes, Acting State Historic Preservation Officer, ATTN: Peter Kurtze, Maryland Historical Trust, 100 Community Place, Crownsville, Maryland 21032-2023 by the date of the meeting given above.

Listing in the National Register does NOT mean that the Federal Government or the State of Maryland wants to acquire the property, place restrictions on the property, or dictate the color or materials used on individual buildings. Local ordinances or laws establishing restrictive zoning, special design review committees, or review of exterior alterations are not a part of the National Register program. Listing also does NOT require the owner to preserve or maintain the property or seek approval of the Federal Government or the State of Maryland to alter the property. Unless the owner applies for and accepts special Federal or state tax, licensing, or funding benefits, the owner can do anything with his property he wishes so long as it is permitted by state or local law.

If you wish to comment on whether the property should be nominated to the National Register, please send your comments to Elizabeth Hughes, Acting State Historic Preservation Officer, ATTN: Peter E. Kurtze, before the Governor's Consulting Committee considers the nomination. A copy of the nomination, regulations and information on the National Register and Federal and State tax provisions are available from the Trust. If you have questions about this nomination please contact Peter E.