

ARCHITECTURAL/HISTORICAL SURVEY

DAVENPORT, IOWA

The Architects Office
 Wehner, Nowysz, Pottschiull and Pfiffner
 801 day building Iowa city, Iowa 52240

DAVENPORT COMMUNITY DEVELOPMENT DEPARTMENT
 IOWA DIVISION OF HISTORIC PRESERVATION

SITE # 82-10- 6 E414 MAP # 4

HIST. DIST. _____

NAME Warner Apartment Building (H) C

ADDRESS 414-16 E. 6th St,

LEGAL DES. LeClaire's 5th 70 2 of Lot 3 & E 14"
SUB-DIVISION BLOCK PARCEL SUB-PARCEL

UTM 2 15 7102184.01 14519918.00 ACREAGE -1 ZONE R-6M
EASTING NORTHING

OWNER Mason + Betty Sherer
822 11th St. Detroit, MI 48242 (Contract)

TITLE H. Galen R. Price & Wife
(IF DIFF) 2524 Forrest Road
Davenport, Ia 52803

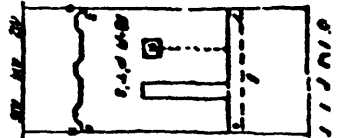
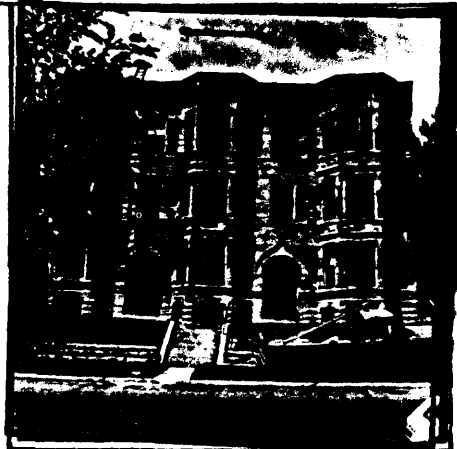

SITE SHEET

DESCRIPTION

FORM 3 story apartment block CONST DATE 1900
 MATERIAL Brick, stone ARCH STYLE Tudor Revival/Jacobethan
 FENESTRATION Rectangular 1/1 sash
 DIST. FEATURES See below
 ALTERATIONS _____
 SITE & RELATED STR. Raised lot, low stone retaining wall

STATEMENT

This handsome apartment block must be counted among the most distinguished in Davenport. Designed in a picturesque Tudor mode, the building displays round-arched entrances beneath ogee-arched moldings and a deep corbelled cornice frieze. The 5-part main facade is articulated by three-full height polygonal bays and banded with both flat and projecting string courses.

ARCHITECTURE

SOURCES

SIGNIFICANCE

HISTORY

DESCRIPTION

Dr. Fay L. Warner, a local dentist, built this apartment building in 1900 and resided here until 1908. Fred Warner, a relative, later managed and building and resided here.

SOURCES

City Directories, 1898-99, 1900-01, 1900, 1902-03, 1906-07, 1908, 1909, 1910.

ARCHITECTURAL HISTORIAN: Martha Bowers | HISTORIAN: MARLYS SVENDSEN - ROESLER | SURVEY COMR 1981

EVALUATION

ARCHITECTURAL

- I. ARCH. EVALUATION: Excellent
- II. ENVIR. STATURE: Incident
- III. INT. OF CONTEXT: Good
- IV. INT. OF FABRIC: Excellent

LEVEL OF SIGNIFICANCE:

- NAT. STATE LOCAL N. ELIG.

HISTORICAL

I. THEME(S) OF SIGNIFICANCE:

- A. PRIMARY _____
- B. SECONDARY _____

II. LEVEL OF SIGNIFICANCE:

- NAT. STATE LOCAL

III. N.R.H.P.

- ELIGIBLE NOT ELIGIBLE

HISTORIC DISTRICT CLASSIFICATION

- A. B. C.

FOR DIVISION OF HISTORIC PRESERVATION USE ONLY

1. DATE RECEIVED _____

2. DATE OF STAFF EVALUATION _____

- | | | |
|---------------------------|--------------------------|--------------------------|
| | A. ARCHITECTURAL | B. HISTORICAL |
| ELIGIBLE FOR N.R.H.P. | <input type="checkbox"/> | <input type="checkbox"/> |
| NOT ELIGIBLE FOR N.R.H.P. | <input type="checkbox"/> | <input type="checkbox"/> |

3. N.R.H.P. ACTION

- A. STATE REVIEW COMM. APP. DISAPP. TABLED DATE _____
- B. FEDERAL REVIEW APP. DISAPP. TABLED DATE _____

4. D.H.P. SOURCES

- COUNTY RESOURCES
- W'SHIELD SURVEY
- N.R.H.P.
- GRANT _____

- DET. OF ELIGIBILITY
- R. & C. _____
- DAVENPORT A/H SURVEY
- _____
- _____

5. SUBJECT TRACES

6. PHOTO

82-10-1691, 3

