

Iowa Site Inventory

Office of Historic Preservation
Iowa State Historical Department
East 12th & Grand Avenue
Des Moines, Iowa 50319

Site Number 70
District Name _____
Map Reference # 70

Identification

- Site Name Polygonal Barn, New Oregon Twp., Howard County
- Village/Town/City Cresco Township New Oregon County Howard
- Street Address Off Iowa Highway 39
- Legal Location 97 N 11 W 15
Urban: subdivision block range parcel section subparcel
Rural: township % section of 1/4 section
- UTM Location: zone 15 easting 570,870 northing 4,786,020; Acreage less than one acre
- Owner(s) Name Art C. Pecinovsky
- Owner(s) Address R. R. #4 Box 168 Cresco Iowa 52136
(Street address) (City) (State) (Zip)
- Use: Present Pig and feeder cattle barn Original Show barn for English Short Horn Cattle

Description

- Date of Construction 1920 Architect/Builder Horkey and Andra
- Building Type: (Owner says c. 1900)
 single-family dwelling industrial other institutional religious
 multiple-family dwelling educational public agricultural
 commercial
- Exterior Walls: clapboard stone brick board and batten shingles stucco
 other vertical sawed wood.
- Structural System: wood frame with interlocking joints wood frame with light members (balloon frame)
 masonry load-bearing walls iron frame steel frame with curtain walls reinforced concrete
 other _____
- Condition: excellent good fair deteriorated
- Integrity: original site moved—if so, when? _____
 Notes on alterations, additions (with dates and architect, if known) and any other notable features of building and site:
See reverse side.
- Related Outbuildings and Property: barn other farm structures carriage house garage privy
 other _____
- Is the building endangered? no yes—if so, why? _____
- Surroundings of the building: open land woodland scattered outbuildings densely built-up commercial
 industrial residential other _____

18. Map

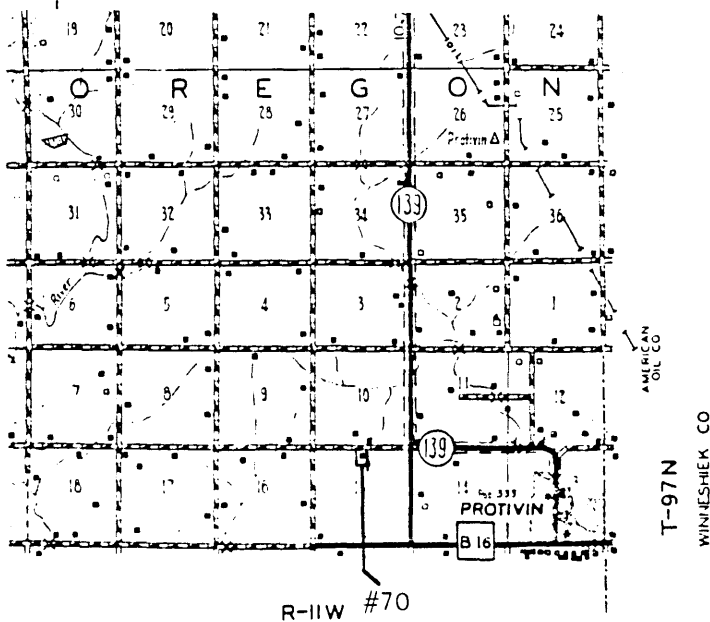

19. Photo

Roll 476 Frame 2 View _____

VBD: A circle 90' in diameter, based on center point of barn, includes barn and attached shed addition.

MAY 27 1986

Significance

(Indicate sources of information for all statements)

20. Architectural significance

- a. Key structure/individually may qualify for the National Register
- b. Contributing structure
- c. Not eligible/intrusion

N/A

Circular interior. 16 - sided with diameter 70'. Central cement silo with 13' diameter. Gambrel, 16 - section roof. Stone foundation. Metal roof. Used for dairying 1958 - 1968, then pigs and feeder cattle.

21. Historical Significance

Theme(s) Common Variation; Polygonal type.

- a. Key structure individually may qualify for the National Register
- b. Contributing structure
- c. Not eligible/intrusion

The most common of the common variations of the round barn built in Iowa was the polygonal barn of 6 to 16 equal sides. Barns of this type dating from the peak years for construction of round barns, 1910-1920, are generally modeled after the true-round Illinois Agricultural Experiment Station / H.E. Crouch prototypes. Characteristic of the polygonal type, this sixteen-sided example has a central silo and self-supporting single hip gambrel roof of sixteen equal sections. This barn's heavy timber construction with interlocking joints is an exception to the ideal.

22. Sources (for primary and secondary sources, give complete facts of publication: author, title, place of publication, date, etc.):

Art C. Pecinovsky, RR 4, Cresco, IA 52136

Soike, Lowell J. Without Right Angles. Des Moines, Iowa: Iowa State Historical Department, Office of Historic Preservation, 1983.

Prepared by _____ Date _____

Address _____ Telephone _____

Organization _____

For Office of Historic Preservation Use Only

1. Office Information Sources on this Property

- County Resource File
- Windshield Survey
- National Register
- Grants-In-Aid: _____
- Determination of Eligibility

Review and Compliance Project:

- Other _____
- Other _____
- Other _____

2. Subject Traces

- a. _____
- b. _____
- c. _____
- d. _____
- e. _____

3. Photo Images _____

- _____
- _____
- _____
- _____
- _____