

**FORM B - BUILDING**

AREA	FORM NO.
	323

MASSACHUSETTS HISTORICAL COMMISSION  
80 BOYLSTON STREET, BOSTON, MA 02116

-----

PHOTO: (3x3" or 3x5", black & white)  
staple to left side of form

Photo number \_\_\_\_\_

-----

**SKETCH MAP**

Show property's location in relation to nearest cross streets and/or geographical features. Indicate all buildings between inventoried property and nearest intersection. Indicate north.

Town North Adams MRA

Address 521 West Main Street

Historic Name Sykes House

Use: Present residence

Original residence

**DESCRIPTION:**

Date ca. 1890

Source City directories; 1894 Atlas

Style Queen Anne

Architect Porter & Hannum, builder

Exterior wall fabric clapboard

Outbuildings none

Major alterations (with dates) Two-  
story sleeping porches added on east  
side ca. 1920.

Moved no Date N/A

Approx. acreage less than one acre

Setting The house sets on a large lot on  
a nineteenth-century residential street.  
Known as Braytonville, this neighborhood  
also contains the nineteenth-century mill  
after which it was named.

Recorded by Betsy Friedberg

Organization Mass. Historical Commission

Date July, 1985

Williamstown Quadrangle

UTM Reference: 18/652920/4728840

(Staple additional sheets here)

**ARCHITECTURAL SIGNIFICANCE** (Describe important architectural features and  
evaluate in terms of other buildings within the community.)

The Thomas Sykes House is architecturally distinguished as an intact example of the Queen Anne style. It was constructed by Porter & Hannum, one of the leading building firms in North Adams. The design for the house, which may have originated either in a mail-order catalogue or with Porter & Hannum, is atypical of Queen Anne-style architecture in North Adams. The massing and plan is more compact with fewer projecting gable ends than is commonly found even on smaller lots. The small porch has turned posts and decorative grillework. Above each window the lintels have incised designs in a floral pattern, and the chimney is paneled and ornamented with terracotta designs.

**HISTORICAL SIGNIFICANCE** (Explain the role owners played in local or state history and how the building relates to the development of the community.)

This house was originally the home of Thomas Sykes, the superintendent of the North Adams Manufacturing Company. Thomas Sykes started his career in dyeing and woolen manufacturing in Cavendish, Vermont. In 1867, he came to North Adams, where he remained for three years working in several woolen mills. He then went on to important positions in Great Barrington mills and returned to North Adams in 1873, as the superintendent of the North Adams Manufacturing Company. For over 25 years he gave devoted service to the company and was thought of as one of the best citizens of his community.

Sykes located his house in Braytonville near the mill where he worked. By locating near his place of employment rather than in the more fashionable neighborhood of Church St. at Cady Hill, Sykes departed from the usual practice of the city's wealthier citizens. He may, however, have been anticipating the growth of a new suburban development to the south of West Main Street. That area grew slowly in the early part of this century.

**BIBLIOGRAPHY and/or REFERENCES** (name of publication, author, date and publisher)

North Adams Directories for 1889-90, 1893

Atlas of the Towns of Adams, No. Adams & Williamstown, D.L. Miller, N. Adams, 1894

North Adams and Vicinity, H.G. Rowe, No. Adams, 1898

INVENTORY FORM CONTINUATION SHEET

MASSACHUSETTS HISTORICAL COMMISSION  
Office of the Secretary, Boston

Community: North Adams	Form No: 323
Property Name: Sykes House	

Indicate each item on inventory form which is being continued below.

Criteria for Evaluation

The Thomas Sykes House retains integrity of setting, design, location, material, workmanship, feeling, and association. The building is a stylish, yet compact, example of the Queen Anne style. With associations with North Adams' thriving mid 19th century industrial past (the home of a mill superintendent located close to his place of employment), the structure fulfills Criteria A and C of the National Register of Historic Places.

Staple to Inventory form at bottom

United States Department of the Interior  
National Park Service

National Register of Historic Places  
Inventory—Nomination Form

For NPS use only  
received 9/12/85  
date entered \_\_\_\_\_

Continuation sheet Item number Page 2 of 2

Multiple Resource Area  
Thematic Group

Name North Adams MRA  
State Bershire County, MASSACHUSETTS

Nomination/Type of Review

Date/Signature

11. Hathaway Tenement

Entered in the  
National Register

*for* Keeper

*Delores Byrum* 10/25/85

Attest \_\_\_\_\_

12. Johnson School

Entered in the  
National Register

*for* Keeper

*Delores Byrum* 10/25/85

Attest \_\_\_\_\_

13. Johnson Manufacturing  
Company

Entered in the  
National Register

*for* Keeper

*Delores Byrum* 10/25/85

Attest \_\_\_\_\_

14. Norad Mill

Entered in the  
National Register

*for* Keeper

*Delores Byrum* 10/25/85

Attest \_\_\_\_\_

15. Sherman, William B.,  
Farm

Entered in the  
National Register

*for* Keeper

*Delores Byrum* 10/25/85

Attest \_\_\_\_\_

16. Sykes House

Entered in the  
National Register

*for* Keeper

*Delores Byrum* 10/25/85

Attest \_\_\_\_\_

17. Wells House

Entered in the  
National Register

*for* Keeper

*Delores Byrum* 10/25/85

Attest \_\_\_\_\_

18. Phelps House

*S. Review*

Keeper

Attest \_\_\_\_\_

19.

Keeper

Attest \_\_\_\_\_

20.

Keeper

Attest \_\_\_\_\_

85003420

NATIONAL REGISTER OF HISTORIC PLACES  
EVALUATION/RETURN SHEET

Sykes House (North Adams MRA)  
Bershire County  
MASSACHUSETTS

Working No. SEP 17 1985  
Fed. Reg. Date: 3/3/87  
Date Due: 10/10/85 10/27/85  
Action:  ACCEPT 10-25-85  
 RETURN  
 REJECT  
Federal Agency: \_\_\_\_\_

Entered in the  
National Register

- resubmission
- nomination by person or local government
- owner objection
- appeal

Substantive Review:  sample  request  appeal  NR decision

Reviewer's comments:

Recom./Criteria \_\_\_\_\_  
Reviewer \_\_\_\_\_  
Discipline \_\_\_\_\_  
Date \_\_\_\_\_  
\_\_\_\_\_ see continuation sheet

Nomination returned for: \_\_\_\_\_ technical corrections cited below  
\_\_\_\_\_ substantive reasons discussed below

1. Name

2. Location

3. Classification

Category	Ownership Public Acquisition	Status Accessible	Present Use
----------	---------------------------------	----------------------	-------------

4. Owner of Property

5. Location of Legal Description

6. Representation in Existing Surveys

Has this property been determined eligible?  yes  no

7. Description

Condition  excellent  good  fair  deteriorated  ruins  unexposed

Check one  unaltered  altered

Check one  original site  moved date \_\_\_\_\_

Describe the present and original (if known) physical appearance

- summary paragraph
- completeness
- clarity
- alterations/integrity
- dates
- boundary selection

---

**8. Significance**

Period \_\_\_\_\_ Areas of Significance—Check and justify below

Specific dates \_\_\_\_\_ Builder/Architect \_\_\_\_\_  
Statement of Significance (*in one paragraph*)

- summary paragraph
- completeness
- clarity
- applicable criteria
- justification of areas checked
- relating significance to the resource
- context
- relationship of integrity to significance
- justification of exception
- other

---

**9. Major Bibliographical References**

---

**10. Geographical Data**

Acreage of nominated property \_\_\_\_\_  
Quadrangle name \_\_\_\_\_  
UTM References \_\_\_\_\_

Verbal boundary description and justification \_\_\_\_\_

---

**11. Form Prepared By**

---

**12. State Historic Preservation Officer Certification**

The evaluated significance of this property within the state is:

\_\_\_\_ national      \_\_\_\_ state      \_\_\_\_ local

State Historic Preservation Officer signature

title \_\_\_\_\_ date \_\_\_\_\_

---

**13. Other**

- Maps
- Photographs
- Other

Questions concerning this nomination may be directed to \_\_\_\_\_

Signed \_\_\_\_\_ Date \_\_\_\_\_ Phone: \_\_\_\_\_



Sykes House  
521 West Main St.  
North Adams, <sup>MA</sup> Mass.  
Southeast view.  
Photo by R.Reed, 1983.  
Negative at NAHC

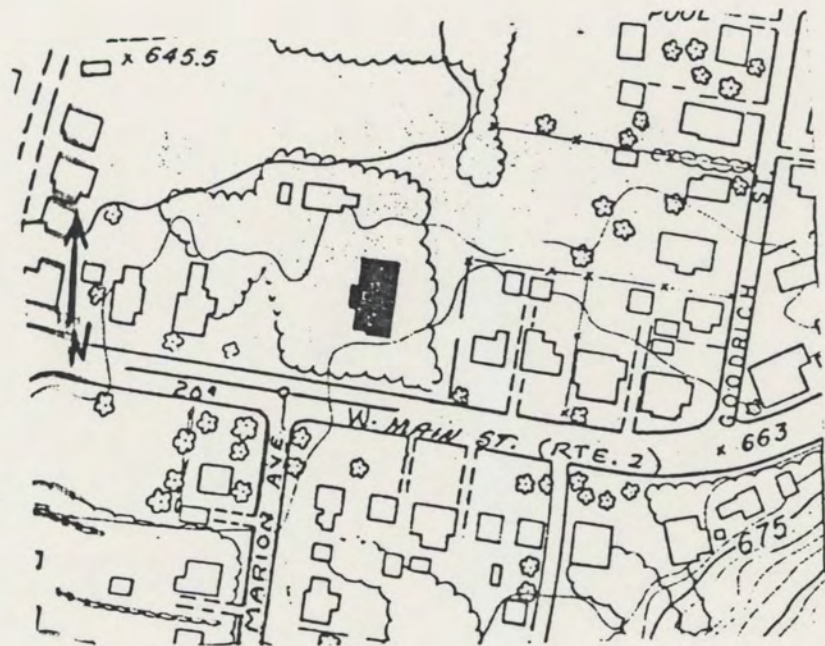

Sykes House  
521 West Main Street  
North Adams, Mass.  
North Adams MRA

Sketch Map

eloped)  
100.9

285.9

52

203.9

140.5

53

114.9

129

North Adams Assessors' Map,  
ca. 1915 1"=40'

Sykes House  
521 West Main Street  
North Adams MRA

Sykes House

WEST  
MAIN

225

S T R E E T

9.165  
25'

64.16