

FORM B - BUILDING

In Area no.	Form no.
	<del>B-78</del> 498 <del>407/30</del>

MASSACHUSETTS HISTORICAL COMMISSION  
Office of the Secretary, State House, Boston

1. Town Fall River, Mass.

Address 1588 S. Main St.

Name St. Patrick's Church

Present use church

Present owner R.C. Bishop of Fall River

3. Description: Large stone church w/central projecting tower.

Date 1881-1889

Source Cornerstone

Style Gothic

Architect Patrick Keely

Exterior wall fabric granite

Outbuildings (describe) \_\_\_\_\_

Other features Basilican plan w/rectangular <sup>nave</sup> clerestory windows in nave walls above the aisle roofs. Buttressed corners. Central portion blocked forward w/ open 4 gabled clock tower w/crosses Gothic windows w/tracery

Altered \_\_\_\_\_ Date \_\_\_\_\_

Moved \_\_\_\_\_ Date \_\_\_\_\_

5. Lot size: 53,820 sq.ft.

One acre or less \_\_\_\_\_ Over one acre x

Approximate frontage \_\_\_\_\_

Approximate distance of building from street \_\_\_\_\_

6. Recorded by P. Giza

Organization F.R.O.H.P.

Date 7-23-80

2. Photo (3x3" or 3x5")  
Staple to left side of form  
Photo number C.P. II 35.2

4. Map. Draw sketch of building location in relation to nearest cross streets and other buildings. Indicate north.

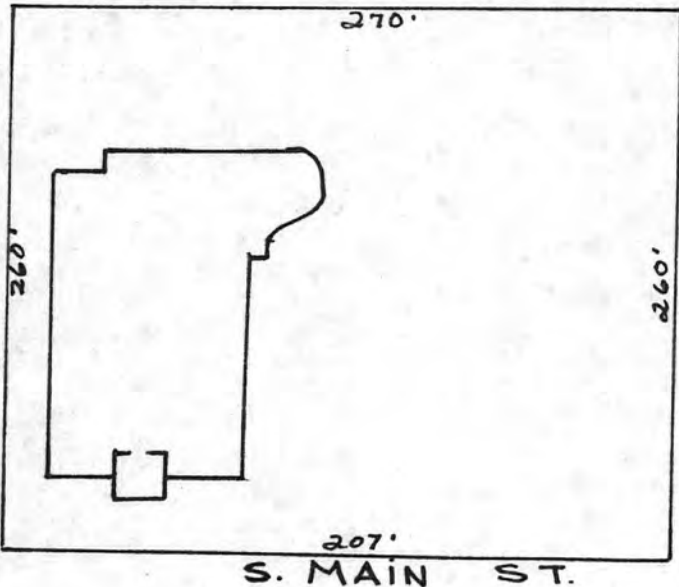

(over)

7. Original owner (if known) St. Patrick's Church

Original use church

Subsequent uses (if any) and dates \_\_\_\_\_

8. Themes (check as many as applicable)

Aboriginal	_____	Conservation	_____	Recreation	_____
Agricultural	_____	Education	_____	Religion	<u>x</u>
Architectural	<u>x</u>	Exploration/ settlement	_____	Science/ invention	_____
The Arts	_____	Industry	_____	Social/ humanitarian	_____
Commerce	_____	Military	_____	Transportation	_____
Communication	_____	Political	_____		
Community development	<u>x</u>				

9. Historical significance (include explanation of themes checked above)

Parish History: Founded in 1873 by Rt. Rev. Thomas Hendricken, Bishop of Providence. Rev. John Kelly, who came to this city from Newport, was appointed first pastor. Father Kelly celebrated the first mass in St. Patrick's parish, in a building known as the "broom factory" situated close to where St. Anne's Hospital now stands. On Sept. 18, 1881 Bishop Hendricken, assisted by a large number of local & visiting clergy, laid the cornerstone. The edifice was opened to public worship in 1889.

A simple Gothic Revival stone church with a rectangular nave with clerestory, a projecting clock & bell tower with a large Gothic window; the building corners are embellished w/decorative buttresses. This style was loosely based on English parish churches. One of three major Catholic churches in Fall River designed by Patrick C. Keely, probably America's first Catholic ecclesiastical architect. By 1873 the Irish Catholic population throughout the city had increased manyfold, so that additional parishes were founded in other parts of the city; St. Patrick's was built to accommodate the Catholics in the southern part of the city and remains a key landmark in this less dense part of the city. The church meets Criteria A and C of the National Register of Historic Places.

10. Bibliography and/or references (such as local histories, deeds, assessor's records, early maps, etc.)

Atlas of Bristol County- 1895- structure shown  
1883- structure shown  
1871- no structure

Water Dept.- St. Patrick's Church- April 30, 1888-App. #4285

Fall River Herald News clipping- Sept. 23, 1948

Fall River Daily Herald- Sept. 19, 1881

United States Department of the Interior  
National Park Service

National Register of Historic Places  
Inventory—Nomination Form

For NPS use only  
received 1/5/83  
date entered

Continuation sheet

Item number

Page 9 of 10

Multiple Resource Area  
Thematic Group

Name Fall River Multiple Resource Area  
State MA

Nomination/Type of Review

Date/Signature

81. St. Joseph's Orphanage

Substantive Review

Keeper

2/16/83 [Signature]

Attest

82. St. Louis Church

Entered in the  
National Register

Keeper

2/16/83 [Signature]

Attest

83. St. Mary's Cathedral and Rectory

Entered in the  
National Register

Keeper

2/16/83 [Signature]

Attest

84. St. Patrick's Church

Entered in the  
National Register

Keeper

2/16/83 [Signature]

Attest

85. Stafford Mills

Entered in the  
National Register

Keeper

2/16/83 [Signature]

Attest

86. Union Mills

Entered in the  
National Register

Keeper

2/16/83 [Signature]

Attest

87. Valentine-French House

Entered in the  
National Register

Keeper

2/16/83 [Signature]

Attest

88. Wampanoag Mills

Entered in the  
National Register

Keeper

2/16/83 [Signature]

Attest

89. Winslow, Luther Jr., House

Entered in the  
National Register

Keeper

2/16/83 [Signature]

Attest

90. Woman's Club of Fall River

Entered in the  
National Register

Keeper

2/16/83 [Signature]

Attest

United States Department of the Interior  
National Park Service

St. Patrick's Church (Fall River MRA)  
Bristol County  
MASSACHUSETTS

Working No. 115/83-15  
Fed. Reg. Date: 2.7.84  
Date Due: 2/3/83 - 2/19/83  
Action:  ACCEPT 2/16/83  
 RETURN  
Entered in the  REJECT  
National Register  
Federal Agency: \_\_\_\_\_

- resubmission
- nomination by person or local government
- owner objection
- appeal

Substantive Review:  sample  request  appeal  NR decision

Reviewer's comments:

Recom./Criteria \_\_\_\_\_  
Reviewer \_\_\_\_\_  
Discipline \_\_\_\_\_  
Date \_\_\_\_\_  
see continuation sheet

Nomination returned for:  technical corrections cited below  
 substantive reasons discussed below

1. Name

2. Location

3. Classification

Category	Ownership	Status	Present Use
	Public Acquisition	Accessible	

4. Owner of Property

5. Location of Legal Description

6. Representation in Existing Surveys

has this property been determined eligible?  yes  no

7. Description

Condition		Check one	Check one
<input type="checkbox"/> excellent	<input type="checkbox"/> deteriorated	<input type="checkbox"/> unaltered	<input type="checkbox"/> original site
<input type="checkbox"/> good	<input type="checkbox"/> ruins	<input type="checkbox"/> altered	<input type="checkbox"/> moved date _____
<input type="checkbox"/> fair	<input type="checkbox"/> unexposed		

Describe the present and original (if known) physical appearance

- summary paragraph
- completeness
- clarity
- alterations/integrity
- dates
- boundary selection

## 8. Significance

Period \_\_\_\_\_ Area of Significance—Check and justify below

Specific dates \_\_\_\_\_ Builder/Architect \_\_\_\_\_

Statement of Significance (in one paragraph)

- summary paragraph
- completeness
- clarity
- applicable criteria
- justification of areas checked
- relating significance to the resource
- context
- relationship of integrity to significance
- justification of exception
- other

## 9. Major Bibliographical References

## 10. Geographical Data

Acres of nominated property \_\_\_\_\_

Quadrangle name \_\_\_\_\_

UMT References \_\_\_\_\_

Verbal boundary description and justification \_\_\_\_\_

## 11. Form Prepared By

## 12. State Historic Preservation Officer Certification

The evaluated significance of this property within the state is:

national  state  local

State Historic Preservation Officer signature \_\_\_\_\_

title \_\_\_\_\_ date \_\_\_\_\_

## 13. Other

- Maps
- Photographs
- Other

Questions concerning this nomination may be directed to \_\_\_\_\_

Signed \_\_\_\_\_ Date \_\_\_\_\_ Phone: 202 272 - 3504

Comments for any item may be continued on an attached sheet



NAME: St. Patrick's Church  
LOCATION: 1588 South Main Street  
Fall River, <sup>MA</sup> Mass.  
PHOTO CREDIT: Pamela Shields (1981)  
NEGATIVE FILED AT: Fall River Office of Historic  
Preservation  
One Government Center  
Fall River, Mass. 02722  
(PSNR-12-3)  
IDENTIFICATION: St. Patrick's Church  
*photo # 1 of 2* Front Facade, looking east



Fall River MRA, Ma

St. Patrick's Church

1588 So. Main

CP II-35a

Please refer to the map in the  
Multiple Property Cover Sheet  
for this property

Multiple Property Cover Sheet Reference Number: 64000279