

18. (cont.)

a T-plan in design. The facade has Flemish bond brickwork and at foundation level, there's a band of bush-hammered stone. The windows are 6/6-paned up and 9/9 down with stone lentils and sills and louvered shutters. The cornice have dentils.

According to Lancaster, the front hall and parlors can be isolated from the rest of the rooms and with sliding doors these rooms would become a 58' long area. The main stairway is behind the parlor rooms in a hall accessible to side galleries and the dining room between them. A secondary stair is behind the dining room with the kitchen. The basement once held the kitchen. Parlor ceilings have flowered centerpieces. The voluted newel post of the main staircase is "like an element from a piece of Empire furniture."

Lancaster compares Corinthia to Buenna Hill across the road from it (Fa-504), except Buenna Hill has an L-shape rather than a T-shape plan. Both were built by the architect-builder John McMurtry for brothers. The heavy newel post with volutes in the McCauley house in Lexington (also built by McMurtry) is compared to the one at Corinthia by Lancaster as is the layout of the Gothic Revival house in Lexington, Ingelside, by McMurtry to the design of Corinthia.

Behind the house is an outbuilding in common bond brick.

19. (cont.)

raised Short-Horn cattle on his 560 acres known as Corinthia in 1882.

Fayette Co. Maps show C.W. Innes, Corinthia, here in 1861 and 1877, T.H. Wilson ten. in 1891 and Mrs. Wasson in 1904. House was un-lived in for many years until purchased and rehabilitated by Mario Crespo, California horseman.

KENTUCKY HISTORIC RESOURCE INVENTORY SUPPLEMENT
BOUNDARY AND LOCATION INFORMATION

Historic Property Name Corinthia Site # Fa-502

Multiple Resource/Thematic Nomination Title Innes Family Houses of Fayette County

U.T.M. Coordinates - List multiple UTMs if property is ten or more acres.

A. 16 726555 4227940 D. _____

B. _____ E. _____

C. _____ F. _____

Verbal Boundary Description Acreage .3

The nominated area begins at a point (A) (which is 80 feet northeast of the northeast corner of the house and approximately 575 feet west of the intersection of the south side of the driveway and Russell Cave Pike) and proceeds south 150 feet along a line to a point (B) thence west 225 feet to a point (C) thence north 150 feet to a point (D) thence east 225 feet to the point of origin, thereby incorporating the house.

Sketch of Site Plan (Showing outbuildings, structures, landscape features and the site boundary as described above.)

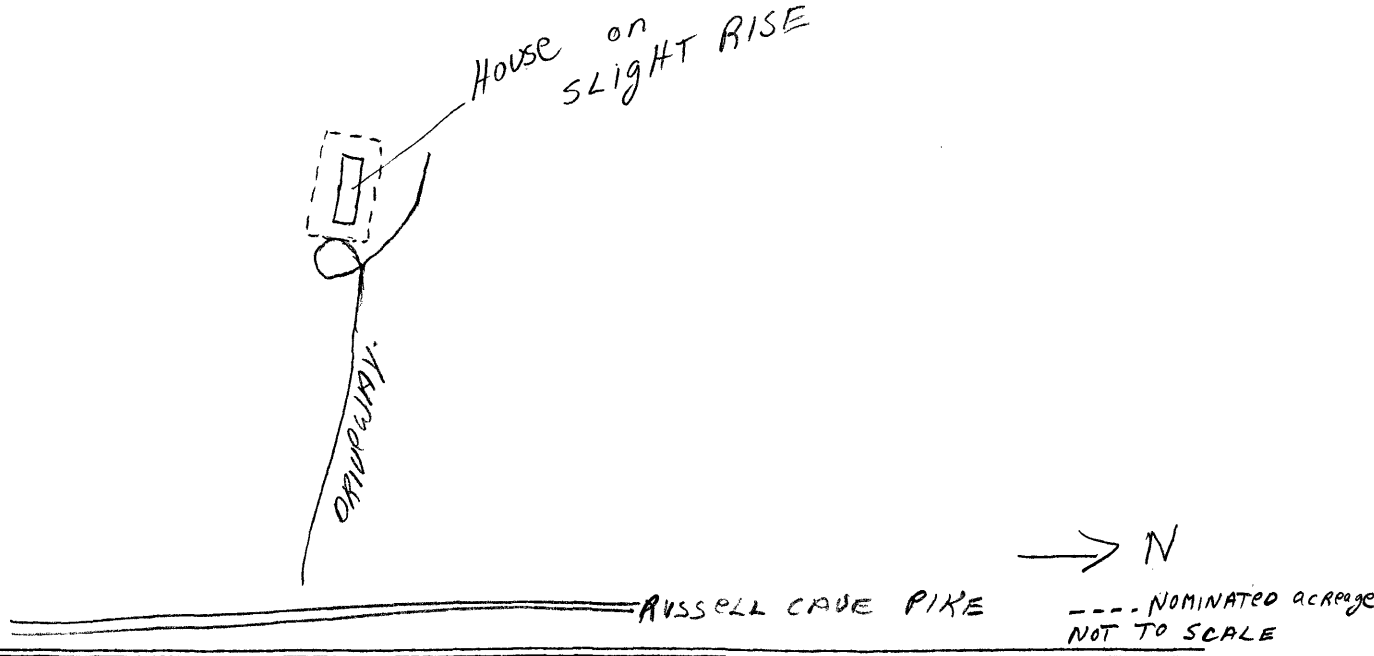

Official Courthouse Property Reference: