

1. Historic Name (s) 844 South Second Street
 Original Owner Mary Curran

Present Name 844 South Second Street

3. Owner's Name Berneta Still

4. Owner's Address 844 South Second Street

5. Location 844 South Second Street, Louisville, KY

6. Open to Public Yes No X
 7. Visible from road Yes X No

8. Ownership Private
 Local
 State
 Federal

9. Local Contact/Organization Landmarks Commission

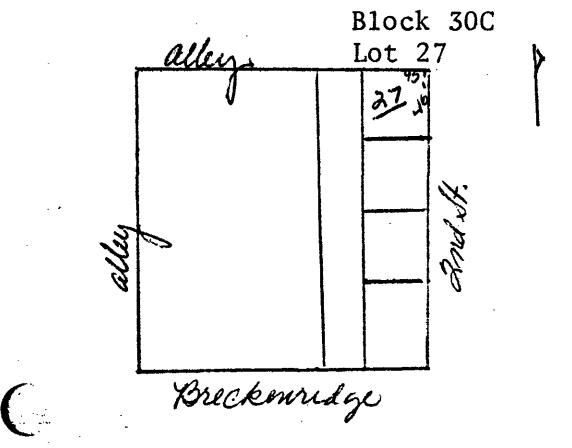

11. Architect

12. Builder

13. Date ca. 1895

14. Style Victorian

15. Original Use residential

16. Present Use residential

17. Condition Interior
 Exterior very good

18. Description
 No. 844 South Second Street is a two-and-one-half-story brick house. The facade has an arched opening on the right with smooth stone voussoirs with a pronounced key-stone. The arch contains a recessed entry consisting of a single door with sidelights. The left side of the ground floor is pierced by a double-hung window with a square-headed hood. A stone band runs across the facade from the ends of the hood. The second floor has two

19. History
 This structure is one of four houses built on the site of a house owned by Mary Curran. The property was rented to the former governor of Kentucky, John Young Brown, at the turn-of-the-century.

20. Significance
 This house is a fine example of the late Victorian style and is interesting as an example of speculative buildings. The structure is part of a small cluster of residential dwellings which remain in North Old Louisville.

21. Source of Information
 Caron Directory
 Jefferson County (KY) Deed Books
 Sanborn Real Estate Maps. 1892, 1905
 1884 Atlas of Louisville.

22. ADD/County JF- 056

23. Zoning Classification Magisterial District

24. U.S.G. S. Quadrant (15'/75') Louisville West 079

25. UTM Reference
 Zone 16 Easting 608920 Northing 4233180

26. Prehistoric Site Object
 Historic Site Structure
 Building X

27. District Yes No
 Name: District 2
 North Old Louisville Multiple Res.

28. Significance Evaluation contributing element - H

29. Status Date
 National Landmark
 National Register
 Landmark Certificate
 Kentucky Survey XXXX 1981
 Local Landmark
 HABS/HAER

30. Theme architecture 03
 Primary
 Secondary
 Other

31. Endangered Yes No X

32.

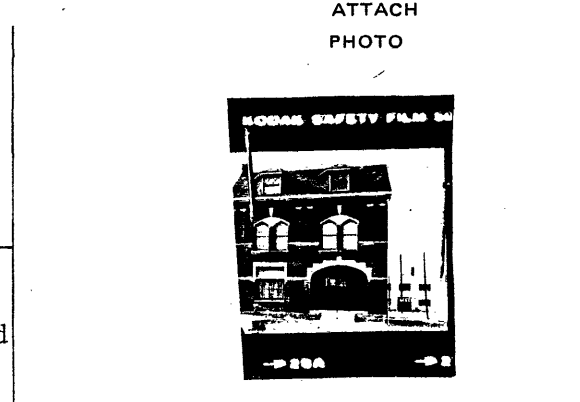

Roll No. 96
 Picture No. 26A
 Direction

33. Tape No. Negative No.

34. Prepared by: Marty Hedgepeth, Director of Research

35. Organization Landmarks Commission

36. Date March 3, 1981

37. Revision Dates 12/82
 38. Staff Review

#18 (continued)

pairs of rectangular windows, with pointed tops. The windows are encased in heavy brick voussoirs with a paneled spandrel. The floor is articulated by three pilasters rising from a stone band. The structure is capped by an extended cornice broken by two dormers with chamfered corners. The windows of the dormers have crossed cames.

#20 (continued)

built on the site of an early structure. They are architecturally interesting for their use of similar classical motifs used differently in each structure. This inter-relation of motifs and similarity in scale and materials gives a strong sense of cohesiveness and unity to the cluster while each building displays a unique facade. These 4 structures represent a fine design solution to a tightly clustered development of urban townhouses.

#10 Less than one acre. The structure and small yard occupy the entire lot.

KENTUCKY HISTORIC RESOURCES INVENTORY

CN 16

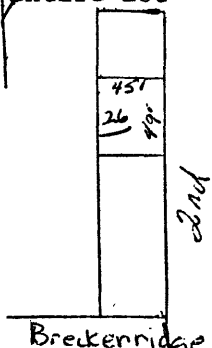
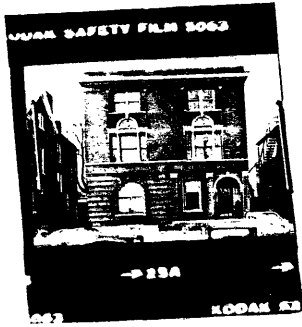
1. Historic Name (s) 848 South Second Street		22. ADD/County JF- 0 5 6																												
Original Owner Mary Curran		23. Zoning Classification Magisterial District																												
Present Name 848 South Second Street		24. U.S.G. S. Quadrant (15'/75') Louisville West 079																												
3. Owner's Name Donald Sloan		25. UTM Reference <table border="1" style="display: inline-table; border-collapse: collapse;"><tr><td style="border: 1px solid black;">1</td><td style="border: 1px solid black;">6</td><td style="border: 1px solid black;">6</td><td style="border: 1px solid black;">0</td><td style="border: 1px solid black;">8</td><td style="border: 1px solid black;">9</td><td style="border: 1px solid black;">2</td><td style="border: 1px solid black;">0</td><td style="border: 1px solid black;">4</td><td style="border: 1px solid black;">2</td><td style="border: 1px solid black;">3</td><td style="border: 1px solid black;">3</td><td style="border: 1px solid black;">1</td><td style="border: 1px solid black;">8</td><td style="border: 1px solid black;">0</td></tr><tr><td colspan="4" style="text-align: center;">Zone</td><td colspan="4" style="text-align: center;">Easting</td><td colspan="4" style="text-align: center;">Northing</td></tr></table>		1	6	6	0	8	9	2	0	4	2	3	3	1	8	0	Zone				Easting				Northing			
1	6	6	0	8	9	2	0	4	2	3	3	1	8	0																
Zone				Easting				Northing																						
4. Owner's Address 848 South Second Street		26. Prehistoric Site <input type="checkbox"/> Object Historic Site <input type="checkbox"/> Structure Building <input checked="" type="checkbox"/> X																												
5. Location 848 South Second Street, Louisville, KY		27. District <input checked="" type="checkbox"/> Yes <input type="checkbox"/> No Name: District 2 North Old Louisville Multiple Res.																												
6. Open to Public Yes <input type="checkbox"/> No <input checked="" type="checkbox"/> X	7. Visible from road Yes <input checked="" type="checkbox"/> X No <input type="checkbox"/>	8. Ownership Private <input checked="" type="checkbox"/> X Local <input type="checkbox"/> State <input type="checkbox"/> Federal <input type="checkbox"/>																												
9. Local Contact/Organization Landmarks Commission		28. Significance Evaluation Contributing element - H																												
10. Site Plan with North Arrow Block 30C Less than one acre. Lot 26 Structure and small front yard take up entire lot		29. Status <input type="checkbox"/> National Landmark <input type="checkbox"/> National Register <input type="checkbox"/> Landmark Certificate <input checked="" type="checkbox"/> Kentucky Survey 1981 <input type="checkbox"/> Local Landmark <input type="checkbox"/> HABS/HAER																												
		11. Architect																												
		12. Builder																												
		13. Date c. 1895																												
		14. Style Victorian <input type="checkbox"/> <input type="checkbox"/>																												
		15. Original Use residential																												
16. Present Use residential		30. Theme architecture <input type="checkbox"/> <input type="checkbox"/> <input type="checkbox"/> <input checked="" type="checkbox"/> 3																												
17. Condition <input type="checkbox"/> <input type="checkbox"/>		31. Endangered <input type="checkbox"/> Yes <input checked="" type="checkbox"/> No X																												
Interior <input type="checkbox"/>		32.																												
Exterior very good																														
18. Description 846 South Second Street is a two-and-one-half-story brick structure. The right of the facade contains an arched opening which is faced with a classical stone surround and keystone. A recessed entry with a wood door in a simple surround sets behind the arch. The arch is flanked by pilasters. A narrow window to the left of the entry is also flanked by a pilaster and has a raised brick surround. The pilasters support a band of vertically																														
19. History This structure is one of four houses built on the site of a house owned by Mary Curran. The property was initially rented to J. K. Lemon of Lemon and Sons Jewelers.		Roll No. <u>96</u> Picture No. <u>25A</u> Direction _____																												
20. Significance This house is a fine example of the late Victorian style and is interesting as an example of speculative building. The structure is part of a small cluster of residential dwellings which remain in North Old Louisville.		33. Tape No. _____ Negative No. _____																												
201 W. Breckenridge, 844, 848, and 852 S. 2nd were (cont)		34. Prepared by: Marty Hedgepeth-Director of Research																												
21. Source of Information Caron Directory Jefferson County (KY) Deed Books. Sanborn Real Estate Maps 1892, 1905. 1884 Atlas of Louisville.		35. Organization Landmarks Commission																												
		36. Date March 3, 1981																												
		37. Revision Dates 12/82 38. Staff Review _____																												

#18 (continued)

laid bricks which run across the facade. The left half of the facade on the first floor is covered by brick laid in a rusticated pattern. The area is pierced by a large round arched window with brick voussoirs. A stone band articulates the first and second floors. Two Palladian-type windows which are recessed rise from the stone band on the second story. The windows are articulated by Tuscan columns which support the center window which is decorated with wreaths and ribbons. The attic story contains two pairs of short double-hung windows. The building is capped by a simple cornice with dentils.

#20 (continued)

built on the site of an early structure. They are architecturally interesting for their use of similar classical motifs used differently in each structure. This inter-relation of motifs and similarity in scale and materials gives a strong sense of cohesiveness and unity to the cluster while each building displays a unique facade. These 4 structures represent a fine design solution to a tightly clustered development of urban townhouses.

1. Historic Name (s) 852 South Second Street
 Original Owner Mary Curran

Present Name 852 S. Second

3. Owner's Name Bill Detore

4. Owner's Address P.O. Box 16035 Louis., KY 40216

5. Location 852 South Second Street

6. Open to Public Yes No X
 7. Visible from road Yes X No

8. Ownership Private
 Local
 State
 Federal
 9. Local Contact/Organization Landmarks Commission

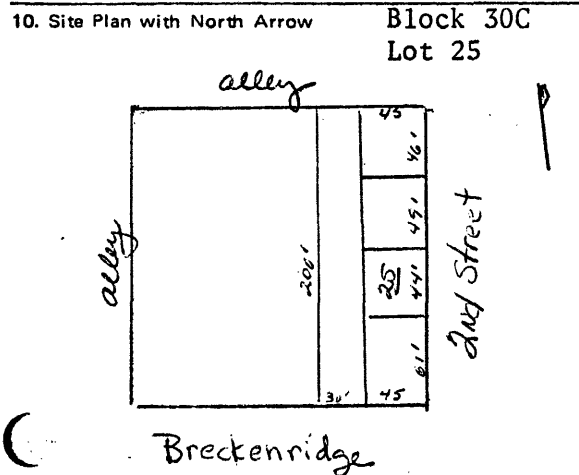

11. Architect

12. Builder

13. Date c. 1895

14. Style Victorian

15. Original Use residential

16. Present Use vacant

17. Condition Interior
 Exterior fair

22. ADD/County JF-056

23. Zoning Classification Magisterial District

24. U.S.G. S. Quadrant (15'/75') Louisville West 079

25. UTM Reference
 Zone 16 Easting 608920 Northing 4233180

26. Prehistoric Site Object
 Historic Site Structure
 Building X

27. District Yes No
 Name: District 2
 North Old Louisville Multiple Res.

28. Significance Evaluation Contributing element - h

29. Status Date
 National Landmark
 National Register
 Landmark Certificate
 Kentucky Survey 1981
 Local Landmark
 HABS/HAER

30. Theme
 Primary architecture 3
 Secondary
 Other

31. Endangered Yes X
 No

32.

18. Description
 852 South Second Street is a two-and-a-half-story brick residence. The right of the facade contains a round arch and a recessed entry of a door in a simple surround. The arch has a stone surround with a keystone and brick voussoirs. The window next to the entry has a pronounced smooth stone voussoirs. The left side of the facade contains two narrow rectangular windows. The first and

19. History
 This structure is one of four houses built on the site of a house owned by Mary Curran. The property was initially rented to E.D. Graff of the American Elixir Company.

20. Significance
 This house is a fine example of the late Victorian style and is an interesting example of speculative buildings. The structure is part of a small cluster of residential dwellings which remains in North Old Louisville.
 201 W. Breckenridge, 844, 848, and 852 S. 2nd were (cont)

21. Source of Information
 Caron Directory
 Jefferson County (KY) Deed Books.
 Sanborn Real Estate Maps, 1892, 1905.
 1884 Atlas of Louisville.

ATTACH PHOTO

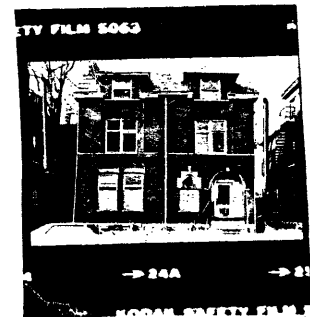

Roll No. 96
 Picture No. 24
 Direction

33. Tape No. Negative No.

34. Prepared by: Marty Hedgepeth, Director of Research

35. Organization Landmarks Commission

36. Date March 3, 1981

37. Revision Dates 12/82
 38. Staff Review

#18 (continued)

second stories are articulated horizontally by stone and brick banding. The second story is pierced by two pairs of coupled windows with transoms. The windows are set between pilaster strips and have a recessed brick panel above. A row of dentils and brick corbelling adorns the top of the building between two dormers which have diagonally camed windows.

#20 (continued)



built on the site of an early structure. They are architecturally interesting for their use of similar classical motifs used differently in each structure. This inter-relation of motifs and similarity in scale and materials gives a strong sense of cohesiveness and unity to the cluster while each building displays a unique facade. These 4 structures represent a fine design solution to a tightly clustered development of urban townhouses.

#10 Less than one acre. Structure and small front yard footage occupy entire lot.

KENTUCKY HISTORIC RESOURCES INVENTORY

CN

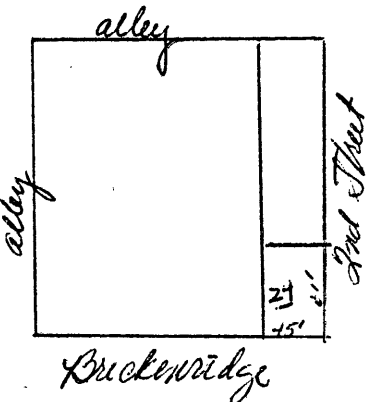
18

1. Historic Name (s) 201 West Breckenridge Street		22. ADD/County JF- <table border="1"><tr><td>0</td><td>5</td><td>6</td></tr></table>		0	5	6																								
0	5	6																												
Original Owner Mary Curran		23. Zoning Classification Magisterial District																												
Present Name 201 West Breckenridge Street		24. U.S.G. S. Quadrant (15'/75') Louisville-West																												
3. Owner's Name Bill Detore P.O. Box 16035 Louis, KY 40216		25. UTM Reference <table border="1"><tr><td>1</td><td>6</td><td>6</td><td>0</td><td>8</td><td>9</td><td>2</td><td>0</td><td>4</td><td>2</td><td>3</td><td>3</td><td>1</td><td>8</td><td>0</td></tr><tr><td colspan="4">Zone</td><td colspan="4">Easting</td><td colspan="4">Northing</td></tr></table>		1	6	6	0	8	9	2	0	4	2	3	3	1	8	0	Zone				Easting				Northing			
1	6	6	0	8	9	2	0	4	2	3	3	1	8	0																
Zone				Easting				Northing																						
4. Owner's Address 201 West Breckenridge Street		26. Prehistoric Site Historic Site <input type="checkbox"/> Building <input checked="" type="checkbox"/>																												
5. Location 201 West Breckenridge Street, Louisville, KY		27. District Yes <input type="checkbox"/> No <input type="checkbox"/> Name: <i>District 2</i> <i>North Old Louisville Multiple Res.</i>																												
6. Open to Public Yes <input type="checkbox"/> No <input checked="" type="checkbox"/>	7. Visible from road Yes <input checked="" type="checkbox"/> No <input type="checkbox"/>	8. Ownership Private <input checked="" type="checkbox"/> Local <input type="checkbox"/> State <input type="checkbox"/> Federal <input type="checkbox"/>																												
9. Local Contact/Organization Landmarks Commission		28. Significance Evaluation <i>Contributing element - h</i>																												
10. Site Plan with North Arrow Block 30C Lot 24 		11. Architect																												
		12. Builder																												
		13. Date ca. 1893																												
		14. Style <table border="1"><tr><td> </td><td> </td></tr></table>																												
		15. Original Use residential																												
		16. Present Use vacant																												
		17. Condition <table border="1"><tr><td> </td><td> </td></tr></table> Interior <input type="checkbox"/> Exterior <i>fair</i>																												
18. Description No. 201 West Breckenridge is a two-and-one-half-story brick townhouse. The facade has a central projecting bay. The first floor porch is formed by the projection. It is supported by incised piers adorned with egg-and-dart mold and chevron motifs. The entry is a double door which is now boarded. Above the porch on the second story is a Palladian window. The window is articulated by Tuscan columns which support an entablature. An arched, terra		29. Status National Landmark <input type="checkbox"/> National Register <input type="checkbox"/> Landmark Certificate <input type="checkbox"/> Kentucky Survey <input checked="" type="checkbox"/> 1981 Local Landmark <input type="checkbox"/> HABS/HAER <input type="checkbox"/>																												
19. History This structure is one of four houses built on the site of a house owned by Mary Curran. She rented the property to J.P. Roche.		30. Theme <i>architecture</i> Primary <input type="checkbox"/> Secondary <input type="checkbox"/> Other <input type="checkbox"/> <table border="1"><tr><td> </td><td> </td><td> </td></tr><tr><td> </td><td> </td><td> </td></tr><tr><td> </td><td> </td><td> </td></tr></table>																												
20. Significance This house is a fine example of the late Victorian style and is part of a cluster of residential buildings left in the North Old Louisville area. 201 W. Breckenridge, 844, 848, and 852 S. Second were built on the site of an early structure. (cont.)		31. Endangered Yes <input checked="" type="checkbox"/> No <input type="checkbox"/>																												
21. Source of Information <u>Caron Directory of Louisville.</u> <u>Jefferson County (KY) Deed Books.</u> <u>Sanborn Real Estate Maps. 1892, 1905.</u> <u>1884 Atlas of Louisville.</u>		32. 																												
		Roll No. <u>96</u> Picture No. <u>23A</u> Direction _____																												
		33. Tape No. _____ Negative No. _____																												
		34. Prepared by: <u>Marty Hedgepeth,</u> <u>Director of Research</u>																												
		35. Organization <u>Landmarks Commission</u>																												
		36. Date <u>March 3, 1981</u>																												
		37. Revision Dates <u>12/82</u> 38. Staff Review _____																												

#18 (continued)

cotta crown surmounts the center window which is adorned by a wreath and ribbons. The end bays contain rectangular windows with segmentally arched brick voussoirs on the first and second stories.

The side of the structure which faces Second Street has a bay projection. The central face of the bay has small windows on the first floor and a terra cotta panel on the second adorned with a wreath motif. The chamfered sections contain rectangular windows. The structure still retains its slate roof.

#20 (continued)



They are architecturally interesting for their use of similar classical motifs used differently in each structure. This inter-relation of motifs and similarity in scale and materials gives a strong sense of cohesiveness and unity to the cluster while each building displays a unique facade. These 4 structures represent a fine design solution to a tightly clustered development of urban townhouses.

#10. Less than one acre. Structure occupies entire lot except for small front yard footage.

KENTUCKY HISTORIC RESOURCES INVENTORY

CN

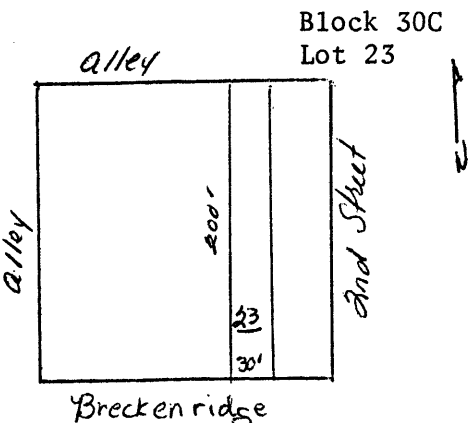
19

1. Historic Name (s) 203 West Breckenridge Street		22. ADD/County JF 056	
Original Owner Mattie Dickerson Dugan		23. Zoning Classification Magisterial District	
Present Name 203 West Breckenridge		24. U.S.G. S. Quadrant (15'/75') Louisville West 079	
3. Owner's Name Breckel Press		25. UTM Reference Zone 16 Easting 608920 Northing 4233180	
4. Owner's Address 203 West Breckenridge Street, Louisville, KY		26. Prehistoric Site Object Historic Site Structure Building X	
5. Location 203 West Breckenridge Street, Louisville, KY		27. District Yes <input checked="" type="checkbox"/> No Name: District 2 North Old Louisville Multiple Res.	
6. Open to Public Yes No <input checked="" type="checkbox"/>	7. Visible from road Yes <input checked="" type="checkbox"/> No	28. Significance Evaluation Contributing element - h	
9. Local Contact/Organization Landmarks Commission		29. Status National Landmark National Register Landmark Certificate Kentucky Survey <input checked="" type="checkbox"/> 1981 Local Landmark HABS/HAER	
10. Site Plan with North Arrow 		11. Architect	
		12. Builder	
		13. Date ca. 1893	
		14. Style Richardsonian Romanesque	
		15. Original Use residential	
		16. Present Use residential	
		17. Condition Interior <input type="checkbox"/> Exterior good <input type="checkbox"/>	
18. Description No. 203 West Breckenridge Street is a two-and-one-half-story brick townhouse. The right side of the facade is treated like a tower. This section contains a recessed entry. The second story has a double-hung window with a stone lintel and the upper story has an arched window with brick voussoirs. This upper story projects above the rest of the facade and is adorned by dentils. The left side of the facade on the first floor has a large round		30. Theme Primary architecture 03 Secondary Other	
19. History This structure was built in ca. 1893. The structure was rented to Charles Erveel Craik, rector of Christ Episcopal Church.		31. Endangered Yes No <input checked="" type="checkbox"/>	
20. Significance This house is part of a cluster of residential dwellings left in the North Old Louisville area. It is a fine example of the Richardsonian Romanesque.		32. ATTACH PHOTO 	
21. Source of Information Garon Directory of Louisville. Jefferson County (KY) Deed Books. Sanborn Real Estate Maps. 1892, 1905.		Roll No. 96 Picture No. 22A Direction	
		33. Tape No. Negative No.	
		34. Prepared by: Marty Hedgepeth, Director of Research	
		35. Organization Landmarks Commission	
		36. Date March 3, 1981	
		37. Revision Dates 38. Staff Review	

#18 (continued)

arch supported by squat, engaged Romanesque columns. The arch has brick voussoirs and a stone extrados. The second floor contains two coupled windows of the same treatment as the right side of the facade. This section is capped by a gable. The gable face is pierced by three small coupled arched windows with brick voussoirs and stone extrados.

#10. Less than one acre. Structure and rear addition occupy entire lot except for small front yard footage.

0
A

0
A

45E

6' W.P.

FA

OFF. FFX 192

PARK'G

SALES NC

AUTO SALES & SERVICE

A CONSTN BUILT 1921

OFF. N.C. 1974 (C.B.R.F.)

243

PARK'G

HALL FFX 1967

OFF. EP 1957

PRIV. PARK'G

PARK'G

PRINTING PLASTIC WALLS
15
16
17
18
19

W. BRECKINRIDGE

DISTRICT NO. 2

— District Boundary

State Survey

48E

60'

6' W.P.

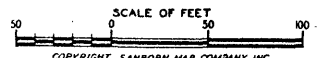

COPYRIGHT, SANBORN MAP COMPANY, INC.

S. 2ND ST.

OFF. FFX 1960
NONCOMB. CEILING
PARK'G
PRIV. PARK'G
PARK'G
F
F
S (C.B.)
APTS
D
RATS
PRIV. PARK'G
PRIV. PARK'G
C

807A

239

172A

PARK'G
OFF. FFX 1964 (C.B.)
PARK'G
PARK'G
LOAD'G C.B.
TILE STGE
REST.
PRIV. PARK'G
(IRON)
(C.B.)
PRIV. PARK'G
PRIV. PARK'G
C

60'

6' W.P.

FA

49E

ST. IS

D.H.

CISTERN

B.W.P.

E. BRECKINRIDGE

North Old Louisville Multiple Resources Area
Louisville, Jefferson County, Kentucky
Map No. 3 District No. 2
Sanborn Map, 1974