

FORM B - BUILDING

MAY 15 1989

550

MRA

MASSACHUSETTS HISTORICAL COMMISSION
80 BOYLSTON STREET
BOSTON, MA 02116

AREA	FORM NO.
F	611

Roll # 3-8

Photo (3"x3" or 3"x5", black and white) Indicate address of property on back of photo. Staple to left side of form.

Sketch Map: Draw map showing property's location in relation to nearest cross streets and/or geographical features. Indicate all buildings between inventoried property and nearest intersection(s). Indicate north

Town Southbridge

Address 561 South Street

Historic Name Simon Plimpton Farmhouse

Use: Present residential

Original residential

DESCRIPTION

Date 1819

Source Quinebaug Historical Society Leaflet

Style Federal

Architect UNKNOWN

Exterior Wall Fabric clapboard

Outbuildings barn (c)

Major Alterations (with dates) numerous

changes in the 19th-century

Condition good

Moved no Date n/a

Acreage 9.2 acres

Setting rural/suburban area

Recorded by E. Woodford, S. Ceccacci

Organization Southbridge Historical Commission

Date May 1986

- Ⓐ 18/743 730/4662 150
- Ⓑ 18/743 740/4662 050
- Ⓒ 18/743 700/4661 970
- Ⓓ 18/743 505/4662 050
- Ⓔ 18/743 445/4662 040
- Ⓕ 18/743 485/4662 140

UTM REFERENCE See above

USGS QUADRANGLE Southbridge MA CT

SCALE 1:25,000

NATIONAL REGISTER CRITERIA STATEMENT (if applicable)

The Simon Plimpton ~~farmhouse~~ is significant for its association with the settlement period of Southbridge's history and the development of its mill economy, and its regionally significant center chimney house form. It meets National Register criteria A and C at the local level and retains integrity of setting, location, materials, workmanship, design, feeling, and association. The boundaries of this property are those of current ownership, outlined on the attached assessors map, the large parcel contributing to the rural quality surrounding the house and barn.

ARCHITECTURAL SIGNIFICANCE Describe important architectural features and evaluate in terms of other buildings within the community.

This two-and-a-half story, five bay, center entry house has the typical central chimney placement, gable roof and double pile vernacular form popular in Central Massachusetts from the late-18th through the mid-19th century. One source indicates that the house was built in 1819, however, the broad eaves and the substantial Greek Revival doorframes appear to date from the mid-19th century. Despite these alterations and the later-19th century addition of a porch across the facade, the house remains one of the best preserved examples of 19th-century rural architecture in Southbridge. Surrounded by open space and large old trees, the house still retains a barn and much of its rural setting.

HISTORICAL SIGNIFICANCE Explain the role owners played in local or state history and how the building relates to the development of the community.

The land on which this house stands seems originally to have been part of a larger tract of 115 acres settled by Col. Daniel Plimpton who came to Sturbridge in 1738 from Medfield. Plimpton land was divided between two towns in 1819 when Southbridge was established as a separate entity. Simon Plimpton, a grandson of Capt. John Plimpton, is said to have built this house in 1819 together with his brother Baxter. In 1823 Baxter deeded his half of the property to Simon. Later, in 1828, he built himself a brick house, no longer standing, across the road. Sometime before 1855, Simon's son, John B. Plimpton, occupied a small house at 579 South Street, just south of his father's house, which had been moved to this location from the Pond Factory region on Woodstock Road. After Simon's death (pre-1870) the big house was inherited by John B. Plimpton and occupied by his widow in 1898. Today the house is still in the hands of Plimpton co-relations.

Members of the Plimpton family began using water power near by, in about 1812, for a cotton spinning and a wool carding mill. Later, about 1846, the Litchfield Shuttle factory was established across the road from the Simon Plimpton house. With the exception of the houses belonging to the Plimpton family, most other houses in the area were occupied at one time or another by persons related to the shuttle business as partners, employers, or employees.

BIBLIOGRAPHY and/or REFERENCES

maps, atlases

Quinebaug Historical Society Leaflets, Vol. I, P. 49; Vol. II, #7 & 10
Deed to property in possession of Richard Harwood, December 12, 1823.

United States Department of the Interior
National Park Service

National Register of Historic Places
Continuation Sheet

Section number _____ Page _____

Multiple Resource Area
Thematic Group

Name Southbridge MRA
State Worcester County, MASSACHUSETTS

Nomination/Type of Review	Date/Signature
61. Oakes, J.J., House Entered in the National Register	Keeper <u>Delores Byers 6/22/89</u> Attest _____
62. Phillips, E.M., House Entered in the National Register	Keeper <u>Delores Byers 6/22/89</u> Attest _____
63. Plimpton, Simon, Farmhouse Entered in the National Register	Keeper <u>Delores Byers 6/22/89</u> Attest _____
64. Richard, Stephen, House Entered in the National Register	Keeper <u>Delores Byers 6/22/89</u> Attest _____
65. Sacred Heart Church Historic District Entered in the National Register	Keeper <u>Delores Byers 6/22/89</u> Attest _____
66. Smith--Lyon Farmhouse Entered in the National Register	Keeper <u>Delores Byers 6/22/89</u> Attest _____
67. St. George's Greek Orthodox Church Entered in the National Register	Keeper <u>Delores Byers 6/22/89</u> Attest _____
68. St. Peter's Roman Catholic Church-- St. Mary's School Entered in the National Register	Keeper <u>Delores Byers 6/22/89</u> Attest _____
69. Stone, Lorenzo R., House Entered in the National Register	Keeper <u>Delores Byers 6/22/89</u> Attest _____
70. Sumner, George, House Entered in the National Register	Keeper <u>Delores Byers 6/22/89</u> Attest _____

NATIONAL PARK SERVICE

NATIONAL REGISTER OF HISTORIC PLACES
EVALUATION/RETURN SHEET

REQUESTED ACTION: NOMINATION

PROPERTY NAME: Plimpton, Simon, Farmhouse

MULTIPLE NAME: Southbridge MRA

STATE & COUNTY: MASSACHUSETTS, Worcester

DATE RECEIVED: 5/15/89 DATE OF PENDING LIST: 5/31/89
DATE OF 16TH DAY: 6/16/89 DATE OF 45TH DAY: 6/29/89
DATE OF WEEKLY LIST:

REFERENCE NUMBER: 89000550

NOMINATOR: STATE

REASONS FOR REVIEW:

APPEAL: N DATA PROBLEM: N LANDSCAPE: N LESS THAN 50 YEARS: N
OTHER: N PDIL: N PERIOD: N PROGRAM UNAPPROVED: N
REQUEST: N SAMPLE: N SLR DRAFT: N NATIONAL: N

COMMENT WAIVER: N

ACCEPT RETURN REJECT 6/24/89 DATE

Entered in the
National Register

ABSTRACT/SUMMARY COMMENTS:

RECOM./CRITERIA _____
REVIEWER _____
DISCIPLINE _____
DATE _____

DOCUMENTATION see attached comments Y/N see attached SLR Y/N

CLASSIFICATION

count resource type

STATE/FEDERAL AGENCY CERTIFICATION

FUNCTION

historic current

DESCRIPTION

architectural classification
 materials
 descriptive text

SIGNIFICANCE

Period Areas of Significance--Check and justify below

Specific dates Builder/Architect
Statement of Significance (in one paragraph)

summary paragraph
 completeness
 clarity
 applicable criteria
 justification of areas checked
 relating significance to the resource
 context
 relationship of integrity to significance
 justification of exception
 other

BIBLIOGRAPHY

GEOGRAPHICAL DATA

acreage verbal boundary description
 UTM's boundary justification

ACCOMPANYING DOCUMENTATION/PRESENTATION

sketch maps USGS maps photographs presentation

OTHER COMMENTS

Questions concerning this nomination may be directed to

_____ Phone _____

Signed _____

Date _____



Simon Plimpton Farmhouse, (F-611)

Southbridge, MA *MA*

Ceccacci, 1986

Southbridge Historical Society

Roll # 3.8

516 South Street

SOUTHBRIDGE MASS
MRA

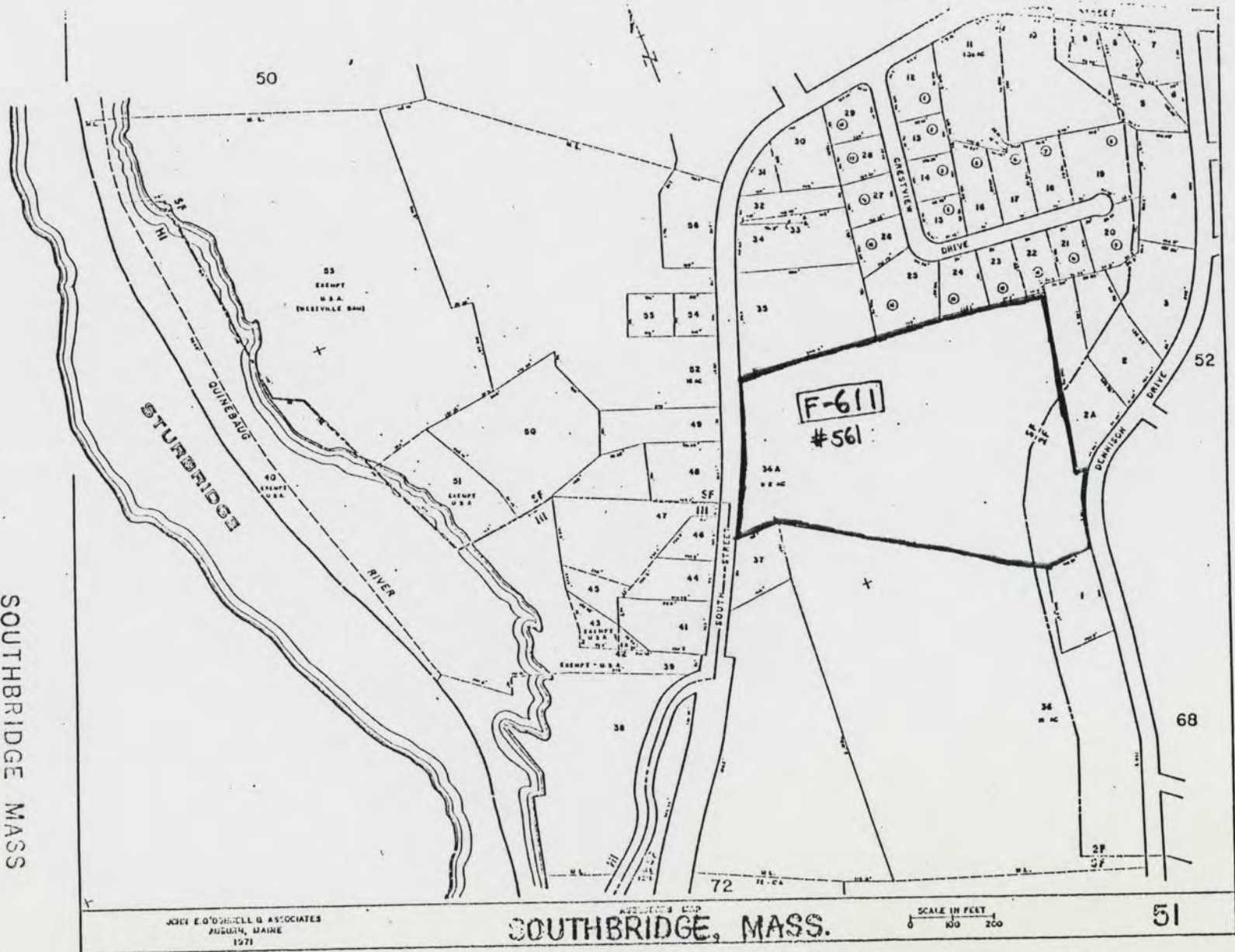

JOHN E. O'DONNELL & ASSOCIATES
PLANNERS
JUGUIN, MAINE
1971

ASSOCIATES INC.
SOUTHBRIDGE, MASS.

SCALE IN FEET
0 100 200

51

561 South Street

Please refer to the map in the
Multiple Property Cover Sheet
for this property

Multiple Property Cover Sheet Reference Number: 64000294