

KENTUCKY HISTORIC RESOURCES INVENTORY

Site No. Gn-19

1. Historic Name(s) ✓ Mt. Gilead Baptist Church (Green County H.R.A.) Original Owner		22. ADD/County Lake Cumberland/Gn 0 4 4	
2. Present Name Mt. Gilead Christian Church		23. U.S.G.S. Quadrant (15'/75') Gresham G.I.S. Mod. <input type="checkbox"/>	
3. Location W side Haskingsville - Mt. Gilead Road N. side Ky 767; E. side Skinhouse Bruch.		24. UTM Reference Zone Easting Northing	
4. Owner's Name Mt. Gilead Christian Church		25. Coordinate Accuracy <input type="checkbox"/>	
5. Owner's Address Route 5, Greensburg, Ky. 42743		26. Prehistoric Site Object Historic Site Structure Building Other	
6. Open to Public Yes <input checked="" type="checkbox"/> No <input type="checkbox"/>	7. Visible from road Yes <input checked="" type="checkbox"/> No <input type="checkbox"/>	8. Ownership Private <input checked="" type="checkbox"/> Local <input type="checkbox"/> State <input type="checkbox"/> Federal <input type="checkbox"/>	
9. Local Contact/Organization Owner		27. National Register District Name: _____	
10. Site Plan with North Arrow See attached		28. Significance Evaluation National Register B	
11. Architect 12. Builder 13. Date 1804* A. <input checked="" type="checkbox"/> B. <input type="checkbox"/>		29. Status Date National Landmark <input type="checkbox"/> National Register <input type="checkbox"/> Landmark Certificate <input checked="" type="checkbox"/> 3/28/79 Kentucky Survey <input checked="" type="checkbox"/> 9/28/72 Local Landmark <input type="checkbox"/> HABS/HAER <input type="checkbox"/>	
14. Style A. Federal <input checked="" type="checkbox"/> B. <input type="checkbox"/>		30. Historic Theme Primary <u>exploration</u> K Secondary <u>architecture</u> C Other <input type="checkbox"/>	
15. Original Use church <input checked="" type="checkbox"/>		31. Endangered Yes <input type="checkbox"/> No <input checked="" type="checkbox"/>	
16. Present use church		32. Preservation Project Status <input type="checkbox"/>	
17. Condition good <input checked="" type="checkbox"/>		Actual Cost in \$1,000s _____	
18. Description 1-story; brick; 1/5 American bond; jack arches; unbonded gable-end; 6-bay E side apparently unaltered: w/d/w/w/d/w; paneled doors on E - vertical board door on S; no transoms; 9/9 windows; 4-bay w side all windows; 29th c rear end addition; pulpit on W wall with congregation facing, so the principal entrances were probably the E doors. (Continue on Back)		33. ATTACH PHOTO Roll No. <u>15,16</u> Picture No. _____ Direction _____	
No. Stories single <input checked="" type="checkbox"/>		34. Prepared by: KTG	
Single Pile _____ NA <input checked="" type="checkbox"/>		35. Organization KHC	
Double Pile _____		36. Date Fall, 1979	
Floor Plan N/A <input type="checkbox"/>		37. Revision Dates 38. Staff Review	
Structural Fabric Brick A. <input checked="" type="checkbox"/> B. <input type="checkbox"/>		*1972 survey form; Historical Green County, Ky., Green Co. Hist. Soc.; Green County Factbook, Lowe & Scott, pp.3-4, 27-28; Allen's History p. 145.	
Decorative Fabric Common bond A. <input checked="" type="checkbox"/> B. <input type="checkbox"/>			
Roof Form Gable			
19. History held to be site of camp of Long Hunters, 22 men led by Col. James Knox 1768-1770; carved on nearby beech tree: "2300 skins lost/ Ruination by God"; they were from N. Carolina; congregation org. by Trabue & Haskins families, who were also incorporators of			
20. Significance Architecture: the church is the only surviving example in the county of early 19th century religious architecture. Site also important (over)			
21. Source of Information			

19. History (cont.)
New Athens Academy (Gn-G-12)

20. (cont.) because of its association with early exploration and settlement
by hunters who camped in the region.

KENTUCKY HISTORIC RESOURCE INVENTORY SUPPLEMENT
BOUNDARY AND LOCATION INFORMATION

Historic Property Name MT. GILEAD BAPTIST CHURCH Site # GN-19

Multiple Resource/~~Thematic~~ Nomination Title GREEN COUNTY

U.T.M. Coordinates - List multiple UTMs if property is ten or more acres.

A. 16 643620 4114800 D. _____

B. _____ E. _____

C. _____ F. _____

Verbal Boundary Description

Acreage 2.2 ACRES

BEGINNING AT POINT (A) ON N SIDE HWY 767 WHERE SKENHOUSE BRANCH PASSES UNDER SAID HIGHWAY, RUNNING NORTHWARD ALONG SAID BRANCH AS IT COURSES TO A POINT (B) ON W SIDE OF HASKINSVILLE - MT. GILEAD RD. NEAR SAID ROAD APPROXIMATELY 100 YARDS FROM BEGINNING, THENCE S ALONG SAID ROAD TO ITS INTERSECTION WITH HWY 767 (C) THENCE W ALONG THE NORTHERN EDGE OF HWY 767 TO THE BEGINNING.

Sketch of Site Plan (Showing outbuildings, structures, landscape features and the site boundary as described above.)

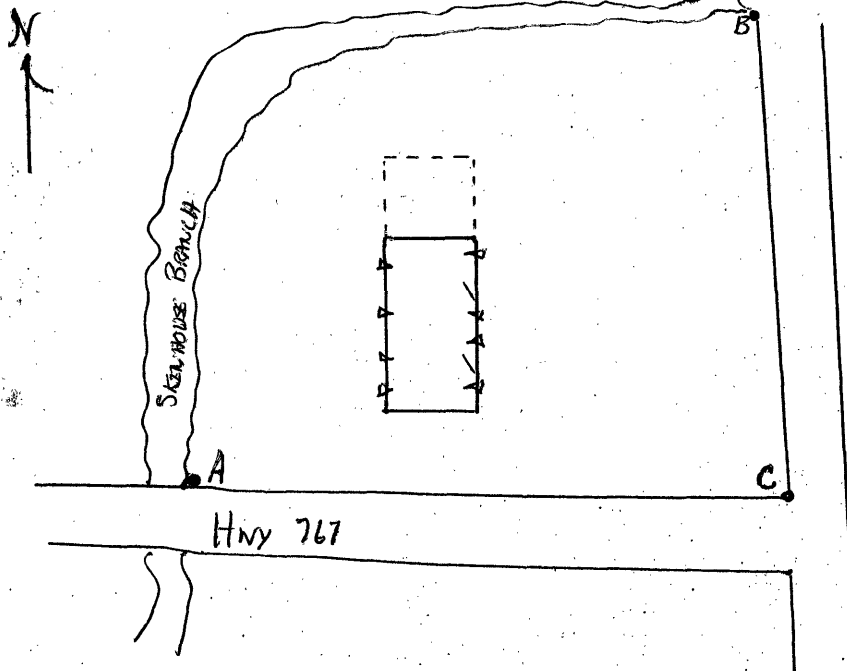

Official Courthouse Property Reference: