

PH 0664251

3.1.78

DATA SHEET

UNITED STATES DEPARTMENT OF THE INTERIOR  
NATIONAL PARK SERVICE

FOR NPS USE ONLY	
RECEIVED	MAR 1 1978
DATE ENTERED	JUN 7 1978

# NATIONAL REGISTER OF HISTORIC PLACES INVENTORY -- NOMINATION FORM

SEE INSTRUCTIONS IN HOW TO COMPLETE NATIONAL REGISTER FORMS  
TYPE ALL ENTRIES -- COMPLETE APPLICABLE SECTIONS

## 1 NAME

HISTORIC

Rockland Main Street Historic District

AND/OR COMMON

## 2 LOCATION

STREET & NUMBER

main st from Summer St to Winter St

CITY, TOWN

Rockland

VICINITY OF

1st

STATE

Maine

CODE

23

COUNTY

Knox

CODE

013

## 3 CLASSIFICATION

<sup>ok</sup> CATEGORY

DISTRICT

BUILDING(S)

STRUCTURE

SITE

OBJECT

OWNERSHIP

PUBLIC

PRIVATE

BOTH

PUBLIC ACQUISITION

IN PROCESS

BEING CONSIDERED

STATUS

OCCUPIED

UNOCCUPIED

WORK IN PROGRESS

ACCESSIBLE

YES: RESTRICTED

YES: UNRESTRICTED

NO

PRESENT USE

AGRICULTURE

COMMERCIAL

EDUCATIONAL

ENTERTAINMENT

GOVERNMENT

INDUSTRIAL

MILITARY

MUSEUM

PARK

PRIVATE RESIDENCE

RELIGIOUS

SCIENTIFIC

TRANSPORTATION

OTHER:

## 4 OWNER OF PROPERTY

NAME

Multiple Ownership

STREET & NUMBER

CITY, TOWN

VICINITY OF

STATE

## 5 LOCATION OF LEGAL DESCRIPTION

COURTHOUSE,  
REGISTRY OF DEEDS, ETC.

Knox County Registry of Deeds

STREET & NUMBER

CITY, TOWN

Rockland

STATE  
Maine

## 6 REPRESENTATION IN EXISTING SURVEYS

TITLE

DATE

FEDERAL  STATE  COUNTY  LOCAL

DEPOSITORY FOR  
SURVEY RECORDS

CITY, TOWN

STATE

# 7 DESCRIPTION

<input checked="" type="checkbox"/> EXCELLENT	<input type="checkbox"/> DETERIORATED	<input type="checkbox"/> UNALTERED	<input checked="" type="checkbox"/> ORIGINAL SITE
<input type="checkbox"/> GOOD	<input type="checkbox"/> RUINS	<input checked="" type="checkbox"/> ALTERED	<input type="checkbox"/> MOVED
<input type="checkbox"/> FAIR	<input type="checkbox"/> UNEXPOSED		DATE _____

## DESCRIBE THE PRESENT AND ORIGINAL (IF KNOWN) PHYSICAL APPEARANCE

The Main Street Historic District in Rockland comprises some sixteen architecturally and historically significant buildings. Dating from the mid-19th century, few of the district's buildings have undergone major alteration. The district is located in the center of the coastal city of Rockland and retains the scale and density of a prosperous 19th-century commercial district.

### Buildings contributing to the character of the district:

Map #	Street #	Main Street - East Side
1	335-359	Burpee and Singhi Block, by 1873 Italianate, 3 stories, brick with wood and stone trim
2	371-377	Ulmer Block, 1858 Italianate, 2 stories, frame with clapboarded exterior
3	387	Thorndike Hotel, 1854-55 Italianate, 3 stories, brick with wood and stone trim
4	401	Phoenix Block, 1856 Originally Italianate, 3 stories, brick with wood and stone trim, Mansard 4th story with slate sheathing added after 1873
5	407	Masonic Block, by 1873 Italianate, originally 3 stories, brick with stone trim, reduced to 2 stories in 20th century
6	419	Custom House Block, 1853 Italianate, 3 stories, brick with cast iron trim
7	423-429	Kimball Block, 1853 Greek Revival, 3 stories, brick with wood and stone trim
8	431-439	Wise and Kimball Block, by 1873 Italianate, 3 stories, brick with wood and stone trim
9		Berry Block, by 1873 Originally Italianate, 2 stories, brick with wood and stone trim, facade remodeled and 3rd story added c. 1900
10	447-449	Hewett Block, by 1873 Italianate, 3 stories, brick with wood and stone and cast iron trim
11	374	Security Trust Building, 1912 R. Clipstone Sturgis of Boston, Architect Colonial Revival, 1 story, brick with wood and stone trim

# 8 SIGNIFICANCE

PERIOD	AREAS OF SIGNIFICANCE -- CHECK AND JUSTIFY BELOW			
<input type="checkbox"/> PREHISTORIC	<input type="checkbox"/> ARCHEOLOGY-PREHISTORIC	<input type="checkbox"/> COMMUNITY PLANNING	<input type="checkbox"/> LANDSCAPE ARCHITECTURE	<input type="checkbox"/> RELIGION
<input type="checkbox"/> 1400-1499	<input type="checkbox"/> ARCHEOLOGY-HISTORIC	<input type="checkbox"/> CONSERVATION	<input type="checkbox"/> LAW	<input type="checkbox"/> SCIENCE
<input type="checkbox"/> 1500-1599	<input type="checkbox"/> AGRICULTURE	<input type="checkbox"/> ECONOMICS	<input type="checkbox"/> LITERATURE	<input type="checkbox"/> SCULPTURE
<input type="checkbox"/> 1600-1699	<input checked="" type="checkbox"/> ARCHITECTURE	<input type="checkbox"/> EDUCATION	<input type="checkbox"/> MILITARY	<input type="checkbox"/> SOCIAL/HUMANITARIAN
<input type="checkbox"/> 1700-1799	<input type="checkbox"/> ART	<input type="checkbox"/> ENGINEERING	<input type="checkbox"/> MUSIC	<input type="checkbox"/> THEATER
<input checked="" type="checkbox"/> 1800-1899	<input checked="" type="checkbox"/> COMMERCE	<input type="checkbox"/> EXPLORATION/SETTLEMENT	<input type="checkbox"/> PHILOSOPHY	<input type="checkbox"/> TRANSPORTATION
<input type="checkbox"/> 1900-	<input type="checkbox"/> COMMUNICATIONS	<input type="checkbox"/> INDUSTRY	<input type="checkbox"/> POLITICS/GOVERNMENT	<input type="checkbox"/> OTHER (SPECIFY)
		<input type="checkbox"/> INVENTION		

SPECIFIC DATES

BUILDER/ARCHITECT

## STATEMENT OF SIGNIFICANCE

That section of Main Street in Rockland included in the historic district is of significance from two important aspects; 1. It contains a remarkably well preserved collection of commercial buildings which possess rare uniformity both chronologically and in architecture and scale and, 2. It demonstrates the amazing resilience and vitality of this thriving mid-nineteenth century city in the wake of a major disaster.

Originally a part of Thomaston, where settlement took place along the St. George River by the mid-17th century, the area on the shore of Penobscot Bay now encompassed by the City of Rockland was not occupied until the late 18th century. Lime-burning, an industry later to become a main stay of 19th century Rockland's economy was begun in the region during the 1730's but it was not until 1785 that George Ulmer established the first such enterprise on the bay shore.

As a measure of the growth of early Rockland, the first tavern was established in 1793 and two years later the first post office as well as the first meeting house. After 1815 the development of this section was steady and began to outstrip the earlier centers of settlement. Rockland harbor, although somewhat exposed became the focal point of three major industries, shipbuilding, lime-burning in the great kilns which lined the shore, and salt manufacture (the latter died out by mid-century). In 1848, after much acrimonious debate, the bay shore area separated itself and was incorporated as East Thomaston. Two years later the name was changed to Rockland in recognition of the now preeminent limestone processing industry. By 1850 the population had reached 2,600.

In 1853 a series of fires beset the Rockland business district on Main Street, the east side of which backs up on the waterfront. These occurred on January 1, February 28, March 28 and May 22. The last of these was particularly disastrous beginning at the site of the present Pillsbury Block (13) and destroying all the buildings on the west side of Main Street between Spring (now Museum) Street and Limerock Road and most of those immediately opposite. There was of course speculation that these conflagrations were the work of an "incendiary", but no definite proof was ever produced.

Rebuilding was begun immediately and such was the economic climate in the thriving town that in spite of the capital losses a business boom resulted. It is interesting to note that two of the first three blocks erected, the Kimball Block (7) and the first Berry Block (15) were designed in the Greek Revival style which had dominated the earlier streetscape. All the subsequent buildings, however,

# 9 MAJOR BIBLIOGRAPHICAL REFERENCES

Eaton, Cyrus, History of Thomaston, Rockland and South Thomaston, Maine.  
Hallowell, 1865

Leading Businessmen of Bangor, Rockland and Vicinity. Mercantile Publishing Co.,  
Boston, 1888

# 10 GEOGRAPHICAL DATA

ACREAGE OF NOMINATED PROPERTY

4 2 1/2 Frank Beard 6.5.78

UTM REFERENCES

A | 1,9 | | 4,9,1 | 2,4,0 | | 4,8 | 8,3 | 2,1,0 |  
ZONE EASTING NORTHING  
C | | | | | | | | | | | | |

B | | | | | | | | | | | | |  
ZONE EASTING NORTHING  
D | | | | | | | | | | | | |

VERBAL BOUNDARY DESCRIPTION Beginning at the corner of Winter Street, the district boundary runs north along the east side of Museum Street to the rear property line of the Security Trust Block(11). The line then runs north along the rear property lines on the south side of School Street to the west property line of the Thorndike and Hix Block (18) which it follows northerly to School Street and then turns northerly to follow the rear property lines on the west side of Main Street to Limerock Street where it turns easterly along the south side of said street and,

LIST ALL STATES AND COUNTIES FOR PROPERTIES OVERLAPPING STATE OR COUNTY BOUNDARIES

STATE	CODE	COUNTY	CODE
STATE	CODE	COUNTY	CODE

# 11 FORM PREPARED BY

NAME / TITLE Frank A. Beard, Historian  
Robert L. Bradley, Architectural Historian

ORGANIZATION Maine Historic Preservation Commission DATE January, 1978

STREET & NUMBER 242 State Street TELEPHONE (207)-289-2133

CITY OR TOWN Augusta, STATE Maine

# 12 STATE HISTORIC PRESERVATION OFFICER CERTIFICATION

THE EVALUATED SIGNIFICANCE OF THIS PROPERTY WITHIN THE STATE IS:

NATIONAL \_\_\_ STATE \_\_\_ LOCAL

As the designated State Historic Preservation Officer for the National Historic Preservation Act of 1966 (Public Law 89-665), I hereby nominate this property for inclusion in the National Register and certify that it has been evaluated according to the criteria and procedures set forth by the National Park Service.

STATE HISTORIC PRESERVATION OFFICER SIGNATURE Earle S. Shatteworth, Jr. DATE 2/9/78  
TITLE S.H.P.O.

FOR NPS USE ONLY	
I HEREBY CERTIFY THAT THIS PROPERTY IS INCLUDED IN THE NATIONAL REGISTER	
DIRECTOR, OFFICE OF ARCHITECTURE AND HISTORIC PRESERVATION	KEEPER OF THE NATIONAL REGISTER
ATTEST: <u>Walter Cole</u>	DATE <u>6/7/78</u>
KEEPER OF THE NATIONAL REGISTER	DATE <u>6.5.78</u>

UNITED STATES DEPARTMENT OF THE INTERIOR  
NATIONAL PARK SERVICE

FOR NPS USE ONLY  
RECEIVED MAR 1 1978  
DATE ENTERED JUN 7 1978

NATIONAL REGISTER OF HISTORIC PLACES  
INVENTORY -- NOMINATION FORM

MAIN STREET HISTORIC DISTRICT

CONTINUATION SHEET

ITEM NUMBER 4 PAGE 2

Property Owners  
Main Street - East Side

Map #	Street #	Property Owners
1	335-359	Burpee and Singhi Block- David Bjork, <sup>30 Chestnut St.</sup> Rockland, Maine ✓
2	371-377	✓ Ulmer Block- Joy Realty Co., <sup>377 Main St</sup> Rockland, Maine ✓
3	387	✓ Thorndike Hotel- Nathan Berliawsky, <sup>387 Main St.</sup> Rockland, Maine ✓
4	401	✓ Phoenix Block- Evelyn Kohn, <sup>Somerset Fl 06 Central Villa</sup> West Palm Beach, Florida
5	407	✓ Masonic Block- <del>Franway Realty</del> , <sup>Sidney Epstein - 351 Newbury St</sup> Boston, Massachusetts
6	419	✓ Custom House Block- Knox Broadcasting, <sup>415 Main St</sup> Inc. Rockland, Maine
7	423-429	✓ Kimball Block- Knox Mining Corp., <sup>429 Main St</sup> Rockland, Maine
8	431-439	✓ Wise and Kimball Block- Barbara Emple, <sup>40 Bruce Rd</sup> Brewer, <sup>BANGOR</sup> Maine
9		Berry Block - Paul Arvidson, <sup>57 Samoset Rd.</sup> Rockland, Maine
10	447-449	Hewett Block - Barry Faber, <sup>449 Main St.</sup> Rockland, Maine
11	374	Security Trust Building - Bruce J. MacDiarmid, <sup>Upper Chestnut St.</sup> Camden, Maine
12	376	Big L Discount Health and Beauty Aids - Kennedy Crane II, Battery Pt. Owls Head, Maine
13		✓ Pillsbury Block - Kennedy Crade II, <sup>Battery Point</sup> Owls Heads, Maine
14		✓ Coffin's - Levi Coffin, <sup>43 Acadia Drive</sup> Rockland, Maine
15	410	Berry Block - David Achorn - Kelly Crie, <sup>14 Summer St.</sup> Rockland, Maine
16		Berry Block - Robert Gregory, Owls Head, Maine School Street - South side <sup>P.O. Box 431</sup> Rockland, ME 04841
17	10	House - Samuel Collins, <sup>10 School St.</sup> Rockland, Maine
18	18	✗ Thorndike & Hix Block - M. Rollins, Union, Maine

UNITED STATES DEPARTMENT OF THE INTERIOR  
NATIONAL PARK SERVICE

**NATIONAL REGISTER OF HISTORIC PLACES  
INVENTORY -- NOMINATION FORM**

FOR NPS USE ONLY	
RECEIVED	MAR 1 1978
DATE ENTERED	JUN 7 1978

CONTINUATION SHEET

ITEM NUMBER 7 PAGE 2

Map # Street #

13 Pillsbury Block, 1859, remodeled c. 1915  
Originally Mansard, 4 stories, brick with stone and metal  
trim, facade remodeled c. 1915 to include replacement of  
Mansard roof with projecting horizontal cornice

15 410 Berry Block, 1853-54  
Greek Revival, 3 stories, brick with wood and stone trim

16 Berry Block, 1856  
Italianate, 3 stories, brick with wood and stone trim

School Street - South Side

17 10 House, by 1859  
Italianate, 2½ stories, frame with clapboarded exterior

18 18 Thorndike and Hix Block, 1905-06  
Colonial Revival, 3 stories, brick with wood and stone trim

Nonconforming intrusions detracting from the integrity of the district  
Main Street - West Side

12 376 Big L Discount Health and Beauty Aids  
Contemporary, 1 story

14 Coffin's  
Contemporary, 1 story

UNITED STATES DEPARTMENT OF THE INTERIOR  
NATIONAL PARK SERVICE

**NATIONAL REGISTER OF HISTORIC PLACES  
INVENTORY -- NOMINATION FORM**

FOR NPS USE ONLY	
RECEIVED	MAR 1 1978
DATE ENTERED	JUN 7 1978

CONTINUATION SHEET

ITEM NUMBER 8 PAGE 2

---

beginning the following year, bespoke the new movement in architecture and were either Italianate or Mansard in design.

As further evidence of the resiliency of the community, it was incorporated as a city in 1854, the eighth in the state. By 1860 the population had burgeoned to 7,317.

UNITED STATES DEPARTMENT OF THE INTERIOR  
NATIONAL PARK SERVICE

**NATIONAL REGISTER OF HISTORIC PLACES  
INVENTORY -- NOMINATION FORM**

FOR NPS USE ONLY

RECEIVED MAR 1 1978

DATE ENTERED JUN 7 1978

CONTINUATION SHEET

ITEM NUMBER 10 PAGE 2

crossing Main Street, along the south side of the alley opposite, to the rear property line of the Hewett Block (10) where it turns southerly running along the rear property lines of the buildings on the east side of Main Street to Winter Street and westerly along the north side of said street to the point of beginning.



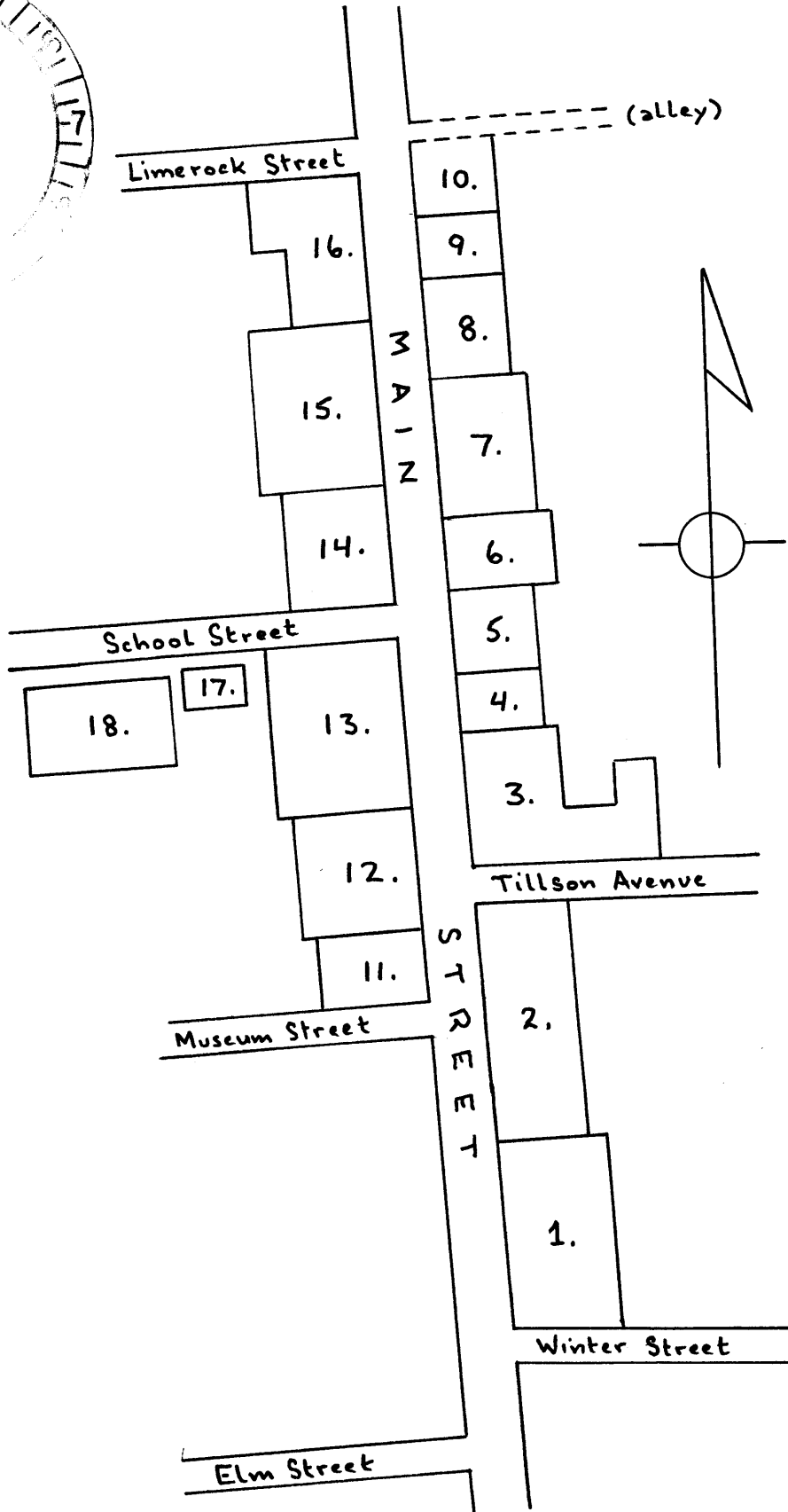
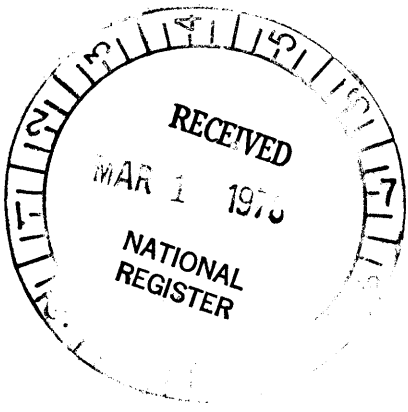

Rockland Main Street Historic District