

**United States Department of the Interior
Heritage Conservation and Recreation Service**

**National Register of Historic Places
Inventory—Nomination Form**

See instructions in *How to Complete National Register Forms*
Type all entries—complete applicable sections

For HCERS use only

received SEP 17 1981

date entered

NOV 12 1981

1. Name

historic Fields Corner Municipal Building

and/or common same

2. Location

street & number 1 Arcadia Street, corner 195 Adams Street not for publication

city, town Boston (Dorchester) vicinity of congressional district Ninth

state Massachusetts code 025 county Suffolk code 025

3. Classification

Category	Ownership	Status	Present Use
<input type="checkbox"/> district	<input checked="" type="checkbox"/> public	<input type="checkbox"/> occupied	<input type="checkbox"/> agriculture <input type="checkbox"/> museum
<input checked="" type="checkbox"/> building(s)	<input type="checkbox"/> private	<input checked="" type="checkbox"/> unoccupied	<input type="checkbox"/> commercial <input type="checkbox"/> park
<input type="checkbox"/> structure	<input type="checkbox"/> both	<input type="checkbox"/> work in progress	<input type="checkbox"/> educational <input type="checkbox"/> private residence
<input type="checkbox"/> site	Public Acquisition	Accessible	<input type="checkbox"/> entertainment <input type="checkbox"/> religious
<input type="checkbox"/> object	<input type="checkbox"/> in process	<input checked="" type="checkbox"/> yes: restricted	<input checked="" type="checkbox"/> government <input type="checkbox"/> scientific
	<input type="checkbox"/> being considered	<input type="checkbox"/> yes: unrestricted	<input type="checkbox"/> industrial <input type="checkbox"/> transportation
		<input type="checkbox"/> no	<input checked="" type="checkbox"/> other: vacant

4. Owner of Property

name City of Boston Public Facilities Dept. Attn: Michael Killion

street & number 137 Milk Street

city, town Boston vicinity of state Massachusetts

5. Location of Legal Description

courthouse, registry of deeds, etc. Suffolk County Registry of Deeds

street & number Pemberton Square

city, town Boston state Massachusetts

6. Representation in Existing Surveys

title 1) Inventory of Historic Assets of the Commonwealth of Massachusetts has this property been determined eligible? yes no

date 1977 federal state county local

depository for survey records Massachusetts Historical Commission

city, town Boston 02109 (CONTINUED NEXT PAGE) state MA

7. Description

Condition		Check one	Check one
<input type="checkbox"/> excellent	<input type="checkbox"/> deteriorated	<input checked="" type="checkbox"/> unaltered	<input checked="" type="checkbox"/> original site
<input type="checkbox"/> good	<input type="checkbox"/> ruins	<input type="checkbox"/> altered	<input type="checkbox"/> moved
<input checked="" type="checkbox"/> fair	<input type="checkbox"/> unexposed		date _____

Describe the present and original (if known) physical appearance

7. Description

The Fields Corner Municipal Building is located in the Fields Corner section of Dorchester, Boston's largest neighborhood, at the corner of Adams and Arcadia Streets. It is situated on a small, sparsely landscaped lot near the intersection of the main thoroughfares of Dorchester Avenue and Adams Street.

The Municipal Building is a 2½-story brick structure, erected in 1874 and most probably designed by City Architect George A. Clough. The building is H-shaped in plan, with gabled wings and High Victorian Gothic styling. Limestone trim is used extensively in window lintels and stringcourses. Unifying the various masses of the structure are fenestration detailing, an arcaded brick stringcourse at the cornice, parapeted dormers, and a slate tiled roof. Paired windows emphasize the symmetry of the building. The first and attic floors have pointed arch windows, while the second story has strictly rectangular openings; bold limestone architraves ornament both types.

The Adams Street facade of the Municipal Building is three bays long, with a three-story central pavilion featuring a parapeted gable and a pointed arch entrance. The corresponding western wing of the building is distinguished by a cupola with its original weathervane. A decorative cast iron fence runs along the perimeter of the lot and up the high flight of stairs to the facade entrance.

8. Significance

Period	Areas of Significance—Check and justify below			
<input type="checkbox"/> prehistoric	<input type="checkbox"/> archeology-prehistoric	<input type="checkbox"/> community planning	<input type="checkbox"/> landscape architecture	<input type="checkbox"/> religion
<input type="checkbox"/> 1400-1499	<input type="checkbox"/> archeology-historic	<input type="checkbox"/> conservation	<input type="checkbox"/> law	<input type="checkbox"/> science
<input type="checkbox"/> 1500-1599	<input type="checkbox"/> agriculture	<input type="checkbox"/> economics	<input type="checkbox"/> literature	<input type="checkbox"/> sculpture
<input type="checkbox"/> 1600-1699	<input checked="" type="checkbox"/> architecture	<input type="checkbox"/> education	<input type="checkbox"/> military	<input type="checkbox"/> social/
<input type="checkbox"/> 1700-1799	<input type="checkbox"/> art	<input type="checkbox"/> engineering	<input type="checkbox"/> music	<input type="checkbox"/> humanitarian
<input checked="" type="checkbox"/> 1800-1899	<input type="checkbox"/> commerce	<input type="checkbox"/> exploration/settlement	<input type="checkbox"/> philosophy	<input type="checkbox"/> theater
<input type="checkbox"/> 1900-	<input type="checkbox"/> communications	<input type="checkbox"/> industry	<input checked="" type="checkbox"/> politics/government	<input type="checkbox"/> transportation
		<input type="checkbox"/> invention		<input type="checkbox"/> other (specify)

Specific dates 1874-1875

Builder/Architect George A. Clough (?)

Statement of Significance (in one paragraph)

8. Significance

The Fields Corner Municipal Building retains integrity of location, design, materials and workmanship. It is significant as a fine example of the High Victorian Gothic style and is a unique example of this style in the Dorchester area. Additionally, the building is an example of the work of Boston's first City Architect, George A. Clough, and is significant for its role in community development. The property thus meets Criteria A and C of the National Register.

Although the building permits and records no longer exist for the Municipal Building, it is generally thought that Clough (1843-ca. 1916) - who began designing schools for the City in 1872 and became the first City Architect in 1873 - is the building's architect. Clough learned drafting from his father, who was a Maine shipbuilder, and studied under George Snell of the Boston firm of Snell & Gregerson. He opened his own firm in 1869.

Clough's most prominent buildings are the Suffolk County Courthouse in Pemberton Square (1888-89) and Boston Latin and English High School (1877). He worked in a number of eclectic styles and is credited with introducing "the German system, which provides for constructing the building around open courts, thus affording ample light and ventilation to all parts of it..." Although not built around an open court as were the Courthouse and High School, the Municipal Building does provide generous light and ventilation through its H-plan and paired fenestration. Symmetry and balance-- of plan, scale, and massing -- also characterize most of Clough's work. George Clough is credited with designing over 25 schools for the City of Boston, several local churches, and numerous other municipal buildings and public and charitable institutions in the Boston area.

Besides being significant for its architectural merit and association with the first City Architect, the Municipal Building is important for its strong community identity and for its contribution to the civic and cultural history of Dorchester. The building was originally constructed as a replacement for the old District 11 Police Station that was located on Hancock Street. The eastern wing of the Municipal Building, facing Adams Street, housed the new police station, with jail cells (still remaining) in the basement. The rear (western) wing was designed as the Dorchester branch of the Boston Public Library, the first such branch system in the United States. The building also served for a time as a district court.

The Municipal Building is also significant for its visual impact on the neighborhood, and its preservation is seen by the City of Boston as a key to the revitalization of Fields Corner.

9. Major Bibliographical References

See continuation sheet.

10. Geographical Data

ACREAGE NOT VERIFIED

Acreeage of nominated property 7,500 square feet

Quadrangle name Boston South

UTM NOT VERIFIED

Quadrangle scale 1:25,000

UMT References

A

1	9	3	3	0	1	4	0	4	6	8	5	1	5	0
Zone			Easting				Northing							

B

Zone			Easting				Northing							

C

Zone			Easting				Northing							

D

Zone			Easting				Northing							

E

Zone			Easting				Northing							

F

Zone			Easting				Northing							

G

Zone			Easting				Northing							

H

Zone			Easting				Northing							

Verbal boundary description and justification

Please refer to the attached map.

List all states and counties for properties overlapping state or county boundaries

state code county code

state code county code

11. Form Prepared By

name/title Candace Jenkins, National Register Coordinator/by Boston Landmarks Commission and /by Neighborhood Development Agency

organization Massachusetts Historical Commission date July 1981

street & number 294 Washington Street telephone 617 727-8470

city or town Boston state Massachusetts

12. State Historic Preservation Officer Certification

The evaluated significance of this property within the state is:

national state local

As the designated State Historic Preservation Officer for the National Historic Preservation Act of 1966 (Public Law 89-665), I hereby nominate this property for inclusion in the National Register and certify that it has been evaluated according to the criteria and procedures set forth by the Heritage Conservation and Recreation Service.

State Historic Preservation Officer signature Patricia L. Weslowski

title Executive Director, Mass. Historical Commission date 9/11/81

For HCERS use only

I hereby certify that this property is included in the National Register

Entered in the National Register

date 11/12/81

Keeper of the National Register

Attest:

date

Chief of Registration

**NATIONAL REGISTER OF HISTORIC PLACES
INVENTORY -- NOMINATION FORM**

FOR HCRS USE ONLY

RECEIVED SEP 17 1981

DATE ENTERED NOV 12 1981

CONTINUATION SHEET

ITEM NUMBER 6 & 9 PAGE 1

6. Representation in Existing Surveys

(continued)

2. Dorchester/Mattapan Preservation Survey
Boston Landmarks Commission, Boston City Hall, Boston, MA
1977

9. Bibliographical References

Herndon, Richard. Boston of Today, Boston, Boston Post Publishing Co., 1892, p. 186.

King, Moses. King's Handbook of Boston, Boston, 1878, p. 118-119.

National Cyclopedia of American Biography, James T. White & Co., 1892, Vol. 7, p. 480.

"Proceedings at the Dedication of the Dorchester Branch Library," January 18, 1875,
City Document #24, City of Boston.

Whitehill, Walter, M. Boston Public Library: A Centennial History, Cambridge, MA.
1956, p. 134-138.

Withey, Henry F. & Elsie R. Biographical Dictionary of American Architects
(Deceased), Los Angeles, 1956, p. 127.

Who Was Who in America, THE A.N. Marquis Co., Chicago, 1943, Vol. 1, Copy 3, p. 232.

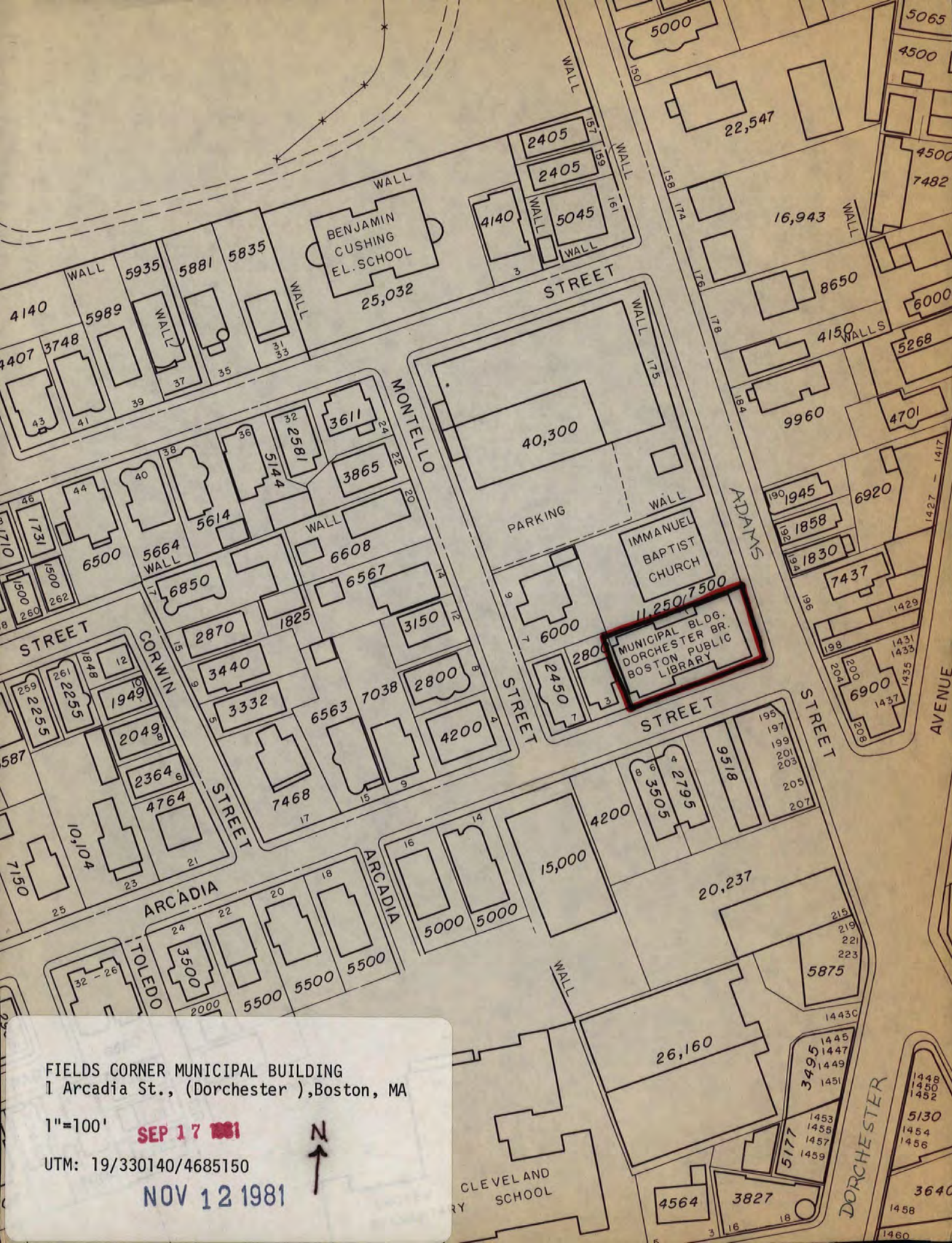

FIELDS CORNER MUNICIPAL BUILDING
 1 Arcadia St., (Dorchester), Boston, MA

1"=100'

SEP 17 1981

UTM: 19/330140/4685150

NOV 12 1981



CLEVELAND
 SCHOOL

DORCHESTER

DUE 10/17/81 - 11/1/81

dnr-3

Name Fields Corner Municipal Building
State, County MA, Suffolk Fed Nom or Request-Agency _____
Working Number 9.17.81.340 Federal Register Date _____

Nomination
 Determination of Eligibility
 On Nomination Form

Bldg(s)
 Site
 Object
 Structure
 District

Within:
 Multiple Resource Area
 Thematic Group

Maps 1
Photos 5

Nomination prepared by:
 State Staff
 Local
 Other

Action:
 ACCEPT
 RETURN 10/2/81
 REJECT

Check if Appropriate:
 State Request for Review
 Keeper's Decision to Review
 2nd Return

I. Evaluation of Resource (cont. on back if necessary)

II. Evaluation of Nomination

	Good	Adequate	Poor	Comments
1. Descriptive Statement Short Format <input type="checkbox"/> Yes <input type="checkbox"/> No				
2. Significance Statement Short Format <input type="checkbox"/> Yes <input type="checkbox"/> No				
3. Concepts/Integrity				
4. Concepts/Criteria				
5. Concepts/Boundaries				
6. Contextual Evaluation				

General Comments (cont. on back if necessary):

Reviewer/Date _____

See Attached _____

United States Department of the Interior
National Park Service

Name of Property Fields Corner Municipal Building
State, County MA Suffolk County
Federal Agency _____

The above nomination is being returned to you because of problems in the areas checked below and/or on the back of this form. Please return this form when the nomination is resubmitted.

Technical Review

Name

Location

Classification
 Category Ownership Status Present Use

Owner of Property

Location of Legal Description

Representation in Existing Surveys

Description
 Condition Original Site/Moved (w/date)

Significance
 Period Areas of Significance Specific Dates

Major Bibliographical References

Geographical Data
 Acreage Quad Name Quad Scale UTM
 Verbal Boundary Description and/or Site Plan or Tax Map

Form Prepared By

Certification
 Level of Significance SHPO Signature Federal Signature

Photographs
 Missing Not Adequate in Quality

Maps
 USGS Map Site Plan/Sketch Map Historic District Map

Comments:

Substantive Review Problems (see reverse)

Signed Delores Byers 10/2/81

Description

- Incomplete/Inaccurate: _____
- Alterations: _____
- Dates: _____
- Boundary Selection/Justification: _____
- Other: _____

Significance

- Too Weak or General: _____
- Poorly Related to Resource: _____
- Confusing/Incomplete: _____
- Context: _____
- Integrity: _____
- Period of Significance Unclear: _____
- Exception(s) to Criteria not Justified: _____
- Other: _____

Bibliography: _____

Geographical Data

- Acreage: _____
- VBD: _____

Certification: _____

Photographs:

- Inadequate Coverage: _____
- Poorly Labeled/Not Keyed to Map
- Other: _____

Maps

- | | | |
|-------------------------------|---------------------------------|-------------------------|
| <input type="checkbox"/> USGS | <input type="checkbox"/> Sketch | |
| <input type="checkbox"/> | <input type="checkbox"/> | Missing |
| <input type="checkbox"/> | <input type="checkbox"/> | Location of Resource(s) |
| <input type="checkbox"/> | <input type="checkbox"/> | Boundary Lines |
| <input type="checkbox"/> | <input type="checkbox"/> | Discrepancies |
| <input type="checkbox"/> | <input type="checkbox"/> | Other |

Comments

DUE 12/20/81

dnr-3

2nd Control

Name Fields Corner Municipal Building
State, County MA, Suffolk Fed Nom or Request-Agency _____
Working Number 9.17.81.340 Federal Register Date 2.2.82

Nomination Bldg(s) Within:
 Determination of Eligibility Site Multiple Resource Area
 On Nomination Form Object Thematic Group
 Structure
 District

Maps 1/1
Photos 5

Nomination prepared by:
 State Staff Action: National Register Check if Appropriate:
 Local ACCEPT 11/12/81 State Request for Review
 Other RETURN _____ Keeper's Decision to Review
 REJECT _____ 2nd Return

I. Evaluation of Resource (cont. on back if necessary)

II. Evaluation of Nomination

	Good			Comments
	Adequate	Poor		
1. Descriptive Statement Short Format <input type="checkbox"/> Yes <input type="checkbox"/> No				
2. Significance Statement Short Format <input type="checkbox"/> Yes <input type="checkbox"/> No				
3. Concepts/Integrity				
4. Concepts/Criteria				
5. Concepts/Boundaries				
6. Contextual Evaluation				

General Comments (cont. on back if necessary):

Reviewer/Date _____

See Attached _____



FIELDS CORNER MUNICIPAL BUILDING
1 Arcadia Street
Boston (Dorchester), MA.

SEP 17 1981

Negative filed at Neighborhood Development
Agency, 182 Tremont St., Boston

view of Arcadia St. (southerly) elevation
looking from the southwest

1981

10F5

NOV 12 1981



FIELDS CORNER MUNICIPAL BUILDING
1 Arcadia Street
Boston (Dorchester), MA

SEP 17 1981

Negative filed at Neighborhood Development
Agency, 182 Tremont St., Boston

view of Adams St. (easterly) elevation
looking from the southeast

1981

2085

NOV 12 1981



FIELDS CORNER MUNICIPAL BUILDING
1 Arcadia Street
Boston (Dorchester), MA

SEP 17 1981

Negative filed at Neighborhood Development
Agency, 182 Tremont St., Boston

view of northerly elevation looking from
the northeast.

NOV 12 1981

1981

30F5



FIELDS CORNER MUNICIPAL BUILDING
1 Arcadia Street
Boston (Dorchester), MA

SEP 17 1981

Negative filed at Neighborhood Development
Agency, 182 Tremont St., Boston

detail of Arcadia St. (southerly) elevation
looking from the southwest

1981

40F5

NOV 12 1981



FIELDS CORNER MUNICIPAL BUILDING
1 Arcadia Street
Boston (Dorchester), MA

SEP 17 1981

Negative filed at Neighborhood Development
Agency, 182 Tremont St., Boston

detail of perimeter fencing along Adams St.
looking from the north.

1981

50F5

NOV 12 1981



CONVERSION SCALES

Feet	Meters
15000	4500
14000	4000
13000	3500
12000	3000
11000	2500
10000	2000
9000	1500
8000	1000
7000	500
6000	0
5000	1500
4000	1000
3000	500
2000	0
1000	500
0	0

Feet / Meters

1	3048
2	6096
3	9144
4	12192
5	15240
6	18288
7	21336
8	24384
9	27432
10	30480

To convert feet to meters multiply by 3048
To convert meters to feet multiply by 3.2808

FIELDS CORNER MUNICIPAL BUILDING
1 Arcadia St.,
Boston (Dorchester), MA.
1"=25,000'
UTM: 19/330140/4685150

Mapped, edited, and published by the Geological Survey
Control by USGS, USC&GS, and Massachusetts Geodetic Survey
Topography by planetree surveys 1943. Revised from aerial photographs taken 1969. Field checked 1970
Selected hydrographic data compiled from USC&GS Charts 246 and 248 (1971). This information is not intended for navigational purposes
Polyconic projection. 1927 North American datum 10,000-foot grid based on Massachusetts coordinate system, mainland zone
1,000-meter Universal Transverse Mercator grid, zone 19
Boundaries in tidewater areas from information supplied by Massachusetts Department of Public Works
Red tint indicates areas in which only landmark buildings are shown

SCALE 1:25,000
1000 0 1000 2000 3000 4000 5000 6000 7000 FEET
1 KILOMETER
CONTOUR INTERVAL 10 FEET
NATIONAL GEODETIC VERTICAL DATUM OF 1929
DEPTH CURVES AND SOUNDINGS IN FEET—DATUM IS MEAN LOW WATER
THE RELATIONSHIP BETWEEN THE TWO DATUM IS VARIABLE
SHORELINE SHOWN REPRESENTS THE APPROXIMATE LINE ON MEAN HIGH WATER
THE MEAN RANGE OF TIDE IS APPROXIMATELY 9.5 FEET
THIS MAP COMPLIES WITH NATIONAL MAP ACCURACY STANDARDS FOR SALE BY U.S. GEOLOGICAL SURVEY, RESTON, VIRGINIA 22092
A FOLDER DESCRIBING TOPOGRAPHIC MAPS AND SYMBOLS IS AVAILABLE ON REQUEST

ROAD CLASSIFICATION
Primary highway, hard surfaced
Secondary highway, hard surfaced
Interstate Route
U.S. Route
State Route
Light-duty road, hard or improved surface
Unimproved road
RECEIVED SEP 17 1979 NATIONAL REGISTER
QUADRANGLE LOCATION
BOSTON SOUTH, MASS.
N4215—W7100/7.5
1970
PHOTOREVISED 1979
AMS 6768 I SE—SERIES V814

NOV 12 1981

Boston

RECEIVED

SEP - 8 1981

MASS. HIST. COMM.

September 8, 1981

Massachusetts Historical Commission
294 Washington Street
Boston, Massachusetts 02108

Attention Patricia L. Weslowski

Re: Fields Corner Municipal Building

To Whom It May Concern:

For the record, the Public Facilities Department supports the City's nomination of the Fields Corner Municipal Building to the National Register of Historic Places.

Very truly yours,

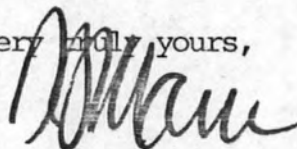

DBM
Donald B. Manson
Director

MK:lv



Kevin H. White, Mayor / PUBLIC FACILITIES DEPARTMENT / 147 Milk Street / Boston, MA 02109



MASSACHUSETTS
HISTORICAL
COMMISSION

COMMONWEALTH OF MASSACHUSETTS
Office of the Secretary of State

294 Washington Street
Boston, Massachusetts
02108
617-727-8470

MICHAEL JOSEPH CONNOLLY
Secretary of State

October 22, 1981

Carol Shull, Acting Keeper
National Register of Historic Places
National Park Service
Department of the Interior
Washington, D.C. 20243

Dear Ms. Shull:

Enclosed you will find the following nomination forms:

Fall River: Fall River Water Works (local)

Northfield: King Philip's Hill (local) resubmission

Boston: Field's Corner Municipal Building (local) resubmission

All have been voted eligible by the State Review Board and have been signed by the State Historic Preservation Officer.

Sincerely,

Candace Jenkins

Candace Jenkins
Registration Director

CJ/pb Enclosure



ENTRIES IN THE NATIONAL REGISTER

STATE MASSACHUSETTS

Date Entered NOV 12 1981

Name

Location

Fields Corner Municipal Building

Boston
Suffolk County

Also Notified

Honorable Edward M. Kennedy
Honorable Paul E. Tsongas
Honorable John Joseph Moakley
Mid-Atlantic Region, NPS

State Historic Preservation Officer
Mrs. Patricia L. Weslowski
Executive Director
Massachusetts Historical Commission
294 Washington Street
Boston, Massachusetts 02108

NR

Eady/ts/11.17.81

For further information, please call the National Register at (202) ~~343-6401~~.

272-3504