

KENTUCKY HISTORIC RESOURCES INVENTORY

Site No. WS-82

1. Historic Name(s) <u>Shawnee High School</u>		22. ADD/County <u>JF</u> 0 5 6	
Original Owner		23. U.S.G.S. Quadrant (15'/75') <u>New Albany</u> 1 3 3	
2. Present Name <u>Shawnee High School</u>		24. UTM Reference 1 6 6 0 3 6 3 0 4 2 3 5 2 6 0	
3. Location <u>4015 Herman Street</u>		Zone Easting Northing	
4. Owner's Name <u>Jefferson County Board of Education</u>		25. Coordinate Accuracy 	
5. Owner's Address <u>Vanhoose Education Center</u> <u>3332 Newburg Road</u> <u>40218</u>		26. Prehistoric Site Object Historic Site Structure Building <u>X</u> Other	
6. Open to Public Yes <u>X</u> No <u> </u>	7. Visible from road Yes <u>X</u> No <u> </u>	8. Ownership Private <u> </u> Local <u>X</u> State <u> </u> Federal <u> </u>	
9. Local Contact/Organization <u>Louisville Landmarks Commission</u>		27. National Register District Name: 	
Site Plan with North Arrow Block <u> </u> Lot <u> </u> See Attached Sheet		11. Architect <u>J. Earl Henry</u>	
		12. Builder <u> </u>	
		13. Date <u>1928</u> A. 7 B. 	
		14. Style <u>Tudor Revival</u> 23 A. B. 	
		15. Original Use <u>educational</u> 9	
		16. Present use <u>educational</u>	
		17. Condition <u>good</u> 2	
18. Description <p>Shawnee High School is an irregular "U" shaped building, three stories in height, with both a built up and a shed roof. It is constructed in brick with stone decorative elements. The central portion is that which contains the entrance and is of stone construction on all three floors. The four-door entry is framed by a compound Tudor arch. An additional Tudor arch rises (over)</p>		No. Stories <u>3</u> D	
		Single Pile <u> </u> NA <u>X</u>	
		Double Pile <u> </u>	
		Floor Plan 0	
		Structural Fabric <u>brick</u> A. c B. 	
		Decorative Fabric <u>Stone</u> A. H B. 	
		Roof Form <u>Built up, Shed</u>	
19. History <p>Shawnee Elementary and High School were named for the area in which they were built. The name Shawnee comes from the Indian name which was chosen for a park in the western part of Louisville. Shawnee is located on Herman Street between 39th and 41st Streets with a 1961 addition facing west Market Street. Thus, the emphasis (over)</p>		30. Historic Theme Primary <u>architecture</u> 0 3 Secondary <u> </u> Other <u> </u>	
20. Significance <p>Shawnee High School is an excellent example of the Tudor Revival Style. The decorative elements of masonry construction are examples of outstanding</p>		31. Endangered Yes <u> </u> No <u> </u>	
21. Source of information <u>Caron Annual Directories of the City of Louisville</u> <u>Jefferson County Board of Education, Louisville,</u> <u>Kentucky. Vertical Files. 1984 (Typewritten).</u>		32. Preservation Project Status 	
		Actual Cost in \$1,000s 	
		33. ATTACH PHOTO <p style="text-align: center;">see attached</p>	
		Roll No. <u> </u>	
		Picture No. <u> </u>	
		Direction <u> </u>	
		34. Prepared by: <p style="text-align: center;">Joanne Weeter Researcher</p>	
		35. Organization <u>Landmarks Commission</u>	
		36. Date <u>March, 1984</u>	
		37. Revision Dates <u> </u> 38. Staff Review <u> </u>	

NOV 2 1984

6/18/84

18. up to surround all three floors and frames the paired windows on both the second and third floors. This central portion is topped by a parapet wall and a balustrade. The inside of the "U" has both stone and brick on the multibayed first floor. Most of the building's windows are grouped in threes or fours, share a common surround, and are framed by irregularly shaped quoins. Two of the bays in the central portion of Shawnee High School are constructed of stone and have incised stone detailing. On the building's west side, a windowed tower, framed at the corners by stone quoins, is located. To its south is a slate-roofed and gabled auditorium. Its entrance projects slightly and has two double doors with a transom above, framed by a Tudor arch. The second floor has two paired, blind windows. The entrance is flanked by a set of long, narrow, paired, nine-over-nine windows with a three-light transom above and framed by quoins. The southeast side of Shawnee High has two sets of windows grouped in fours as well as two single windows, all of which are framed by quoins. This southeast portion, similar to the west side, also has a crenellated tower with arched corbeling and two multi-light flat arched windows. To the south of this east wing is a recently constructed addition. The entire building is topped by a crenellated parapet wall with stone coping. The rear facade of Shawnee High School has simple windows with stone lintels grouped in two threes, and fours with a stone stringcourse above. The outer bays of the first floor have casement windows topped with brick voussoirs.
19. of the original structure is on Herman Street and its residences rather than towards West Market Street, a primarily commercial thoroughfare. Shawnee High School was originally intended for use as both a Junior and Senior High School. It originally housed Western High School for Girls (grades 10-11) and Shawnee Junior High School (grades 7-8). The name of the school was changed to Shawnee High School in 1930 and served as both a junior and senior division. The school continued as a two-division school until the new Shawnee High School was completed in 1962. The building has an addition to the north built in 1961 with subsequent additions made in 1962-1968. A gymnasium was added to the building's southeast wing in 1961-1962. These additions are included in the nomination because they are integral parts of the structure. They are, however, non-contributing structures.
20. craftsmanship and detailing. The main entry into the building is through a compound Tudor arch. Another Tudor arch continues up to the third floor and frames both the second and third floor windows. In addition, a handsome parapet wall and balcony top this portion of the building. The building auditorium is also framed by a beautiful Tudor arch. Both the east and west wings have towers enhanced by a crenellated parapet wall accented by stone coping. All of these elements combine to create a cohesive design, typical of J. Earl Henry's work. Shawnee High School was designed by J. Earl Henry who served as the city architect for schools from 1912 to 1919. Among his most noted buildings are Male High School, (National Register, 1979) and Brandeis Elementary School (National Register, 1980). Henry is particularly noted for his use of architectural detailing which make reference to outstanding historic architecture. Shawnee High School is presently used as an educational building owned by the Jefferson County Board of Education.

KENTUCKY HISTORIC RESOURCE INVENTORY SUPPLEMENT
BOUNDARY AND LOCATION INFORMATION

Historic Property Name Shawnee High School Site # WS-82

Multiple Resource/Thematic Nomination Title West Louisville MRA Amended

U.T.M. Coordinates - List multiple UTM's if property is ten or more acres.

A. _____ D. _____

B. 16 603630 4235260 E. _____

C. _____ F. _____

Verbal Boundary Description Acreage approximately .9 acres

City of Louisville Block 8E, part of lots 27, 28, 29, 30, 31, 32, 33, 34, 35, 36, and 69. The boundary of the site extends ten feet from the foundation of the building as indicated on the Sanborn map.

Sketch of Site Plan (Showing outbuildings, structures, landscape features and the site boundary as described above.)

(see attached map)

Official Courthouse Property Reference:

Block 8-E, part of Lot 69

NOV 2 1984

6/18/84

HERMAN

320

NOV 2 1951

LOUISVILLE, KY, VOL. 3

322



PARKING

ANNEX BUILT 1966
ANNEX BUILT 1966

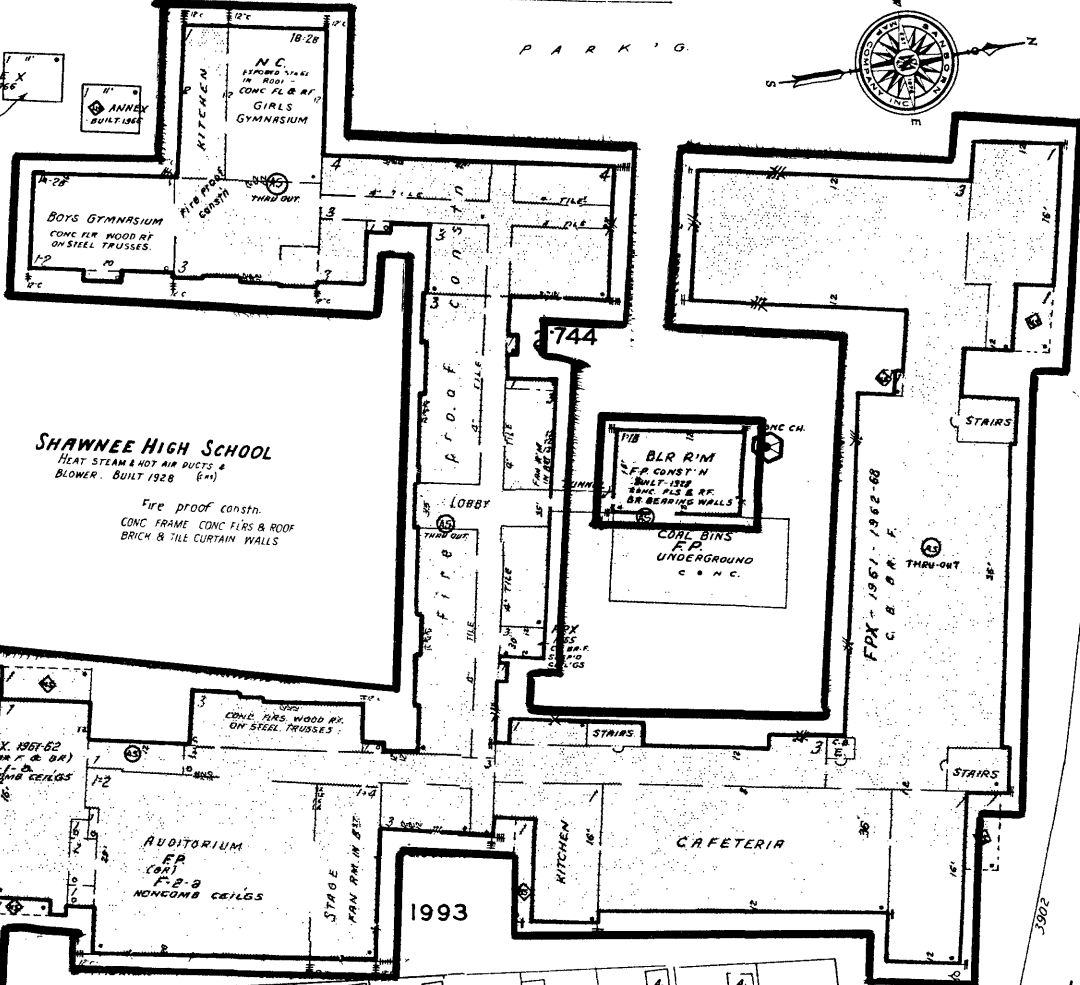

SHAWNEE HIGH SCHOOL
HEAT STEAM & HOT AIR DUCTS,
BLOWER, BUILT 1928 (64)

Fire proof constn.
CONC. FRAME CONC. FLRS & ROOF
BRICK & TILE CURTAIN WALLS

337

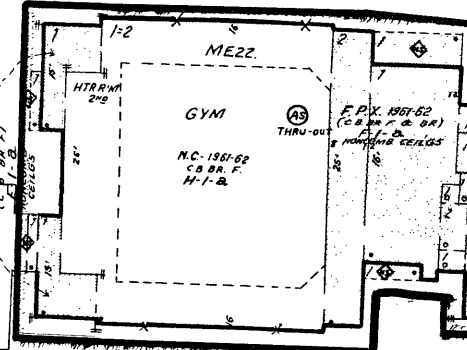

321

S. 39 TH ST.

W. MARKET

S. 40 TH ST.

339

Shawnee High School
4015 Herman Street
Louisville, Jefferson, KY
Sanborn Map 1974
Sanborn Map Company, Inc
629 Fifth Avenue
Pelham, New York