

United States Department of the Interior
National Park Service

For NPS use only

FEB 24 1984

National Register of Historic Places
Inventory—Nomination Form

received

date entered

See instructions in *How to Complete National Register Forms*

Type all entries—complete applicable sections

Received OHP 10-24-83

1. Name

historic HIGHLAND PARK POLICE STATION (City of Los Angeles Police Station No. 19)

and/or common Northeast Police Station

2. Location

street & number 6045 York ^{Bldg.} ~~Boulevard~~ N/A not for publication

city, town Los Angeles N/A vicinity of

state California code 06 county Los Angeles code 037

3. Classification

Category	Ownership	Status	Present Use	
<input type="checkbox"/> district	<input checked="" type="checkbox"/> public	<input checked="" type="checkbox"/> occupied	<input type="checkbox"/> agriculture	<input type="checkbox"/> museum
<input checked="" type="checkbox"/> building(s)	<input type="checkbox"/> private	<input type="checkbox"/> unoccupied	<input type="checkbox"/> commercial	<input type="checkbox"/> park
<input type="checkbox"/> structure	<input type="checkbox"/> both	<input type="checkbox"/> work in progress	<input type="checkbox"/> educational	<input type="checkbox"/> private residence
<input type="checkbox"/> site	Public Acquisition	Accessible	<input type="checkbox"/> entertainment	<input type="checkbox"/> religious
<input type="checkbox"/> object	<input type="checkbox"/> in process	<input checked="" type="checkbox"/> yes: restricted	<input checked="" type="checkbox"/> government	<input type="checkbox"/> scientific
	<input type="checkbox"/> being considered	<input type="checkbox"/> yes: unrestricted	<input type="checkbox"/> industrial	<input type="checkbox"/> transportation
	<input checked="" type="checkbox"/> N/A	<input type="checkbox"/> no	<input type="checkbox"/> military	<input type="checkbox"/> other:

4. Owner of Property

name Los Angeles Police Department

street & number 200 N. Main Street

city, town Los Angeles N/A vicinity of state CA 90012

5. Location of Legal Description

courthouse, registry of deeds, etc. Los Angeles City Hall

street & number 200 N. Spring St.

city, town Los Angeles state CA 90012

6. Representation in Existing Surveys

title TELACU/CRG Cultural Resources Survey has this property been determined eligible? yes no

date 1981 federal state county local

depository for survey records State Office of Historic Preservation

city, town P. O. Box 2390, Sacramento state CA 95811

7. Description

Condition		Check one	Check one
<input type="checkbox"/> excellent	<input type="checkbox"/> deteriorated	<input type="checkbox"/> unaltered	<input checked="" type="checkbox"/> original site
<input checked="" type="checkbox"/> good	<input type="checkbox"/> ruins	<input checked="" type="checkbox"/> altered	<input type="checkbox"/> moved date _____
<input type="checkbox"/> fair	<input type="checkbox"/> unexposed	(minor)	N/A

Describe the present and original (if known) physical appearance

The structure is a two story brick and reinforced concrete building. Designed in an institutional Renaissance Revival style, it displays many of the classical concepts and motifs associated with this formal design. The majority of exterior detailing is on the south facade. The facade is symmetrical, with fenestration and entrance openings carefully balanced. Exterior building material is coursed brick, with cast stone and terra cotta detailing. The recessed main entrance is reached by a series of stone steps. The arched entrance is decorated with radiating voussoirs. Double swinging doors are wood and glass and are flanked by glass sidelights and transoms. First floor windows are placed two on each side of the entry and capped with flat arches with radiating voussoirs. The building retains a very high level of integrity.

A stringcourse separates the first and second levels. The second story is the more decorated of the two, with quoins at the corners of the building. The treatment of the second story fenestration is more ornate than ground level, each window opening surrounded by terra cotta and slightly recessed. All five windows are arched and flanked by two small rosettes. Two larger medallions, the state seal of California and the seal of the City of Los Angeles, are embedded in the brick directly below the frieze containing the words, "Police Station No. 19." The second story is capped with a decorative boxed cornice. A flag pole hangs directly above the main entrance.

The east and west sides continue the decorative window treatments established on the south facade, as well as the brick exterior. Porte cocheres serve as entrances to the building on the east and west. Both contain large arches decorated with voussoirs. The flat roof of the porte cocheres serve as patio space for the second level. Many of the windows on the north, east, and west are barred. The rear (north elevation) is utilitarian and faced with stucco. A detached L-shaped brick garage is to the north of the main building; it is of more recent construction and does not contribute to the significance of the property. Exterior remains intact, with few, very minor renovations.

8. Significance

Period	Areas of Significance—Check and justify below			
<input type="checkbox"/> prehistoric	<input type="checkbox"/> archeology-prehistoric	<input type="checkbox"/> community planning	<input type="checkbox"/> landscape architecture	<input type="checkbox"/> religion
<input type="checkbox"/> 1400-1499	<input type="checkbox"/> archeology-historic	<input type="checkbox"/> conservation	<input type="checkbox"/> law	<input type="checkbox"/> science
<input type="checkbox"/> 1500-1599	<input type="checkbox"/> agriculture	<input type="checkbox"/> economics	<input type="checkbox"/> literature	<input type="checkbox"/> sculpture
<input type="checkbox"/> 1600-1699	<input checked="" type="checkbox"/> architecture	<input type="checkbox"/> education	<input type="checkbox"/> military	<input type="checkbox"/> social/
<input type="checkbox"/> 1700-1799	<input type="checkbox"/> art	<input type="checkbox"/> engineering	<input type="checkbox"/> music	<input type="checkbox"/> humanitarian
<input type="checkbox"/> 1800-1899	<input type="checkbox"/> commerce	<input type="checkbox"/> exploration/settlement	<input type="checkbox"/> philosophy	<input type="checkbox"/> theater
<input checked="" type="checkbox"/> 1900-	<input type="checkbox"/> communications	<input type="checkbox"/> industry	<input checked="" type="checkbox"/> politics/government	<input type="checkbox"/> transportation
		<input type="checkbox"/> invention		<input type="checkbox"/> other (specify)

Specific dates 1925-26 **Builder/Architect** L. A. City Construction Dept.

Statement of Significance (in one paragraph)

Highland Park Police Station is a two story structure with full basement designed in the Renaissance Revival style. This style, once very common for governmental and other institutional buildings in Los Angeles, now has very few intact examples in the area. The classic detailing and symmetry of the design lend a formal air to this station, compatible with its assigned function. In addition to being a notable example of its type and period, the building is historically important for its role in the establishment and provision of police services in the Highland Park section of Los Angeles.

As a civic building in a primarily residential area of Los Angeles, the structure is a landmark for the surrounding neighborhoods. Its low-rise construction makes it compatible with surrounding commercial establishments, but its formal design, building materials, and the quality of craftsmanship attest to its status. Highland Park Division has served this ten square mile area of Los Angeles since the dedication of the present structure in 1926. Prior to that, police service was furnished to this area by the neighboring Lincoln Heights Division. As the area was primarily residential in character, police activities were concerned with traffic violations, a small amount of juvenile petty theft, and an occasional burglary. The division was proud of its lack of major crime and enjoyed a cordial relationship with the community. Construction began in 1925; the completed building was dedicated in April of 1926. Part of a substantial building program designed to better serve Los Angeles' rapidly growing suburbs, the station was designed and built by the City of Los Angeles Construction Department. Construction costs were estimated at \$67,500; actual cost was \$94,500 plus furnishings and equipment. Fifty personnel were assigned to the new station, including clerks, five detectives, and two traffic investigators. Four of the five stations designed in this two year expansion program (77th Street, Newton, Wilshire, and West Los Angeles) are no longer in existence.

9. Major Bibliographical References

Annual Reports LAPD , 1924-26.
 The Guardian, (LAPD Revolver and Athletic Club, 1937), pp. 209-211.
 Highland Park Evening Herald, 4/13/26 and 4/20/26.
 Sjoquist, Arthur W. From Posses to Professionals (Cal State LA, 1972) pp. 210,211.

10. Geographical Data

Acreeage of nominated property 0.16 acre
 Quadrangle name Los Angeles Quadrangle scale 1:24,000

UTM References

A	1 1	3 9 0 5 5 0	3 7 7 5 7 8 0	B			
	Zone	Easting	Northing		Zone	Easting	Northing
C				D			
E				F			
G				H			

Verbal boundary description and justification Building occupies its historic 200x300' parcel on north side of York Blvd. between Aldama St. and Mesa Ave. Lots 13, 14 and 15, Block 37, Garvanza Addition #1 as per map recorded in Book 9, Pages 45 and 46 of Miscellaneous Records of Los Angeles County.

List all states and counties for properties overlapping state or county boundaries

state	N/A	code	county	N/A	code
state	N/A	code	county	N/A	code

11. Form Prepared By

name/title Christy Johnson McAvoy, Consultant (Cultural Heritage Board, LA)
 organization Johnson Research Associates date September, 1983
 street & number 3103 Lindo Street telephone (213) 851-8854
 city or town Los Angeles state CA 90068

12. State Historic Preservation Officer Certification

The evaluated significance of this property within the state is:

national state local

As the designated State Historic Preservation Officer for the National Historic Preservation Act of 1966 (Public Law 89-665), I hereby nominate this property for inclusion in the National Register and certify that it has been evaluated according to the criteria and procedures set forth by the National Park Service.

State Historic Preservation Officer signature Marion Mitchell Wilson

title Deputy State Historic Preservation Officer date February 9, 1984

For NPS use only
 I hereby certify that this property is included in the National Register
 Entered in the National Register
 Keeper of the National Register
 Attached
 Chief of Registration

[Signature] 3/22/84

**United States Department of the Interior
National Park Service**

**National Register of Historic Places
Inventory—Nomination Form**

For NPS use only

received

Date entered

Continuation sheet

Item number 6

Page 1

REPRESENTATION IN EXISTING SURVEYS (Continued)

Historic-Cultural Monument #274

January 4, 1984 Local

City of Los Angeles Cultural Heritage Board

City Hall, Room 1500

Los Angeles, CA 90012

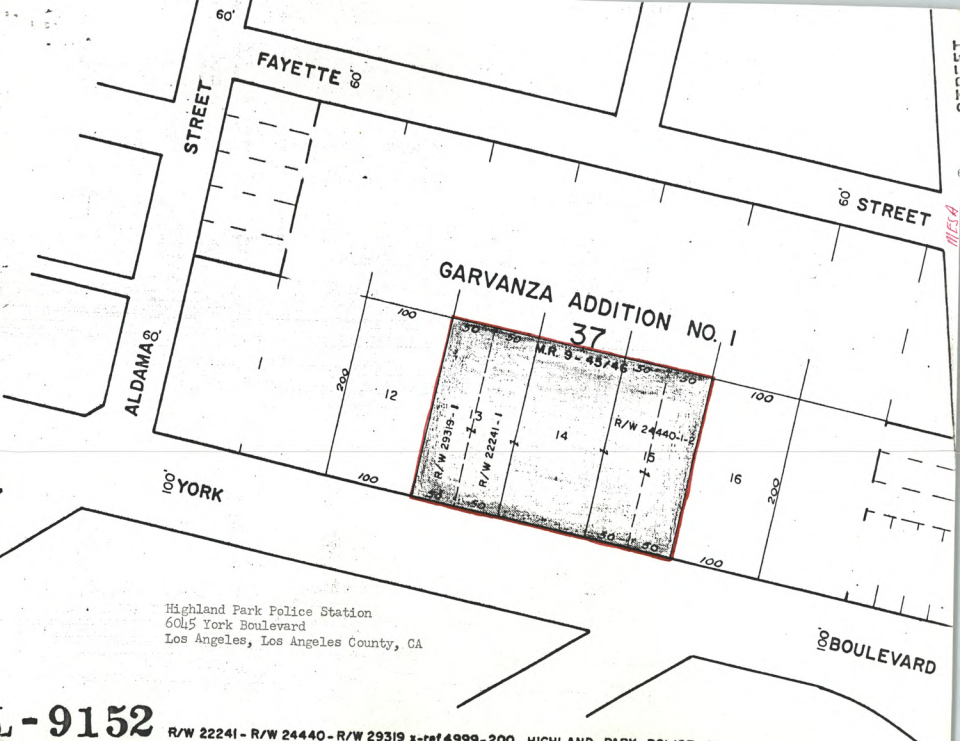

FAYETTE 60'

STREET

60' STREET

ALDAMA 60'

GARVANZA ADDITION NO. 1
37

100' YORK

R/W 29319-1
R/W 22241-1
M.R. 9-45746-50
R/W 24440-1

Highland Park Police Station
6045 York Boulevard
Los Angeles, Los Angeles County, CA

8 BOULEVARD

L-9152

R/W 22241 - R/W 24440 - R/W 29319 x-ref 4999-200 HIGHLAND PARK POLICE

SKETCH MAP

NORTHEAST POLICE STATION
6045 York Boulevard
Los Angeles, CA 90042

NORTH
↑

