

**United States Department of the Interior
National Park Service**

**National Register of Historic Places
Continuation Sheet**

Section number _____ Page _____

SUPPLEMENTARY LISTING RECORD

NRIS Reference Number: 93000959

Date Listed: 10/1/93

Ellsworth--Jones Building
Property Name

Hardin
County

IA
State

Architectural & Historical Resources of Iowa Falls, Iowa MPS
Multiple Name

This property is listed in the National Register of Historic Places in accordance with the attached nomination documentation subject to the following exceptions, exclusions, or amendments, notwithstanding the National Park Service certification included in the nomination documentation.

for Patrick Ardies
Signature of the Keeper

10/1/93
Date of Action

=====
Amended Items in Nomination:

UTM:
The UTM coordinates were omitted from the nomination form. The correct coordinates were obtained from the attached USGS map.

This information was confirmed with Beth Foster of the Iowa SHPO.

DISTRIBUTION:
National Register property file
Nominating Authority (without nomination attachment)

RECEIVED

AUG 12 1993

NATIONAL REGISTER

United States Department of the Interior
National Park Service

National Register of Historic Places
Registration Form

This form is for use in nominating or requesting determinations for individual properties and districts. See instructions in *How to Complete the National Register of Historic Places Registration Form* (National Register Bulletin 16A). Complete each item by marking "x" in the appropriate box or by entering the information requested. If an item does not apply to the property being documented, enter "N/A" for "not applicable." For functions, architectural classification, materials, and areas of significance, enter only categories and subcategories from the instructions. Place additional entries and narrative items on continuation sheets (NPS Form 10-900a). Use a typewriter, word processor, or computer, to complete all items.

1. Name of Property

historic name Ellsworth-Jones Building
other names/site number N.A.

2. Location

street & number 511 Washington Avenue not for publication
city or town Iowa Falls vicinity
state Iowa code IA county Hardin code 083 zip code 50126

3. State/Federal Agency Certification

As the designated authority under the National Historic Preservation Act, as amended, I hereby certify that this nomination request for determination of eligibility meets the documentation standards for registering properties in the National Register of Historic Places and meets the procedural and professional requirements set forth in 36 CFR Part 60. In my opinion, the property meets does not meet the National Register criteria. I recommend that this property be considered significant nationally statewide locally. (See continuation sheet for additional comments.)

[Signature] 8/13/93
Signature of certifying official/Title Date

State Historical Society of Iowa
State of Federal agency and bureau

In my opinion, the property meets does not meet the National Register criteria. (See continuation sheet for additional comments.)

Signature of certifying official/Title Date

State or Federal agency and bureau

4. National Park Service Certification

I hereby certify that the property is:

- entered in the National Register.
 See continuation sheet.
- determined eligible for the National Register
 See continuation sheet.
- determined not eligible for the National Register.
- removed from the National Register.
- other, (explain:) _____

Signature of the Keeper

Date of Action

Patrick Andrews 10/1/93

Name of Property

County and State

5. Classification

Ownership of Property (Check as many boxes as apply)

Category of Property (Check only one box)

Number of Resources within Property (Do not include previously listed resources in the count.)

- private, public-local, public-State, public-Federal

- building(s), district, site, structure, object

Contributing Noncontributing
1 buildings
sites
structures
objects
1 Total

Name of related multiple property listing (Enter "N/A" if property is not part of a multiple property listing.)

Number of contributing resources previously listed in the National Register

Architectural & Historical Resources of Iowa Falls, IA 0

6. Function or Use

Historic Functions (Enter categories from instructions)

Current Functions (Enter categories from instructions)

COMMERCE/TRADE

COMMERCE/TRADE

Financial Institution

Business

7. Description

Architectural Classification (Enter categories from instructions)

Materials (Enter categories from instructions)

Late 19th/Early 20th Century Revival

foundation Limestone

Neo-classical Revival

walls Brick with stone trim

roof Asphalt

other Metal Cornice

Narrative Description

(Describe the historic and current condition of the property on one or more continuation sheets.)

Name of Property

County and State

8. Statement of Significance

Applicable National Register Criteria

(Mark "x" in one or more boxes for the criteria qualifying the property for National Register listing.)

- A Property is associated with events that have made a significant contribution to the broad patterns of our history.
B Property is associated with the lives of persons significant in our past.
C Property embodies the distinctive characteristics of a type, period, or method of construction or represents the work of a master, or possesses high artistic values, or represents a significant and distinguishable entity whose components lack individual distinction.
D Property has yielded, or is likely to yield, information important in prehistory or history.

Criteria Considerations

(Mark "x" in all the boxes that apply.)

Property is:

- A owned by a religious institution or used for religious purposes.
B removed from its original location.
C a birthplace or grave.
D a cemetery.
E a reconstructed building, object, or structure.
F a commemorative property.
G less than 50 years of age or achieved significance within the past 50 years.

Areas of Significance

(Enter categories from instructions)

Commerce
Architecture

Period of Significance

1902-1907

Significant Dates

1902

Significant Person

(Complete if Criterion B is marked above)

Eugene S. Ellsworth

Cultural Affiliation

N.A.

Architect/Builder

Unknown

Narrative Statement of Significance

(Explain the significance of the property on one or more continuation sheets.)

9. Major Bibliographical References

Bibliography

(Cite the books, articles, and other sources used in preparing this form on one or more continuation sheets.)

Previous documentation on file (NPS):

- preliminary determination of individual listing (36 CFR 67) has been requested
previously listed in the National Register
previously determined eligible by the National Register
designated a National Historic Landmark
recorded by Historic American Buildings Survey
recorded by Historic American Engineering Record

Primary location of additional data:

- State Historic Preservation Office
Other State agency
Federal agency
Local government
University
Other

Name of repository:

Name of Property

County and State

10. Geographical Data

Acreage of Property Less than one acre.

UTM References

(Place additional UTM references on a continuation sheet.)

1	15	478370	47107245
	Zone	Easting	Northing
2			

3			
	Zone	Easting	Northing
4			

See continuation sheet

Verbal Boundary Description

(Describe the boundaries of the property on a continuation sheet.)

Boundary Justification

(Explain why the boundaries were selected on a continuation sheet.)

11. Form Prepared By

name/title Molly Myers Naumann, Consultant (515) 682-2743

organization Iowa Falls Historic Preservation Commission date May 1993

street & number City Hall, 321 Stevens telephone (515) 648-2527

city or town Iowa Falls state IA zip code 50126

Additional Documentation

Submit the following items with the completed form:

Continuation Sheets

Maps

A USGS map (7.5 or 15 minute series) indicating the property's location.

A Sketch map for historic districts and properties having large acreage or numerous resources.

Photographs

Representative black and white photographs of the property.

Additional Items

(Check with the SHPO or FPO for any additional items)

Property Owner

(Complete this item at the request of SHPO or FPO.)

name John V. Nissly

street & number 511 Washington, P.O. Box 606 telephone (515) 648-4017

city or town Iowa Falls state IA zip code 50126

Paperwork Reduction Act Statement: This information is being collected for applications to the National Register of Historic Places to nominate properties for listing or determine eligibility for listing, to list properties, and to amend existing listings. Response to this request is required to obtain a benefit in accordance with the National Historic Preservation Act, as amended (16 U.S.C. 470 et seq.).

Estimated Burden Statement: Public reporting burden for this form is estimated to average 18.1 hours per response including time for reviewing instructions, gathering and maintaining data, and completing and reviewing the form. Direct comments regarding this burden estimate or any aspect of this form to the Chief, Administrative Services Division, National Park Service, P.O. Box 37127, Washington, DC 20013-7127; and the Office of Management and Budget, Paperwork Reductions Projects (1024-0018), Washington, DC 20503.

United States Department of the Interior
National Park Service

National Register of Historic Places Continuation Sheet

Section number 7 Page 1

CFN-259-1116

Ellsworth-Jones Building
Hardin County, Iowa

Description:

The Ellsworth-Jones Building (1902) is a three story, single storefront Neo-classical structure located at 511 Washington Avenue. Rectangular in shape, the building of reddish-brown brick measures 22' x 132', with the narrow end facing Washington. Directly west of the building is the Metropolitan Opera House, while to the east once stood the double storefront Ellsworth Block. The flat roof slopes to the rear. At street level, the Ellsworth-Jones Building is asymmetrical. On the right side is the raised entrance: a plate glass door flanked by plate glass sidelights. Above the entrance is a new metal canopy, affording a degree of protection from the elements. To the left is a large display window with brick in-fill below and prism glass transom above. Three granite columns, square in shape and topped with egg and dart engraved capitols, support the first floor cornice. This granite cornice continues the Neo-classical detailing. Carved into the entablature is the name of the company for which the structure was built: Ellsworth and Jones. The symmetrical second floor is composed of three rectangular windows, capped by prism glass transoms. Ionic columns appear to support this transom area and cornice above. Triple arched windows with stone surrounds are featured at the third floor level. The windows are separated by Doric columns from which the arches spring. The keystones are of acanthus leaf design. The metal cornice rests on heavy paired brackets. Centered between the brackets on the entablature is an olive wreath, with olive branches curving to each side. The Neo-classical details are continued in the dentils across the metal cornice. Historic photographs show that originally the building was crowned by a stone balustrade and identification pediment. With this exception, the building retains a very high degree of integrity.

The east elevation is presently exposed to the elements. The three story building which was adjacent was destroyed by fire. The owners have plans to cover this wall for both aesthetic and practical reasons.

The interior of the Ellsworth-Jones building is remarkably intact. The first floor retains its pressed metal ceiling, transomed doors, Neo-classical fireplaces in the NE and SE corners, pine woodwork, and marble and mahogany counter. A thirty inch mural, depicting various E.S. Ellsworth properties, runs around the perimeter of the main room between the ceiling and the picture rail. The original vault, extending from the basement through the second floor, is intact. The second and third floors, unoccupied and used largely for storage, also retain a high degree of integrity. The second floor, with its two fireplaces and vault, and the third floor with its skylight, are prime candidates for renovation and use as living space.

United States Department of the Interior
National Park Service

National Register of Historic Places Continuation Sheet

Section number 7 Page 2

CFN-259-1116

Ellsworth-Jones Building
Hardin County, Iowa

Description Continued:

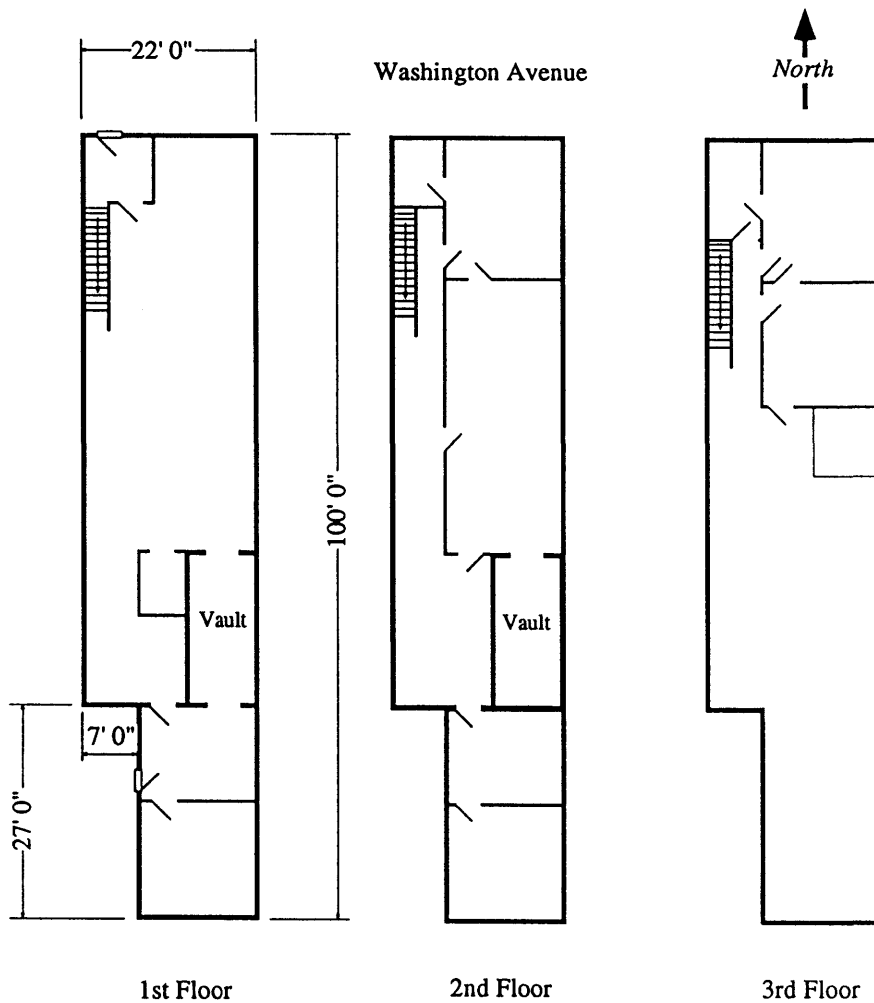

United States Department of the Interior
National Park Service

National Register of Historic Places Continuation Sheet

Section number 7 Page 3

CFN-259-1116

Ellsworth-Jones Building
Hardin County, Iowa

Description Continued:

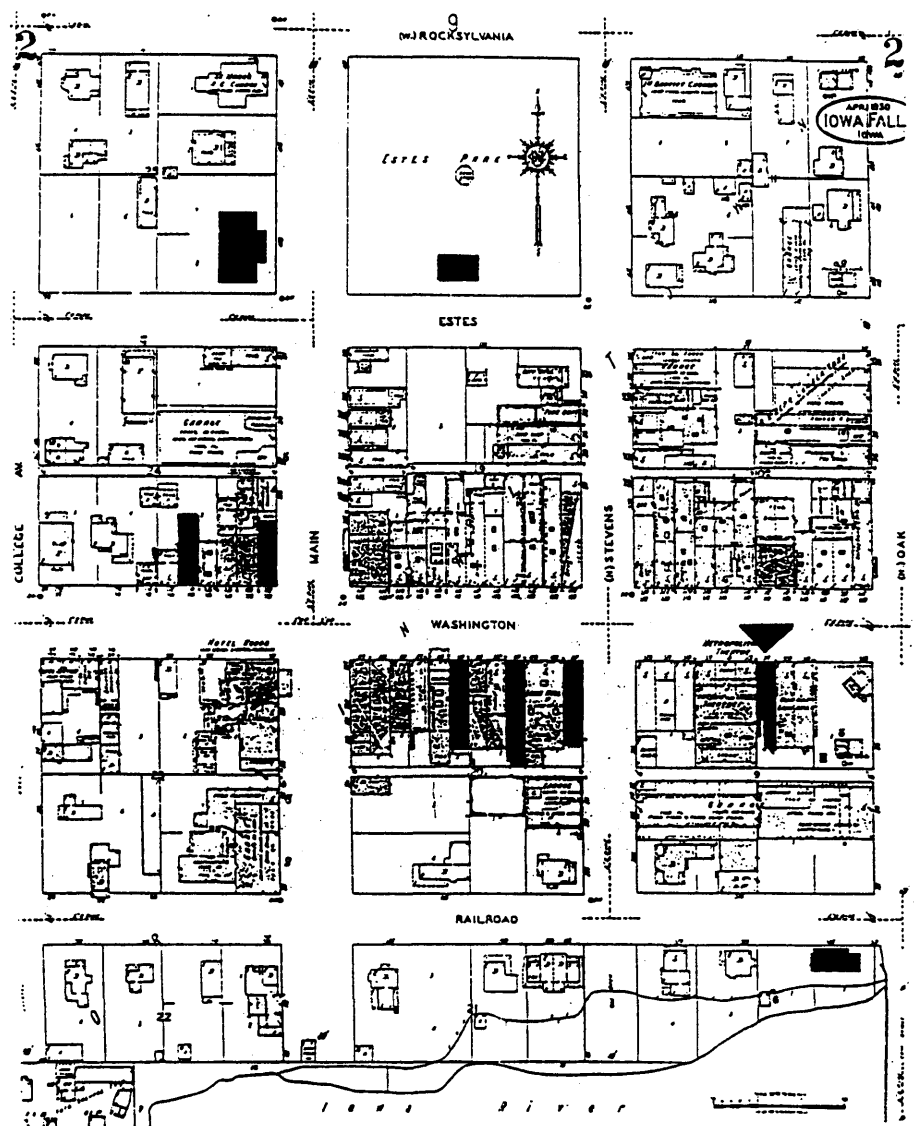

IOWA FALLS BUSINESS DISTRICT

Shaded buildings are those being nominated.

▶ indicates specific building being nominated.

United States Department of the Interior
National Park Service

National Register of Historic Places Continuation Sheet

Section number 7 Page 4

CFN-259-1116

Ellsworth-Jones Building
Hardin County, Iowa

Description Continued:

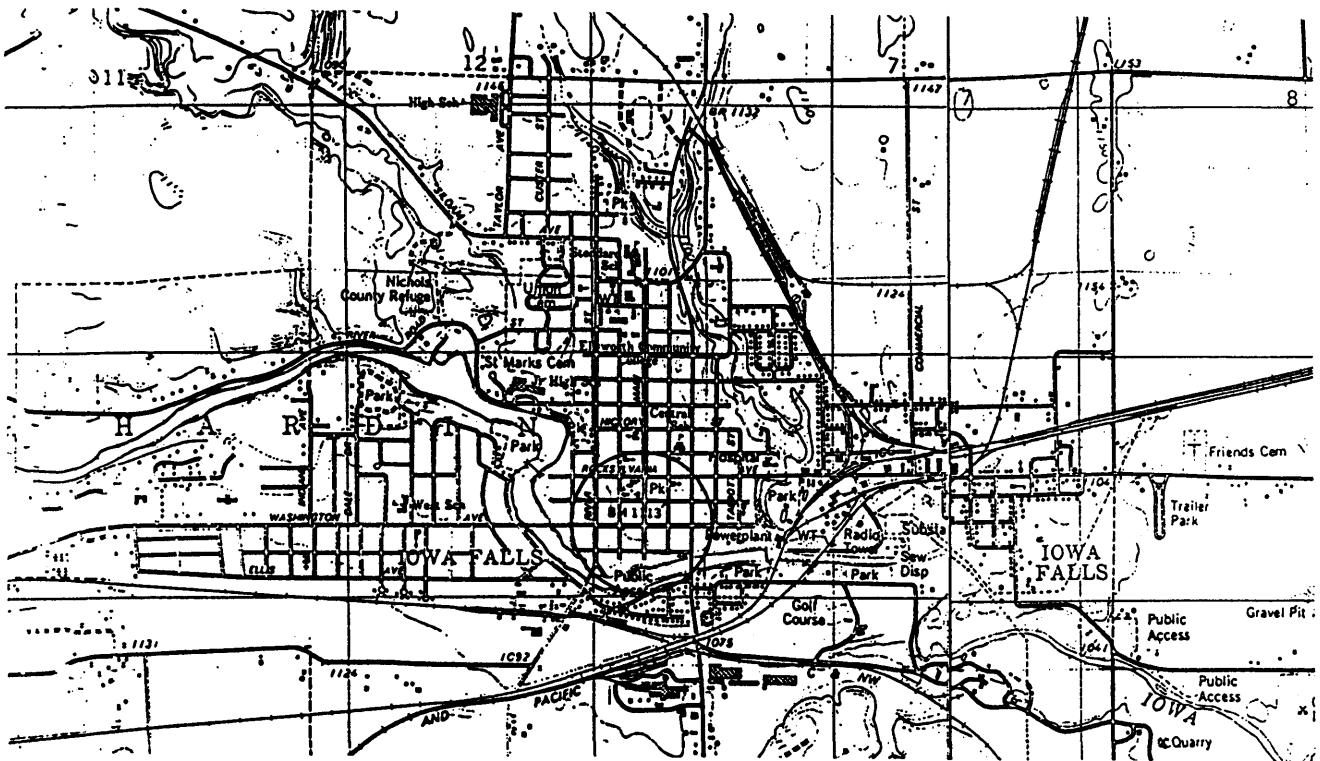

Central Business District is circled.
U.S.G.S. Map

United States Department of the Interior
National Park Service

National Register of Historic Places Continuation Sheet

Section number 8 Page 5

CFN-259-1116

**Ellsworth-Jones Building
Hardin County, Iowa**

Significance:

The Ellsworth-Jones Building is the structure which best illustrates the importance of E.S. Ellsworth the businessman and philanthropist. It is locally significant under Criterion B as the main office of Eugene S. Ellsworth, and under Criterion C as an outstanding example of turn of the century Neo-classical commercial design. The period of significance is from the completion of the building in 1902 until Ellsworth's death in 1907.

Eugene S. Ellsworth was a land broker, town developer, and philanthropist of immense success. The firm of Ellsworth and Jones, headquartered in Iowa Falls, purchased and sold land throughout the state of Iowa and other midwestern states. The company also had an extensive business in making loans from the same office and other offices located in Chicago, Boston, and Crookston, MN.

Ellsworth was active in more than business affairs. Between 1905 and 1907 he worked tirelessly to permanently endow Ellsworth College. He was one of the prime benefactors of the Iowa Falls Library and the Ellsworth Hospital. Ellsworth was instrumental in Iowa Falls' development in that he helped secure rail transportation, telephone communication, a golf course, and zoological park, and constructed significant commercial buildings for the city. Purportedly one of the four wealthiest men in Iowa at the time of his death (1907), there was little in Iowa Falls that E.S. Ellsworth did not leave a mark upon.

The Ellsworth-Jones Building is a superbly intact example of Neo-classical commercial architecture. From the egg and dart motif of the columns at street level, to the dentil work on the cornice, the exterior of the building is resplendent with Neo-classical details. Ionic and Doric columns, Roman arches, acanthus leaf keystones, and foliated decorative elements are only a few of the decorative elements found on the exterior of the Ellsworth-Jones Building.

The interior has changed very little from the days of its completion. Neo-classical fireplaces, with three quarter fluted columns, olive wreaths, and garlands upon the mantle, grace the offices of the first and second floors. Fluted pilasters, surmounted by lyres and acanthus leaves, flank the doorways of the first and second floor vaults. The stairway to the second floor retains its dark wainscoting and ornate newel post. The marble and mahogany counter, and the mural encircling the front office reflect the prominence of the firm and its partners.

Despite extensive research, the identity of the architect remains unknown.

United States Department of the Interior
National Park Service

National Register of Historic Places Continuation Sheet

Section number 9 & 10 Page 6

CFN-259-1116

Ellsworth-Jones Building
Hardin County, Iowa

Bibliography:

Abstract of Title, City of Iowa Falls, Original Plat, Blk 9, W 1/3 Lot 2.

Iowa Falls Sentinel, June 28, 1899, p 4, c 4
February 27, 1901, p 5, c 3
July 24, 1901, p 5
October 16, 1901, p 5
November 14, 1901, p 5
November 18, 1901, p 5
November 29, 1901, p 5
December 31, 1901, p 1
March 4, 1902, p 8
April 15, 1902
November 11, 1902, p 8
December 19, 1905, p ?, c 3

Johnson, Curtis Lee. E.S. Ellsworth In Iowa Falls: 1864-1907. M.A. Thesis,
Department of English, State University of Iowa, June 1952.

Nichols, I.A. Pioneer Days in Iowa Falls, Iowa. Fort Dodge, IA: Messenger Printing
Co., 1944, pp 325-335.

Sanborn Fire Insurance Maps

Verbal Boundary Description:

City of Iowa Falls, Original Plat, Block 9, W 1/3 Lot 2.

Boundary Justification:

This is the area historically associated with this resource.