

KENTUCKY HISTORIC RESOURCES INVENTORY

Site No. Do 360

1. Historic Name(s) <u>Stone house on ^{old} Stage Road</u>		22. ADD/County <u>Bluegrass, Boyle</u>	
Origin Owner <u>not known</u>		23. U.S.G.S. Quadrant (15'/75') <u>Boyanville vic</u>	
2. Present Name		24. UTM Reference <u>360</u>	
3. Location <u>facing Old Lexington Rd just W of eastern intersection W Hwy. 34. R 434</u>		Zone <u>16</u> Easting <u>7100920</u> Northing <u>411712810</u>	
4. Owner's Name <u>James Pollard</u>		25. Coordinate Accuracy <input type="checkbox"/>	
5. Owner's Address <u>Route 1 Box 377 Danville, Ky. 40422</u>		26. Prehistoric Site <input type="checkbox"/> Object	
6. Open to Public Yes <input type="checkbox"/> No <input checked="" type="checkbox"/>		Historic Site <input type="checkbox"/> Structure	
7. Visible from road Yes <input checked="" type="checkbox"/> No <input type="checkbox"/>		Building <input type="checkbox"/> Other	
8. Ownership		27. National Register District Name:	
Private <input checked="" type="checkbox"/>		<input type="checkbox"/>	
Local <input type="checkbox"/>		28. Significance Evaluation <input type="checkbox"/>	
State <input type="checkbox"/>		29. Status	
Federal <input type="checkbox"/>		National Landmark <input type="checkbox"/> Date	
9. Local Contact/Organization		National Register <input type="checkbox"/>	
10. Site Plan with North Arrow		Landmark Certificate <input type="checkbox"/>	
<u>See attached boundary form</u>		Kentucky Survey <input checked="" type="checkbox"/> <u>4-10-76</u>	
11. Architect		Local Landmark <input type="checkbox"/>	
12. Builder		HABS/HAER <input type="checkbox"/>	
13. Date <u>2nd 1/4 19th C.A. [3]</u> B. <input type="checkbox"/>		30. Historic Theme	
14. Style		Primary <u>Architecture</u> <input checked="" type="checkbox"/>	
A. <u>G.R. person</u> <input checked="" type="checkbox"/>		Secondary <input type="checkbox"/>	
B. <input type="checkbox"/>		Other <input type="checkbox"/>	
15. Original Use <u>Residence</u> <input checked="" type="checkbox"/>		31. Endangered Yes <input type="checkbox"/> No <input checked="" type="checkbox"/>	
16. Present use <u>Residence</u>		32. Preservation Project Status <input type="checkbox"/>	
17. Condition <u>excellent</u> <input checked="" type="checkbox"/>		Actual Cost in \$1,000s <input type="checkbox"/>	
18. Description		33. ATTACH PHOTO	
3 bay 1 3/4 story dry stone house built into hillside w cellar exposed on N. side. Built of large size white limestone, some stones span 2 or 3 courses, laid w green vertical, flat pointing, no voussoirs; (over)		<u>in attached envelope</u>	
(Continue on Back)		Roll No. _____	
19. History <u>not researched. Owned by J. Chinn in 1876; McMillen in 20th C; Jones?</u>		Picture No. _____	
20. Significance <u>Late dry stone house of unique form, in pretty setting having remnants of its past.</u>		Direction _____	
21. Source of Information <u>18. inspection 19. James Pollard</u>		34. Prepared by: <u>C.M. Woolley</u>	
		35. Organization _____	
		36. Date <u>1982</u>	
		37. Revision Dates _____ 38. Staff Review _____	

18. cont.:

superior chimneys each end.
Regular size 6/6 windows each side of chimney. 2nd floor.

3 bays on N side, 1st floor and cellar.
Most frames have been replaced, except center cellar door which has beaded frame and beaded batten door.

House had unique plan. According to the owner, the cellar was divided into 2 rooms, and had no access to first floor; 1st floor had 3 windows only on N side, only door in E bay (of 3 bays) of S side; hall parlor plan w enclosed corner stair arising from S to N in hall on partition wall; 2nd floor has 2 rooms, fireplace in each. The $1\frac{3}{4}$ height is very unusual.

Much of the woodwork has been replaced. Beaded board walls remain beside the stair; W room has chair rail of single board, beaded on 1 edge & w.o. cap, which goes across chimney breast, so may be later; only mantel in house is in E room 2nd floor - late 1800's vernacular; new task.

Owner said the walls are 29 in thick, double walled, w space between filled w clay, rock & oak hair. Center window 1st floor N side made into door, and at one time house had porch on this side - full flight of wooden steps to door now. Eaves extended on gable ends and shed roofed addition built across 2/3 of S. side. Foundation of root cellar and smoke house behind house.

House located on side of hill above valley with 4 springs. Quarry across road from house. House faces old road to Lexington. There was a distillery on the property which operated until 1906-10. Stone mounting blocks in valley in front of house, where beggy house was located.

VERBAL BOUNDARY DESCRIPTION & JUSTIFICATION

Beginning at a post in the NW corner of the yard, thence with fence around yard E 130 ft to B, S 100 ft to C, W 130 ft to D, and N 100 ft to the beginning containing the stone house - about 1/3 acre. (Property has 33 acres, giving description to site, but no other buildings or structures.)

SKETCH MAP OF SITE SHOWING BOUNDARIES AND KEY BUILDINGS AND FEATURES WITH NORTH ARROW.

Hwy 37

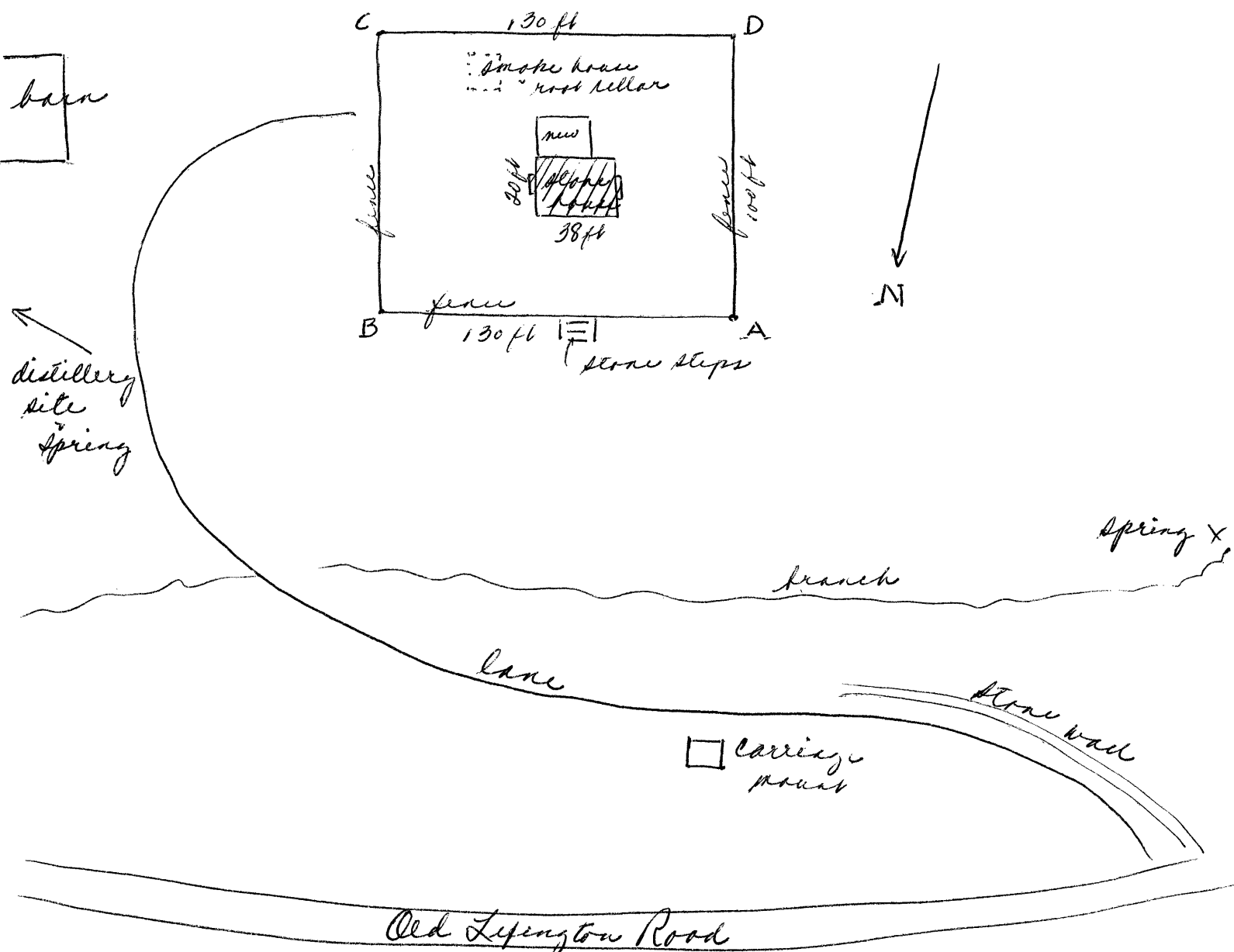

KENTUCKY HISTORIC RESOURCES INVENTORY

Site No. Do 360

1. Historic Name(s) <u>Stone house on ^{old} Stage Road</u>		22. ADD/County <u>Bluegrass, Boyle</u>	
Origin Owner <u>not known</u>		23. U.S.G.S. Quadrant (15'/75') <u>Boyantsville vic</u>	
2. Present Name		24. UTM Reference <u>360</u>	
3. Location <u>facing Old Lexington Rd just W of eastern intersection W Hwy. 34. R 434</u>		Zone <u>16</u> Easting <u>7100920</u> Northing <u>411712810</u>	
4. Owner's Name <u>James Pollard</u>		25. Coordinate Accuracy <input type="checkbox"/>	
5. Owner's Address <u>Route 1 Box 377 Danville, Ky. 40422</u>		26. Prehistoric Site _____ Object _____	
6. Open to Public Yes _____ No <input checked="" type="checkbox"/>		Historic Site _____ Structure _____	
7. Visible from road Yes <input checked="" type="checkbox"/> No _____		Building <u>i</u> Other _____	
8. Ownership Private <input checked="" type="checkbox"/> Local _____ State _____ Federal _____		27. National Register District Name: _____	
9. Local Contact/Organization		28. Significance Evaluation <input type="checkbox"/>	
10. Site Plan with North Arrow <u>See attached boundary form</u>		29. Status _____ Date _____	
11. Architect		National Landmark _____	
12. Builder		National Register _____	
13. Date <u>2nd 1/4 19th C.A. [3] B. []</u>		Landmark Certificate _____	
14. Style <u>A. G.R. person [C] B. []</u>		Kentucky Survey <input checked="" type="checkbox"/> <u>4-10-76</u>	
15. Original Use <u>Residence [A]</u>		Local Landmark _____	
16. Present use <u>Residence</u>		HABS/HAER _____	
17. Condition <u>excellent [A]</u>		30. Historic Theme Primary <u>Architecture [C]</u> Secondary _____ Other _____	
18. Description <u>3 bay 1 3/4 story dry stone house built into hillside w cellar exposed on N. side. Built of large size white limestone, some stones span 2 or 3 courses, laid w green vertical, flat pointing, no voussoirs; (over)</u>		31. Endangered Yes _____ No <input checked="" type="checkbox"/>	
(Continue on Back)		32. Preservation Project Status <input type="checkbox"/>	
19. History <u>not researched. Owned by J. Chinn in 1876; McMillen in 20th C; Jones?</u>		Actual Cost in \$1,000s _____	
20. Significance <u>Late dry stone house of unique form, in pretty setting having remnants of its past.</u>		33. ATTACH PHOTO <u>in attached envelope</u>	
21. Source of Information <u>18. inspection 19. James Pollard</u>		Roll No. _____	
		Picture No. _____	
		Direction _____	
		34. Prepared by: <u>C.M. Woolley</u>	
		35. Organization _____	
		36. Date <u>1982</u>	
		37. Revision Dates _____ 38. Staff Review _____	

18. cont.:

superior chimneys each end.
Regular size 6/6 windows each side of chimney. 2nd floor.

3 bays on N side, 1st floor and cellar.
Most frames have been replaced, except center cellar door which has beaded frame and beaded batten door.

House had unique plan. According to the owner, the cellar was divided into 2 rooms, and had no access to first floor; 1st floor had 3 windows only on N side, only door in E bay (of 3 bays) of S side; hall parlor plan w enclosed corner stair arising from S to N in hall on partition wall; 2nd floor has 2 rooms, fireplace in each. The $1\frac{3}{4}$ height is very unusual.

Much of the woodwork has been replaced. Beaded board walls remain beside the stair; W room has chair rail of single board, beaded on 1 edge & w.o. cap, which goes across chimney breast, so may be later; only mantel in house is in E room 2nd floor - late 1800's vernacular; new task.

Owner said the walls are 29 in thick, double walled, w space between filled w clay, rock & oak hair. Center window 1st floor N side made into door, and at one time house had porch on this side - full flight of wooden steps to door now. Eaves extended on gable ends and shed roofed addition built across 2/3 of S side. Foundation of root cellar and smoke house behind house.

House located on side of hill above valley with 4 springs. Quarry across road from house. House faces old road to Lexington. There was a distillery on the property which operated until 1906-10. Stone mounting blocks in valley in front of house, where beggy house was located.

