

1376

United States Department of the Interior  
National Park Service

RECEIVED

NOV 01 1993

National Register of Historic Places  
Registration Form

NATIONAL  
REGISTER

This form is for use in nominating or requesting determinations for individual properties and districts. See instructions in *How to Complete the National Register of Historic Places Registration Form* (National Register Bulletin 16A). Complete each item by marking "x" in the appropriate box or by entering the information requested. If an item does not apply to the property being documented, enter "N/A" for "not applicable." For functions, architectural classification, materials, and areas of significance, enter only categories and subcategories from the instructions. Place additional entries and narrative items on continuation sheets (NPS Form 10-900a). Use a typewriter, word processor, or computer, to complete all items.

1. Name of Property

historic name Lamme Hospital

other names/site number 5HF366; "1899" Inn

2. Location

street & number 314 South Main Street  not for publication

city or town La Veta  vicinity

state Colorado code CO county Huerfano code 055 zip code 81055

3. State/Federal Agency Certification

As the designated authority under the National Historic Preservation Act, as amended, I hereby certify that this  nomination  request for determination of eligibility meets the documentation standards for registering properties in the National Register of Historic Places and meets the procedural and professional requirements set forth in 36 CFR Part 60. In my opinion, the property  meets  does not meet the National Register criteria. I recommend that this property be considered significant  nationally  statewide  locally. ( See continuation sheet for additional comments.)

James Duane Hartmann October 25, 1993  
Signature of certifying official/Title Date

State Historic Preservation Office  
State or Federal agency and bureau

In my opinion, the property  meets  does not meet the National Register criteria. ( See continuation sheet for additional comments.)

\_\_\_\_\_  
Signature of certifying official/Title Date

\_\_\_\_\_  
State or Federal agency and bureau

4. National Park Service Certification

I hereby certify that the property is:

- entered in the National Register.  See continuation sheet.
- determined eligible for the National Register  See continuation sheet.
- determined not eligible for the National Register.
- removed from the National Register.
- other, (explain): \_\_\_\_\_

[Signature] Signature of the Keeper Entered in the National Register Date of Action 12/10/93

Lamme Hospital

Huerfano County, CO

Name of Property

County and State

5. Classification

Ownership of Property

(Check as many boxes as apply)

- private
- public-local
- public-State
- public-Federal

Category of Property

(Check only one box)

- building(s)
- district
- site
- structure
- object

Number of Resources within Property

(Do not include previously listed resources in the count.)

Contributing	Noncontributing	
2	1	buildings
		sites
		structures
		objects
2	1	Total

Name of related multiple property listing

(Enter "N/A" if property is not part of a multiple property listing.)

N/A

Number of contributing resources previously listed in the National Register

N/A

6. Function or Use

Historic Functions

(Enter categories from instructions)

HEALTH CARE/hospital

DOMESTIC/single dwelling

Current Functions

(Enter categories from instructions)

DOMESTIC/hotel

7. Description

Architectural Classification

(Enter categories from instructions)

OTHER: Eclectic

Materials

(Enter categories from instructions)

foundation STONE

walls STONE: Sandstone

roof ASPHALT

other

Narrative Description

(Describe the historic and current condition of the property on one or more continuation sheets.)

**8. Statement of Significance**

**Applicable National Register Criteria**

(Mark "x" in one or more boxes for the criteria qualifying the property for National Register listing.)

- A** Property is associated with events that have made a significant contribution to the broad patterns of our history.
- B** Property is associated with the lives of persons significant in our past.
- C** Property embodies the distinctive characteristics of a type, period, or method of construction or represents the work of a master, or possesses high artistic values, or represents a significant and distinguishable entity whose components lack individual distinction.
- D** Property has yielded, or is likely to yield, information important in prehistory or history.

**Criteria Considerations**

(Mark "x" in all the boxes that apply.)

Property is:

- A** owned by a religious institution or used for religious purposes.
- B** removed from its original location.
- C** a birthplace or grave.
- D** a cemetery.
- E** a reconstructed building, object, or structure.
- F** a commemorative property.
- G** less than 50 years of age or achieved significance within the past 50 years.

**Areas of Significance**

(Enter categories from instructions)

HEALTH/MEDICINE

**Period of Significance**

1909-1937

**Significant Dates**

1909

1918

**Significant Person**

(Complete if Criterion B is marked above)

N/A

**Cultural Affiliation**

**Architect/Builder**

Coleman, E. R.

**Narrative Statement of Significance**

(Explain the significance of the property on one or more continuation sheets.)

**9. Major Bibliographical References**

**Bibliography**

(Cite the books, articles, and other sources used in preparing this form on one or more continuation sheets.)

**Previous documentation on file (NPS):**

- preliminary determination of individual listing (36 CFR 67) has been requested
- previously listed in the National Register
- previously determined eligible by the National Register
- designated a National Historic Landmark
- recorded by Historic American Buildings Survey # \_\_\_\_\_
- recorded by Historic American Engineering Record # \_\_\_\_\_

**Primary location of additional data:**

- State Historic Preservation Office
- Other State agency
- Federal agency
- Local government
- University
- Other

Name of repository:

Huerfano County Public Library

Lamme Hospital  
Name of Property

Huerfano County, CO  
County and State

**10. Geographical Data**

Acreage of Property less than one acre.

**UTM References**

(Place additional UTM references on a continuation sheet.)

1 

1	3	4	9	9	2	3	0	4	1	5	0	9	5	0
Zone			Easting					Northing						

  
2 

Zone			Easting					Northing						

3 

Zone			Easting					Northing						

  
4 

Zone			Easting					Northing						

See continuation sheet

**Verbal Boundary Description**

(Describe the boundaries of the property on a continuation sheet.)

**Boundary Justification**

(Explain why the boundaries were selected on a continuation sheet.)

**11. Form Prepared By**

name/title Catherine M. Cramer & V. Rottman

organization \_\_\_\_\_ date April 16, 1993

street & number 792 Ponderosa Road telephone (719) 742-3762

city or town La Veta state CO zip code 81055

**Additional Documentation**

Submit the following items with the completed form:

**Continuation Sheets**

**Maps**

A **USGS map** (7.5 or 15 minute series) indicating the property's location.

A **Sketch map** for historic districts and properties having large acreage or numerous resources.

**Photographs**

Representative **black and white photographs** of the property.

**Additional Items**

(Check with the SHPO or FPO for any additional items)

**Property Owner**

(Complete this item at the request of SHPO or FPO.)

name Marilyn Hall

street & number 314 South Main Street telephone (719) 742-3576

city or town La Veta state CO zip code 81055

**Paperwork Reduction Act Statement:** This information is being collected for applications to the National Register of Historic Places to nominate properties for listing or determine eligibility for listing, to list properties, and to amend existing listings. Response to this request is required to obtain a benefit in accordance with the National Historic Preservation Act, as amended (16 U.S.C. 470 *et seq.*).

**Estimated Burden Statement:** Public reporting burden for this form is estimated to average 18.1 hours per response including time for reviewing instructions, gathering and maintaining data, and completing and reviewing the form. Direct comments regarding this burden estimate or any aspect of this form to the Chief, Administrative Services Division, National Park Service, P.O. Box 37127, Washington, DC 20013-7127; and the Office of Management and Budget, Paperwork Reductions Projects (1024-0018), Washington, DC 20503.

United States Department of the Interior  
National Park Service

National Register of Historic Places  
Continuation Sheet

Lamme Hospital  
Huerfano County, CO

Section number 7 Page 1

---

DESCRIPTION

The Lamme Hospital is a two-and-one-half-story building of Eclectic Style, representing a number of stylistic influences available in the early 20th century. Built of local sandstone, its rectangular, symmetrical plan and hipped roof are typical of the popular Foursquare Style, but its gabled dormers with fishscale shingles are a holdover from the Queen Anne Style. The simple battered porch posts foreshadow the Craftsman.

The property is located on Main Street just one block from the center of the commercial district. Behind the main building are a garage and planter also of cut stone. In 1985 a cottage was built at the back of the site, which reflects the style of the hospital and the stucco finish of the back porch. The original stone buildings are in good condition and look much like they did in 1925.

Comprising four lots, the Lamme Hospital site has 100 feet of frontage on Main Street. It is just south of the La Veta Public Library (5HF 334) and just east of the Fort Francisco Plaza, which is listed on the National Register of Historic Places (5HF 519). One-half block north is the beginning of the retail district. The Library and Lamme Hospital mark the beginning of a residential area which extends along Main Street to the south.

The hospital, built in 1909 by E.R. Coleman, is constructed of load-bearing ashlar coursed sandstone. The hipped roof is covered with asphalt shingles. Dormer gables on the front and side elevations have wood-shingled ends. The front porch, added in 1911, has a wood cornice and wood posts resting on a cut sandstone base. The floor of the front porch is wood decking. The two enclosed back porches, added about 1925, have a sand-colored stucco finish.

Inside, the hospital has twelve rooms and is approximately 2500 square feet. The ground floor has a living room and dining room on the south side and a sitting room (now used as a gift shop), bedroom with bath, and a powder room on the north. At the back of the building is the kitchen, with an enclosed porch at either side. On the second floor are five bedrooms and three full baths. Up a few steps is a small porch over the front porch, within the center gable. A furnace room partially above grade at the back of the hospital still houses the original coal-burning iron furnace (no longer in use).

United States Department of the Interior  
National Park Service

National Register of Historic Places  
Continuation Sheet

Section number 7 Page 2

Lamme Hospital  
Huerfano County, CO

---

**DESCRIPTION (continued)**

The original high quality woodwork of the interior is seen in the door and window trim, stairs, wainscoting, and built-in shelves. Interior details include beveled glass transoms above the windows and doors on the ground floor. Several original light fixtures have been recovered and reinstalled in the building.

In the early 1980s, alterations were made to reverse those made in the 1950s and 1960s, returning the property to much the same condition it was in during the late 1920s. Screens enclosing the front porch were removed. Surface mounted fluorescent light fixtures were removed and replaced with the original where available or with other fixtures consistent with the hospital's period of construction. Doors and door hardware were replaced in the same manner.

In addition, a corridor was closed between the upstairs operating rooms to create a bathroom. Lavatories were installed in small bedroom closets. The plumbing and electrical systems were upgraded to comply with current building codes. A soffit was added in the kitchen to enclose a required range exhaust hood.

Spalling of the sandstone has occurred, and mortar joints have deteriorated primarily at the steps of the porch and, to a lesser extent, near grade at other areas of the building. Otherwise, the building is in very good condition.

The gabled roof, stone garage, built in 1920 also by E.R. Coleman, is about 570 square feet. The garage is located on the northwest corner of the site. It is a two-car garage, square in plan, accessed by an alley directly off of Main Street. It is considered contributing.

A cottage, built in 1985 at the southwest corner of the site, is approximately 456 square feet. It has one bedroom, a combination living room/dining room/kitchen, and one bath. Its stucco finish matches that of the back porch of the hospital. The cottage's gabled roof with gabled dormer and its windows reflect the style of the hospital. A cut sandstone planter is located just north of the cottage. Because of its recent construction, this is considered noncontributing.

United States Department of the Interior  
National Park Service

National Register of Historic Places  
Continuation Sheet

Section number 8 Page 3

Lamme Hospital  
Huerfano County, CO

---

**SIGNIFICANCE**

The Lamme Hospital is considered eligible to the National Register of Historic Places under Criteria A. The building was an early medical facility and La Veta's only hospital for a number of years. Many local citizens were born and received treatment here. It also provided medical services for the local coal camps of Oakview and Ojo.

**HISTORICAL BACKGROUND**

The land which is now the Town of La Veta, Colorado, was part of the Vigil-St. Vrain Mexican Land Grant of 1844. Colonel John M. Francisco, a Virginia merchant, had an agreement with Ceran St. Vrain to acquire a part of St. Vrain's share of the grant. Francisco chose Henry Daigre as his partner to oversee his claim. In 1862 an expedition led by Daigre established Francisco Fort or "Francisco Plaza" at the center of what is now La Veta, Colorado, attracting employees and settlers from New Mexico.

Francisco Plaza was one of a few communities in southern Colorado that served both Anglo and Latin communities. Construction of a grist mill was soon begun at what is now the south end of Main Street. The first buildings constructed after the adobe fort were log, wood frame, and adobe structures. Later, brick and concrete block were also used. Around 1890 the first cut-stone buildings were erected.

Around 1865, the settlement became known as "Las Cucharas," after the Cucharas River adjacent to the plaza. In 1871, it was designated "Spanish Peaks, Colorado Territory." In 1876 the Denver and Rio Grande Railroad arrived and used the northeast corner room of the plaza as a depot. D & RG officials platted a town on 200 acres of land donated by Daigre and Francisco and named the new railroad terminus "La Veta." The town was officially incorporated on October 9, 1876. La Veta was the division point for the railroad, and its general offices, telegraph office, and roundhouse helped the local economy grow.

Construction of the Lamme Hospital was begun in July, 1909, by E.R. Coleman. Peter Smith, a newspaper editor, and his wife Selina had commissioned it as a residence, but before its completion in December of that year, the Smiths traded homes with Dr. S. Julian Lamme.

United States Department of the Interior  
National Park Service

National Register of Historic Places  
Continuation Sheet

Section number 8 Page 4

Lamme Hospital  
Huerfano County, CO

**SIGNIFICANCE (continued)**

Dr. Stephen Jullian Lamme, who always used the name Jullian, grew up in various southern Colorado mining camps, attended high school in Walsenburg, and went on to obtain his medical degree in 1904 from the University of Colorado in Boulder. He and his new wife moved to La Veta the same year and opened his medical practice. An expanding clientele necessitated his move into what became the Lamme Hospital. Dr. Lamme used this building as his family's residence as well as his office and drugstore between 1909 and 1918. The downstairs housed the office and dispensary; upstairs were the clinic and living quarters.

Jullian's younger brother, James McGrew Lamme, joined the practice in 1911. James too grew up in southern Colorado, attending high school in Canon City before following his brother to the University of Colorado for a medical degree. For several years the brothers supplemented their private practice by working under contract to the company mining towns of Ojo and Oakview, a few miles north of La Veta. They agreed to treat the medical needs of all the communities residents for a modest monthly fee. During the violent 1913 mining strikes, the brothers tried to remain neutral as they removed bullets from victims on both sides of the dispute.

The influenza epidemic of 1918 swept through Huerfano county and the lack of a hospital caused the brothers to set up cots for additional patients in their living quarters and in the upstairs offices. In November 1918, the entire building was given over to hospital functions, including an operating room. The following year the Lammes moved to Walsenburg and sold the hospital to Dr. A.J. Chisholm. The Doctors Lee (Earl, Lewis W., and Paul) leased the hospital from 1921 to 1923, and purchased it in 1923. With partners and assistants, they continued operating it as a hospital until 1937.

In 1944, the building was sold to Pete and Kate Gross, who used it as a private residence with occasional roomers until ca. 1955. It served as a private home from 1955 to 1980, until sold to Marilyn Hall, the current owner. She restored it for its present use as a bed and breakfast inn.

The firm of E.R. Coleman (made up of the Coleman brothers along with William Fey) built most of the stone structures in and around La Veta between the years of 1890 and 1920. These stone structures, which number at least two dozen, include commercial, residential, and institutional



United States Department of the Interior  
National Park Service

## National Register of Historic Places Continuation Sheet

Lamme Hospital  
Huerfano County, CO

Section number 8 Page 5

---

### SIGNIFICANCE (continued)

these buildings was quarried near La Veta on "Pinon Hill."

With twelve rooms, the hospital was La Veta's largest residence for many years and is still the town's largest sandstone residence. The hospital is a unique contribution to an area which has one of the largest concentrations of sandstone buildings in rural Colorado.

United States Department of the Interior  
National Park Service

National Register of Historic Places  
Continuation Sheet

Lamme Hospital  
Huerfano County, CO

Section number 9 & 10 Page 6

---

**BIBLIOGRAPHY**

Albright, Zalla Rae, One Man's Family: The Life of Hiram Vasquez, 1984.

Christofferson, Nancy Hirleman; Researcher. Murphy, Sara; Historical Survey Investigator. Property abstract of 314 South Main Street, La Veta, Colorado, 1983.

Pansy Coleman (wife of Coleman brother) interviewed by Nancy Christofferson, March 23, 1982. Nancy Christofferson files.

Lola Masinton interviewed by Nancy Christofferson, March 13, 1982. Nancy Christofferson files.

Arline Smirch interviewed by Nancy Christofferson, March 3, 1982. Nancy Christofferson files.

Huerfano World, Walsenburg, Colorado

Christofferson, Nancy C., "Lunch, fashions benefit Mar.27,"  
March 21, 1985, P.9.

"Lamme family doctors practice here 129 years," October 24, 1985, P.5.

La Veta Advertiser, La Veta, Colorado

July 17, 1909

December 31, 1909

May 19, 1911

August 10, 1945

November 1, 1918

**VERBAL BOUNDARY DESCRIPTION**

The east 115 feet of Lots 25-28, Block 7, Town of La Veta.

**BOUNDARY JUSTIFICATION**

The nominated property includes the entire parcel historically associated with the Lamme Hospital.

United States Department of the Interior  
National Park Service

# National Register of Historic Places Continuation Sheet

Lamme Hospital  
Huerfano County, CO

Section number \_\_\_\_\_ Page 7

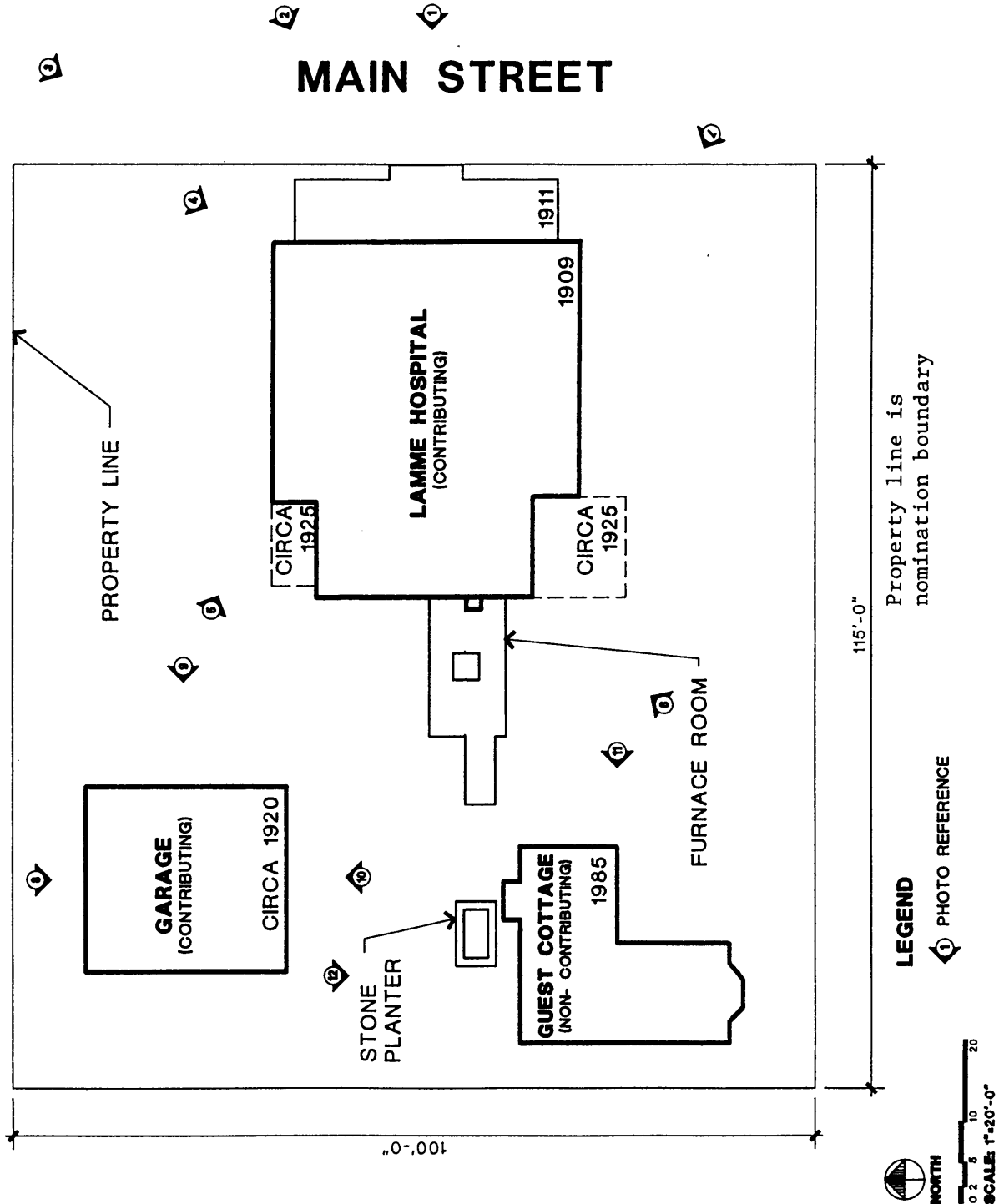

## FORT FRANCISCO PLAZA

United States Department of the Interior  
National Park Service

National Register of Historic Places  
Continuation Sheet

Lamme Hospital  
Huerfano County, CO

Section number photos Page 8

---

PHOTOGRAPH LOG

All photographs were taken by C.M. Cramer and the negatives are located in the photographer's files.

Photo No. 1 June 25, 1993, camera facing west.  
Front facade of Lamme Hospital.

Photo No. 2 June 25, 1993, camera facing west-southwest.  
Front facade of Lamme Hospital.

Photo No. 3 June 25, 1993, camera facing south-southwest.  
Setting of Lamme Hospital showing facade.

Photo No. 4 June 25, 1993, camera facing south-southwest.  
North elevation of Lamme Hospital.

Photo No. 5 June 25, 1993, camera facing south-southeast  
North and east elevations of Lamme Hospital.

Photo No. 6 June 25, 1993, camera facing north-northeast.  
East elevation of Lamme Hospital.

Photo No. 7 June 25, 1993, camera facing northwest.  
South elevation of Lamme Hospital.

Photo No. 8 June 25, 1993, camera facing south.  
North elevation of garage.

Photo No. 9 June 25, 1993, camera facing west.  
East elevation of garage.

Photo No. 10 June 25, 1993, camera facing north.  
South elevation of garage.

Photo No. 11 June 25, 1993, camera facing west.  
East elevation of guest cottage.

Photo No. 12 June 25, 1993, camera facing south.  
North elevation of guest cottage.