

**United States Department of the Interior
National Park Service**

**National Register of Historic Places
Continuation Sheet**

Section number _____ Page _____

SUPPLEMENTARY LISTING RECORD

NRIS Reference Number: 00001400	Date Listed: 11/29/00
Sedgewood Plantation	Madison MISSISSIPPI
Property Name	County State

N/A
Multiple Name

This property is listed in the National Register of Historic Places in accordance with the attached nomination documentation subject to the following exceptions, exclusions, or amendments, notwithstanding the National Park Service certification included in the nomination documentation.

Ma J. M. [Signature]
for Signature of the Keeper

11/30/00
Date of Action

=====
Amended Items in Nomination:

Section No. 8

This nomination is amended to add Criteria Consideration B, since the house was moved in 1942 a short distance from its original site and then moved back in 1993. The house has been carefully restored and is now close to its original location in a rural plantation setting little changed from its historic character.

This amendment has been confirmed with the Mississippi SHPO.

DISTRIBUTION:

- National Register property file
- Nominating Authority (without nomination attachment)

NPS Form 10-900
(Rev. 10-90)
United States Department of the Interior
National Park Service

OMB No. 1024-0018

OCT 23 2000

1400

**NATIONAL REGISTER OF HISTORIC PLACES
REGISTRATION FORM**

1. Name of Property

historic name: SEDGEWOOD PLANTATION
other names/site number:

2. Location

street & number: 2607 VIRLILIA ROAD
city or town: CANTON
state: MISSISSIPPI code: MS county: MADISON code: 89 zip code: 39046
Not for publication N/A
vicinity x

3. State/Federal Agency Certification

As the designated authority under the National Historic Preservation Act of 1966, as amended, I hereby certify that this X nomination request for determination of eligibility meets the documentation standards for registering properties in the National Register of Historic Places and meets the procedural and professional requirements set forth in 36 CFR Part 60. In my opinion, the property X meets does not meet the National Register Criteria. I recommend that this property be considered significant nationally statewide X locally. (See continuation sheet for additional comments.)

Signature of certifying official Date

Deputy State Historic Preservation Officer
State or Federal agency and bureau

In my opinion, the property meets does not meet the National Register criteria. (See continuation sheet for additional comments.)

Signature of commenting or other official Date

State or Federal agency and bureau

4. National Park Service Certification

I, hereby certify that this property is:
X entered in the National Register,
 See continuation sheet.
 determined eligible for the
National Register
 See continuation sheet.
 determined not eligible for the
National Register
 removed from the National Register
 other (explain):

Signature of the Keeper Date of Action

 11/29/00

Sedgewood Plantation

Madison County, MS

5. Classification

Ownership of Property: PRIVATE

Number of Resources within Property:
(Do not include previously listed resources in the count)

Category of Property: BUILDING

Contributing	Noncontributing
1	buildings
1	sites
	structures
	objects
2	Total

Name of related multiple property listing
(Enter "N/A" if property is not part of a multiple property listing.)

**Number of contributing resources previously listed
in the National Register**

0

6. Function or Use

Historic Functions: Domestic: Single dwelling

Current Functions: Domestic: Single dwelling

7. Description

Architectural Classification(s): Greek Revival

Materials:

foundation: BRICK
roof: FIBERGLASS SHINGLES
walls: WOOD CLAPBOARDS
other

Narrative Description:

See Continuation Sheets

8. Statement of Significance**Applicable National Register Criteria**

- A** Property is associated with events that have made a significant contribution to the broad patterns of our history.
- B** Property is associated with the lives of persons significant in our past.
- XX C** Property embodies the distinctive characteristics of a type, period, or method of construction or represents the work of a master, or possesses high artistic values, or represents a significant and distinguishable entity whose components lack individual distinction.
- D** Property has yielded, or is likely to yield information important in prehistory or history.

Areas of Significance

Architecture

Period of Significance

1842

Significant Dates

1842

Criteria Considerations:

Property is:

- A** owned by a religious institution or used for religious purposes.
- B** removed from its original location.
- C** a birthplace or a grave.
- D** a cemetery.
- E** a reconstructed building, object, or structure.
- F** a commemorative property.
- G** less than 50 years of age or achieved significance within the past 50 years.

Significant Person(s)**Cultural Affiliation(s)**

Architect/Builder
UNKNOWN

Narrative Statement of Significance: See continuation sheets.

9. Major Bibliographical References

Bibliography See continuation sheet.

Previous documentation on file (NPS)

- preliminary determination of individual listing (36 CFR 67) has been requested.
- previously listed in the National Register
- previously determined eligible by the National Register
- designated a National Historic Landmark
- recorded by Historic American Buildings Survey

- recorded by Historic American Engineering Record

Primary Location of Additional Data

- State Historic Preservation Office
- Other State agency
- Federal agency
- Local government
- University
- Other
- Name of repository: _____

Sedgewood Plantation

Madison County, MS

10. Geographical Data

Acreage of Property: 50 acres

UTM References:	Zone	Easting	Northing	Zone	Easting	Northing	
A	15	755380	3612120	C	15	756180	3611860
B	15	756170	3612300	D	15	755400	3611840

___ See continuation sheet.

Verbal Boundary Description See continuation sheet.

Boundary Justification: See continuation sheet.

11. Form Prepared By

name/title: WM. P. HOWARD, OWNER

organization:

date: 3-27-2000

street & number: 2607 VIRLILIA ROAD

telephone: 601-879-8739

city or town: CANTON,

state: MS.

Zip code: 39046

Additional Documentation

Submit the following items with the completed form:

Continuation Sheets

Maps

A USGS map (7.5 or 15 minute series) indicating the property's location.

A sketch map for historic districts and properties having large acreage or numerous resources.

Photographs

Representative black and white photographs of the property.

Additional items (Check with the SHPO or FPO for any additional items)

Property Owner(s)

name: WM. P. & NANCY HOWARD

street & number: 2607 VIRLILIA ROAD

telephone: 601-879-8739

city or town: CANTON

state: MS.

zip code: 39046

Paperwork Reduction Act Statement: This information is being collected for applications to the National Register of Historic Places to nominate properties for listing or determine eligibility for listing, to list properties, and to amend existing listings. Response to this request is required to obtain a benefit in accordance with the National Historic Preservation Act, as amended (16 U.S.C. 470 et seq.).

Estimated Burden Statement: Public reporting burden for this form is estimated to average 18.1 hours per response including the time for reviewing instructions, gathering and maintaining data, and completing and reviewing the form. Direct comments regarding this burden estimate or any aspect of this form to the Chief, Administrative Services Division, National Park Service, P.O. Box 37127, Washington, DC 20013-7127; and the Office of Management and Budget, Paperwork Reductions Projects (1024-0018), Washington, DC 20503.

**United States Department of the Interior
National Park Service
NATIONAL REGISTER OF HISTORIC PLACES
CONTINUATION SHEET**

Section: 7

Page: 1

**SEDGEWOOD PLANTATION
MADISON COUNTY, MISSISSIPPI**

Description of Physical Appearance

Sedgewood was established in 1842 as a 1200 acre plantation. It was located in North-central Madison County about 12 miles west of Canton and 5 miles east of Vernon, an extinct community north of present day Flora. The plantation residence and 700 acres remain today. The "big house" is a circa 1842 Greek Revival cottage with typical center hall floor plan. Except for the hand hewn oak sills, the entire house (exterior clapboards, all the framing lumber, floors and millwork) is constructed of heart cypress. There are four rooms (approximately 18' x 18') off the central hall (12' x 34') with a fifth room (also 18' x 18') in an ell to the rear. Windows have typical 6 over 6 double hung sashes with fixed louvered exterior shutters. The roof is hipped with 6 on 12 pitch except for the ell, which ends with a gable. Each corner has a prominent pilaster supporting a full molded entablature, which encircles the house and breaks forward to wrap around the hipped portico roof. The portico is especially ornate with eight Greek Doric fluted columns and a coffered, paneled ceiling. The recessed entry has Greek pilasters and two different styles of dentil molding over the doorway. Gothic Revival trefoil panels embellish both side walls and the ceiling above the recessed entry. Sidelights and transom are enhanced by diamond shaped stained glass panes of six different colors and Gothic trefoil panels below each sidelight.

The ceilings are 14 feet high and the house has five fireplaces (two back to back with double chimneys and one single). Interior doors are eight feet tall and composed of four panels. The front and rear doors off the central hall are double leafed. The original rear doors have two panels per leaf, as do the reproduction front doors. All door surrounds in the central hall have "Greek shouldered architrave" trim with pediments embellished with a battlemented or crenellated crest. The two front rooms have the same "Greek shoulder" trim around the doors and windows, except the pediments have a "wave motif" crest. The next two rooms have identical pilastered door and window trim with molded capitals supporting a smooth pediment. The fifth room in the ell has a similar treatment, but without capitals and with a simpler pediment.

The entire house was originally plastered. Apparently some repair work was done about 1897, during which the plaster walls in the ell and the ceiling and crown mold in the NW room were removed and beaded board was installed. Plaster remnants found behind the window headers demonstrated that there had been an elaborate denticulated Corinthian crown mold in the front two rooms. The central hall also had a very ornate Corinthian crown mold, although of a different configuration.

**United States Department of the Interior
National Park Service
NATIONAL REGISTER OF HISTORIC PLACES
CONTINUATION SHEET**

Section: 7

Page: 2

**SEDGEWOOD PLANTATION
MADISON COUNTY, MISSISSIPPI**

During World War II the United States government took many thousands of acres in Madison County to build the Kearney Park Army Camp. Unfortunately, 500 acres of that land was taken from Sedgewood. The "big house" lay across the section line of that property. My father was told to move the house or have it demolished. He moved the house by rolling it on logs and timbers pulled by a cable that was hooked to a turnstile propelled by a mule (Howard oral history). The house was only moved 50 feet to get it across the section line, but it was severely damaged. Plaster ceilings fell, walls shattered, and one chimney fell. The pegged mortise and tenon 8" by 10" oak sills came apart and gaps appeared in the floors of the central hall and in three rooms. Over the next 20 years, the damaged plaster was removed and replaced with fiberboard or sheet rock with the exception of the hall and NW room.

During 1993-94 the house underwent a complete restoration. It was moved back to its approximate original location and the structural damage from the 1942 move was repaired. The brick piers were rebuilt like the originals based on a pre-1940 photograph. The rusty tin roof was replaced with architectural fiberglass shingles that closely approximate the original cypress shingles. The many damaged windows were restored using antique wavy glass. The old damaged plaster and the later fiberboard/sheet rock was replaced with new sheet rock. The original hand split oak lathe was left in place and thinner 3/8" sheet rock was placed over it to maintain the original reveal around the trim. Plaster veneer finish was applied to the sheet rock. The crown molding in the hall was restored and in places where the damage was too great, it was replaced with an exact plaster reproduction. There were enough pieces of the original Corinthian crown mold found behind the door and window pediment trim in the front rooms to enable us to reproduce the plaster crown for those rooms also. When the interior trim and mantles were sanded to determine the original colors, it was discovered that black and gold marbleizing adorned the baseboards and mantles. The marbleizing was reproduced by an artisan from Natchez.

The only remaining outbuilding was a 10' by 12' clapboard smoke house with a gabled tin roof that was located to the rear of the big house. It was restored and now serves as a well house/utility service building. The various 1930's-40's additions to the rear of the house were removed during restoration. A new addition for the kitchen, utility room, and extra bedroom/bathes and farm office was built. Pains were taken to differentiate the new construction from the old.

**United States Department of the Interior
National Park Service
NATIONAL REGISTER OF HISTORIC PLACES
CONTINUATION SHEET**

Section: 7

Page: 3

**SEDGEWOOD PLANTATION
MADISON COUNTY, MISSISSIPPI**

Sedgewood is situated on the crest of a hill in rural Madison County in an appropriate setting of 160 year old cedar trees. The original abandoned sunken roadbed cuts deep between the present public road and the front yard. Sedgewood is once again the "big house" on a working farm surrounded by green pastures, cattle and cotton fields after its restoration back to the original appearance.

**United States Department of the Interior
National Park Service
NATIONAL REGISTER OF HISTORIC PLACES
CONTINUATION SHEET**

Section: 8

Page: 4

**SEDGEWOOD PLANTATION
MADISON COUNTY, MISSISSIPPI**

Statement of Significance

Sedgewood was built in 1842 as the "big house" for a 1200 acre plantation that by the 1890's was known as the Sedge Hill Place or Sedgewood Plantation. The land, located between the now extinct communities of Beatie's Bluff and Vernon, was purchased in 1841 by a lawyer and planter from Canton named John H. Thomas. By 1868 he had either died or fallen on hard times as the plantation was sold to someone in Massachusetts. Between 1868 and 1897 the place changed ownership five times, always to a Northern absentee landowner who rented it to local cotton farmers. In 1897, W. E. Parkinson, a native of New York and former Lt. Governor of Washington state, bought Sedgewood and moved South to become a cotton farmer. It was probably about this time that the house had some renovation (Parkinson oral history).

By 1901 Mr. Parkinson had all the cotton farming he wanted and leased the place out to my grandparents, Percy O'Leary and "Miss Lizzie" Griffin Howard, who farmed nearby. They and my father, John W. G. Howard, who was five years old, moved to Sedgewood in 1901 and lived there the remainder of their lives. After my father's death in 1965 we built a new home and the "old house" was occupied by a succession of farm laborer's families. The house continued to decline after it became vacant in 1988. My family rented the plantation from 1901 until 1988 at which time we purchased Sedgewood. Although we had rented it for 87 years, this made the first time in 120 years that Sedgewood had been owned by a local Southern family. During 1993-1994 we restored the house to its original appearance and made it our home again.

Sedgewood is a good example of an antebellum upper middle-class planter's home. It is not as massive as the two story mansions of Natchez, yet it is very sophisticated architecturally with an elegant portico, elaborate recessed entry, ornate interior trim details, marbleizing, and plaster crown mold. Its architectural style is classic Greek revival, however, Gothic panels are used extensively in the portico's recessed entry. This structure is significant in that it is very ornate for what was then the backwoods of Madison County. It is also important because it is one of the few remaining antebellum planter's homes in Madison County and one of the even fewer that is still intact with most of the original land.

**United States Department of the Interior
National Park Service
NATIONAL REGISTER OF HISTORIC PLACES
CONTINUATION SHEET**

Sections: 9 & 10

Page: 5

**SEDGEWOOD PLANTATION
MADISON COUNTY, MISSISSIPPI**

BIBLIOGRAPHICAL REFERENCES

Howard, John W. G., lived at Sedgewood from 1901 – 1965 and was the father of the interviewer. Oral history gleaned from conversations from 1960 – 1965.

Parkinson, Samuel G., whose father (W. E. Parkinson) bought Sedgewood in 1897. Oral history gleaned by Wm. P. Howard from 1957 – 1977.

VERBAL BOUNDARY DESCRIPTION

Beginning at the intersection of Virilia Road and the east boundary of the SW1/4 of Section 14, Township 9 North, Range 1 West, Madison County, Miss.; run south to a concrete marker at the NE corner of the NW1/4 of Section 23; continue south 740 feet; then run west 1980 feet to the west boundary of Section 23; then north to Virilia Road; then continue easterly along Virilia Road to the point of beginning.

BOUNDARY JUSTIFICATION

Of the 1200 acres in the original 1842 plantation, 700 acres remain with the house today. Fifty acres define the vista and setting of the "big house" and are therefore included in this nomination.

**United States Department of the Interior
National Park Service
NATIONAL REGISTER OF HISTORIC PLACES
CONTINUATION SHEET**

Section: PHOTOGRAPHS

Page: 6

**SEDGEWOOD PLANTATION
MADISON COUNTY, MISSISSIPPI**

The following information is the same for all photographs:

- (1) Sedgewood Plantation
- (2) Madison County, Mississippi
- (3) Wm. P. Howard
- (4) April 26, 2000
- (5) Mississippi Department of Archives and History

- Photo 1 North elevation, view to south
- Photo 2 West elevation, view to southeast
- Photo 3 East elevation, view to southwest
- Photo 4 South elevation, view to north
- Photo 5 East elevation of smokehouse, view to northwest
- Photo 6 Entry door side light, exterior view
- Photo 7 Entry door, north end of central hall
- Photo 8 Architectural details over entry door
- Photo 9 Rear door, south end of central hall
- Photo 10 Crown mold in central hall
- Photo 11 Doorway details in central hall
- Photo 12 Crown mold in northwest room

**United States Department of the Interior
National Park Service**

**NATIONAL REGISTER OF HISTORIC PLACES
CONTINUATION SHEET**

Section: PHOTOGRAPHS

Page: 7

SEDGEWOOD PLANTATION
MADISON COUNTY, MISSISSIPPI

Photo 13 Doorway details in northwest room

Photo 14 Mantle piece in northwest room

Photo 15 Doorway details in southwest room

Photo 16 Crown mold in southwest room

Photo 17 Doorway details in ell

FIRST FLOOR

NORTH



New Addition
Original House

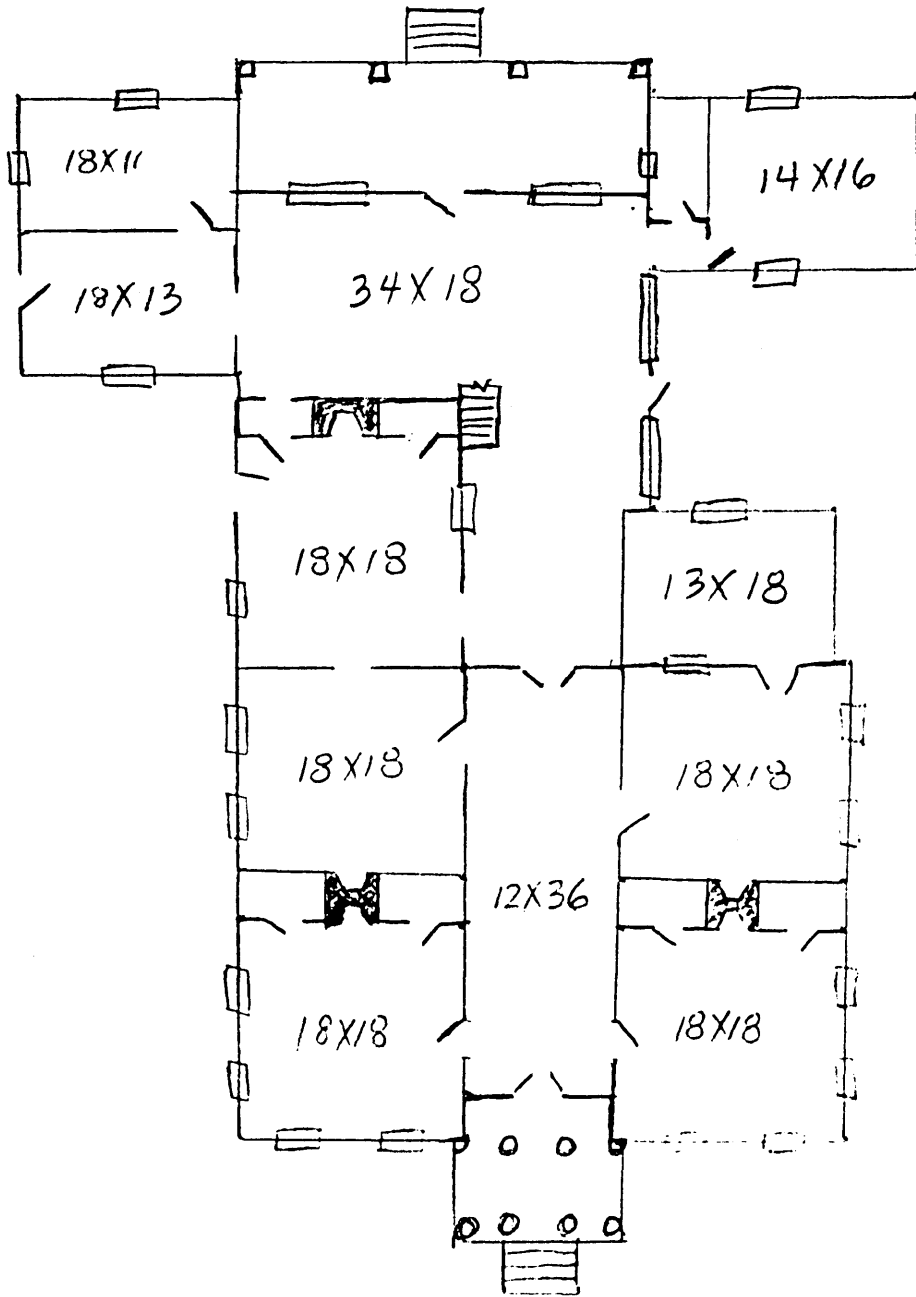

SEDGEWOOD PLANTATION
MADISON CO., MISS.

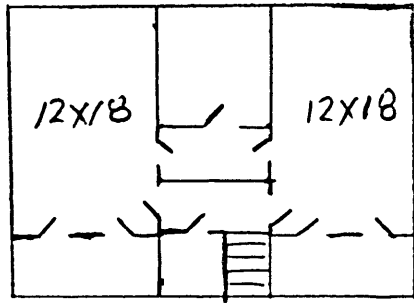

Second Floor
(new addition)

NORTH



SEDGEWOOD PLANTATION
MADISON CO., MISS.