

**United States Department of the Interior
National Park Service**

For NPS use only

**National Register of Historic Places
Inventory—Nomination Form**

received DEC 26 1985

date entered JAN 23 1986

See instructions in *How to Complete National Register Forms*
Type all entries—complete applicable sections

1. Name

historic Joseph Petitpierre (Kleinpeter) House

and or common Same

2. Location

street & number 5544 Highland Road N/A not for publication

city, town Baton Rouge N/A vicinity of

state Louisiana code 22 ~~county~~ parish East Baton Rouge code 033

3. Classification

Category	Ownership	Status	Present Use	
<input type="checkbox"/> district	<input type="checkbox"/> public	<input type="checkbox"/> occupied	<input type="checkbox"/> agriculture	<input type="checkbox"/> museum
<input checked="" type="checkbox"/> building(s)	<input checked="" type="checkbox"/> private	<input type="checkbox"/> unoccupied	<input type="checkbox"/> commercial	<input type="checkbox"/> park
<input type="checkbox"/> structure	<input type="checkbox"/> both	<input checked="" type="checkbox"/> work in progress	<input type="checkbox"/> educational	<input type="checkbox"/> private residence
<input type="checkbox"/> site	Public Acquisition	Accessible	<input type="checkbox"/> entertainment	<input type="checkbox"/> religious
<input type="checkbox"/> object	<u>N/A</u> in process	<input type="checkbox"/> yes: restricted	<input type="checkbox"/> government	<input type="checkbox"/> scientific
	<u>N/A</u> being considered	<input checked="" type="checkbox"/> yes: unrestricted	<input type="checkbox"/> industrial	<input type="checkbox"/> transportation
		<input type="checkbox"/> no	<input type="checkbox"/> military	<input checked="" type="checkbox"/> other: restoration in progress for use as historic house museum

4. Owner of Property

name Robert H. Hodges

street & number 5566 Highland Road

city, town Baton Rouge N/A vicinity of state LA 70808

5. Location of Legal Description

courthouse, registry of deeds, etc. East Baton Rouge Parish Courthouse

street & number 222 St. Louis Street P. O. Box 1991

city, town Baton Rouge state LA 70821

6. Representation in Existing Surveys

title LA Historic Sites Survey has this property been determined eligible? yes no

date 1985 federal state county local

depository for survey records LA State Historic Preservation Office

city, town Baton Rouge state LA

7. Description

Condition		Check one	Check one
<input type="checkbox"/> excellent	<input type="checkbox"/> deteriorated	<input type="checkbox"/> unaltered	<input type="checkbox"/> original site
<input checked="" type="checkbox"/> good	<input type="checkbox"/> ruins	<input checked="" type="checkbox"/> altered	<input checked="" type="checkbox"/> moved date 1985
<input type="checkbox"/> fair	<input type="checkbox"/> unexposed		

Describe the present and original (if known) physical appearance

The Joseph Petitpierre House is an early nineteenth century bousillage Creole cottage located in a suburban area of Baton Rouge. Despite a short move and numerous alterations, the house retains its National Register eligibility.

Opinions differ as to the exact date of construction. In his historic structure report, George Fore tentatively placed the date between 1800 and 1805 based largely upon nail chronology. Mr. Fore notes that the documented dates of production for early machine cut nails such as those found in the house "range from the early to mid 1790's to 1810, with some evidence of their being produced into the early 1820's." "With the other details of the house," concluded Fore, "a narrow range of construction dates would be 1800 to 1805." Subsequent to Fore's analysis, the project architect found the date 1816 stamped in one of the iron fireplace lintels. Since it has no bearing upon the National Register eligibility of the house, the State Historic Preservation Office has decided to avoid this controversy and use the more general term "early nineteenth century."

The Petitpierre House began as a typical Creole plantation house with a front gallery, two front rooms, a rear gallery, and two cabinets. It had a massive hip roof with "outlookers" and a more or less central chimney. A noteworthy feature of the house was the medieval style attic structure with its king posts, struts, principal rafters, and common rafters. Window and door surrounds were primitive with exposed structural members forming most of the visible surround. Surrounds were accented with molded strips. Other features included walls plastered flush with the exposed studs, chair rails, and beaded beam ceilings.

In the early twentieth century the house was extended in the rear and given a low-key bungalow treatment. Major changes included:

1. The replacement of the front gallery columns.
2. The moving of one of the original two front doors.
3. The installation of modern doors and windows.
4. The removal of the old rear wall.
5. The installation of plain brick mantels.
6. The removal of chair rails, baseboards and decorative molding.
7. The addition of a new pitched roof. (The original hip roof structure was left intact underneath.)

By the early 1980's the house had fallen into disrepair. Plywood paneling and wall-to-wall carpeting had been installed. The eleven acre tract on which the house stood was for sale and the decrepit structure was thought to be a hindrance to potential buyers. Demolition was contemplated.

The present owner was allowed to purchase the structure with the condition that he move it off the tract. It was moved some three and a half miles to the north and west. The present setting is somewhat more developed than the original, and the direction of the house has been reversed. Nonetheless, the structure has not been moved out of the area which is the context for its architectural significance (i.e., East Baton Rouge Parish). Moreover, the present lot is open and well treed enough to still convey something of a rural character.

**United States Department of the Interior
National Park Service**

**National Register of Historic Places
Inventory—Nomination Form**

For NPS use only

received

date entered

Continuation sheet Joseph Petitpierre House Item number 7

Page 1

7. Description (cont'd)

Assessment of Integrity

The house is presently undergoing a complete restoration under the guidance of the State Historic Preservation Office. All early twentieth century changes have been reversed, and when the work is complete, the house will certainly convey its early nineteenth century appearance. Many of the features have had to be replaced; however, the house still retains the following original features:

1. Its plan and configuration.
2. Its building mass and roof shape.
3. Its fenestration pattern.
4. All but one of its bousillage walls.
5. Its exposed studs.
6. Its beaded beam ceilings.
7. Its clapboards.
8. Its original structural fenestration surrounds (without moldings).
9. Its original floors.
10. Its original medieval style attic structure minus a few members.

These features establish the local architectural significance of the Petitpierre House. Consequently in our opinion it retains enough integrity to merit a Register listing.

8. Significance

Period	Areas of Significance—Check and justify below			
<input type="checkbox"/> prehistoric	<input type="checkbox"/> archeology-prehistoric	<input type="checkbox"/> community planning	<input type="checkbox"/> landscape architecture	<input type="checkbox"/> religion
<input type="checkbox"/> 1400–1499	<input type="checkbox"/> archeology-historic	<input type="checkbox"/> conservation	<input type="checkbox"/> law	<input type="checkbox"/> science
<input type="checkbox"/> 1500–1599	<input type="checkbox"/> agriculture	<input type="checkbox"/> economics	<input type="checkbox"/> literature	<input type="checkbox"/> sculpture
<input type="checkbox"/> 1600–1699	<input checked="" type="checkbox"/> architecture	<input type="checkbox"/> education	<input type="checkbox"/> military	<input type="checkbox"/> social/ humanitarian
<input type="checkbox"/> 1700–1799	<input type="checkbox"/> art	<input type="checkbox"/> engineering	<input type="checkbox"/> music	<input type="checkbox"/> theater
<input checked="" type="checkbox"/> 1800–1899	<input type="checkbox"/> commerce	<input type="checkbox"/> exploration/settlement	<input type="checkbox"/> philosophy	<input type="checkbox"/> transportation
<input type="checkbox"/> 1900–	<input type="checkbox"/> communications	<input type="checkbox"/> industry	<input type="checkbox"/> politics/government	<input type="checkbox"/> other (specify)
		<input type="checkbox"/> invention		

Specific dates early 19th century **Builder/Architect** Builder: Joseph Petitpierre (Kleinpeter)

Statement of Significance (in one paragraph) Criterion C

The Joseph Petitpierre House is locally significant in the area of architecture as a rare example of the Creole style, and more importantly, of bousillage construction within East Baton Rouge Parish.

Bousillage was a prevalent form of construction in French Louisiana during the eighteenth and early nineteenth centuries. Undoubtedly there were innumerable examples in East Baton Rouge Parish at one time. The Petitpierre House, however, is one of only four that survive. It is a worthy example because it retains all but one of its original bousillage walls. Also, it is one of only two featuring the more typical bousillage interior treatment--i.e., exposed studs.

In addition, the house has a lesser degree of significance as an example of the Creole style. Its four room plan is typical of many smaller plantation houses across South Louisiana. These were far more numerous than grand Creole houses such as Parlange (NHL, Pointe Coupee Parish) or Magnolia Mound (NR, Baton Rouge). Yet they have not tended to survive as well. For example, the Petitpierre House is one of only two remaining examples in East Baton Rouge Parish. Characteristics which establish the house as an example of the style include the hip roof configuration, the four room hall-less plan, the front fenestration pattern, the two cabinets, and the use of bousillage.

Historical Note:

Joseph Petitpierre (Kleinpeter) acquired the land on which the house was built from the Spanish government in 1786. He owned the property until his death in 1823.

9. Major Bibliographical References

Fore, George T. The Kleinpeter House: Architectural and Finishes Analysis, January 1985, Copy at Louisiana State Historic Preservation Office.

Research conducted by and for the owner in primary sources such as conveyance records, probate records, church records, etc.

10. Geographical Data

Acreeage of nominated property @ 1/8th of an acre

Quadrangle name Baton Rouge West, LA

Quadrangle scale 1:24000

UTM References

A

1	5	6	7	7	0	4	0	3	3	6	3	4	4	0
Zone			Easting					Northing						

B

Zone			Easting					Northing						

C

Zone			Easting					Northing						

D

Zone			Easting					Northing						

E

Zone			Easting					Northing						

F

Zone			Easting					Northing						

G

Zone			Easting					Northing						

H

Zone			Easting					Northing						

Verbal boundary description and justification

Please refer to enclosed sketch map. Boundaries were chosen to encompass the resource. It is a moved building, and hence there is no historic setting to recognize. Moreover, nominating all the land under single ownership would have meant including a modern unrelated residence.

List all states and counties for properties overlapping state or county boundaries

state N/A code county code

state code county code

11. Form Prepared By

name/title National Register Staff ASSISTED BY OWNER
Division of Historic Preservation

organization State of Louisiana date October 1985

street & number P. O. Box 44247 telephone (504) 922-0358

city or town Baton Rouge state LA

12. State Historic Preservation Officer Certification

The evaluated significance of this property within the state is:

national state local

As the designated State Historic Preservation Officer for the National Historic Preservation Act of 1966 (Public Law 89-665), I hereby nominate this property for inclusion in the National Register and certify that it has been evaluated according to the criteria and procedures set forth by the National Park Service.

State Historic Preservation Officer signature 

Robert B. DeBlieux

title State Historic Preservation Officer date December 20, 1985

For NPS use only

I hereby certify that this property is included in the National Register

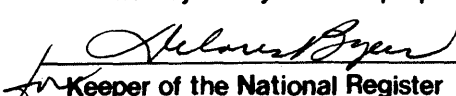
 date 1-23-86
Keeper of the National Register National Register

Attest: _____ date _____

Chief of Registration

BOUNDARY BOUNDARIES PARALLEL
BUILDING ELEVATIONS
AT A DISTANCE OF
TEN FEET

JOSEPH PETITPIERRE
HOUSE EAST BATON ROUGE
PARISH, LA.

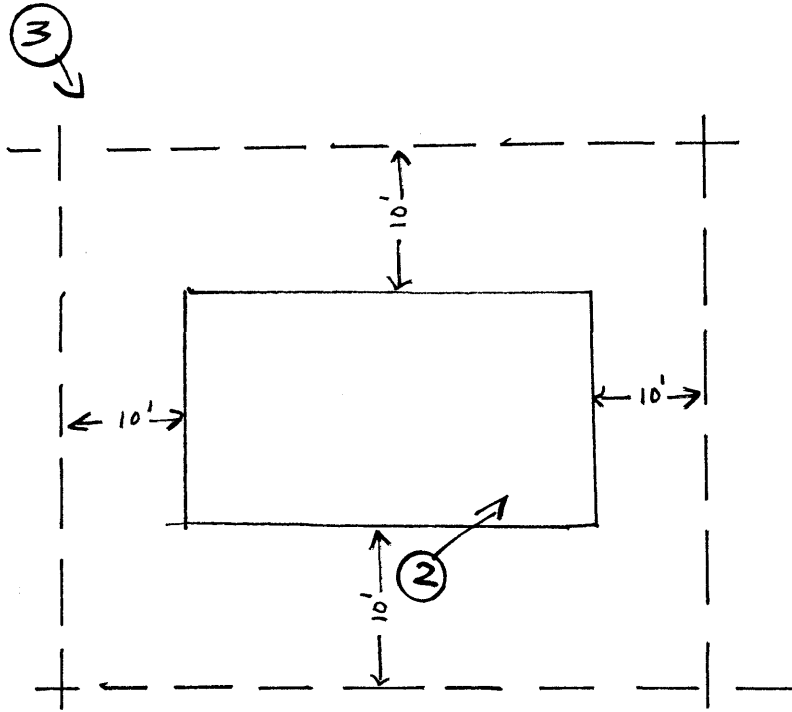

TO HIGHLAND
ROAD

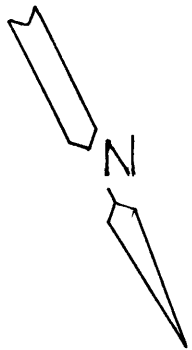

(NOT TO SCALE)