

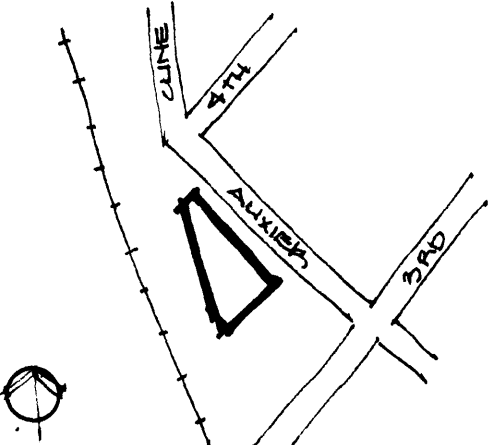

KENTUCKY HISTORIC RESOURCES INVENTORY

Site No. PIP 45

1. Historic Name(s) <u>R.T. Greer and Co. Root & Herb</u> Original Owner		22. ADD/County <u>Big Sandy/ Pike</u> 098	
2. Present Name <u>Greer Root and Herb</u>		23. U.S.G.S. Quadrant (15'/75') <u>Pikeville</u> G.I.S. Mod.	
3. Location <u>Auxier St. Pikeville, Ky. 41501</u>		24. UTM Reference <u>17 365710 4149200</u> Zone Easting Northing	
4. Owner's Name <u>Mr. Bruce Walters/ Bruce Walters Ford</u> <u>South Mayo Trail Pikeville</u>		25. Coordinate Accuracy 	
5. Owner's Address <u>Mr. Jeff Ward Citizens Bank Bldg.</u> <u>Pikeville, Ky. 41501</u>		26. Prehistoric Site Object Historic Site Structure <input checked="" type="checkbox"/> Building Other	
6. Open to Public Yes <input type="checkbox"/> No <input checked="" type="checkbox"/>	7. Visible from road Yes <input checked="" type="checkbox"/> No <input type="checkbox"/>	8. Ownership X Private <input checked="" type="checkbox"/> Local <input type="checkbox"/> State <input type="checkbox"/> Federal <input type="checkbox"/>	
9. Local Contact/Organization <u>Preservation Council of Pike Co.</u>		27. National Register District Name: <u>Multiple Resources of Pikeville</u> 	
10. Site Plan with North Arrow 		11. Architect 12. Builder 13. Date <u>1912</u> A. <input checked="" type="checkbox"/> B. <input type="checkbox"/> 14. Style A. <u>vernacular</u> <input checked="" type="checkbox"/> B. <input type="checkbox"/> 15. Original Use <u>large scale com.</u> <input checked="" type="checkbox"/> F 16. Present use <u>warehouse</u> 17. Condition <u>Fair</u> <input checked="" type="checkbox"/> C	
18. Description <u>Three story brick warehouse</u> <u>with round arched double win-</u> <u>dows and corbelled brick</u> <u>cornice</u> (Continue on Back)		29. Status Date National Landmark <input type="checkbox"/> National Register <input type="checkbox"/> Landmark Certificate <input type="checkbox"/> Kentucky Survey <input type="checkbox"/> Local Landmark <input type="checkbox"/> HABS/HAER <input type="checkbox"/> 30. Historic Theme Primary <input type="checkbox"/> Secondary <input type="checkbox"/> Other <input type="checkbox"/> 31. Endangered Yes <input type="checkbox"/> No <input type="checkbox"/> 32. Preservation Project Status Actual Cost in \$1,000s 	
19. History		33. ATTACH PHOTO  Roll No. Picture No. Direction	
20. Significance <u>One of two remaining brick</u> <u>warehouses left from the</u> <u>railroad era in Pikeville</u>		34. Prepared by: <u>Helen Powell</u> 35. Organization <u>Carman and Powell, Inc.</u> 36. Date <u>3/83</u>	
21. Source of Information <u>Sandborn Insurance Map 1920</u>		37. Revision Dates 38. Staff Review	

KENTUCKY HISTORIC RESOURCE INVENTORY SUPPLEMENT
BOUNDARY AND LOCATION INFORMATION

Historic Property Name R.T. Greer and Co. Site # PIp 45
Multiple Resource/Thematic Nomination Title Root and Herb Multiple Resources of Pikeville

U.T.M. Coordinates - List multiple UTMs if property is ten or more acres.

A. 17 365710 4149200 D. _____
B. _____ E. _____
C. _____ F. _____

Verbal Boundary Description Acreage .15

Beginning at the south corner of Auxier and Fourth, 60 feet west to the point of beginning; then 85 feet west along the north facade of Greer Root and Herb to the alley; then south 70 feet to a point; then 100 feet northeast to a point; then 20 feet north to the point of beginning.

Sketch of Site Plan (Showing outbuildings, structures, landscape features and the site boundary as described above.)

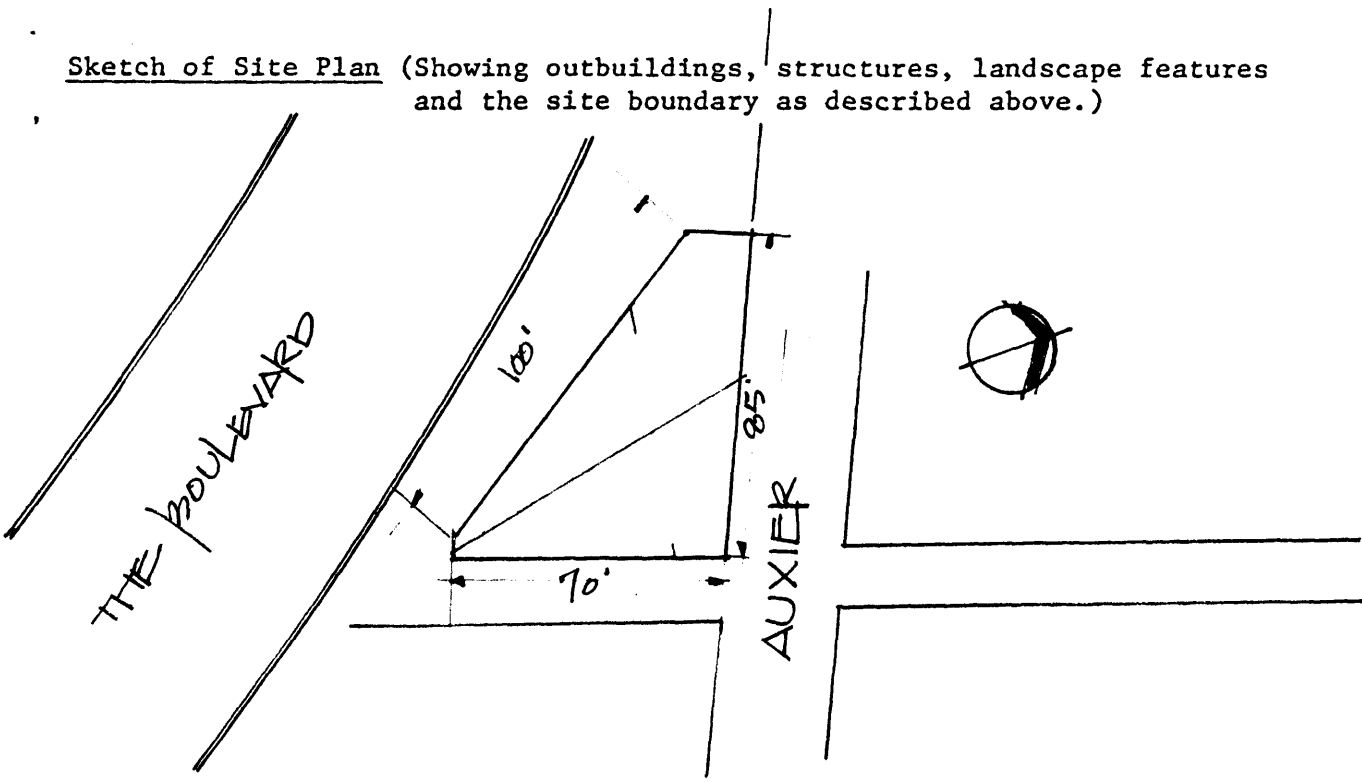

Official Courthouse Property Reference: