

RECEIVED

United States Department of the Interior
National Park Service

FEB 14 1994

NATIONAL REGISTER OF HISTORIC PLACES
REGISTRATION FORM

NATIONAL
REGISTER

1. Name of Property

historic name: Panola Street, North, Historic District

other name/site number: N/A

2. Location

street & number: 101 South Panola Street; 104, 106 and 108 North Panola Street

not for publication: N/A

city/town: Senatobia

vicinity: N/A

state: Mississippi code: MS county: Tate code: 137 zip code: 38668

3. State/Federal Agency Certification

As the designated authority under the National Historic Preservation Act of 1986, as amended, I hereby certify that this nomination request for determination of eligibility meets the documentation standards for registering properties in the National Register of Historic Places and meets the procedural and professional requirements set forth in 36 CFR Part 60. In my opinion, the property meets does not meet the National Register Criteria. I recommend that this property be considered significant nationally statewide locally. (See continuation sheet for additional comments.)

Kenneth H. P. Pool
Signature of certifying official

February 1, 1994
Date

Deputy State Historic Preservation Officer
State or Federal agency and bureau

In my opinion, the property meets does not meet the National Register criteria. (See continuation sheet for additional comments.)

Signature of commenting or other official

Date

State or Federal agency and bureau

4. National Park Service Certification

I, hereby certify that this property is:

- entered in the National Register
 ___ See continuation sheet.
- determined eligible for the
 National Register
 ___ See continuation sheet.
- determined not eligible for the
 National Register
- removed from the National Register
- other (explain): _____

Mag M. Way 3/31/94

for Signature of Keeper Date of Action

5. Classification

Ownership of Property: Private

Category of Property: District

Number of Resources within Property:

Contributing	Noncontributing	
10	-0-	buildings
1	-0-	sites
-0-	-0-	structures
-0-	-0-	objects
11	-0-	Total

Number of contributing resources previously listed in the National Register: N/A

Name of related multiple property listing:

Architectural and Historical Resources of Senatobia, Mississippi

Panola Street, North Historic District

Senatobia, Tate County, MS

6. Function or Use

Historic: DOMESTIC
DOMESTIC

Sub: Single dwelling
Secondary structure

Current : DOMESTIC
DOMESTIC

Sub: Single dwelling
Secondary structure

7. Description

Architectural Classification:

Italianate
Craftsman
Colonial Revival

Other Description: N/A

Materials: foundation BRICK roof ASPHALT
walls BRICK other sheet metal roofing
Weatherboard

8. Statement of Significance

APPLICABLE NATIONAL REGISTER CRITERIA

AREAS OF SIGNIFICANCE

- A Property is associated with events that have made a significant contribution to the broad patterns of our history.
- B Property is associated with the lives of persons significant in our past.
- X C Property embodies the distinctive characteristics of a type, period, or method of construction or represents the work of a master, or possesses high artistic values, or represents a significant and distinguishable entity whose components lack individual distinction.
- D Property has yielded, or is likely to yield, information important in prehistory or history.

ARCHITECTURE

PERIOD OF SIGNIFICANCE

Ca. 1875 to Ca. 1930

CRITERIA CONSIDERATIONS N/A

SIGNIFICANT DATES

N/A

Property is:

- A owned by a religious institution or used for religious purposes
- B removed from its original location.
- C a birthplace or grave
- D a cemetery
- E a reconstructed building, object, or structure
- F a commemorative property
- G less than 50 years of age or achieved significance within the past 50 years.

SIGNIFICANT PERSON

N/A

CULTURAL AFFILIATION

N/A

ARCHITECT/BUILDER

Various, unknown

=====

9. MAJOR BIBLIOGRAPHICAL REFERENCES

=====

X See continuation sheet.

PREVIOUS DOCUMENTATION ON FILE (NPS):

preliminary determination of individual listing (36 CFR 67) has been requested.

previously listed in the National Register
previously determined eligible by the National Register
designated a National Historic Landmark
recorded by Historic American Buildings Survey # _____
recorded by Historic American Engineering Record # _____

PRIMARY LOCATION OF ADDITIONAL DATA:

<input checked="" type="checkbox"/> State historic preservation office	Local government
Other state agency	University
Federal agency	Other

Specify Repository: Mississippi Department of Archives and History

=====

10. Geographical Data

=====

Acreage of Property: Approximately three acres

UTM References:	Zone	Easting	Northing	Zone	Easting	Northing
		Senatobia Quadrangle				
	E 16	227840	3834780	F 16	227820	3834440
	G 16	227580	3834450	_____	_____	_____

___ See continuation sheet.

Verbal Boundary Description: See continuation sheet.

Boundary Justification: See continuation sheet.

=====

11. Form Prepared By

=====

Name/Title: John Linn Hopkins, Preservation Consultant

Organization: N/A

Date: June 1, 1993

Street & Number: 974 Philadelphia Street

Telephone: (901) 278-5186

City or Town: Memphis

State: TN ZIP: 38104

=====

PROPERTY OWNER

=====

Name: Various

Street & Number: N/A

Telephone: N/A

City/Town: N/A

State: N/A

Zip Code: N/A

United States Department of the Interior
National Park Service

RECEIVED

NATIONAL REGISTER OF HISTORIC PLACES
CONTINUATION SHEET

FEB 14 1994

Section number 7 Page # 1 Panola Street, North, ~~NATIONAL~~ District
Senatobia, Tate County ~~REGISTER~~

=====

NARRATIVE DESCRIPTION

The Panola Street, North, Historic District is made up of a small group of residential properties located along the west side of Panola Street, between its intersection with West Main and Strayhorn streets. The district is composed of four principal residences, constructed over a period of ca. 1875-80 to ca. 1925-30.

Landscape characteristics of the district include mature street trees in varieties of oak and maple placed near the front edges of lots. Structures are sited atop low land terraces, some of which are separated from the grade-level sidewalk by modest retaining walls. Structures in the district are placed on an irregular pattern of lots with frontages that range from ninety to 230 feet; lot depths range from 230 feet to 500 feet. Front setbacks of structures range from forty to one hundred feet.

While most of the structures in the district simply face the right-of-way of Panola Street, the Chambless-Carloch House was sited at an angle to Panola Street so that its facade was perpendicular to the terminus of West Main Street, centered on its front door. This clever attention to detail insured that the house would occupy one of the most prominent sites in Senatobia, seen at the end of the sweeping vista west on Main Street from the Tennessee and Mississippi Railroad (now Illinois Central Gulf) tracks-- a position it retains today.

Architectural styles in evidence in the district are Italianate and Craftsman influences; house types found here include a side L-plan house, a center hall plan cottage and two bungalows.

The inventory of the structures and outbuildings in the district follows. All of the principal houses and secondary structures found in this district at the time of this nomination contribute to its historical character; these structures have been given the notation of "C" as further confirmation of this assessment.

The elements provided by individual lots and general streetscapes establish an important contribution to the qualities of the district's historic setting, as evolved over time. The pattern of lot divisions, front yard, and side yard setbacks all establish the matrix of rhythm evidenced by its historic buildings; its pattern of historic street trees, sidewalks, land terraces, lawns and private plantings all stand as evidence of continuity within the district as a place for living. All of these diverse elements contribute in important ways to the character of the district, but are not presented in the inventory of structures which follows. Never-the-less, these characteristics have been accounted for in the resource count as a single contributing site.

United States Department of the Interior
National Park Service

NATIONAL REGISTER OF HISTORIC PLACES
CONTINUATION SHEET

Section number 7 Page # 2 Panola Street, North, Historic District
Senatobia, Tate County, MS
=====

- 001 C 101 South Panola Street Chambless-Carlock House
Two-story, five-bay, load-bearing brick, side L-plan house with Italianate influence, built ca. 1880-85. Gable roofs with bracketed boxed cornice, covered with asphalt shingles. Gable ends are closed, with dentiled cornice and bull's-eye windows. Window reveals are segmental arched with corbeled hoods, and contain 4/4 DHSL. Partial width, two-story, shed-roofed porch supported by chamfered boxed posts, with wrought iron balustrade. Door is a single-light door with segmental transom.
- a. Servant's Quarters, ca. 1880-85. One-story, two-bay, frame, side gable roof covered with sheet metal, shed porch supported by posts, asphalt roll siding, 4/4 DHSL, solid board door. (C)
 - b. Storage Barn, ca. 1900-10. One-story, one-bay, frame, gable roof, vertical board siding, side shed additions. (C)
 - c. Equipment Barn, ca. 1920-25. One-story, three-bay, frame, gable roof, vertical board siding. (C)
- 002 C 104 North Panola Street
One-story, three-bay, frame bungalow with Craftsman influence, built ca. 1910-15. Hip roof with exposed rafter tails, covered with asphalt shingles. Shed-roofed dormer contains two single-light windows. Exterior wall surfaces covered with aluminum siding. Windows are 15/1 DHSL. Full-width shed-roofed porch supported by battered boxed piers on brick bases with a closed brick balustrade. Entrance contains a Craftsman multi-light door.
- 003 C 106 North Panola Street
One-story, five-bay, frame, center hall cottage with Italianate influence, built ca. 1875-80. Side-gable roof with boxed cornice, covered with asphalt shingles. Exterior wall surfaces covered with weatherboard siding. Windows are 4/4 DHSL. Full-width, shed-roofed porch supported by chamfered boxed posts and scroll-sawn brackets, with a turned balustrade. Entrance contains a single-light, three-panel door topped by a single-light transom.
- Shed, ca. 1880-85. One-story, one-bay, frame, gable roof, weatherboard siding, hinged boarded doors. (C)

United States Department of the Interior
National Park Service

NATIONAL REGISTER OF HISTORIC PLACES
CONTINUATION SHEET

Section number 7 Page # 3 Panola Street, North, Historic District
Senatobia, Tate County, MS
=====

004 C 108 North Panola Street

One-story, five-bay, brick-veneered bungalow with Craftsman influence, built 1925-30. Gable roof with exposed rafter tails, fascia board and knee brace brackets, covered with asphalt shingles. Windows are 6/6 DHSL. Partial-width gable-front porch with side, hip-roofed porte-cochere, supported by brick piers with a closed brick balustrade. Entrance contains a Craftsman multi-light door.

- a. Garage, ca. 1925-30. One-story, one-bay, brick veneer, gable roof. (C)
- b. Shed, ca. 1925-30. One-story, three-bay, frame, gable roof, sheet metal siding, 6/6 DHSL, hinged boarded doors. (C)

United States Department of the Interior
National Park Service

NATIONAL REGISTER OF HISTORIC PLACES
CONTINUATION SHEET

Section number 8 Page # 4 Panola Street, North Historic District
Senatobia, Tate County, MS
=====

NARRATIVE STATEMENT OF SIGNIFICANCE

The Panola Street, North, Historic District is being proposed for nomination under criterion C in the area of architecture for its small but significant collection of nineteenth and early twentieth century house types and architectural influences. The well-preserved Italianate residences found here effectively reflect the prevalent architectural taste popular in the early years of Senatobia's development; the Craftsman bungalows contained in the district reflect contributions made during the last major historic building period in Senatobia. The period of significance was selected on the basis of the date of construction for the earliest building and the date of construction for the ~~last~~ building with the district.

The Panola Street, North, Historic District reflects a development pattern that is consistent with that of the pattern of Senatobia as a whole. Residential development along this portion of Panola Street is tied, in part, to the importance of Panola Street as a major early road transportation corridor. It appears that the Panola Road was developed in ca. 1875-1880 to replace the Stage Road as the major north-south roadway linking the courthouse of DeSoto County in Hernando with the original courthouse of Panola County at Sardis. The realignment of the road section through this area was made to provide more convenient access to the new Tate County Courthouse, established in Senatobia following the creation of the new county in 1873 (see Tate County Courthouse, NR pending). The earliest of structures in the Panola Street, North district reflect residential development that followed soon after the completion of the new roadway.

The fact that two distinct development periods are in evidence in the district reflect the effects of the division of larger lots in the area and subsequent infill construction. There have been further subdivisions of some lots in the years since the close of the historical period of significance; the non-historic properties resulting from these subdivisions have not been included in the boundaries of the district.

Though small in number, the Panola Street, North, Historic District provides a sense of continuity to the aspects of time and place uniquely reflective of the historical development of Senatobia.

United States Department of the Interior
National Park Service

NATIONAL REGISTER OF HISTORIC PLACES
CONTINUATION SHEET

Section number 9 Page #5 Panola Street, North Historic District
Senatobia, Tate County, MS

=====

9. MAJOR BIBLIOGRAPHIC REFERENCES

Carpenter, Howard, editor, The History of Tate County. (Senatobia, MS:
B/C Printing, 1975)

Sanborn Ferris Insurance Map Company, "Sanborn Fire Insurance Maps of
Senatobia". Map series 1902, 1907, 1915, 1925, 1936-1942.

Tate County Genealogical and Historical Society, Inc., The Heritage of
Tate County, Mississippi. (Curtis Media, 1991)

United States Department of the Interior
National Park Service

NATIONAL REGISTER OF HISTORIC PLACES
CONTINUATION SHEET

Section number 10 Page #6 Panola Street, North Historic District
Senatobia, Tate County, MS

=====

10. GEOGRAPHICAL DATA

Verbal Boundary Description

The property in nomination is a small area composed of all of parcels 1, 2, 3.1 and 4 in Block 1 as delineated on the attached Tate County Property Tax Map 99F.

Boundary Justification

The boundaries of the Panola Street, South Historic District are drawn to include the four contiguous significant houses and their outbuildings on the lots historically associated with them.

United States Department of the Interior
National Park Service

NATIONAL REGISTER OF HISTORIC PLACES
CONTINUATION SHEET

Section number Photos Page #7 Panola Street, North Historic District
 Senatobia, Tate County, Mississippi
=====

PHOTO LIST

PANOLA STREET, NORTH HISTORIC DISTRICT

Senatobia, Tate County, Mississippi

Photographer: John Linn Hopkins

Date: July, 1993

Negatives: Mississippi Department of Archives and History
(Survey File Negative Roll # 2685:8, 10, 13 and 22)

Photo 1 of 4

View of 101 South Panola Street, looking west.

Photo 2 of 4

View of 104 North Panola Street, looking west.

Photo 3 of 4

View of 106 North Panola Street, looking west.

Photo 4 of 4

View of 108 North Panola Street, looking west.

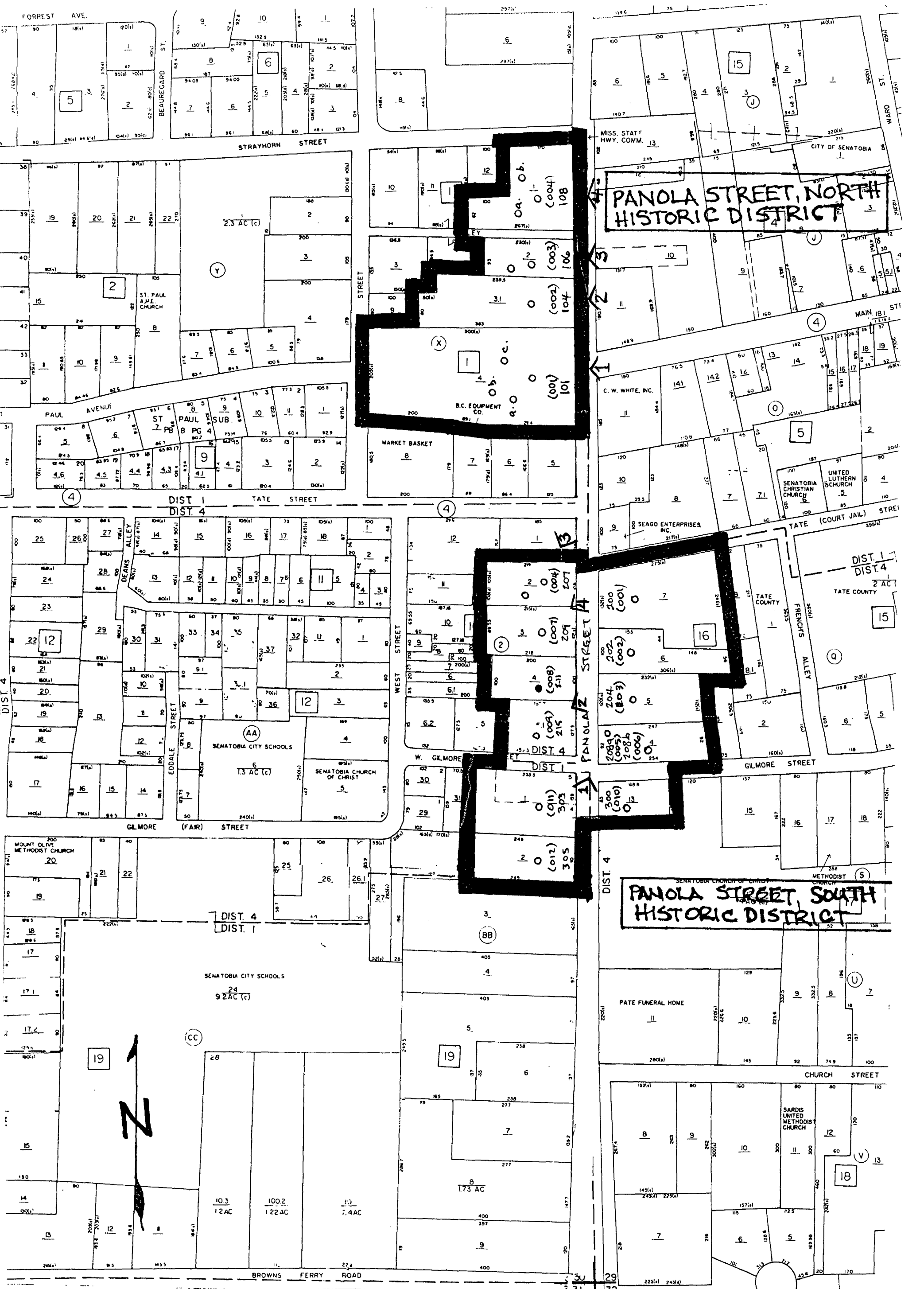

PHOTO MAP
 PANOLA STREET, SOUTH; AND, PANOLA STREET, NORTH
 HISTORIC DISTRICTS
 SENATOBIA, TATE COUNTY, MISSISSIPPI
 SCALE: 1" = 200'
 BOUNDARY:

CONTRIBUTING STRUCTURE: ○
 NON-CONTRIBUTING STRUCTURE: ●