

PH0000027

Form 10-300
(July 1969)

UNITED STATES DEPARTMENT OF THE INTERIOR
NATIONAL PARK SERVICE

NATIONAL REGISTER OF HISTORIC PLACES INVENTORY - NOMINATION FORM

(Type all entries - complete applicable sections)

STATE: Alabama	
COUNTY: Lauderdale	
FOR NPS USE ONLY	
ENTRY NUMBER	DATE
70-3-01-0005	3/31/70

1. NAME

COMMON: ~~(Oscar) Kennedy~~ House **Karsner-Carroll House**

AND/OR HISTORIC: (see letter)

2. LOCATION

STREET AND NUMBER:
303 North Pine Street

CITY OR TOWN:
Florence

STATE Alabama	CODE 01	COUNTY: Lauderdale	CODE 077
------------------	------------	-----------------------	-------------

3. CLASSIFICATION

CATEGORY (Check One)	OWNERSHIP	STATUS	ACCESSIBLE TO THE PUBLIC
<input type="checkbox"/> District <input type="checkbox"/> Site <input type="checkbox"/> Object	<input checked="" type="checkbox"/> Building <input type="checkbox"/> Structure <input type="checkbox"/> Both	<input checked="" type="checkbox"/> Public <input type="checkbox"/> Private <input type="checkbox"/> Both	Public Acquisition: <input type="checkbox"/> In Process <input type="checkbox"/> Being Considered
PRESENT USE (Check One or More as Appropriate)		<input type="checkbox"/> Occupied <input checked="" type="checkbox"/> Unoccupied <input checked="" type="checkbox"/> Preservation work in progress	Yes: <input type="checkbox"/> Restricted <input type="checkbox"/> Unrestricted <input checked="" type="checkbox"/> No
<input type="checkbox"/> Agricultural <input type="checkbox"/> Commercial <input type="checkbox"/> Educational <input type="checkbox"/> Entertainment	<input checked="" type="checkbox"/> Government <input type="checkbox"/> Industrial <input type="checkbox"/> Military <input type="checkbox"/> Museum	<input type="checkbox"/> Park <input type="checkbox"/> Private Residence <input type="checkbox"/> Religious <input type="checkbox"/> Scientific	<input type="checkbox"/> Transportation <input type="checkbox"/> Comments <input checked="" type="checkbox"/> Other (Specify) _____

4. OWNER OF PROPERTY

OWNER'S NAME:
Florence Housing Authority

STREET AND NUMBER:
P. O. Box 816

CITY OR TOWN:
Florence

STATE: Alabama	CODE 01
-------------------	------------

5. LOCATION OF LEGAL DESCRIPTION

COURTHOUSE, REGISTRY OF DEEDS, ETC:
Office of Probate Judge, Lauderdale County

STREET AND NUMBER:
202 South Court Street

CITY OR TOWN:
Florence

STATE: Alabama	CODE 01
-------------------	------------

6. REPRESENTATION IN EXISTING SURVEYS

TITLE OF SURVEY:
NONE

DATE OF SURVEY: Federal State County Local

DEPOSITORY FOR SURVEY RECORDS:

STREET AND NUMBER:

CITY OR TOWN:

STATE:	CODE:
--------	-------

SEE INSTRUCTIONS

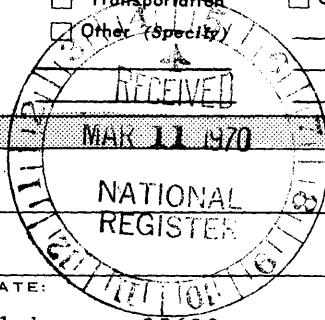

STATE: Alabama

COUNTY: Lauderdale

ENTRY NUMBER

DATE

FOR NPS USE ONLY

7. DESCRIPTION

CONDITION	(Check One)					
	<input type="checkbox"/> Excellent	<input checked="" type="checkbox"/> Good TO	<input checked="" type="checkbox"/> Fair	<input type="checkbox"/> Deteriorated	<input type="checkbox"/> Ruins	<input type="checkbox"/> Unexposed
	(Check One)			(Check One)		
	<input checked="" type="checkbox"/> Altered	<input type="checkbox"/> Unaltered	<input type="checkbox"/> Moved	<input checked="" type="checkbox"/> Original Site		

DESCRIBE THE PRESENT AND ORIGINAL (if known) PHYSICAL APPEARANCE

The exterior form of the Oscar Kennedy House has been so changed by alteration and additions that it takes close examination to discern the original outline and probable appearance. The original portion of the structure has been changed little, but merely buried beneath additions. The brick work, wood detail, and structure are virtually intact, and much of the original structure is in fair to good condition. It is the modern additions that have deteriorated so badly.

Three changes account for the present superficially nondescript appearance, the front porch (obviously tacked on only a few years ago), the uplifted roof with its row of windows lighting the half story both in front and in back, and the removal of the south rear part of the original structure to allow the small room behind the entrance hall to be enlarged (evident in the substitution of frame exterior wall construction for brick).

The original house has 13 inch brick bearing exterior walls, with wood floor, ceiling and roof framing. The brick is a soft, rich red color laid in common bond with every sixth course being a header course. Exterior lintels are flat arch tapered brick. The main chimney is intergral with the wall, not projected on the exterior.

In plan, the original house was almost square, with a narrow wing projecting to the rear on the north side. Within the square, there are two rooms on the north side connected by an ordinary door (rather than by the wide, double sliding doors that were used between such rooms in a later period.) On the south side, there is the entrance hall, with a straight stairway leading upstairs, doubling back from a landing. A door beneath the stairway landing leads to what may have been a gallery or open porch rather than the enclosed room that is there now.

The wing projecting to the rear contains three rooms, apparently the original division of the space. The first was quite obviously the kitchen. The last room, which has a fireplace with a simple frame that matches the trim of the front part of the house, was likely a servant's room. The middle room served for storage or some other purpose. The floor level of the rear wing is lower; there evidently was an outdoor passage or porch giving access to the wing rooms. Some evidence of the original construction may be found when the additions are taken off, exposing early footings and foundations and possible ceiling and roof connections.

One of the most interesting characteristics of the house is the woodwork or trim that is almost intact. The entrance door is a double door, fanlighted. (The present doors themselves are replacements, but other doors in the house are original, having paneling matching that of the wainscot.) There is a chair rail in the entrance hall which carries through into the front room, but there has beneath it a paneled wainscot. The stair rail is of simple, oval shape with plain capped column newel

SEE INSTRUCTIONS

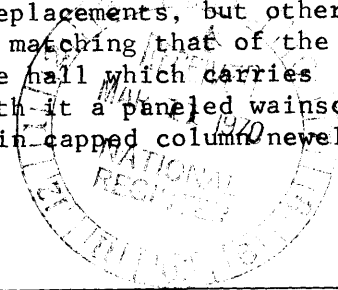

SIGNIFICANCE

PERIOD (Check One or More as Appropriate)

- | | | | |
|--|---------------------------------------|--|---------------------------------------|
| <input type="checkbox"/> Pre-Columbian | <input type="checkbox"/> 16th Century | <input type="checkbox"/> 18th Century | <input type="checkbox"/> 20th Century |
| <input type="checkbox"/> 15th Century | <input type="checkbox"/> 17th Century | <input checked="" type="checkbox"/> 19th Century | |

SPECIFIC DATE(S) (If Applicable and Known)

AREAS OF SIGNIFICANCE (Check One or More as Appropriate)

- | | | | |
|--|---------------------------------------|--|---|
| <input type="checkbox"/> Aboriginal | <input type="checkbox"/> Education | <input type="checkbox"/> Political | <input type="checkbox"/> Urban Planning |
| <input type="checkbox"/> Prehistoric | <input type="checkbox"/> Engineering | <input type="checkbox"/> Religion/Philosophy | <input checked="" type="checkbox"/> Other (Specify) Historic |
| <input type="checkbox"/> Historic | <input type="checkbox"/> Industry | <input type="checkbox"/> Science | |
| <input type="checkbox"/> Agriculture | <input type="checkbox"/> Invention | <input type="checkbox"/> Sculpture | |
| <input checked="" type="checkbox"/> Architecture | <input type="checkbox"/> Landscape | <input type="checkbox"/> Social/Humanitarian | |
| <input type="checkbox"/> Art | <input type="checkbox"/> Architecture | <input type="checkbox"/> Theater | |
| <input type="checkbox"/> Commerce | <input type="checkbox"/> Literature | <input type="checkbox"/> Transportation | |
| <input type="checkbox"/> Communications | <input type="checkbox"/> Military | | |
| <input type="checkbox"/> Conservation | <input type="checkbox"/> Music | | |

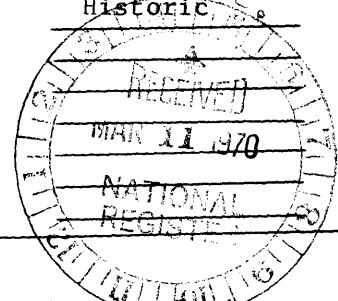

STATEMENT OF SIGNIFICANCE

The significance of the Oscar Kennedy House is architectural. It is one of the few remaining examples of the early nineteenth century Federal architecture in the Tennessee Valley. Many of the large mansions and plantations were preserved, but very few of the smaller homes remain. Its simplicity of form and structure is combined with unusual refinement of detail and precisions of execution. The structure is essentially a cottage of modest proportion that is in surprising contrast with the elegance of detail.

The town of Florence was laid out under the direction of General James Coffee by Ferdinand Sannoner in 1818 with an eye for future growth. Sannoner, a young Italian engineer, was given the honor of naming the city, and he chose the name of his native city on the Arno. Lot Number Seven, on which the Kennedy House stands was purchased by the Cyprus Land Company from the United States Government on March 9, 1818, a year after the territory was ceded to the United States by the Cherokee Indians.

At the first public sale of lots, which began July 22, Lot Number Seven was purchased by James Gadsden for three hundred fifty dollars. The adjoining lot on the west, number six, was purchased by General Andrew Jackson for the same price.

Florence and Lauderdale County grew rapidly during the next few years. The county population increased from 4,365 in 1820 to 11,781 in 1830.

The early Cypress Land Company records were destroyed by fire; therefore it is not known how long James Gadsden maintained possession of this property. The first family known to occupy the house was that of B. F. Karsner. It is not known when the house was built, but when Mr. Karsner mortgaged to Joseph Biggers for R. M. Patton & Company on December 29, 1831, the property was described as "with a brick dwelling house thereon". Another early family to live in this house was that of Mary Fannie Hudson.

Dr. George W. Carroll, a physician of the Smithsonia Community, moved his wife and two daughters into the house on September 10, 1902, so the girls could attend school in Florence. The two Carroll girls were married in this house. Velce was married to J. C. Rhodes and Bertha to Oscar Y. Kennedy, whose name is still associated with the house.

SEE INSTRUCTIONS

9. MAJOR BIBLIOGRAPHICAL REFERENCES

Archives of Florence Housing Authority. Florence, Suite M 2-8, Mobile Street Building.
 Florence-Lauderdale County Public Library. Florence, 218 North Wood Avenue.
 Moore, Albert B. History of Alabama. Tuscaloosa: Alabama Book Store, 1951.
 Owen, Marie Bankhead, ed. Alabama Census Returns, 1820. Baltimore: Genealogical Publishing Company, 1967.
 Owen, Thomas M. History of Alabama and Dictionary of Alabama Biography, Volume I. Chicago: S. J. Clarke Publishing Company, 1921.
 Tennessee Valley Historical Society Collection. Florence: Florence State University and Pope's Tavern.

10. GEOGRAPHICAL DATA

LATITUDE AND LONGITUDE COORDINATES DEFINING A RECTANGLE LOCATING THE PROPERTY			O R	LATITUDE AND LONGITUDE COORDINATES DEFINING THE CENTER POINT OF A PROPERTY OF LESS THAN TEN ACRES		
CORNER	LATITUDE	LONGITUDE		LATITUDE	LONGITUDE	
	Degrees Minutes Seconds	Degrees Minutes Seconds		Degrees Minutes Seconds	Degrees Minutes Seconds	
NW	° ' "	° ' "		° ' "	° ' "	
NE	° ' "	° ' "		° ' "	° ' "	
SE	° ' "	° ' "		° ' "	° ' "	
SW	° ' "	° ' "		° ' "	° ' "	

APPROXIMATE ACREAGE OF NOMINATED PROPERTY: **one-half (1/2) acre**

LIST ALL STATES AND COUNTIES FOR PROPERTIES OVERLAPPING STATE OR COUNTY BOUNDARIES

STATE:	CODE	COUNTY	CODE
All in Alabama	01	Lauderdale	077
STATE:	CODE	COUNTY:	CODE
STATE:	CODE	COUNTY:	CODE
STATE:	CODE	COUNTY:	CODE

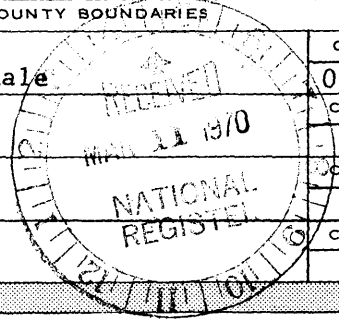

11. FORM PREPARED BY

NAME AND TITLE: **W. Warner Floyd, Executive Director, Alabama Historical Commis. Alfred McCroskey, Project Officer, Lauderdale Co. Historical Inventory Comm.**

ORGANIZATION: **Alabama Historical Commission** DATE: **March 2, 1970**

STREET AND NUMBER: **305 South Lawrence Street**

CITY OR TOWN: **Montgomery** STATE: **Alabama** CODE: **01**

12. STATE LIAISON OFFICER CERTIFICATION NATIONAL REGISTER VERIFICATION

As the designated State Liaison Officer for the National Historic Preservation Act of 1966 (Public Law 89-665), I hereby nominate this property for inclusion in the National Register and certify that it has been evaluated according to the criteria and procedures set forth by the National Park Service. The recommended level of significance of this nomination is:

National State Local

Name Wils B. Toward, Jr.
 Chairman, Alabama Historical Commission, SLD

Date March 3, 1970

I hereby certify that this property is included in the National Register.

Ernest Allen Connolly
 Chief, Office of Archeology and Historic Preservation

Date MAR 31 1970

ATTEST:

William J. Stoutish
 Keeper of The National Register

Date MAR 27 1970

SEE INSTRUCTIONS

**NATIONAL REGISTER OF HISTORIC PLACES
INVENTORY - NOMINATION FORM**

(Continuation Sheet)

STATE Alabama	
COUNTY Lauderdale	
FOR NPS USE ONLY	
ENTRY NUMBER 70.3.01.0007	DATE 3/31/70

(Number all entries)

7. Description (continued)

that is repeated against the wall as an engaged newel with no rail. Balusters are untapered and rectangular in shape.

Trim is deeply incised, with slightly rounded V-shaped ribs. Door casings rest on plinths having molded cap and shoe that continue the baseboard. Casings are joined at corners with square blocks with turned rosettes in the center. The mantel piece has subtle, deeply cut mouldings and sharply carved details. Almost none of the detail has been broken or lost, although it has been coarsened by repeated painting.

The original wide pine board flooring remains in the two downstairs rooms and the entrance hall.

Upstairs, there has been a good deal of alteration. But since the exterior walls, windows on the gable ends, stairway and other features remain as originally constructed, careful removal of additions and changed work is expected to reveal information that can be used as a basis for faithful restoration.



NOTE: DIMENSIONS WERE TAKEN AT SITE AND MAY VARY SLIGHTLY

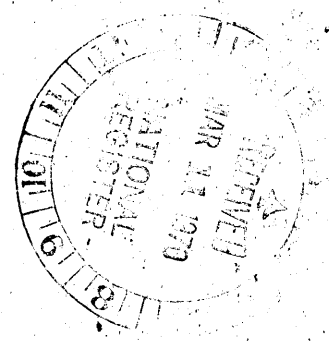
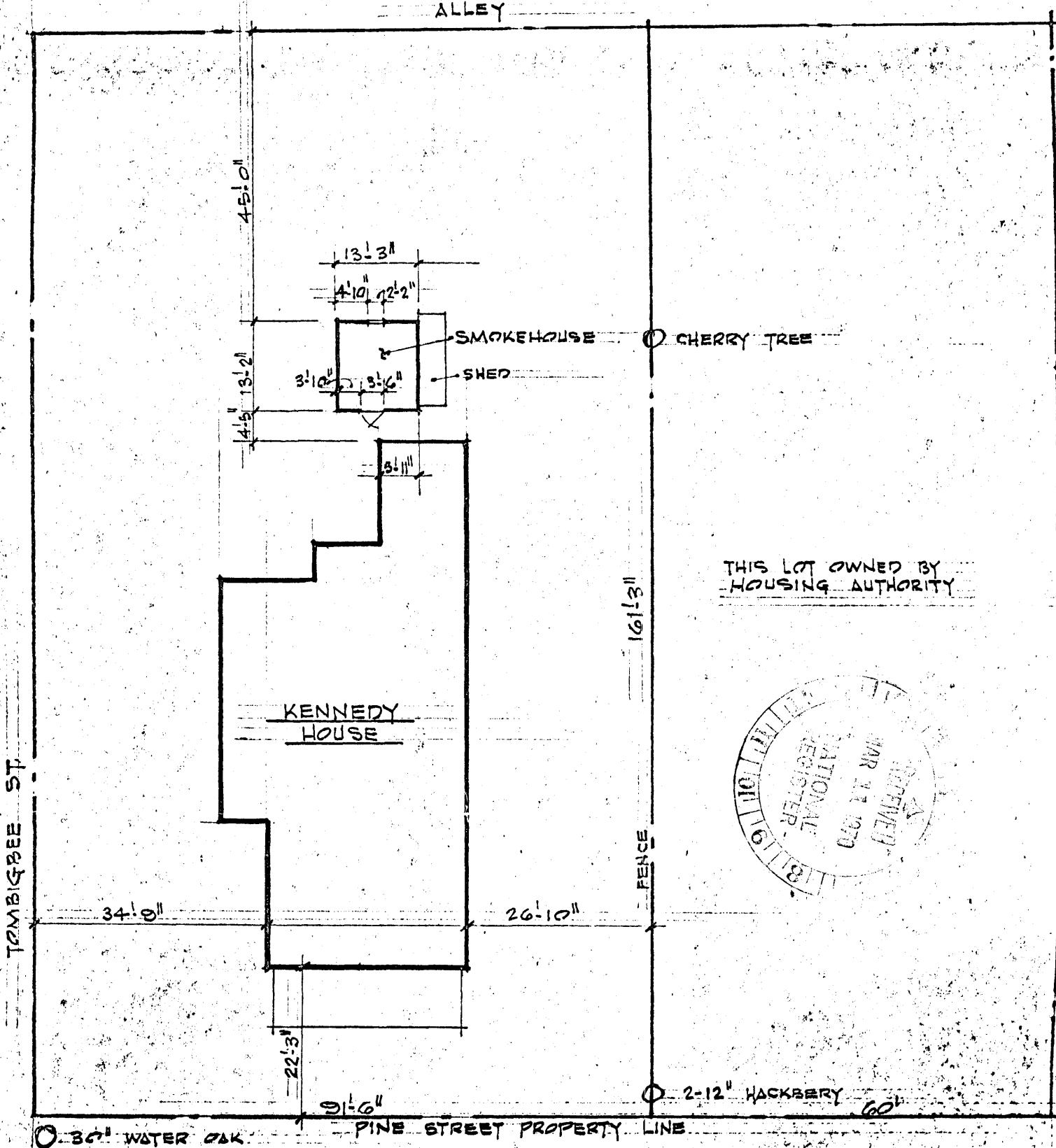

TOMBIGREE ST

PLOT PLAN

SCALE: 1" = 20'

Form 10-301
(July 1969)

UNITED STATES DEPARTMENT OF THE INTERIOR
NATIONAL PARK SERVICE

**NATIONAL REGISTER OF HISTORIC PLACES
PROPERTY MAP FORM**

(Type all entries - attach to or enclose with map)

STATE	Alabama
COUNTY	Lauderdale
FOR NPS USE ONLY	
ENTRY NUMBER	10-301-002
DATE	3/31/72

1. NAME

COMMON: Oscar Kennedy House
AND/OR HISTORIC:

2. LOCATION

STREET AND NUMBER: 303 North Pine St.
CITY OR TOWN: Florence

STATE: Ala.

MAP REFERENCE: 35630

3. MAP REFERENCE

SOURCE:

SCALE:

DATE:

4. REQUIREMENTS

TO BE INCLUDED ON ALL MAPS

1. Property boundaries where required.
2. North arrow.
3. Latitude and longitude reference.

Plot Plan

SEE INSTRUCTIONS

