

**NATIONAL REGISTER OF HISTORIC PLACES  
INVENTORY - NOMINATION FORM**

(Type all entries - complete applicable sections)

STATE: <b>Utah</b>	
COUNTY: <b>Salt Lake</b>	
FOR NPS USE ONLY	
ENTRY NUMBER <b>70.6.43.0005</b>	DATE <b>6/15/70</b>

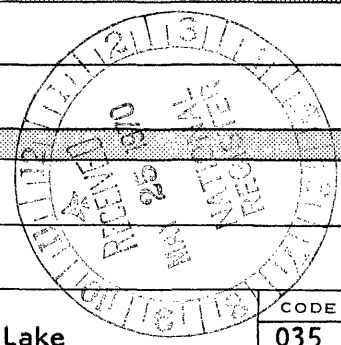

**1. NAME**

COMMON: **(Isaac) Chase Mill**

AND/OR HISTORIC:

**2. LOCATION**

STREET AND NUMBER: **Liberty Park - 6th East**

CITY OR TOWN: **Salt Lake City**

STATE: **Utah** CODE: **43** COUNTY: **Salt Lake** CODE: **035**

**3. CLASSIFICATION**

CATEGORY (Check One)	OWNERSHIP	STATUS	ACCESSIBLE TO THE PUBLIC
<input type="checkbox"/> District <input type="checkbox"/> Site <input checked="" type="checkbox"/> Building <input type="checkbox"/> Structure <input type="checkbox"/> Object	<input type="checkbox"/> Public <input type="checkbox"/> Private <input checked="" type="checkbox"/> Both	Public Acquisition: <input type="checkbox"/> In Process <input type="checkbox"/> Being Considered <input type="checkbox"/> Occupied <input type="checkbox"/> Unoccupied <input checked="" type="checkbox"/> Preservation work in progress	Yes: <input checked="" type="checkbox"/> Restricted <input type="checkbox"/> Unrestricted <input type="checkbox"/> No

PRESENT USE (Check One or More as Appropriate) **Relic Hall**

<input type="checkbox"/> Agricultural	<input type="checkbox"/> Government	<input type="checkbox"/> Park	<input type="checkbox"/> Transportation	<input type="checkbox"/> Comments
<input type="checkbox"/> Commercial	<input type="checkbox"/> Industrial	<input type="checkbox"/> Private Residence	<input type="checkbox"/> Other (Specify)	
<input checked="" type="checkbox"/> Educational	<input type="checkbox"/> Military	<input type="checkbox"/> Religious		
<input type="checkbox"/> Entertainment	<input checked="" type="checkbox"/> Museum	<input type="checkbox"/> Scientific		

**4. OWNER OF PROPERTY**

OWNER'S NAME: **Daughters of Utah Pioneers, Salt Lake Company (Building Property is city owned. only)**

STREET AND NUMBER: **300 North Main Street**

CITY OR TOWN: **Salt Lake City** STATE: **Utah** CODE: **43**

**5. LOCATION OF LEGAL DESCRIPTION**

COURTHOUSE, REGISTRY OF DEEDS, ETC.: **Salt Lake City & County Building**

STREET AND NUMBER: **451 Washington Square**

CITY OR TOWN: **Salt Lake City** STATE: **Utah** CODE: **43**

**6. REPRESENTATION IN EXISTING SURVEYS**

TITLE OF SURVEY: **1968 Utah Historical American Buildings Survey**

DATE OF SURVEY: **1968**  Federal  State  County  Local

DEPOSITORY FOR SURVEY RECORDS: **Utah Heritage Foundation**

STREET AND NUMBER: **603 East South Temple**

CITY OR TOWN: **Salt Lake City** STATE: **Utah** CODE: **43**

SEE INSTRUCTIONS

STATE: **Utah**  
COUNTY: **Salt Lake**  
ENTRY NUMBER  
DATE

FOR NPS USE ONLY

7. DESCRIPTION

CONDITION

(Check One)

Excellent     Good     Fair     Deteriorated     Ruins     Unexposed

(Check One)

Altered     Unaltered

(Check One)

Moved     Original Site

DESCRIBE THE PRESENT AND ORIGINAL (if known) PHYSICAL APPEARANCE

The Chase Mill was built of adobe made on the old Church Farm at a place now known as Forest Dale Golf Club. The adobes, which are now covered with plastic, were held together with clay mortar, since no lime was then available. Framework was heavy timber, mortised and held together with wooden pins. The timbers were bored from end to end with two-inch holes to prevent dry rot.

The building is rectangular, two stories, and measures 40' x 50'. Each floor plan is open with a double row of columns. The foundation, which is not exposed above grade, is red sandstone. The brick chimney on the west wall, covered with plaster, is probably an addition to the original building.

The roof is a gabled clerestory with cedar shingles and no overhang.

The interior stairway is not original but approximates the original location in the northeast corner. The interior second story walls are exposed adobe blocks while the walls on the first level have been plastered and painted. The first floor knotty pine wainscot was added in 1959.

The flooring on the first level is original 6" pine boards. The second level flooring is new.

Much of the original machinery remains in the mill.

S E E I N S T R U C T I O N S

**SIGNIFICANCE**

PERIOD (Check One or More as Appropriate)

- |  |                                       |  |                                       |
|--|---------------------------------------|--|---------------------------------------|
| <input type="checkbox"/> Pre-Columbian | <input type="checkbox"/> 16th Century | <input type="checkbox"/> 18th Century            | <input type="checkbox"/> 20th Century |
| <input type="checkbox"/> 15th Century  | <input type="checkbox"/> 17th Century | <input checked="" type="checkbox"/> 19th Century |                                       |

SPECIFIC DATE(S) (If Applicable and Known) 1852

AREAS OF SIGNIFICANCE (Check One or More as Appropriate)

- |   |   |  |  |
|---|---|--|--|
| <input type="checkbox"/> Aboriginal             | <input type="checkbox"/> Education              | <input type="checkbox"/> Political           | <input type="checkbox"/> Urban Planning        |
| <input type="checkbox"/> Prehistoric            | <input type="checkbox"/> Engineering            | <input type="checkbox"/> Religion/Philosophy | <input type="checkbox"/> Other (Specify) _____ |
| <input type="checkbox"/> Historic               | <input type="checkbox"/> Industry               | <input type="checkbox"/> Science             | _____  |
| <input checked="" type="checkbox"/> Agriculture | <input type="checkbox"/> Invention              | <input type="checkbox"/> Sculpture           | _____  |
| <input type="checkbox"/> Architecture           | <input type="checkbox"/> Landscape Architecture | <input type="checkbox"/> Social/Humanitarian | _____  |
| <input type="checkbox"/> Art                    | <input type="checkbox"/> Literature             | <input type="checkbox"/> Theater             | _____  |
| <input type="checkbox"/> Commerce               | <input type="checkbox"/> Military               | <input type="checkbox"/> Transportation      | _____  |
| <input type="checkbox"/> Communications         | <input type="checkbox"/> Music                  |  |  |
| <input type="checkbox"/> Conservation           |   |  |  |

STATEMENT OF SIGNIFICANCE

The Isaac Chase Mill, located in Liberty Park, remains as the only grist mill on its original site built by the early pioneers in Salt Lake City. It was also the first mill in the valley to separate the flour from the shorts and bran.

The property, with springs of water, was deeded to Isaac Chase in 1847. He soon purchased another fifteen acres and eventually owned more than one hundred acres in the area. In late 1847, he built an upright sawmill to cut lumber for his home and mill. In 1848, a small crackling mill was built. Then, in 1852, Isaac Chase supervised the building of the "Chase Mill" and installed the irons and millstones his daughter had "freighted" to Utah when the family emigrated to the valley in September 1847. William Weeks was the architect. Chase later built a home nearby, which is still standing.

In 1854 Brigham Young, who had married Mrs. Chase's daughter by a previous marriage, bought into the mill. The mill's flour became extremely important during the famine period of 1856-1857. In 1859 Brigham Young Jr. was assigned to manage the mill. By 1860 Brigham Young purchased Chase's stock and assumed complete control. Chase moved to his adobe cabin on State Street where he died a year later.

The mill continued to be used into the 1880's. About 1882 the location was purchased from the Brigham Young estate by Salt Lake City for "Liberty Park." The mill was used as a supply shed for a number of years. Then, in 1896, a drive was made to tear it down; however, through the effective efforts of Kate Chase, a grand-daughter, support was marshalled to save it.

In 1927, the Daughters of Utah Pioneers began negotiations with the city for its use and preservation, which they obtained under lease in 1933. They have used it as a relic hall and now open it to the public during the summer months.

Interest has been expressed at various times to restore it to operating condition, which now may become a possibility.

SEE INSTRUCTIONS

**9. MAJOR BIBLIOGRAPHICAL REFERENCES**

Goeldner, Paul, Utah Catalog - Historic American Buildings Survey, Salt Lake City, Utah. Utah Heritage Foundation 1969.  
 Carter, Kate B., The Chase Mill, 1852, Liberty Park, Salt Lake City: Utah Printing Company, 1957.  
 Daughters of Utah Pioneers, Tales of a Triumphant People, a History of Salt Lake County, 1847-1900, Stevens and Wallis Press, 1947.  
 Bunnell, L. L., "Liberty Park Reflections," The Wick, III (Oct., 1967).

**10. GEOGRAPHICAL DATA**

LATITUDE AND LONGITUDE COORDINATES DEFINING A RECTANGLE LOCATING THE PROPERTY			O R	LATITUDE AND LONGITUDE COORDINATES DEFINING THE CENTER POINT OF A PROPERTY OF LESS THAN TEN ACRES		
CORNER	LATITUDE	LONGITUDE		LATITUDE	LONGITUDE	
	Degrees Minutes Seconds	Degrees Minutes Seconds		Degrees	Minutes	Seconds
NW	0 ' "	0 ' "		40°	44'	36"
NE	0 ' "	0 ' "		111°	52'	25"
SE	0 ' "	0 ' "				
SW	0 ' "	0 ' "				

APPROXIMATE ACREAGE OF NOMINATED PROPERTY:

LIST ALL STATES AND COUNTIES FOR PROPERTIES OVERLAPPING STATE OR COUNTY BOUNDARIES

STATE:	CODE	COUNTY	CODE

**11. FORM PREPARED BY**

NAME AND TITLE: **Melvin T. Smith, Preservation Officer**

ORGANIZATION: **Utah State Historical Society**      DATE: **May 21, 1970**

STREET AND NUMBER: **603 E. South Temple**

CITY OR TOWN: **Salt Lake City**      STATE: **Utah**      CODE: **43**

**12. STATE LIAISON OFFICER CERTIFICATION      NATIONAL REGISTER VERIFICATION**

As the designated State Liaison Officer for the National Historic Preservation Act of 1966 (Public Law 89-665), I hereby nominate this property for inclusion in the National Register and certify that it has been evaluated according to the criteria and procedures set forth by the National Park Service. The recommended level of significance of this nomination is:

National     State     Local

Name: Milton L. Weilenmann  
 Title: Utah State Liaison Officer  
 Date: May 22, 1970

I hereby certify that this property is included in the National Register.

Ernest Allen Crumley  
 Chief, Office of Archeology and Historic Preservation

Date: JUN 15 1970

ATTEST:

William J. ...  
 Keeper of The National Register

Date: JUN 12 1970

SEE INSTRUCTIONS

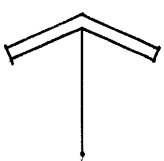
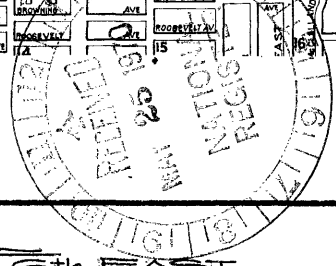
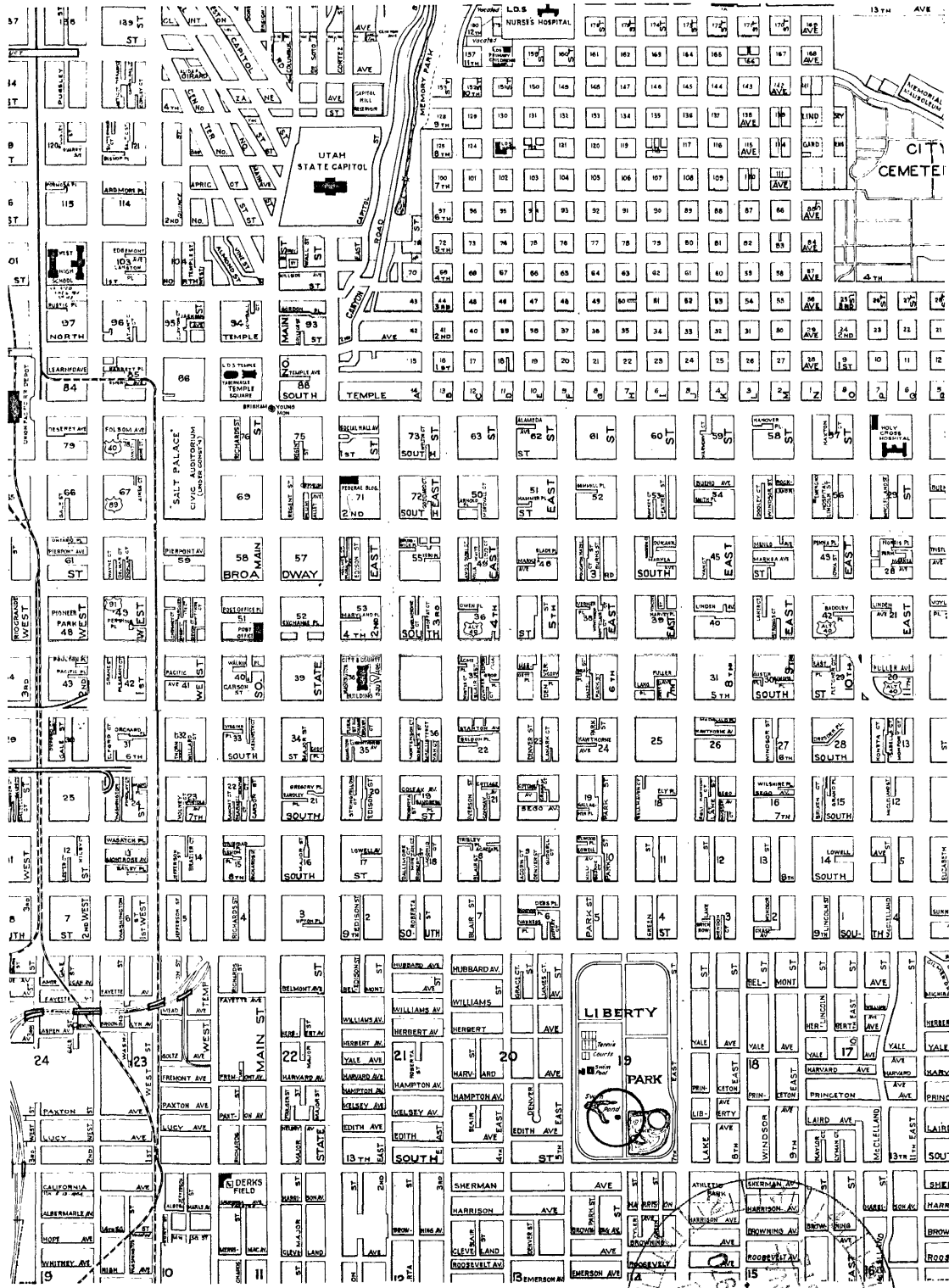

**ISAAC CHASE ALL**  
 APPROX 1200 SOUTH ON 6TH EAST  
 SALT LAKE CITY, UTAH  
 LATITUDE : 40°-44'-36"  
 LONGITUDE : 111°-52'-25"  
 CITY ENGINEERING MAP  
 DATE : MAY 1970  
 SCALE: 1" = 2,200'

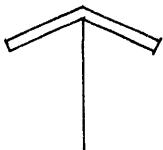
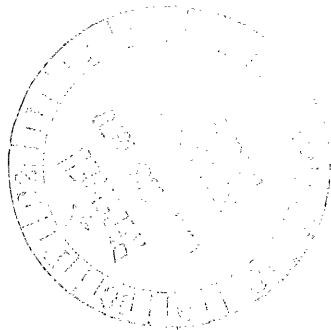
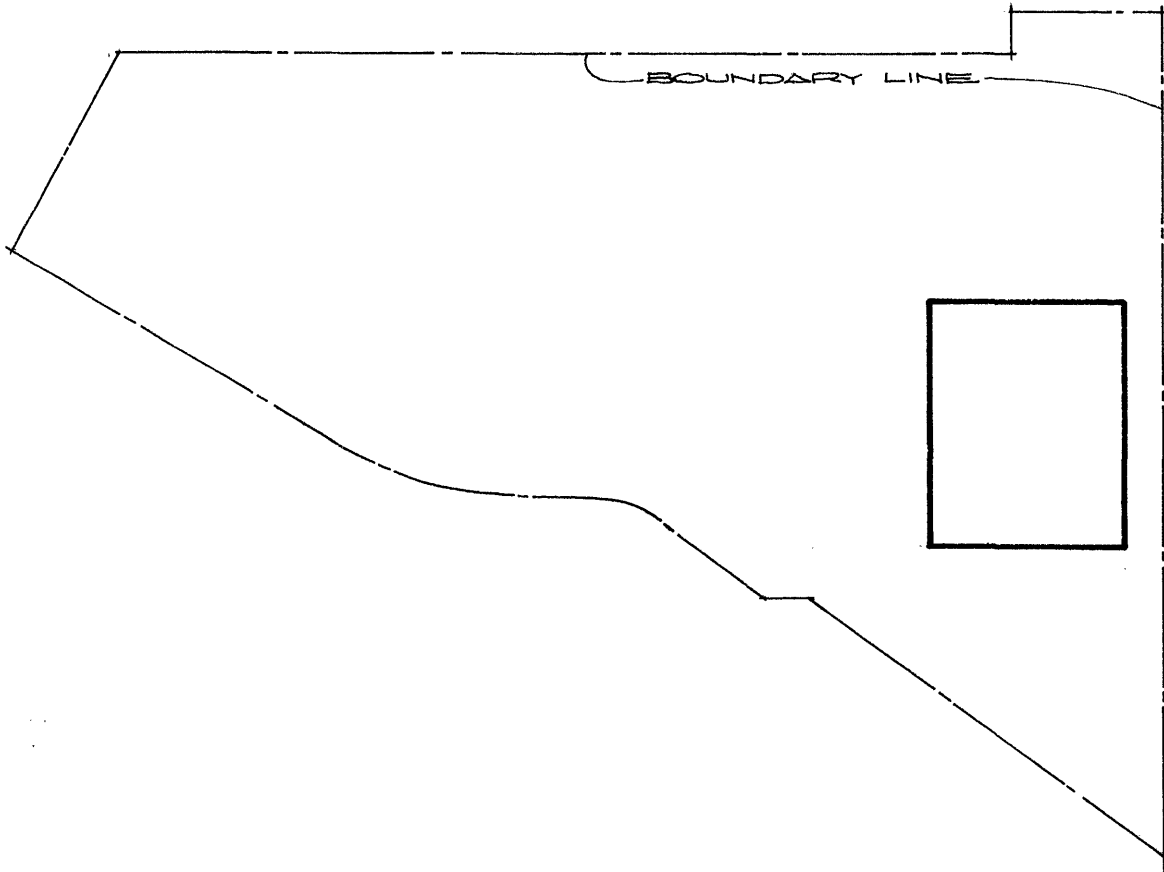

**ISAAC CHASE MILL**  
 APPROX. 1200 SOUTH ON 6th EAST  
 SALT LAKE CITY, UTAH

LATITUDE : 40° - 44' - 36"  
 LONGITUDE : 111° - 52' - 25"

DATE: MAY 1970  
 SCALE: 1" = 40'