

United States Department of the Interior
National Park Service

National Register of Historic Places Continuation Sheet

Section number _____ Page _____

SUPPLEMENTARY LISTING RECORD

NRIS Reference Number: 91000160 Date Listed: 3/6/91

| | | |
|------------------------------|---------------|-----------|
| <u>Lucerne Guard Station</u> | <u>Chelan</u> | <u>WA</u> |
| Property Name | County | State |

USDA Forest Service Administrative Buildings in OR and WA Built
by the CCC
Multiple Name

This property is listed in the National Register of Historic
Places in accordance with the attached nomination documentation
subject to the following exceptions, exclusions, or amendments,
notwithstanding the National Park Service certification included
in the nomination documentation.

for *Antoniotti Glee*
Signature of the Keeper

3/6/91
Date of Action

=====
Amended Items in Nomination:

Statement of Significance: The check next to Criteria
Consideration G should be deleted. The Period of Significance
should be amended to read: 1936-41.

This information was confirmed with Evan DeBloois, Preservation
Officer, Forest Service.

DISTRIBUTION:

- National Register property file
- Nominating Authority (without nomination attachment)

160
RECEIVED
D

JAN 25 1991

NATIONAL
REGISTER

United States Department of the Interior
National Park Service

**NATIONAL REGISTER OF HISTORIC PLACES
REGISTRATION FORM**

This form is for use in nominating or requesting determinations of eligibility for individual properties or districts. See instructions in How to Complete National Register Forms (revised 1986). Complete each item by marking "x" in the appropriate box or by entering the requested information. If an item does not apply to the property being documented, enter "N/A" for "not applicable." For functions, styles, materials, and areas of significance, enter only the categories and subcategories listed in the instructions. For additional space use continuation sheets (Form) and identify the section being continued. Type all entries.

1. NAME OF PROPERTY

Lucerne Guard Station

historic name

other names/site number

2. LOCATION

~~Chelan Ranger District~~ Wenatchee National Forest

N/A not for publication

street & number ~~428 West Woodin Ave xxx Box 189~~ Chelan Ranger District

vicinity

city, town ~~Lucerne~~

N/A

state Washington code 53 county Chelan code 007 zipcode 98816

3. CLASSIFICATION

| Ownership of Property | Category of Property | Number of Resources within Property | |
|--|---|-------------------------------------|---|
| <input type="checkbox"/> private | <input checked="" type="checkbox"/> building(s) | Contributing | Noncontributing |
| <input type="checkbox"/> public-local | <input type="checkbox"/> district | 1 | <input checked="" type="checkbox"/> 1 buildings |
| <input type="checkbox"/> public-State | <input type="checkbox"/> site | _____ | _____ sites |
| <input checked="" type="checkbox"/> public-Federal | <input type="checkbox"/> structure | _____ | _____ structures |
| | <input type="checkbox"/> object | _____ | _____ objects |
| | | 1 | <input checked="" type="checkbox"/> 1 Total |

Name of related multiple property listing:
USDA Forest Service Administrative Buildings
in the States of Oregon and Washington. Built
by the Civilian Conservation Corps

Number of contributing
resources previously listed in
the National Register 0

4. STATE/FEDERAL AGENCY CERTIFICATION

As the designated authority under the National Historic Preservation Act of 1966, as amended, I hereby certify that this nomination request for determination of eligibility meets the documentation standards for registering properties in the National Register of Historic Places and meets the procedural and professional requirements set forth in 36 CFR Part 60. In my opinion, the property meets does not meet the National Register criteria. See continuation sheet.

Joseph E. Moran April 11, 1988
Signature of certifying official Date
Office of Archaeology & Historic Preservation
State or Federal agency and bureau

In my opinion, the property meets does not meet the National Register criteria. See continuation sheet.

Walter J. DeBlois 1-8-91
Signature of commenting or other official Date
USDA Forest Service
State or Federal agency and bureau

5. NATIONAL PARK SERVICE CERTIFICATION

I, hereby, certify that this property is:

| | Signature of the Keeper | Date of Action |
|---|--------------------------|----------------|
| <input checked="" type="checkbox"/> entered in the National Register. | <u>Antonietta A. Kee</u> | <u>3/6/91</u> |
| <input type="checkbox"/> determined eligible for the National Register. | _____ | _____ |
| <input type="checkbox"/> determined not eligible for the National Register. | _____ | _____ |
| <input type="checkbox"/> removed from the National Register. | _____ | _____ |
| <input type="checkbox"/> other, (explains) _____ | _____ | _____ |

6. FUNCTION & USE

Historic Functions (enter categories from instructions)

GOVERNMENT: Government Office

Current Functions (enter categories from instructions)

GOVERNMENT: Government Office

7. DESCRIPTION

Architectural Classification (enter categories from instructions)

OTHER: Rustic architecture of the USDA Forest Service in the Pacific Northwest Region

Materials (enter categories from instructions)

foundation concrete roof wood:shingle
walls wood:weatherboard other vertical board & batten

Describe present and historic physical appearance.

See continuation sheet

8. STATEMENT OF SIGNIFICANCE

Certifying official has considered the significance of this property in relation to other properties:

nationally statewide locally

Applicable National Register Criteria A B C D

Criteria Considerations (Exceptions) A B C D E F G

Areas of Significance (enter categories from instructions)

POLITICS/GOVERNMENT
CONSERVATION
ARCHITECTURE

Period of Significance

1933-1942

Significant Dates

1936-38

Cultural Affiliation

N/A

Significant Person

N/A

Architect/Builder

Regional Office Architectural Group--Linn A. Forrest, Howard L. Gifford, Ward Gano, James Pollock, Emmett U. Blanchfield

State significance of property and justify criteria, criteria considerations, and areas and periods of significance noted above.

See continuation sheet

9. MAJOR BIBLIOGRAPHICAL REFERENCES

- Previous documentation on file (NPS):
- preliminary determination of individual listing (36 CFR 67) has been requested
 - previously listed in the National Register
 - previously determined eligible by the National Register
 - designated a National Historic Landmark
 - recorded by Historic American Buildings Survey # _____
 - recorded by Historic American Engineering Record # _____

See continuation sheet

- Primary location of additional data:
- State historic preservation office
 - Other State agency
 - Federal agency
 - Local government
 - University
 - Other

Specify repository:
USDA Forest Service, Regional Office,
Pacific Northwest Region, Recreation Unit

10. GEOGRAPHICAL DATA

Acreeage of property .18 acres

UTM References

| | | | | | | | |
|---|------------|---------------|----------------|---|------------|---------------|----------------|
| A | <u>110</u> | <u>679140</u> | <u>5341400</u> | B | <u>110</u> | <u>679140</u> | <u>5341400</u> |
| | Zone | Easting | Northing | | Zone | Easting | Northing |
| C | | | | D | | | |
| E | | | | F | | | |
| G | | | | H | | | |

Verbal Boundary Description

See continuation sheet

Boundary Justification The boundaries are drawn to include those buildings and spaces that describe the Forest Service administrative use of the site. The area encompassed is limited to the portion of the tract designated for administrative withdrawal containing the actual improvements and such spaces as may define the site function.

See continuation sheet

11. FORM PREPARED BY

name/title E. Gail Throop, Regional Historian
 organization USDA Forest Service, Pacific Northwest Region date 9/2/86
 street & number 319 SW Pine, P.O. Box 3623 telephone (503) 221-3644
 city or town Portland state Oregon zip code 97208

United States Department of the Interior
National Park Service

**NATIONAL REGISTER OF HISTORIC PLACES
CONTINUATION SHEET**

Section number 7 Page 1 of 1

Lucerne Guard Station: Detached, T-shaped, 1 story, wood-frame, poured concrete foundation, wood-shingled high gable roof, cross gables offset left, attached vertical boards, plain battens every other joint on all gable ends. Windows are one-over-one double-hung aluminum sash and aluminum casements. Umbrage, center east elevation, shelters main entry; surrounds are formed by flush 10 x 10 timber posts, comparable plain lintel, heavy timber brackets extend from platform surface to lintel gradually curving; entry accessed by four straight concrete steps. Rear entry, off-center on west elevation, recessed. Louvered ventilators located on north and south gable ends immediately below roof peak. Single vehicle entry, off-center on north gable end of attached garage, now enclosed by narrow vertical boards. Single-leaf vertical board door, offset to right, accesses converted garage interior. No decorations, no obvious exterior alteration except for aluminum windows. The date of their installation is unknown. New windows appear to be the same size as the originals, thereby retaining the relation of openings to solids and minimizing the effect on the facades.

There is a small outbuilding present on the property and used for storage. It is believed to have been built in the 1960's and is counted as a non-contributing building.

United States Department of the Interior
National Park Service

**NATIONAL REGISTER OF HISTORIC PLACES
CONTINUATION SHEET**

Section number 8 Page 1 of 1

SIGNIFICANCE:

The Lucerne Guard Station typifies the construction projects undertaken by the Civilian Conservation Corps and signifies the aid to the local community provided by the emergency work-relief program through employment of youth and experienced craftsmen, purchase of building materials and camp supplies, and personal expenditures of enrollees. The property represents the Forest Service's presence in the locality, as the headquarters for field operation, and denotes, via the physical facilities required to carry out the agency's expanding responsibilities, the critical transition in the Service's development from custodial superintendence to extensive resource management. The Lucerne Guard Station exemplifies the rustic architectural idiom developed by the Forest Service, Pacific Northwest Region, to impart Forest Service identity and to represent its purposes and ideals, and signifies the agency's particular interpretation of a singular expression of early twentieth century American architectural thought. Possessing high qualities of design and execution, the Guard Station is a good example of an architectural locution invested with special aesthetic and associative values by the agency that created it.

United States Department of the Interior
National Park Service

**NATIONAL REGISTER OF HISTORIC PLACES
CONTINUATION SHEET**

Section number 9 Page 1 of 1

1935-1941 Building Plans and Specifications, Unit of Engineering Files, USDA Forest Service, Regional Office, Portland, Oregon. Microfilm.

Administrative Site Plans, Unit of Recreation Files, USDA Forest Service, Regional Office, Portland, Oregon. Microfilm.

Photograph Collections, Office of Information and Unit of Recreation Files, USDA Forest Service, Regional Office, Portland, Oregon.

Property, Capital Investment, and Building Maintenance Records; Improvements Atlases. Internal Documents on File in Forest Supervisor's Offices. Locations Available USDA Forest Service, Regional Office, Portland, Oregon.

United States Department of the Interior
National Park Service

**NATIONAL REGISTER OF HISTORIC PLACES
CONTINUATION SHEET**

Section number 10 Page 1 of 1

Lucerne Guard Station

In the County of Chelan, State of Washington. A parcel of land lying in the northwestern quarter of Section 10, T.31N., R.18E., W.M., said parcel encompassing approximately .18 acres and described as follows:

Commencing at an orange spike in the southeast corner of the engineering dock on Lake Chelan; thence south 218° a distance of 129.3 feet to a spike imbedded in the north face of a 14 inch DBH ponderosa pine, said spike being the true point of beginning; thence 132° for a distance of 82.6 feet to the northeast corner of the property; thence 216° for a distance of 100 feet to the southeast corner of the property; thence 310° for a distance of 78 feet to the southwest corner of the property; thence 36° for a distance of 93.8 feet to the true point of beginning.

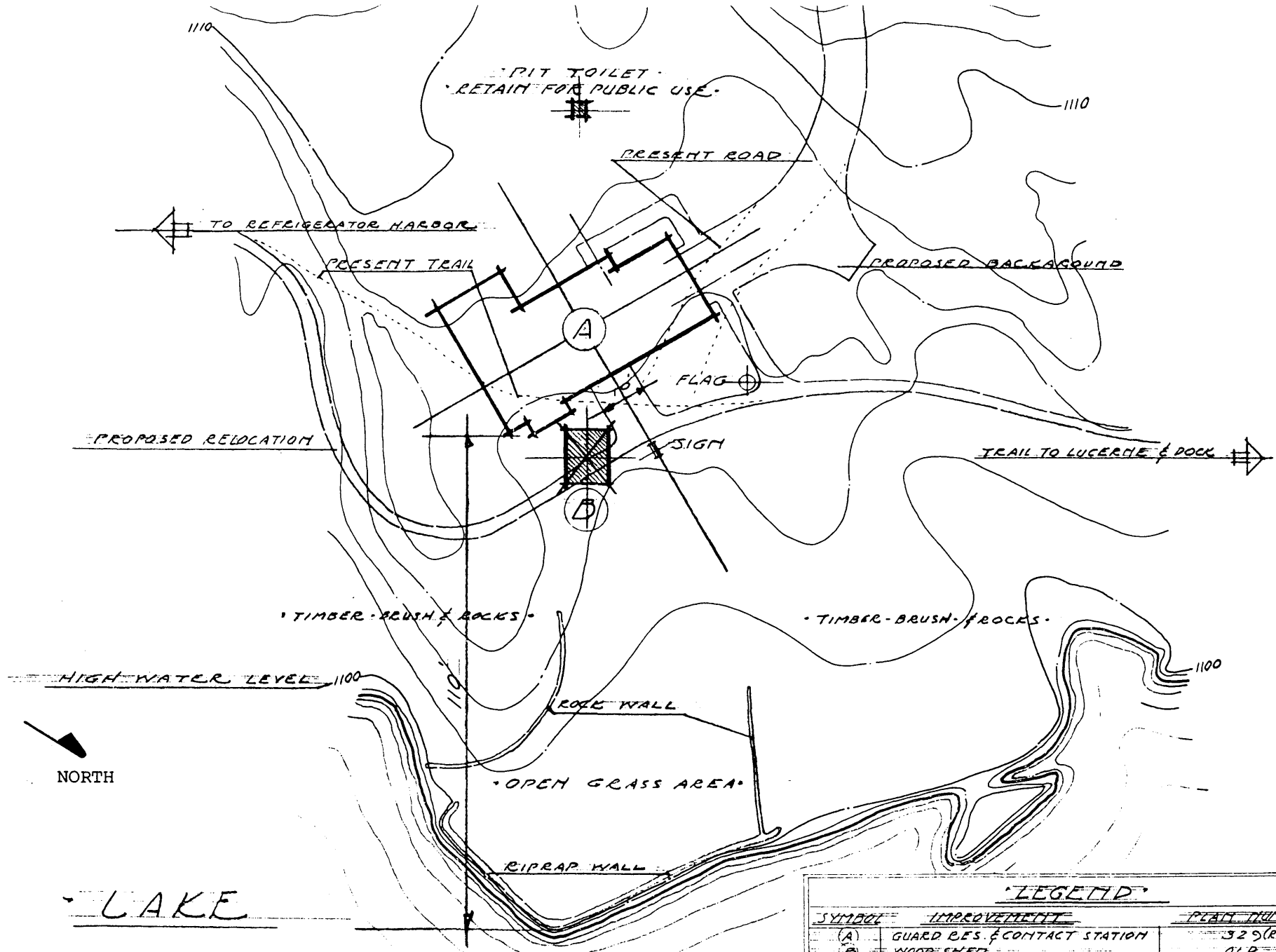

Lucerne Guard Station
 Chelan Ranger District
 Wenatchee National Forest
 Chelan County, WA

| LEGEND | | | |
|--------|-----------------------------|---------------|--------|
| SYMBOL | IMPROVEMENT | PLAN NUMBER | |
| (A) | GUARD B'S & CONTACT STATION | 325 (REVERSE) | |
| (B) | WOOD SHED | OLD | |
| (C) | BAEN | OLD | |
| | FUTURE | | BUILT |
| | PROPOSED | | REMOVE |

U. S. DEPARTMENT OF AGRICULTURE
 FOREST SERVICE
 WENATCHEE NATIONAL FOREST
 NORTH PACIFIC REGION