

## NATIONAL REGISTER OF HISTORIC PLACES INVENTORY -- NOMINATION FORM

Historic Resources of Red Lion Hundred

CONTINUATION SHEET

ITEM NUMBER 7 PAGE 20

8. A. Property Name - N-5035 - Old Post Office

*Kirkwood*

B. Location and Verbal Boundary Description - The nominated property is an irregular parcel fronting on the Kirkwood-St. Georges Road for approximately 220 feet with a maximum depth of 215 feet.

C. Owner - Paul Killen  
Kirkwood, Delaware 19708

D. Property Description

This structure is a five-bay, two-story, mansard roof, frame, double house built about 1870. Brackets, paired at the corners, were removed from the boxed cornice when the exterior walls were covered with asbestos shingles. Cut slate, arranged in a decorative pattern, surround dormers with applied ornamental panels and a bracketed entablature. A full front porch is supported by five chamfered, wooden posts, raised on pedestals and crowned by shaped, pierced brackets. The two facade doors feature four glass panes over two wood panels and are surmounted by a rectangular transom. Symmetrically arranged windows are two-over-two sash with moulded surrounds and wooden lugsills. There are one-story additions on two sides. Flanking each side of this double house is a small, wooden gable-roofed garage. On the north side of this structure is a small wooden shed with a wooden lean-to addition.

### Inventory of Outbuildings

N5035 a. Wooden shed; shed roof with composition shingles.

N5035 b. Wooden shed with shiplap siding; gable roof covered with tarpaper.

N5035 c. Intrusion; modern garage.

N5035 d. Intrusion; modern garage.

### Historical Background

Kirkwood, a small village located on Route 301, approximately 2.7 miles from Route 13, was originally known as Kemp's Corner, then St. George's Station, and finally Kirkwood in 1862, in honor of Captain Robert Kirkwood, a Revolutionary War hero. This village was a railroad shipping

FOR HGCRS USE ONLY  
RECEIVED AUG 18 1980  
DATE ENTERED

## NATIONAL REGISTER OF HISTORIC PLACES INVENTORY -- NOMINATION FORM

Historic Resources of Red Lion Hundred

CONTINUATION SHEET

ITEM NUMBER 7 PAGE 21

point during the latter part of the nineteenth century. In 1888, Kirkwood had a freight and passenger depot, three stores, a hotel, a schoolhouse, a post office, a blacksmith and wheelwright shop, and about fifteen dwellings. The two buildings nominated from that part of Kirkwood, which is in Red Lion Hundred, are: The Post Office and the Freight Depot.

E. Significance

This building is the only example of a second empire residential mansard roofed structure in Red Lion Hundred, outside the incorporated areas. Built as a double house, this structure is known to have housed both a Post Office and a store.

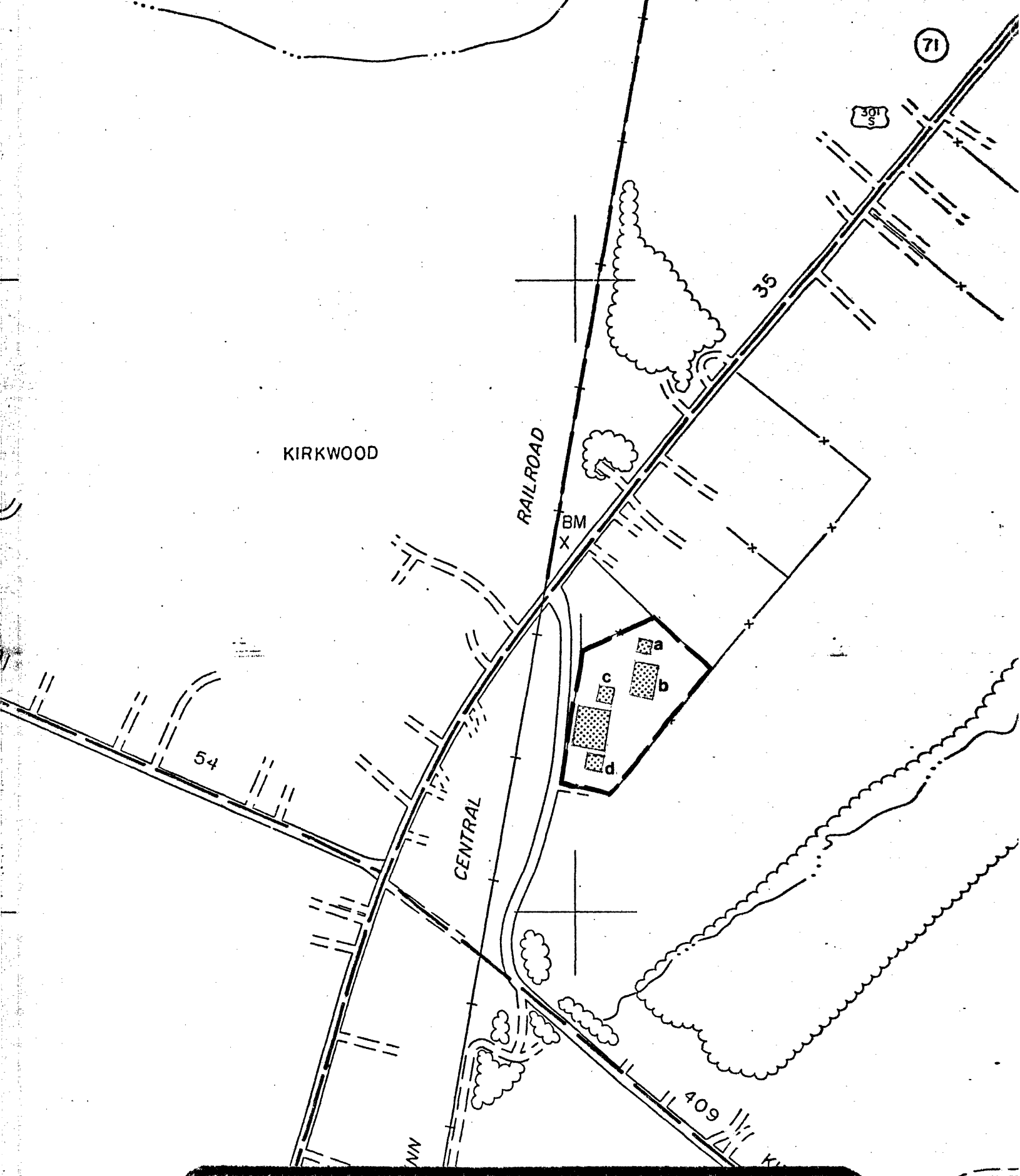

SKETCH MAP

N-5035 Old Post Office

NEW CASTLE COUNTY DEPARTMENT OF PLANNING

DATE : 4/14/80

SCALE: 1:200 ±



AUG 18 1980

ST. GEORGE