

United States Department of the Interior
National Park Service

National Register of Historic Places Registration Form

RECEIVED
SEP 08 1993
NATIONAL
REGISTER

This form is for use in nominating or requesting determinations of eligibility for individual properties or districts. See instructions in *Guidelines for Completing National Register Forms* (National Register Bulletin 16). Complete each item by marking "x" in the appropriate box or by entering the requested information. If an item does not apply to the property being documented, enter "N/A" for "not applicable." For functions, styles, materials, and areas of significance, enter only the categories and subcategories listed in the instructions. For additional space use continuation sheets (Form 10-900a). Type all entries.

1. Name of Property

historic name Hanapepe Town Lot #18

other names/site number Pool Hall

2. Location

street & number Hanapepe Road

not for publication

city, town Hanapepe

vicinity

state Hawaii

code HI

county Kauai

code 007

zip code 967116

3. Classification

Ownership of Property

- private
- public-local
- public-State
- public-Federal

Category of Property

- building(s)
- district
- site
- structure
- object

Number of Resources within Property

Contributing	Noncontributing
<u>1</u>	<u> </u> buildings
<u> </u>	<u> </u> sites
<u> </u>	<u> </u> structures
<u> </u>	<u> </u> objects
<u>1</u>	<u>0</u> Total

Name of related multiple property listing: _____

Number of contributing resources previously listed in the National Register

4. State/Federal Agency Certification

As the designated authority under the National Historic Preservation Act of 1966, as amended, I hereby certify that this nomination request for determination of eligibility meets the documentation standards for registering properties in the National Register of Historic Places and meets the procedural and professional requirements set forth in 36 CFR Part 60.

In my opinion, the property meets does not meet the National Register criteria. See continuation sheet.

[Signature]

8/12/93

Signature of certifying official

Date

State Historic Preservation Officer / Department of Land and Natural Resources

State or Federal agency and bureau

In my opinion, the property meets does not meet the National Register criteria. See continuation sheet.

Signature of commenting or other official

Date

State or Federal agency and bureau

5. National Park Service Certification

I, hereby, certify that this property is:

- entered in the National Register.
- See continuation sheet.
- determined eligible for the National Register. See continuation sheet.
- determined not eligible for the National Register.

[Signature]

10/13/93

removed from the National Register.

other, (explain:)

[Signature] Signature of the Keeper

Date of Action

6. Function or Use

Historic Functions (enter categories from instructions)
Commerce / Trade

Current Functions (enter categories from instructions)
Vacant / Not in Use

7. Description

Architectural Classification
(enter categories from instructions)Other: Vernacular Wood Commercial

Materials (enter categories from instructions)

foundation post on block
walls wood
roof metal
other

Describe present and historic physical appearance.

The former pool hall at Hanapepe lot 18 is a long building which sits on the main road of the once thriving town. Built in 1928, it is a one story, single wall building constructed of vertical tongue and groove boards supported on the interior by girts. The front elevation has a false front which steps back with the lot. The present building is actually an accumulation of structures incorporating the front pool hall and small buildings attached to its rear elevation. The stepped side elevation joins with a corrugated metal shed roof at the back of the property, the latter covering the attached structures.

The front elevation is characterized by the tall false front and an awning roof over the sidewalk. The facade above the overhang is divided into two horizontal sections, the lower level approximately twice as wide as the upper. Between the two is a small horizontal overhang. This overhang gives the uppermost portion of the facade the impression of a frieze and cornice, although it has no decorative features. The lower facade is irregular, with two areas of symmetry. The left portion of the facade contains a single door with a large four-paned window to each side. The right two-thirds of the facade has an ABABA rhythm of windows and paired five paneled doors. The two sets of paired doors have transoms above, and all the large windows are covered with lattice. The interior of the building is a single open space, measuring approximately 30'x50'. A freestanding stair to the attic in the center of this space appears to have been added later.

The side elevations of the original structure each contain two six over six windows and a slatted window. The incorporated buildings at the back appear to be built of salvaged material and have no regular window treatment. While the exterior of the main building is relatively intact, the interior and back portions have suffered from prolonged neglect, with many of the interior walls and portions of the roof missing. A rehabilitation of the building is planned.

8. Statement of Significance

Certifying official has considered the significance of this property in relation to other properties:

nationally statewide locally

Applicable National Register Criteria A B C D

Criteria Considerations (Exceptions) A B C D E F G

Areas of Significance (enter categories from instructions)

Architecture

Social History

Period of Significance

1926

1926

Significant Dates

1926

1926

Cultural Affiliation

Significant Person

Architect/Builder

Unknown

State significance of property, and justify criteria, criteria considerations, and areas and periods of significance noted above.

The former pool hall building at Hanapepe Town lot #18 is significant as a surviving example of the vernacular wood commercial buildings constructed in Hawaii in the early twentieth century. Single wall construction and the false front are characteristic of the type. The plantations popularized single wall construction, but the method was used throughout the islands because of its low cost and ease of construction. The unsupported pent roofs at the sidewalk are characteristic of Hanapepe's commercial buildings.

The building is also significant for its associations with the growth of the town of Hanapepe. Hanapepe is unique in Kauai because it did not develop as a plantation town, rather it grew as workers from the plantation companies completed their contracts and move to the area to farm and to set up businesses. The town expanded rapidly in the 1920s and 1930s and this building is an example of the businesses that served the growing community.

Ah Fong financed the construction of the building in 1926. Its original function was a coffee shop which sold *saimin* and pastries. Later, a radio shop occupied a converted portion of the building. The building was also noted among the local population as the site of a slot machine. Its final use before vacancy was a pool hall, the function remembered by most of the residents of Hanapepe.

See continuation sheet

9. Major Bibliographical References

Historic photographs
Interview with Mr. Tom Okura, Hanapepe, May 1991
Material assembled by Kauai Museum in 1977
Original Hanapepe Town plans

See continuation sheet

Previous documentation on file (NPS):

- preliminary determination of individual listing (36 CFR 67) has been requested
- previously listed in the National Register
- previously determined eligible by the National Register
- designated a National Historic Landmark
- recorded by Historic American Buildings Survey # _____
- recorded by Historic American Engineering Record # _____

Primary location of additional data:

- State historic preservation office
- Other State agency
- Federal agency
- Local government
- University
- Other

Specify repository: _____

10. Geographical Data

Acreage of property under one acre

UTM References

A

0	4
---	---

4	3	9	0	5	5
---	---	---	---	---	---

2	4	2	3	3	5	5
---	---	---	---	---	---	---

Zone Easting Northing

B

--	--

--	--	--	--	--	--

--	--	--	--	--	--

Zone Easting Northing

C

--	--

--	--	--	--	--	--

--	--	--	--	--	--

D

--	--

--	--	--	--	--	--

--	--	--	--	--	--

See continuation sheet

Verbal Boundary Description

This nomination includes the front portion of the lands as described by TMK 1-9-04:8 owned by Gwen Hamabata in 1991.

See continuation sheet

Boundary Justification

This is the historic location of the building.

See continuation sheet

11. Form Prepared By

name/title Daina Penkiunas / architectural historian
organization State Historic Preservation Division date June 13, 1991
street & number 33 S. King St., 6th floor telephone 808-587-0047
city or town Honolulu state Hawaii zip code 96813

E L E E L E

DEPARTMENT OF TAXATION
TERRITORY OF HAWAII
TAX MAPS BRANCH
STATE OF HAWAII
TAX MAP

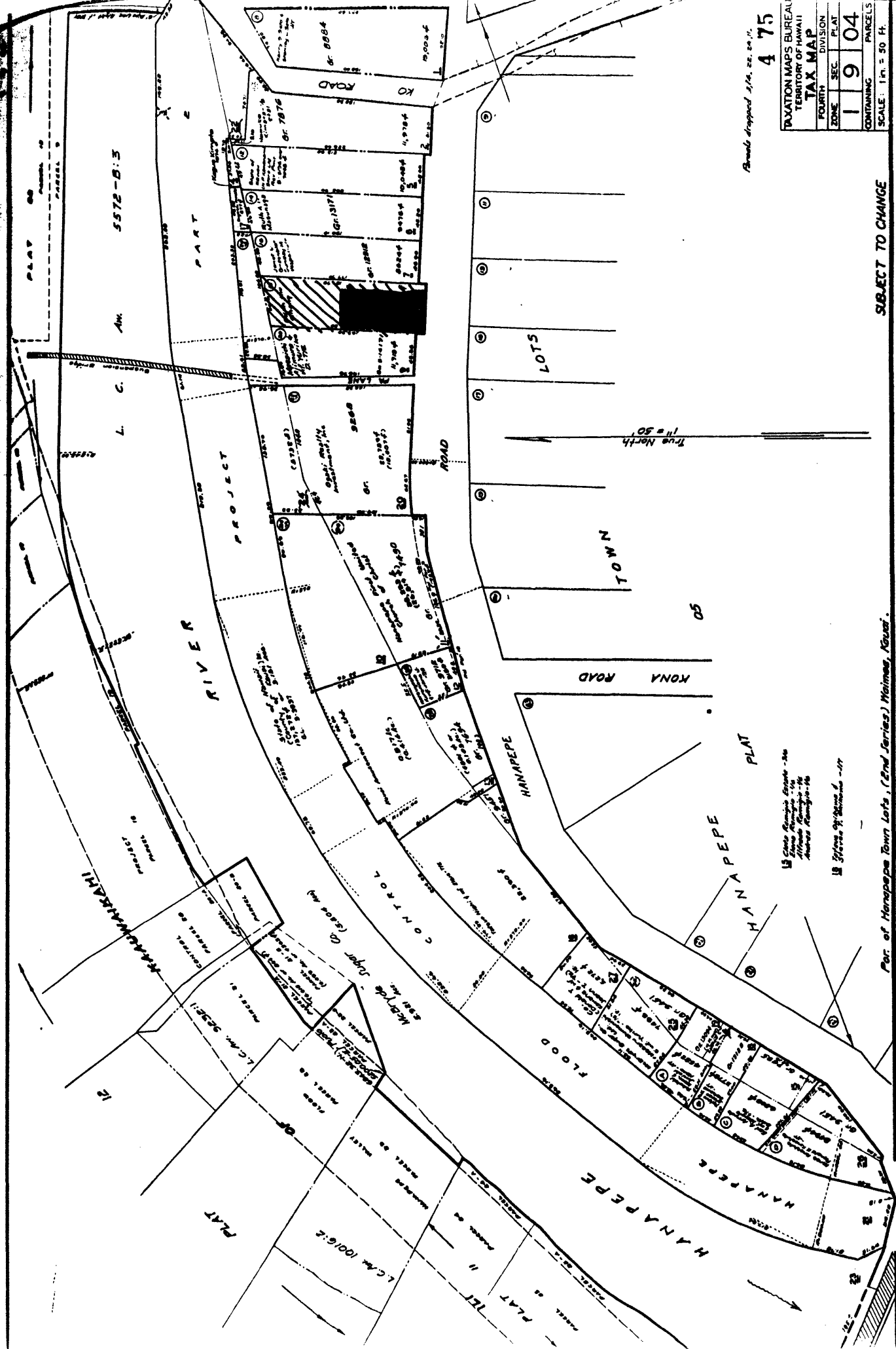

Revised dropped 3/14, 22, 23, 24, 25, 26, 27, 28, 29, 30, 31, 32, 33, 34, 35, 36, 37, 38, 39, 40, 41, 42, 43, 44, 45, 46, 47, 48, 49, 50, 51, 52, 53, 54, 55, 56, 57, 58, 59, 60, 61, 62, 63, 64, 65, 66, 67, 68, 69, 70, 71, 72, 73, 74, 75, 76, 77, 78, 79, 80, 81, 82, 83, 84, 85, 86, 87, 88, 89, 90, 91, 92, 93, 94, 95, 96, 97, 98, 99, 100

4 75

TERRITORY OF HAWAII			
TAX MAP			
FOURTH	DIVISION	PLAT	PARCELS
1	9	04	
CONTAINING PARCELS			
SCALE: 1 in. = 50 Ft.			

SUBJECT TO CHANGE

15. State Range 2000 - 200
 16. State Range 2000 - 200
 17. State Range 2000 - 200
 18. State Range 2000 - 200

Part of Hanapepe Town Lots, (2nd Series) Moines, Agassiz.

**United States Department of the Interior
National Park Service**

**National Register of Historic Places
Continuation Sheet**

Section number _____ Page _____

SUPPLEMENTARY LISTING RECORD

NRIS Reference Number: 93001033 Date Listed: 10/13/93

Hanapepe Town Lot No. 18
Property Name

Kauai County HI State
County State

N/A
Multiple Name

This property is listed in the National Register of Historic Places in accordance with the attached nomination documentation subject to the following exceptions, exclusions, or amendments, notwithstanding the National Park Service certification included in the nomination documentation.

for *Antoinette of Rose*
Signature of the Keeper

10/14/93
Date of Action

Amended Items in Nomination:

Description: In the text, the construction date should read: 1926.

This information was confirmed with Tonia Moy of the Hawaii State Historic Preservation Office.

DISTRIBUTION:

- National Register property file
- Nominating Authority (without nomination attachment)